

# Wound Dressings

## Product Description

This product is a medical dressing used to cover wounds. It is primarily designed to protect the wound from external contamination, promote wound healing, and facilitate observation of the wound condition. The product consists of a transparent film, an absorbent pad, and an adhesive layer, making it suitable for various types of wound care.

## Instructions for Use

1. First, clean your hands to ensure hygiene during the procedure.
2. Disinfect the wound and the surrounding skin as usual, and allow the disinfectant to dry completely.
3. Select the appropriate size and type of dressing based on the wound size and condition.
4. Peel off the release paper, avoiding contact between your fingers and the adhesive layer or the part that will come into contact with the wound.
5. Align the dressing with the wound, gently apply it, and smooth it outward from the center to ensure close contact with the skin and avoid air bubbles.
6. If using a non-woven fabric dressing, ensure its placement does not interfere with observing and protecting the wound.
7. Replace the dressing every 2–3 days, or immediately if it becomes curled, leaks exudate, or is contaminated.
8. Removal: Slowly lift one side parallel to the skin and gently peel it off at a 180° angle. If adhesion occurs, moisten the edges with saline solution.

## Warnings and Precautions

1. This product is for single use only. Do not reuse to prevent cross-contamination.
2. This product is for single use only. Do not reuse to prevent cross-contamination.
3. If abnormalities such as redness, increased pain, exudate, or pus occur during use, discontinue use immediately and consult a doctor.
4. Keep this product out of reach of children to prevent misuse.
5. Store the product in its intact packaging in a cool, dry, and well-ventilated place, away from heat sources and open flames.
6. Do not use this product after its expiration date. Use it within the validity period.

## Contraindications

1. Do not use on individuals allergic to polyurethane film or medical pressure-sensitive adhesive.
2. Do not use on deep wounds, wounds with heavy exudate, or purulent infected wounds.

## Product Composition

Materials: polyurethane film, release paper, non-woven fabric.

## Storage Environment and Conditions

Store this product in a well-ventilated, dry, and temperature-appropriate location, away from high temperatures, open flames, and direct sunlight.

# Wound Dressings

Model	Size	Packing
SMD-WD-0101	4×5cm	100pcs/box, 20box/ctn
SMD-WD-0102	6×7cm	100pcs/box, 20box/ctn
SMD-WD-0103	10×12cm	50pcs/box, 20box/ctn
SMD-WD-0104	10×20cm	50pcs/box, 10box/ctn
SMD-WD-0105	10×25cm	50pcs/box, 10box/ctn
SMD-WD-0106	15×20cm	50pcs/box, 10box/ctn
SMD-WD-0107	5×5.7cm	50pcs/box, 40box/ctn
SMD-WD-0108	7×9cm	50pcs/box, 40box/ctn
SMD-WD-0109	8.5×10.5cm	50pcs/box, 20box/ctn
SMD-WD-0110	10×15cm	50pcs/box, 20box/ctn
SMD-WD-0111	10×12cm	50pcs/box, 20box/ctn
SMD-WD-0112	10×11.5cm	50pcs/box, 20box/ctn
SMD-WD-0113	10×15cm	50pcs/box, 20box/ctn



\*Other sizes can be customized according to customer requirements

Model	Size	Packing
SMD-WD-0201	4×5cm	50pcs/box, 20box/ctn
SMD-WD-0202	6×7cm	50pcs/box, 20box/ctn
SMD-WD-0203	6×9cm	50pcs/box, 20box/ctn
SMD-WD-0204	10×10cm	50pcs/box, 20box/ctn
SMD-WD-0205	10×15cm	50pcs/box, 20box/ctn
SMD-WD-0206	10×20cm	50pcs/box, 20box/ctn
SMD-WD-0207	10×25cm	50pcs/box, 20box/ctn
SMD-WD-0208	10×30cm	50pcs/box, 20box/ctn
SMD-WD-0209	10×35cm	50pcs/box, 20box/ctn
SMD-WD-0210	10×12cm	20pcs/box, 20box/ctn
SMD-WD-0211	15×20cm	20pcs/box, 20box/ctn



\*Other sizes can be customized according to customer requirements

# Wound Dressings

Model	Size	Packing
SMD-WD-0301	10×14cm	20pcs/box, 40box/ctn
SMD-WD-0302	12×25cm	20pcs/box, 20box/ctn
SMD-WD-0303	15×28cm	10pcs/box, 20box/ctn
SMD-WD-0304	20×30cm	20pcs/box, 20box/ctn
SMD-WD-0305	28×30cm	20pcs/box, 20box/ctn
SMD-WD-0306	30×45cm	20pcs/box, 10box/ctn
SMD-WD-0307	38×41cm	10pcs/box, 20box/ctn
SMD-WD-0308	45×45cm	20pcs/box, 10box/ctn
SMD-WD-0309	60×45cm	10pcs/box, 20box/ctn
SMD-WD-0310	90×60cm	10pcs/box, 20box/ctn
SMD-WD-0311	90×45cm	10pcs/box, 10box/ctn

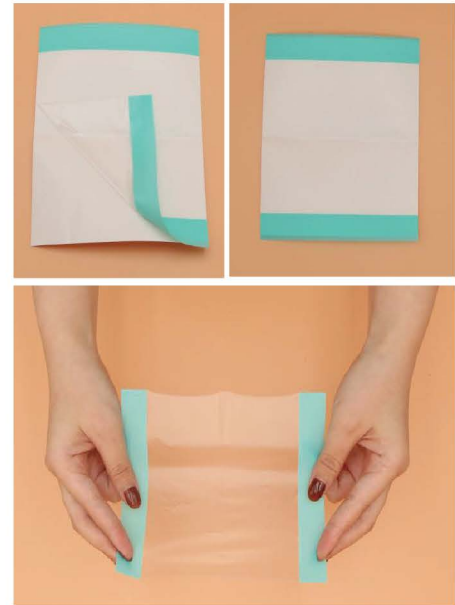

\*Other sizes can be customized according to customer requirements

Model	Size	Packing
SMD-WD-0401	10×14cm	20pcs/box, 40box/ctn
SMD-WD-0402	12×25cm	20pcs/box, 20box/ctn
SMD-WD-0403	15×28cm	10pcs/box, 20box/ctn
SMD-WD-0404	20×30cm	20pcs/box, 20box/ctn
SMD-WD-0405	28×30cm	20pcs/box, 20box/ctn
SMD-WD-0406	30×45cm	20pcs/box, 10box/ctn
SMD-WD-0407	38×41cm	10pcs/box, 20box/ctn
SMD-WD-0408	45×45cm	20pcs/box, 10box/ctn
SMD-WD-0409	60×45cm	10pcs/box, 20box/ctn
SMD-WD-0410	90×60cm	10pcs/box, 20box/ctn
SMD-WD-0411	90×45cm	10pcs/box, 10box/ctn



\*Other sizes can be customized according to customer requirements

# Wound Dressings

Model	Size	Packing
SMD-WD-0501	5cm×10m	1roll/box, 30box/ctn
SMD-WD-0502	7cm×10m	1roll/box, 30box/ctn
SMD-WD-0503	10cm×10m	1roll/box, 30box/ctn
SMD-WD-0504	15cm×10m	1roll/box, 30box/ctn
SMD-WD-0505	15cm×200m	2roll/ctn
SMD-WD-0506	30cm×100m	3roll/ctn
SMD-WD-0507	45cm×200m	1roll/ctn



\*Other sizes can be customized according to customer requirements

Model	Size	Packing
SMD-WD-0601	5×8cm	50pcs/box, 20box/ctn
SMD-WD-0602	6×7cm	50pcs/box, 40box/ctn
SMD-WD-0603	6×8cm	50pcs/box, 40box/ctn
SMD-WD-0604	9×10cm	20pcs/box, 40box/ctn
SMD-WD-0605	9×15cm	20pcs/box, 40box/ctn
SMD-WD-0606	9×20cm	20pcs/box, 20box/ctn
SMD-WD-0607	9×25cm	20pcs/box, 20box/ctn
SMD-WD-0608	10×10cm	20pcs/box, 40box/ctn
SMD-WD-0609	10×15cm	20pcs/box, 40box/ctn
SMD-WD-0610	10×20cm	20pcs/box, 20box/ctn
SMD-WD-0611	10×25cm	20pcs/box, 20box/ctn
SMD-WD-0612	10×35cm	20pcs/box, 20box/ctn
SMD-WD-0613	6.3×9.5cm	50pcs/box, 40box/ctn
SMD-WD-0614	6×8cm	50pcs/box, 40box/ctn
SMD-WD-0615	7×9cm	50pcs/box, 40box/ctn
SMD-WD-0616	12×12cm	20pcs/box, 20box/ctn
SMD-WD-0617	12×14cm	20pcs/box, 20box/ctn



\*Other sizes can be customized according to customer requirements

# Wound Dressings

Model	Size	Packing
SMD-WD-0701	2×7.3cm	50pcs/box, 10box/ctn
SMD-WD-0702	3.5×9cm	50pcs/box, 10box/ctn
SMD-WD-0703	3.5×9cm	50pcs/box, 10box/ctn
SMD-WD-0704	3.5×9cm	50pcs/box, 10box/ctn
SMD-WD-0705	3.5×9cm	50pcs/box, 10box/ctn
SMD-WD-0706	3.5×9cm	50pcs/box, 10box/ctn
SMD-WD-0707	6.5×10.5cm	50pcs/box, 10box/ctn
SMD-WD-0708	6.5×10.5cm	50pcs/box, 10box/ctn
SMD-WD-0709	6×7cm	50pcs/box, 10box/ctn
SMD-WD-0710	6×8.5cm	50pcs/box, 10box/ctn
SMD-WD-0711	6.5×9.5cm	50pcs/box, 10box/ctn

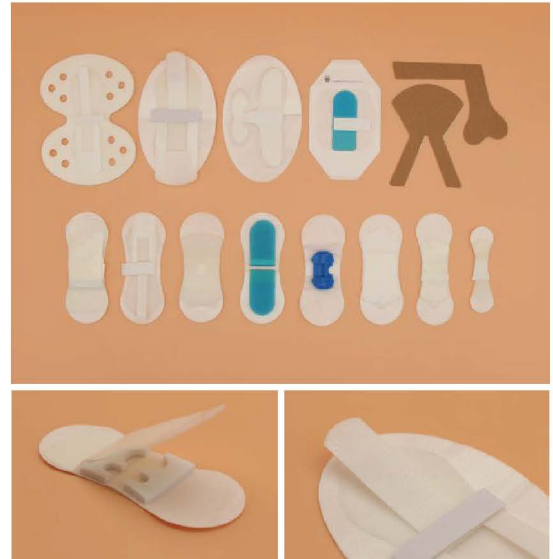

\*Other sizes can be customized according to customer requirements

Model	Size	Packing
SMD-WD-0801	5cm×10m	1roll/box, 30box/ctn
SMD-WD-0802	7cm×10m	1roll/box, 30box/ctn
SMD-WD-0803	10cm×10m	1roll/box, 30box/ctn
SMD-WD-0804	15cm×10m	1roll/box, 30box/ctn
SMD-WD-0805	9cm×10cm	20pcs/box, 40box/ctn
SMD-WD-0806	9cm×15cm	20pcs/box, 40box/ctn
SMD-WD-0807	9cm×20cm	20pcs/box, 20box/ctn
SMD-WD-0808	10cm×10cm	20pcs/box, 40box/ctn
SMD-WD-0809	10cm×20cm	20pcs/box, 20box/ctn

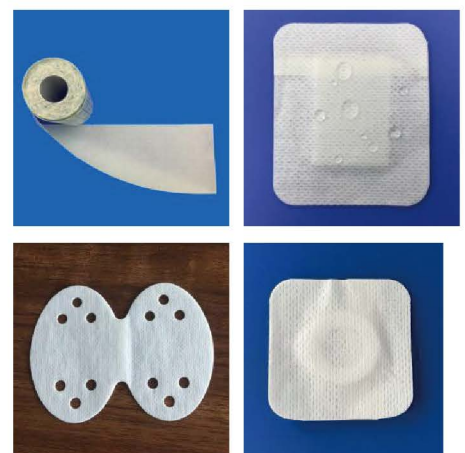

\*Other sizes can be customized according to customer requirements

# Wound Dressings

Model	Size	Packing
SMD-WD-0901	5cm×10m	1roll/box, 30box/ctn
SMD-WD-0902	7cm×10m	1roll/box, 30box/ctn
SMD-WD-0903	10cm×10m	1roll/box, 30box/ctn
SMD-WD-0904	15cm×10m	1roll/box, 30box/ctn
SMD-WD-0905	15cm×200m	2roll/ctn
SMD-WD-0906	30cm×100m	3roll/ctn
SMD-WD-0907	45cm×200m	1roll/ctn



\*Other sizes can be customized according to customer requirements

Model	Size	Packing
SMD-WD-1001	2cm×3m	1roll/box,100box/ctn
SMD-WD-1002	2.5cm×1.5m	1roll/box,100box/ctn
SMD-WD-1003	2.5cm×2.5m	1roll/box,100box/ctn
SMD-WD-1004	2.5cm×3m	1roll/box,100box/ctn
SMD-WD-1005	2.5cm×5m	1roll/box,100box/ctn
SMD-WD-1006	3.5cm×1.5m	1roll/box,100box/ctn
SMD-WD-1007	4cm×1.5m	1roll/box,100box/ctn
SMD-WD-1008	4cm×1.5m	1roll/box,100box/ctn
SMD-WD-1009	5cm×5m	1roll/box,100box/ctn



\*Other sizes can be customized according to customer requirements

# Wound Dressings

Model	Size	Packing
SMD-WD-1101	4×7cm	50pcs/box,40box/ctn
SMD-WD-1102	3×15cm	20pcs/box,20box/ctn
SMD-WD-1103	10×15cm	20pcs/box,10box/ctn
SMD-WD-1104	10×20cm	20pcs/box,10box/ctn
SMD-WD-1105	20×30cm	10pcs/box,20box/ctn
SMD-WD-1106	30×30cm	10pcs/box,20box/ctn
SMD-WD-1107	21cm×15m	6roll/ctn
SMD-WD-1108	30cm×15m	3roll/ctn
SMD-WD-1109	40cm×15m	2roll/ctn



\*Other sizes can be customized according to customer requirements

Model	Size	Packing	Thickness
SMD-WD-1201	5×5cm	1pcs/bag,10pcs/box	0.5mm
SMD-WD-1202	10×10cm	1pcs/bag,10pcs/box	0.5mm
SMD-WD-1203	15×15cm	1pcs/bag,10pcs/box	0.5mm
SMD-WD-1204	14×18cm	1pcs/bag,10pcs/box	0.5mm
SMD-WD-1205	15×18cm	1pcs/bag,10pcs/box	0.35mm
SMD-WD-1206	5×5cm	1pcs/bag,10pcs/box	0.35mm
SMD-WD-1207	10×10cm	1pcs/bag,10pcs/box	0.35mm
SMD-WD-1208	15×15cm	1pcs/bag,10pcs/box	0.35mm

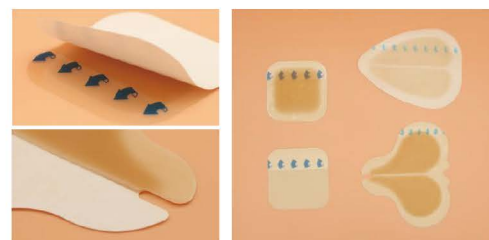

\*Other sizes can be customized according to customer requirements

Model	Size	Packing
SMD-WD-1301	9×10cm	10pcs/box, 20box/ctn
SMD-WD-1302	5×5cm	10pcs/box, 20box/ctn
SMD-WD-1303	9×10cm	10pcs/box, 20box/ctn
SMD-WD-1304	10×10cm	10pcs/box, 20box/ctn



\*Other sizes can be customized according to customer requirements

# Wound Dressings

Model	Size	Packing
SMD-WD-1401	10×10cm	10pcs/box, 20box/ctn
SMD-WD-1402	15×15cm	10pcs/box, 10box/ctn
SMD-WD-1403	10×20cm	10pcs/box, 5box/ctn
SMD-WD-1404	15×20cm	10pcs/box, 5box/ctn
SMD-WD-1405	10×30cm	10pcs/box, 5box/ctn
SMD-WD-1406	18×18cm	10pcs/box, 10box/ctn

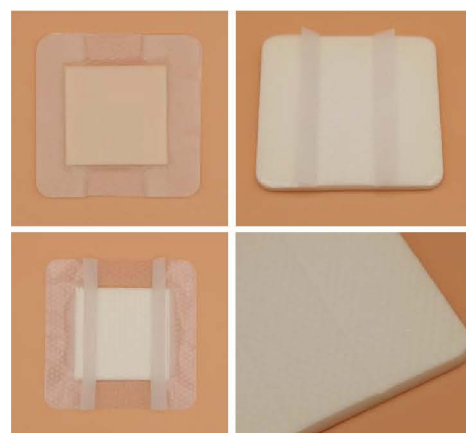

\*Other sizes can be customized according to customer requirements

Model	Size	Packing
SMD-WD-1501	5×5cm	10pcs/box, 20box/ctn
SMD-WD-1502	10×10cm	10pcs/box, 20box/ctn
SMD-WD-1503	6×7cm	50pcs/box, 12box/ctn
SMD-WD-1504	10×10cm	20pcs/box, 40box/ctn
SMD-WD-1505	10×15cm	20pcs/box, 20box/ctn
SMD-WD-1506	10×20cm	20pcs/box, 20box/ctn
SMD-WD-1507	10×25cm	20pcs/box, 20box/ctn
SMD-WD-1508	6×7cm	50pcs/box, 12box/ctn
SMD-WD-1509	5×5cm	10pcs/box, 20box/ctn
SMD-WD-1510	10×10cm	10pcs/box, 20box/ctn
SMD-WD-1511	10×12cm	10pcs/box, 20box/ctn
SMD-WD-1512	10×15cm	10pcs/box, 20box/ctn
SMD-WD-1513	15×15cm	10pcs/box, 20box/ctn
SMD-WD-1514	6×7cm	10pcs/box, 20box/ctn
SMD-WD-1515	10×10cm	10pcs/box, 20box/ctn
SMD-WD-1516	6×7cm	10pcs/box, 20box/ctn

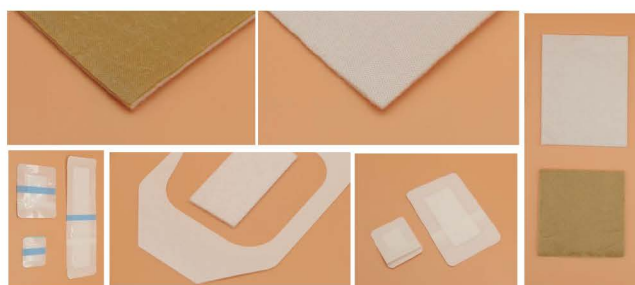

Non adherent type

Non adherent type

Non adherent type

Non adherent type

Non adherent type

Waterproof type

Waterproof type

Self adhesive type

\*Other sizes can be customized according to customer requirements



Website: [www.sainsmed.com](http://www.sainsmed.com)

E-mail: [sales@sainsmed.com](mailto:sales@sainsmed.com)

Manufacturer: Hubei Engi Biotechnology Co.,Ltd.

Phone Number:+86-15295546603

What's up:+86-15295546603