

DIAMETER

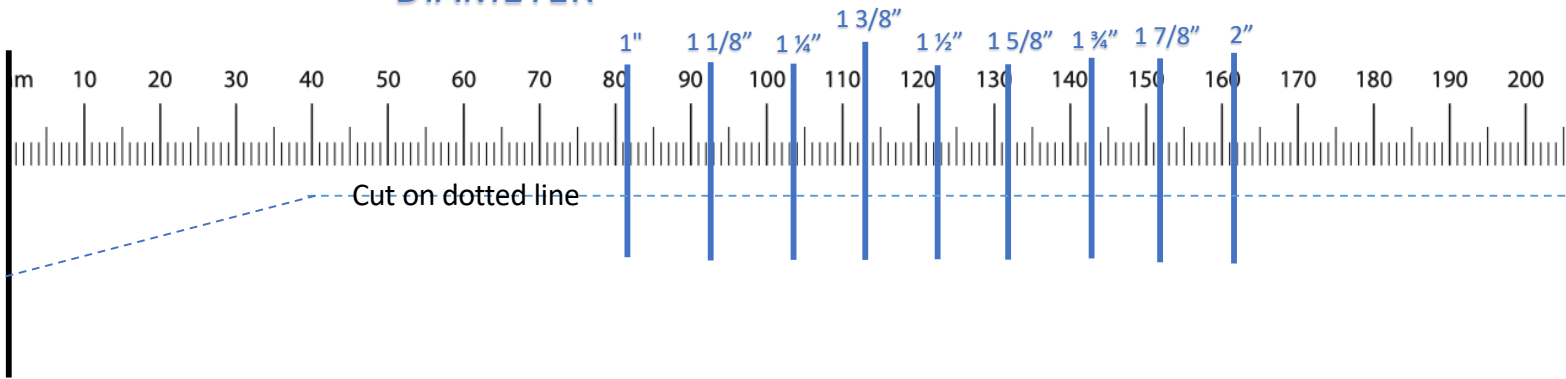

TO MEASURE THE DIAMETER OF YOUR TUBING, CUT ALONG THE CUT LINE AND WRAP THE MEASURING DEVICE AROUND THE TUBE TO SEE WHICH BLUE LINE ALIGNS TO THE RIGHT OF THE FIRST ONE (BLACK LINE) AND READ OFF THE DIAMETER VALUE TO ORDER THE CORRECT SIZE MOUNT FOR YOUR **NAVI**. IF THE BLACK LINE GOES BEYOND THE BLUE LINE, THE TUBE IS TOO BIG, SO ORDER THE NEXT LARGER OR SEND A PICTURE FOR ASSISTANCE.

IF NONE OF THE LINES LINE UP (OR CLOSE - SMALLER), CONTACT **NAVI** AT support@navinightvision.com AND SEND A PICTURE OF THE MEASUREMENT SO WE CAN ASSIST YOU.

MAKE SURE YOU PRINT IT ACTUAL SIZE (100% SCALE). MAKE SURE YOU UNCLICK THE SCALE TO FIT BUTTON

ALIGN TOP EDGE OF PAPER

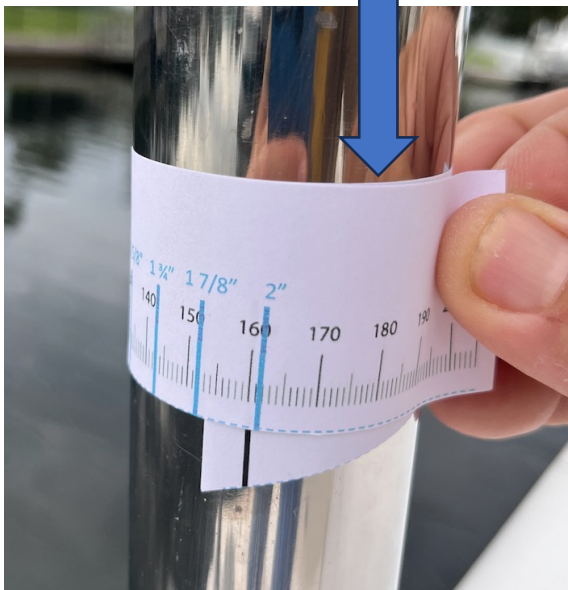

EXAMPLE: THIS IS A 2" TUBE JUST UNDER THE 2" LINE (ORDER 2" MOUNT). WHEN MEASURING, MAKE SURE THE TOP EDGE OF THE PAPER IS ALIGNED ALSO TO GET ACCURACY

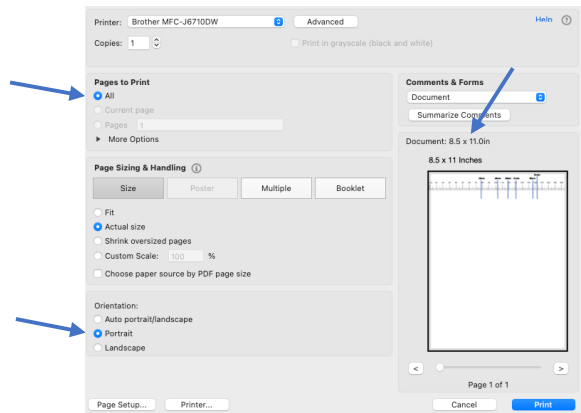

MAKE SURE YOU PRINT THIS WITH THE FOLLOWING SETTINGS: 8.5" X 11", **Actual Size** or **100% scale**, Portrait Orientation.