

Overview of Machine Parts and Controls

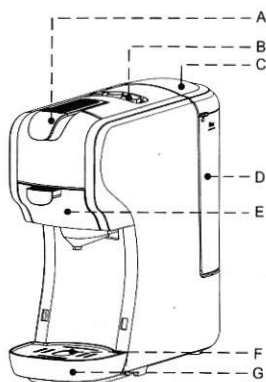

No.	Name
A	Handle
B	Buttons
C	Water tank cover
D	Water tank
E	Brewing Basket
F	Drip tray cover
G	Drip tray

operating instructions

A. First Use

Caution: Improper handling of electrical equipment is dangerous and can be lethal. Please pay attention to the safety precautions in this manual, in particular the following:

- Danger of scalding: beware of hot water!
- Do not operate the machine with an empty water tank or water is less than **MINIMUM** level.
- Do not open the handle when the machine is brewing.
- Always pull out the power plug before cleaning the machine.
- Only use the machine in a dry room.
- Thoroughly rinse out the water tank with fresh water before using for the first time. Clean the Capsule coffee machine using a damp cloth only.

Before using for the first time or after long pauses (e.g. holidays) the machine may be difficult to pump water, this short procedure can help pump to self priming by using the pipe to fill water into the circuit manually prior to turn on the machine for first refill.

Step 1: Insert the pipe into the water entrance.

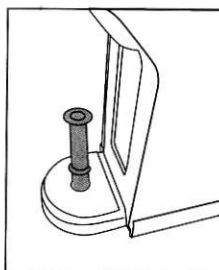

Step 2: Fill water into the pipe.

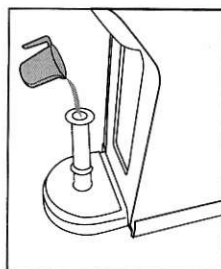

Step 3: Inject the water from pipe into the machine so that the internal circuit is filled with water.

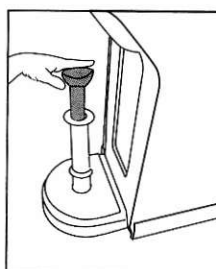

After above steps, the machine will be able to pump water out normally.
* If necessary, repeat the steps for 2 or 3 times..

B. Filling the water tank

There are two ways of filling water tank.

- 1 Filling without removing the tank
 - raise the water tank cover
 - Fill the tank with cold fresh water
 - the maximum capacity is 0.6 litre
 - low down the tank cover
- 2 Filling by removing the water tank
 - Hold the water grip at tilting angle as shown in direction to remove the water tank from the machine.
 - Fill the tank up to the "MAX" mark with cold fresh water (the maximum capacity is 0.6 litre).
 - Slide the water tank slowly on water tank base, when the water tank outlet is inserted in the inlet receptacle, pushing firmly on the water grip as shown in direction to lock the water tank.
- 3 Connect the power supply
- 4 Press the switch button
 - The lights at buttons become steady when the machine is heated up heating up time is 45 seconds approximately
- 5 Press the lungo coffee button, wait for the appliance to complete the flush out.
 - Before pressing the button, make sure that:
 - the handle is closed without capsule inside.
 - the water tank is full.
 - the water tank is firmly in place, otherwise water may leak
 - a large bowl (250ml size or above) is placed under the dispenser.
 - press the lungo coffee button to start flush out.
 - Open the handle when the flush out process stopped automatically.
 - Empty the cup.
 - Flush out cycle is finished.

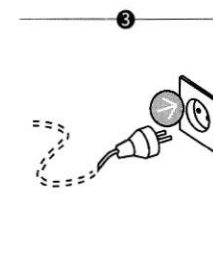
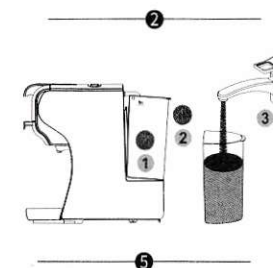



Tips: The machines has different adaptor for different capsules, details refer to below

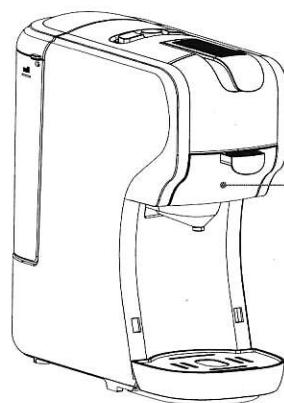

For Nespresso capsules



For Dolce-Gusto capsules



For k-cup capsules
(Optional configuration)

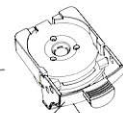

For ground coffee or
E.S.E. pod (44 mm)
(Optional configuration)



Hot Drink or Cold Drink Mode



1



2



3

Hot Drink Mode

1. Connect the device to the main socket, the On/Off button will flash twice in red and twice in blue, indicating power is well connected.

2. One quick press to the ON/OFF button to turn it on in Red light, the small cup button and large cup button will be flashing in blue for 35s about to finish the heating up process.

3. When the small cup button and large cup button stop flashing, the device is ready for hot drink. In this mode, The small cup and large cup are indicated large blue light and the ON/OFF button is indicated in steady RED light.

Cold Drink Mode

1. Connect the device to the main socket, the On/Off button will flash twice in red and twice in blue, indicating power is well connected.

2. Press the ON/OFF button and hold it pressed (about 2 seconds) until the indication light is turned on in BLUE light.

3. When the device enters in the cold drink mode, all the three buttons are indicated in steady BLUE indication light, In this mode, heater is switched off.

4. Tips : add 2-3 pieces of ice cube into the coffee cup for cold drink, or fill in 8~10°C (46~50°F) icy water into the water tank to brew your cold drink.

For Nespresso capsules



1

- Open the handle
- Pull out the brewing basket for Nespresso capsules.

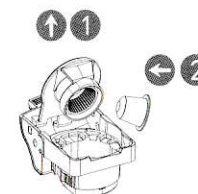

2

- Press the brewing basket cover lid
- Insert a capsule to the brewing basket.



3

- Push in the brewing basket with capsule.
- Close the handle.

4

- Place a cup and press the power button.
- All the buttons start to flash. After 20 seconds, the flashing stops to finish its heat up process.
- Press cup button to select your brewing amount (small cup or large cup).
- Cup button starts to flash and prepare to brew. (the brewing time for small cup is about 25s and the large cup is 47s)
- Lift the handle and pull out the brewing basket, throwing the used capsules into the designated container.

Tips:

1. When the power is turned on for the first time, it needs 20 seconds flashing for preheating before brewing starts, but for the second use, preheating is not needed.

2. Because the brewing temperature is too high, size of the capsule adapters may change a little and resulting in excessive dripping time.

This is a normal phenomenon, please use the drip tray to collect and wait for cooling.



For Dolce-Gusto capsules



- 1
 - Open the handle
 - Pull out the brewing basket for Dolce-Gusto capsules, this is normal performance.



- 2
 - Press the brewing basket cover lid
 - Insert a capsule to the brewing basket.

- 3
 - Push in the brewing basket with capsule.
 - Close the handle.



- 4
 - Place a cup and press the power button.
 - All the buttons start to flash. After 20 seconds, the flashing stops to finish its heat up process.
 - Press cup button to select your brewing amount (small cup or large cup).
 - Cup button starts to flash and prepare to brew. (the brewing time for small cup is about 25s and the large cup is 47s)
 - Lift the handle and pull out the brewing basket, throwing the used capsules into the designated container.

Tips:

1. When the power is turned on for the first time, it needs 20 seconds flashing for preheating before brewing starts, but for the second use, preheating is not needed.

2. Because the brewing temperature is too high, size of the capsule adapters may change a little and resulting in excessive dripping time.

This is a normal phenomenon, please use the drip tray to collect and wait for cooling.

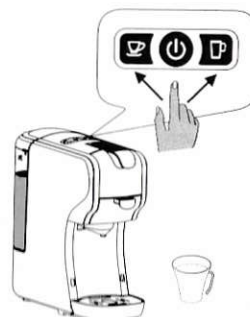

For coffee powder (Optional configuration)

- 1
 - Open the handle
 - Pull out the brewing basket for coffee powder, this is normal performance.



Coffee powder



Press down the coffee powder

- 3
 - Push in the brewing basket with coffee powder.
 - Close the handle, normal performance.



- 4
 - Place a cup and press the power button.
 - All the buttons start to flash. After 20 seconds, the flashing stops to finish its heat up process.
 - Press cup button to select your brewing amount (small cup or large cup).
 - Cup button starts to flash and prepare to brew. (the brewing time for small cup is about 25s and the large cup is 47s)
 - Lift the handle and pull out the brewing basket, throwing the used capsules into the designated container.

Tips:

1. When the power is turned on for the first time, it needs 20 seconds flashing for preheating before brewing starts, but for the second use, preheating is not needed.

2. Because the brewing temperature is too high, size of the capsule adapters may change a little and resulting in excessive dripping time.

This is a normal phenomenon, please use the drip tray to collect and wait for cooling.

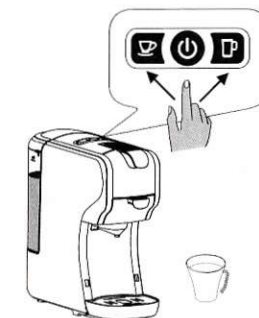

For 44mm E.S.E POD (Optional configuration)

- 1
 - Open the handle
 - Pull out the brewing basket for coffee powder, this is normal performance.



Remove S.S.T filter powder cup, insert the ESE filter cup. Place the ESE coffee pod into the adapter.



Ensure that the edges of the ESE coffee beans do not extend beyond the filter cup, and then close the lid.

3

- Push in the brewing basket with coffee powder.
- Close the handle. normal performe.



4

- Place a cup and press the power button.
- All the buttons start to flash. After 20 seconds, the flashing stops to finish its heat up process.
- Press cup button to select your brewing amount (small cup or large cup).
- Cup button starts to flash and prepare to brew.(the brewing time for small cup is about 25s and the large cup is 47s)
- Lift the handle and pull out the brewing basket, throwing the used capsules into the designated container.

Tips:

1. When the power is turned on for the first time, it needs 20 seconds flashing for preheating before brewing starts, but for the second use, preheating is not needed.
2. Because the brewing temperature is too high, size of the capsule adapters may change a little and resulting in excessive dripping time.

This is a normal phenomenon, please use the drip tray to collect and wait for cooling.

**For k-cup capsules (Optional configuration)**

1

- Open the handle
- Pull out the brewing basket for capsules, this is normal performance.

2

- Insert a capsule to the brewing basket.



1

- Push in the brewing basket with capsule.
- Close the handle.



1

- Place a cup and press the power button.
- All the buttons start to flash. After 20 seconds, the flashing stops to finish its heat up process.
- Press cup button to select your brewing amount (small cup or large cup).
- Cup button starts to flash and prepare to brew.(the brewing time for small cup is about 25s and the large cup is 47s)
- Lift the handle and pull out the brewing basket, throwing the used capsules into the designated container.

Tips:

1. When the power is turned on for the first time, it needs 20 seconds flashing for preheating before brewing starts, but for the second use, preheating is not needed.
2. Because the brewing temperature is too high, size of the capsule adapters may change a little and resulting in excessive dripping time.

This is a normal phenomenon, please use the drip tray to collect and wait for cooling.

**Standby Mode**

1

Factory Default setting: Standby Mode

Time:15 mins

It means the machine will be turned off after 15mins inactive , and all the indicator lights will be off. To press the switch button to cancel the standby mode again if the machine is in standby mode

2

Standby mode setting

Keep pressing both the small cup button and large cup button, meanwhile insert the plug to the socket . ON/OFF button light will be on. Press small cup button, Small cup button light is off, Standby mode canceled. Press small cup button, small cup button light is on, standby mode activated.

3

Clean mode function

1. Put a cup in front of the machine
2. Put some detergent into the water tank
3. Press the small cup and connect the power at the same time
4. The switch button and small cup button are lighted, then press the small cup button to start clean, the working time is 120S. Press the small cup button again to stop.

Decalcification

Drinking water varies according to region.

The lime particles in hard drinking water are deposited as residues in the machine and can block the piping and cause damage. To prevent this, be sure to decalcify the machine at least after making 300 to 400 cups of coffee or, in any case if the production drops significantly or, after one or two months. Decalcification must be done correctly to prevent damage. So it is essential to follow these instructions.

4

Coffee Volume Setting**Small Cup volume setting**

1. Put coffee cup under the coffee outlet
2. The machine is in normal working condition. Keep pressing the small cup button, then release the button till you get the coffee you want (Min:15S, Max:90S)

Large Cup volume setting

1. Put coffee cup under the coffee outlet
2. The machine is in normal working condition. Keep pressing the big cup button, then release the button till you get the coffee you want (Min:15S, Max: 90S)

5

Factory Default Setting

Press the large cup button, and meanwhile insert the plug to the socket. The indicator light of buttons will flash twice. It means the machine come back to factory default setting.

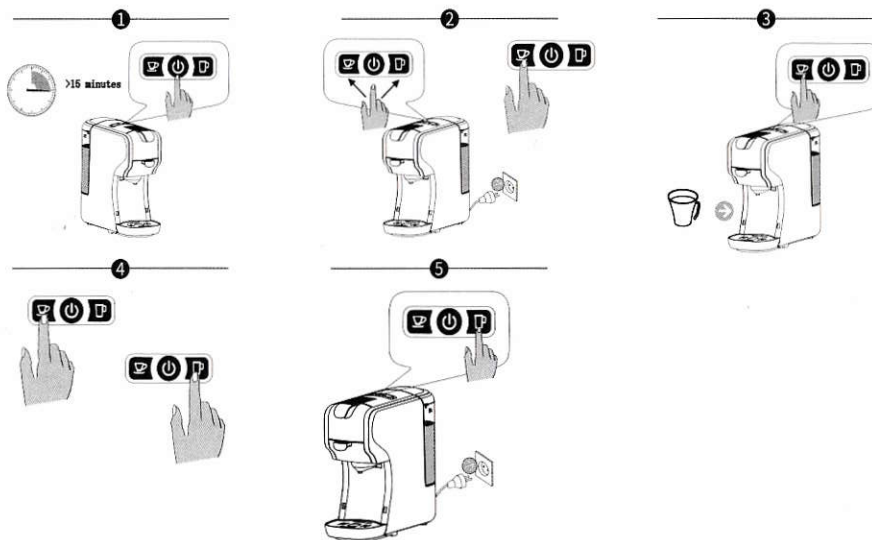
**Cleaning**

Risk of fatal electrical shock and fire. Never immerse the appliance or part of it in water. Be sure to unplug the machine before cleaning. Do not use any strong cleaning agent or solvent cleaner. Do not use sharp objects, brushes or sharp abrasives. Do not place in a dishwasher.

Brewing basket cleaning

-Take out the used coffee capsule/pod

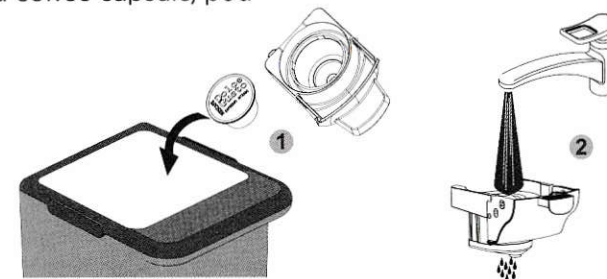

NOTE: Clean the coffee filter cup promptly before or after use to prevent clogging

Important!**DOLCE GUSTO® ADAPTOR-USAGE & CLEANING**

Please note when using the Dolce Gusto capsule adaptor that there are 2 parts to check when cleaning, the 1. Piercing pin 2. Pouring Nozzle on the adaptor.

Please see instructions for cleaning your adaptor:

1. Piercing Pin
2. Pouring Nozzle

**Holistic cleaning**

Important Notes



Prohibit to pull water to the machine.



Prohibit to open the handle when brewing.

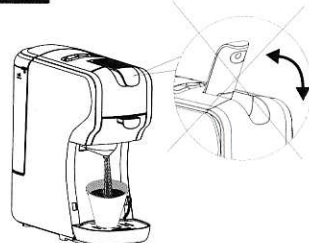

When starting the machine, the water tank must contain at least 200 ml of water.

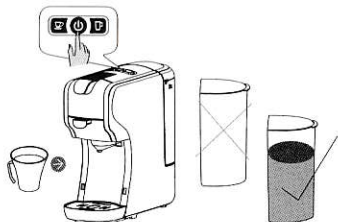

Adapter is still very hot after brewing. Be careful the HOT!

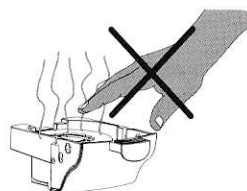

The top cover of the Dolce Gusto adapter and the brewing chamber where the adapter is inserted have sharp needles.

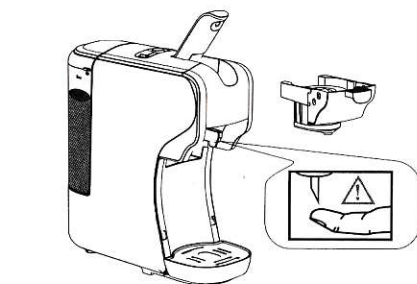

Do not touch these dangerous areas.

PROBLEM	CAUSE	SOLUTION
No coffee is brewed.	The water tank is empty.	Fill water in the water tank.
The coffee is not hot enough.	- the Cold cups / mugs. - Scale build-up in machine. - Cold machine.	Preheat cup / mug. - Descale. - For cold machine, brewing a cup of water to warm up the circuit.
Water on table	- Water tank is leaking. - drip tray is full of water.	- Check if the value on water tank is stuck. - empty the drip tray.
Handle can not close	- the brewing basket is not placed well	- Push the brewing basket into correct position

Technical data

Rated Voltage:	AC220-240V
Rated Frequency:	50/60Hz
Rated Power:	1450W
Pump Pressure:	Max.20 Bars
Water Tank Capacity:	0.6L
Protection Class:	I

Design or execution changes are reserved in the interest of technical progress.