

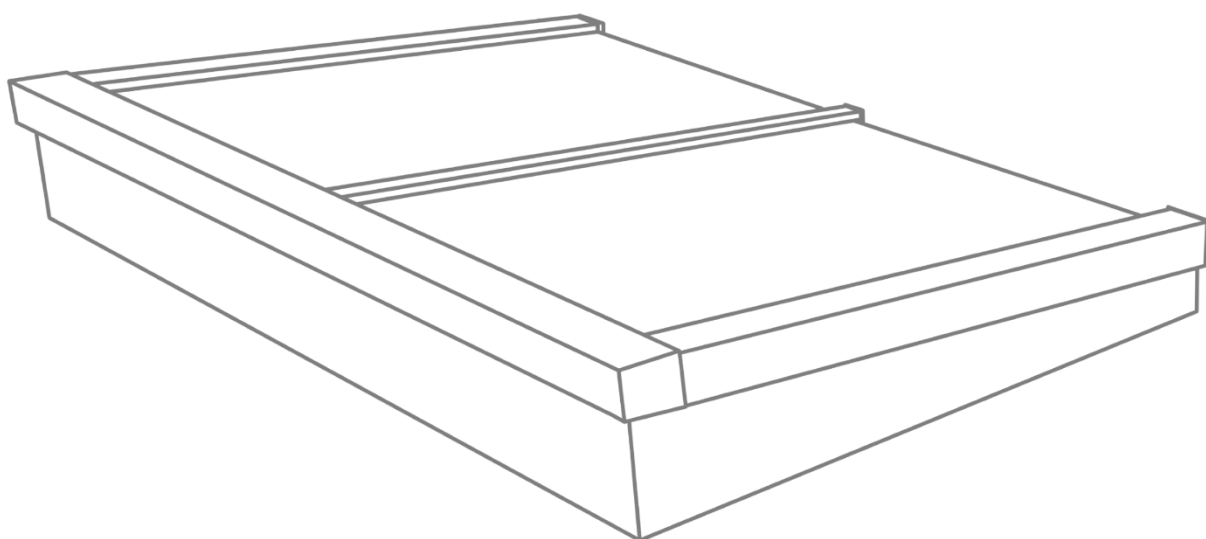

# ASSEMBLY MANUAL

## FLAT SKYLIGHT



1.

Make a recess in the roof where the width (B) and the length (L) are equal to the internal dimensions (clearance dimensions) of the wooden frame of the skylight. The diagonal dimensions must be identical to each other to ensure that the recess is straight. If you are placing insulation on the roof, you must provide a frame of at least 40 mm wide. The height of this frame must be equal to the thickness of the insulation. This way you maintain the ideal height of the upstand.

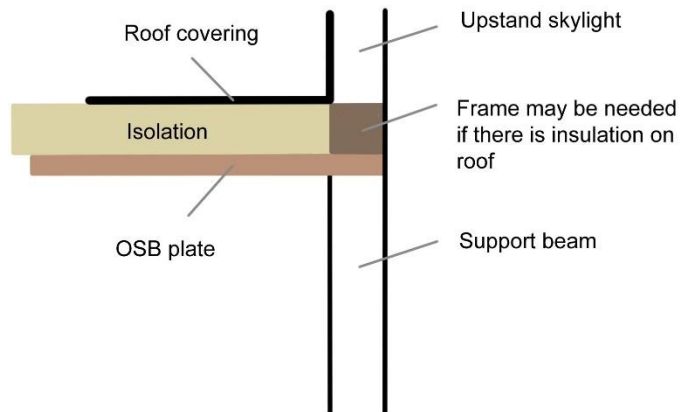
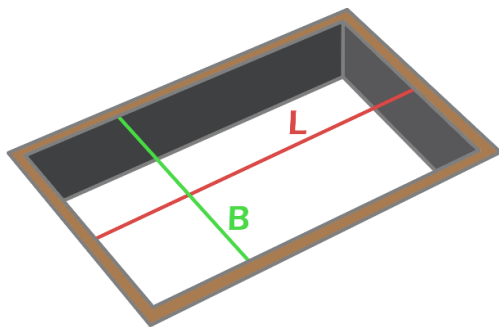

2.

Remove the frame protection profiles, place it over the opening and fix it to the roof all around. (It is recommended to apply PU foam or silicone between the roof and the frame).





3.

Glue the roof covering all around up to the edge of the aluminium profile.



4.

Carefully place the glass with the laminated side on the inside and the coating on the outside in the compartment(s) (See stickers on the glass). Make sure that the glass fits against the PVC blocks at the bottom. Provide equal space on the left and right and make sure that all rubbers remain in place. **Wear gloves to prevent cuts!**

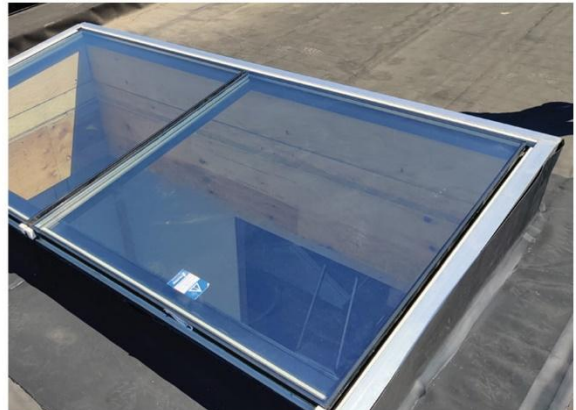



5.

Spray silicone on the pre-drilled profile under the glass. Screw the cover profile onto this with the small screws.



6.

Attach the cover plates left and right with the large screws with painted heads. If your frame has intermediate beams, attach the cover plates of these as well.



7.

Screw the pressure slats left and right, and if intermediate beams also in the middle, into the ledge of the roof beams, the correct position is indicated on the profiles. These must fit perfectly against the cover plates.

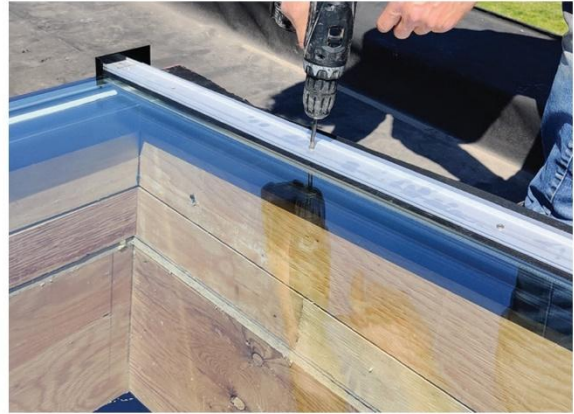

8.

Then screw the pressure slat on top. The rubber seal (on the glass side) of the top pressure slat should lie over the rubber seals of the cross pressure slats. Note: There should be approximately 2 mm of clearance between the top pressure slat and the cross pressure slats (the cover cap should still fit between them).



9.

Tap the cover caps left and right, and if intermediate beam(s) in the middle, onto the pressure slats. These must fit perfectly against the cover plates at the bottom. Make sure that they click into place everywhere, if necessary use a wooden block and a hammer.

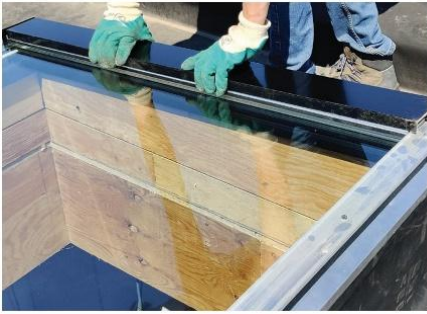

10.

Tap the cover profile at the top onto the pressure slat. Also make sure that it clicks into place everywhere.





11.

Glue the two corner caps at the top left and right with the supplied silicone.



12.

Glue the cover slat to the edge of the glass with silicone. The slat should not come above the glass to ensure good drainage.



# 13.

Seal the skylight further with silicone at the end pieces. (\*) Intermediate beams

