

PRODUCT SPECIFICATIONS

Model	SUAHT5630
Rated voltage	DC 58V
No-load speed	1500 min ⁻¹
Stroke rate at no load	3000spm
Blade length	550 mm
Cutting capacity	30 mm
Vibration level (in accordance with EN 60745-1 and EN 60745-2-15)	
Vibration total value	<2.5 m/s ²
Uncertainty of measurement	1.5 m/s ²
Noise emission level (in accordance with EN 60745-1 and EN 60745-2-15)	
A-weighted sound pressure level	87.0 dB(A)
Uncertainty of measurement	3 dB
A-weighted sound power level	96.0 dB(A)
Uncertainty of measurement	3 dB
Weight without Battery pack	3.54Kg

BATTERY AND CHARGER

Model	
Battery pack	SUABT5620
Weight	1.7 kg -
Charger	SUACH5602
Weight	0.87kg -
Compatible battery pack	SUABT5640,SUABT5620
Compatible charger	SUACH5602

VIBRATION LEVEL

⚠ WARNING

The declared vibration value has been measured with a standard test method and may be used to compare one tool with another.

The declared vibration value may be used in a preliminary assessment of exposure.

The vibration emission during actual use of power tool can differ from the declared total value depending on the ways in which the tool is used.

Identify safety measures to protect yourself based on an estimation of exposure in the actual conditions of use, taking account of all parts of the operating cycle such as the times when the tool is switched off and when it is running idle in addition to the trigger time.



SUAHT5630

Original instruction Cordless Hedge Trimmer

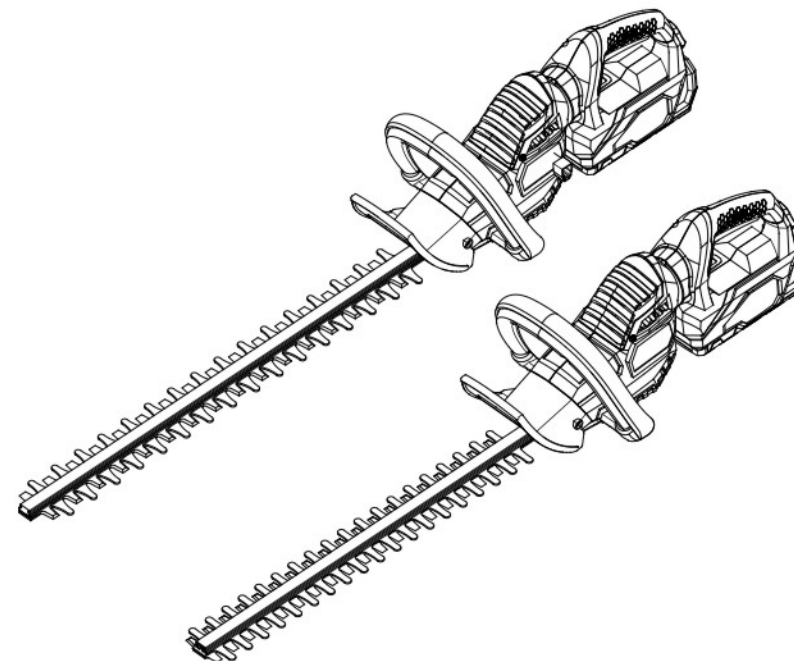

SENCI GENERAL TRADING LLC
Shop #13, Flora Hotel Building, Salem Plaza,
Baniyas Square, Deira, Dubai, UAE
TEL:+971 42955800
www.aipowerglobal.com

Important!

It is essential that you read the instructions in this manual before operating this machine.

Subject to technical modification.



INTENDED USE

This hedge trimmer is intended for cutting and trimming hedges and bushes in domestic use. It is not intended to be used for cutting above shoulder level.

GENERAL SAFETY WARNINGS

⚠ WARNING

Read all safety warnings and all instructions. Failure to follow the warnings and instructions may result in electric shock, fire or/and serious injury.

Save all warnings and instructions for future reference. The term "power tool" in the warnings refers to your mains-operated (corded) power tool or battery-operated (cordless) power tool.

WORK AREA SAFETY

Keep work area clean and well lit. Cluttered or dark areas invite accidents.

Do not operate power tools in explosive atmospheres, such as in the presence of flammable liquids, gases or dust. Power tools create sparks which may ignite the dust or fumes.

Keep children and bystanders away while operating a power tool. Distractions can cause you to lose control.

ELECTRICAL SAFETY

Do not expose power tools to rain or wet conditions. Water entering a power tool will increase the risk of electric shock.

PERSONAL SAFETY

Stay alert, watch what you are doing and use common sense when operating a power tool.

Do not use a power tool while you are tired or under the influence of drugs, alcohol or medication. A lapse of attention while operating power tools may result in serious personal injury.

Use personal protective equipment. Always wear eye protection. Protective equipment such as dust mask, gloves, non-skid safety shoes, hard hat or hearing protection used appropriately will reduce personal injuries.

Prevent unintentional starting

Ensure the switch is in the off position before connecting to power source and/or battery pack and when picking up or carrying the tool. Carrying power tools with your finger on the switch or energizing power tools that have the switch on invites accidents.

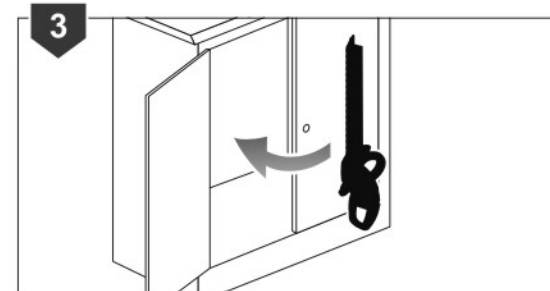
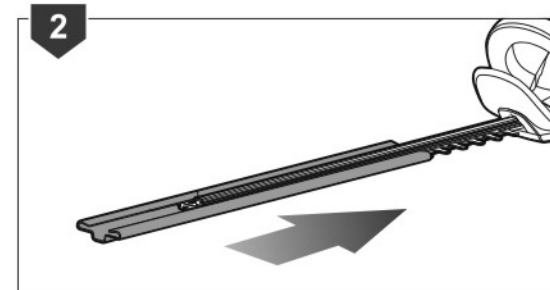
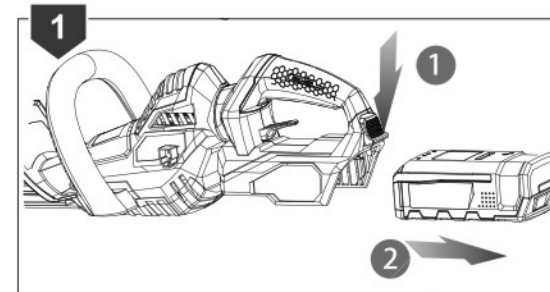
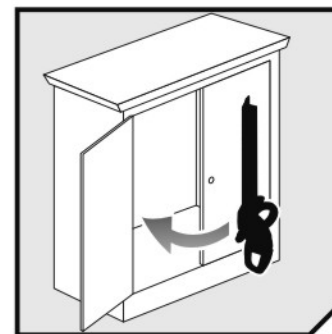

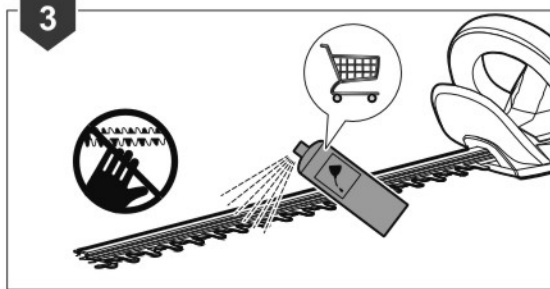
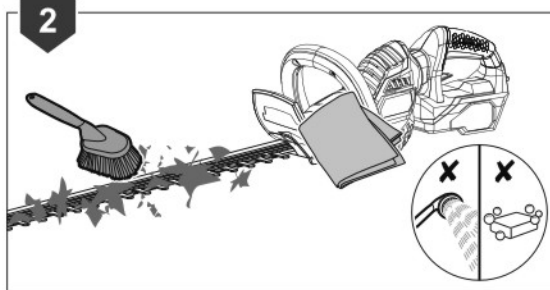
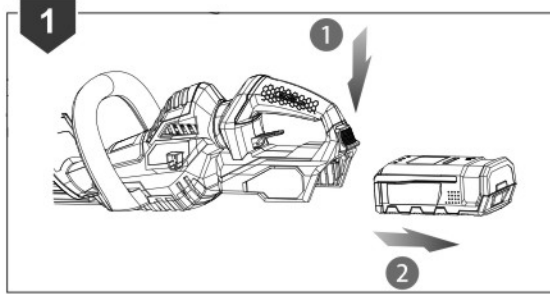
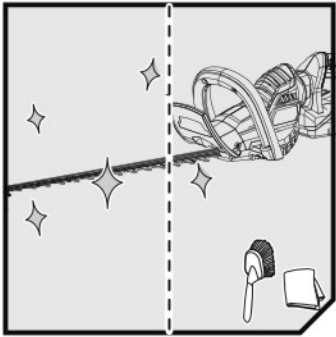

Remove any adjusting key or wrench before turning the power tool on.

A wrench or a key left attached to a rotating part of the power tool may result in personal injury.

Do not over-reach.

Keep proper footing and balance at all times. This enables better control of the power tool in unexpected situations.

Dress properly.

Do not wear loose clothing or jewellery. Keep your hair, clothing and gloves away from moving parts. Loose clothes, jewellery or long hair can be caught in moving parts.

POWER TOOL USE AND CARE

1) Do not force the power tool.

Use the power tool for the application. The correct power tool will do the job better and safer at the rate for which it was designed.

2) Do not use the power tool if the switch does not turn it on and off.

Any power tool that cannot be controlled with the switch is dangerous and must be repaired.

3) The battery pack from the power tool before making any adjustments, changing accessories, or storing power tools.

Such preventive safety measures reduce the risk of starting the power tool accidentally.

4) Store idle power tools out of the reach of children and do not allow persons unfamiliar with the power tool or these instructions to operate the power tool.

Power tools are dangerous in the hands of untrained users.

Maintain power tools.

Check for misalignment or binding of moving parts, breakage of parts and any other condition that may affect the power tool's operation. If damaged, have the power tool repaired before use. Many accidents are caused by poorly maintained power tools.

Keep cutting tools sharp and clean.

Properly maintained cutting tools with sharp cutting edges are less likely to bind and are easier to control.

Use the power tool, accessories and tool bits etc. in accordance with these instructions, taking into account the working conditions and the work to be performed.

Use of the power tool for operations different from those intended could result in a hazardous situation.

BATTERY TOOL USE AND CARE

Ensure the switch is in the off position before inserting battery pack.

Inserting the battery pack into power tools that have the switch on invites accidents.

Recharge only with the charger specified by the manufacturer.

A charger that is suitable for one type of battery pack may create a risk of fire when used with another battery pack.

Use power tools only with specifically designated battery packs.

Use of any other battery packs may create a risk of injury and fire.

When battery pack is not in use, keep it away from other metal objects like paper clips, coins, keys, nails, screws, or other small metal objects that can make a connection from one terminal to another.

Shorting the battery terminals together may cause burns or fire.

Under abusive conditions, liquid may be ejected from the battery; avoid contact.

If contact accidentally occurs, flush with plenty of soap and water.

If liquid contacts eyes, immediately seek medical help. Liquid ejected from the battery may cause irritation or burns.

SERVICE

Have your power tool serviced by a qualified repair person using only identical replacement parts.

This will ensure that the safety of the power tool is maintained.

HEDGE TRIMMER SAFETY WARNINGS

Keep all parts of the body away from the cutter blade. Do not remove cut material or hold material to be cut when blades are moving. Make sure the switch is off when clearing jammed material. A moment of inattention while operating the hedge trimmer may result in serious personal injury.

Carry the hedge trimmer by the handle with the cutter blade stopped. When transporting or storing the hedge trimmer always fit the cutting device cover. Proper handling of the hedge trimmer will reduce possible personal injury from the cutter blades.

Hold the power tool by insulated gripping surfaces only, because the cutter blade may contact hidden wiring. Cutter blades contacting a "live" wire may make exposed metal parts of the power tool "live" and could give the operator an electric shock.

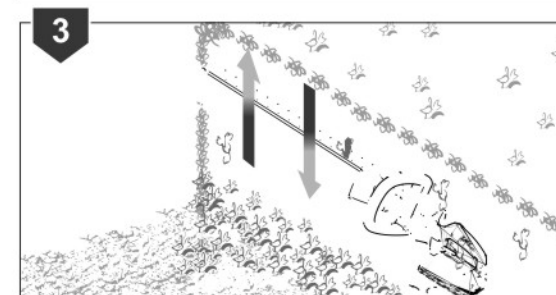
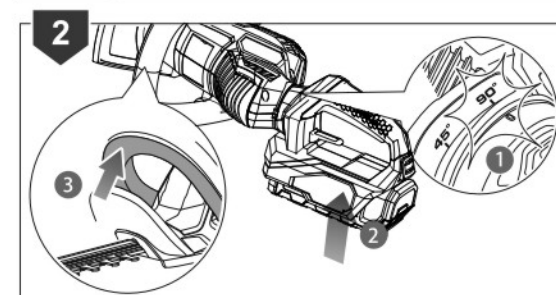
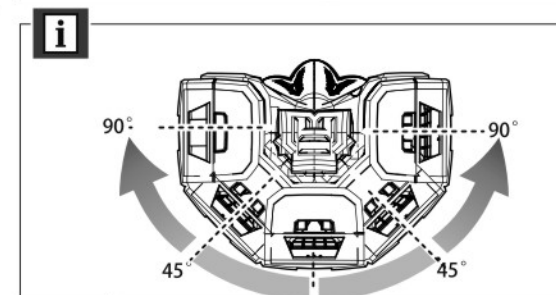
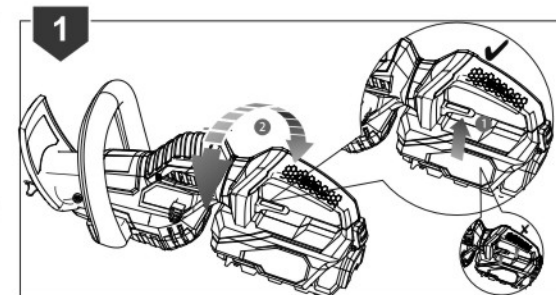
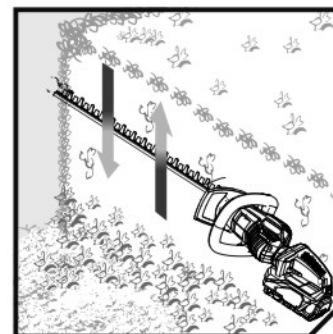

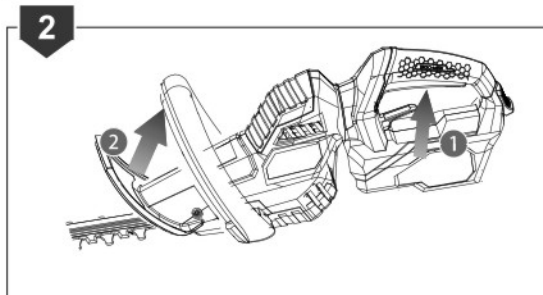
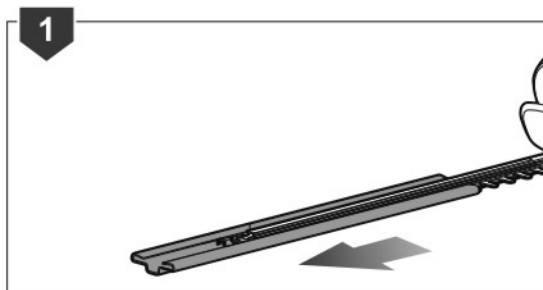
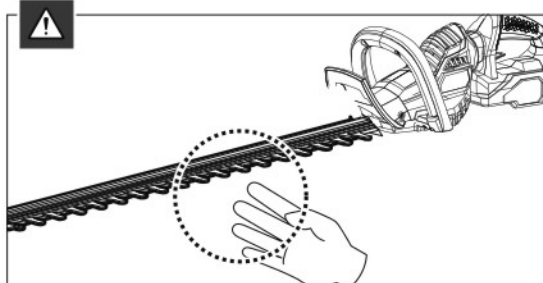
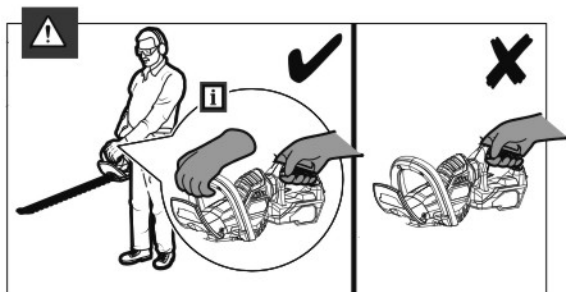
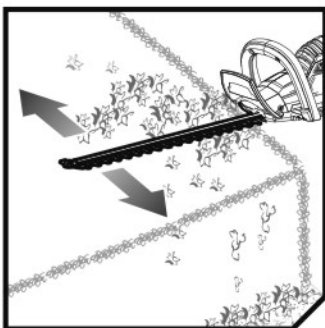

READ ALL INSTRUCTIONS BEFORE OPERATING

Read the instructions carefully. Be familiar with the controls and proper use of the unit.

Do not operate this unit when tired, ill, or under the influence of alcohol, drugs, or medication.

Inspect the unit before use. Replace damaged parts. Check for battery pack leaks.

Make sure all fasteners and guards are in place and secure. Replace cutting blades or any other parts that are cracked, chipped, or damaged. Make sure the cutting blade is properly installed and securely fastened. Failure to do so can result in personal injury to the operator and bystanders, as well as damage to the unit.

Use the right tool. Only use this hedge trimmer for the purpose intended.

Do not use hedge trimmer if switch will not turn the unit on or off. A unit that cannot be controlled with the switch is dangerous and must be repaired.

Clear the area to be cut before each use. Remove all objects such as cords, lights, wire, or string which can become entangled in the cutting blade.

Clear the area of children, bystanders, and pets. At a minimum, keep all children, bystanders and pets outside a 15m radius; there still may be a risk to bystanders from thrown objects. If you are approached, stop the unit immediately.

Do not operate power tools in explosive atmospheres, such as in the presence of flammable liquids, gases or dust. Power tools create sparks which may ignite the dust or fumes.

To avoid the risk of electric shock, do not operate unit in damp or wet locations.

Do not handle the unit with wet hands.

Do not allow children or untrained individuals to use this hedge trimmer.

To reduce the risk of injury, always wear full eye protection, footwear, goggles and clothing when using this machine.

Wear a face or dust mask if the operation is dusty.

Dress properly. Do not wear loose clothing or jewellery; they can be caught in moving parts.

Use of rubber gloves, substantial footwear and long trousers is recommended when working outdoors.

To prevent hair from being drawn into nearby air vents and becoming entangled in moving parts, wear protective hair covering to contain long hair or secure covered hair above shoulder level.

When transporting or storing the machine always fit with blade cover.

Always be aware of your surroundings and stay alert for possible hazards that you may not hear due to the noise of the machine.

Form the habit of checking to see that keys and adjusting wrenches are removed from the tool before turning it on.

Always ensure all the handles and guards are fitted when using the tool.

Never attempt to use an incomplete machine or one fitted with an unauthorised modification. The vibration level during actual use of the power tool can differ from the declared total value depending on the ways in which the tool is used.

It has been reported that vibrations from hand-held tools may contribute to a condition called Raynaud's Syndrome in certain individuals. Symptoms may include tingling, numbness and blanching of the fingers, usually apparent upon exposure to cold. Hereditary factors, exposure to cold and dampness, diet, smoking and work practices are all thought to contribute to the development of these symptoms. It is presently unknown what, if any, vibrations or extent of exposure may contribute to the condition. There are measures that can be taken by the operator to possibly reduce the effects of vibration:

Keep your body warm in cold weather. When operating the unit wear gloves to keep the hands and wrists warm. It is reported that cold weather is a major factor contributing to Raynaud's Syndrome. Check for alignment of moving parts, binding of Syndrome.

After each period of operation, exercise to increase blood circulation.

Take frequent work breaks. Limit the amount of exposure per day.

If you experience any of the symptoms of this condition, immediately discontinue use and see your physician about these symptoms.

WHILE OPERATING

Do not use trimmer without front handle in place.

Keep both hands on handles when unit is in use.

To avoid accidental starting, never carry your unit with your finger on the trigger.

Stay alert and pay attention to what you are doing.

Use common sense when using this hedge trimmer.

Wear heavy, long pants, substantial footwear and well fitting gloves. Do not wear short pants, sandals or go barefoot.

Do not operate in poor lighting. Use the unit only in daylight or good artificial light.

Do not over-reach or stand on unstable support. Keep good footing and balance at all times.

Do not use on ladder.

Do not force the hedge trimmer. It will do the job better and with less likelihood of a risk of injury at the rate for which it was designed.

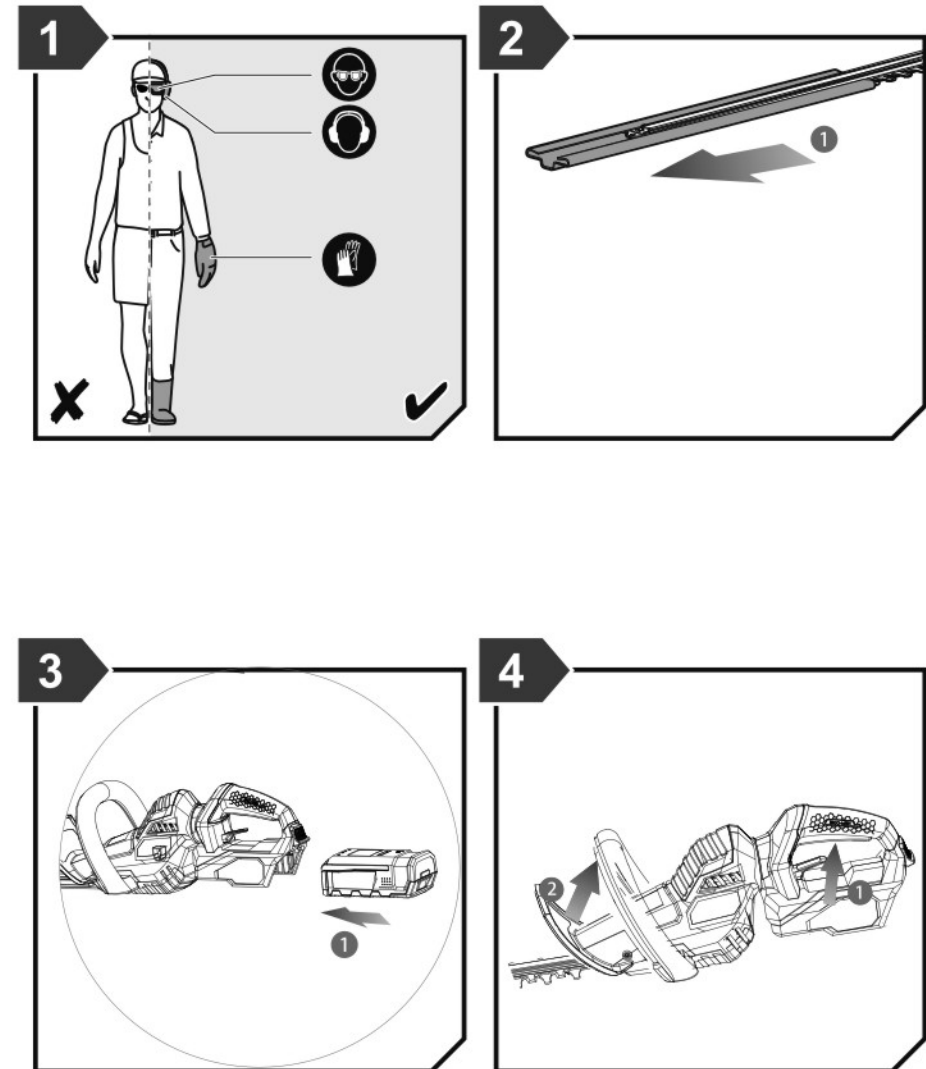

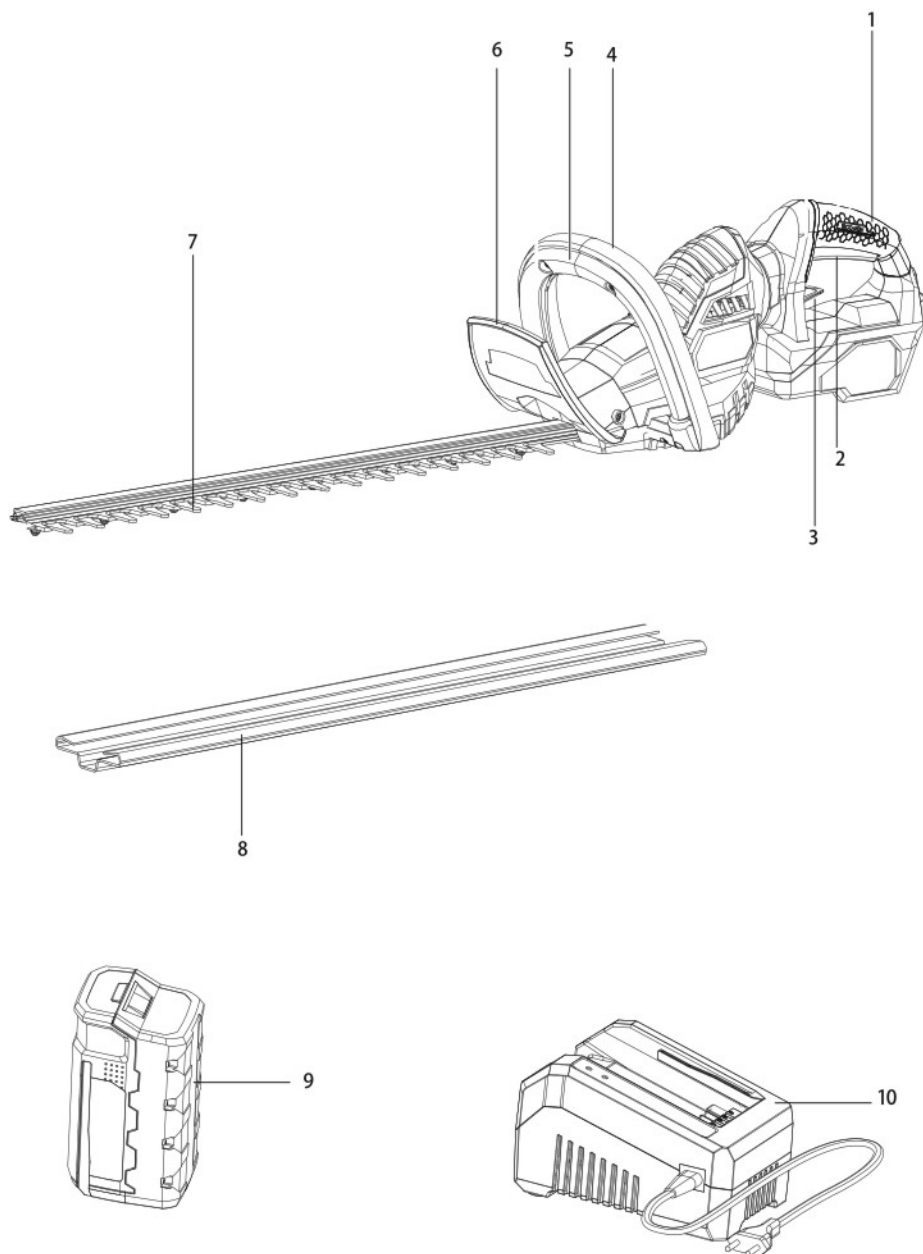

Release the trigger, allow the motor to stop, and remove the battery pack before performing maintenance, repair, or making adjustments.

This hedge trimmer is to be used for cutting hedges, bushes, and shrubs only. Do not use for any other purpose.

Before starting the unit, make sure the cutting blades will not come in contact with anything.

If the machine strikes or becomes entangled with foreign objects, stop the unit immediately, remove the battery pack and check for damage. Do not operate before repairing damage.

Do not operate the unit with loose or damaged parts.

Watch what you are doing. Use common sense.

Maintain hedge trimmer with care. Keep cutting edge sharp and clean for best performance and to reduce the risk of injury. Follow instructions for lubricating and changing accessories. Keep handles dry, clean, and free from oil and grease.

Check damaged parts. Before further use of the hedge trimmer, a guard or other part that is damaged should be carefully checked to determine that it will operate properly and perform its intended function. Moving parts, breakage of parts, mounting of parts, and any other condition that may affect its operation. A guard or other part that is damaged should be properly repaired or replaced by an authorised service centre.

Risk of cut. Keep hands away from blades. Do not attempt to remove cut material or hold material to be cut when blades are moving. Make sure battery pack is removed and the trigger is released when clearing jammed material from blades. Do not grasp the exposed cutting blades or cutting edges when picking up or holding the unit.

CAUTION

Blades continue to move for a short time after unit is turned off.

Keep hands, face, and feet at a safe distance from moving parts. Do not touch or try to stop the cutting blades when they are moving.

Always stop the motor when cutting is delayed or when walking from one cutting location to another.

Keep unit clean of hedge clippings and other materials. They may become lodged in the cutting blades.

Store the unit inside in a dry place, either locked up or up high to prevent unauthorised use or damage. Keep out of the reach of children or untrained individuals.

Replace blade cover when unit is not in use.

Never douse or squirt the unit with water or any other liquid. Keep handles dry, clean and free from debris. Clean after each use, see Storage instructions.

Be sure to secure the unit while transporting.

Keep these instructions. Refer to them often and use them to instruct other users. If you loan someone this unit, also loan them these instructions.

SERVICE

Service on unit must be performed only by qualified repair personnel. Service or maintenance performed by unqualified personnel could result in a risk of injury to the user, or damage to the unit. It may also void your warranty.

When servicing a unit, use only identical replacement parts.

Follow instruction in the of this manual in unauthorised parts or failure to follow Maintenance Instructions may create a risk of shock or serious injury to the user, or damage to the unit. It may also void your warranty.



WARNING

If any parts are missing, do not operate unit until the missing parts are replaced. Failure to do so could result in possible serious personal injury.

SAVE

THESE INSTRUCTIONS. REFER TO THEM FREQUENTLY AND USE THEM TO INSTRUCT OTHERS WHO MAY USE THIS UNIT. IF YOU LOAN SOMEONE THIS UNIT, LOAN THEM THESE INSTRUCTIONS ALSO.

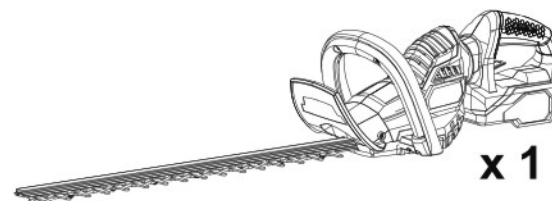

THE PRODUCT

- 1: REAR HANDLE
- 2: TRIGGER
- 3: LOCK BUTTON OF ROTATING HANDLE
- 4: FRONT HANDLE
- 5: FRONT HANDLE TRIGGER
- 6: GUARD
- 7: BLADE
- 8: SCABBARD
- 9: BATTERY PACK
- 10: CHARGER

SYMBOLS ON THE PRODUCT

-  Safety alert
-  Please read the instructions carefully before starting the machine.
-  Wear ear protection.
-  Wear eye protection.
-  Always hold the hedge trimmer with both hands when operating.
-  Wear non-slip, heavy duty gloves.
-  To prevent serious injury, do not touch cutting blades.
-  Do not expose to rain or damp condition.

The following signal words and meanings are intended to explain the levels of risk associated with this product:

-  **DANGER** Indicates an imminently hazardous situation, which, if not avoided, will result in death or serious injury.



Beware of thrown or flying objects. Keep all bystanders, especially children and pets, at least 15m away from the operating area.



Waste electrical products should not be disposed of with household waste. Please recycle where facilities exist. Check with your local authority or retailer for recycling advice.



Conforms to all regulatory standards in the country in the EU where the product is purchased.



GOST-R Conformity



The guaranteed sound power level is shown on this label by 96 dB.



Indicates a potentially hazardous situation, which, if not avoided, could result in death or serious injury.



Indicates a potentially hazardous situation, which, if not avoided, may result in minor or moderate injury.

CAUTION

(Without Safety Alert Symbol)
Indicates a situation that may result in property damage.

SYMBOLS IN THIS MANUAL



Parts or accessories sold separately



Note



Warning

OPERATION

For complete charging instructions, refer to the Operator's Manuals for your A-iPower battery pack and charger models.

NOTE: To avoid serious personal injury, always remove the battery pack and keep hands clear of the lock-out button when carrying or transporting the tool.

INSTALLING BATTERY PACK

Place the battery pack in the hedge trimmer. Align the groove on battery pack with the raised ribs in hedge trimmer.

Make sure the latch on the tool snaps in place of battery slot and that battery pack is secured in hedge trimmer before beginning operation.

REMOVING BATTERY PACK

Pull the battery latch to the battery side and pull out the battery along the raised slide ribs from the hedge trimmer.

Remove battery pack from the hedge trimmer.

CAUTION

When placing battery pack in your hedge trimmer, be sure groove on battery pack aligns with

raised ribs in hedge trimmer and latch snaps in place properly. Improper assembly of battery pack can cause damage to internal components.

STARTING THE HEDGE TRIMMER

Remove the blade cover.

For added safety, there is a micro switch in the front handle. When operating, hold the trimmer with both hands, one hand squeeze the trigger, and the other hand to squeeze the front handle.

STOPPING THE HEDGE TRIMMER

Release the trigger to stop the hedge trimmer.

Remove battery pack from the hedge trimmer.

ROTATING THE REAR HANDLE

The tool rear handle has 5 different operating angle. +/-45degree, +/-90degree and 0degree.

To get the desired operating angle, use Left hand hold the front handle and use right hand hold the rear handle without pressing the trigger, pull the level and rotate the rear handle to the desired angle and release the level.

BLOCK RELEASE GEAR BOX

This hedge trimmer is equipped with a block release system. If the blade jams, the blades will automatically retract allowing the jam to be cleared easily. Release the triggers, remove jammed material, then squeeze trigger again to restart the hedge trimmer. If the stem is too dense or too hard to be trimmed, use a pruning saw to clear the stem.

OPERATING TIPS

Do not force the hedge trimmer through heavy shrubbery. This can cause the blades to bind and slow down. If the blades slow down, reduce the pace.

Do not try to cut stems or twigs that are larger than 20mm thick, or those obviously too large to feed into the cutting blade. Use a non-powered hand saw or pruning saw to trim large stems.

If desired, you can use a string to help cut your hedge level. Decide how high you want the hedge. Then stretch a piece of string along the hedge at this height. Trim the hedge just above this guide line of string. Trim the side of a hedge so that it will be slightly narrower at the top. More of the edge will be exposed when shaped this way, and it will be more uniform. If blades do become jammed, stop the motor, allow the blades to stop and remove the battery pack before attempting to remove the obstruction.

Wear gloves when trimming thorny or prickly growth. When trimming new growth, use a wide sweeping action, so that the stems are fed directly into the cutting blade. Older growth will have thicker stems and will be trimmed easiest by using a sawing movement.

LIMITED WARRANTY

A-iPower warrants this outdoor product to be free of defects in material or workmanship for 24 months from the date of purchase by the original purchaser, subject to the limitations below. Please keep your invoice as proof of date of purchase.

This warranty is only applicable where the product is used for personal and non-commercial purposes.

This warranty does not cover damage or liability caused by / due to misuse, abuse, accidental or intentional acts by user, improper handling, unreasonable use, negligence, failure by end user to follow operating procedures outlined in the user's manual, attempted repair by non-qualified professional, unauthorized repair, modification, or use of accessories and/or attachments not specifically recommended by authorized party.

This warranty does not cover belts, brushes, bags, bulbs or any part which ordinary wear and tear results in required replacement during warranty period. Unless specifically provided under applicable law, this warranty does not cover transportation cost or consumable items such as fuses.

This limited warranty is void if the product's original identification (trade mark, serial number, etc.) markings have been defaced, altered or removed or if product is not purchased from an authorized reseller or if product is sold as is and / or **WITH ALL FAULTS.**

Subject to all applicable local regulations, the provisions of this limited warranty are in lieu of any other written warranty, whether express or implied, written or oral, including any warranty of MERCHANTABILITY OR FITNESS FOR A PARTICULAR PURPOSE. IN NO EVENT SHALL WE BE LIABLE FOR SPECIAL, INCIDENTAL, CONSEQUENTIAL OR INCIDENTAL DAMAGES. OUR MAXIMUM LIABILITY SHALL NOT EXCEED THE ACTUAL PURCHASE PRICE PAID BY YOU FOR THE PRODUCT.

This warranty is valid only in the European Union, Australia and New Zealand. Outside these areas, please contact your authorized A-iPower dealer to determine if another warranty applies.

DISPOSAL



Separate collection. This product must not be disposed of with normal household waste. Should you find one day that your Greenworks tools product needs replacement, or if it is no further use to you, do not dispose of it with household waste. Make this product available for separate collection.



Separate collection of used products and packaging allows materials to be recycled and used again. Re-use of recycled materials helps prevent environmental pollution and reduces the demand for raw materials.

Batteries



Li-ion

At the end of their useful life, discard batteries with due care for our environment. The battery contains material which is hazardous to you and the environment. It must be removed and disposed of separately at a facility that accepts lithium-ion batteries.

DANGER

IF blade jams on any electrical cord or line. DO NOT TOUCH THE BLADE! IT CAN BECOME ELECTRICALLY LIVE AND VERY DANGEROUS.

Continue to hold the hedge trimmer by the insulated rear handle or lay it down and away from you in a safe manner. Disconnect the electrical service to the damaged line or cord before attempting to free the blade from the line or cord. Failure to follow this warning will result in serious personal injury or possible death.



WARNING

Clear the area to be cut before each use. Remove all objects such as cords, lights, wire, or string which can become entangled in the cutting blade and create a risk of serious personal injury.



WARNING

Avoid using solvents when cleaning plastic parts. Most plastics are tend to damage from various types of solvents and may be damaged by their use. Use a clean cloth to remove dirt, oil, grease, etc.

Whenservicinguse onlyidentical our replacement parts. Use of anyotherparts can create a hazard or cause product damage.

CAUTION

Do not at any time let brake fluids, gasoline, petroleum based products, penetrating oils, etc., come in contact with plastic parts. They contain chemicals that may damage, weaken, or destroy plastics.

MAINTENANCE AND REPAIR

BLADE MAINTENANCE HEDGE TRIMMER



WARNING

Battery units do not have to be plugged into an electrical outlet; therefore, they are always in operating condition. To prevent serious personal injury, always remove the battery and take extra precautions and care when performing maintenance, service or for changing the cutting blade.



WARNING

To prevent serious personal injury, remove the battery pack before servicing, cleaning, or removing material from the unit.

BLADE CARE

Lubricate the cutting blades after each use.

Periodically inspect the blades for damage and wear.

Always use the manufacturer's specified replacement blades.

TO LUBRICATE BLADE

Remove battery pack from hedge trimmer.

For easier operation and longer blade life, lubricate the hedge trimmer blade before and after each use.

Before lubricating, remove the battery pack and lay hedge trimmer on a flat surface. Apply light weight machine oil along the edge of the top blade.

Occasionally, you should oil your hedge trimmer during prolonged use. Before oiling, stop hedge trimmer, remove battery pack, then oil. You then can resume trimming. Do not oil while hedge trimmer is running.

SHARPENING BLADE

Allow the blades of the hedge trimmer to come to a stop in the position. This will allow clearance for the file between cutter teeth and guard teeth.

Remove battery pack from hedge trimmer.

Clamp blade assembly in a vice and file the exposed cutting surface of each blade tooth with an 203 mm(8 inch) smooth round file, 6.4 mm (1/4 inch) or 5.6mm (7/32 inch) diameter. Be sure to retain the original angle of tooth when filing.

Remove the hedge trimmer from the vice, replace battery pack and restart the hedge trimmer. Allow the lades of the hedge trimmer to come to a stop so that the unsharpened edges of the cutter blade teeth are exposed.

Remove battery pack from hedge trimmer and repeat the sharpening procedure as described above.

HEDGE TRIMMER LUBRICATION

All of the bearings in this tool are lubricated with a sufficient amount of high-grade lubricant for the life of the unit under normal operating procedures. Therefore, no further lubrication is required.



WARNING

Do not attempt to modify this unit or create or mount any accessory not specifically recommended in this manual for use with this hedge trimmer. Any such alteration or modification is misuse and could result in a hazardous condition leading to possible serious personal injury.



WARNING

Examine hedge trimmer frequently to assure all parts are unbroken and securely attached. Make sure all screws and fasteners are securely tightened to prevent the risk of serious personal injury.

CLEANING THE HEDGE TRIMMER



WARNING

To prevent serious personal injury, remove the battery pack before servicing, cleaning, or removing material from the unit.

Remove the battery pack.

Clean the unit using a damp cloth with a mild detergent.

Do not use any strong detergents on the plastic housing or the handle. They can be damaged by certain aromatic oils such as pine and lemon, and by solvents such as kerosene.

Moisture can cause a shock hazard. Wipe off any moisture with a soft dry cloth.

Use a small brush or the air discharge of a small vacuum cleaner brush to clean the air vents on the battery pack housing and motor housing.

Keep the air vents free of obstructions.

STORING THE HEDGE TRIMMER

Clean the hedge trimmer thoroughly before storing. Store the hedge trimmer in a dry, well-ventilated place that is inaccessible to children. Keep away from corrosive agents such as garden chemicals and de-icing salts.

Always place blade cover on cutting blades before storing.

Store and charge your batteries below in a cool area. Temperatures above or below normal room temperature will shorten battery pack life.

Never store batteries in a discharged condition. Wait for battery pack to cool and fully charge immediately.

Store the battery pack where the temperature is below 27°C, and away from moisture.

All batteries gradually lose their charge. The higher the temperature, the quicker they lose their charge. If you store your unit for long periods of time without using it, recharge the batteries every month or two. This practice will prolong battery pack life.