

Automotive Rear Light Reflector Plastic Injection Mold Design Case

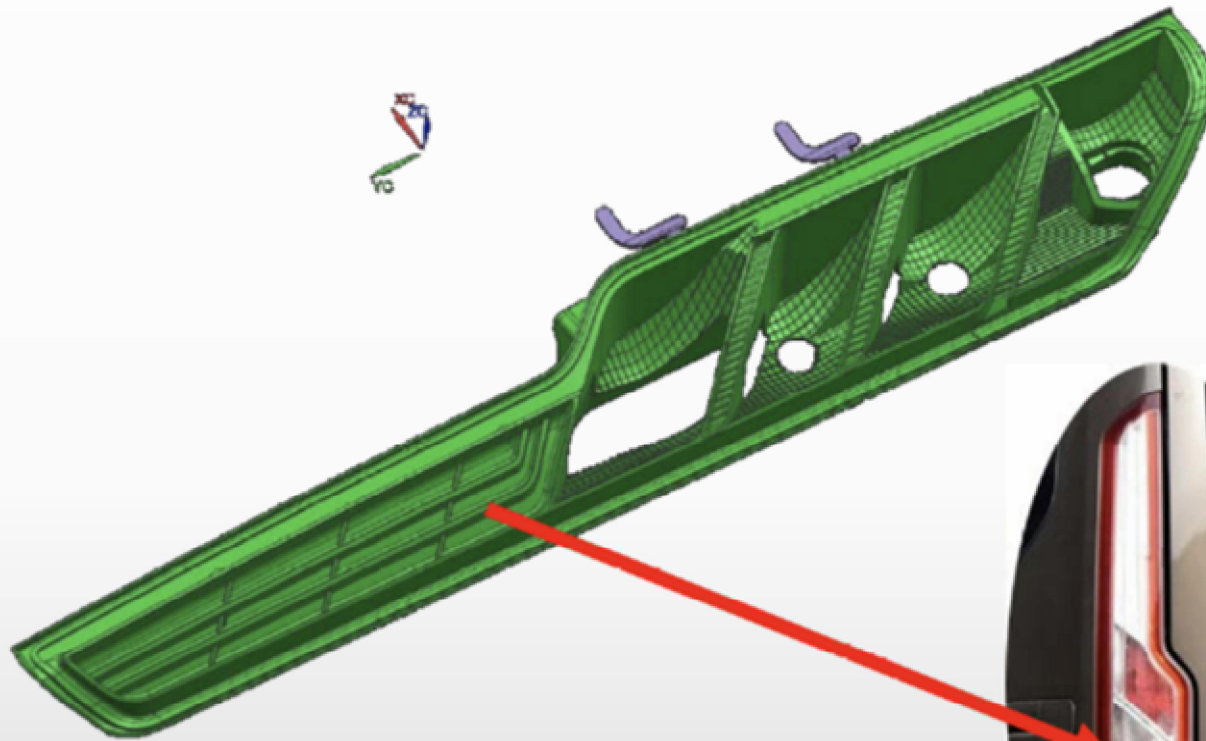

bessproduct.com
info@besstooling.com

Injection Mold Design Study Case



Automotive rear light reflector

This reflector is for the Ford automobile Of Tourneo car.



Injection Mold Design Study Case

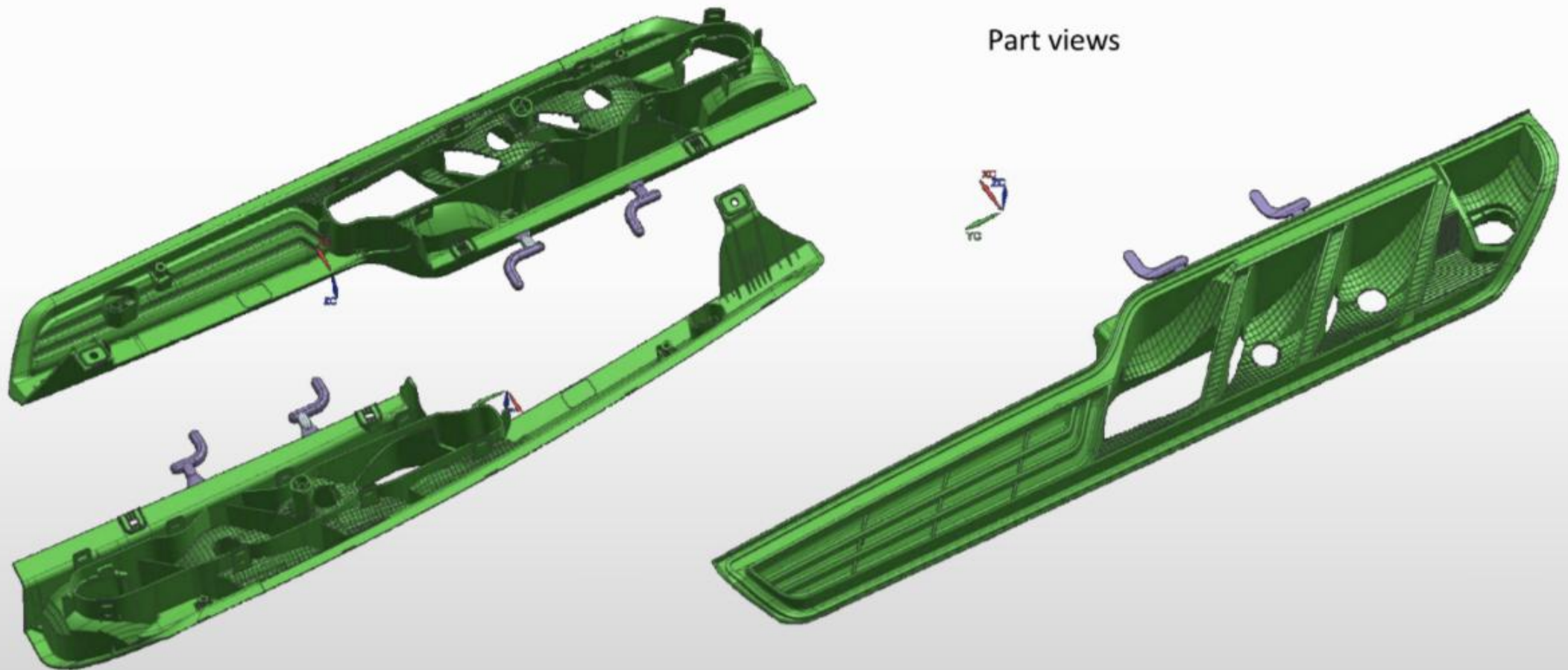

Injection Mold Design Study Case

Left hand & right hand reflector part view

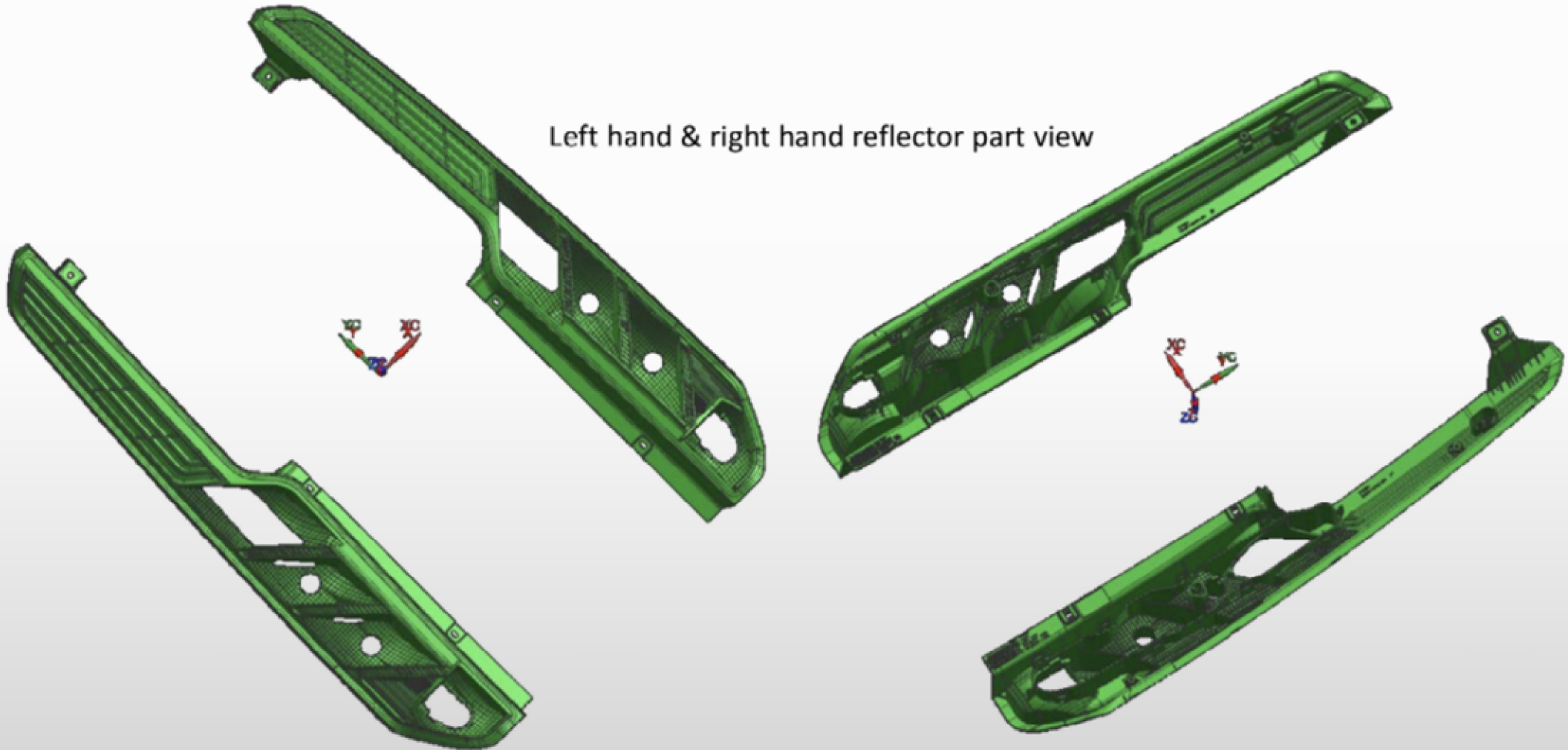

Injection Mold Design Study Case

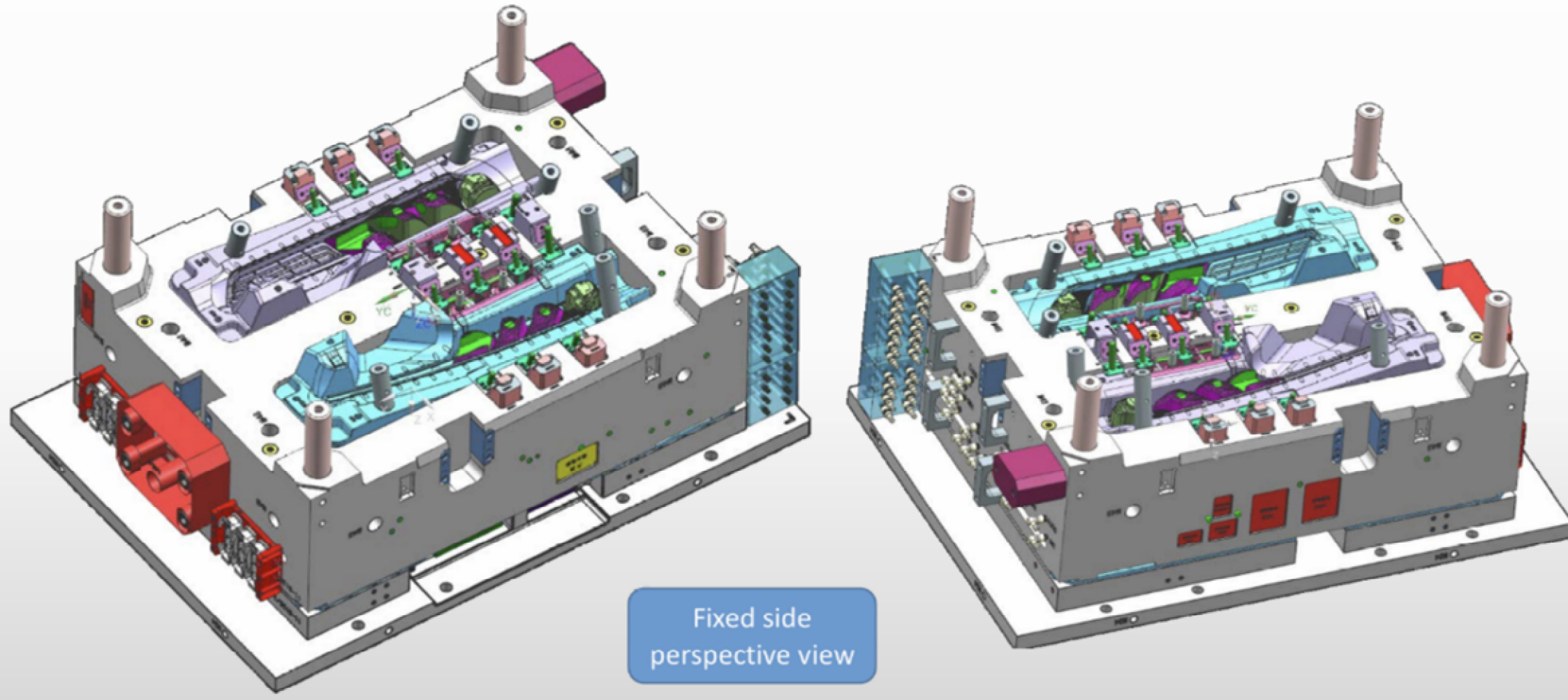

Injection Mold Design Study Case

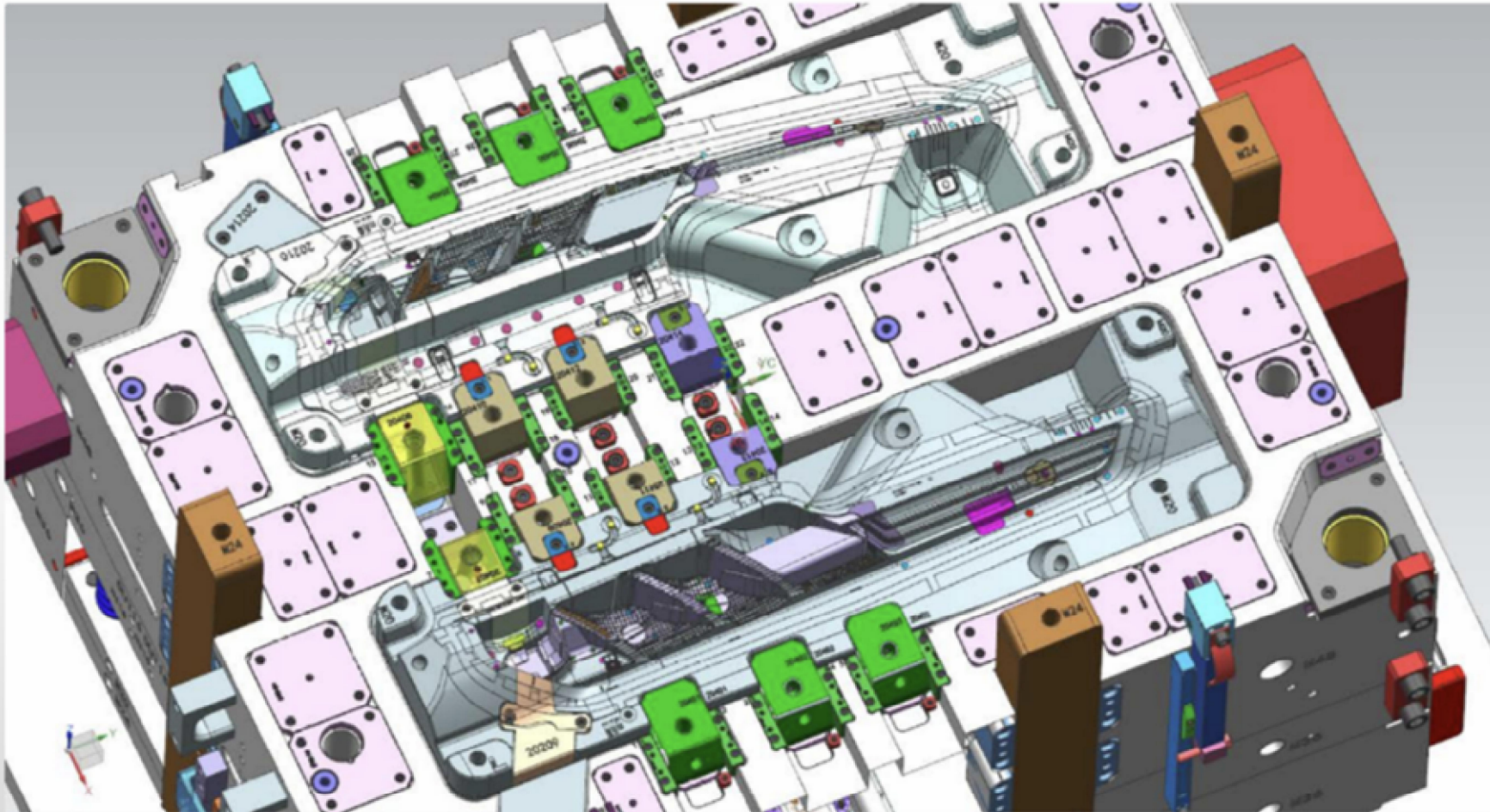

Cavity side view

Injection Mold Design Study Case

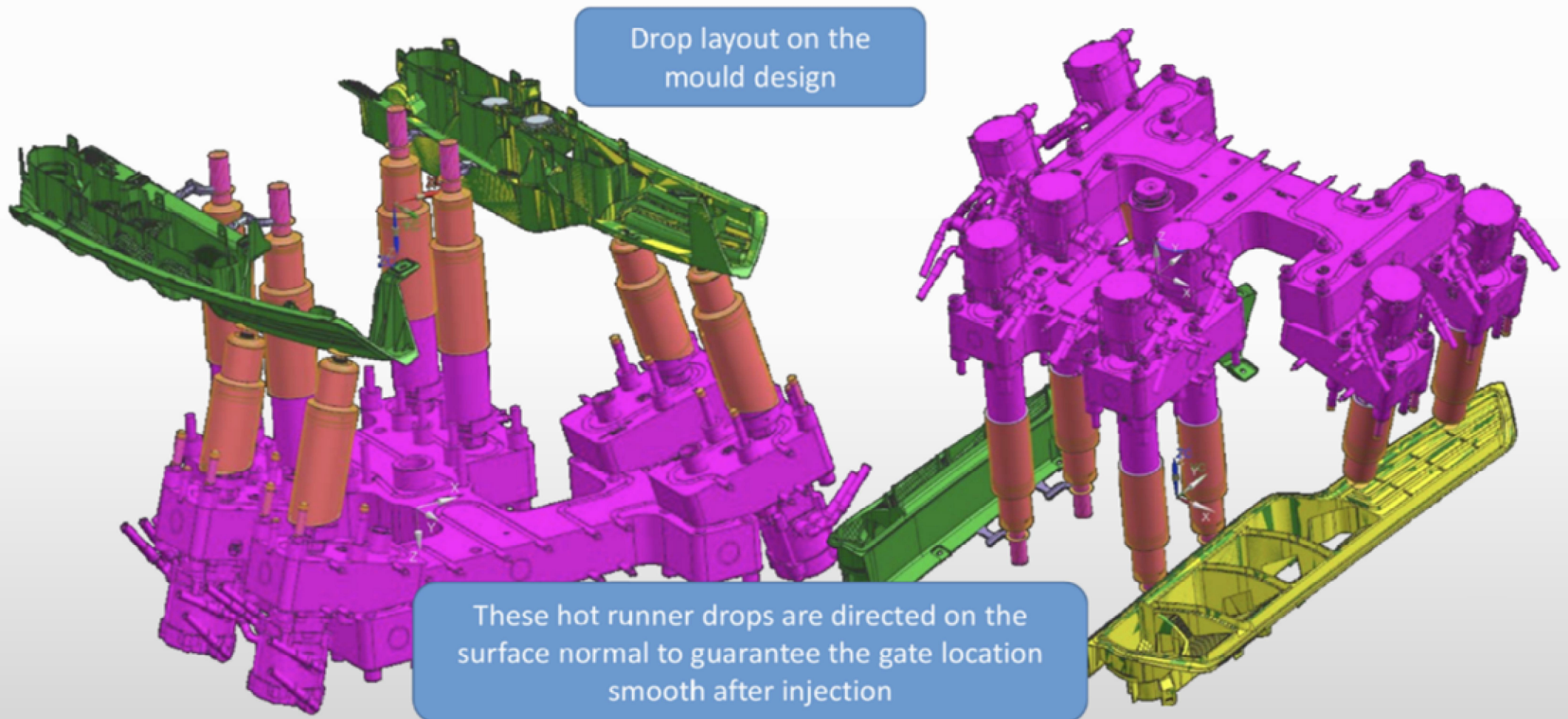

Injection Mold Design Study Case

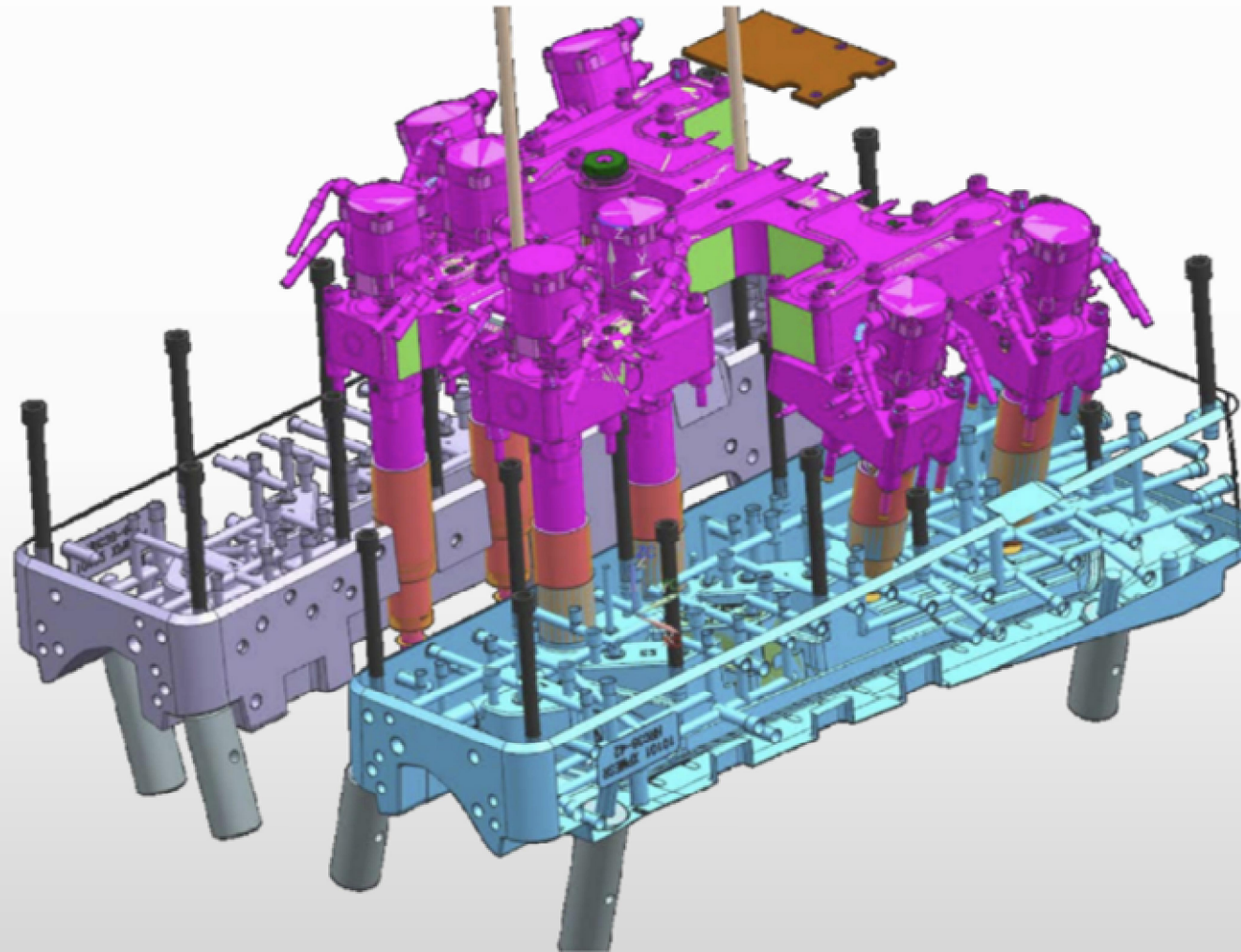

Hot runner
system on the
cavitation

Injection Mold Design Study Case

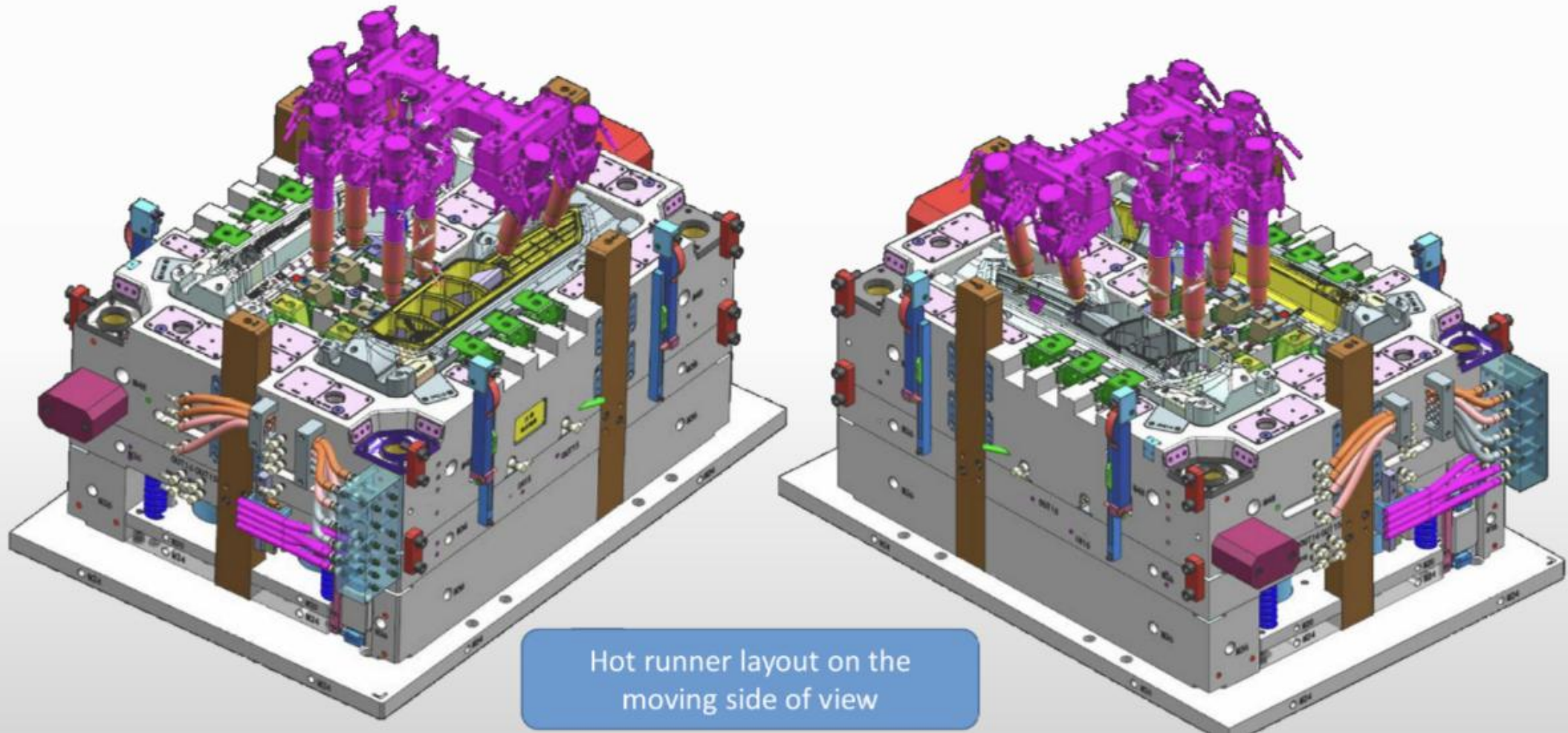

Injection Mold Design Study Case

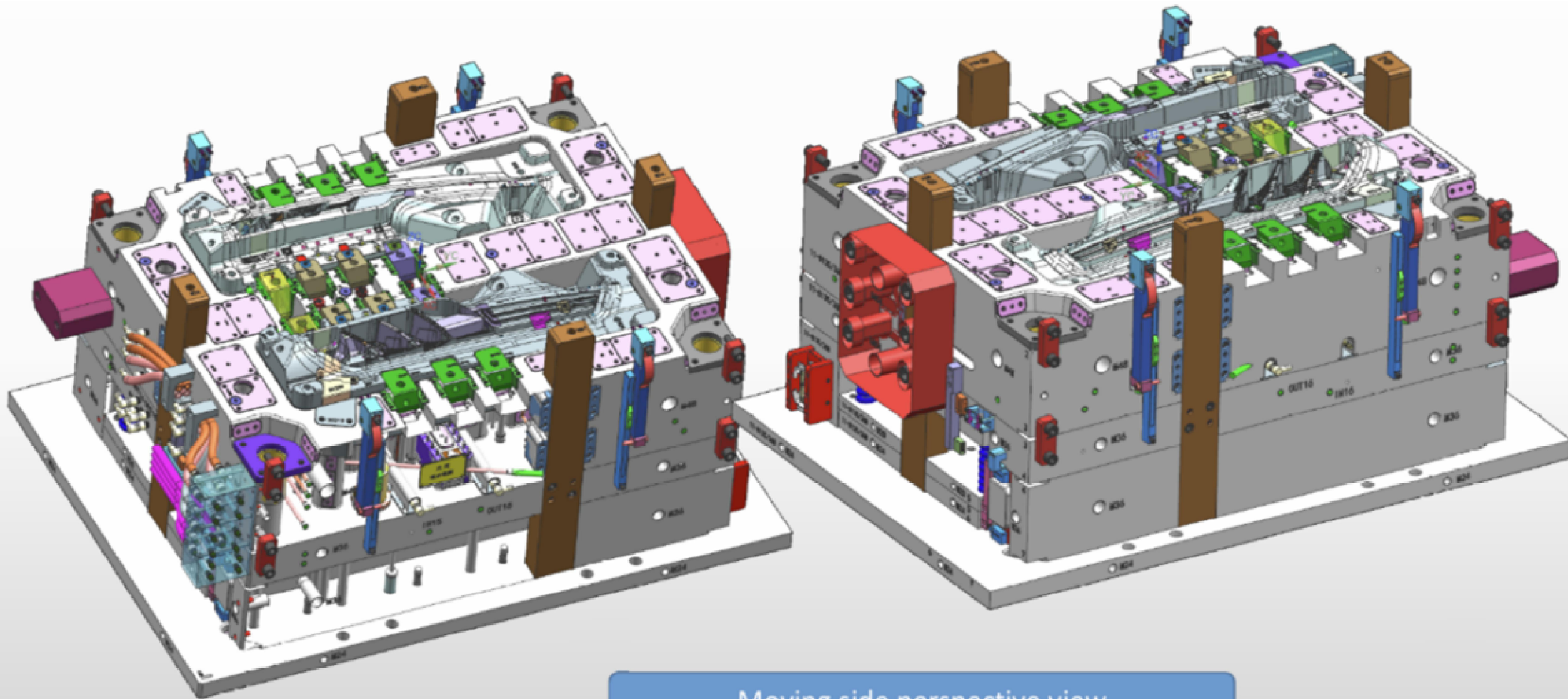

Moving side perspective view

Injection Mold Design Study Case

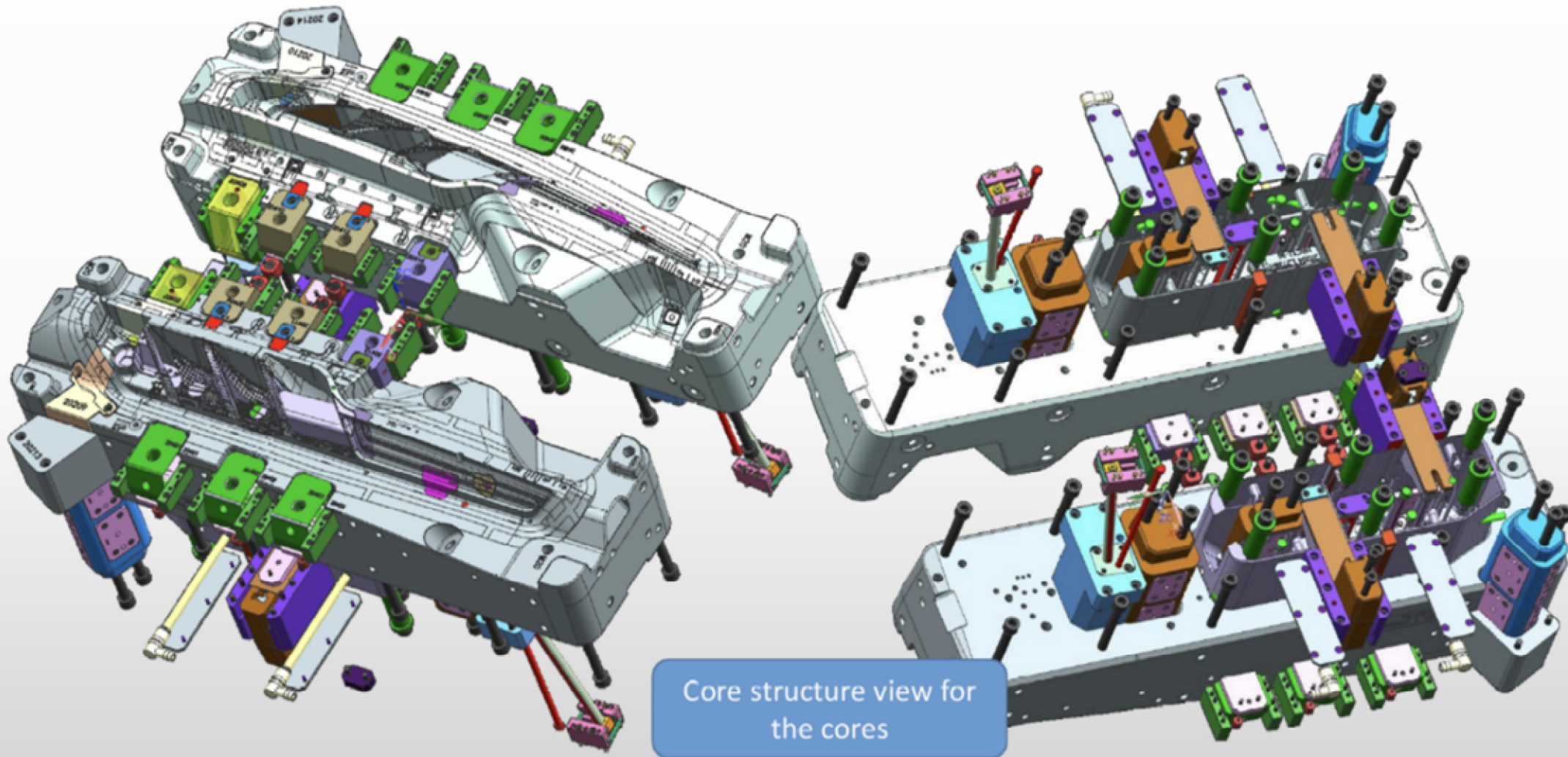

Injection Mold Design Study Case

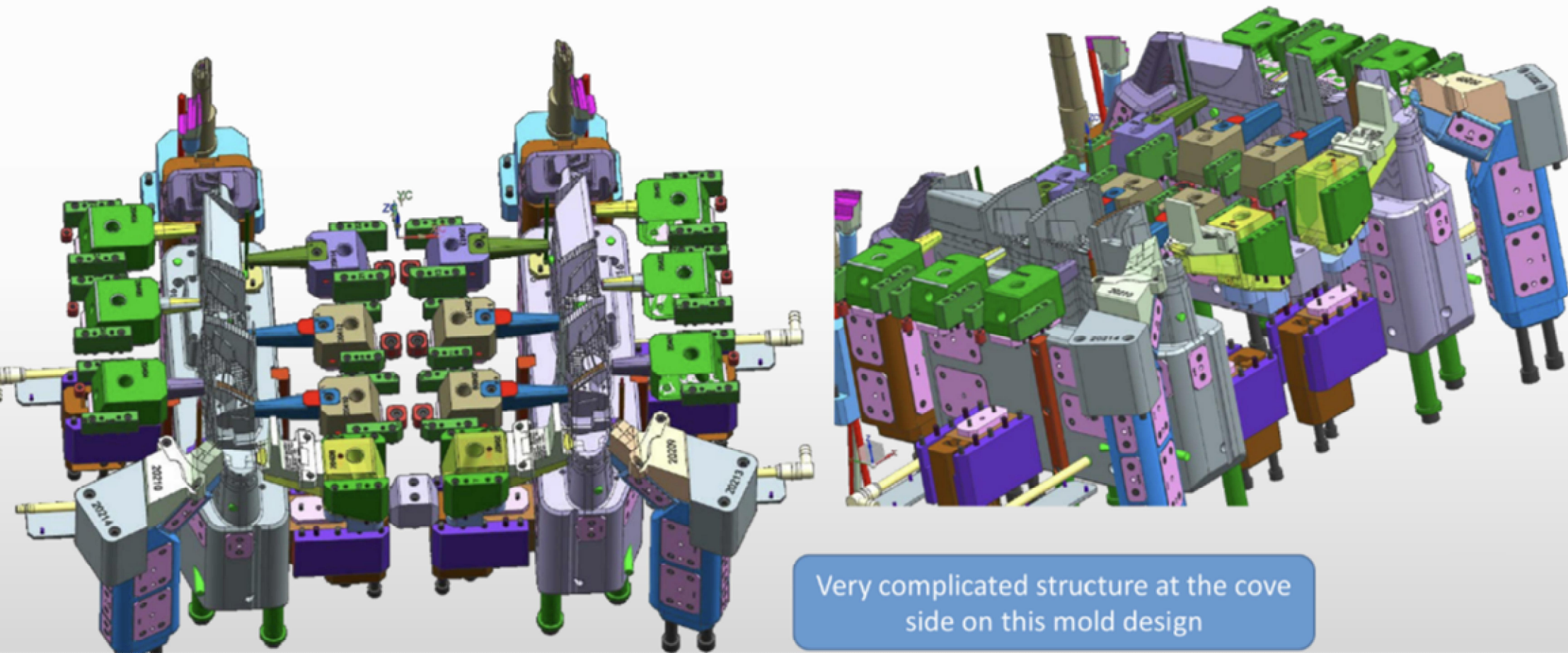

Injection Mold Design Study Case

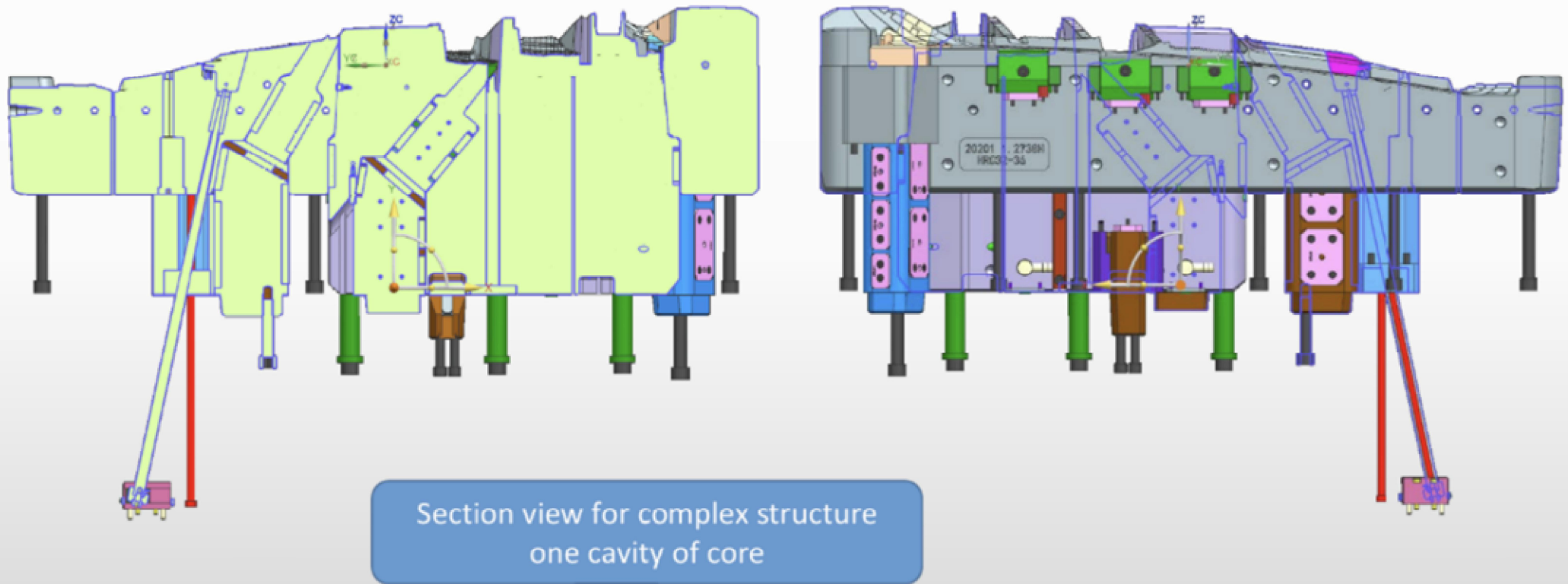

Injection Mold Design Study Case

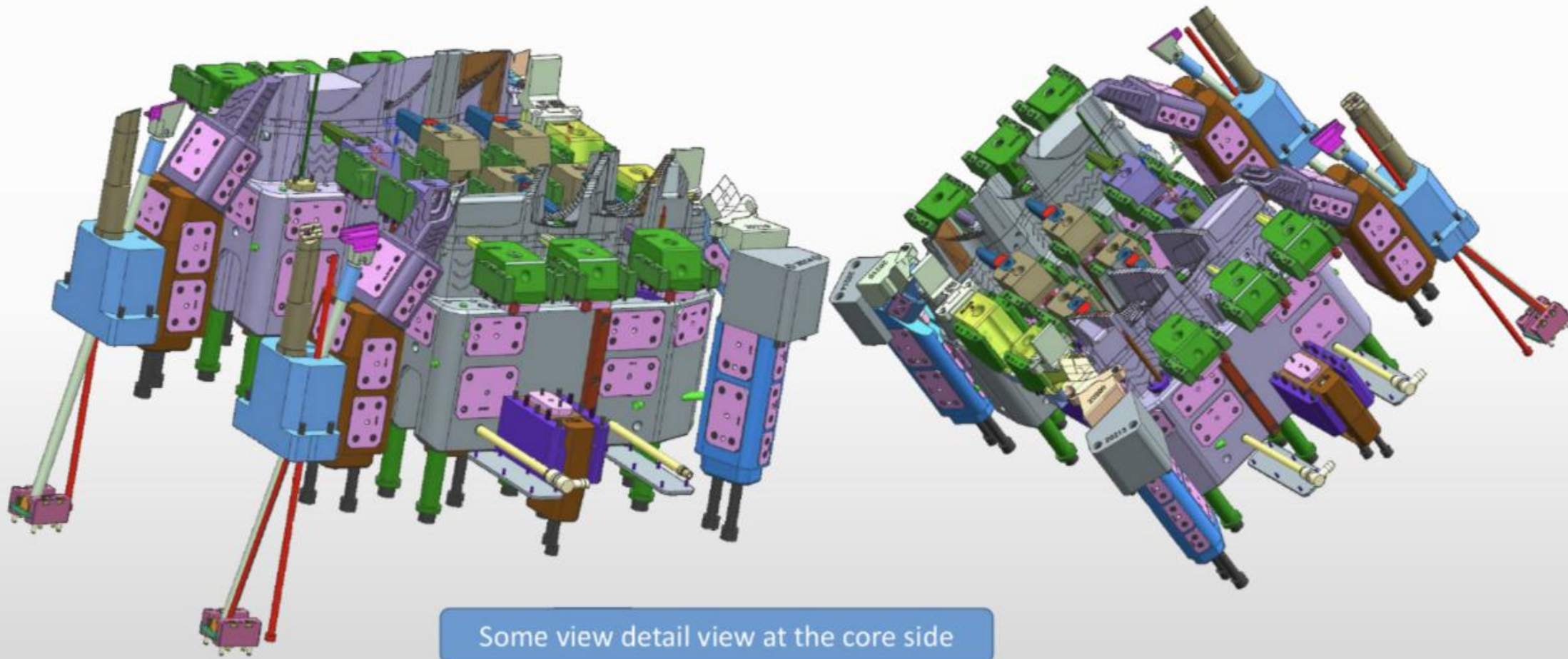

Injection Mold Design Study Case

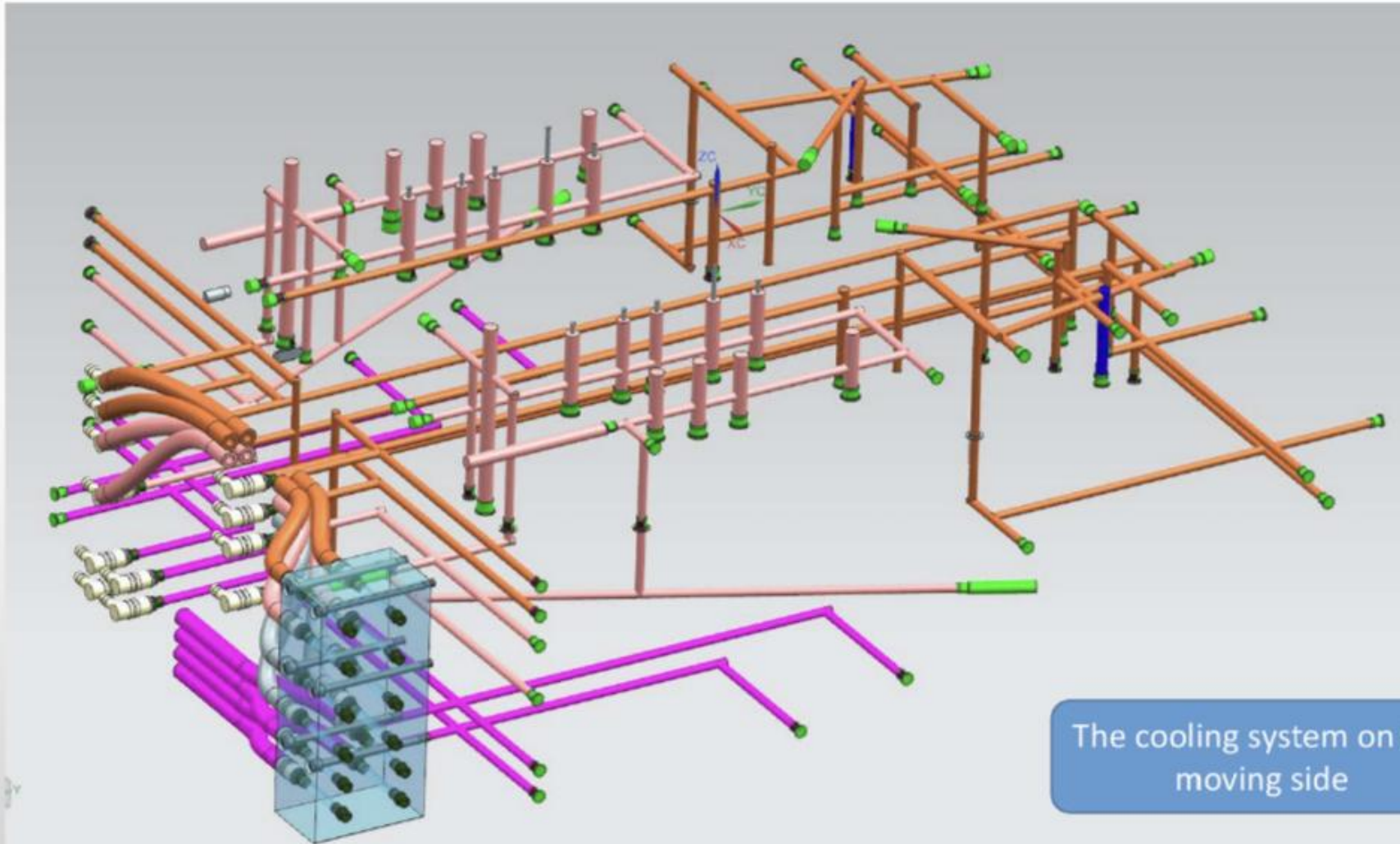

Thank you!

Thanks for attention

Please contact us via info@bestooling.com if you are interested about this complicated plastic injection mold design for the automobile rear light reflector of Ford.