

# VILLO

INDONESIA

Luxury Artisan Stone Bathware



CATALOGUE PRODUCT

VOLUME III



VILLO

# ABOUT US



At Villo, we create beautifully handcrafted bathware and more. By using natural materials, we bring elegance and comfort into every space. Our designs are unique and luxury with attention for detail, turning everyday routines into moments of relaxation.

For over five years, our skilled craftsman in Yogyakarta, have been crafting baths, basins, and accessories by hand, focusing on quality and precision. We carefully select reclaimed crushed marble and onyx, ensuring each piece is not only stunning but also durable and sustainable.

Whether you're looking for a statement bath or a perfectly matched set, our collection is designed to transform your space into a sanctuary of comfort and style. Explore our catalogue and get inspired!

A true local company with international designs & quality!



The background of the page is filled with several line drawings of different bathtub styles. At the top, there are partial views of two tubs. Below them, on the left, is a deep, oval-shaped tub. In the upper center is a rectangular tub with three horizontal bands. To its left is a shallow, wide, oval tub. On the right side is a deep, rectangular tub. Below the central rectangular tub is a shallow, wide, oval tub. At the bottom left is a deep, rectangular tub, and at the bottom right is a shallow, wide, oval tub. The word "BATHTUBS" is centered in the middle of the page.

# **BATHTUBS**



# SIENNA BATH

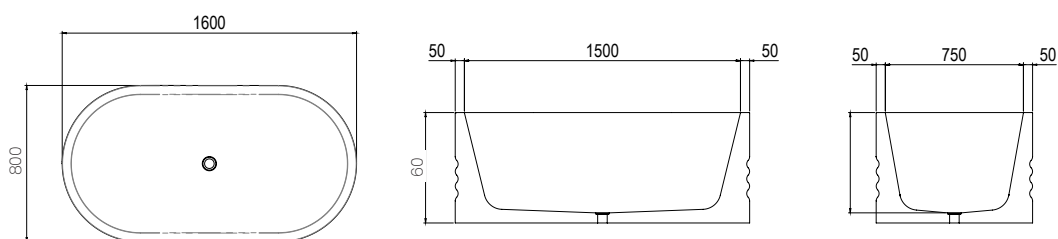

**MATERIALS** : COMPOSITE MINERAL STONE  
**SIZE** : 160 X 80 X 60 CM  
**WEIGHT** : 125 KG

\*overflow by request

\*due to the handmade nature and the high content of natural stone used in our products, colour and dimensional tolerances apply.





# VICTORIA BATH

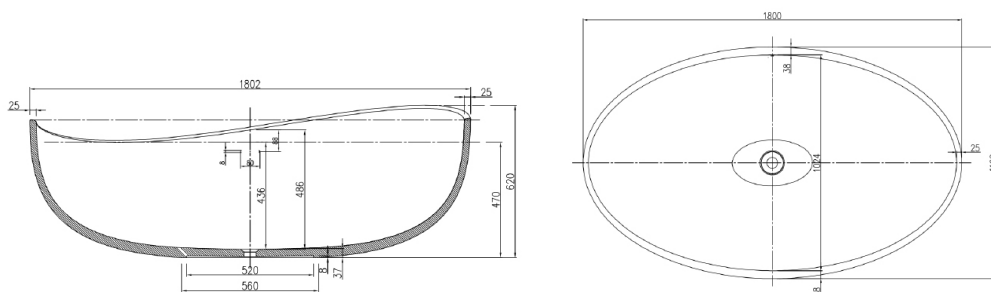

**MATERIALS** : COMPOSITE MINERAL STONE  
**SIZE** : 180 X 110 X 60 CM  
**WEIGHT** : 150 KG

\*overflow by request

\*due to the handmade nature and the high content of natural stone used in our products, colour and dimensional tolerances apply.



VILLO



# LONDON BATH

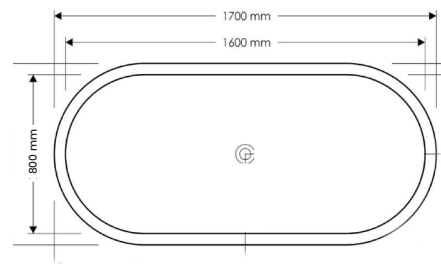
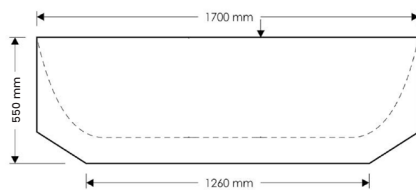

**MATERIALS** : COMPOSITE MINERAL STONE  
**SIZE** : 180 X 80 X 55 CM  
170 X 80 X 55 CM  
**WEIGHT** : 130 KG  
120 KG

\*overflow by request

\*due to the handmade nature and the high content of natural stone used in our products, colour and dimensional tolerances apply.





# BERLIN BATH

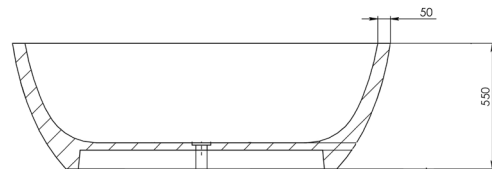
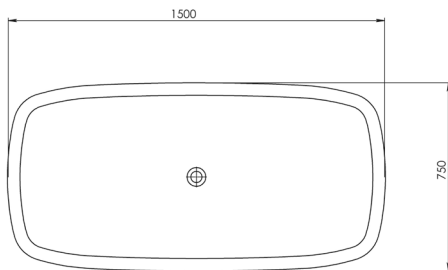

**MATERIALS** : COMPOSITE MINERAL STONE  
**SIZE** : 150 X 75 X 55 CM  
**WEIGHT** : 90 KG

\*overflow by request

\*due to the handmade nature and the high content of natural stone used in our products, colour and dimensional tolerances apply.





# SOFIA BATH

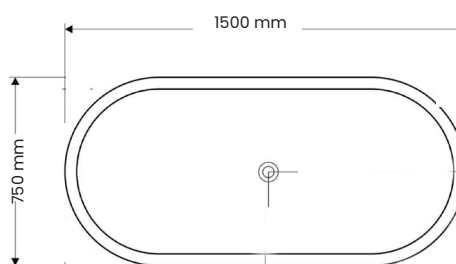
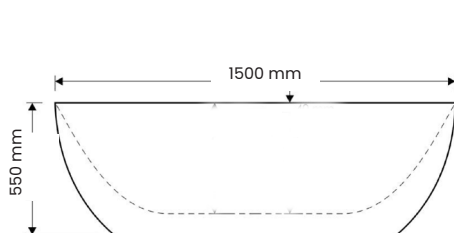

**MATERIALS** : COMPOSITE MINERAL STONE  
**SIZE** : 150 X 75 X 55 CM  
**WEIGHT** : 90 KG

\*overflow by request

\*due to the handmade nature and the high content of natural stone used in our products, colour and dimensional tolerances apply.



# VALENCIA BATH

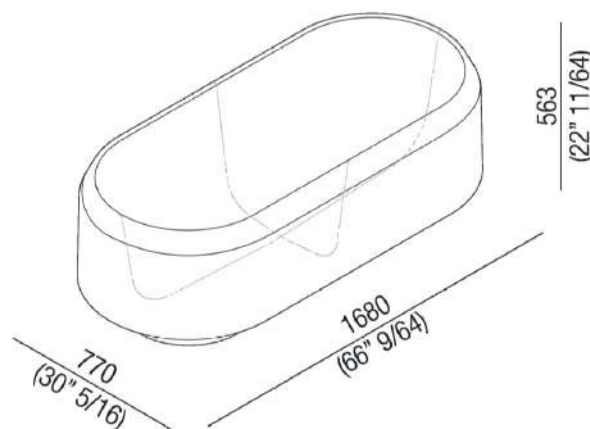

**MATERIALS** : COMPOSITE MINERAL STONE  
**SIZE** : 168 X 77 X 56 CM  
**WEIGHT** : 115 KG

\*overflow by request

\*due to the handmade nature and the high content of natural stone used in our products, colour and dimensional tolerances apply.





# AMSTERDAM BATH

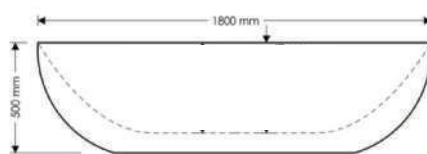
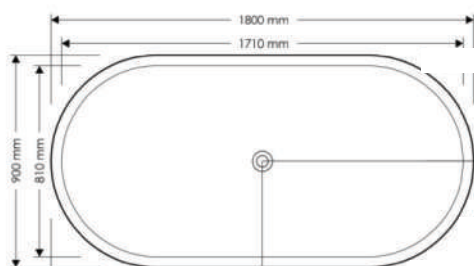

MATERIALS : COMPOSITE MINERAL STONE  
SIZE : 180 X 90 X 50 CM  
WEIGHT : 130 KG

\*overflow by request

\*due to the handmade nature and the high content of natural stone used in our products, colour and dimensional tolerances apply.







# IBIZA BATH

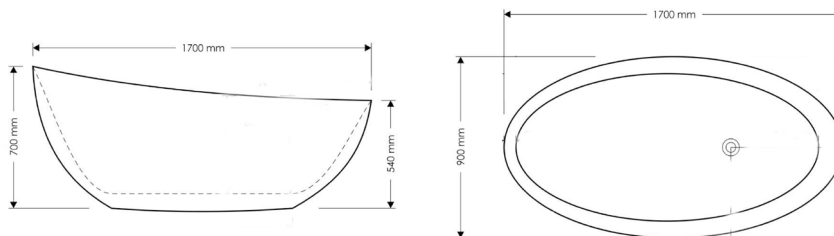

**MATERIALS** : COMPOSITE MINERAL STONE  
**SIZE** : 150 X 85 X 70 CM  
170 X 90 X 70 CM  
**WEIGHT** : 125 KG  
135 KG

\*overflow by request

\*due to the handmade nature and the high content of natural stone used in our products, colour and dimensional tolerances apply.



VILLO

# NEW ZEALAND BATH

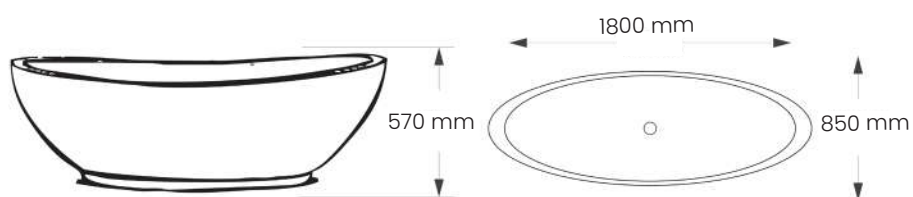

**MATERIALS** : COMPOSITE MINERAL STONE  
**SIZE** : 180 X 85 X 57 CM  
**WEIGHT** : 130 KG

\*overflow by request

\*due to the handmade nature and the high content of natural stone used in our products, colour and dimensional tolerances apply.







# BALINESE BATH



**MATERIALS** : COMPOSITE MINERAL STONE  
**SIZE** : 170 X 80 X 55 CM  
**WEIGHT** : 130 KG

\*overflow by request

\*due to the handmade nature and the high content of natural stone used in our products, colour and dimensional tolerances apply.







# SYDNEY BATH

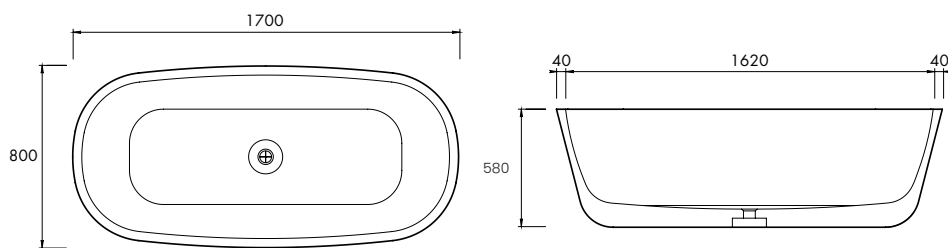

**MATERIALS** : COMPOSITE MINERAL STONE  
**SIZE** : 170 X 75 X 58 CM  
**WEIGHT** : 110 KG

\*overflow by request

\*due to the handmade nature and the high content of natural stone used in our products, colour and dimensional tolerances apply.







# ROMA BATH

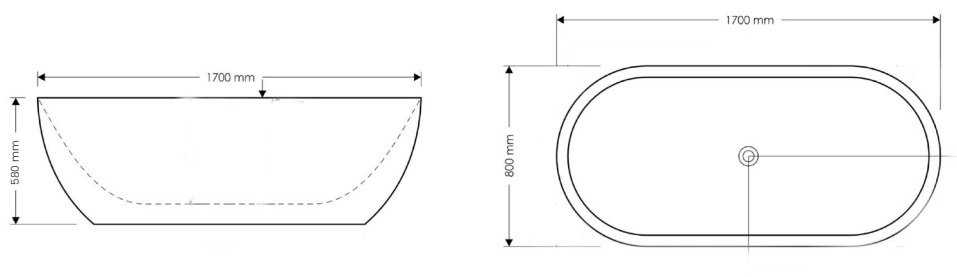

**MATERIALS** : COMPOSITE MINERAL STONE  
**SIZE** : 170 X 80 X 58 CM  
**WEIGHT** : 110 KG

\*overflow by request

\*due to the handmade nature and the high content of natural stone used in our products, colour and dimensional tolerances apply.



VILLO

# MEXICO BATH

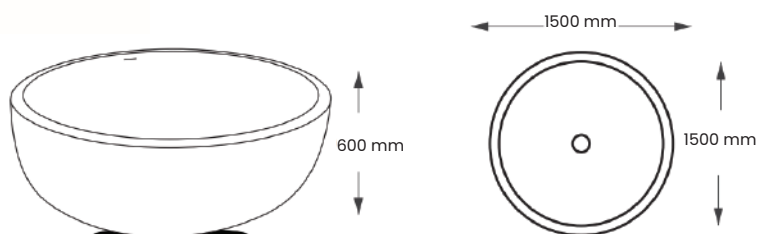

MATERIALS : COMPOSITE MINERAL STONE  
SIZE : 130 X 130 X 55 CM  
150 X 150 X 60 CM  
WEIGHT : 130 KG  
150 KG

\*overflow by request

\*due to the handmade nature and the high content of natural stone used in our products, colour and dimensional tolerances apply.



VILLO



# LONDON ROUND BATH

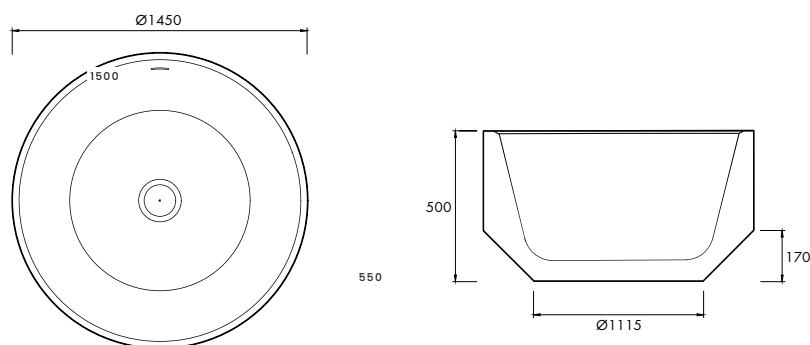

**MATERIALS** : COMPOSITE MINERAL STONE  
**SIZE** : 150 X 150 X 55 CM  
**WEIGHT** : 150 KG

\*overflow by request

\*due to the handmade nature and the high content of natural stone used in our products, colour and dimensional tolerances apply.

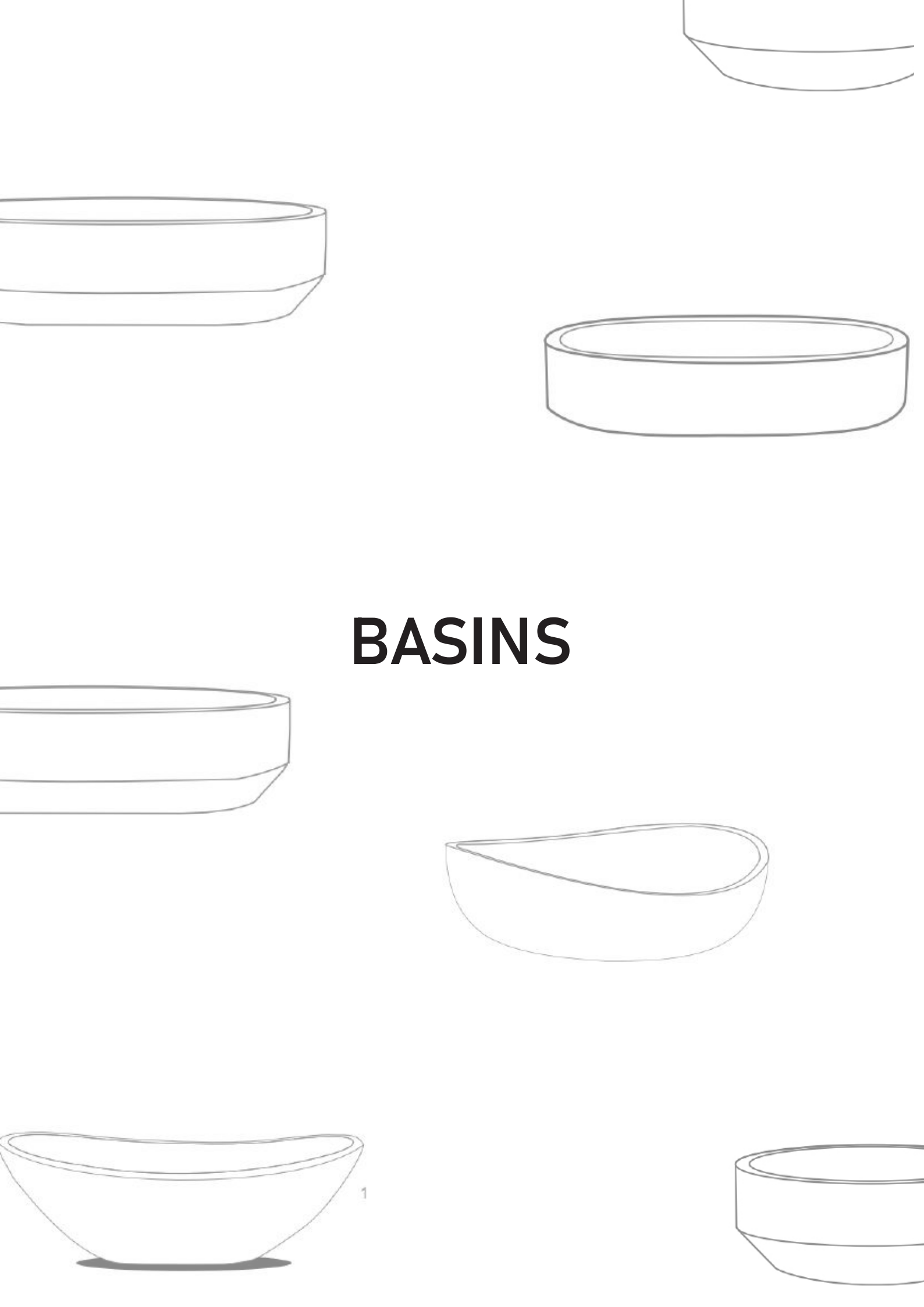

# BASINS

# VICTORIA BASIN



**MATERIALS** : COMPOSITE MINERAL STONE  
**SIZE** : 60 X 37 X 21 CM

\*due to the handmade nature and the high content of natural stone used in our products, colour and dimensional tolerances apply.



## ORPHUS BASIN



**MATERIALS** : COMPOSITE MINERAL STONE  
**SIZE** : 60 X 40 X 19 CM

## MATISE BASIN

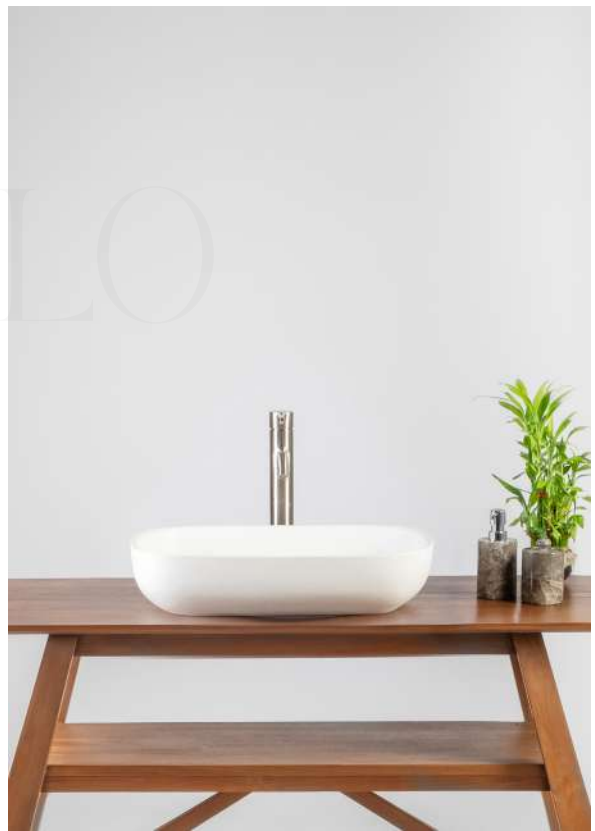

**MATERIALS** : COMPOSITE MINERAL STONE  
**SIZE** : 53 X 35 X 12 CM

\*due to the handmade nature and the high content of natural stone used in our products, colour and dimensional tolerances apply.

## SIENNA BASIN



**MATERIALS** : COMPOSITE MINERAL STONE  
**SIZE** : 43 X 43 X 14 CM

## CASSA BASIN



**MATERIALS** : COMPOSITE MINERAL STONE  
**SIZE** : 52 X 36 X 12 CM

\*due to the handmade nature and the high content of natural stone used in our products, colour and dimensional tolerances apply.



## MILANO WITHOUT LIST BASIN



**MATERIALS** : COMPOSITE MINERAL STONE  
**SIZE** : 59 X 39 X 12 CM  
45 X 30 X 12 CM

## MILANO LIST BASIN



**MATERIALS** : COMPOSITE MINERAL STONE  
**SIZE** : 59 X 39 X 12 CM

\*due to the handmade nature and the high content of natural stone used in our products, colour and dimensional tolerances apply.

## LONDON OVAL BASIN



**MATERIALS** : COMPOSITE MINERAL STONE  
**SIZE** : 45 X 29 X 14 CM  
57 X 36,5 X 14 CM

## LONDON ROUND BASIN

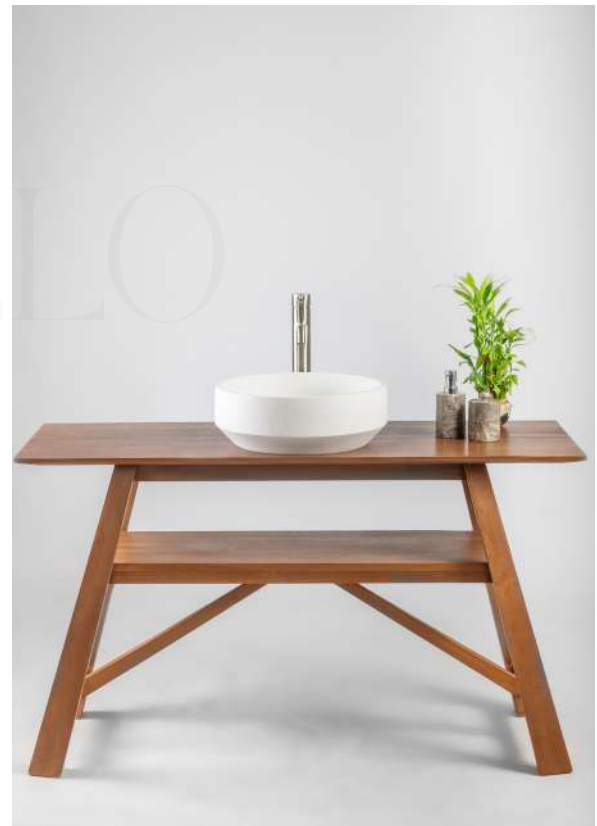

**MATERIALS** : COMPOSITE MINERAL STONE  
**SIZE** : 40 X 40 X 14 CM

\*due to the handmade nature and the high content of natural stone used in our products, colour and dimensional tolerances apply.



## MEXICO BASIN



**MATERIALS** : COMPOSITE MINERAL STONE  
**SIZE** : 40 X 40 X 15 CM  
40 X 40 X 12 CM

## KAMBOJA BASIN

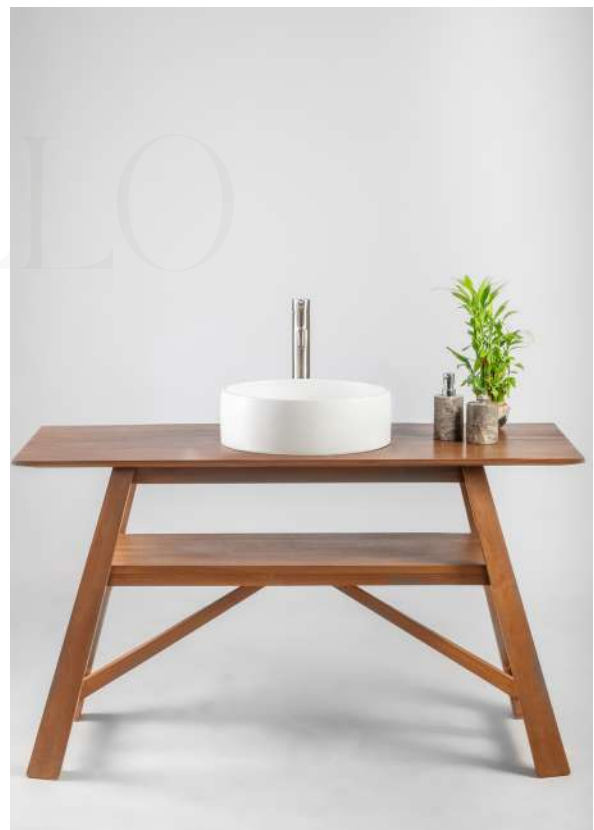

**MATERIALS** : COMPOSITE MINERAL STONE  
**SIZE** : 38 X 38 X 12 CM

\*due to the handmade nature and the high content of natural stone used in our proudcts, colour and dimensional tolerances apply.

## THAI BASIN



**MATERIALS** : COMPOSITE MINERAL STONE  
**SIZE** : 56 X 35 X 15 CM

## ORLANDO BASIN



**MATERIALS** : COMPOSITE MINERAL STONE  
**SIZE** : 50 X 35 X 12 CM  
60 X 40 X 14 CM

\*due to the handmade nature and the high content of natural stone used in our products, colour and dimensional tolerances apply.



## VALENCIA BASIN



**MATERIALS** : COMPOSITE MINERAL STONE  
**SIZE** : 65 X 46,5 X 14 CM

## VIETNAM BASIN



**MATERIALS** : COMPOSITE MINERAL STONE  
**SIZE** : 40 X 40 X 15 CM

\*due to the handmade nature and the high content of natural stone used in our products, colour and dimensional tolerances apply.

# STANDING SIENNA



**MATERIALS** : COMPOSITE MINERAL STONE

**SIZE** : 43 X 43 X 90 CM

\*due to the handmade nature and the high content of natural stone used in our products, colour and dimensional tolerances apply.



# STANDING CASABLANCA



**MATERIALS** : COMPOSITE MINERAL STONE  
**SIZE** : 40 X 40 X 90 CM

\*due to the handmade nature and the high content of natural stone used in our products, colour and dimensional tolerances apply.

# ACCESSORIES

We have a wide range of existing products, but if you're looking for something unique, tell us your needs, and we will create the perfect accessories to complement your bathware.



## STOOL JAPAN

**MATERIALS** : COMPOSITE MINERAL STONE  
**SIZE** : 36 X 36 X 45 CM

\*due to the handmade nature and the high content of natural stone used in our products, colour and dimensional tolerances apply.



# COLOR OPTIONS

Here is our selection of colours. Looking for something unique? At Villo, we can create a custom colour just for you.



TERRACOTA



JADE  
SMOKE



TAUPE



CREAM  
ONYX



BLACK  
ONYX



BLACK  
NATURAL



GREY  
ONYX



LIGHT  
GREY



WHITE  
NATURAL



WHITE  
ONYX



# CONTACT US

**Whatsapp** : WA 1 +6281226261214 - Dika Hendrawati (Export/B2B/Projects)  
WA 2 +6285290516165 - Fatiah Safitri (Local/Retails/Villa)

**Email** : villoindonesia@gmail.com  
marketingvilloindonesia@gmail.com

**Instagram** : @bathtubvillo @villoindonesia

**Webstie** : villoindonesia.com

**Address** : Jl. Sepiangin Selatan, Grujugan, Tamanan, Kec. Banguntapan,  
Kabupaten Bantul, Daerah Istimewa Yogyakarta 55191









@VILLOINDONESIA