



HDBO-36

Gas Range

Features

- Key components have CSA / ETL certificate.
- 6" adjustable stainless steel legs and back shelf can be removed when packing to reduce transportation cost.
- Equipped with regulator.
- Gas convert kit to exchange the gas type.
- Heavy-duty cast iron lift-off grates for easy cleaning.
- Adjustable thermostat from 250°F-550°F.

Size(W*D*H): 908.8X829.7X1532.9mm
 Size(W*D*H): 35.78"X32.67"X60.35"
 N.W. : 170kg G.W. : 204kg
 Gas consumption(m³/h):
 NG: 5.524 / LPG: 2.379

Quantity of Burners: 6
 Quantity of Controls: 7
 Quantity of Racks: 2
 Burner Power(BTU): 30,000X6
 Oven Power(BTU): 30,000X1
 Total Power(BTU): 210,000

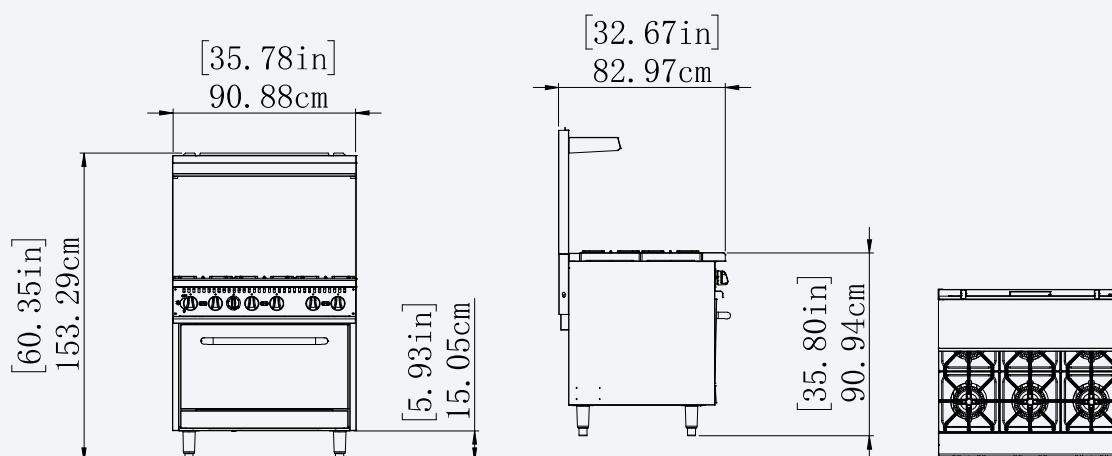

* All above parameters for reference only, take practicality as standard.