

SOULfERYO

SAHL HASHEESH

SOULfERYO
DEVELOPMENTS

TIMELESS
EXPERIENCE



FOR THE
PREMIUM
FEW

SIGNATURE VILLA
E-CATALOGUE 2025

ELEGANCE OF DESIGN MEETS THE
TRANQUILLITY OF NATURE,
INVITING OWNERS AND VISITORS
TO ENJOY AN UNMATCHED
LIFESTYLE IN ONE OF THE MOST
BEAUTIFUL LOCATIONS IN THE
WORLD.

SOULFERYO

ADDRESS:

CG9 Old Town Sahl Hasheesh,
Hurghada, Red Sea, Egypt.

HOTLINE:

17362

DIRECT:

ENGLISH: +2 010 300 200 26

GERMAN: +2 010 300 200 51

RUSSIAN: +2 010 300 200 21

WEBSITE:

www.buildixrealestate.com

EMAIL:

info@buildixrealestate.com

SOULFERYO

PARTNERS OF SUCCESS

SOULFERYO
DEVELOPMENTS

SOULFERYO
DEVELOPER

RG
ROMA GROUP

SOULFERYO
OWNER

AZURE
PLANNING & ARCHITECTURE

PLANNING
& ARCHITECTURE

BUILDIX[®]
PROJECT MANAGEMENT

PROJECT
MANAGEMENT

BUILDIX[®]
ARCHITECTURE & INTERIOR DESIGN

ARCHITECTURE
& INTERIOR DESIGN

BUILDIX[®]
BRANDING & MARKETING

BRANDING
& MARKETING

BUILDIX[®]
REAL ESTATE INVESTMENT

REAL ESTATE
INVESTMENT

SOULFORYO
SAHL HASHEESH



TIMELESS EXPERIENCE

Enjoy Our Virtual Reality Tour



SOULferryYO

SAHL HASHEESH

THE STORY

SOUL – **FER** – **YO**

SOUL

The circle signifies many sacred and spiritual concepts and it's how light forms. It represents the soul, unity, infinity, wholeness, the universe, divinity, balance, stability and perfection, among others.

FERRY

A ferry dream may reflect your current state of mind and your readiness to face new experiences.

YOU

The sea represents yourself with its calm presence and sense of space. Soulferyo is gifted with a place to reflect on the past, and to dream and hope about the future.

FOR THE PREMIUM FEW

E – CATALOGUE

2025

01

SOULFERYO DEVELOPMENTS

Established in 1980, Soulferyo Developments prides itself in creating a new standard in resort and residential living through its outstanding record of accomplishments. With an in-house construction and design office that includes an expert team of engineers, Soulferyo Developments' holistic approach of building new communities embraces all practices from vision to design, construction, finishing and operation, which has allowed Soulferyo to continually deliver the highest standards to its clients. We have amassed a large client-base who believe in our expertise and in the strong investments made with a property purchase from Soulferyo Developments. This trust continues to fuel our drive to grow even further and successfully deliver on schedule several projects in Cairo and the Red Sea. With more projects currently being developed.



MESSAGE FROM THE CHAIRMAN

We strive to build sustainable communities integrating architectural designs with state-of-the-art landscape. We promise our clients the perfect balance between privacy and social life, as we design and build a unique lifestyle. For more than 4 decades we, at Soulferyo were able to build a strong bond with our distinguished clients based on trust and perfection. Soulferyo team members are dedicated to fulfil the needs of our clients and to introduce the latest technology while sustaining a convenient environment for our residents to live.

FOR THE PREMIUM FEW

E – CATALOGUE

2025

02



25
minutes

to Hurghada
Downtown

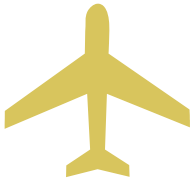

20
minutes

to Hurghada
Airport



15
minutes

to Senzo Mall



5
minutes

to Old Town
Sahl Hasheesh

FOR THE PREMIUM FEW

SAHL HASHEESH

SOULFEROVO
DEVELOPMENTS

TIMELESS
EXPERIENCE

 FOR THE
PREMIUM
FEW

TIMELESS EXPERIENCE

SOULFORYO

SAHL HASHEESH

ELEGANCE OF DESIGN MEETS THE TRANQUILLITY
OF NATURE, INVITING OWNERS AND VISITORS TO
ENJOY AN UNMATCHED LIFESTYLE IN ONE OF THE
MOST BEAUTIFUL LOCATIONS IN THE WORLD.

SOULFORYO
DEVELOPMENTS



FOR THE
PREMIUM
FEW



SOULFEROYO

PROJECT POSITIONING

THIS RESORT POSITIONS ITSELF AS A LUXURY REAL ESTATE DEVELOPMENT WITH DEEP EMPHASIS ON NATURAL BEAUTY, AND UPSCALE LIVING, WITH UNMATCHED COMFORT FOR THE FEW.

FOR THE PREMIUM FEW

E – CATALOGUE

2025

06



SOULFERYO

SOULFERYO RESORT

SOULFERYO TESTAMENT

THE SIGNATURE VILLAS AT SOULFERYO EMBODY ARCHITECTURAL INNOVATION AND REFINED MINIMALISTIC ELEGANCE ACROSS 45 DISTINCTIVE TOWNHOUSES. THIS DEVELOPMENT REDEFINES MODERN HOSPITALITY WITH THOUGHTFUL SPATIAL PLANNING AND CUTTING-EDGE CRAFTSMANSHIP..

TIMELESS ARCHITECTURE
AND MODERN ELEGANCE

FOR THE PREMIUM FEW

E – CATALOGUE

2025

07

SOULFERYO



TIMELESS EXPERIENCE

SOULFEROYO



UPSCALE

COMFORT

LUXURY

BEAUTY

LIVING

TIMELESS EXPERIENCE

FOR THE PREMIUM FEW

E - CATALOGUE

2025

09

PROJECT OVERVIEW

LAND AREA

53,000m²

SPACIOUS

TOTAL UNITS

250 Units

LIMITED

COMMERCIAL

1,500m²

MALL

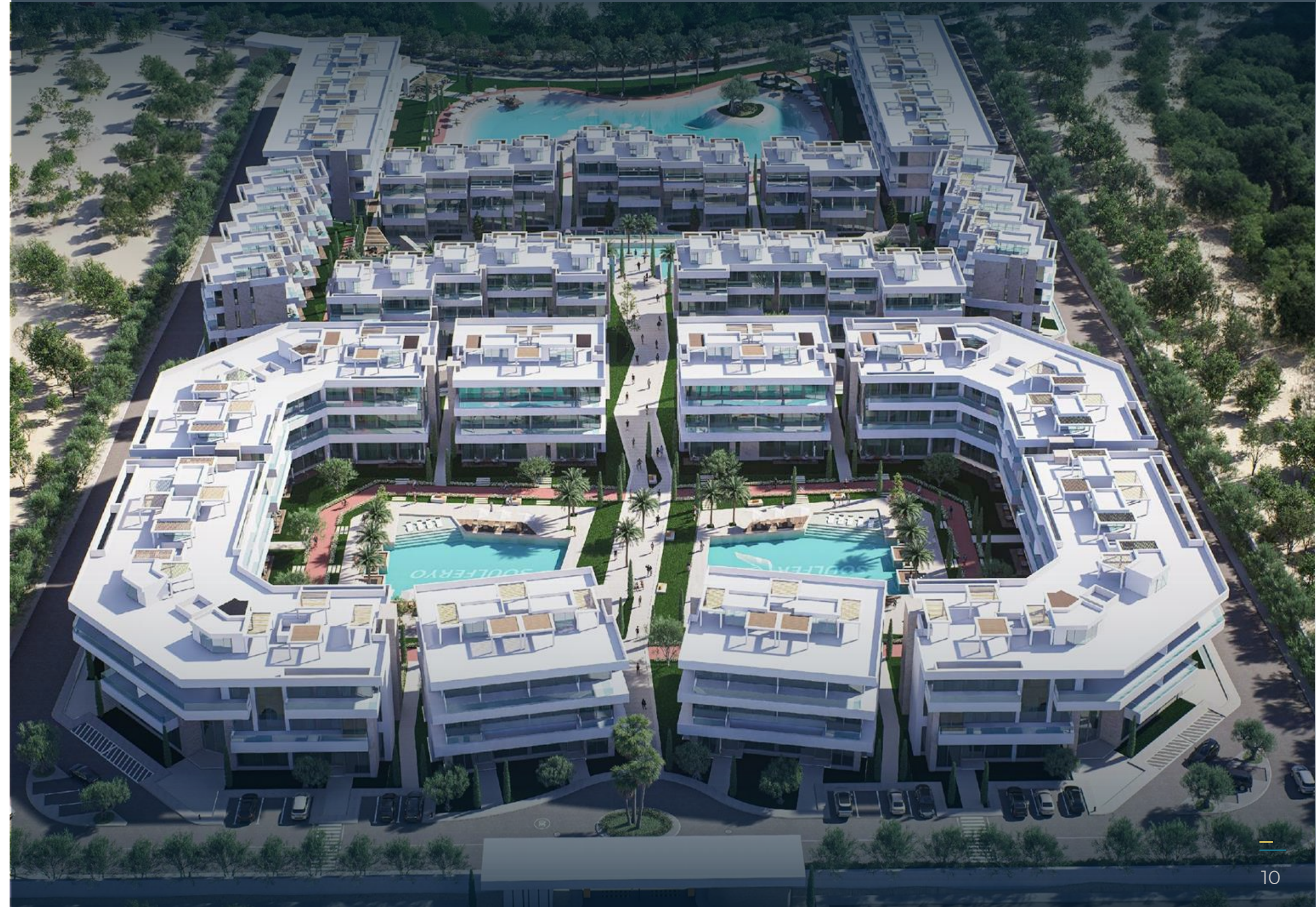



34m²
ABOVE
SEA
LEVEL

ELEVATION

The site is 34 meters above sea level, providing unique sea and lush golf course views, contributing to the luxurious feel.

FOOTPRINT

20% of the area is reserved for construction, with a focus on minimizing the environmental footprint.

LANDSCAPE

80% of the land will be lush green and fascinating landscapes, enhancing the aesthetic and offering an eco-friendly stunning resort-like atmosphere.

FOR THE PREMIUM FEW



SOULFERYO

TYPES

DUPLEXES & FLATS

TOWNHOUSES

BOUTIQUE
VILLAS

FOR THE PREMIUM FEW

E – CATALOGUE

2025

TYPES

COLOR CODES

DUPLEXES

TOWNHOUSES

BOUTIQUE VILLAS

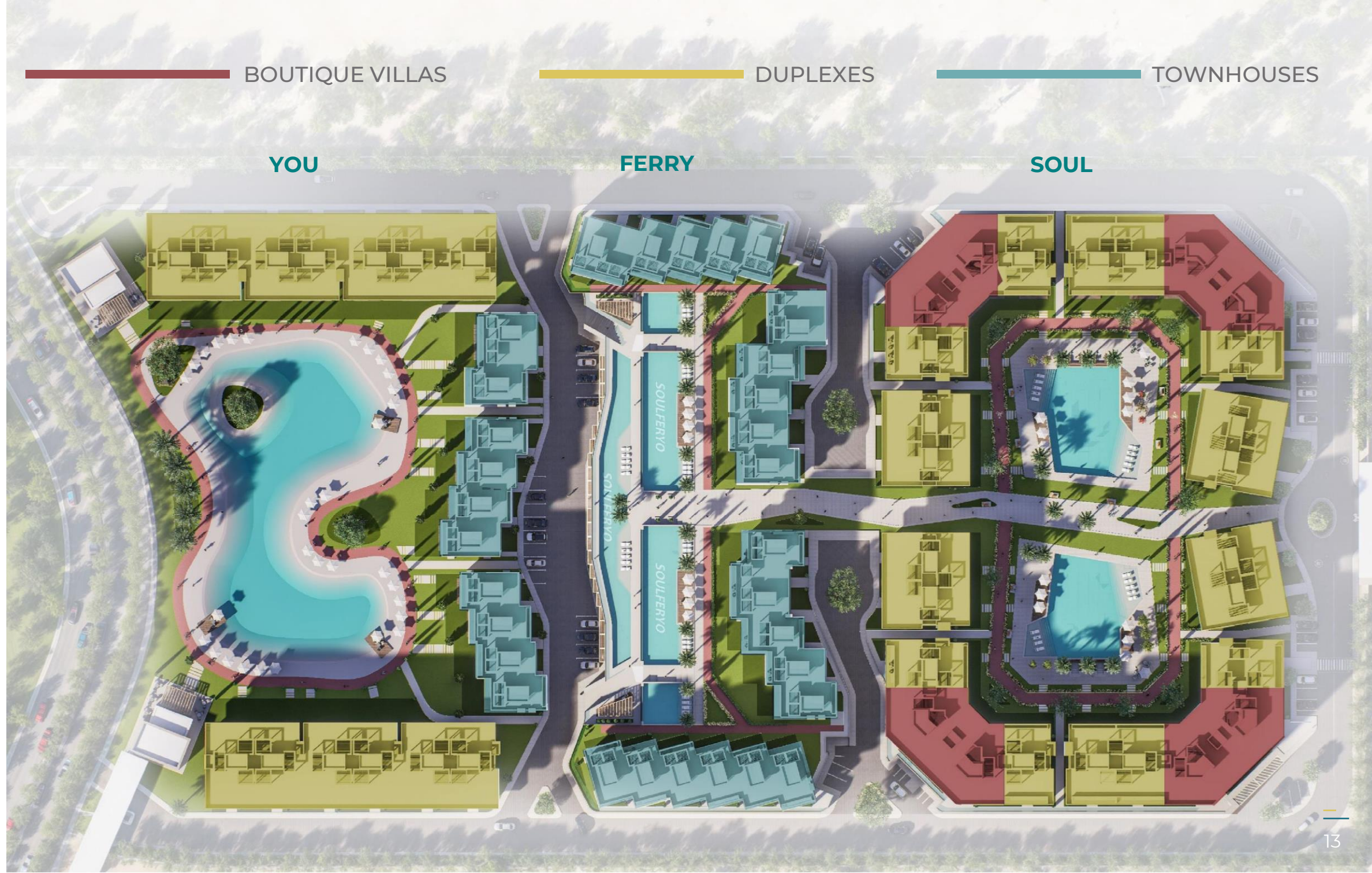



Soulferyo

EXPERIENCE THE LUXURY

Step into a world of elegance and exclusivity at Soulferyo Resort, where residents and guests are invited to indulge in a lifestyle like no other; nestled in one of the most breath-taking and sought-after locations.

Soulferyo offers an extraordinary blend of luxury, naturalistic beauty, and tranquillity, creating the ultimate sanctuary for those who seek the exceptional.

FOR THE PREMIUM FEW

E – CATALOGUE

2025

14

SAHL HASHEESH

SOULferyo

SAHL HASHEESH

SOULferyo
DEVELOPMENTS

TIMELESS
EXPERIENCE



FOR THE
PREMIUM
FEW

PHASE
DELIVERY

NUMBER PHASE 2

NAME FERRY

DELIVERY 4
YEARS

These phases ensure a structured rollout and allow for flexible investment options at different stages.

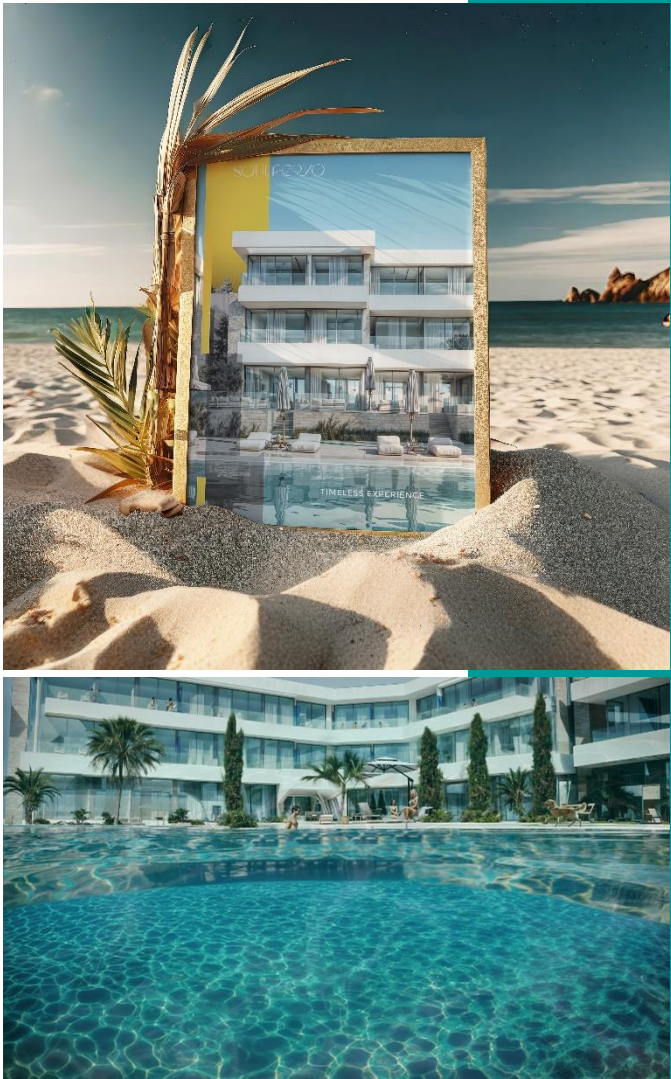



PHASE 2
FERRY

CONCEPT: With stunning views of the Red Sea, this phase likely embodies luxury and freedom, offering upscale living spaces with direct access to the sea. It may focus on high-end amenities such as private beaches, water sports, privacy, & exclusive services.

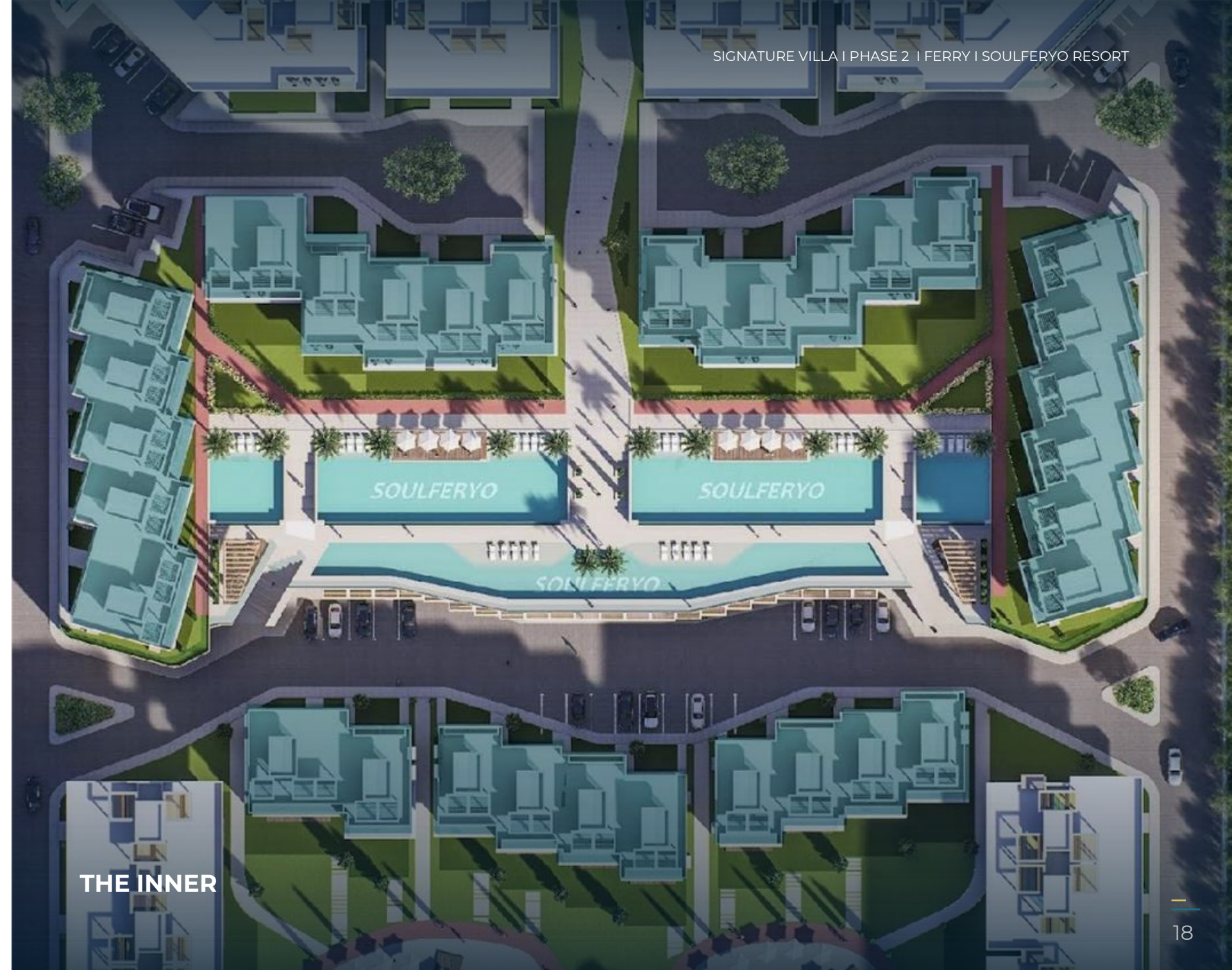

SIGNATURE VILLA | PHASE 2 | FERRY | SOULFERYO RESORT

THE INNER

PHASE 2
FERRY

AUDIENCE: Individuals or families who seek a combination of relaxation and activity, enjoying the balance between nature and community life.



THE INNER



A FUSION OF TIMELESS ARCHITECTURE AND MODERN ELEGANCE

SOULFERYO stands as a testament to architectural innovation and interior design sophistication. This exclusive development combines the elegance of traditional craftsmanship with cutting-edge modernism, offering a living experience that is both timeless and forward-thinking.

FOR THE PREMIUM FEW

E – CATALOGUE

2025

20

SOULFERYO

SIGNATURE VILLA | PHASE 2 | FERRY | SOULFERYO RESORT





SOULFERYO



BACK

SIGNATURE VILLA | PHASE 2 | FERRY | SOULFERYO RESORT



FRONT







SOULFERYO

PHASE 2 | FERRY | SOULFERYO RESORT



SOULFERYO

PHASE 2 | FERRY | SOULFERYO RESORT





TIMELESS EXPERIENCE

[CLICK HERE](#)

360°
TOUR

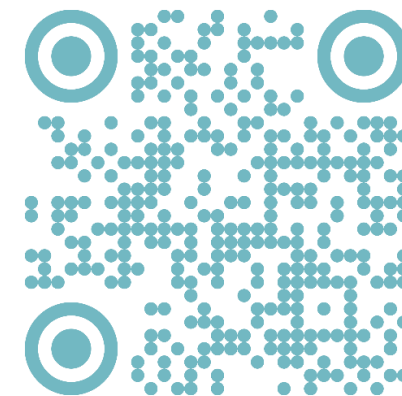

SCAN
QR

VR
EXPERIENCE

ELEGANCE OF DESIGN MEETS THE TRANQUILITY
OF NATURE, INVITING OWNERS AND VISITORS TO
ENJOY AN UNMATCHED LIFESTYLE IN ONE OF THE
MOST BEAUTIFUL LOCATIONS IN THE WORLD.

SOULFEROYO
SAHL HASHEESH

FOR THE PREMIUM FEW

E – CATALOGUE

2025

30

TIMELESS EXPERIENCE

360°
TOUR

CLICK HERE

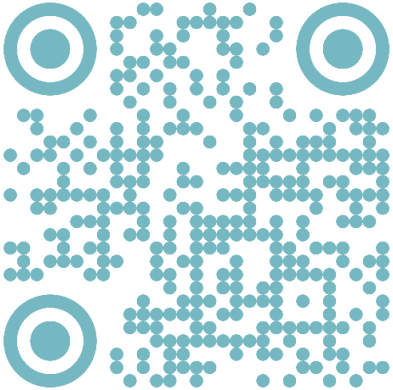

SCAN
QR

VR
EXPERIENCE

ELEGANCE OF DESIGN MEETS THE TRANQUILLITY OF NATURE, INVITING OWNERS AND VISITORS TO ENJOY AN UNMATCHED LIFESTYLE IN ONE OF THE MOST BEAUTIFUL LOCATIONS IN THE WORLD.



LESS-IS-MORE

Soulferyo embodies a modern minimalist approach, where elegance meets simplicity. The spaces are thoughtfully crafted to highlight clean lines, open layouts, and a neutral palette, allowing the natural beauty of the surrounding environment to shine through.

Each Signature Villa is designed with high-quality materials and carefully selected furnishing designs, blending functionality with timeless style.

Soulferyo elevates the townhouse living experience to new heights of elegance.

SIGNATURE VILLA

LIVING ROOM

SECTIONS CODES:

{TH1 : TH45}

SIGNATURE VILLA | PHASE 2 | FERRY | INTERIOR | SOULFERYO RESORT



SIGNATURE
VILLA

LIVING
ROOM

SECTIONS CODES:
{TH1 : TH45}

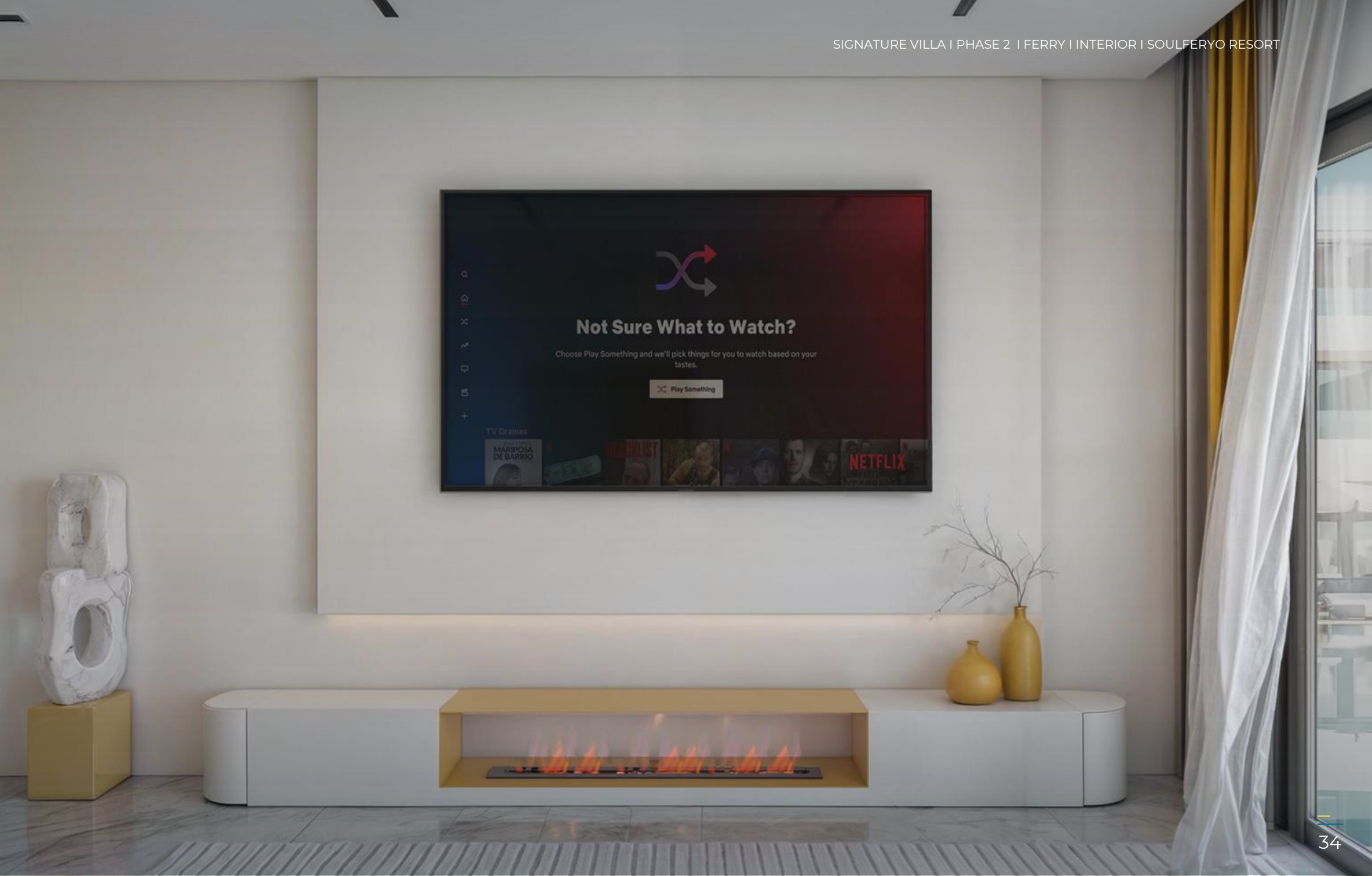

SIGNATURE
VILLA

DINING
AREA

SECTIONS CODES:
{TH1 : TH45}



SIGNATURE
VILLA

DINING
AREA

SECTIONS CODES:
{TH1 : TH45}



SIGNATURE VILLA

DINING AREA

SECTIONS CODES:

{TH1 : TH45}



SIGNATURE
VILLA

LIVING
ROOM

SECTIONS CODES:
{TH1 : TH45}



SIGNATURE
VILLA

LIVING
ROOM

SECTIONS CODES:
{TH1 : TH45}



SIGNATURE
VILLA

UNIT
BEDROOM

SECTIONS CODES:
{TH1 : TH45}



SIGNATURE
VILLA

UNIT
BEDROOM

SECTIONS CODES:
{TH1 : TH45}



SIGNATURE
VILLA

UNIT
BEDROOM

SECTIONS CODES:
{TH1 : TH45}



SIGNATURE
VILLA

UNIT
BEDROOM

SECTIONS CODES:
{TH1 : TH45}



SIGNATURE
VILLA

UNIT
BEDROOM

SECTIONS CODES:
{TH1 : TH45}



SIGNATURE
VILLA

UNIT
BEDROOM

SECTIONS CODES:
{TH1 : TH45}



TIMELESS EXPERIENCE

[CLICK HERE](#)

360°
TOUR

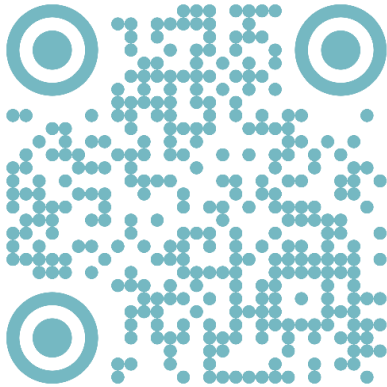

SCAN
QR

VR
EXPERIENCE

ELEGANCE OF DESIGN MEETS THE TRANQUILLITY OF NATURE, INVITING OWNERS AND VISITORS TO ENJOY AN UNMATCHED LIFESTYLE IN ONE OF THE MOST BEAUTIFUL LOCATIONS IN THE WORLD.

SIGNATURE
VILLA

UNIT
ROOF

SECTIONS CODES:
{TH1 : TH45}



SIGNATURE
VILLA

UNIT
ROOF

SECTIONS CODES:
{TH1 : TH45}

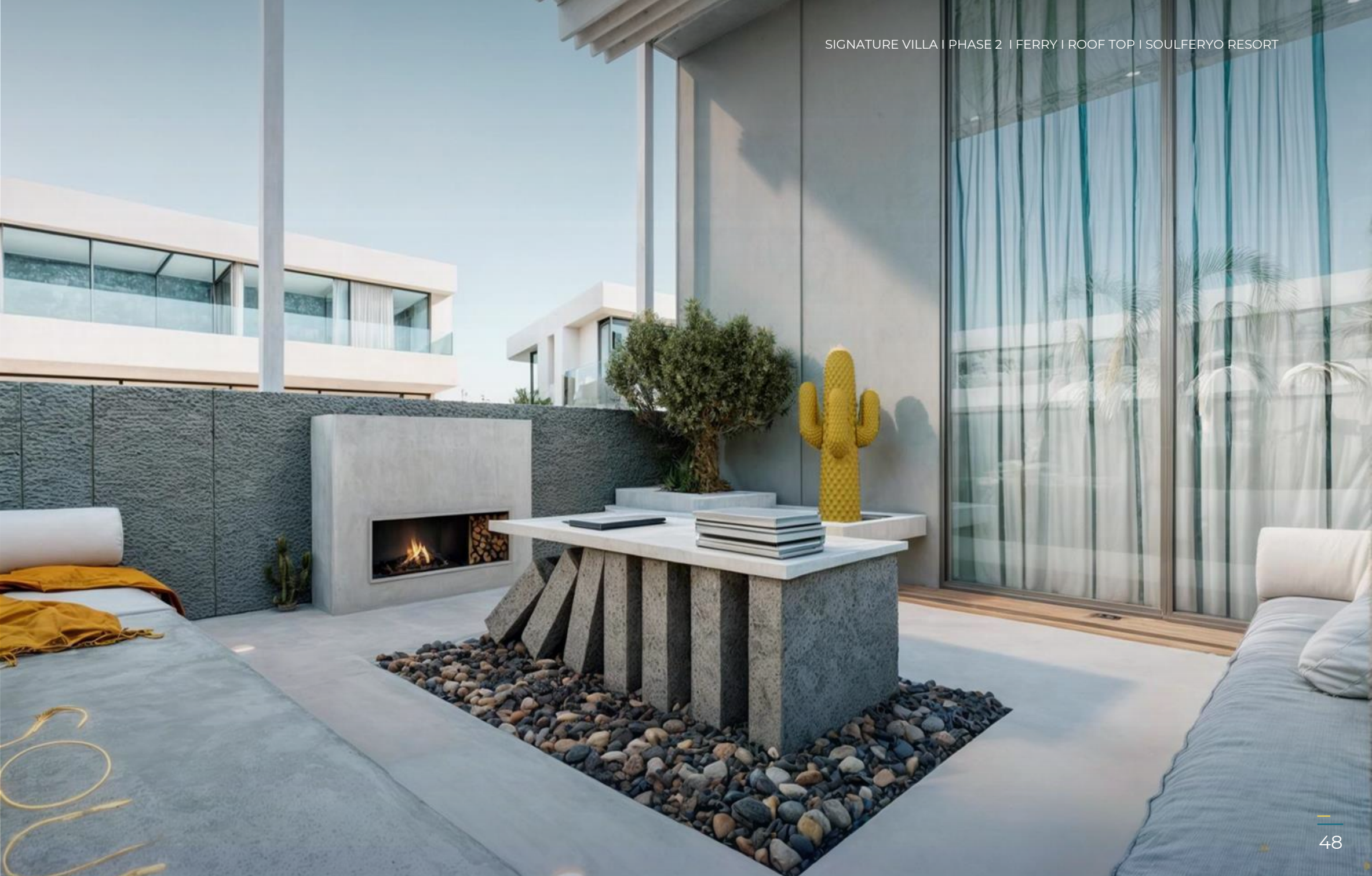

SIGNATURE VILLA | PHASE 2 | FERRY | ROOF TOP | SOULFERYO RESORT

SIGNATURE
VILLA

UNIT
ROOF

SECTIONS CODES:
{TH1 : TH45}

SIGNATURE VILLA | PHASE 2 | FERRY | ROOF TOP | SOULFERYO RESORT



SIGNATURE
VILLA

UNIT
ROOF

SECTIONS CODES:
{TH1 : TH45}

SIGNATURE VILLA | PHASE 2 | FERRY | ROOF TOP | SOULFERYO RESORT



SIGNATURE
VILLA

UNIT
ROOF

SECTIONS CODES:
{TH1 : TH45}



SIGNATURE VILLA | PHASE 2 | FERRY | ROOF TOP | SOULFERYO RESORT

TIMELESS EXPERIENCE

CLICK HERE

360°
TOUR

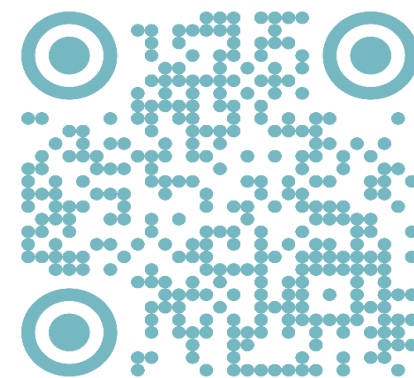

SCAN
QR

VR
EXPERIENCE

ELEGANCE OF DESIGN MEETS THE TRANQUILITY
OF NATURE, INVITING OWNERS AND VISITORS TO
ENJOY AN UNMATCHED LIFESTYLE IN ONE OF THE
MOST BEAUTIFUL LOCATIONS IN THE WORLD.

SOULFORYO
SAHL HASHEESH

FOR THE PREMIUM FEW

E – CATALOGUE

2025

52

SIGNATURE VILLA

GENERAL INFO



FURNITURE
AVAILABLE
UPON REQUEST



VIEW
Sea, Golf,
Pool, Mountain



TOWNHOUSE
45 Units



SPACES
Starting
273m²



FLOORS
Ground + First +
Second + Roof



4 MASTER BR
Per Townhouse



5 BATHROOM
Per Townhouse



SERVICE
Fully Serviced



FULLY
Finished

FEATURED:
(VIEW, BUILDINGS, SPACES, FLOORS,
ROOMS, SERVICE, FINISHING &
FURNISHING)

FOR THE PREMIUM FEW

SIGNATURE
VILLA

FLOOR PLAN

GROUND
FIRST
SECOND
ROOF

SECTIONS CODES:
{TH1 : TH45}

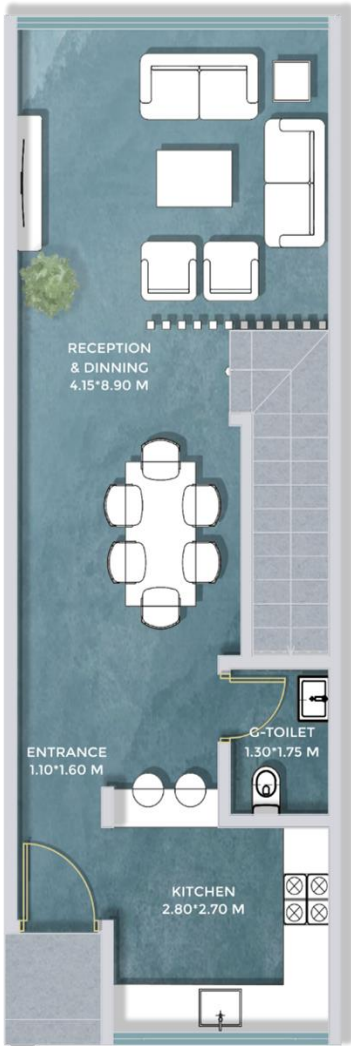

GROUND

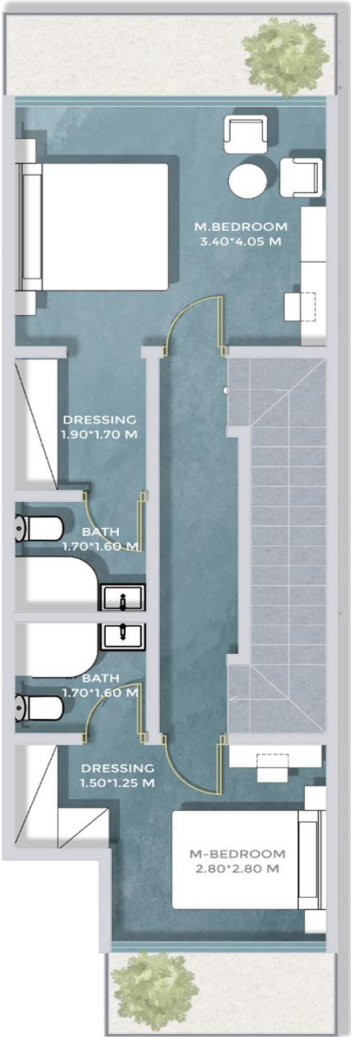

FIRST

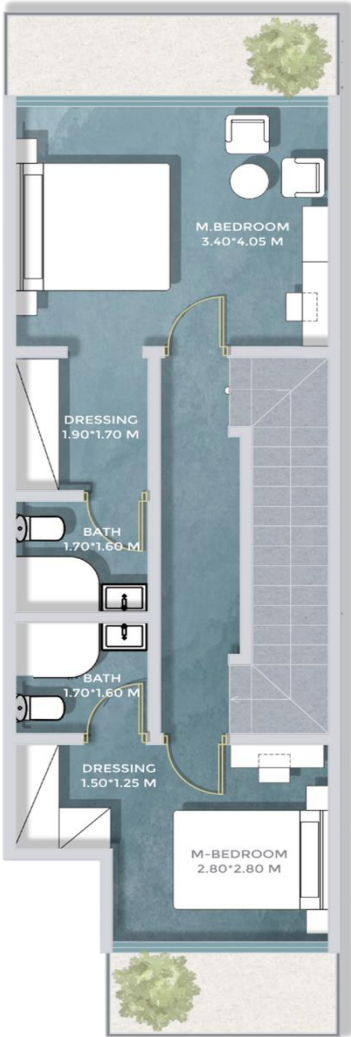

SECOND

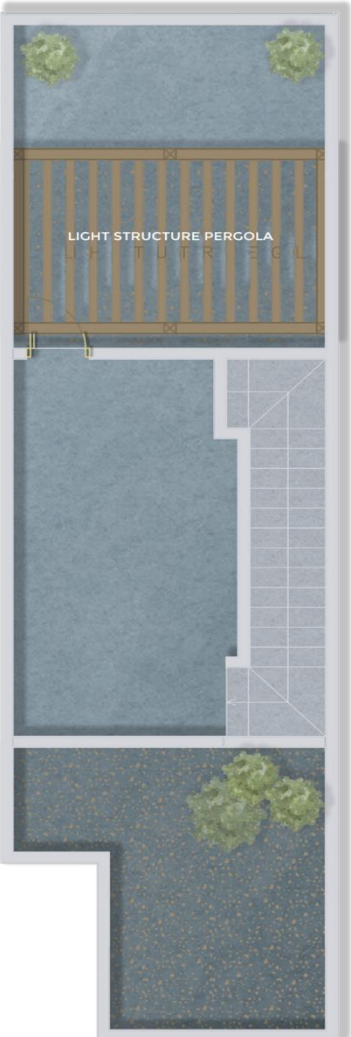

ROOF

FOR THE PREMIUM FEW

SIGNATURE
VILLA

FLOOR PLAN
SPACES

SECTIONS CODES:
{TH1 : TH45}

GROUND FLOOR

ENTRANCE	1.10m x 1.60m
KITCHEN	2.80m x 2.70m
G-BATHROOM	1.30m x 1.75m
RECEPTION + DINING	4.15m x 8.90m

FIRST FLOOR

M. BEDROOM 1	3.40m x 4.05m
DRESSING	1.90m x 1.70m
BATHROOM	1.90m x 1.70m
M. BEDROOM 2	2.80m x 2.80m
DRESSING	1.50m x 1.25m
BATHROOM	1.70m x 1.60m

SECOND FLOOR

M. BEDROOM 1	3.40m x 4.05m
DRESSING	1.90m x 1.70m
BATHROOM	1.90m x 1.70m
M. BEDROOM 2	2.80m x 2.80m
DRESSING	1.50m x 1.25m
BATHROOM	1.70m x 1.60m

OUTER AREAS

GARDEN	34m ²
ROOF	50m ²
TERRACES X 2	3.00m x 1.20m
TERRACES X 2	4.28m x 1.20m

FOR THE PREMIUM FEW

SOULFERYO

SAHL HASHEESH



SOULFERYO
DEVELOPMENTS

TIMELESS
EXPERIENCE



FOR THE
PREMIUM
FEW

THANK YOU!

SOULFERYO

ADDRESS

CG9 Old Town Sahl Hasheesh,
Hurghada, Red Sea, Egypt.

HOTLINE:

17362

DIRECT:

ENGLISH: +2 010 300 200 26

GERMAN: +2 010 300 200 51

RUSSIAN: +2 010 300 200 21

WEBSITE:

www.buildixrealestate.com

EMAIL:

info@buildixrealestate.com