



ALL WEATHER CABINETRY





AWC®

Premium Outdoor Cabinetry Solutions

AWC® specializes in the design and manufacture of high-quality Compact HPL (High Pressure Laminate) cabinetry, engineered to perform in versatile and demanding outdoor environments.

With a highly skilled production team based in Bogotá, Colombia, AWC® ensures a fast and efficient turnaround — from personalized kitchen design and technical drawings to fully assembled cabinets, ready for seamless installation.

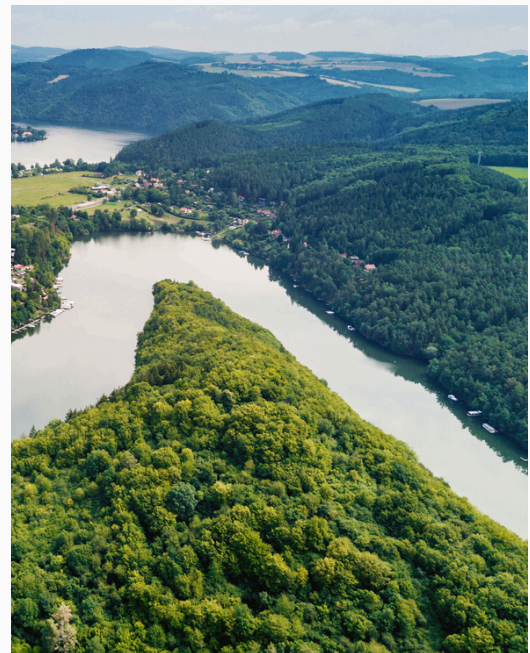

ENVIROMENTALLY FRIENDLY

High Pressure Laminate and the Compact Laminate are sheets consisting of layers of papers impregnated with thermosetting resin, dried and bond together in a high pressure process. The kraft papers we used are mostly recycled papers, also called “regenerated papers”.



Feature



Low Swelling



Fire-resistant



Mould proof



Scratch-proof



Stain resistant



Wear resistant



Free maintenance



Hygienic



Machining friendly



Various surface

FEATURES & BENEFITS

Built for Life Outdoors

Thoughtfully designed and engineered to match your unique lifestyle, AWC® offers a collection of innovative, weather-resistant cabinets ideal for both residential and commercial outdoor spaces.

Durable and long-lasting, our cabinetry ensures your investment with years of outdoor living enjoyment.

CABINETS

SPECIFICATIONS

- Full Access, frameless construction
- Standard depth is 24" deep, can be ordered 28" deep. Drawers remain 21" deep
- 1/4" LDPE thick cabinet backs with 4" nailers top and bottom
- Full depth adjustable shelves
- 110° soft-close stainless steel concealed hinges
- Finished back and side panels
- slides, concealed by drawer sides and treated with corrosion blocker
- Standard base cabinets are 30 1/2" H plus an adjustable leg leveler (standard toe kick is 4")
- Standard cabinets for any type of appliances with customizable cutouts

FINISHES



OAK

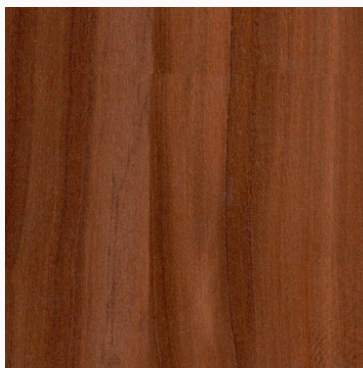

NOCE

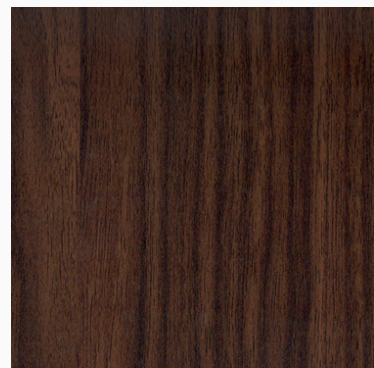

WALNUT

CABINETS

CONSTRUCTION

Cabinet Box: 3/4" thick Anthracite

Compact Laminate

Drawer Box: 3/4"

thick Anthracite

Compact Laminate

Door Hinges:

Stainless Steel

Cabinet Shelves: 3/4" thick

Anthracite Compact Laminate

Drawer and Door Finishes: 3/4"

thick Compact Laminate in WOOD
finish

Back Panel and Side Panel Finishes:

3/4" thick Compact Laminate in wood
color

Toe Kick: Aluminum with adjustable legs

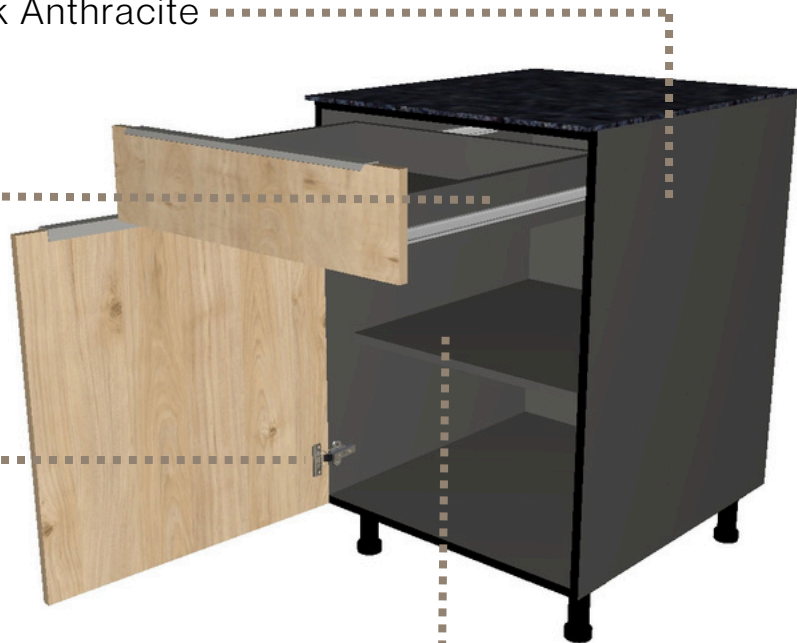



LIST OF CABINETS

Functionality and Design

- Base Cabinet
- Appliances Cabinet
- Wall Cabinet
- Tall Cabinet
- Accessories
- Special Order Cabinet

CABINETS



Full Height 1 Door

VERSION	WIDTH		HEIGHT		DEPTH	
	IN.	MM	IN.	MM	IN.	MM
BC1DO-12	12	304.8	31	787.4	23	584.2
BC1DO-15	15	381	31	787.4	23	584.2
BC1DO-18	18	457.2	31	787.4	23	584.2
BC1DO-21	21	533.4	31	787.4	23	584.2
BC1DO-24	24	609.6	31	787.4	23	584.2
BC1DOX-12	12	304.8	31	787.4	26	660.4
BC1DOX-15	15	381	31	787.4	26	660.4
BC1DOX-18	18	457.2	31	787.4	26	660.4
BC1DOX-21	21	533.4	31	787.4	26	660.4
BC1DOX-24	24	609.6	31	787.4	26	660.4



Top Drawer 1 Door

VERSION	WIDTH		HEIGHT		DEPTH	
	IN.	MM	IN.	MM	IN.	MM
BC1T1DO-12	12	304.8	31	787.4	23	584.2
BC1T1DO-15	15	381	31	787.4	23	584.2
BC1T1DO-18	18	457.2	31	787.4	23	584.2
BC1T1DO-21	21	533.4	31	787.4	23	584.2
BC1T1DO-24	24	609.6	31	787.4	23	584.2
BC1T1DOX-12	12	304.8	31	787.4	26	660.4
BC1T1DOX-15	15	381	31	787.4	26	660.4
BC1T1DOX-18	18	457.2	31	787.4	26	660.4
BC1T1DOX-21	21	533.4	31	787.4	26	660.4
BC1T1DOX-24	24	609.6	31	787.4	26	660.4



Top Drawer 2 Doors

VERSION	WIDTH		HEIGHT		DEPTH	
	IN.	MM	IN.	MM	IN.	MM
BC1T2DO-30	30	762	31	787.4	23	584.2
BC1T2DO-36	36	914.4	31	787.4	23	584.2
BC1T2DO-42	42	1066.8	31	787.4	23	584.2
BC1T2DO-48	48	1219.2	31	787.4	23	584.2
BC1T2DOX-30	30	762	31	787.4	26	660.4
BC1T2DOX-36	36	914.4	31	787.4	26	660.4
BC1T2DOX-42	42	1066.8	31	787.4	26	660.4
BC1T2DOX-48	48	1219.2	31	787.4	26	660.4



Three Drawers

VERSION	WIDTH		HEIGHT		DEPTH	
	IN.	MM	IN.	MM	IN.	MM
BC1T2DW-12	12	304.8	31	787.4	23	584.2
BC1T2DW-15	15	381	31	787.4	23	584.2
BC1T2DW-18	18	457.2	31	787.4	23	584.2
BC1T2DW-21	21	533.4	31	787.4	23	584.2
BC1T2DW-24	24	609.6	31	787.4	23	584.2
BC1T2DWX-12	12	304.8	31	787.4	26	660.4
BC1T2DWX-15	15	381	31	787.4	26	660.4
BC1T2DWX-18	18	457.2	31	787.4	26	660.4
BC1T2DWX-21	21	533.4	31	787.4	26	660.4
BC1T2DWX-24	24	609.6	31	787.4	26	660.4

CABINETS



Four Drawer

VERSION	WIDTH		HEIGHT		DEPTH	
	IN.	MM	IN.	MM	IN.	MM
BC1T3DW-12	12	304.8	31	787.4	23	584.2
BC1T3DW-15	15	381	31	787.4	23	584.2
BC1T3DW-18	18	457.2	31	787.4	23	584.2
BC1T3DW-21	21	533.4	31	787.4	23	584.2
BC1T3DW-24	24	609.6	31	787.4	23	584.2
BC1T3DWX-12	12	304.8	31	787.4	26	660.4
BC1T3DWX-15	15	381	31	787.4	26	660.4
BC1T3DWX-18	18	457.2	31	787.4	26	660.4
BC1T3DWX-21	21	533.4	31	787.4	26	660.4
BC1T3DWX-24	24	609.6	31	787.4	26	660.4



Full Height 2 Doors

VERSION	WIDTH		HEIGHT		DEPTH	
	IN.	MM	IN.	MM	IN.	MM
BC2DO-30	30	762	31	787.4	23	584.2
BC2DO-36	36	914.4	31	787.4	23	584.2
BC2DO-42	42	1066.8	31	787.4	23	584.2
BC2DO-48	48	1219.2	31	787.4	23	584.2
BC2DOX-30	30	762	31	787.4	26	660.4
BC2DOX-36	36	914.4	31	787.4	26	660.4
BC2DOX-42	42	1066.8	31	787.4	26	660.4
BC2DOX-48	48	1219.2	31	787.4	26	660.4



Two Drawers 1 Basket

VERSION	WIDTH		HEIGHT		DEPTH	
	IN.	MM	IN.	MM	IN.	MM
BC2DW1POT-12	12	304.8	31	787.4	23	584.2
BC2DW1POT-15	15	381	31	787.4	23	584.2
BC2DW1POT-18	18	457.2	31	787.4	23	584.2
BC2DW1POT-21	21	533.4	31	787.4	23	584.2
BC2DW1POT-24	24	609.6	31	787.4	23	584.2
BC2DW1POTX-12	12	304.8	31	787.4	26	660.4
BC2DW1POTX-15	15	381	31	787.4	26	660.4
BC2DW1POTX-18	18	457.2	31	787.4	26	660.4
BC2DW1POTX-21	21	533.4	31	787.4	26	660.4
BC2DW1POTX-24	24	609.6	31	787.4	26	660.4



Two Baskets

VERSION	WIDTH		HEIGHT		DEPTH	
	IN.	MM	IN.	MM	IN.	MM
BC2POT-12	12	304.8	31	787.4	23	584.2
BC2POT-15	15	381	31	787.4	23	584.2
BC2POT-18	18	457.2	31	787.4	23	584.2
BC2POT-21	21	533.4	31	787.4	23	584.2
BC2POT-24	24	609.6	31	787.4	23	584.2
BC2POTX-12	12	304.8	31	787.4	26	660.4
BC2POTX-15	15	381	31	787.4	26	660.4
BC2POTX-18	18	457.2	31	787.4	26	660.4
BC2POTX-21	21	533.4	31	787.4	26	660.4
BC2POTX-24	24	609.6	31	787.4	26	660.4

CABINETS



Three Drawer Line

VERSION	WIDTH		HEIGHT		DEPTH	
	IN.	MM	IN.	MM	IN.	MM
BC3DWL-12	12	304.8	31	787.4	23	584.2
BC3DWL-15	15	381	31	787.4	23	584.2
BC3DWL-18	18	457.2	31	787.4	23	584.2
BC3DWL-21	21	533.4	31	787.4	23	584.2
BC3DWL-24	24	609.6	31	787.4	23	584.2
BC3DWLX-12	12	304.8	31	787.4	26	660.4
BC3DWLX-15	15	381	31	787.4	26	660.4
BC3DWLX-18	18	457.2	31	787.4	26	660.4
BC3DWLX-21	21	533.4	31	787.4	26	660.4
BC3DWLX-24	24	609.6	31	787.4	26	660.4



Corner Base L/R

VERSION	WIDTH		HEIGHT		DEPTH	
	IN.	MM	IN.	MM	IN.	MM
CBCL-44	44	1117.6	31	787.4	23	584.2
CBCLX-44	44	1117.6	31	787.4	26	660.4
CBCR-44	44	1118	31	787.4	23	584.2
CBCRX-44	44	1118	31	787.4	26	660.4



Grill Cabinet 2 Doors

VERSION	WIDTH		HEIGHT		DEPTH	
	IN.	MM	IN.	MM	IN.	MM
GC1FF2DO-36	36	914.4	31	787.4	23	584.2
GC1FF2DO-39	39	990.6	31	787.4	23	584.2
GC1FF2DO-42	42	1066.8	31	787.4	23	584.2
GC1FF2DO-45	45	1143	31	787.4	23	584.2
GC1FF2DO-48	48	1219.2	31	787.4	23	584.2
GC1FF2DOX-36	36	914.4	31	787.4	26	660.4
GC1FF2DOX-39	39	990.6	31	787.4	26	660.4
GC1FF2DOX-42	42	1066.8	31	787.4	26	660.4
GC1FF2DOX-45	45	1143	31	787.4	26	660.4
GC1FF2DOX-48	48	1219.2	31	787.4	26	660.4



Grill Cabinet 4 Doors

VERSION	WIDTH		HEIGHT		DEPTH	
	IN.	MM	IN.	MM	IN.	MM
GC1FF4DO-51	51	1295.4	31	787.4	23	584.2
GC1FF4DO-54	54	1371.6	31	787.4	23	584.2
GC1FF4DO-57	57	1447.8	31	787.4	23	584.2
GC1FF4DO-60	60	1524	31	787.4	23	584.2
GC1FF4DOX-51	51	1295.4	31	787.4	26	660.4
GC1FF4DOX-54	54	1371.6	31	787.4	26	660.4
GC1FF4DOX-57	57	1447.8	31	787.4	26	660.4
GC1FF4DOX-60	60	1524	31	787.4	26	660.4

CABINETS



Green Egg 1 Door

VERSION	WIDTH		HEIGHT		DEPTH	
	IN.	MM	IN.	MM	IN.	MM
GEC1DO-24	24	609.6	31	787.4	23	584.2
GEC1DO-36	36	914.4	31	787.4	23	584.2
GEC1DOX-24	24	609.6	31	787.4	26	660.4
GEC1DOX-36	36	914.4	31	787.4	26	660.4



Propane Tank Cabinet

VERSION	WIDTH		HEIGHT		DEPTH	
	IN.	MM	IN.	MM	IN.	MM
LP1DO-18	18	457.2	31	787.4	23	584.2
LP1DO-21	21	533.4	31	787.4	23	584.2
LP1DO-24	24	609.6	31	787.4	23	584.2
LP1DO-30	30	762	31	787.4	23	584.2
LP1DO-36	36	914.4	31	787.4	23	584.2
LP1DOX-18	18	457.2	31	787.4	26	660.4
LP1DOX-21	21	533.4	31	787.4	26	660.4
LP1DOX-24	24	609.6	31	787.4	26	660.4
LP1DOX-30	30	762	31	787.4	26	660.4
LP1DOX-36	36	914.4	31	787.4	26	660.4



Propane 1 Drawer 1 Door

VERSION	WIDTH		HEIGHT		DEPTH	
	IN.	MM	IN.	MM	IN.	MM
LP1TD1DO-18	18	457.2	31	787.4	23	584.2
LP1TD1DO-21	21	533.4	31	787.4	23	584.2
LP1TD1DO-24	24	609.6	31	787.4	23	584.2
LP1TD1DO-30	30	762	31	787.4	23	584.2
LP1TD1DO-36	36	914.4	31	787.4	23	584.2
LP1TD1DOX-18	18	457.2	31	787.4	26	660.4
LP1TD1DOX-21	21	533.4	31	787.4	26	660.4
LP1TD1DOX-24	24	609.6	31	787.4	26	660.4
LP1TD1DOX-30	30	762	31	787.4	26	660.4
LP1TD1DOX-36	36	914.4	31	787.4	26	660.4



Propane 1 fake front 1 Door

VERSION	WIDTH		HEIGHT		DEPTH	
	IN.	MM	IN.	MM	IN.	MM
LPFF1DO-18	18	457.2	31	787.4	23	584.2
LPFF1DO-21	21	533.4	31	787.4	23	584.2
LPFF1DO-24	24	609.6	31	787.4	23	584.2
LPFF1DO-30	30	762	31	787.4	23	584.2
LPFF1DO-36	36	914.4	31	787.4	23	584.2
LPFF1DOX-18	18	457.2	31	787.4	26	660.4
LPFF1DOX-21	21	533.4	31	787.4	26	660.4
LPFF1DOX-24	24	609.6	31	787.4	26	660.4
LPFF1DOX-30	30	762	31	787.4	26	660.4
LPFF1DOX-36	36	914.4	31	787.4	26	660.4

CABINETS



Open Base

VERSION	WIDTH		HEIGHT		DEPTH	
	IN.	MM	IN.	MM	IN.	MM
OBC-12	12	304.8	31	787.4	23	584.2
OBC-15	15	381	31	787.4	23	584.2
OBC-18	18	457.2	31	787.4	23	584.2
OBC-21	21	533.4	31	787.4	23	584.2
OBC-24	24	609.6	31	787.4	23	584.2
OBCX-12	12	304.8	31	787.4	26	660.4
OBCX-15	15	381	31	787.4	26	660.4
OBCX-18	18	457.2	31	787.4	26	660.4
OBCX-21	21	533.4	31	787.4	26	660.4
OBCX-24	24	609.6	31	787.4	26	660.4



Open Refrigerator Cabinet

VERSION	WIDTH		HEIGHT		DEPTH	
	IN.	MM	IN.	MM	IN.	MM
OBCREF-15	15	381	31	787.4	4.50	114.30
OBCREF-18	18	457.2	31	787.4	4.50	114.30
OBCREF-21	21	533.4	31	787.4	4.50	114.30
OBCREF-24	24	609.6	31	787.4	4.50	114.30



Sink Cabinet 1 Door

VERSION	WIDTH		HEIGHT		DEPTH	
	IN.	MM	IN.	MM	IN.	MM
SB1DO-12	12	304.8	31	787.4	23	584.2
SB1DO-15	15	381	31	787.4	23	584.2
SB1DO-18	18	457.2	31	787.4	23	584.2
SB1DO-21	21	533.4	31	787.4	23	584.2
SB1DO-24	24	609.6	31	787.4	23	584.2
SB1DOX-12	12	304.8	31	787.4	26	660.4
SB1DOX-15	15	381	31	787.4	26	660.4
SB1DOX-18	18	457.2	31	787.4	26	660.4
SB1DOX-21	21	533.4	31	787.4	26	660.4
SB1DOX-24	24	609.6	31	787.4	26	660.4



Sink 2 Full Doors

VERSION	WIDTH		HEIGHT		DEPTH	
	IN.	MM	IN.	MM	IN.	MM
SB2DO-27	27	685.8	31	787.4	23	584.2
SB2DO-30	30	762	31	787.4	23	584.2
SB2DO-33	33	838.2	31	787.4	23	584.2
SB2DO-36	36	914.4	31	787.4	23	584.2
SB2DO-39	39	990.6	31	787.4	23	584.2
SB2DO-42	42	1066.8	31	787.4	23	584.2
SB2DO-48	48	1219.2	31	787.4	23	584.2
SB2DOX-27	27	685.8	31	787.4	26	660.4
SB2DOX-30	30	762	31	787.4	26	660.4
SB2DOX-33	33	838.2	31	787.4	26	660.4
SB2DOX-36	36	914.4	31	787.4	26	660.4
SB2DOX-39	39	990.6	31	787.4	26	660.4
SB2DOX-42	42	1066.8	31	787.4	26	660.4
SB2DOX-48	48	1219.2	31	787.4	26	660.4

CABINETS



Sink Full Height 4 Doors

VERSION	WIDTH		HEIGHT		DEPTH	
	IN.	MM	IN.	MM	IN.	MM
SB4DO-51	51	1295.4	31	787.4	23	584.2
SB4DO-54	54	1371.6	31	787.4	23	584.2
SB4DO-57	57	1447.8	31	787.4	23	584.2
SB4DO-60	60	1524	31	787.4	23	584.2
SB4DO-63	63	1600.2	31	787.4	23	584.2
SB4DOX-51	51	1295.4	31	787.4	26	660.4
SB4DOX-54	54	1371.6	31	787.4	26	660.4
SB4DOX-57	57	1447.8	31	787.4	26	660.4
SB4DOX-60	60	1524	31	787.4	26	660.4
SB4DOX-63	63	1600.2	31	787.4	26	660.4



Sink Front Panel 1 Door

VERSION	WIDTH		HEIGHT		DEPTH	
	IN.	MM	IN.	MM	IN.	MM
SBFF1DO-12	12	304.8	31	787.4	23	584.2
SBFF1DO-15	15	381	31	787.4	23	584.2
SBFF1DO-18	18	457.2	31	787.4	23	584.2
SBFF1DO-21	21	533.4	31	787.4	23	584.2
SBFF1DO-24	24	609.6	31	787.4	23	584.2
SBFF1DOX-12	12	304.8	31	787.4	26	660.4
SBFF1DOX-15	15	381	31	787.4	26	660.4
SBFF1DOX-18	18	457.2	31	787.4	26	660.4
SBFF1DOX-21	21	533.4	31	787.4	26	660.4
SBFF1DOX-24	24	609.6	31	787.4	26	660.4



Sink Front Panel 2 Doors

VERSION	WIDTH		HEIGHT		DEPTH	
	IN.	MM	IN.	MM	IN.	MM
SBFF2DO-27	27	685.8	31	787.4	23	584.2
SBFF2DO-30	30	762	31	787.4	23	584.2
SBFF2DO-36	36	914.4	31	787.4	23	584.2
SBFF2DO-42	42	1066.8	31	787.4	23	584.2
SBFF2DO-48	48	1219.2	31	787.4	23	584.2
SBFF2DOX-27	27	685.8	31	787.4	26	660.4
SBFF2DOX-30	30	762	31	787.4	26	660.4
SBFF2DOX-36	36	914.4	31	787.4	26	660.4
SBFF2DOX-42	42	1066.8	31	787.4	26	660.4
SBFF2DOX-48	48	1219.2	31	787.4	26	660.4



Sink Front Panel 4 Doors

VERSION	WIDTH		HEIGHT		DEPTH	
	IN.	MM	IN.	MM	IN.	MM
SBFF4DO-51	51	1295.4	31	787.4	23	584.2
SBFF4DO-54	54	1371.6	31	787.4	23	584.2
SBFF4DO-57	57	1447.8	31	787.4	23	584.2
SBFF4DO-60	60	1524	31	787.4	23	584.2
SBFF4DO-63	63	1600.2	31	787.4	23	584.2
SBFF4DOX-51	51	1295.4	31	787.4	26	660.4
SBFF4DOX-54	54	1371.6	31	787.4	26	660.4
SBFF4DOX-57	57	1447.8	31	787.4	26	660.4
SBFF4DOX-60	60	1524	31	787.4	26	660.4
SBFF4DOX-63	63	1600.2	31	787.4	26	660.4

CABINETS



Side Burner 1 Door

VERSION	WIDTH		HEIGHT		DEPTH	
	IN.	MM	IN.	MM	IN.	MM
SBU1FF1DO-12	12	304.8	31	787.4	23	584.2
SBU1FF1DO-15	15	381	31	787.4	23	584.2
SBU1FF1DO-18	18	457.2	31	787.4	23	584.2
SBU1FF1DO-21	21	533.4	31	787.4	23	584.2
SBU1FF1DO-24	24	609.6	31	787.4	23	584.2
SBU1FF1DO-12	12	304.8	31	787.4	26	660.4
SBU1FF1DO-15	15	381	31	787.4	26	660.4
SBU1FF1DO-18	18	457.2	31	787.4	26	660.4
SBU1FF1DO-21	21	533.4	31	787.4	26	660.4
SBU1FF1DO-24	24	609.6	31	787.4	26	660.4



Trash C. Full Height Door

VERSION	WIDTH		HEIGHT		DEPTH	
	IN.	MM	IN.	MM	IN.	MM
TC1DW-12	12	304.8	31	787.4	23	584.2
TC1DW-15	15	381	31	787.4	23	584.2
TC1DW-18	18	457.2	31	787.4	23	584.2
TC1DW-21	21	533.4	31	787.4	23	584.2
TC1DW-24	24	609.6	31	787.4	23	584.2
TC1DWX-12	12	304.8	31	787.4	26	660.4
TC1DWX-15	15	381	31	787.4	26	660.4
TC1DWX-18	18	457.2	31	787.4	26	660.4
TC1DWX-21	21	533.4	31	787.4	26	660.4
TC1DWX-24	24	609.6	31	787.4	26	660.4



Trash 1 Drawer, 1 Door

VERSION	WIDTH		HEIGHT		DEPTH	
	IN.	MM	IN.	MM	IN.	MM
TC1TD1DW-12	12	304.8	31	787.4	23	584.2
TC1TD1DW-15	15	381	31	787.4	23	584.2
TC1TD1DW-18	18	457.2	31	787.4	23	584.2
TC1TD1DW-21	21	533.4	31	787.4	23	584.2
TC1TD1DW-24	24	609.6	31	787.4	23	584.2
TC1TD1DW-12	12	304.8	31	787.4	26	660.4
TC1TD1DW-15	15	381	31	787.4	26	660.4
TC1TD1DW-18	18	457.2	31	787.4	26	660.4
TC1TD1DW-21	21	533.4	31	787.4	26	660.4
TC1TD1DW-24	24	609.6	31	787.4	26	660.4



Wall Cabinet 1 Door 30"H

VERSION	WIDTH		HEIGHT		DEPTH	
	IN.	MM	IN.	MM	IN.	MM
WC1DO30-12	12	304.8	30	762	12	304.8
WC1DO30-15	15	381	30	762	12	304.8
WC1DO30-18	18	457.2	30	762	12	304.8
WC1DO30-21	21	533.4	30	762	12	304.8
WC1DO30-24	24	609.6	30	762	12	304.8

CABINETS



Wall Cabinet 1 Door 36"H

VERSION	WIDTH		HEIGHT		DEPTH	
	IN.	MM	IN.	MM	IN.	MM
WC1DO36-12	12	304.8	36	914.4	12	304.8
WC1DO36-15	15	381	36	914.4	12	304.8
WC1DO36-18	18	457.2	36	914.4	12	304.8
WC1DO36-21	21	533.4	36	914.4	12	304.8
WC1DO36-24	24	609.6	36	914.4	12	304.8



Wall Cabinet 2 Door 30"H

VERSION	WIDTH		HEIGHT		DEPTH	
	IN.	MM	IN.	MM	IN.	MM
WC2DO30-24	24	609.6	30	762	12	304.8
WC2DO30-27	27	685.8	30	762	12	304.8
WC2DO30-30	30	762	30	762	12	304.8
WC2DO30-33	33	838.2	30	762	12	304.8
WC2DO30-36	36	914.4	30	762	12	304.8



Wall Cabinet 2 Door 36"H

VERSION	WIDTH		HEIGHT		DEPTH	
	IN.	MM	IN.	MM	IN.	MM
WC2DO30-24	24	609.6	30	762	12	304.8
WC2DO30-27	27	685.8	30	762	12	304.8
WC2DO30-30	30	762	30	762	12	304.8
WC2DO30-33	33	838.2	30	762	12	304.8
WC2DO30-36	36	914.4	30	762	12	304.8



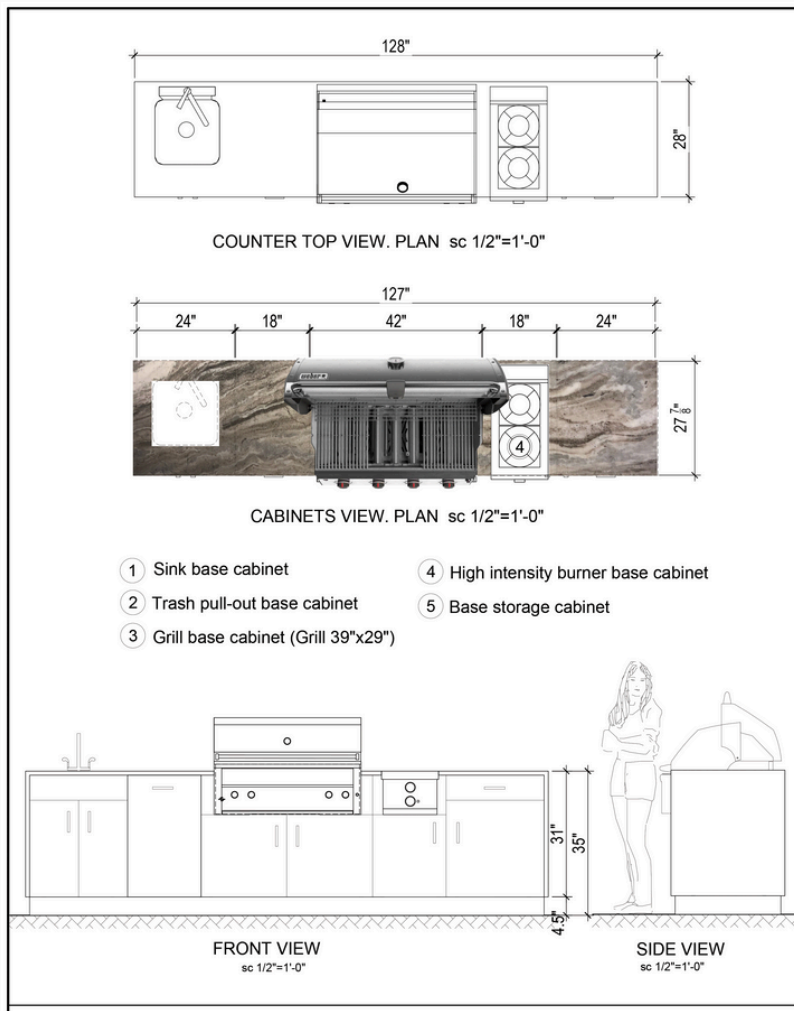

DESIGN

Complimentary Design Services for Custom Outdoor Kitchens

Unlike indoor kitchens, outdoor kitchens demand a unique design mindset. Priorities shift — from how storage is configured to the strategic placement of appliances — all while considering exposure to the elements, traffic flow, and lifestyle needs. Our expertise ensures that every detail is optimized for outdoor living, durability, and daily enjoyment.

AWC® offers free design consultation and expert advice for every custom outdoor kitchen project. Whether you're creating a space for family gatherings or upscale entertaining, our team is here to help you bring your vision to life — beautifully and efficiently.

Colombia

Ave. Troncal de Occidente # 20-85, Int 34
Bod 1, Mosquera, Cundinamarca, Colombia.

Panama

Av Centenario, Torre Aseguradora Ancon,
Piso 13, Oficina 13a, Frente A Ph Sol De
Panama, 0832, Panama

USA

3201 NW 82nd Ave Doral FL 33122, USA

Contact

Phone: 786-851-3546

Emails: info@allweathercabinetry.com

Web. www.allweathercabinetry.com

