

EXPLOSION LAMP

---



IP65

UNTI-EXPLOSION 8070  
50W/70W/100W/120W  
150W/200W  
P.1-2



IP65

UNTI-EXPLOSION 8071  
18W  
P.3



IP65

UNTI-EXPLOSION 8072  
36W  
P.4



IP65

UNTI-EXPLOSION 8073  
30W  
P.5



IP65

UNTI-EXPLOSION 8074  
50W  
P.6



IP65

UNTI-EXPLOSION 8075  
100W  
P.7

# 8070

Downlight Recessed. Ambience/UGR

UNTI-EXPLOSION series

IP65

# Architectural OUTDOOR

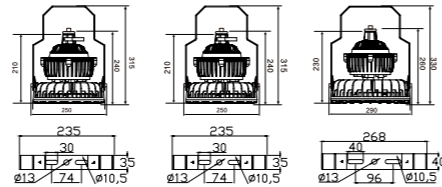

OSRAM 50,000hrs SMD LED LM80 Fixed Ra >80 UGR <19 IP66 5 years Warranty AC220-240V 50/60Hz CE Aluminum+PC 90°

Light Source	Power	Size	Source Lumens	System Lumens	CCT	Code
SMD LED	50W	ø230x210mm	6536lm	5032lm	● 2700K	807012.B.P.C
SMD LED	50W	ø230x210mm	6975lm	5371lm	● 3000K	807013.B.P.C
SMD LED	50W	ø230x210mm	7414lm	5709lm	○ 4000K	807014.B.P.C
SMD LED	50W	ø230x210mm	7700lm	5929lm	○ 5000K	807015.B.P.C
SMD LED	70W	ø230x210mm	9150lm	7045lm	● 2700K	807022.B.P.C
SMD LED	70W	ø230x210mm	9765lm	7519lm	● 3000K	807023.B.P.C
SMD LED	70W	ø230x210mm	10380lm	7993lm	○ 4000K	807024.B.P.C
SMD LED	70W	ø230x210mm	10781lm	8301lm	○ 5000K	807025.B.P.C
SMD LED	100W	ø270x230mm	13071lm	10065lm	● 2700K	807032.B.P.C
SMD LED	100W	ø270x230mm	13950lm	10742lm	● 3000K	807033.B.P.C
SMD LED	100W	ø270x230mm	14829lm	11418lm	○ 4000K	807034.B.P.C
SMD LED	100W	ø270x230mm	15401lm	11859lm	○ 5000K	807035.B.P.C

Beam Angle: B(1-90°)

Power Supply: P(1-On/Off)

Colour Finish: C(1-Dark Yellow)



Dark Yellow

# 8070

Downlight Recessed. Ambience/UGR

UNTI-EXPLOSION series

IP65

# Architectural OUTDOOR

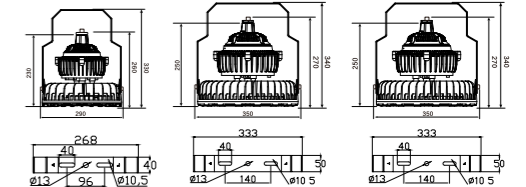

OSRAM 50,000hrs SMD LED LM80 Fixed Ra >80 UGR <19 IP66 5 years Warranty AC100-240V 50/60Hz CE PC+PC 90°

Light Source	Power	Size	Source Lumens	System Lumens	CCT	Code
SMD LED	120W	ø270x230mm	15685lm	12078lm	● 2700K	807042.B.P.C
SMD LED	120W	ø270x230mm	16740lm	12890lm	● 3000K	807043.B.P.C
SMD LED	120W	ø270x230mm	17795lm	13702lm	○ 4000K	807044.B.P.C
SMD LED	120W	ø270x230mm	18481lm	14230lm	○ 5000K	807045.B.P.C
SMD LED	150W	ø330x250mm	19607lm	15097lm	● 2700K	807052.B.P.C
SMD LED	150W	ø330x250mm	20925lm	16112lm	● 3000K	807053.B.P.C
SMD LED	150W	ø330x250mm	22243lm	17127lm	○ 4000K	807054.B.P.C
SMD LED	150W	ø330x250mm	23101lm	17788lm	○ 5000K	807055.B.P.C
SMD LED	200W	ø330x250mm	26142lm	20130lm	● 2700K	807062.B.P.C
SMD LED	200W	ø330x250mm	27900lm	21483lm	● 3000K	807063.B.P.C
SMD LED	200W	ø330x250mm	29658lm	22836lm	○ 4000K	807064.B.P.C
SMD LED	200W	ø330x250mm	30802lm	23717lm	○ 5000K	807065.B.P.C

Beam Angle: B(1-90°)

Power Supply: P(1-On/Off)

Colour Finish: C(1-Dark Yellow)



Dark Yellow

# 8071

Downlight Recessed. Ambience/UGR

**UNTI-EXPLOSION** series

**IP65**



# Architectural OUTDOOR

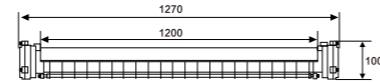

OSRAM | SMD | LED LM80 | | Ra >80 | UGR <19 | | | AC220-240V 50/60Hz | | Aluminum+PC |

Light Source	Power	Size	Source Lumens	System Lumens	CCT	Code
SMD LED	18W	1270x160x100mm	2125lm	1636lm	● 2700K	807112.B.P.C
SMD LED	18W	1270x160x100mm	2268lm	1746lm	● 3000K	807113.B.P.C
SMD LED	18W	1270x160x100mm	2411lm	1856lm	○ 4000K	807114.B.P.C
SMD LED	18W	1270x160x100mm	2504lm	1928lm	○ 5000K	807115.B.P.C

Beam Angle: B(1-180°)

Power Supply: P(1-On/Off)

Colour Finish: C(1-Dark Yellow)



Dark Yellow

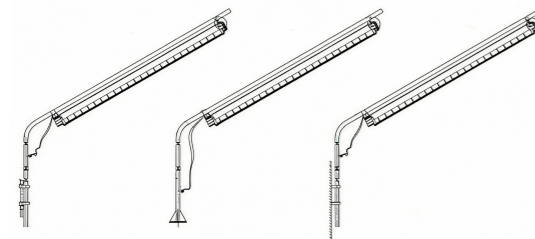

Guardrail Type    Flange Type    Curve Type

# 8072

Downlight Recessed. Ambience/UGR

**UNTI-EXPLOSION** series

**IP65**



# Architectural OUTDOOR

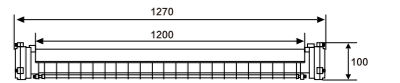

OSRAM | SMD | LED LM80 | | Ra >80 | UGR <19 | | | AC100-240V 50/60Hz | | PC+PC |

Light Source	Power	Size	Source Lumens	System Lumens	CCT	Code
SMD LED	36W	1270x180x100mm	4250lm	3273lm	● 2700K	807212.B.P.C
SMD LED	36W	1270x180x100mm	4536lm	3493lm	● 3000K	807213.B.P.C
SMD LED	36W	1270x180x100mm	4822lm	3713lm	○ 4000K	807214.B.P.C
SMD LED	36W	1270x180x100mm	5008lm	3856lm	○ 5000K	807215.B.P.C

Beam Angle: B(1-180°)

Power Supply: P(1-On/Off)

Colour Finish: C(1-Dark Yellow)



Dark Yellow



Guardrail Type    Flange Type    Curve Type

# 8073

Downlight Recessed. Ambience/UGR

**UNTI-EXPLOSION** series

**IP65**



# Architectural OUTDOOR

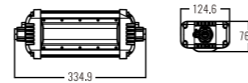

OSRAM 50,000hrs	SMD	LED LM80	Fixed	Ra >80	UGR <19	IP66	5 years Warranty	AC220-240V 50/60Hz	CE	Aluminum+PC	180°
--------------------	-----	-------------	-------	-----------	------------	------	---------------------	-----------------------	----	-------------	------

Light Source	Power	Size	Source Lumens	System Lumens	CCT	Code
SMD LED	30W	335x125x77mm	3668lm	2825lm	● 2700K	807312.B.P.C
SMD LED	30W	335x125x77mm	3915lm	3015lm	● 3000K	807313.B.P.C
SMD LED	30W	335x125x77mm	4162lm	3204lm	● 4000K	807314.B.P.C
SMD LED	30W	335x125x77mm	4322lm	3328lm	● 5000K	807315.B.P.C

Beam Angle: B(1-180°)

Power Supply: P(1-On/Off)

Colour Finish: C(1-White)



White

# 8074

Downlight Recessed. Ambience/UGR

**UNTI-EXPLOSION** series

**IP65**



# Architectural OUTDOOR

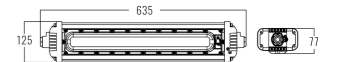
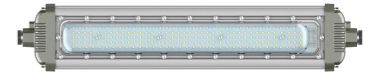

OSRAM 50,000hrs	SMD	LED LM80	Fixed	Ra >80	UGR <19	IP66	5 years Warranty	AC100-240V 50/60Hz	CE	PC+PC	180°
--------------------	-----	-------------	-------	-----------	------------	------	---------------------	-----------------------	----	-------	------

Light Source	Power	Size	Source Lumens	System Lumens	CCT	Code
SMD LED	50W	635x125x77mm	6114lm	4708lm	● 2700K	807212.B.P.C
SMD LED	50W	635x125x77mm	6525lm	5024lm	● 3000K	807213.B.P.C
SMD LED	50W	635x125x77mm	6936lm	5341lm	● 4000K	807214.B.P.C
SMD LED	50W	635x125x77mm	7204lm	5547lm	● 5000K	807215.B.P.C

Beam Angle: B(1-180°)

Power Supply: P(1-On/Off)

Colour Finish: C(1-White)



White

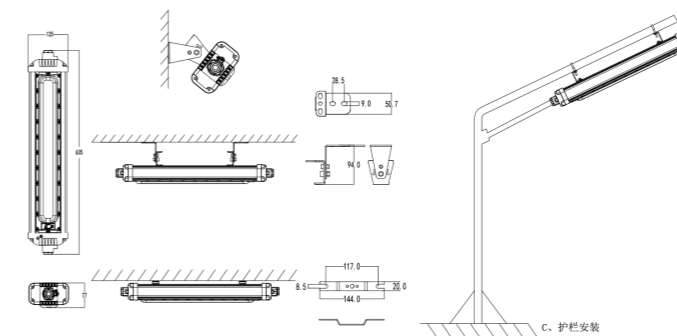

8075

Downlight Recessed. Ambience/UGR

UNTI-EXPLOSION series

IP65

Architectural OUTDOOR

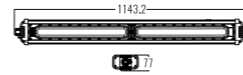
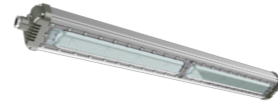

OSRAM 50,000hrs	SMD	LED LM80	Fixed	Ra >80	UGR <19	IP66	5 Years Warranty	AC220-240V 50/60Hz	CE	Aluminum+PC	180°
--------------------	-----	-------------	-------	-----------	------------	------	------------------------	-----------------------	----	-------------	------

Light Source	Power	Size	Source Lumens	System Lumens	CCT	Code
SMD LED	100W	1145x125x77mm	12228lm	9415lm	● 2700K	807512.B.P.C
SMD LED	100W	1145x125x77mm	13050lm	10049lm	● 3000K	807513.B.P.C
SMD LED	100W	1145x125x77mm	13872lm	10682lm	○ 4000K	807514.B.P.C
SMD LED	100W	1145x125x77mm	14407lm	11094lm	○ 5000K	807515.B.P.C

Beam Angle: B(1-180°)

Power Supply: P(1-On/Off)

Colour Finish: C(1-White)

