

SoiTech, S.A.

Corporate Presentation

Abstract

This document is the corporate presentation of **SoiTech, S.A.**, detailing its vision, mission, services and products. It also includes the notice of operations and financial statements.



Innovative Design and Construction Solutions

Civil Engineering | Master's in Structures | Master's in Geotechnics

At **SoiTech, S.A.**, our philosophy of excellence and innovation drives each of our projects. As a company specializing in civil engineering consulting and construction, we are committed to providing comprehensive solutions that turn ideas into concrete realities.

Who We Are?

SoiTech, S.A. is a partnership of leading companies in design, architecture, engineering, civil construction, and restoration in Panama and Colombia. Our focus is on the preservation of cultural and architectural heritage, as well as technical excellence to provide comprehensive solutions to our clients.

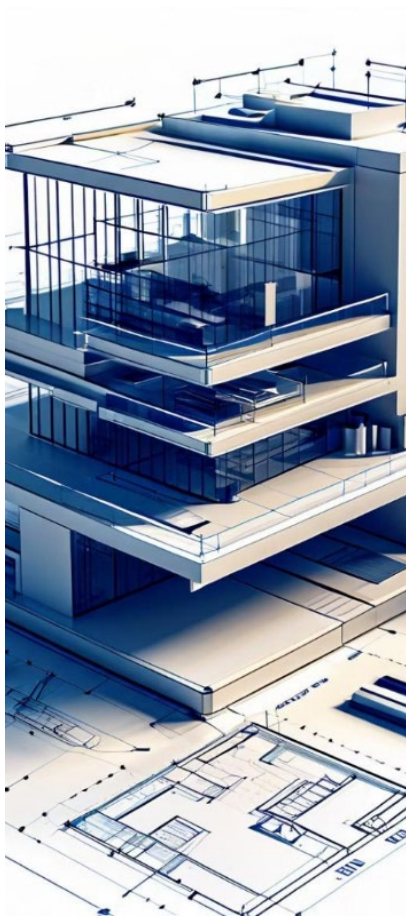

Areas of Expertise

The team of engineers and architects at **SoiTech, S.A.**, specializing in geotechnics, structures, pavements, and construction, brings the necessary experience and quality to ensure the success of every project.

Professional Consulting: Our team of experts is at your disposal to turn your ideas into reality. From initial planning to comprehensive project management, we support you at every stage of the process.

Quality Construction: With a focus on quality and efficiency, we carry out construction projects in various areas. From residential buildings to commercial facilities, we deliver durable and high-standard results.

Design and Architecture: Experts in creating innovative and aesthetically pleasing architectural solutions, with an emphasis on functionality and harmony with the environment.

Engineering and Construction: Leaders in the execution of infrastructure and building projects, ensuring quality, safety, and efficiency at every stage.

Restoration and Conservation: Specialists in the recovery and rehabilitation of historical and heritage buildings, preserving their essence and cultural value.

Geotechnics

Structures

Pavements

Construction

Restoration

Our services

Consulting and project development with available financing.

Technical Consulting

Advisory in project planning, execution and structuring.

Construction & Development

Execution of civil, commercial and industrial projects.

Investment & Financing

Access to investment opportunities with structured financing.

Our Company

SoiTech, S.A. is a leading company in the design and construction of high-quality projects, with over 20 years of experience in Colombia and 3 years in Panama. We stand out for our innovation and technical excellence, being experts in geotechnics, structures, and pavements.

In the field of Architecture and Consulting, we offer services ranging from architectural design to project supervision. We are also committed to real estate development, encompassing residential, commercial, and mixed-use projects.

In the area of Construction, Remodeling, and Additions, we provide specialized services that include structural welding, reinforcements and foundations, masonry, electrical wiring, potable water and sewage systems, excavations, earthworks and paving.

In Construction and Restoration, we are dedicated to the preservation of architectural and cultural heritage in Panama and Colombia. Our team of experts works passionately to preserve the history and legacy of the most emblematic buildings in these countries.

Additionally, in Comprehensive Services, we specialize in design, supply of materials, and industrial safety. We offer customized solutions, such as the construction of greenhouses and the transformation of containers into functional spaces.

With a solid track record, we provide a complete range of services that integrate design, construction, historical and archaeological research, and the conservation of the cultural and architectural heritage of the region.

Design and Construction Services



Comprehensive Design

We offer architectural and engineering design services that encompass everything from conceptualization to project execution. Our holistic approach ensures consistency and excellence at every stage of the design process.



Quality Engineering

Our team of engineers ensures structural integrity. From planning to execution, we prioritize excellence. Comprehensive Construction. We preserve historical heritage using specialized techniques.



Quality Construction

We have an experienced team in the construction and management of civil works, committed to the highest standards of quality and safety. Our projects are characterized by their impeccable finishing and durability.



Heritage Restoration

Specialized in the restoration and conservation of architectural and cultural heritage, our services include analysis, planning, and the execution of interventions that respect the history and identity of each building.

SoiTech, S.A. stands out as a leader in civil engineering consulting and construction, offering a wide range of services that encompass everything from mechanical engineering to the construction of projects from the ground up.

In the structural domain, we provide engineering and structural design, building assessment and intervention, structural pathology studies, and solutions for structural vulnerability.

In geotechnics, we offer high-quality soil engineering solutions, including soil studies, slope stability assessments, and analyses in our laboratory. Our pavement services cover the design, construction, maintenance, and repair of pavements, including special projects.

In the construction sector, we specialize in the execution of diverse projects, from buildings and roads to special initiatives. We apply Building Information Modeling (BIM) technology in all our projects to ensure efficient planning and execution, enhancing collaboration and guaranteeing accurate and cost-effective results.

Our Technical Excellence

Innovation



We apply the latest technologies and methods to achieve exceptional results.

Quality Control



Our rigorous processes ensure the highest quality in every project.

Technical Experience



We have a highly skilled interdisciplinary team.

Our Experience

We take pride in our experience across a wide range of projects, including:

- **Heritage Properties/Civil Works:** From planning to execution and supervision, we have a proven track record in the design and construction of civil works, including the conservation and restoration of heritage properties.
- **Historical and Archaeological Research:** Our team includes experts in historical and archaeological research, ensuring a comprehensive approach to each project.
- **Regulations and Legislation:** We are fully familiar with both Panamanian and international regulations and legislation, including UNESCO standards.
- **Architectural and Structural Assessment:** We offer detailed evaluation services to ensure the integrity and safety of structures.
- **Conservation and Restoration:** From material conservation to structural reinforcement, we are committed to preserving history and culture through our advanced restoration techniques.
- **Planning and Design:** We have a creative and experienced team in project planning and design, ensuring innovative and functional solutions.
- **Construction and Finishes:** Our technical capabilities include the construction of hydraulic and electrical systems, as well as the execution of high-quality finishes.

Our Commitment

At **SoiTech, S.A.**, we deeply value human capital. We have a multidisciplinary team of experts in design, architecture, engineering, restoration, and construction. Our highly qualified staff works in a coordinated manner to approach each project with a comprehensive focus, combining various areas of knowledge and expertise.

Engineers, architects, designers, restorers, and project managers come together to offer innovative and cutting-edge solutions that ensure technical excellence and the preservation of cultural heritage in each of our endeavors.

Commitment to Excellence

In Panama, our team of experts in design, architecture, and engineering stands out for their technical excellence and attention to detail. We apply the highest quality standards in every one of our projects, ensuring exceptional results that reflect the country's cultural and heritage richness. Our highly qualified professionals work in an integrated manner to provide innovative and sustainable solutions that respect the environment and meet the specific needs of our clients.



Vision

To become the recognized leader in design, architecture and engineering of high-impact construction projects.



Mission

To offer comprehensive construction and conservation solutions that transform the urban landscape and enrich the architectural culture.



Values

Integrity, excellence, innovation and collaboration guide our efforts to create a positive and lasting impact.



Additionally, we have a solid understanding of local regulations and standards, which allows us to successfully navigate the unique challenges and requirements of the construction industry in Panama. Our commitment to technical excellence is reflected in the quality and efficiency of each of our projects, positioning us as leaders in the design and construction sector in the country.

From iconic projects to specialized interventions, we are committed to exceeding our clients' expectations and contributing to the cultural and architectural enrichment of our community.

Commitment to Quality

Guarantee of Excellence. Our commitment to quality is reflected in every project we undertake. From design to construction, we implement rigorous quality controls to ensure that our works exceed our clients' expectations and meet the highest standards.



Highly Skilled Team. We have a team of experts in design, engineering, and construction who stay at the forefront of the latest techniques and technologies. Their dedication and specialized knowledge ensure the flawless execution of each project.

Premium Materials. We carefully select the best materials and suppliers to ensure the durability and reliability of our works. Our attention to detail and the quality of inputs are reflected in the excellence of the final results.

General Information

- Company Name: **SoiTech, S.A.**
- Foundation: April 2004
- NIT: 830139015 DV 1 | RUC: 155710852-2-2021 DV 86
- Start Date of Operations in CO: April 16, 2004
- Start Date of Operations in PA: August 16, 2021

Contact and More Information



For more details about our design and construction services, or to schedule a consultation with our team of experts, please feel free to contact us.

You can find us at our headquarters in Panama or contact us through our website or direct line. Our staff will be happy to answer all your questions and guide you through our project process. We also invite you to follow us on our social media to stay updated on our latest work and news.

Geotechnics | Structures | Pavements | Construction | Restoration



Civil Engineering | Master's in Structures | Master's in Geotechnics

T: +507 6564-7847 - +57 3158318542

soitech@hotmail.com | info@soitechco.com

www.soitechco.com