



**PDQ GLOBAL HOTELS & HOSPITALITY CENTRES – PRE BUILT STYLISH SOLUTIONS**





**PDQ Global pods are available in a range of contemporary designs and sizes and are a perfect solution for hotel construction for the tourism industry and pop-up usage for sporting events and music festivals. Our China factory partner, is the first company to introduce the concept of Space Capsule Modules and leads the trend of mobile micro-buildings, integrating comprehensive cultural and tourism development. We are focused on bringing ecology, science and technology as we strive to provide customers with better products and services, to become the leader in high-end holiday travel experiences and accommodation in the next few years. Our space capsules are equipped with every modern feature required by a discerning guest to ensure a comfortable and memorable stay. Al-fresco patio areas for that early breakfast or a pre concert cocktail, relaxing lounges, state of the art bathrooms and even washing machines and cooking hobs can be supplied and fitted.**



# SPACE CAPSULES – PRODUCT FEATURES

Ultra- quiet Design  
Double layer hollow  
tempered glass

Superior Corrosion  
Resistance.  
Aluminium outer plate

Ultra transparent  
Unobstructed visibility.  
Panoramic lighting

Highly mobile  
Ease of movability if  
required between sites.

Entire unit fitted  
with 'smart'  
intelligent system.

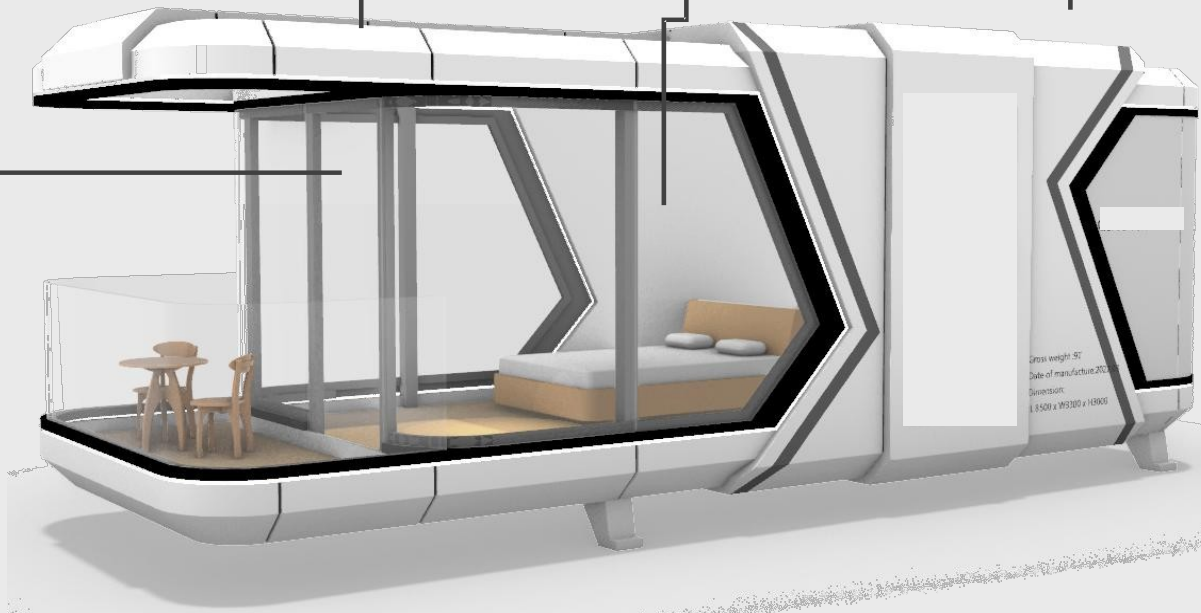

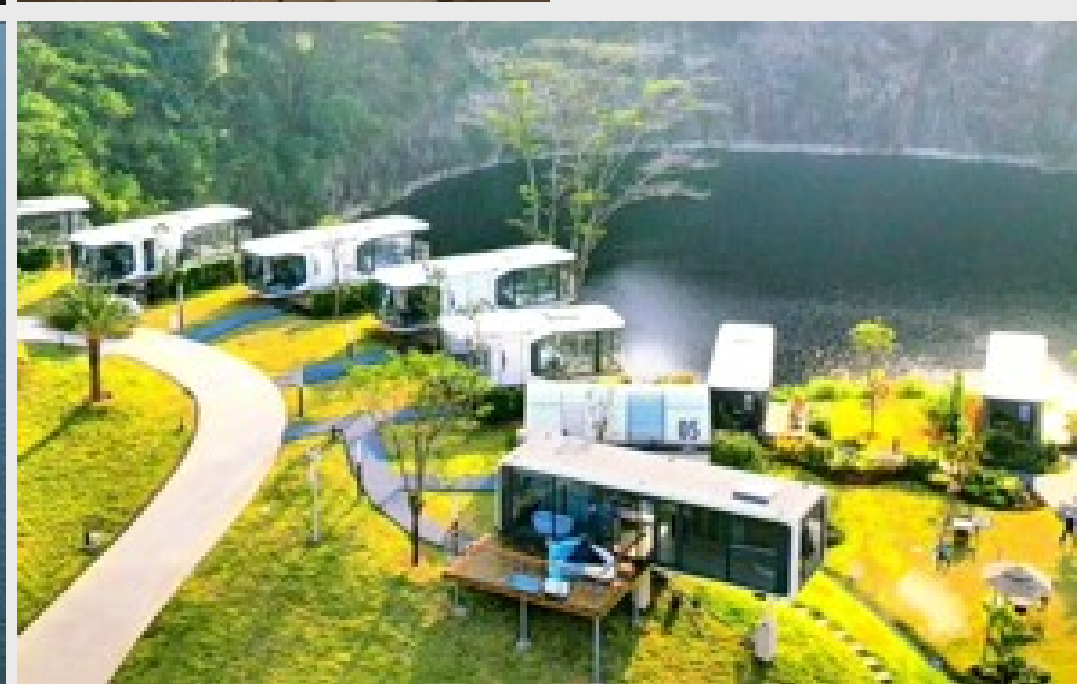
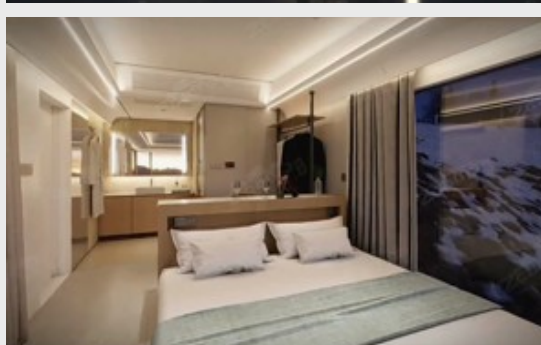



# SPACE CAPSULES – INTERNAL PRODUCT FEATURES



Internal Ambient  
Lighting LED Strip



Electrically operated  
Curtains – Control Box



Background Music  
Control Pad



Smart Controls Panel:  
Power - Lighting  
– Air Conditioning



# IN SITU RECENT INSTALLATIONS





# SPACE CAPSULE MODELS



**C70**

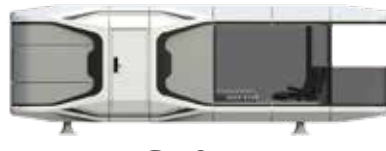

**C50**



**G80**



**V90**

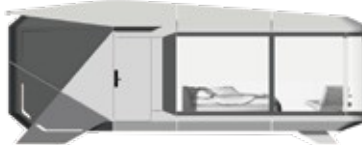

**V80**



**V30**

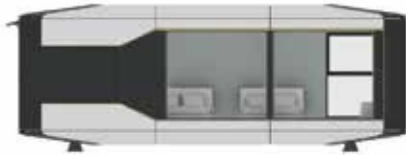

**A90**

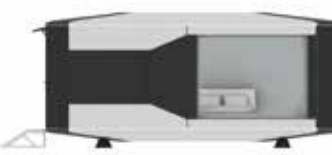

**A60**

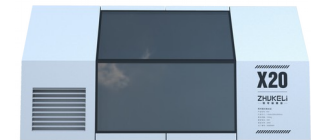

**X20**



**Q30**





**PDQ Global pods are safe & secure. We use the finest insulated materials for the main body construction and double glazed windows and external security doors. High quality wooden flooring, LED lighting and air conditioning are all fitted as standard. Electricity and water are available via connection to the local site utilities and solar power systems are also an option if required. Widescreen TVs can be fitted and stereo systems, and all electrical appliances supplied and fitted are of the highest quality and fully warranted and covered by the manufacturers guarantees. Showers, washbasins and toilets are of exceptional styling and are available in a range of colours if required. We hope that you enjoy the unique experience of your stay in a PDQ SPACE CAPSULE POD!**



# **Model: C70 – SPACE CAPSULE**

**Dimensions: Length: 11,500 \* Width: 3,300 \* Height: 3,400 Cms**

**Gross Weight: 9.5 Tons**

**Floor Area: 38m2**

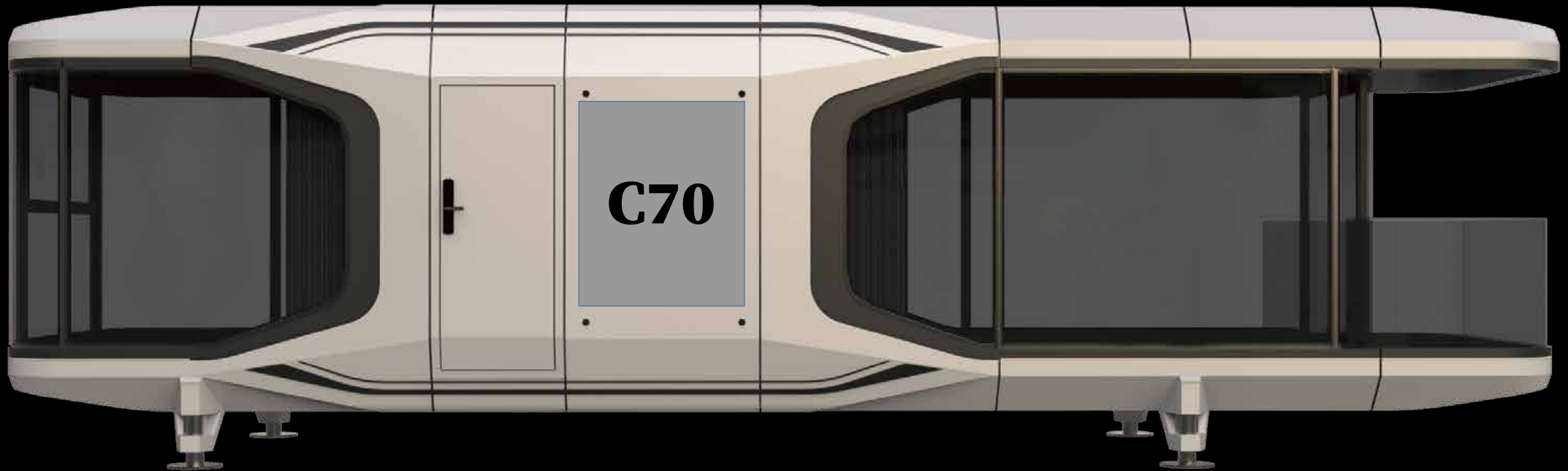

**Low energy consumption / Zero harmful emissions**

**Modular prefabrication integrated construction / Product Quality Assurance**

**Smooth and strong design lines / Spacious balcony / Floor to ceiling windows**

**High quality internal decoration and fixtures and fittings / Smart intelligent control system**

**Easily adjustable stabilising legs/feet / Ease of site installation and movability from site to site if required**

# Model: C70 – 38m2 Internal Living Space



## Standard Features:

Balcony

Electric Curtains

Air Conditioning

Smart Sound System

Atmospheric Lighting

Intelligent Toilet System

High Quality Laminate Flooring

Exterior High Quality Aluminium Panels

Complete Capsule Intelligent Control System

Ecological and Environmentally Safe Materials and Construction Methods



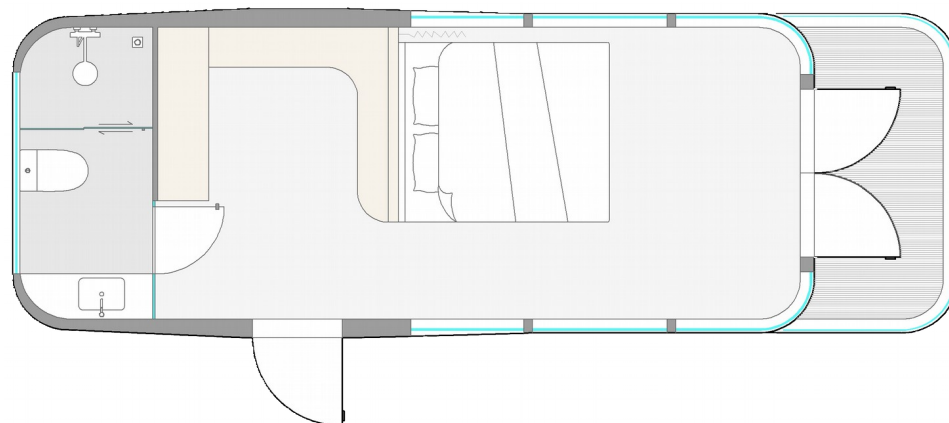
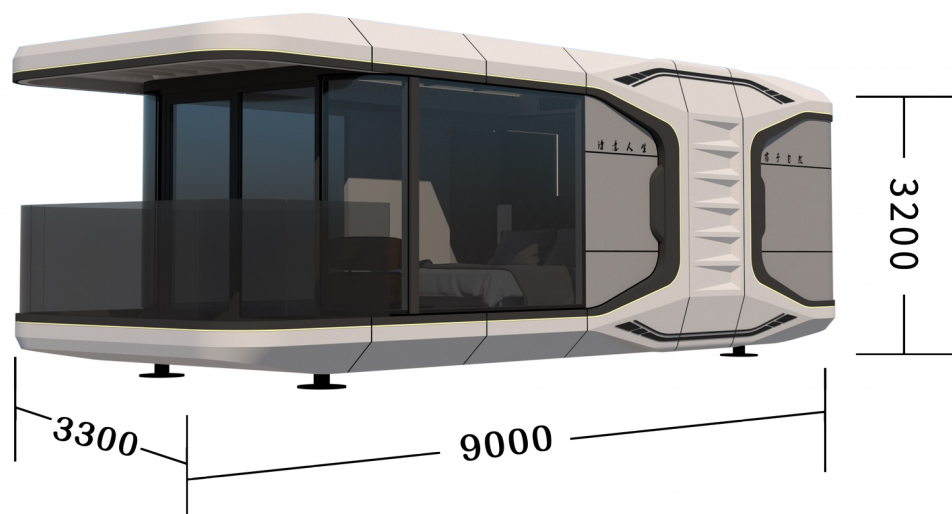
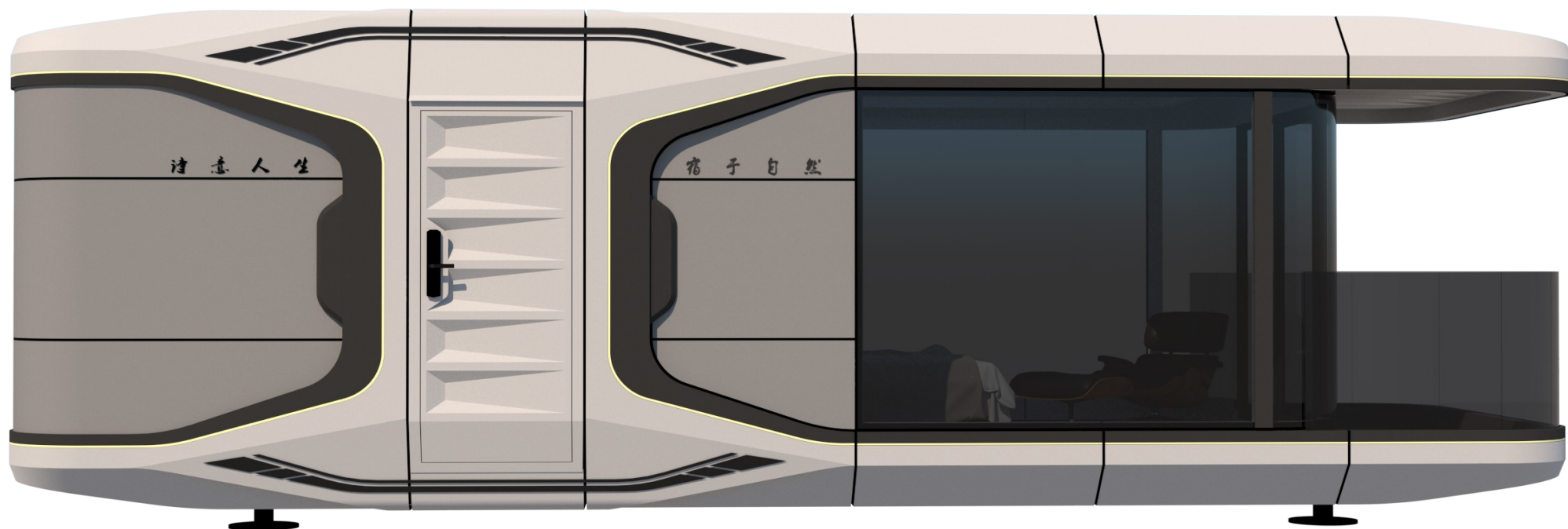

# Model: C70 – Specifications

	Basic Model Configuration	Standard Model Configuration	Deluxe Model Configuration
<b>Main Capsule Structure</b>	Steel structure frame.....exterior decoration panel.....(2.5 mms aluminium veneer...Polyurethane heat insulation layer + extruded Board. Exterior and skylight glass 6 + 12A+ 6 hollow low E glass..... Entrance door with intelligent access control.....Sliding balcony Door. Shishu standard adjustable feet & structure support.....	Steel structure frame.....Exterior decoration panel.....(3.0 mms aluminium veneer..... 100mms Polyurethane heat insulation layer + extruded board..... Exterior and skylight glass 6+12A 6 hollow low E glass.....Entrance door with intelligent access. Control Sliding balcony door..... Shishu standard adjustable feet, structure support	Steel structure frame.....Exterior decoration panel.....(3.0 mms aluminium veneer..... 100mms Polyurethane heat insulation layer + extruded board..... Exterior and skylight glass 6+12A 6 hollow low E glass.....Entrance door with intelligent access. Control Sliding balcony door..... Shishu standard adjustable feet, structure support
<b>Internal Configuration</b>	Ceiling and walls – Bamboo fibre - board. Composite wooden flooring LED downlights & room surround lighting. Electric curtains..... Exterior waterproof lighting effect Numerous wall power sockets.....	Ceiling and walls – High end Bamboo charcoal fibre - board. Composite wooden flooring. LED downlights and room surround Lighting. Voice controlled Electric curtains, lighting and background music..... Smoke detector & fire alarm.....Exterior waterproof lighting effect..... Numerous wall power sockets.....	Ceiling and walls – High end Bamboo charcoal fibre - board. Composite wooden flooring. LED downlights and room surround Lighting. Voice controlled Electric curtains, lighting and background music..... Smoke detector & fire alarm.....Exterior waterproof lighting effect..... Numerous wall power sockets....Aluminium living room cabinet, bed, mattress, sofa and coffee table
<b>Bathroom Hardware</b>	Shower, washbasin, toilet & faucet	Integrated hot water shower..... washbasin/vanity unit. Intelligent toilet & faucet	Integrated hot water shower..... washbasin/vanity unit. Intelligent toilet & faucet. Heated towel rail
<b>Equipment</b>	2 x wall- mounted 1.5P air conditioning units. 60 Ltr capacity water storage heater. 3 in 1 Bath - Master integrated control system	1 x wall - mounted 1.5P airduct air conditioning unit and 1 x 2P unit... 60 Ltr capacity water storage..... heater..... 3 in 1 Bath - Master integrated control system	1 x wall - mounted 1.5P airduct air conditioning unit and 1 x 2P unit... 60 Ltr capacity water storage..... heater..... 3 in 1 Bath - Master integrated control system..... Refrigerator & projector.....



# Model: C50 – SPACE CAPSULE

Dimensions: Length: 9,000 \* Width: 3,300 \* Height: 3,150 Cms

Floor Area: 30m2

Gross Weight: 7.0 Tons



The C50 Capsule continues the consistent design style and inspiration of the C70 and also has its own unique charm with thick texture, bright atmospheric colours, French windows, balcony and intelligent control systems, recreating the luxury usually only found in top star rated hotels around the world.



## C 50 Series – Space Capsule

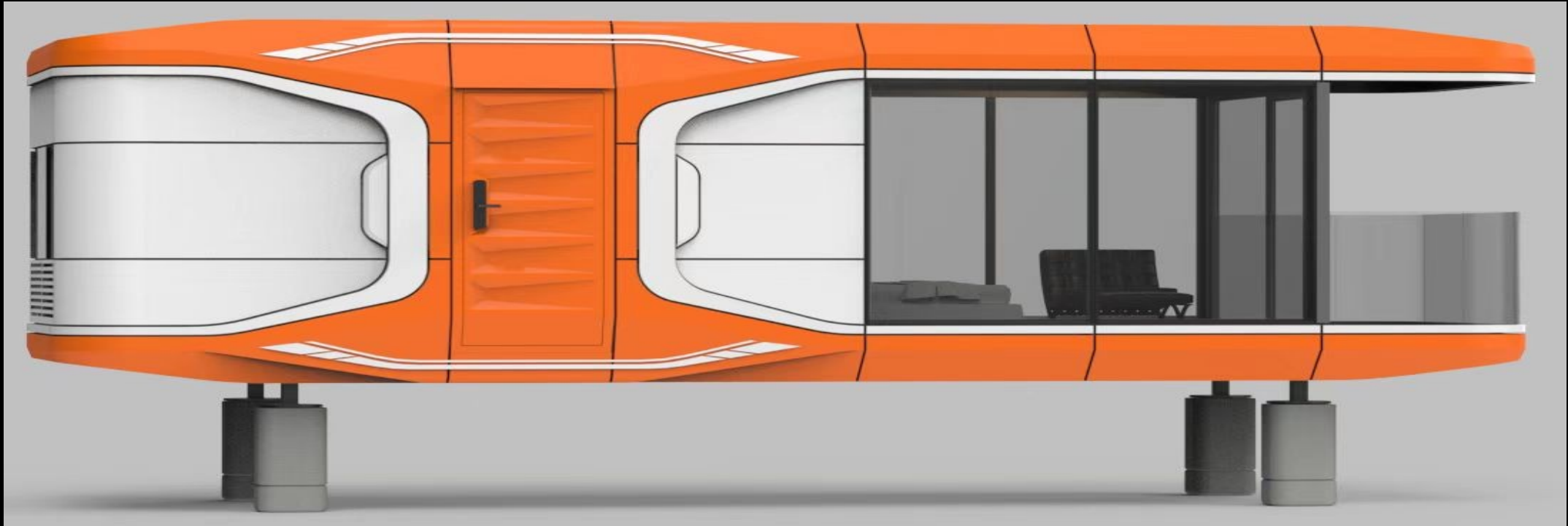



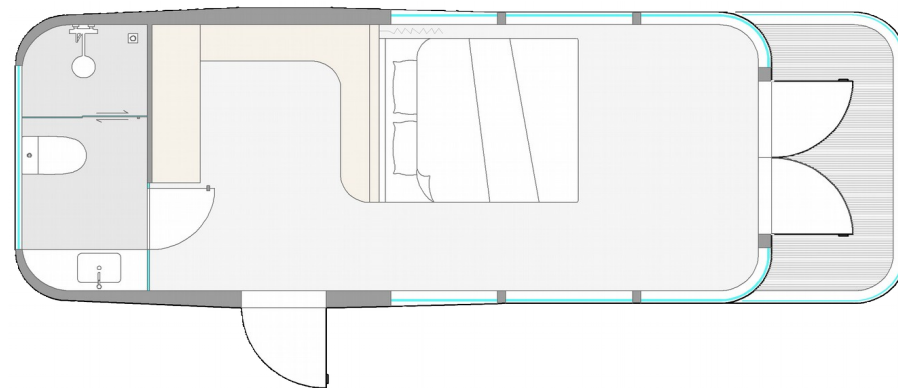
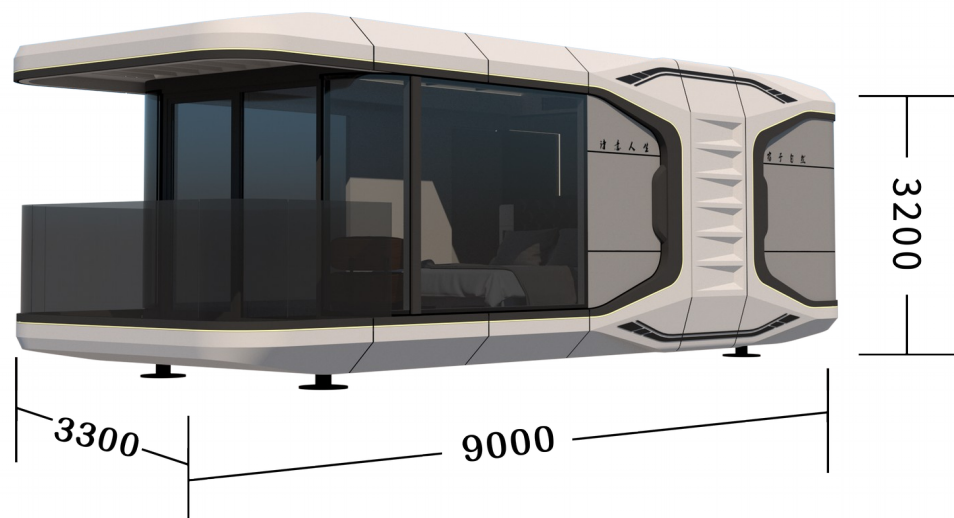
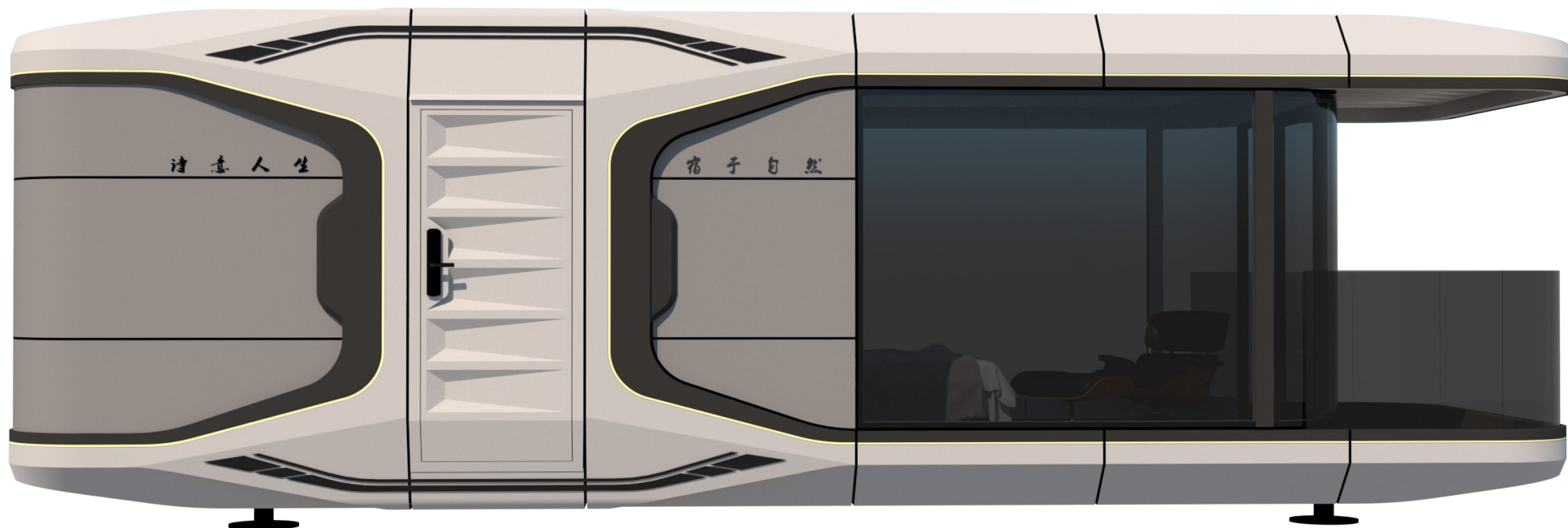

# Model: C50 – Specifications

	Basic Model Configuration	Standard Model Configuration	Deluxe Model Configuration
<b>Main Capsule Structure</b>	Steel structure frame.....exterior decoration panel.....(2.5 mms aluminium veneer...Polyurethane heat insulation layer + extruded Board. Exterior and skylight glass 6 + 12A+ 6 hollow low E glass..... Entrance door with intelligent access control.....Sliding balcony Door. Shishu standard adjustable feet & structure support.....	Steel structure frame.....Exterior decoration panel.....(3.0 mms aluminium veneer..... 100mms Polyurethane heat insulation layer + extruded board..... Exterior and skylight glass 6+12A 6 hollow low E glass.....Entrance door with intelligent access. Control Sliding balcony door..... Shishu standard adjustable feet, structure support	Steel structure frame.....Exterior decoration panel.....(3.0 mms aluminium veneer..... 100mms Polyurethane heat insulation layer + extruded board..... Exterior and skylight glass 6+12A 6 hollow low E glass.....Entrance door with intelligent access. Control Sliding balcony door..... Shishu standard adjustable feet, structure support
<b>Internal Configuration</b>	Ceiling and walls – Bamboo fibre - board. Composite wooden flooring LED downlights & room surround lighting. Electric curtains..... Exterior waterproof lighting effect Numerous wall power sockets.....	Ceiling and walls – High end Bamboo charcoal fibre - board. Composite wooden flooring. LED downlights and room surround Lighting. Voice controlled Electric curtains, lighting and background music..... Smoke detector & fire alarm.....Exterior waterproof lighting effect..... Numerous wall power sockets.....	Ceiling and walls – High end Bamboo charcoal fibre - board. Composite wooden flooring. LED downlights and room surround Lighting. Voice controlled Electric curtains, lighting and background music..... Smoke detector & fire alarm.....Exterior waterproof lighting effect..... Numerous wall power sockets....Aluminium living room cabinet, bed, mattress, sofa and coffee table
<b>Bathroom Hardware</b>	Shower, washbasin, toilet & faucet	Integrated hot water shower..... washbasin/vanity unit. Intelligent toilet & faucet	Integrated hot water shower..... washbasin/vanity unit. Intelligent toilet & faucet. Heated towel rail
<b>Equipment</b>	2 x wall- mounted 1.5P air conditioning units. 60 Ltr capacity water storage heater. 3 in 1 Bath - Master integrated control system	1 x wall - mounted 2P airduct air conditioning unit. 60 Ltr capacity water storage heater.....3 in 1 Bath - Master integrated control system	1 x wall - mounted 2P airduct air conditioning unit. 60 Ltr capacity water storage heater..... 3 in 1 Bath - Master integrated control system. Refrigerator.....and projector.....



# Model: G80 – SPACE CAPSULE

Dimensions: Length: 12,000 \* Width: 3,300 \* Height: 3,200 Cms

Floor Area: 42m<sup>2</sup>

Gross Weight: 9.5 Tons



The G80 creates a new flagship and era in design of Space Capsules. It integrates creativity and innovation and reduces complexity to simplicity.



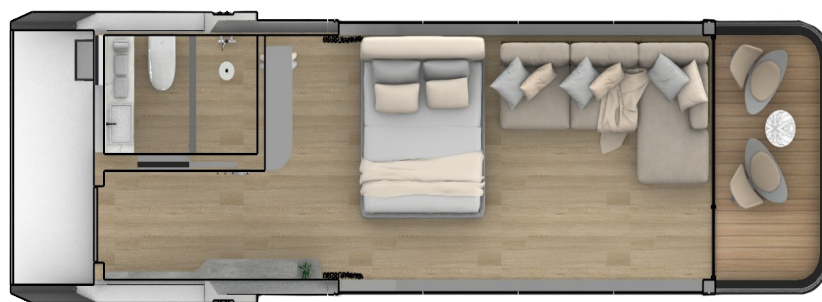
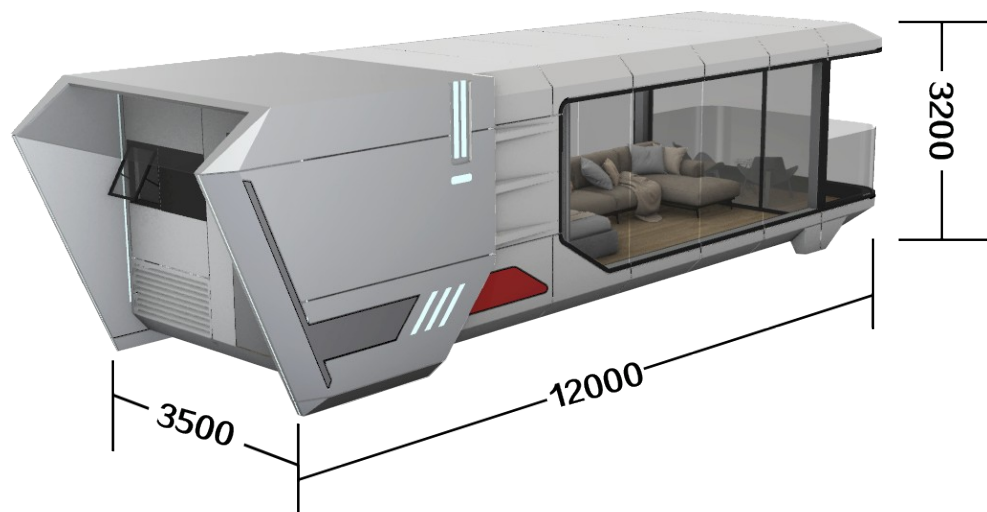
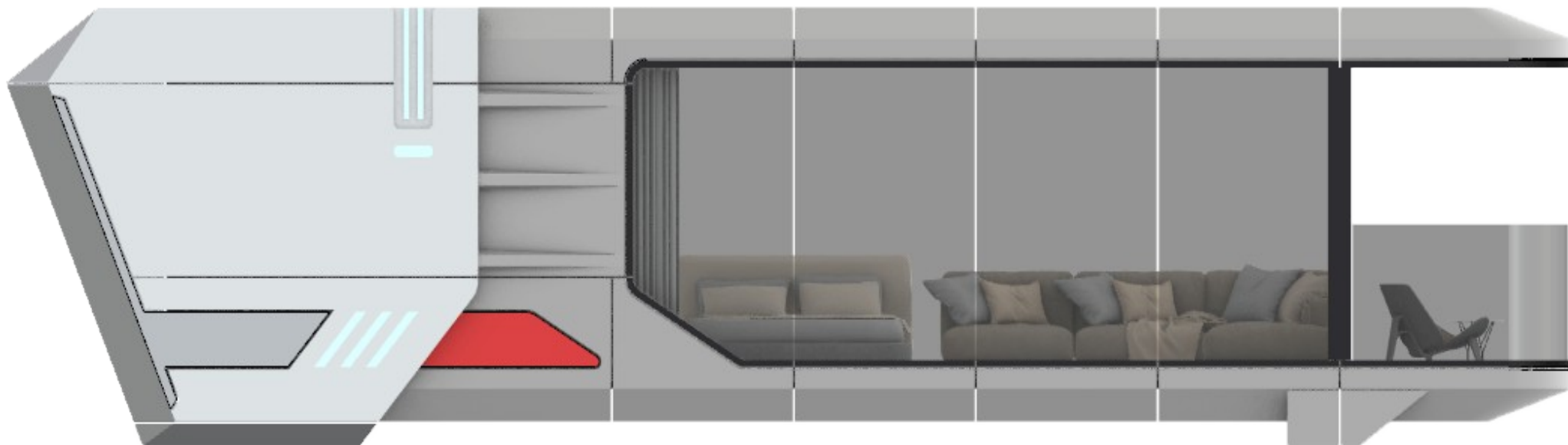



# Model: G80 – Specifications

	Standard Model Configuration	Deluxe Model Configuration
<b>Main Capsule Structure</b>	Steel structure frame. Exterior decoration panel (3.0 mms aluminium veneer..... 100mms Polyurethane heat insulation layer + extruded board...Exterior and skylight glass 6+12A 6 hollow low E glass. Entrance door with intelligent access. Control Sliding balcony door..... Shishu standard adjustable feet, structure support	Steel structure frame. Exterior decoration panel (3.0 mms aluminium veneer..... 100mms Polyurethane heat insulation layer + extruded board...Exterior and skylight glass 6+12A 6 hollow low E glass. Entrance door with intelligent access. Control Sliding balcony door..... Shishu standard adjustable feet, structure support
<b>Internal Configuration</b>	Ceiling and walls – High end Bamboo charcoal fibre - board. Composite wooden flooring.....LED downlights and room surround Lighting..... Voice controlled Electric curtains, lighting and background music. Smoke detector & fire alarm Exterior waterproof lighting effect.....Numerous wall power sockets.....	Ceiling and walls – High end Bamboo charcoal fibre - board. Composite wooden flooring.....LED downlights and room surround Lighting..... Voice controlled Electric curtains, lighting and background music. Smoke detector & fire alarm Exterior waterproof lighting effect.....Numerous wall power sockets.....Aluminium living room cabinet, bed, mattress, sofa and coffee table.....
<b>Bathroom Hardware</b>	Integrated hot water shower..... washbasin/vanity unit. Intelligent toilet & faucet	Integrated hot water shower..... washbasin/vanity unit. Intelligent toilet & faucet. Heated towel rail
<b>Equipment</b>	1 x wall - mounted 3P airduct air conditioning unit 60 Ltr capacity water storage heater..... 3 in 1 Bath - Master integrated control system.....	1 x wall - mounted 3P airduct air conditioning unit 60 Ltr capacity water storage heater..... 3 in 1 Bath - Master integrated control system..... Refrigerator & projector.....

# Model: V90 – SPACE CAPSULE

Dimensions: Length: 8,800 \* Width: 3,300 \* Height: 3,400 Cms

Floor Area: 29.7m<sup>2</sup>

Gross Weight: 7.0 Tons



The V90 is sculpted using simple lines of design enhancing the balance and depth of the overall shape, creating a striking appearance.





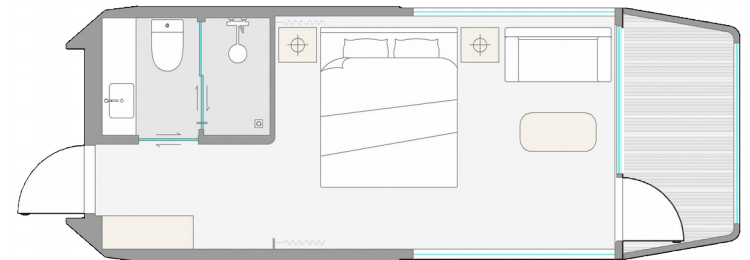
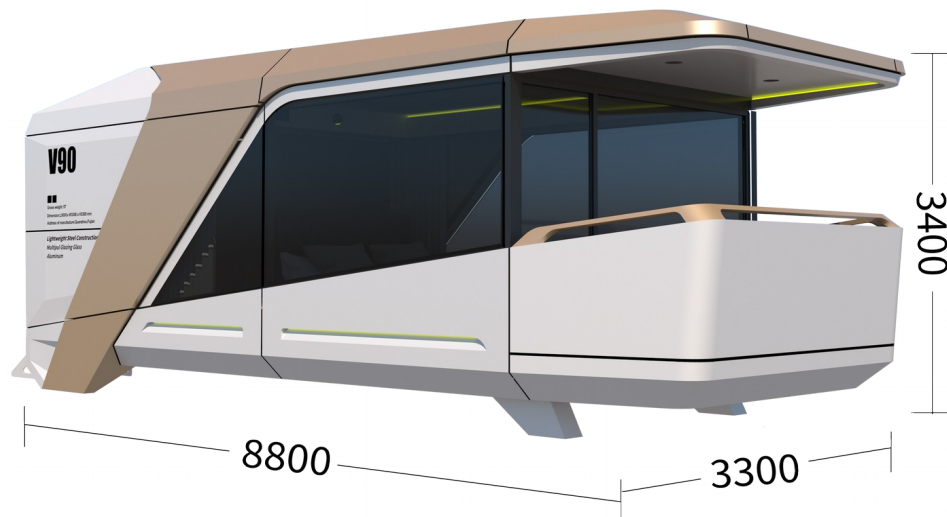
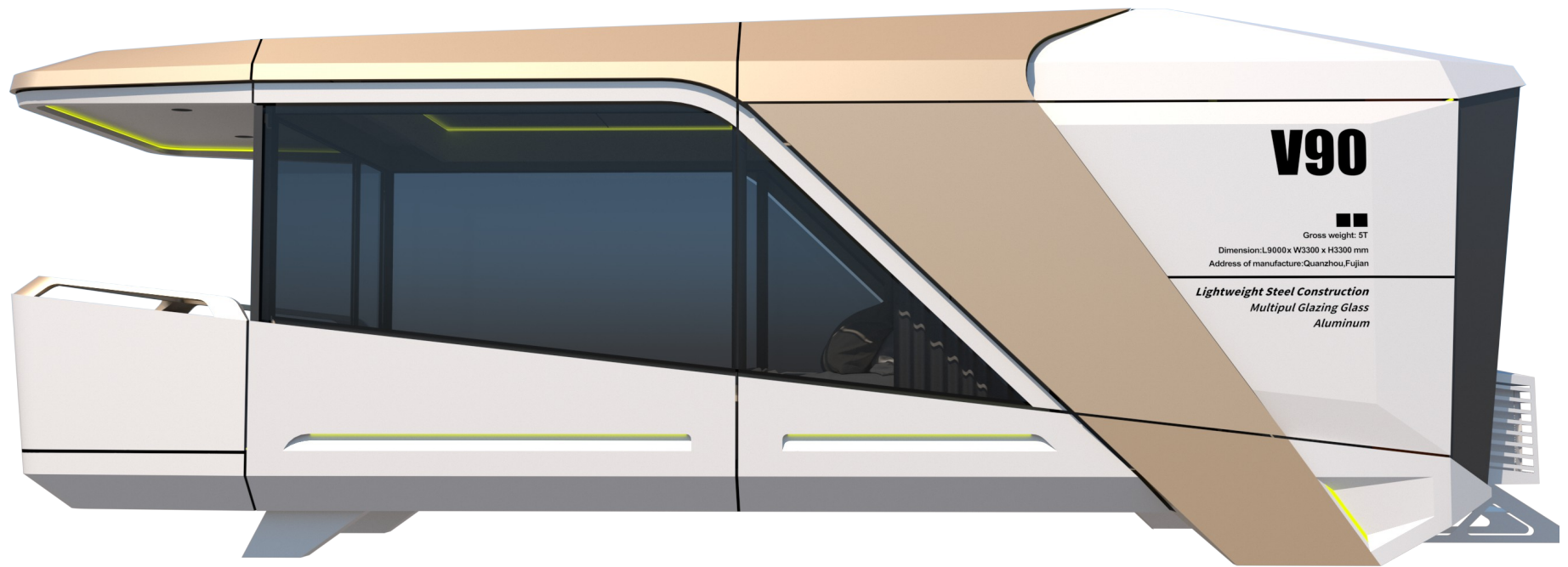

# Model: V90 – Specifications

	Standard Model Configuration	Deluxe Model Configuration
<b>Main Capsule Structure</b>	Steel structure frame. Exterior decoration panel (2.5 mms aluminium veneer..... Polyurethane heat insulation layer + extruded board...Exterior and skylight glass 6+12A 6 hollow low E glass. Entrance door with intelligent access. Shishu standard adjustable feet, structure support	Steel structure frame. Exterior decoration panel (3.0 mms aluminium veneer..... 100mms Polyurethane heat insulation layer + extruded board...Exterior and skylight glass 6+12A 6 hollow low E glass. Entrance door with intelligent access. Shishu standard adjustable feet, structure support
<b>Internal Configuration</b>	Ceiling and walls – High end Bamboo charcoal fibre - board. Composite wooden flooring.....LED downlights and room surround Lighting..... Voice controlled Electric curtains, lighting and background music. Smoke detector & fire alarm Exterior waterproof lighting effect.....Numerous wall power sockets.....	Ceiling and walls – High end Bamboo charcoal fibre - board. Composite wooden flooring.....LED downlights and room surround Lighting..... Voice controlled Electric curtains, lighting and background music. Smoke detector & fire alarm Exterior waterproof lighting effect.....Numerous wall power sockets.....Aluminium living room cabinet, bed, mattress, sofa and coffee table.....
<b>Bathroom Hardware</b>	Integrated hot water shower..... washbasin/vanity unit. Intelligent toilet & faucet	Integrated hot water shower..... washbasin/vanity unit. Intelligent toilet & faucet. Heated towel rail
<b>Equipment</b>	1 x wall - mounted 2P airduct air conditioning unit 60 Ltr capacity water storage heater..... 3 in 1 Bath - Master integrated control system.....	1 x wall - mounted 2P airduct air conditioning unit 60 Ltr capacity water storage heater..... 3 in 1 Bath - Master integrated control system..... Refridgerator & projector.....



# Model: V80 – SPACE CAPSULE

Dimensions: Length: 8,500 \* Width: 3,300 \* Height: 3,400 Cms

Floor Area: 26.4m<sup>2</sup>

Gross Weight: 6.5 Tons



The V80 is sculpted using simple lines of design enhancing the balance and depth of the overall shape, creating a striking appearance.



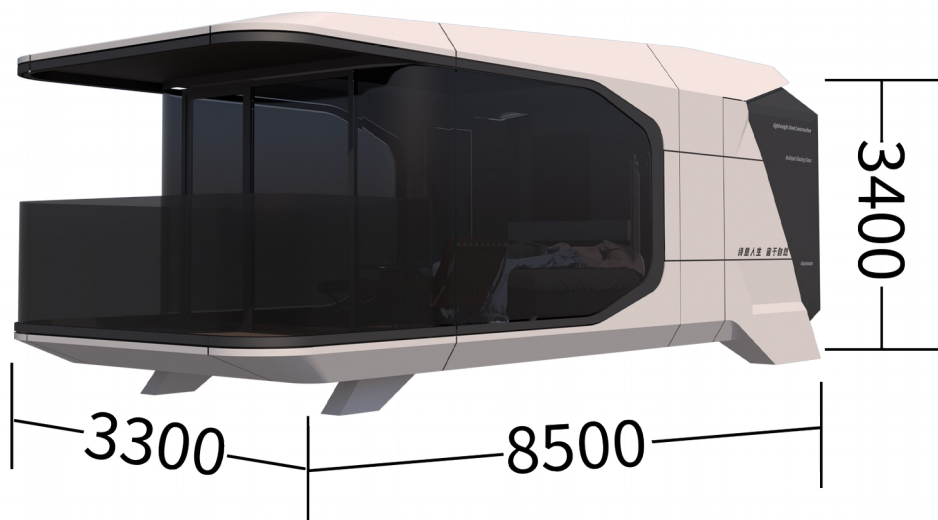
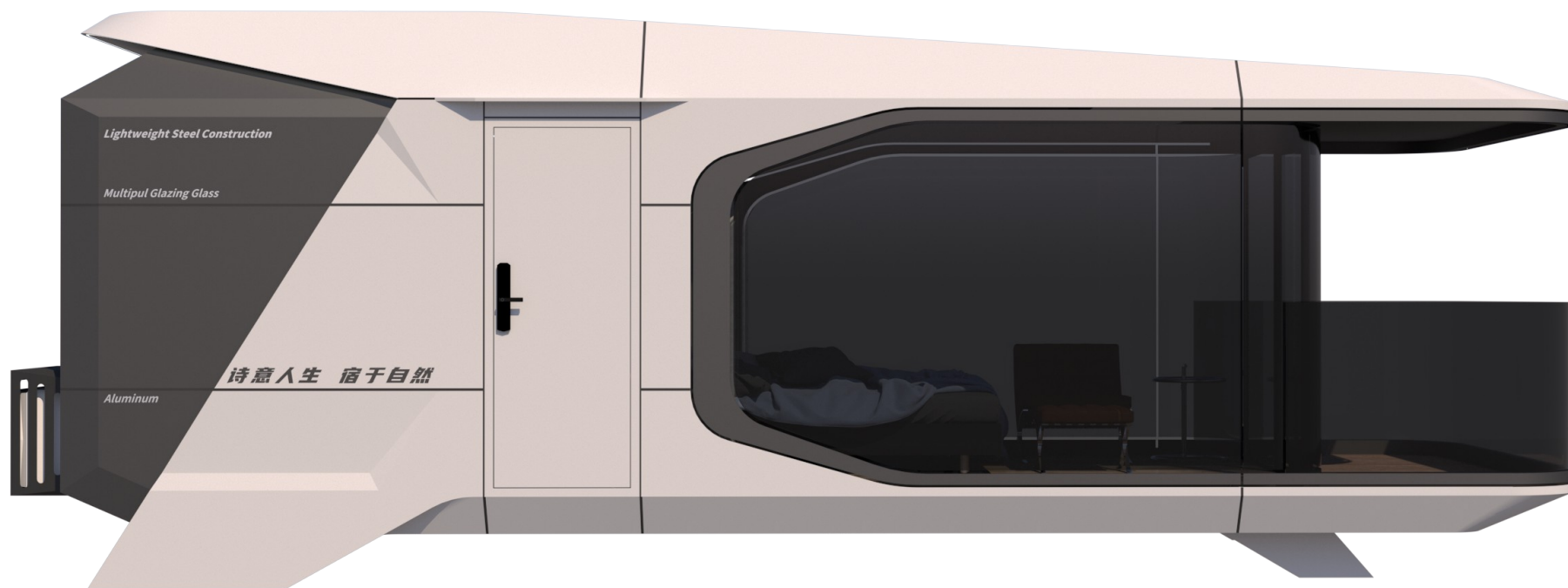



# Model: V80 – Specifications

	Standard Model Configuration	Deluxe Model Configuration
<b>Main Capsule Structure</b>	Steel structure frame. Exterior decoration panel (2.5 mms aluminium veneer..... Polyurethane heat insulation layer + extruded board...Exterior and skylight glass 6+12A 6 hollow low E glass. Entrance door with intelligent access. Shishu standard adjustable feet, structure support	Steel structure frame. Exterior decoration panel (3.0 mms aluminium veneer..... 100mms Polyurethane heat insulation layer + extruded board...Exterior and skylight glass 6+12A 6 hollow low E glass. Entrance door with intelligent access. Shishu standard adjustable feet, structure support
<b>Internal Configuration</b>	Ceiling and walls – High end Bamboo charcoal fibre - board. Composite wooden flooring.....LED downlights and room surround Lighting..... Voice controlled Electric curtains, lighting and background music. Smoke detector & fire alarm Exterior waterproof lighting effect.....Numerous wall power sockets.....	Ceiling and walls – High end Bamboo charcoal fibre - board. Composite wooden flooring.....LED downlights and room surround Lighting..... Voice controlled Electric curtains, lighting and background music. Smoke detector & fire alarm Exterior waterproof lighting effect.....Numerous wall power sockets.....Aluminium living room cabinet, bed, mattress, sofa and coffee table.....
<b>Bathroom Hardware</b>	Integrated hot water shower..... washbasin/vanity unit. Intelligent toilet & faucet	Integrated hot water shower..... washbasin/vanity unit. Intelligent toilet & faucet. Heated towel rail
<b>Equipment</b>	1 x wall - mounted 2P airduct air conditioning unit 60 Ltr capacity water storage heater..... 3 in 1 Bath - Master integrated control system.....	1 x wall - mounted 2P airduct air conditioning unit 60 Ltr capacity water storage heater..... 3 in 1 Bath - Master integrated control system..... Refrigerator & projector.....

# Model: V30 – SPACE CAPSULE

Dimensions: Length: 6,800 \* Width: 3,300 \* Height: 3,300 Cms

Floor Area: 22.5m2

Gross Weight: 5.0 Tons



The V30 is sculpted using simple lines of design enhancing the balance and depth of the overall shape, creating a striking appearance.





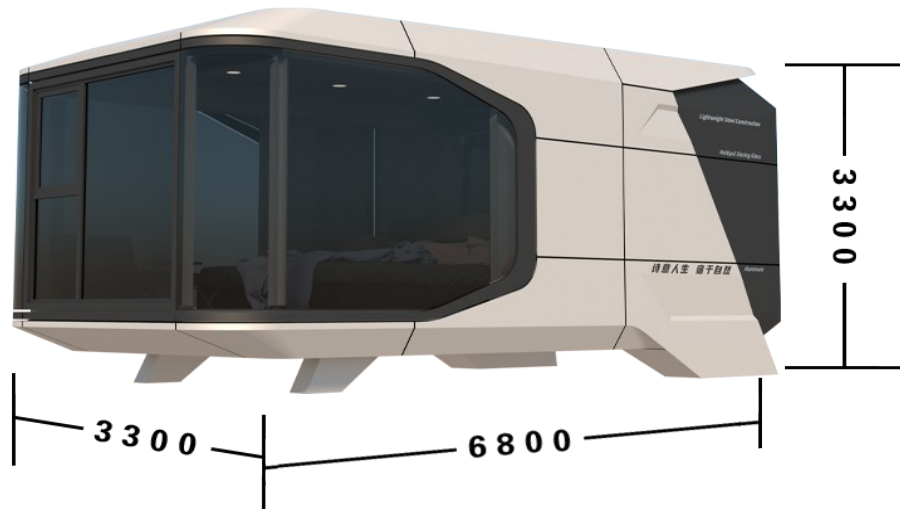
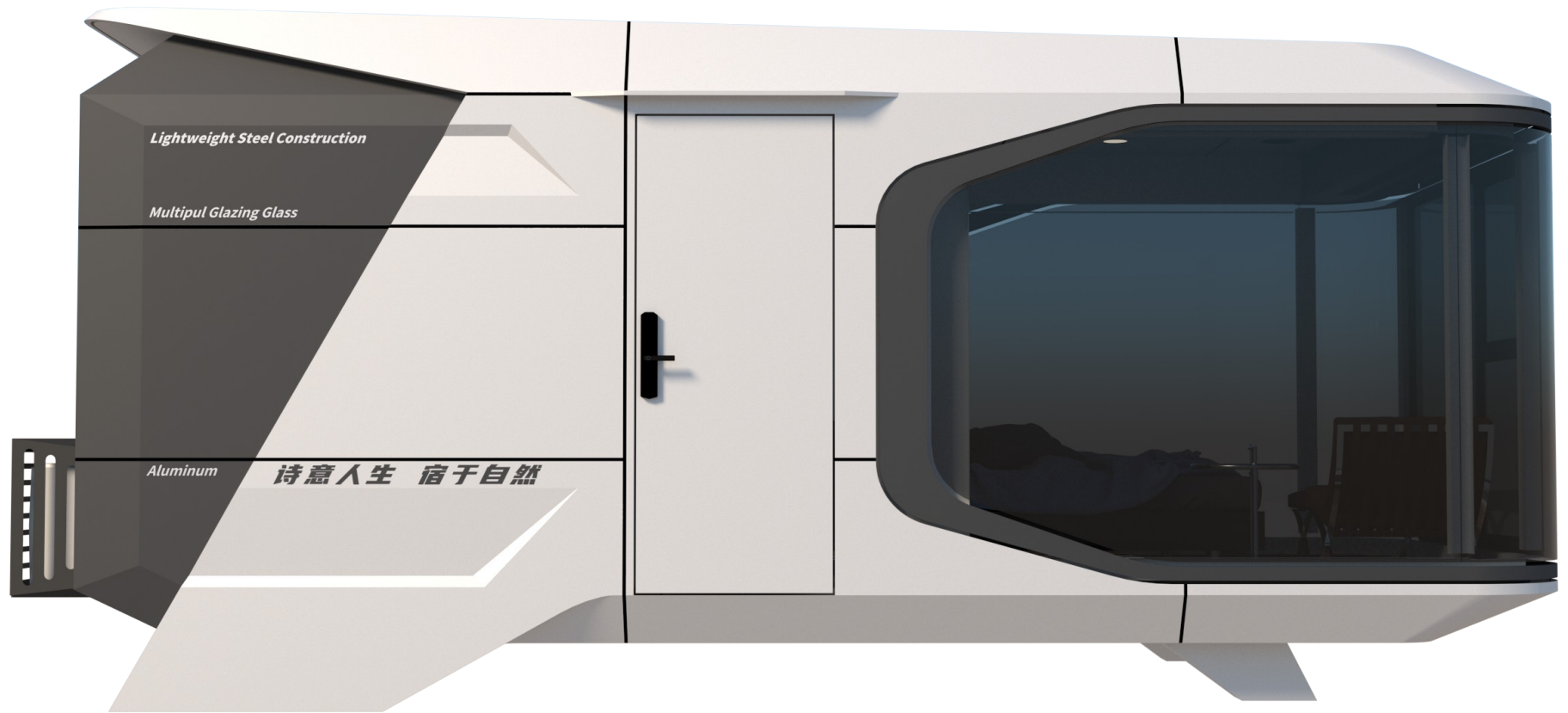

# Model: V30 – Specifications

	Standard Model Configuration	Deluxe Model Configuration
<b>Main Capsule Structure</b>	Steel structure frame. Exterior decoration panel (2.5 mms aluminium veneer..... Polyurethane heat insulation layer + extruded board...Exterior and skylight glass 6+12A 6 hollow low E glass. Entrance door with intelligent access. Shishu standard adjustable feet, structure support	Steel structure frame. Exterior decoration panel (3.0 mms aluminium veneer..... 100mms Polyurethane heat insulation layer + extruded board...Exterior and skylight glass 6+12A 6 hollow low E glass. Entrance door with intelligent access. Shishu standard adjustable feet, structure support
<b>Internal Configuration</b>	Ceiling and walls – High end Bamboo charcoal fibre - board. Composite wooden flooring.....LED downlights and room surround Lighting..... Voice controlled Electric curtains, lighting and background music. Smoke detector & fire alarm Exterior waterproof lighting effect.....Numerous wall power sockets.....	Ceiling and walls – High end Bamboo charcoal fibre - board. Composite wooden flooring.....LED downlights and room surround Lighting..... Voice controlled Electric curtains, lighting and background music. Smoke detector & fire alarm Exterior waterproof lighting effect.....Numerous wall power sockets.....Aluminium living room cabinet, bed, mattress, sofa and coffee table.....
<b>Bathroom Hardware</b>	Integrated hot water shower..... washbasin/vanity unit. Intelligent toilet & faucet	Integrated hot water shower..... washbasin/vanity unit. Intelligent toilet & faucet. Heated towel rail
<b>Equipment</b>	1 x wall – mounted 1.5P airduct air conditioning unit 60 Ltr capacity water storage heater..... 3 in 1 Bath - Master integrated control system.....	1 x wall - mounted 2P airduct air conditioning unit 60 Ltr capacity water storage heater..... 3 in 1 Bath - Master integrated control system..... Refrigerator & projector.....



# **Model: V90/80/30 – SPACE CAPSULES**



**The V90, V80 and V30 Space Capsules bring the ultimate experience in luxury accommodation wherever in the world a guest may be**

# Model: A90 & A60 – SPACE CAPSULES

Dimensions: Length: 9,000 / 6,600 \* Width: 3,300 / 3,300 \* Height: 3,300 / 3,150 Cms

Floor Area: 30m2 / 21.7m2

Gross Weight: 6.8 Tons / 4.8 Tons



Both the A90 and its smaller sister the A60, are minimalistic styled rectangular capsules, designed in a White & Grey colour scheme. The A90 has 3 floor to ceiling windows and a 3.12 meter skylight.

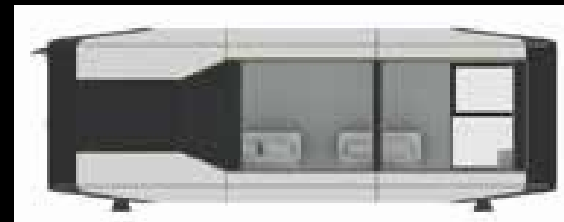



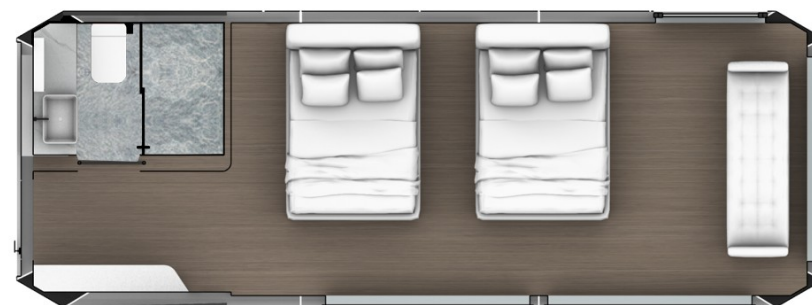
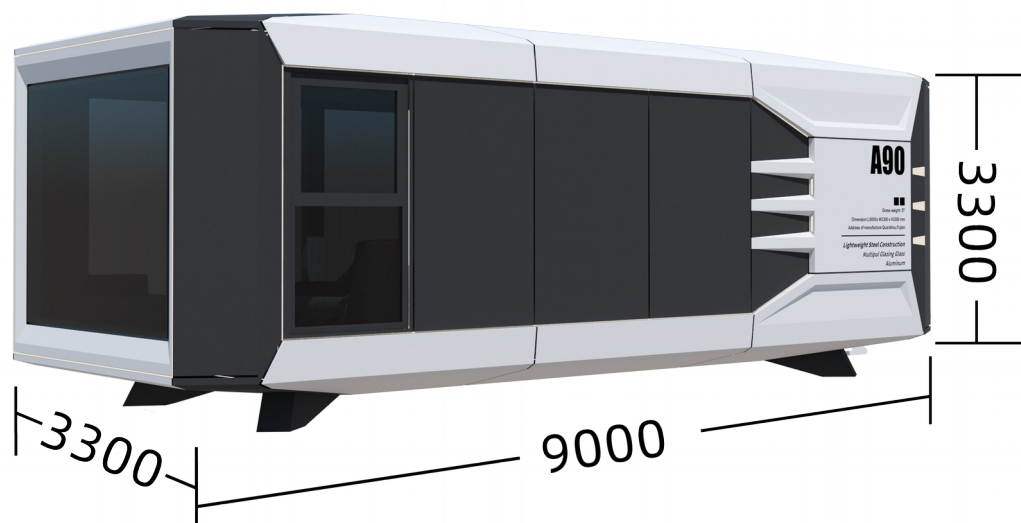
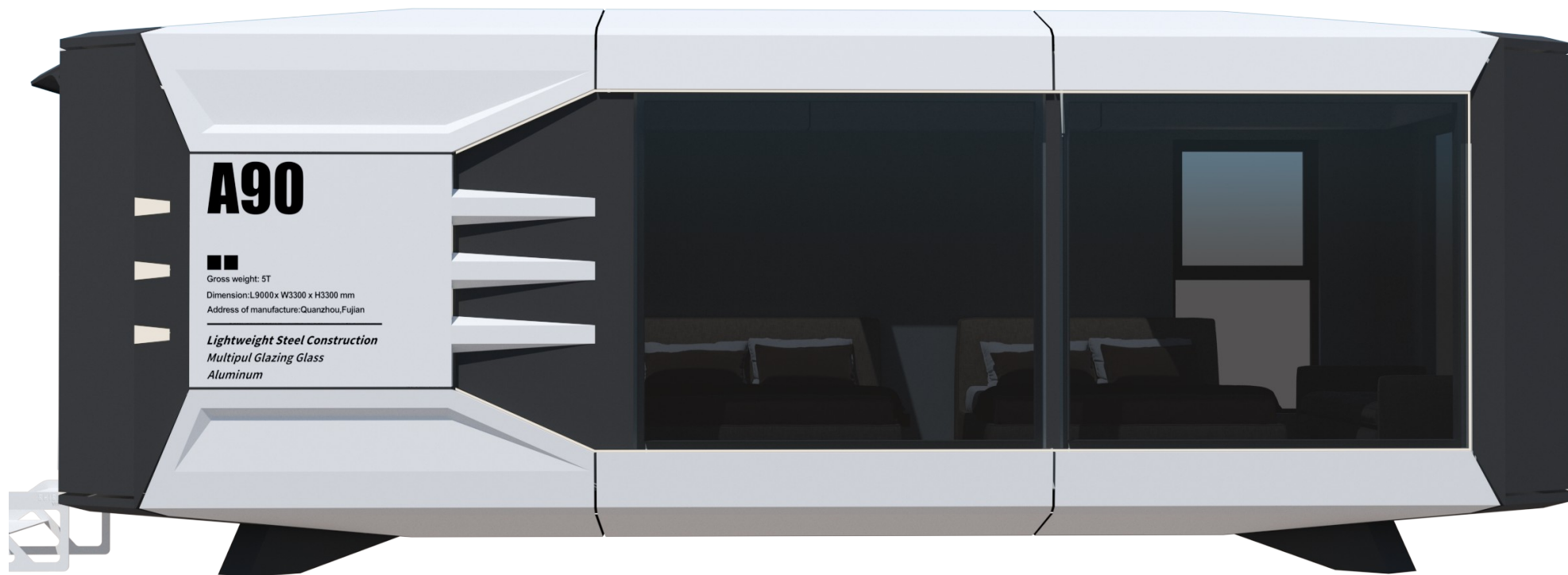

# Model: A90 – Specifications

	Standard Model Configuration
<b>Main Capsule Structure</b>	Steel structure frame. Exterior decoration panel (2.5 mms aluminium veneer..... Polyurethane heat insulation layer + extruded board...Exterior and skylight glass 6+12A 6 hollow low E glass. Entrance door with intelligent access. Shishu standard adjustable feet, structure support
<b>Internal Configuration</b>	Ceiling and walls – High end Bamboo charcoal fibre - board. Composite wooden flooring.....LED downlights and room surround Lighting. Voice controlled Electric curtains, lighting and background music. Smoke detector & fire alarm. Exterior waterproof lighting effect.....Numerous wall power sockets.....
<b>Bathroom Hardware</b>	Hot water shower..... washbasin/vanity unit. Intelligent toilet & faucet
<b>Equipment</b>	1 x wall – mounted 2.0P airduct air conditioning unit 60 Ltr capacity water storage heater..... 3 in 1 Bath - Master integrated control system.....





# Model: A60 – Specifications

	Standard Model Configuration
<b>Main Capsule Structure</b>	Steel structure frame. Exterior decoration panel (2.5 mms aluminium veneer.....100mm Polyurethane heat insulation layer + extruded board.....Exterior glass 6+12A+6 hollow low E glass. Skylight glass 5+5+12A+6 hollow laminated low E grade. Entrance door with intelligent access. Shishu standard adjustable feet, structure support
<b>Internal Configuration</b>	Ceiling and walls – High end Bamboo charcoal fibre - board. Composite wooden flooring.....LED downlights and room surround Lighting. Voice controlled Electric curtains, lighting and background music. Smoke detector & fire alarm. Exterior waterproof lighting effect.....Numerous wall power sockets.....
<b>Bathroom Hardware</b>	Hot water shower..... washbasin/vanity unit. Intelligent toilet & faucet
<b>Equipment</b>	1 x wall – mounted 2P airduct air conditioning unit 60 Ltr capacity water storage heater..... 3 in 1 Bath - Master integrated control system.....

# Model: X20 +(X30) – SPACE CAPSULES

Dimensions: Length: 6,600 \* Width: 3,300 \* Height: 3,200 Cms

Floor Area: 30m<sup>2</sup>

Gross Weight: 7.0 Tons



The X20 and it's slightly larger sister the X30, are rectangular capsules, with sloping roof lines, in a White & Grey colour scheme. Both models have floor to ceiling windows and an integral exterior . seating area .



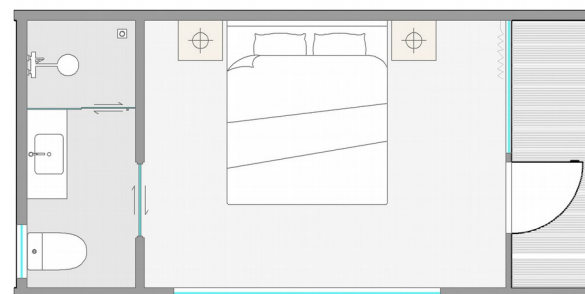
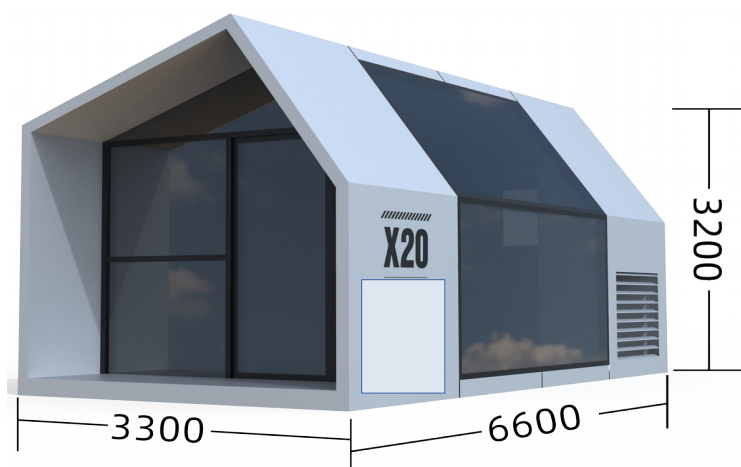



# Model: A60 – Specifications

	Standard Model Configuration
<b>Main Capsule Structure</b>	Steel structure frame. Exterior decoration panel (2.5 mms aluminium veneer.....100mm Polyurethane heat insulation layer + extruded board....Exterior glass 6+12A+6 hollow low E glass. Skylight glass 5+5+12A+6 hollow laminated low E grade. Entrance door with intelligent access. Shishu standard adjustable feet, structure support
<b>Internal Configuration</b>	Ceiling and walls – fibre - board. Composite wooden flooring.....LED downlights and room surround lighting. Smoke detector & fire alarm. Exterior waterproof lighting effect.....Numerous wall power sockets.....
<b>Bathroom Hardware</b>	Hot water shower..... washbasin/vanity unit. Intelligent toilet & faucet
<b>Equipment</b>	1 x wall – mounted 2P airduct air conditioning unit 60 Ltr capacity water storage heater..... 3 in 1 Bath - Master integrated control system.....

# Model: Q30 – SPACE CAPSULE

Dimensions: Length: 6,600 \* Width: 3,300 \* Height: 3,150 Cms

Floor Area: 21.7m<sup>2</sup>

Gross Weight: 4.8 Tons



The Q30 is a minimalistic styled rectangular capsule, designed in a White & Grey colour scheme, with a sloping roof bringing an elegant exterior appearance.



# Model: Q30 – SPACE CAPSULE



The Q30 interiors are stylishly fitted with high quality laminate flooring and panelled ceiling. Floor to ceiling windows and a large skylight. Smart lighting and sound systems, intelligent toilets, air-conditioning and all the facilities required and expected from a top rated hotel but within the confines of a guest's own Space Capsule, ensuring either a weekend break or longer stay remains an unforgettable experience.







PDQ Global pods are protected by in excess of 30 invention, utility model & appearance Patents and are easy to ship and install on a customers final destination site. Shipping and local delivery to site can be arranged if required, even to what may appear to be the most.....



.....Challenging of locations!

# Transportation & Installation:

PDQ can, if required, arrange both the overseas shipping and transportation to the Capsules final destination site.

A standard delivery truck is a 13.5m in length semi-trailer, with a width of 3.0m. The overall height does not exceed 4.2m, therefore allowing the vehicles to travel without restriction on local roads. A crane is required at site, which must be arranged by the local on-site installation team and this is recommended to have a lifting capacity of 25 tons. The weight of the Capsules is between 6 & 10 tons depending on model.

Prior to placement, the load bearing foundations guidelines supplied in our standard foundation technical drawings must be followed and the on site required utilities, water, electricity & sewage installation must be completed and the Capsule precisely positioned for connection of both the water & electricity. Utilities testing must be completed prior to sign off and customer satisfaction.

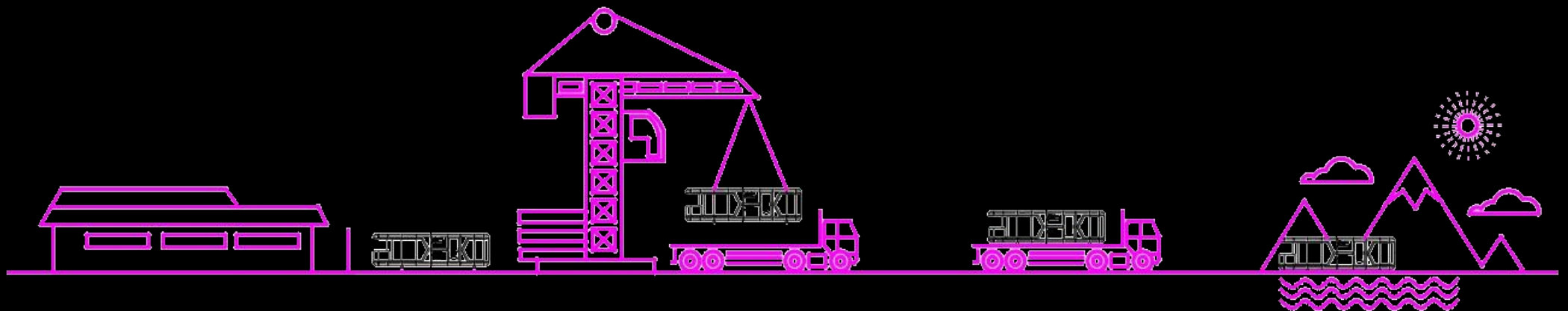

# Contact Us:



**Peter Hurst**

**Mobile: + 44 (0) 7743 948674 (UK)**  
**Whatsapp: + 852 93073664 (Hong Kong)**

**Email: [peterhurstdq@gmail.com](mailto:peterhurstdq@gmail.com)**

**Hong Kong Office: UNITS 2804-7. 28<sup>th</sup> FLOOR, MAN YEE BUILDING,  
68 DES VOEUX ROAD CENTRAL, HONG KONG.**

**Head Office: WICKHAMS CAY II, ROAD TOWN, TORTOLA  
VG1110, BRITISH VIRGIN ISLANDS.**

**[WWW.PDQ-GLOBAL.COM](http://WWW.PDQ-GLOBAL.COM)**

