

Specs

Robox

ROBOX™ Navigation System

Temi's human-robot interaction and autonomous navigation

2D Mapping

3D Localization

Navigation

User detection and tracking

Obstacle avoidance

Path planning

CPU

ARM Hexa Core

LINUX OS

Sensors

360 degrees LIDAR

2 depth cameras

RGB camera

IMU sensor

6 Time of Flight linear sensors

Fully-Autonomous Navigation with accuracy of 5cm/2Inches

Navigation and Human Follow mode without the need of any external device.

Real-time sensor fusion and data analysis ensures safe

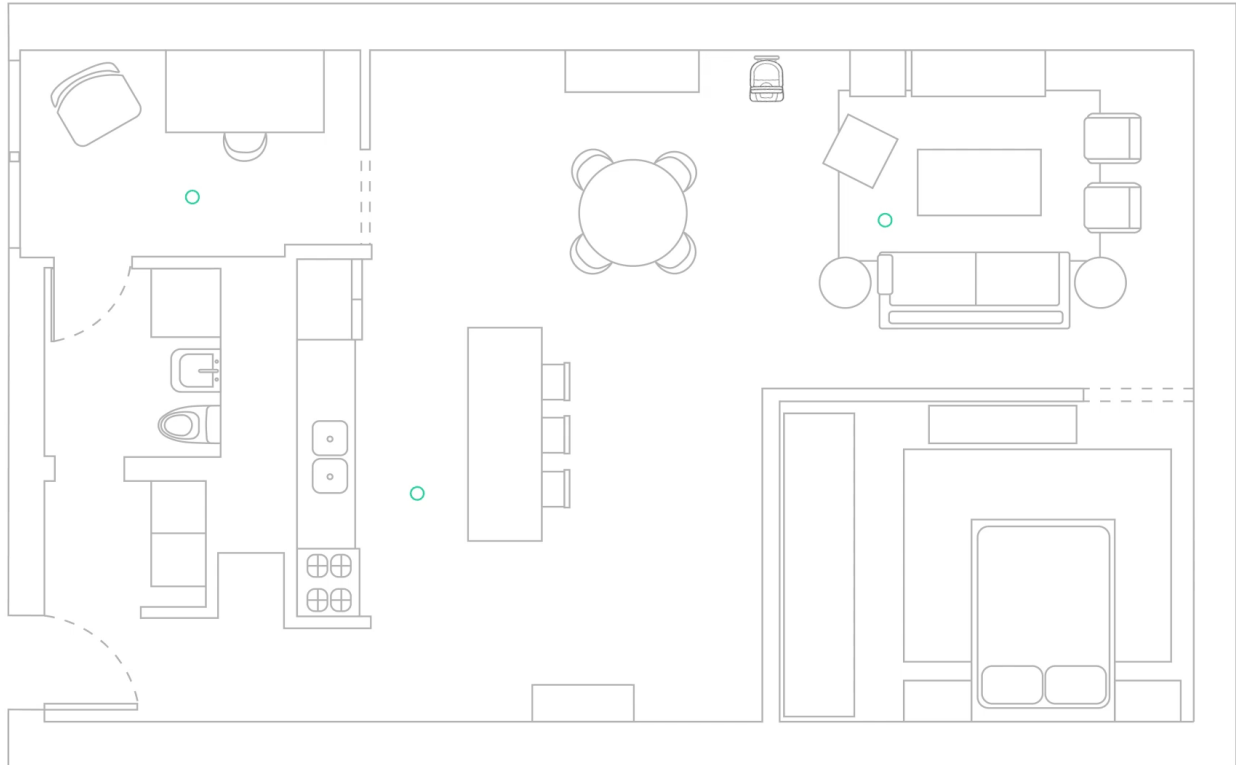

TEMI OS

Super intuitive operating system that comes, hears, speaks, sees and understands you, and is always learning how to serve you better

Temi center – Online management system for centralized control and customization

<https://center.robotemi.com/>

Voice interaction

temi hears, identifies, understands and responds to the user's voice using Auto Speech Recognition (ASR) and far field voice technology, natural language processing (NLP), speech-to-text and text-to-speech (TTS) engines

User Interface

temi's designed display enhances your experience with visuals that invite you to speak, hear and see what you want – creating the ultimate human-robot interaction

AI

temi integrates the best AI engines together to connect you to your favorite services. It's navigation system self-learns it's surroundings and understands where temi is, what it is seeing and where it is going.

Facial recognition supported

Open to 3rd party apps

Full SDK Available for 3rd party apps development and deployment

Security

Top security measures and protocols.

Protected by Firedome IOT security.



Built in Apps

Built in and and Temi Designated App Store, with Apps available from global developers



AI Assistant



Be home



Video calls



Personal DJ



Developers



Personal photographer



Personal Caddy



Home hub



Entertainment

Connectivity

wifi

WIFI 5 (802.11 a/b/g/n/ac with both 2.4G/5G)

Bluetooth

V5.1 BLE compatible Master and slave modes

USB

1 USB 3.0 port TYPE-C, 1 USB 2.0 port TYPE-A Supports 4G USB dongle

Supports external USB camera

Supports common USB devices

Cellular (optional)

Cellular network SIM slot 4G/5G support

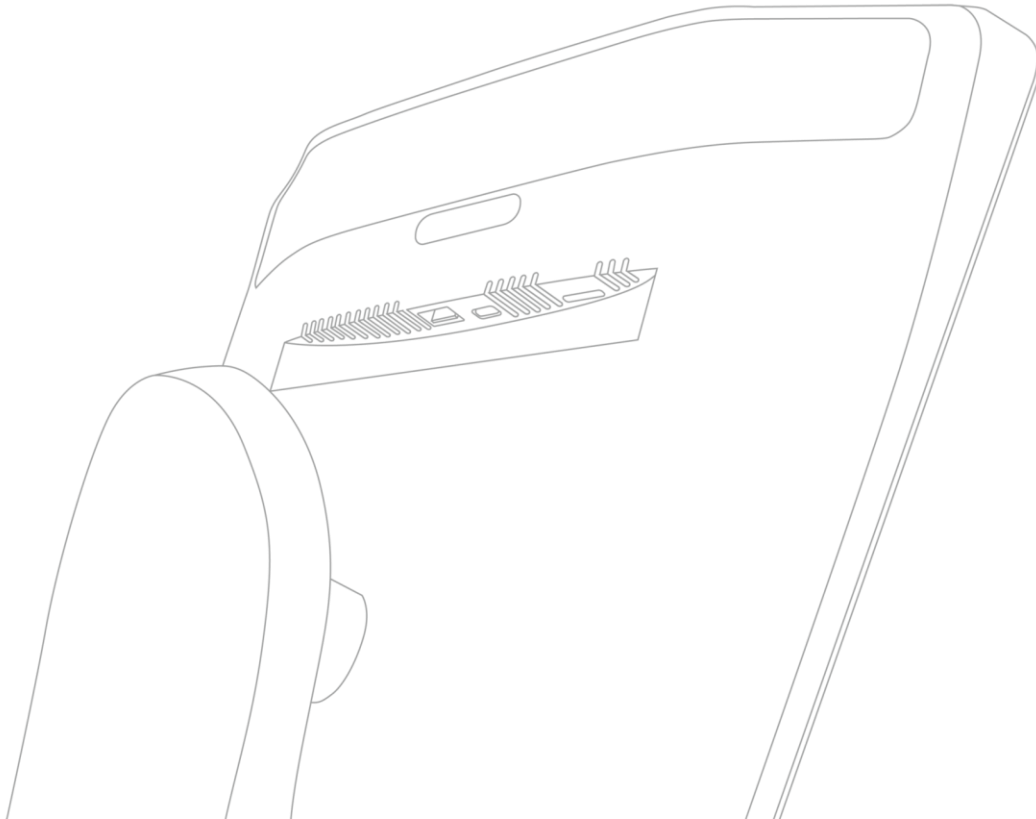

Dimensions

Size

(ft.) 3.2H x 1.1W x 1.5D

(cm.) 100H x 35W x 45D

Weight

26 lbs / 12 kg

DISPLAY

13.3" (H293.76 / V 165.24)

Capacitive multi-touch for intuitive interface. (1920X1080) IPS LCD 16M colors Touch

Capacity Display Pixel density: 224 (ppi)

340 cd/m2 max brightness (typical)

Fingerprint-resistant coating



Screen Tilt

Autonomous face tracking screen tilt

Brushless DC motor with planetary gear for high accuracy and quiet operation

Motion range – 15°~+55°

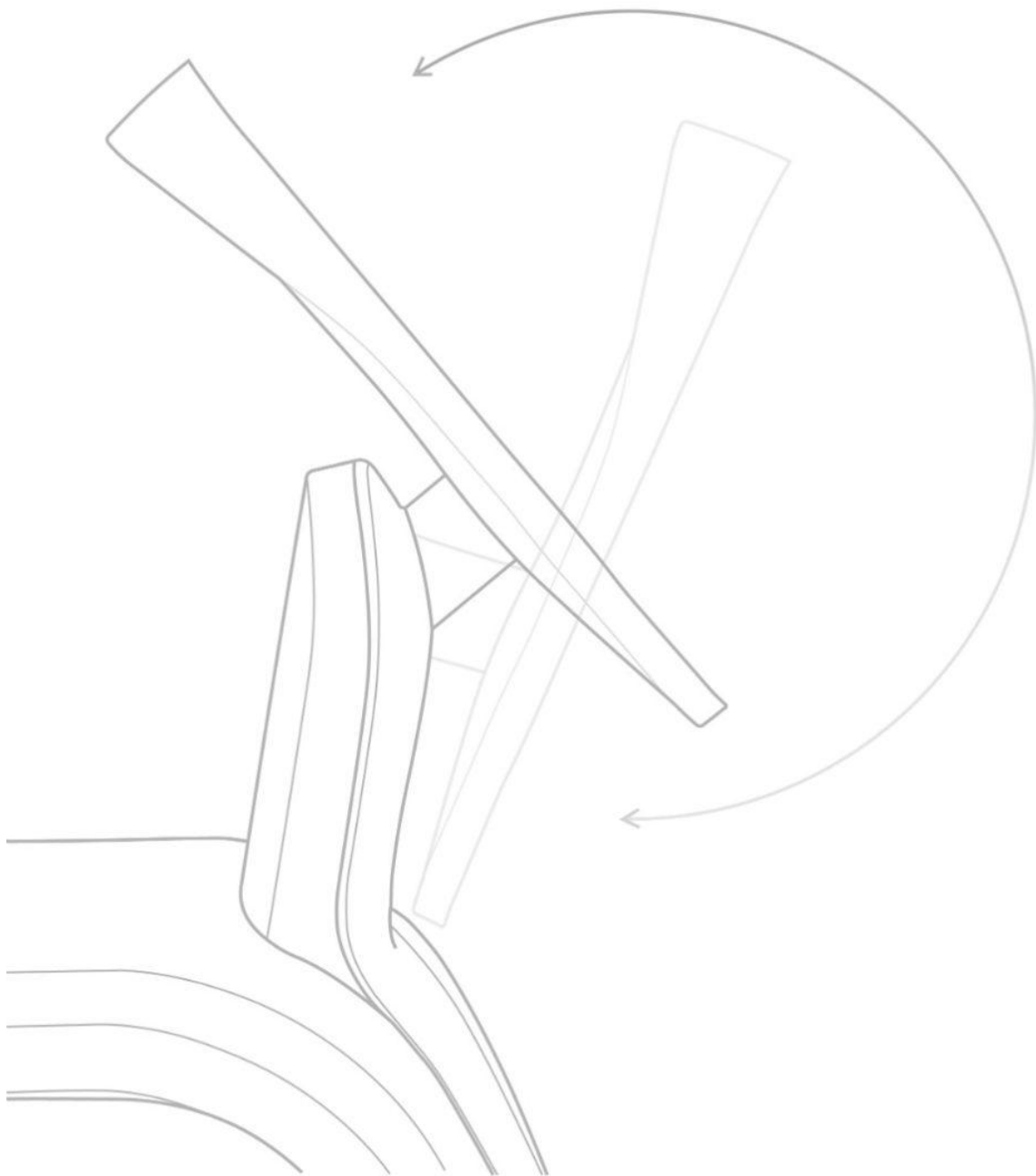

Mics

Microphone Array

4 Omni-directional digital mics

Real-time localization

Beam forming

Acoustic echo cancellation

Environment noise reduction

Audio

20W Audio

High fidelity equalizer

One sub-woofer

Two midrange speakers

Two tweeters

Passive radiators

Acoustically transparent fabric

CAMERAS

13 MP high resolution camera

Autofocus

1080p@30FPS

FOV 120 Degrees

5-Element lens

Hybrid IR filter

Digital Zoom

TOF Depth Camera

30 FPS

Up to 5 meters

90° FOV

CPU

CPU 1

Dual-core Cortex-A72 1.8GHz

Quad-core Cortex-A53 1.4GHz

Operation System

Human interaction computer based on Android 11 architecture with proprietary launcher and User Interface

CPU 2

Dual-core Cortex-A72 1.8GHz

Quad-core Cortex-A53 1.4GHz

Main navigation computer based on ARM architecture, enabling high performance with minimal power consumption

Power

Up to 8 Hours of operation per charge

Autonomous charging- 220V/110V

High performance docking station

Lithium-Ion cells

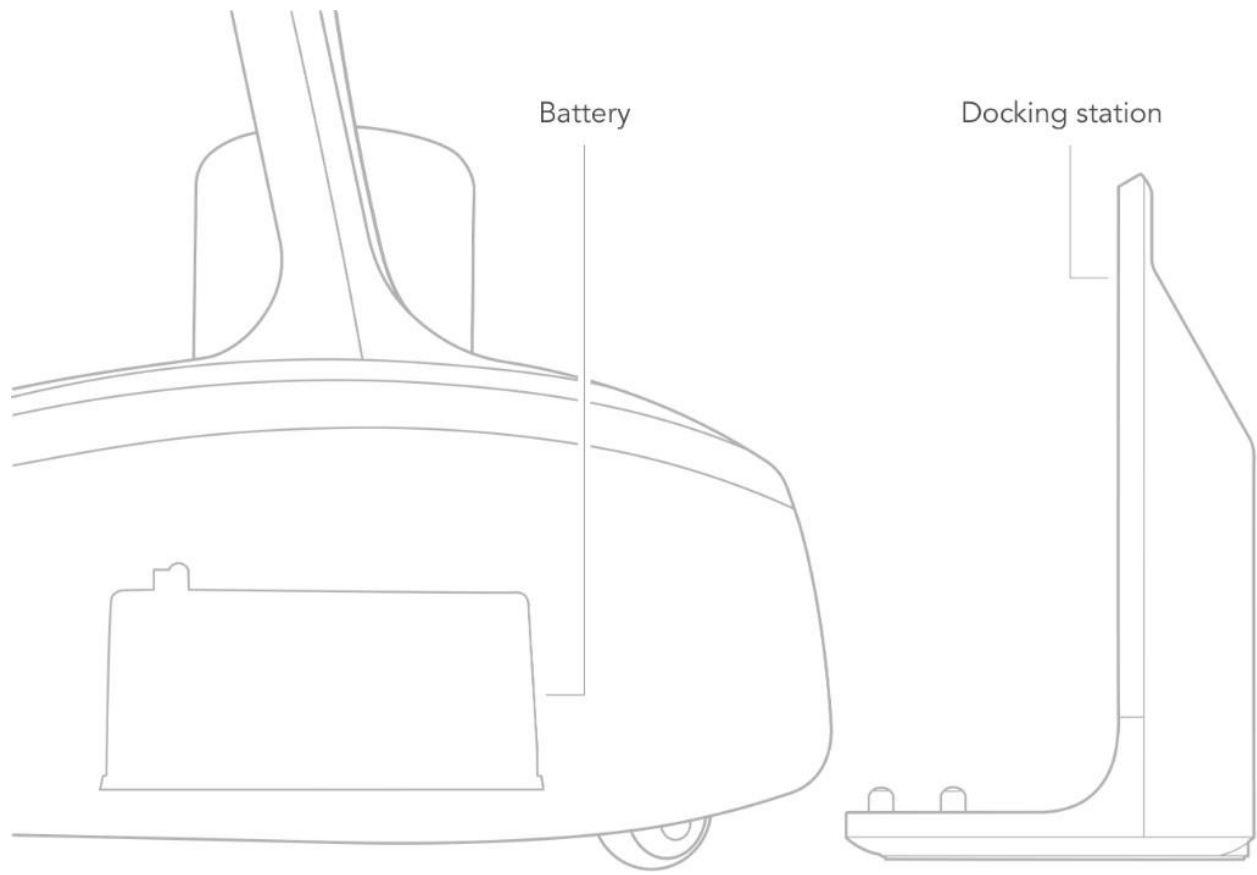

Mobility

Two independent 50 W direct drive Brushless DC motors

High resolution magnetic encoders that produce a smooth, accurate ride

Maneuverability

Zero turn radius

Speed

Up to 1 meter per second

Custom tires for optimal grip, stability and vibrations management

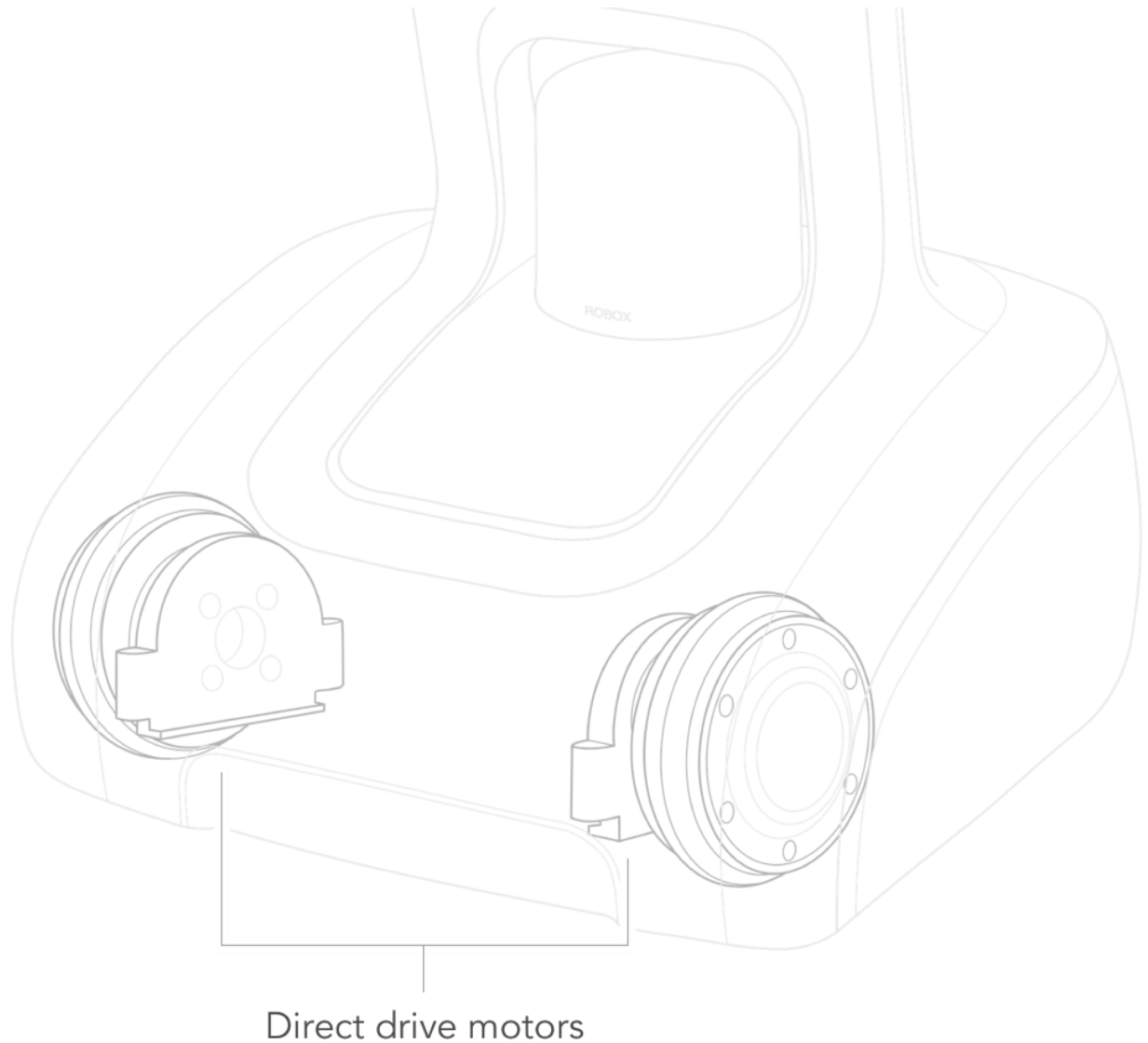

Tray

Ergonomic Tray

temi V2 or V2 upgraded to V3:

The tray contains a standard wireless charger for your mobile phone

temi V3:

The tray contains a 12V DC power jack and 4 screw holes for add-on attachment.

0.98ft X 0.8ft/ 30cmx25cm

Tray load: 6.6Lb / 3KG (Depends on assembly – consult with support team)

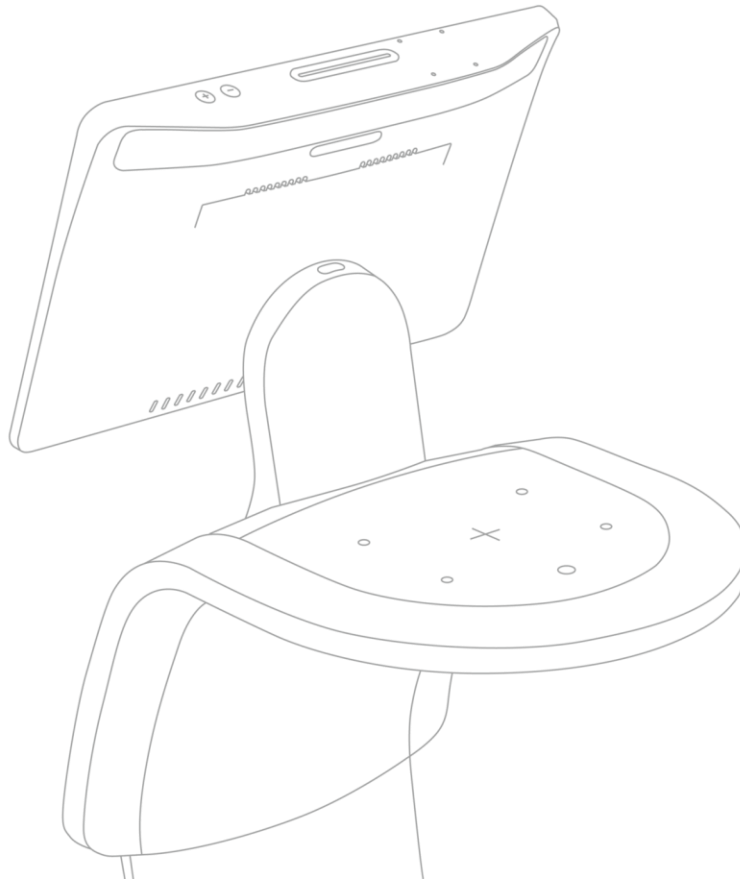

In The Box

1 temi robot

1 Docking station+ Cable

Quick setup guide

Contact

www.premiumrobots.ai

tab@premiumrobots.ai

+994 50 522 4000