

Smart Dog Bark Control Collar

Read and fully understand this manual before use

1. IMPORTANT SAFETY INFORMATION.



NOT for aggressive dogs!



For dogs over 6 months



Keep out reach of Children!
For DOG use only!



DO NOT leave the Bark Collar on dog for more than 12 hours per day!



DO NOT attach an extra leash to the Bark Collar!

- DO NOT leave the Bark Collar on the dog for more than 12 hours per day.
- When possible, reposition the Bark Collar on the dog's neck every 1 to 2 hours.
- Check the fit of the nylon collar to prevent excessive pressure. More information on achieving the perfect fit for your dog's nylon collar can be found in this manual.
- Never attach a leash to the Bark Collar, as it may cause excessive pressure on the contact points.
- Clean the dog's neck area and the Prongs of the Bark Collar weekly using a damp cloth.

2. PRODUCT INFORMATION.



Bark Collar

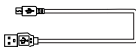

Charging Cable



User Manual

SET OF COLORED DOTS



Apply the colored dot to the center of the front panel in the designated area. This allows you to easily differentiate between collars (to maintain individual settings for each dog) if you have more than one dog.

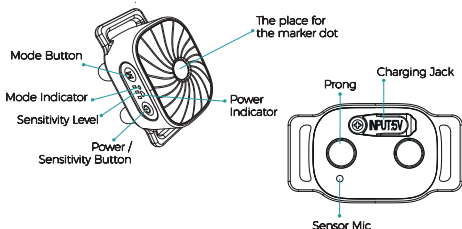

3. SET UP THE BARK COLLAR.

1) Charge the Bark Collar before Use

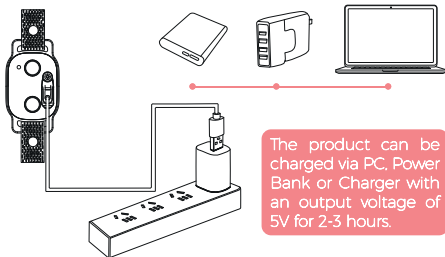

The product can be charged via PC, Power Bank or Charger with an output voltage of 5V for 2-3 hours.

Power Indicator:

- Flashing green slowly: the Bark Collar is charging.
- Solid green: the Bark Collar is fully charged.
- Flashing green rapidly: the Bark Collar battery is low.
- Flashing red rapidly with a constant warning tone: the Bark Collar is charging incorrectly.

Note:

1. The Bark Collar ONLY supports a 5V-rated power source.
2. Use the charging cable included in the package when charging. Other charging cables may not be suitable for this Bark Collar, which could cause electric damage.
3. The charger, power bank, and other charging devices shown in the above picture are not included in the box.

2) Turn on / off the Bark Collar



Press and hold the Power / Sensitivity Button to:

Power on: Press for 2 seconds, accompanied by a vibration.

Power off: Press for 3 seconds, accompanied by a beeping tone.

3) Mode Setting



Press the Mode Button to switch between modes.



Vibration Mode



Vibration+Beeping Mode

4) Sensitivity Level Setting:



Press the Power/Sensitivity Button to adjust the sensitivity level.

	Low Level
	Medium Level
	High Level

5) Test the Function of the Bark Collar:

Set the Bark Collar to either mode and then adjust the sensitivity level to the highest setting. After that, imitate a dog barking towards the Sensor Mic located at the back of the Bark Collar.

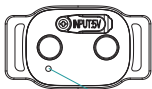

Sensor Mic



Let's take an example: if you set the Bark Collar to Vibration + Beeping Mode, it will vibrate and emit a beeping tone when it detects the dog barking. This indicates that the Bark Collar is effective in deterring unwanted barking.

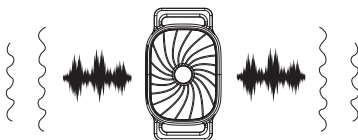
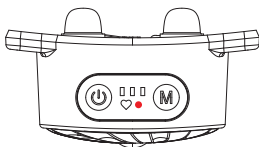

4. FITTING THE BARK COLLAR.

Note: Please pay special attention if you have a small dog!

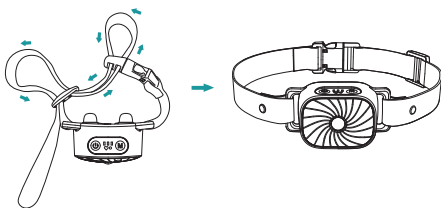

Ensure that the Bark Collar fits securely against your dog's neck, while still allowing enough space for a finger to fit between the strap and the neck. For optimal performance, make sure the collar is centered on the dog's throat.

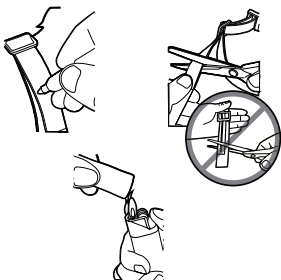

TRIM THE COLLAR AS FOLLOWS:

- a) Use a pen to mark the desired length of the collar. Take into account potential growth if your pet is young or has a thick winter coat.
- b) Remove the collar from your pet and cut off any excess material.
- c) Before putting the collar back on your pet, seal the cut edge by briefly applying a flame along the trimmed edge.

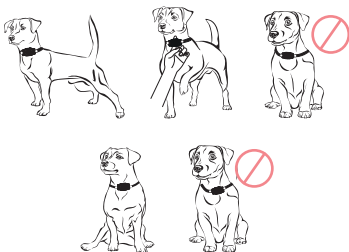

Great! You have successfully fitted the Bark Collar on your dog, and it is now ready for training!

5. HOW IT WORKS.

1) Vibration Mode

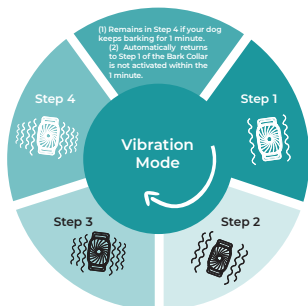

2) Vibration + Beeping Mode

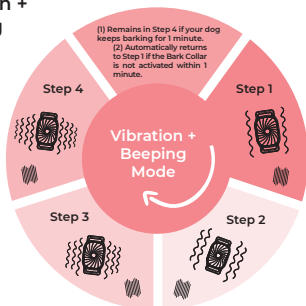

Icon Description:

- Vibration (increases automatically in intensity with each step).
- Beeping Tone (remains unchanged).

NOTES:

- (1) If your dog continues barking for more than 1 minute, the Bark Collar will advance to the next step.
- (2) If the collar is not activated within 1 minute, it will automatically return to Step 1.

6. FREQUENTLY ASKED QUESTIONS AND ANSWERS.

Q: Why does the Bark Collar not work when the dog barks?

A: Please first ensure that the Bark Collar fits securely, but with enough looseness for one finger to fit between the strap and the dog's neck. Some dogs may bark weakly, in which case you need to increase the sensitivity level. There is also a slight possibility that a thick coat around the neck area can reduce the detection of barking. Please trim the hair close to the area where the Bark Collar is placed.

Q: Why is the Bark Collar sometimes triggered in a noisy environment even when the dog is not barking?

A: Although we have optimized the barking detection, certain environmental noises may have a similar frequency to barking, which can occasionally activate the Bark Collar. If such situations occur multiple times, please lower the sensitivity level.

Q: Can I use the Bark Collar when other dogs are playing around?

A: Dogs tend to bark when they play and get excited. For the comfort and safety of your dog, we do not recommend using the Bark Collar in such an environment.

Q: How do I know if I can use this Bark Collar for my dog?

A: The Bark Collar is designed for healthy dogs over 6 months old. It is important to note that this Bark Collar should not be used on unhealthy or aggressive dogs. If you are uncertain whether this Bark Collar is suitable for your dog, please consult your veterinarian or a certified trainer.

6. FREQUENTLY ASKED QUESTIONS AND ANSWERS.

Q: Can I charge this Bark Collar with any type of charger?

A: No, it is recommended that you use a charger with an output voltage of 5V to charge this Bark Collar, as using a charger with an output voltage higher than 5V may damage the Bark Collar. If the input voltage is too high, the Bark Collar will automatically stop charging and emit a warning tone.

Q: Will my dog stop barking completely?

A: The Bark Collar is designed to effectively and humanely reduce excessive barking, and it is recommended to use the Bark Collar when you want to discourage your dog from barking excessively.

Q: Is this Bark Collar safe and humane?

A: Yes, this Bark Collar is designed to get your dog's attention without causing harm. However, the initial vibration or beeping tone may startle your dog.

For any questions about the collar or dog training, we're here to help. Contact us at support@traintail.us.

Our professional team is committed to your success.



TrainTail.us



support@traintail.us