



uPVC & System Aluminium Windows



Defined by

EXPERIENCE
EXPERTISE &
EXCELLENCE

Casement Windows



ENCRAFT Casement Window range is designed to provide the maximum flexibility for fabricators and clients alike. The system is based on a two profile depths - 42 and 62 mm and was designed to facilitate maximum application coverage with the minimum number of profile sections providing fabricators and clients at the same time with the ideal range of products to suit any window replacement program or building type in the fast growing construction industry.

- ✓ Contemporary modern soft line profile appearance.
- ✓ 10 mm sash overlap for enhanced performance.
- ✓ Internal glazing options from 4 mm single to 36 mm triple
- ✓ Choice of single or multi-point locking devices
- ✓ Build-in hardware location facility for hinges, striker etc.
- ✓ Secure hardware fitting into steel reinforcements as standard.

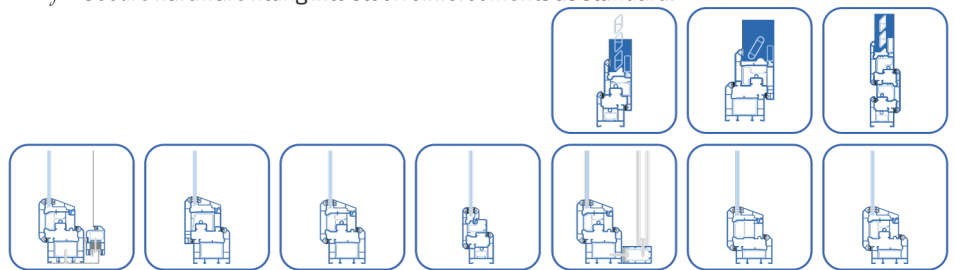

Sliding Windows



ENCRAFT Sliding Window range is designed to provide the maximum flexibility for fabricators and clients alike. Based on a range of sections, it offers full flexibility offering from single sliding to multiple sliding openers, clip on or integrated sections for fly screen and a range of section sizes covering small and large openings. It provides the ideal range of products to suit any window replacement program or building type in the fast growing construction industry.

- ✓ One, two and three track sliding, window and fly screen options.
- ✓ Multi-chamber profile design, frame depth from 62 to 112 mm.
- ✓ 10 mm sash overlap for enhanced performance.
- ✓ Internal glazing options from 4 mm single to 22 mm double.
- ✓ There is a Choice of single or multi-point locking devices.

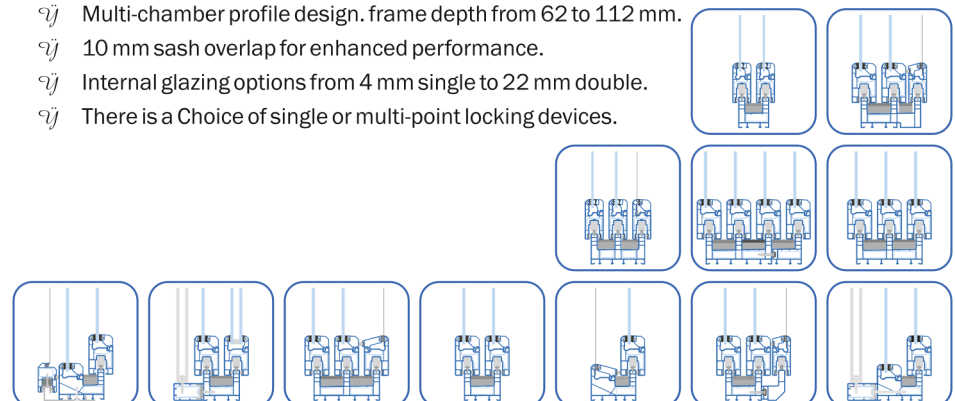

Tilt N Turn Windows



ENCRAFT Tilt N Turn Windows are designed to provide a European window option for fabricators and clients alike. The window is available as part of the EN62 range and was designed to give the discerning end user a state of the art inward opening fenestration solution. The ENCRAFT Tilt N Turn provides the client maximum design freedom due to larger opening sizes that can be achieved and suits any window replacement program or building type in the fast growing construction industry.

- ✓ Contemporary modern soft line profile appearance.
- ✓ 10 mm sash overlap for enhanced performance
- ✓ Internal glazing options from 4 mm single to 36 mm triple
- ✓ Concealed heavy duty hinges to enable continuous weather seals
- ✓ External sliding fly screen system
- ✓ Secure hardware fitting into steel reinforcements as standard

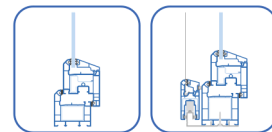

Fold & Slide Windows



ENCRAFT Fold N Slide Windows system offers superior operating performance and smooth integration into any architectural style and space. The window system is engineered for using multiple panel from 2 to 7 panels. this system offers unobstructed opening options. The hardware used offers a smooth glide and reliable performance with solid design and engineering.

- ✓ Can be opening in or out
- ✓ 2, 3, 4, 5, 6 and 7 pane option
- ✓ Dedicated ENCRAFT top guide and bottom track to ensure perfect alignment
- ✓ Internal glazing option from 4mm single to 36mm triple glazing
- ✓ Frame width of up to 18'8" can be achieved with a maximum height of 9'

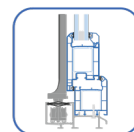

TwinSash Doors



ENCRAFT TwinSash Doors are probably the most ingenious door invented in India comprising two independently operated door sashes. one sash opening-out for mosquito screen and one sash opening-in for glazing. However, some parts of India may only require one sash equipped with mosquito screen whilst the second sash houses fixed or adjustable louvers. TwinSash doors can utilize ENCRAFT's two dedicated, door sashes and wide range of locking devices. For today's requirement, the ultimate TwinSash door comprises an external mosquito screen with a high performance double glazing unit incorporating blinds.

- ✓ 152 mm outer frame depth with 56 mm available space between sashes
- ✓ 10 mm sash overlap for enhanced performance
- ✓ Internal glazing option from 4 mm single to 36 mm double
- ✓ Possibility to combine mosquito screen, panel, louvers and glass within one unit
- ✓ Choice of locking devices and hinge types including concealed (invisible) hinges
- ✓ Threshold-less

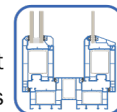
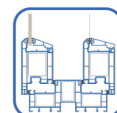

Tilt N Slide Doors



ENCRAFT Tilt N Slide Doors offer the ultimate in protection for your home. The European concept of tilting and sliding the door sash allows the provision of a dual compression seal and provides the maximum ventilation and glass area. The dual compression seal gives excellent insulation from sound and dust alike

- ✓ Contemporary modern soft line profile appearance.
- ✓ Double Compression seals protect against draught, dust & water
- ✓ 10 mm sash overlap for enhanced performance
- ✓ Internal glazing options from 4 mm single to 36 mm triple
- ✓ Multi-point perimeter locking and heavy duty tandem rollers as standard
- ✓ Secure hardware fitting into steel reinforcements as standard

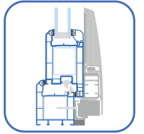

Invisi Fold Doors



The ENFOLD System is designed to convert standard welded windows & doors into sliding/folding/swing systems. ENFOLD is a unique alternative for 'concertina', 'fold & slide' or 'bi-fold' windows & doors which is based on movement of individual panels.

It can be manufactured with invisible hinges showing only 1 or 2 handles (depending on style), also it can be manufactured alternatively with face mounted, and fully adjustable 3D hinges. ENFOLD sliding panels are bottom loaded and will 'NOT' drop like conventional 'fold & slide' systems resulting in trouble free installations.

- ✓ Can be opening in or out
- ✓ 2, 3, 4, 5, 6 and 7 pane option
- ✓ Internal glazing option from 4mm single to 36mm triple glazing
- ✓ Frame width of up to 18'8" can be achieved with a maximum height of 9' in Single Glass unit & 7' in Double Glass unit without exceeding a sash weight of 80 kgs.

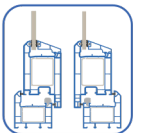

Fold N Slide Doors



ENCRAFT Fold N Slide Doors system provides superior operating performance and smooth integration into any architectural style and space. The door system is engineered using high quality uPVC Window. Door profiles, superior hinge, and locking systems that are reliable and secure. The rollers, along which the doors slide, offer a smooth glide and reliable performance with solid design and expert engineering.

- ✓ Contemporary modern Softline appearance
- ✓ 10 mm sash overlap for enhanced performance
- ✓ Internal glazing option from 4 mm single to 36 mm double
- ✓ Multi-point perimeter locking devices as standard
- ✓ Heavy duty tandem rollers for smooth operation
- ✓ Secure hardware fitting into steel reinforcements as standard

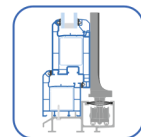

Balcony Doors



ENCRAFT Balcony Doors are intended to provide more glass area due to an overall, slimmer frame sight line and are available as either single or double doors (French doors), opening-in or opening-out, and are offered with one operating handle by design, which is positioned inside. A special handle and a concealed snap-in device enables a temporary closing of the door when outside. Balcony doors can be stand-alone items, manufactured with fanlights and/or sidelights, or integrated into complete curtain walling screens.

- ✓ Contemporary modern Softline appearance
- ✓ 10 mm sash overlap for enhanced performance
- ✓ Internal glazing option from 4 mm single to 36 mm double
- ✓ Choice of numerous multi-point locking devices including full perimeter locking
- ✓ Threshold-less or Aluminum low threshold
- ✓ Choice of hinge types including concealed (invisible) hinges

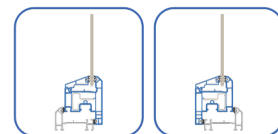

ADVANTAGE OF uPVC

Strong & Secure

uPVC Door & Window systems have been engineered to allow the secure fitting of hinges, locking devices and handles high providing a level of security against high providing a level of security against intrusion and peace of mind.

uPVC systems are naturally flame retardant and decrease the fire load of a building fire.

UV Resistant

uPVC door and window systems are capable of protecting from high UV index. Entire process from raw material selection to advanced extruding to further processing is formulated to attain highest quality profiles capable to resist UV radiations which are generally high in Indian subcontinent.

Wind Load

uPVC Door & Windows can with stand Storms woth wind pressure of over 3000 Pascal's which is equivalentents to a speed of 245Km/hr. this provides excellent application flexibility for today's modern high rise building dtructure.

Weather Resitant

Built with engineering precision, uPVC product range when installed in accordance with known installation guidelines like BS8213-4 will provide the perfect barrier against the elements. Rotting, splitting, warping or corroding, some of the problems associated with other frame materials will not happen with uPVC.

Sensibly Green

upVC doors and windows are a superior option to wood and aluminium. Positive insulation reduces the carbon footprint of he building. 100% recyclable uPVC systems are Lead free, thus increasing the environmental sustainability.

Energy Efficient

When it comes to thermal properties, uPVC is an excellent proposition for fenestration solutions due to its inherent warmth. All uPVC systems provide excellent thermal insulation, and the TwinSash can achieve as low as 0.8 W/m2K by using double glazed units. This makes the TwinSash from uPVC a truly energy efficient, comfortable and affordable fenestration solution for all markets.

FEATURES

Infrastructure

Our fabrication unit is located in RIICO Industrial Area Bhiwadi. We are having a good infrastructure . Our well-equipped plant aids us in developing unmatched quality of different types of uPVC windows & Doors. Our hi-tech manufacturing facility and sophisticated technology allows us to design quality products.

Quality Products

We are one of the leading Manufacturers of quality uPVC Window & Doors. We use Latest Technology in our production process. Our UPVC Window & Doors are steel reinforced (to give strength), termite proof, resistant to weather and fire, non-conductive, sound insulated to prevent noise pollution. These are designed for high performance and stay in shape for longer period.

TECHNICAL SPECIFICATIONS

- 100% local production to european standards with latest technologies
- Only uPVC profiles company that is ROHS compliant
- Member of the **"INDIAN GREEN BUILD COUNCIL"**
- IMC certification, covering ISO9001, ISO14001, and OHSAS18001 standards
- Nationwide coverage with 5 distribution centers
- 50 years of plastic processing know how
- Associate traing program covering fabrication and installation
- Modern soft line appearance
- Wide range of glazing options; 4 - 36mm
- Soecially designed steel reinforcement sections to give maximum strength in all directions
- Build in basic Security features- Internal beading & Anti lift mechanism
- Wood effect finishes on matching bas colour
- Non- sulphur & Carbon black content grey TPE Gaskets
- Specially designed Secure Butt hinge for casement windows & doors.
- Fly screen options for both Casement & Slibling windows.
- Unique Glazing bead cutting system which gives excellent aesthetic appeal.
- Our products are approved for green Building and we also support "GO GREEN"

A treat to behold

ENCRAFT Door & Window systems come in a variety of wood finishes to suit a range of interiors and exteriors lending grace and beauty to the architectural design. The available attractive wooden shades are:

Dark Oak

Anthracite Grey

Golden Oak

Black Smooth

Walnut

Flemish Gold

Mahogany

Smooth Grey

Rustic Oak

