



At APB Creative Minds we design and produce 3D printed railway modelling scenic items (primarily in N scale)

If you don't find what you are looking for or perhaps have seen something elsewhere and have ideas for improvement, then please get in touch and we shall see what we can do.

Likewise, if you have suggestions for improvements to our products, please let us know.

We are passionate about railway modelling and very much enjoy the hobby.

apbcreativeminds.com

For assistance, please find Pippa
(around here somewhere)

20ft Open Top Shipping Container with Openable Doors



A nicely detailed 20ft open top shipping container complete with doors that can be opened to reveal more of the insides

Complete with internal details, with side corrugations that matches the outsides and a ply sheet base

Ideal for carrying scrap loads

Scale

Available in two N scales: American (1:160) and British (1:148), please select when ordering

Pack quantity

1 unit

Construction details

🔧 Printed in PLA

🔧 None required, delivered as one piece

🔧 The doors may be opened (with possible light use of a scalpel) and left in place

🎨 May be weathered/coloured with acrylic paints as required and apply your appropriate decals to bring to life

⚠️ Do not open and close the doors multiple times, designed to be set and left

Available in white, grey, red, green, brown, orange, blue and pink

£2.99

40ft Open Top Shipping Container with Openable Doors



A nicely detailed 40ft open top shipping container complete with doors that can be opened to reveal more of the insides

Complete with internal details, with side corrugations that matches the outsides and a ply sheet base

Ideal for carrying scrap loads

Scale

Available in two N scales: American (1:160) and British (1:148), please select when ordering

Pack quantity

1 unit

Construction details

🔧 Printed in PLA

🔧 None required, delivered as one piece

🔧 The doors may be opened (with possible light use of a scalpel) and left in place

🎨 May be weathered/coloured with acrylic paints as required and apply your appropriate decals to bring to life

⚠️ Do not open and close the doors multiple times, designed to be set and left

Available in white, grey, red, green, brown, orange, blue and pink

£3.99

40ft Shipping Container with Openable Doors



A nicely detailed 40ft shipping container complete with doors that can be opened to reveal the insides

The container has an open bottom that can be closed off with the optional floor piece (if required), this would help provide a realistic look if the doors are opened to reveal your added container contents

Scale

Available in two N scales: American (1:160) and British (1:148), please select when ordering

Pack quantity

1 unit

Construction details

🔧 Printed in PLA

🔧 None required, delivered as one piece

🔧 If adding the optional floor then just glue into place

🎨 May be weathered/coloured with acrylic paints as required and apply your appropriate decals to bring to life

⚠️ Do not open and close the doors multiple times, designed to be set and left

Available in white, grey, red, green, brown, orange, blue and pink

£3.99

20ft Shipping Container with Openable Doors

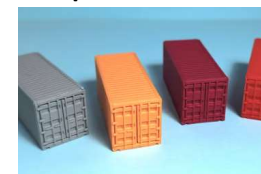

A nicely detailed 20ft shipping container complete with doors that can be opened to reveal the insides

The container has an open bottom that can be closed off with the optional floor piece (if required), this would help provide a realistic look if the doors are opened to reveal your added container contents

Scale

Available in two N scales: American (1:160) and British (1:148), please select when ordering

Pack quantity

1 unit

Construction details

🔧 Printed in PLA

🔧 None required, delivered as one piece

🔧 If adding the optional floor then just glue into place

🎨 May be weathered/coloured with acrylic paints as required and apply your appropriate decals to bring to life

⚠️ Do not open and close the doors multiple times, designed to be set and left

Available in white, grey, red, green, brown, orange, blue and pink

£2.99

Container Floors for 20ft and 40ft Shipping Containers



How about adding a floor panel to the bottom of a shipping container then open the doors and show off some stored contents, or have one being loaded/unloaded to add extra dimensions to your model scene

The floor panel fits any of our 20ft or 40ft closed top containers

Printed in brown to represent a wood base and sits on integrated bearers to bring the floor to the door level

Scale

Suitable for N scale

Measurements

Only suitable for our 20ft and 40ft shipping containers

Pack quantity

3 units

Construction details

🔧 Printed in brown PLA

🔧 Glue the floor base into your container by adding a small amount of super glue to the floor edges and lower the container down onto it

🌤️ May be weathered/coloured with acrylic paints as required

Available for 20ft and 40ft containers

£1.25/1.99

20ft and 40ft Shipping Container Stacking Components



If you desire a stack of containers to model your container depot/port and baulk at excessive cost, then look no further...

Why not build your stacks out of the minimal parts required and thus save money! Don't just stack complete containers next to and on top of others and hide most parts of them. Buy the bits you need and create any size stack at a significant saving

There are also two types of door available, one with four locking bars and one with the newer three locking bars. This gives the ability to mix up the front of your container stack, giving a more convincing look

Scale

Suitable for American N scale (1:160)

Pack quantity

3 each of you selected part in your selected colour

Construction details

🔧 Printed in PLA

🔧 Each piece will need to be glued to construct your stack. For more information on construction methods refer to our website

🌤️ May be weathered/coloured with acrylic paints as required and apply your appropriate decals to bring to life

Available in white, grey, red, green, brown, orange and blue

Parts range from **£1.49 to £3.99**

Shipping Container Stacking Component Assemble Jig

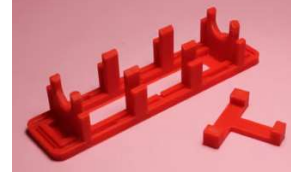

This handy little jig will make the process of glueing our shipping container stacking components together much easier. Panels align nicely and can be left in place until set

Suitable for both our 20ft and 40ft containers

Pack quantity

1x Jig

1x Clip

Construction details

🔧 Printed in PLA

🔧 None required, ready to use

£2.49

Industrial Staircase/Steps with Handrails

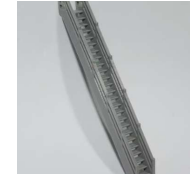

A set of industrial staircase/steps with handrails

With a rise (from ground to upper floor) of 50mm over a horizontal distance of 40mm

Can be supplied ready assembled or in two pieces, the latter making it easier to cut down to your particular size requirements if necessary

Scale

Suitable for **N scale only**

Pack quantity

1 set

Construction details

🔧 Printed in grey PLA in two parts

🔧 For the ready assembled version - none

🔧 For the two-piece option - just add small drops of super glue to each tread end and then position the side stringer/railing piece to it

🌤️ May be weathered or colour changed using acyclic paints

£3.99/£4.49

Industrial Racking



Flat packed industrial racking with adjustable shelves

Ideal for modelling a warehouse or workshop

Scale

Suitable for N scale

Measurements

A built 4 shelf position unit measures 26h x 8d x 24w (mm)

A built 6 shelf position unit measures 38h x 8d x 24w (mm)

Pack contents

6 uprights with 9 shelves for the 4 shelf position unit

6 uprights with 12 shelves for the 6 shelf position unit

Both provide enough parts to make 3 complete racks

Construction details

🔧 Printed in grey PLA

🔧 Add a little super glue to the uprights and glue the shelves where desired

🎨 May be weathered/colour with acrylic paints as required

Available in 4 shelf position unit or 6 shelf position

£3.99 / £4.99

Industrial Work Desks



Industrial work desk with 3 drawers

Ideal for you modelled warehouse or workshop

Scale

Suitable for N scale

Measurements

One desk measures 6.5h x 7.2d x 20.2w (mm)

Pack quantity

2 units

Construction details

🔧 Printed in grey PLA

🔧 None required, ready to decorate

🎨 May be weathered/coloured with acrylic paints as required

£2.99

Industrial Work Benches



Industrial work bench/table, ideal for modelling a workshop

Scale

Suitable for N scale

Measurements

One work bench measures 6.5h x 7.2d x 20.2w (mm)

Pack quantity

3 units

Construction details

🔧 Printed in grey PLA

🔧 None required, ready to decorate

🎨 May be weathered/coloured with acrylic paints as required

£2.99

Workshop or Office Cabinets



A set of typical metal cabinets suitable for both industrial workshop or office environments

The cabinets come with matching doors that may or not be put in place, and if used could be left ajar to show off their contents

Scale

Suitable for N scale

Measurements

The short cabinet measures 7.6h x 7.8w x 4.9d (mm)

The tall cabinet measures 13.7h x 7.8w x 4.9d (mm)

Pack contents

2x tall cabinets

3x short cabinets

Construction details

🔧 Printed in grey PLA

🔧 If using the supplied doors just add a little glue and locate in the desired positions

🎨 May be coloured/highlighted with acrylic paints as required

💡 Place some small items on the visible shelves for some added realism

💡 Lightly crease or bend the odd door to show some wear and tear

£3.49

Office Furniture



A nicely detailed and scaled set of office furniture for modelling a typical warehouse, workshop or station office

Scale

Suitable for N scale

Pack contents

1x A0 plan drawers

1x desk with drawers

1x four drawer filing cabinet

1x three drawer filing cabinet

Construction details

🔧 Printed in grey and brown PLA

👉 May be coloured with acrylic paints as required

£3.99

Shelves with Brackets



Nicely detailed shelves complete with angle mounting brackets

Scale

Suitable for N scale

Measurements

Small shelves measure 10w x 3.0d x 2.38h (mm)

Large shelves measure 16w x 3.0d x 2.38h (mm)

Pack quantity

5 of your selected type

Construction details

🔧 Printed in white or brown/grey PLA

👉 May be coloured with acrylic paints as required

£1.09 to £1.39

Sherman Tank Barrel Supports

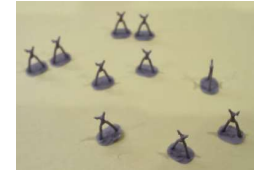

These little things are designed to support the barrel of a Sherman tank during transportation

They are prototypical and are found on the front of the tank, but normally tank models have them in the folded down position, these let you model a tank in a transport scenario

Scale

Suitable for N scale

Pack quantity

10

Construction details

🔧 Printed in grey PLA

👉 Cut to size and glue in place

👉 May be weathered/coloured with acrylic paints as desired

£1.99

Scaffold Set



How about some scaffolding to model maintenance or construction work

Mix it up and make it fit, to meet your particular scenario

Scale

Suitable for N scale

Pack contents

2x preformed scaffolds sides (vertical poles crossed with horizontal poles and two diagonal braces) printed as one piece

12x additional poles (for vertical and horizontal bracing etc)

6x preformed two colour platforms (scaffold planks across three horizontal poles)

6x additional single scaffold planks (for vertical safety sides to horizontal platforms or for free standing workways)

2x lengths of wooden ladder

Construction details

The poles are printed in grey PLA, with the scaffold planks and ladders in brown

Just cut to size and glue into place to form a 3D scaffold structure

All may be weathered/coloured with acrylic paints as desired

£8.99

Ladders

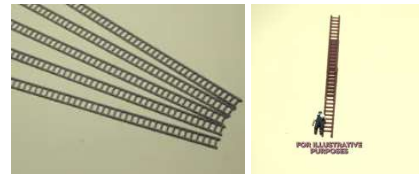

A general-purpose ladder that could be utilised for a number of jobs; access to signal heads, building/maintenance, access to other high places etc

Scale

Suitable for N scale

Measurements

One length measures 150h x 4.2w x 0.75d (mm)

Pack quantity

5 lengths

Construction details

Printed in grey or brown PLA (select required option)

Just cut to size

May be weathered/coloured with acrylic paints as desired

Use the brown coloured version to represent wood and the grey for aluminium

Overlay one or more lengths to create an extending ladder

£3.99

Holed Steel I-Beams

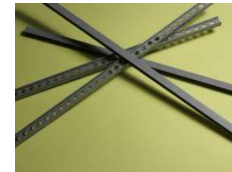

Industrial steel girders with lighting holes

Scale

Suitable for N scale

Measurements

Each piece measures 165L x 5h x 4w (mm)

Pack quantity

4 pieces, giving a total run of 660mm

Construction details

Printed in grey PLA

Just cut to size and glue into place

May be weathered/coloured with acrylic paints as required

£3.99

Ladder Cages and Platforms

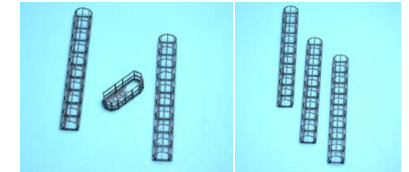

How about adding some safety to your access ladder...

Ideally suited to our [ladders](#)

Add this finely detailed cage to a permanent ladder installation, and perhaps further improve safety with the use of the intermediary platform

Scale

Suitable for N scale

Measurements

One ladder cage measures 49h x 7w x 6d (mm)

One platform measures 6h x 17w x 7d (mm)

Pack quantity

Either two cages and one platform or three ladder cages

Construction details

Printed in grey PLA

Just cut the ladder cage to size, and trim the vertical poles as required (for access)

May be weathered/coloured with acrylic paints as desired

£3.99/ £3.99

Mechanics Tool Chest and Roller Cabinet

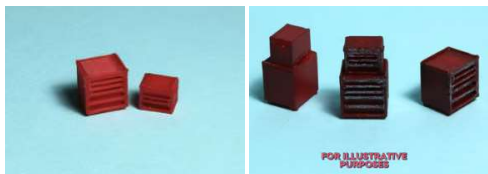

Workshop floor standing tool chest and top roller cabinet combination

Two separate pieces so may be positioned as required

Scale

Suitable for N scale

Measurements

The floor standing tool chest measures 6.6h x 6.3w x 5.0d (mm)

The top roller cabinet measures 4.1h x 5.2w x 3.5d (mm)

Pack contents

1x floor standing tool chest

1x top roller cabinet

Construction details

🔧 Printed in red PLA

💡 May be coloured/highlighted with acrylic paints as required

💡 Add a little silver paint to the drawer handles for a more realistic look, hopefully with a steadier hand than mine

£2.49

Industrial Arc/Mig Welder

TBA

TBA

£ TBA

Industrial Overhead Gantry Crane



Every machine shop or engineering works needs a heavy-duty industrial gantry crane for lifting and shifting. This would be ideal for lifting freight cars around your car/wagon repair shop for example.

Available as a base kit for lighter lifting or with the extension set that in total would provide two lift points for those bigger loads

Scale

Suitable for N scale

Measurements

The holed main gantry beams measure 165mm in length

The crane motor gantry rail has a span of 122mm (fitting perfectly in the [Walthers Car Shop](#)), but could be cut down to suit other installations

Pack quantity

The base set consists of: 2x holed main gantry beams, 1x crane motor gantry rail, 1x crane motor trolley, 1x hook and 1x small length of cotton

The extension set consists of: 1x crane motor gantry rail, 1x crane motor trolley, 1x hook and 1x small length of cotton

Construction details

🔧 Printed in grey PLA

🔧 Cut to size as required, glue together and use supplied cotton to hang the hook from the motor trolley

Base set / extension set

£8.49 / £5.99

Mezzanine Floor Kit for Walthers N Scale Car Shop



Why not add some more detail to your Walthers Car Shop, by adding a mezzanine floor.

Sits between the two rows of windows at one end.

Supplied with a safety rail and steps to the workshop floor for extra realism.

Adds an extra 25% to the original floor space providing an area for more of your workshop details

Scale

Suitable for N scale

Pack quantity

1 of each piece

Construction details

🔧 The mezzanine floor is printed in two colours of PLA, giving a grey steel frame with brown wooden floor appearance

🔧 The steps and railing are printed in grey PLA

🔧 The one-piece floor may be glued in place as is. Followed by the steps which can be glued in top and bottom. Finally cut and glue the railing to fill either side of the steps to the outer wall braces.

💡 All pieces may be weathered or colour changed using acrylic paints

£9.99

Ranch Style Fencing with Gates

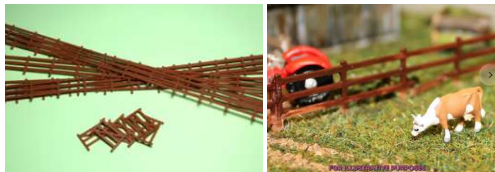

Ranch style three bar wooden fencing with matching gates

Scale

Suitable for N scale

Measurements

Each length of fencing measures 182mm x 11mm

Each gate measures 15mm x 11mm

Pack contents

6 lengths of fencing, giving a total run of 1092mm plus 6 gates

Construction details

🔧 Printed in brown PLA

🔧 Just cut fencing to size and glue into place

🔧 Fencing can be creased to make a bend without having to cut and join

👉 May be weathered/coloured with acrylic paints as required

💡 Break or remove the odd cross bar for some added rustic realism

£4.99

Fine Two Bar Railing

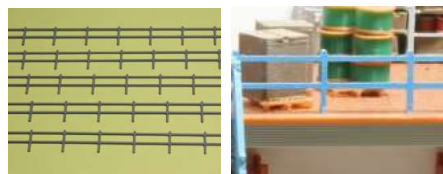

Fine two horizontal bar railing

Scale

Suitable for N scale

Measurements

Each pieces measures 130mm x 7mm

Pack quantity

5 pieces, giving a total run of 650mm

Construction details

🔧 Printed in grey PLA

🔧 Just cut to size and glue into place

👉 May be weathered/coloured with acrylic paints as required

£3.99

Wooden Fencing with Gates

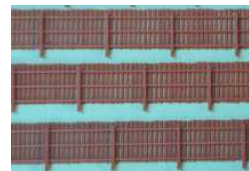

Wooden fencing; vertical planks fixed to three cross bars and wooden posts

Supplied with two widths of matching gates

Scale

Suitable for N scale

Measurements

Each length of fencing measures 146w x 13.5h (mm)

Each gate measures; small 6.5w x 11h and large 9w x 11h (mm)

Pack contents

6x Lengths of fencing, giving a total run of 876mm

4x Small gates

4x Large gates

Construction details

🔧 Printed in brown PLA

🔧 Just cut fencing to size and glue into place

👉 May be weathered/coloured with acrylic paints as required

£4.99

Concrete or Wooden Retaining Wall

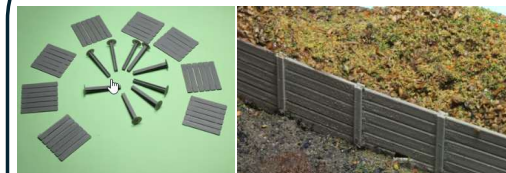

Need a means of retaining an embankment or cutting then this could be ideal, or perhaps some industrial looking fencing. Place the panels supported with concrete posts and make a run as needed

The posts are finely printed with slots to accept the panels

The planks in the panels may be separated as they are loosely attached, allowing the panel height to be easily adjusted if needed

Scale

Suitable for N scale

Measurements

Each panel measures 17.5w x 17.0h (mm)

Pack contents

9x concrete posts

8x panels in either concrete or wood (please select which is required), giving a total run of 140mm

Construction details

🔧 Concrete posts and concrete panels printed in grey PLA, wooden panels in brown PLA

🔧 Add a little glue to the side edges of each panel and slip into the recessed groves on each post, then glue and position the complete structure into place

👉 May be weathered/coloured with acrylic paints as required

£3.99

Aggregate Stores



Need a place to store your aggregate, scrap, recycling etc, then how about having some aggregate stores/bays to keep everything in order

The base kit provides enough parts to make a two-bay unit, with each bay being two panels deep by two panels wide

The extension kit along with the base kit will allow up to four bays to be constructed

Scale

Suitable for N scale

Measurements

Each panel measures 17.5w x 17.0h (mm)

Pack contents

Base pack comprises of 10x side panels, 5x straight joining posts, 2x corner posts, 1x tee post and 3x End posts

Extension pack comprises of 8x side panels, 4x straight joining posts and 2x tee posts

Construction details

🔧 Posts and concrete panels printed in grey PLA, wooden panels in brown PLA

🔧 Add a little glue to the side edges of each panel and slip into the recessed grooves on each post, then glue and position the completed structure into place

🌈 May be weathered/coloured with acrylic paints as desired

Base pack / extension pack

£4.99 / £3.99

Fence Posts

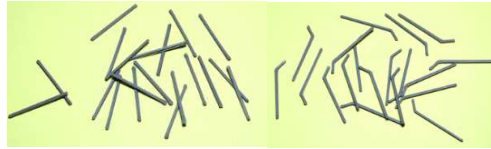

Choose from two styles of typical fencing posts and add your chosen fencing to them

Scale

Suitable for N scale

Measurements

Each straight post measures 20h x 0.8 square (mm)

Each security style post measures 24h x 0.8 square (mm)

Pack quantity

25 of your selected type

Construction details

🔧 Printed in grey PLA

🔧 Drill a small locating hole in your base board, add a little glue to the hole and position your post

🌈 May be weathered/coloured with acrylic paints as desired

£1.99/£2.25

U Profile Sheet Piling

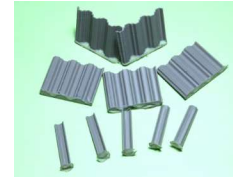

Create a retaining wall by placing these U profile piling sheets (with a small overlap) in a row

The individual pieces are slightly higher than the sheets and could be placed at the ends to show construction, where they have not all been cut to the finalised height

Scale

Suitable for N scale

Measurements

Sheet of piling measures 26w x 3d x 21h (mm)

Individual piling measures 5w x 1.7d x 23h (mm)

Pack quantity

5 sheets (giving a 128mm run) plus 5 individual pieces

Construction details

🔧 Printed in grey PLA

🔧 The heights may be modified by lightly scoring and snapping apart

🌈 May be coloured with acrylic paints as required

£3.49

Industrial Building Steel Work

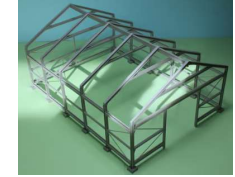

How about showing an industrial building (workshop, warehouse, locomotive depot etc) under construction using our steel frame building kit

Or simply use these components to create a framework to support your outer covering, while having nice detail within

Scale

Suitable for N scale

Measurements

The complete structure measures 77h x 152d x 110w (mm)

Pack quantity

1 kit consists of 6x roof truss A frames, 5x roof beams, 2x sides, 1x end, 1x front and 14x pad stones

Construction details

🔧 Printed in grey PLA

🔧 Use superglue to join the pieces together to create the structure pictured

🌈 May be weathered/coloured with acrylic paints as required

💡 By not glueing in all components you could mimic earlier stages of construction

£12.99

Wooden Pallets

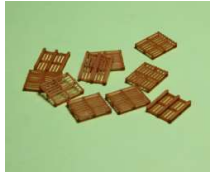

Make your goods yard or warehouse look busy with some loaded pallets along with empties using these finely detailed wooden pallets

Available in a number of types/sizes and to exact scale (for both American and British N)

Scale

All available in American N scale (1:160) or British N scale (1:148)

Measurements

Standard American - 48x40 inches (1219x1016mm) to 1:160 measures 1.1h x 7.6w x 6.4d (mm)

Pack quantity

10 empty pallets

Construction details

🔧 Printed in brown PLA

🔧 None, ready to use

🎨 May be painted with acrylic paints as desired

Standard American 48" x 40", to 1:160 or 1:148

£3.99

Cable Drums



Cable drums with full loads of cable.

Various colour combinations available

Three size options available

Scale

Suitable for many scales, including HO, OO and N scale

Measurements

Small cabled drums measure 2.6mm diameter x 2mm in width

Medium cabled drums measure 5mm diameter x 3mm in width

Large cabled drums measure 8mm diameter x 5mm in width

Pack quantity

5

Construction details

🔧 Printed in two colours of PLA

🔧 No construction is required as these are printed in one piece

🎨 May be weathered or colour changed using acrylic paints

Available in many colour combination and in three sizes (Small/Medium/Large)

£1.99 / £2.99 / £3.99

Packing Boxes



A set of basic packing boxes that could be used as is or separated into smaller or individual pieces

Each box in a row is connected with a thin easy to break link

Ideal for populating our industrial racking and numerous other areas of your layout

Scale

Suitable for N scale

Measurements

The maximum width is 21mm, maximum height is 7mm and the maximum depth is 5mm

Pack quantity

One each of the four different sizes

Construction details

🔧 Printed in brown PLA

🔧 Just cut to size

🎨 May be weathered/coloured with acrylic paints as desired

£ 1.49

Industrial Light Shades

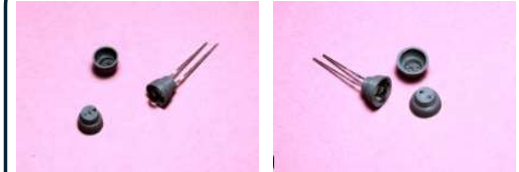

Add some realistic industrial light shades to your building illuminations

Two shade sizes are available, each taking standard round 3mm LEDs with 2.54mm (0.1") pitch legs

Scale

Suitable for all scales

Measurements

The small shades measure 5mm high x 6mm diameter

The large shades measure 5mm high x 8mm diameter

Pack quantity

5 of your selected size (LEDs NOT included)

Construction details

🔧 Printed in grey PLA

🔧 Add a little superglue to the base of the LED and push the two legs through the two tiny holes in the top of the shade

🎨 May be weathered/coloured with acrylic paints as desired

£ 1.99/£2.25

Jersey Barriers (K-rail)

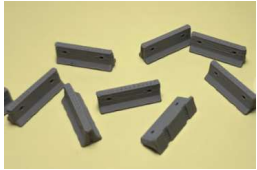

These Jersey barriers (Jersey wall or Jersey bump or sometimes K-rails) are modular concrete barriers employed to separate lanes of traffic. Designed to minimize vehicle damage in cases of incidental contact while still preventing vehicle crossovers resulting in a likely head-on collision. These are also used to reroute traffic and protect pedestrians, workers and site equipment during highway construction or many other industrial settings.

Scale

Suitable for N scale

Measurements

Each piece measures 5.5h x 5.0d x 16.0w (mm)

Pack quantity

10

Construction details

🔧 Printed in grey PLA

🔧 Glue in place with super glue

👉 May be weathered/coloured with acrylic paints as desired

£2.49

Interlocking Concrete Blocks



Interlocking concrete blocks designed for projects including block wall flood defence, coastal erosion prevention, storage bays, counterweights and industrial building support.

Scale

Suitable for N scale

Measurements

Each piece measures 4.5h x 4.5d x 11.5w (mm)

Pack quantity

10

Construction details

🔧 Printed in grey PLA

🔧 Glue in place and together with super glue

👉 May be weathered/coloured with acrylic paints as desired

£2.49

Round Connector Bracket



Designed specifically to hold a Cliff Electronics (Cliffcon) chassis plug, available from Rapid Electronics (part numbers 50-3228 and 50-3230), or RS (part numbers 111-5760 and 111-5762)

Pack contents

1x bracket

Fixings and connector not supplied

Construction details

🔧 Printed in black PLA

🔧 Insert your connector and tighten, the nut will be retained in the housing without the need of a spanner

£1.49

D-Type Bracket



Do you still use the old D-types? If so, do you want a reliable and sturdy bracket for mounting it, that doesn't flex or break when the mating half is pushed in and pulled out? Look no further...

Four versions allow standard 9, 15, 25 and 37-way D-type connectors to be screwed into the mounting plate, and the bracket then secured with two screws

It is also possible to retrofit a wired connector by using the two designed in notches, just push the wired connector through at 90 degrees and then screw to the underside

Two pilot holes are built in to accept connector fixing screws

Pack contents

1x bracket to hold the chosen connector size

Fixings and D-type connector not supplied

Construction details

🔧 Printed in black PLA

🔧 Position your D-type in the slot and use two self-tapping screws to fix in place (M3 x 5mm is an ideal size)

Available for 9, 15, 25 and 37 way D-types

£1.49 / £1.99 / £2.49 / £2.99

Sky Board Clips



If like us you have hardboard (3mm thick) sky boards for your layout (and particularly a modular setup), then you might find these handy clips useful in keeping the top of the board joins aligned

Simply clip them over the top of each join and unclip when you are done

We have a few standard angles available, being 180° (straight), 45° and 90°

Measurements

Designed to fit over 3mm thick boards

Pack contents

5x clips (of selected angle)

Construction details

🔧 Printed in grey PLA

180° / 45° / 90°

£1.99 / £2.49 / £2.49

DCC Throttle Holder/Cradle



This bracket is suitable for securely holding a DT602, UT6 and all other legacy Digitrax throttles

May also suit Gagemaster and NCE throttles

Available in two colours and two fixing options

Measurements

The internal fixing version measures 71w x 90h x 39d (mm)

The flange fixing version measures 91w x 90h x 39d (mm)

Both versions have internal dimensions of 66w x 87h x 34d (mm approx.)

Pack contents

1x holder

Fixings not supplied

Construction details

🔧 Printed in black or matt orange PLA

£4.49/4.99

Bottle and paint tin stand



If like me, you have ever knocked over an open bottle of plastic weld glue or Micro Sol/Set decal solution then these handle little things will pay for them selves

They are ideal for holding the product while in use and make it much, much harder to tip over!

Measurements

The single 31mm diameter stand is ideal for Microscale's Micro Sol/Set product

The single 35mm diameter stand suites small tins of paint for example

The single 46mm diameter stand is great for bottles of plastic weld glue

The double 31mm diameter stand is ideal for holding both Microscale's Micro Sol and Micro Set products together

Pack contents

1x stand of selected size

Construction details

 Printed in PLA

£1.75/£1.99/£2.49/£2.75