



2023
2024
2025
2025.12
2026.1
2026.4
2026.7

Part Material:
Parzelle 663 + 664

General tolerances:
ISO 2768-m

Scale:
1 : 500

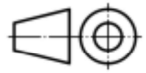

Title: Situation Entwicklung		Created by: Carl Batliner		Owner:	
Document type: Baueingabe Gelobtes Land		Approved by:			
Drawing number: 13		Language: DE	Issue date: 20.05.2026	Revision: E	Sheet: 1 / 1

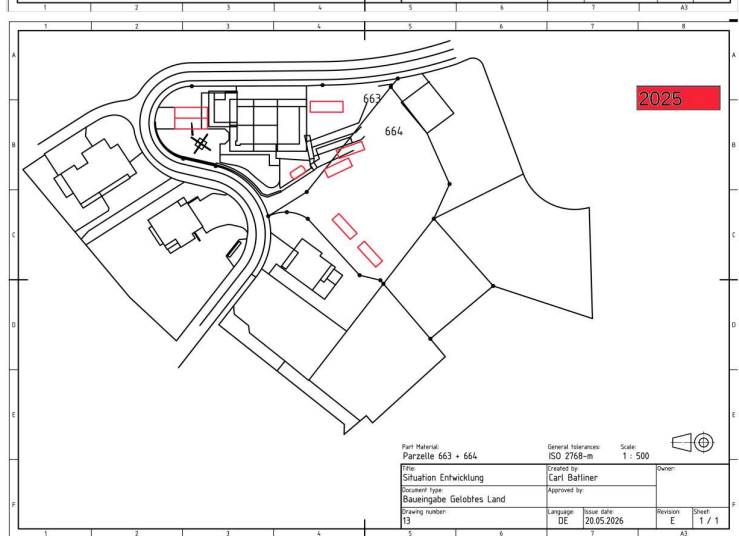
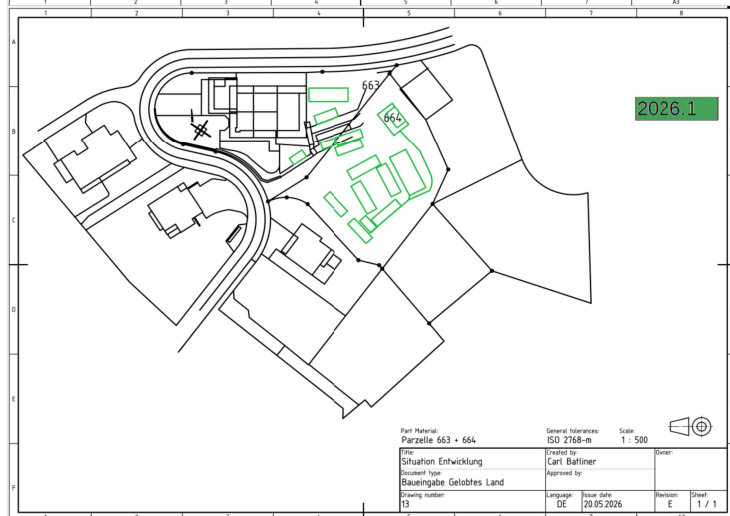
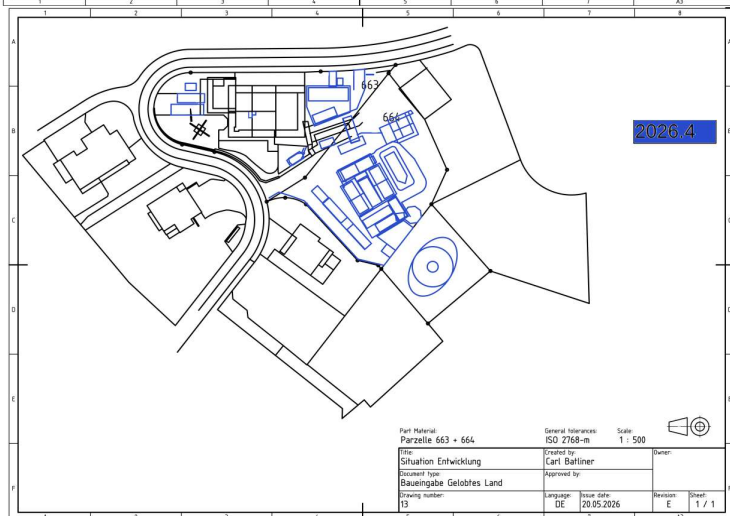
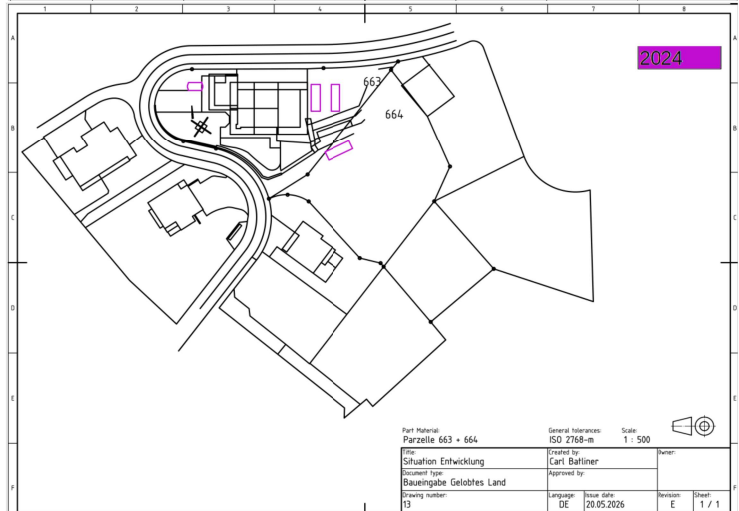
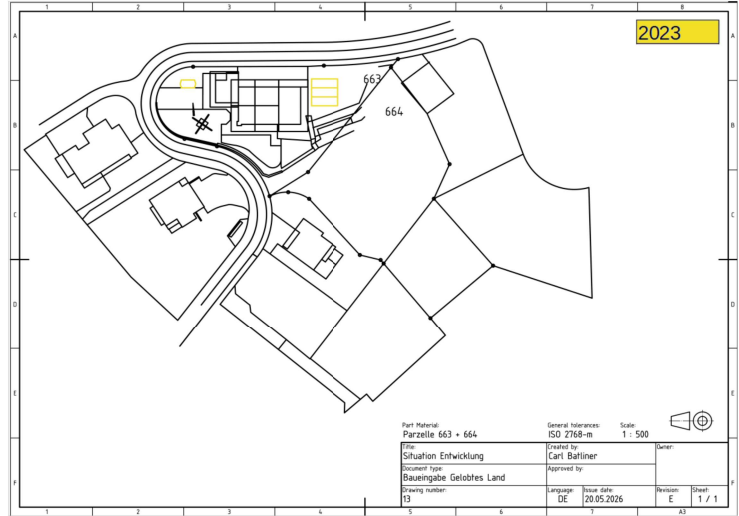
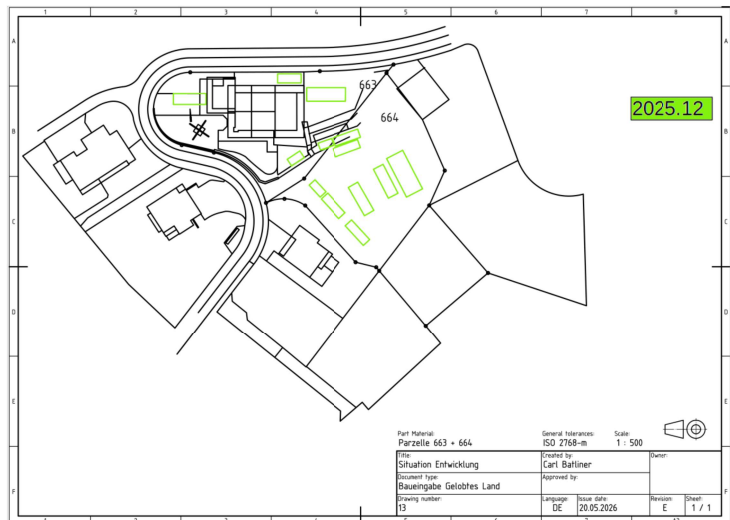
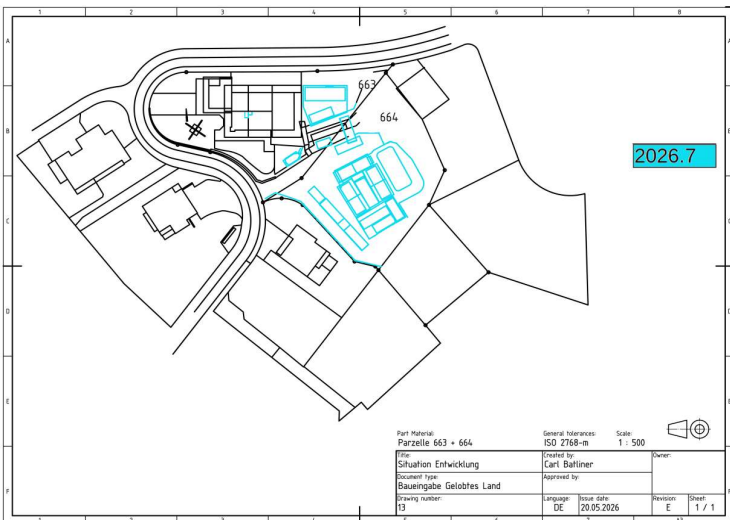

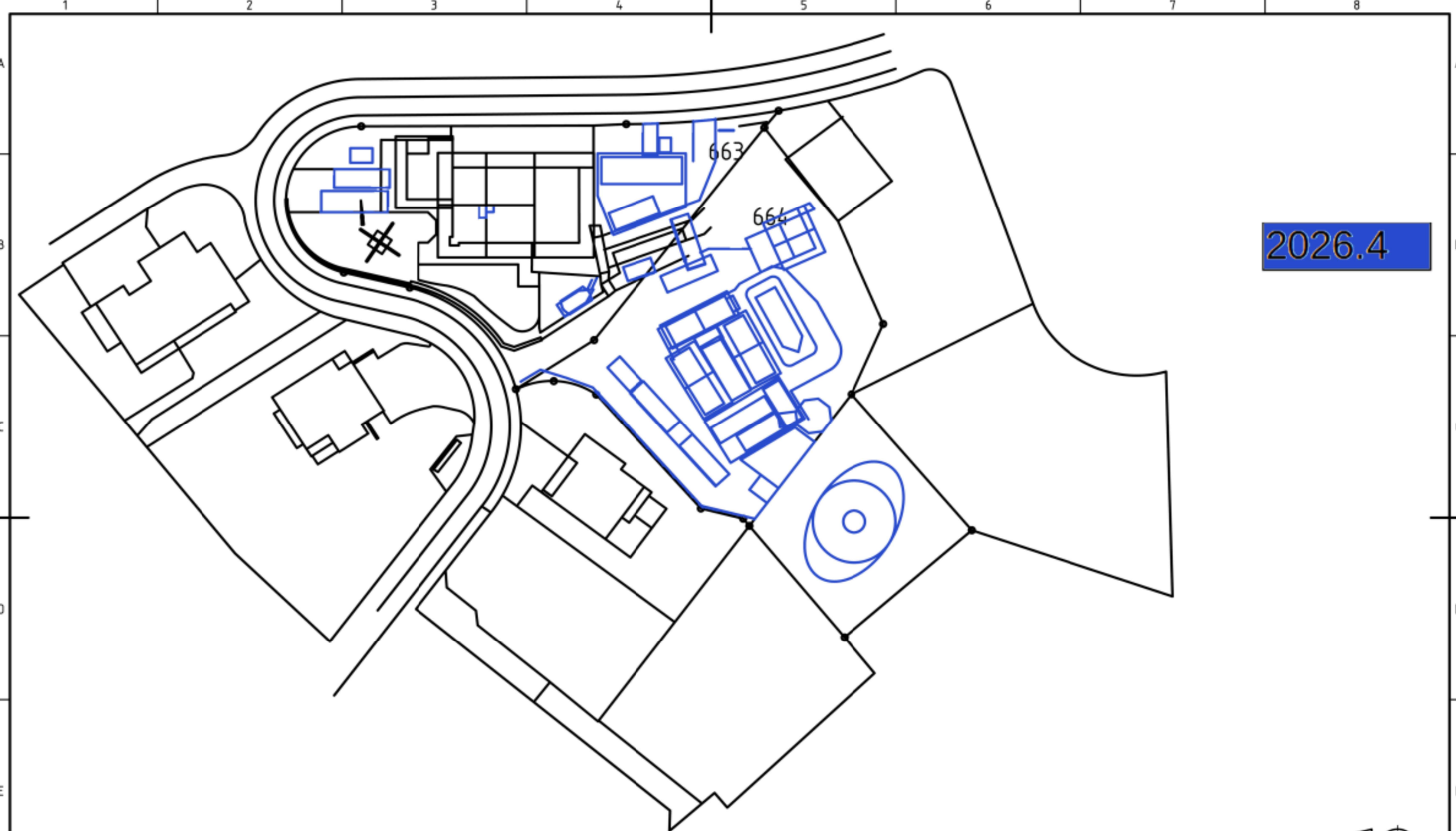

2026.4

Baueingabe 15.4.26
Langfristige Umsetzung

Part Material:
Parzelle 663 + 664

General tolerances:
ISO 2768-m

Scale:
1 : 500



Title: Situation Entwicklung		Created by: Carl Batliner		Owner:	
Document type: Baueingabe Gelobtes Land		Approved by:			
Drawing number: 13		Language: DE	Issue date: 20.05.2026	Revision: E	Sheet: 1 / 1

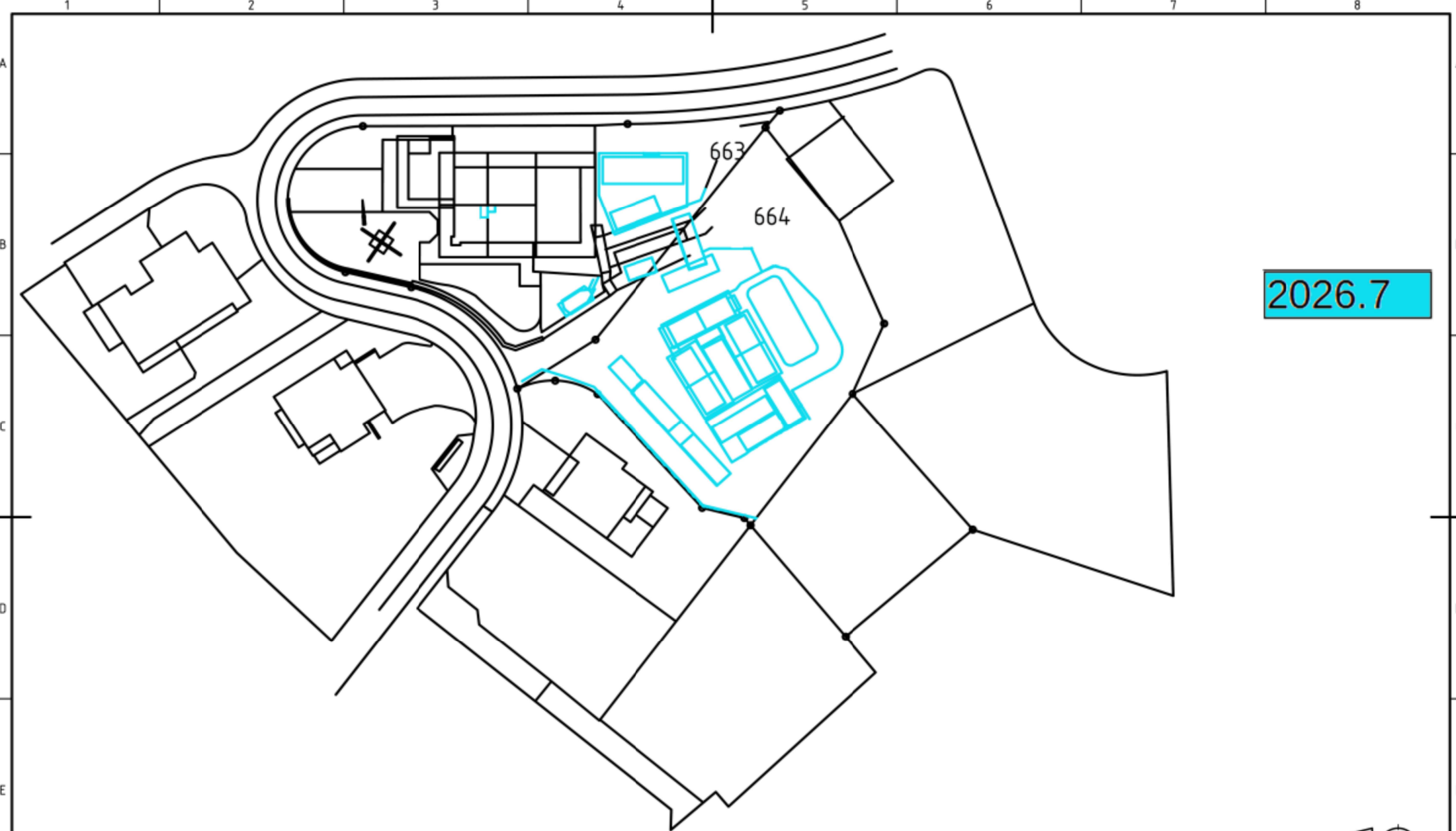

2026.7

Wiederherstellung 20.3.26
 Kurzfristige Umsetzung

Part Material:
 Parzelle 663 + 664

General tolerances:
 ISO 2768-m

Scale:
 1 : 500

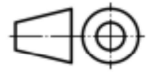

Title: Situation Entwicklung		Created by: Carl Batliner		Owner:	
Document type: Baueingabe Gelobtes Land		Approved by:			
Drawing number: 13		Language: DE	Issue date: 20.05.2026	Revision: E	Sheet: 1 / 1

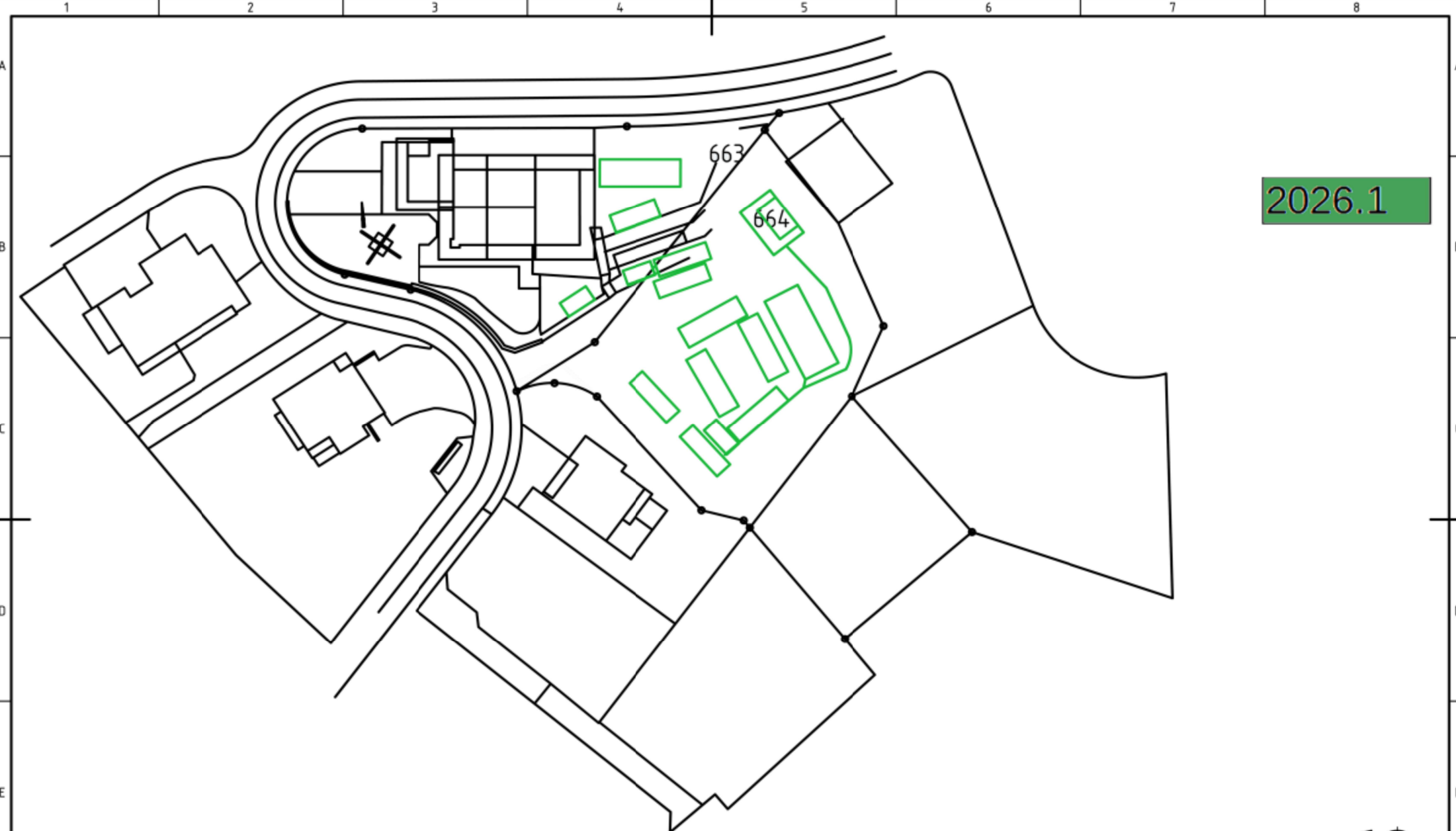

2026.1

Baueingabe 21.1.26

Part Material:
Parzelle 663 + 664

General tolerances:
ISO 2768-m

Scale:
1 : 500



Title: Situation Entwicklung		Created by: Carl Batliner		Owner:	
Document type: Baueingabe Gelobtes Land		Approved by:			
Drawing number: 13		Language: DE	Issue date: 20.05.2026	Revision: E	Sheet: 1 / 1

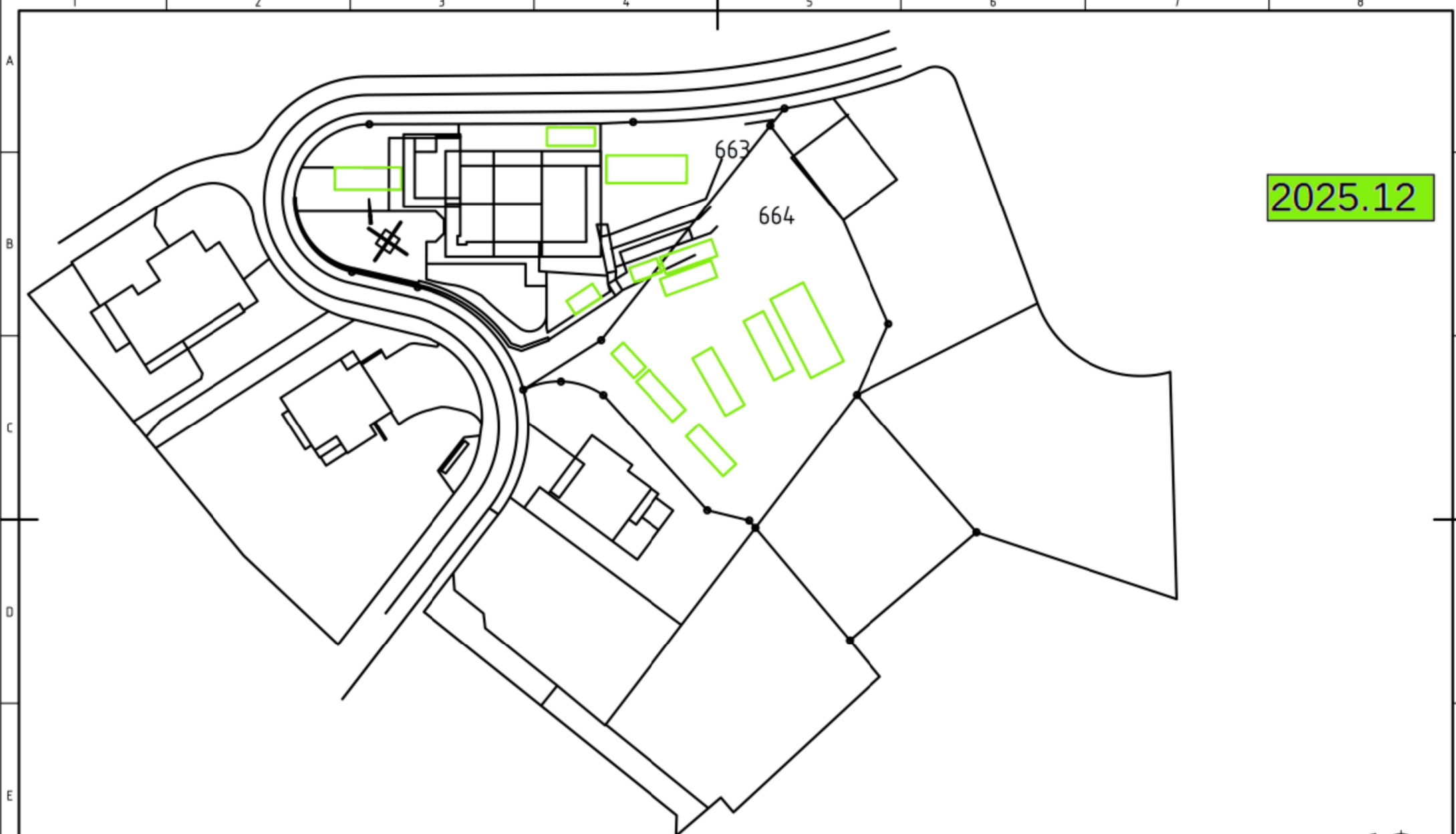

2025.12

Wiederherstellung 1.12.26
 Abbruch Aufforderung 18.3.26

Part Material:
 Parzelle 663 + 664

General tolerances:
 ISO 2768-m

Scale:
 1 : 500

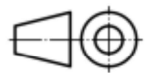

Title: Situation Entwicklung		Created by: Carl Batliner		Owner:	
Document type: Baueingabe Gelobtes Land		Approved by:			
Drawing number: 13		Language: DE	Issue date: 20.05.2026	Revision: E	Sheet: 1 / 1

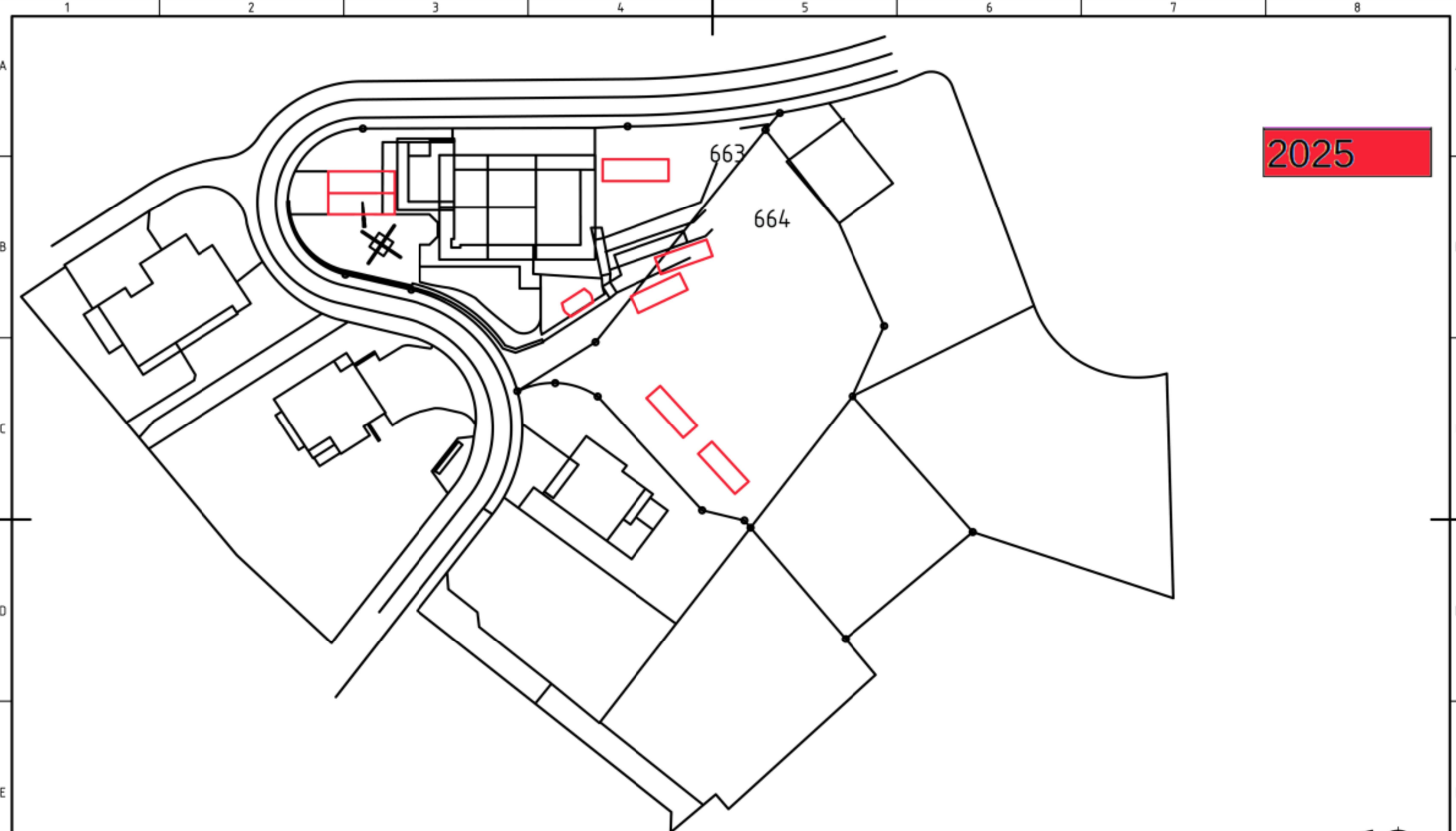

2025

Wiederherstellung 20.05.25
 Abbruch Aufforderung 6.11.24

Part Material:
 Parzelle 663 + 664

General tolerances:
 ISO 2768-m

Scale:
 1 : 500

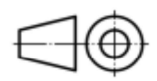

Title: Situation Entwicklung		Created by: Carl Batliner		Owner:	
Document type: Baueingabe Gelobtes Land		Approved by:			
Drawing number: 13		Language: DE	Issue date: 20.05.2026	Revision: E	Sheet: 1 / 1

2024

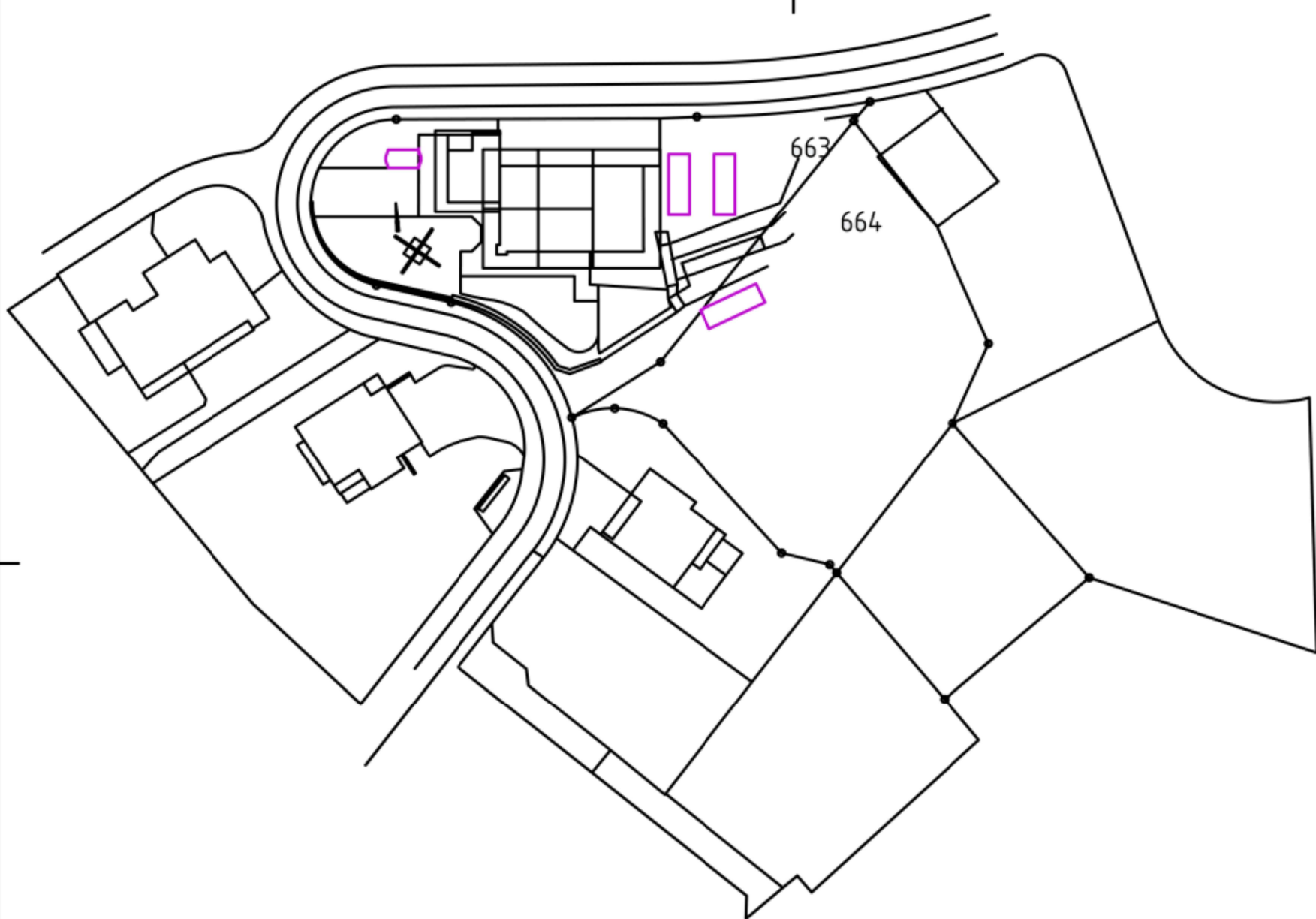

Baueingabe 20.6.24

Part Material:
Parzelle 663 + 664

General tolerances:
ISO 2768-m

Scale:
1 : 500

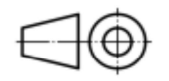

Title: Situation Entwicklung		Created by: Carl Batliner		Owner:	
Document type: Baueingabe Gelobtes Land		Approved by:			
Drawing number: 13		Language: DE	Issue date: 20.05.2026	Revision: E	Sheet: 1 / 1

2023

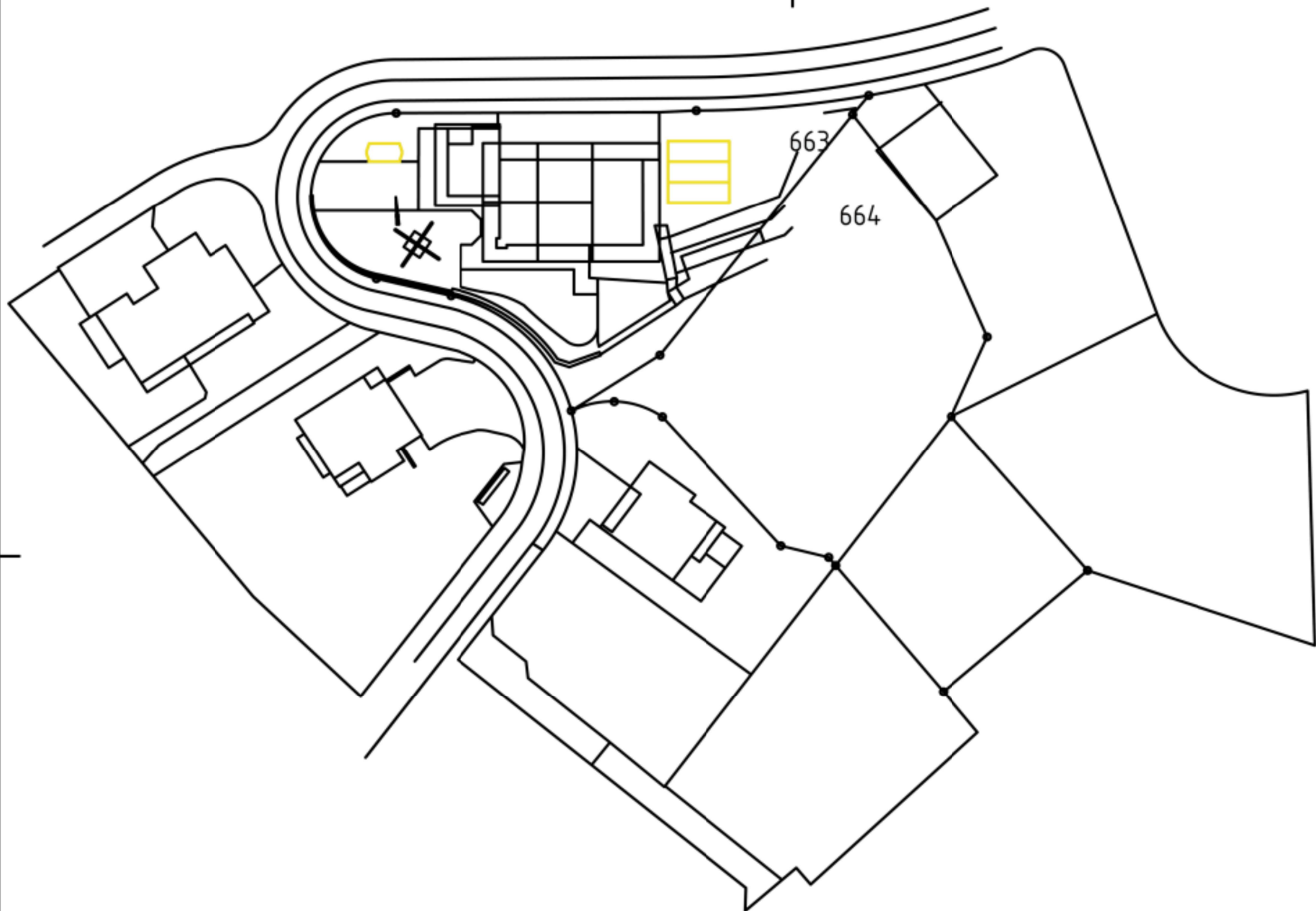

Baueingabe 7.3.23

Part Material:
Parzelle 663 + 664

General tolerances:
ISO 2768-m

Scale:
1 : 500



Title: Situation Entwicklung		Created by: Carl Batliner		Owner:	
Document type: Baueingabe Gelobtes Land		Approved by:			
Drawing number: 13		Language: DE	Issue date: 20.05.2026	Revision: E	Sheet: 1 / 1