



HYDRAULIC TORQUE WRENCH

Email Id: sales@zealindia.co.in

Phone No: +91 9137252196

www.zealindia.co.in

HYDRAULIC TORQUE WRENCH – ZSD-TYPE

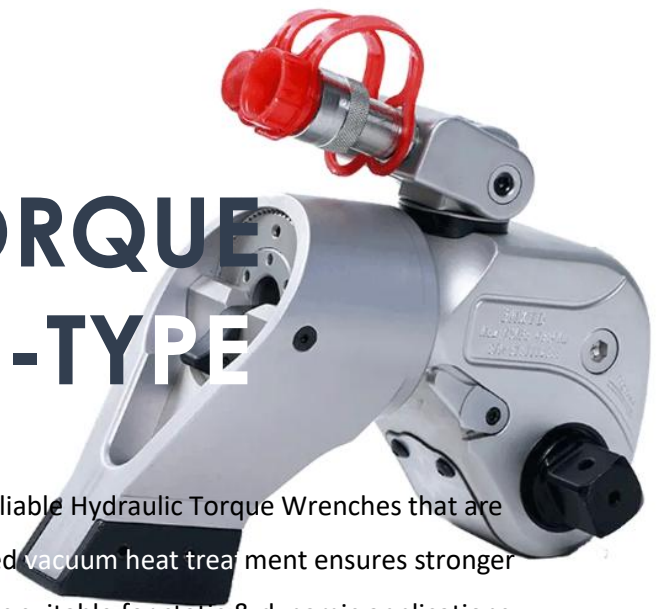

Zeal India manufactures Simple, Faster, Efficient and Reliable Hydraulic Torque Wrenches that are user friendly. The high strength alloy steel and controlled vacuum heat treatment ensures stronger drive components. Improved high pressure seal design is suitable for static & dynamic applications.

There are –

- Provision for lifting tools / handle
- Standard spline design with torque effective length for exact PCD engagement of reaction Arm
- High strength aerospace aluminum material for light weight and stronger body design
- Scratch proof hard anodized body and reaction arm



ZSD SERIES SQUARE DRIVE TORQUE WRENCHES

- QUICK PUSH THROUGH DRIVE FOR EASE OF LOOSENING AND TIGHTENING
- FINE RATCHET AND PAWL FOR BETTER ENGAGEMENT
- MULTI TOOTH DRIVE SEGMENT ENSURES UPTO 32°
- BALANCE DRIVE ROD - SIDE LOAD FREE PISTON MOVEMENT
- LASER ENGRAVED TORQUE CHART (NM & FT LBS)
- HARD CHROME PLATING OF PISTON ROD WHICH ENSURES BETTER WEAR RESISTANCE OF ROD SEAL.
- SELF LUBRICATING LOW NICKEL BRONZE DRIVE BUSH TO PROTECT BODY FROM WEAR
- 360° X 180° SWIVEL FOR BETTER DEGREE OF MOVEMENT
- LEAK PROOF QUICK CONNECT COUPLERS FOR EASY & SAFE OPERATION
- END-CAP DESIGN FOR SUFFICIENT BACK PRESSURE FOR SMOOTH PISTON FORWARD FORCE
- RIGID REACTION SUITABLE FOR HEAVY LOAD APPLICATION
- SIMPLE DESIGN REACTION ARM RELEASE BUTTON FOR EASE OF OPERATIONS
- ALLOY STEEL REACTION BOOT (AVAILABLE IN MULTI-COLOR OPTION)
- COLD WORKED CYLINDER BORE FOR LONGER LIFE AND SUPER FINISH FOR LONG WORKING CONDITIONS.

ZSD SERIES SQUARE DRIVE TORQUE WRENCHES

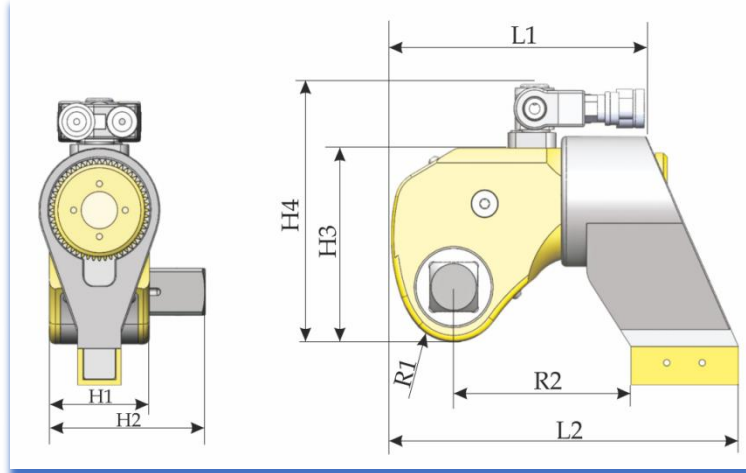

Model No.	Square Drive	Min. Torque (Kg-m)	Min. Torque (Ft/Lbs)	Max. Torque (Kg-m)	Max. Torque (Ft/Lbs)	Output Accuracy	Tool Weight (Kgs)
ZSD-0.75	3/4"	10	72	106	766	+/-3%	1
ZSD-1	3/4"	13	94	126	911	+/-3%	1.25
ZSD-2	3/4"	18	132	183	1325	+/-3%	2.5
ZSD-3	1"	45	330	460	3330	+/-3%	4.2
ZSD-5	1.1/2"	78	565	774	5600	+/-3%	8.4
ZSD-7	1.1/2"	102	740	1020	7400	+/-3%	8.9
ZSD-11	1.1/2"	162	1174	1612	11659	+/-3%	13.6
ZSD-15	2.1/2"	204	1475	2040	14755	+/-3%	22
ZSD-20	2.1/2"	268	1940	2852	20265	+/-3%	28.5
ZSD-27	2.1/2"	375	2720	3762	27200	+/-3%	32.7
ZSD-60	2.1/2"	802	5800	8020	58000	+/-3%	60.8
ZSD-100	3.1/2"	1390	10053	13900	100538	+/-3%	109

DIMENSIONAL DATA

Model No.	Height (mm)	Height (inch)	Length 1 (mm)	Length 1 (inch)	Length 2 (mm)	Length 2 (inch)	Radius (mm)	Radius (inch)	Width 1 (mm)	Width 1 (inch)	Width 2 (mm)	Width 2 (inch)	Width 3 (mm)	Width 3 (inch)
ZSD-0.75	78	3	120	4.75	91.5	3.6	18.7	0.74	40	1.57	52.6	2	86.7	3.4
ZSD-1	88	3.5	94	3.7	123	4.8	20	0.78	42	1.65	65	2.55	87	3.43
ZSD-2	105	4.15	121	4.76	160	6.3	25	0.98	51	2.01	72	2.81	118	4.63
ZSD-3	135	5.3	153	6.02	213	8.38	33	1.28	67	2.64	93	3.67	149	5.85
ZSD-5	163	6.4	194	7.62	254	10	41	1.62	82	3.22	116	4.55	175	6.89
ZSD-7	182	7.17	208	8.2	291	11.5	45	1.78	92	3.61	105	4.13	204	8.03
ZSD-11	198	7.81	227	8.95	313	12.3	50	1.96	100	3.94	137	5.38	225	8.86
ZSD-15	232	9.13	295	11.6	373	14.7	58.7	2.3	100	3.93	158	6.2	252	9.93
ZSD-20	237	9.35	274	10.8	390	15.4	58.2	2.29	123	4.86	183	7.19	275	10.8
ZSD-27	259	10.2	294	11.6	415	16.4	63	2.46	134	5.28	194	7.65	293	11.5
ZSD-60	292	11.5	367	14.5	522	20.6	74	2.9	167	6.57	260	10.3	372	14.6
ZSD-100	349	13.7	469	18.5	619	24.4	95	3.74	200	7.87	310	12.3	416	16.2

HYDRAULIC TORQUE WRENCH – ZXD-TYPE



- 01) Self-lubricating low Nickel Bronze for drive bush to protect body from wear.
- 02) Fine Ratchet & Pawl for better engagement
- 03) Auto engagement of rod in first stroke
- 04) Slider prevents wear of piston and drive plate
- 05) Leak proof quick connecting coupler
- 06) 360°x180° swivel for better degree of movement
- 07) Round shaped simple cylinder design
- 08) Hard chrome plating of piston rod for wear resistance
- 09) High quality German seals for high pressure design
- 10) Torsion free reaction pad
- 11) Balanced load on side plate due to alignment pin
- 12) Cold worked cylinder bore for longer life and superfinish for long working condition
- 13) Never-Lock drive pawl

ZEAL INDIA ZXD Series Direct Hex Drive Hydraulic Torque Wrenches are designed for extreme low spaces where normal tools cannot reach. The light weight & compact hydraulic cylinder is made of special Aircraft Grade Aluminum Alloy and the internal spares are made of high Nickel Alloy Steel. There are 5 Models in ZXD Series ranging from 230 - 45000 Nm. All models have small nose radius which allows the tool to fit in such areas where space constraint is observed.



Technical Data	Units	ZXD-2		ZXD-4		ZXD-8		ZXD-14	ZXD-32	
Min. Torque	Nm	293	305	608	673	1192	1283	2222	5026	5351
	Ft. Lbs	214	221	443	489	867	932	1615	3652	3888
Max. Torque	Nm	2943	3051	6092	6733	11926	12834	22225	50258	53512
	Ft. Lbs	2137	2217	4426	4891	8863	9323	16147	36511	38875
Across Flat	mm	19-55	55-60	34-65	70-80	41-95	100-105	50-117	110-155	160-175
	Inch	3/4-2.3/16	2.3/16-2.3/8	1.5/16-2.9/16	2.3/4-3.1/8	1.5/8-3.3/4	3.7/8-4.1/8	2-4.1/2	4.1/4-6.1/8	6.1/8-6.7/8
Drive Unit Weight	Kg	1.5	1.5	3.2	3.2	5.3	5.3	9.8	15	15
	Lbs.	3.3	3.3	7	7	11.6	11.6	21.6	33	33
Ratchet Unit Weight	Kg	1.7	1.85	4.1	4.2	8.7	8.8	11.5	32	35
	Lbs.	3.7	4	9	9.2	19	19.4	25	70	77

ACCESSORIES

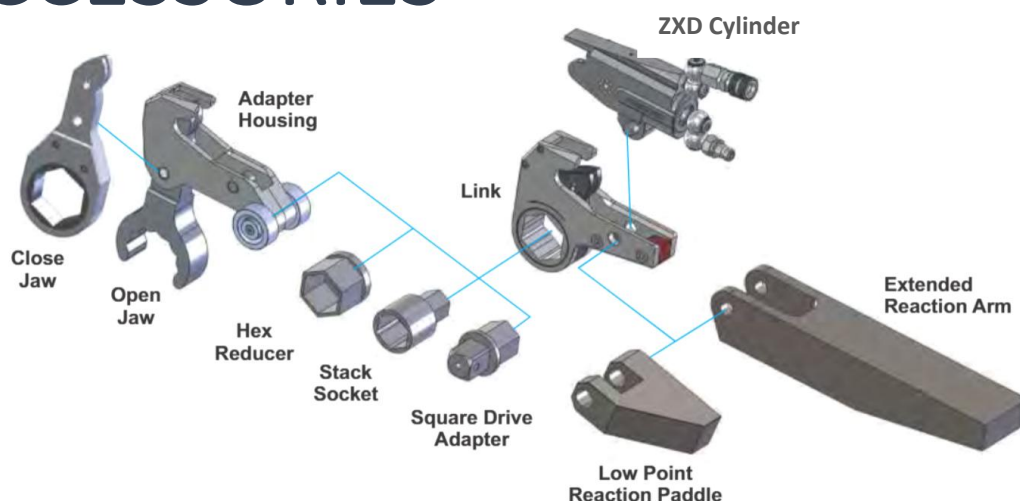

HYDRAULIC POWERPACK

MODEL -ZEP-1 HIGH FLOW - HIGH SPEED FOR HEAVY DUTY APPLICATION

(Electric Operated)

- Quadra-Port Multi-Port Manifold (Max. 4 Ports).
- Cool running continuous duty axial piston pump.
- Single phase induction motor. 115V and 230V available.
- Starts under full load. Runs on reduced voltage.
- Quiet operation (approx. 80 dBA @ 10,000 PSI).
- Rugged remote pendant to control motor and valve.
- Easily adjustable pressure control knob.
- Auto-dump relieves oil pressure from hoses.
- Completely enclosed motor housing and electronics.
- 2 Gallon oil reservoir. Precise PSI/BAR pressure gauge.
- Quick-connect no-drip couplers with safety locking collar.
- Supplied with dual non-conductive high pressure hose with couplers.



TECHNICAL SPECIFICATION

Resvr. Size (Gal.)	Valve		Motor Specifications	Flow Rate		Weight	
	Control	Type		600 psi	10,000 psi	kg	lbs
2	Solenoid	3 Way/2 Pos.	1.5 HP Single Phase	11 lpm	0.9 lpm	38	84

Retract pressure is preset at 1,300 PSI.

MODEL -ZAP-1

HIGH FLOW - HIGH SPEED FOR HEAVY DUTY APPLICATION

(Pneumatic Operated)

- Quadra-Port Multi-Port Manifold (Max. 4 Ports).
- Cool running continuous duty axial piston pump.
- Powerful industrial duty air motor.
- Starts under full load. Runs on reduced voltage.
- Quiet operation (approx. 80 dBA @ 10,000 PSI).
- Rugged remote pendant to control motor and valve.
- Easily adjustable pressure control knob.
- Auto-dump relieves oil pressure from hoses.
- Completely enclosed motor housing and electronics.
- 2 Gallon oil reservoir. Precise PSI/BAR pressure gauge.
- Quick-connect no-drip couplers with safety locking collar.
- Supplied with dual non-conductive high pressure hose with couplers.

TECHNICAL SPECIFICATION

Resvr. Size (Gal.)	Valve		Motor Specifications	Flow Rate		Weight	
	Control	Type		600 psi	10,000 psi	kg	lbs
2	Solenoid	3 Way/2 Pos.	1.5 HP Single Phase	11 lpm	0.9 lpm	38	84

Retract pressure is preset at 1,300 PSI.

