



TACLAB

**SPIROLOX
ANELLI D'ARRESTO**



SERIES "S" EXTERNAL

IMPERIAL SIZES

GROOVE DIMENSIONS

RING DIMENSIONS—TWO TURN

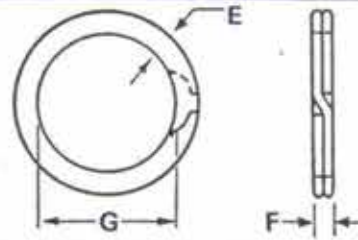
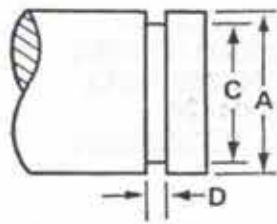

Ring Number	A Shaft Diam. inches	A Shaft Diam. m/m.	Groove Depth	C Diam.	C Tolerance	D Width	E Radial Wall	F Thickness	G Free Diam.	G Tolerance	Approx. Wt. lb. per 1000 lb.	Thrust Load lb.
RS.50	-.500	12.7	-.014	-.472	+.004	-.030+-.003	-.045	-.025±.002	-.467	+.000	-.48	1,260
RS.53	-.531	13.5	-.014	-.503	—000	—000	-.045	-.498	—013	-.49	1,340	
RS.56	-.562	14.3	-.014	-.534			-.045	-.529		-.54	1,410	
RS.59	-.594	15.1	-.014	-.566			-.045	-.561		-.58	1,490	
RS.62	-.625	15.9	-.017	-.591			-.055	-.585		-.72	1,570	
RS.65	-.656	16.7	-.017	-.622			-.055	-.617		-.76	1,650	
RS.68	-.687	17.5	-.017	-.653			-.055	-.647		-.79	1,730	
RS.71	-.718	18.3	-.017	-.684			-.055	-.679		-.81	1,810	
RS.75	-.750	19.0	-.017	-.716	+.004	-.036+-.003	-.065	-.031±.002	-.710	+.000	1.06	2,360
RS.78	-.781	19.8	-.017	-.747	—000	—000	-.065	-.741	—013	1.10	2,460	
RS.81	-.812	20.6	-.017	-.778			-.065	-.771		1.15	2,560	
RS.84	-.843	21.4	-.017	-.809			-.065	-.803		1.30	2,660	
RS.87	-.875	22.2	-.020	-.835			-.065	-.828		1.48	2,760	
RS.90	-.906	23.0	-.020	-.866			-.065	-.860		1.51	2,840	
RS.93	-.937	23.8	-.020	-.897			-.065	-.889		1.59	2,920	
RS.96	-.968	24.4	-.023	-.922	+.005	-.042+-.003	-.075	-.037±.002	-.916	+.000	1.98	3,620
RS.98	-.984	25.0	-.023	-.938	—000	—000	-.075	-.930	—013	2.31	3,720	
RS.100	1.000	25.4	-.023	-.954			-.075	-.946		2.34	3,780	
RS.102	1.023	26.0	-.023	-.977			-.075	-.968		2.39	3,860	
RS.103	1.031	26.3	-.023	-.985			-.075	-.978		2.43	3,900	
RS.106	1.062	27.0	-.023	1.016			-.075	1.007	+.000	2.46	4,010	
RS.109	1.093	27.8	-.023	1.047			-.075	1.040	—015	2.53	4,120	
RS.112	1.125	28.5	-.023	1.079			-.075	1.070		2.60	4,240	
RS.115	1.156	29.3	-.023	1.110			-.075	1.102		2.67	4,350	
RS.118	1.188	30.2	-.026	1.136	+.008	-.048+-.004	-.085	-.043±.002	1.127	+.000	3.51	5,200
RS.121	1.218	31.0	-.026	1.166	—000	—000	-.085	1.159	—015	3.63	5,340	
RS.125	1.250	31.7	-.026	1.198			-.085	1.188		3.75	5,520	
RS.128	1.281	32.6	-.026	1.229			-.085	1.221		3.84	5,650	
RS.131	1.312	33.3	-.026	1.260			-.095	1.251		3.94	5,770	
RS.134	1.343	34.1	-.026	1.291			-.095	1.282		4.25	5,910	
RS.137	1.375	34.9	-.028	1.319			-.095	1.308		4.65	6,050	
RS.140	1.406	35.8	-.028	1.350			-.095	1.340		4.74	6,170	
RS.143	1.437	36.5	-.028	1.381			-.095	1.370		4.82	6,310	
RS.146	1.468	37.3	-.028	1.412			-.095	1.402		4.91	6,450	
RS.150	1.500	38.1	-.028	1.444			-.095	1.433		4.99	6,620	
RS.156	1.562	39.6	-.030	1.502	+.010	-.056+-.004	-.108	-.049±.003	1.490	+.000	6.80	7,860
RS.162	1.625	41.7	-.032	1.561	—000	—000	-.108	1.549	—020	7.14	8,170	
RS.168	1.687	42.8	-.032	1.623			-.118	1.610		7.62	8,470	
RS.175	1.750	44.4	-.032	1.686			-.118	1.673		7.84	8,820	
RS.177	1.771	44.9	-.034	1.703			-.118	1.690		8.46	8,920	

Taclab: info@taclab.net
3341016916

Single and multi-turn rings to customers' dimensions can be manufactured subject to design and material confirmation.

New sizes are continually added to the range. If your existing groove dimensions are not shown herein, please forward details of your requirements.

SERIES "S" EXTERNAL

IMPERIAL SIZES

GROOVE DIMENSIONS

RING DIMENSIONS—TWO TURN

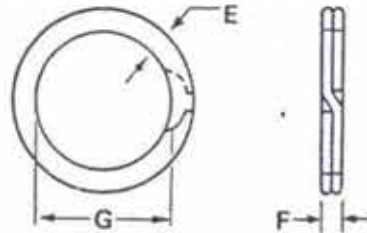
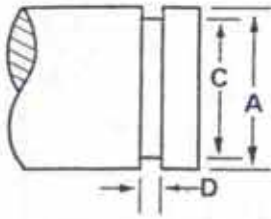

Ring Number	A Shaft Diam. inches	A Shaft Diam. m/m.	Groove Depth	C. Diam.	C. Tolerance	D Width	E Radial Wall	F Thickness	Free Diam.	G Tolerance	Approx. Wt. lb. per 1000	Thrust Load lb.
RS.181	1-812	46-0	-.034	1-744	+.010	-.056 +.004	-.118	-.049 ± .003	1-730	+.000	8-52	9,120
RS.187	1-875	47-6	-.036	1-803	-.000	-.000	-.128		1-789	-.020	9-24	9,420
RS.193	1-937	49-2	-.036	1-856			-.128		1-844		9-41	9,730
RS.196	1-969	50-0	-.036	1-897			-.128		1-882		9-65	9,880
RS.200	2-000	50-8	-.038	1-924			-.128		1-909		10-10	10,080
RS.206	2-062	52-3	-.038	1-986	+.012		-.128		1-971		10-40	10,350
RS.212	2-125	53-9	-.040	2-045	-.000		-.128		2-029		10-70	10,650
RS.215	2-156	54-7	-.040	2-076			-.138		2-060	+.000 -.025	11-40	10,850
RS.218	2-187	55-6	-.040	2-107			-.138		2-092		11-60	11,000
RS.225	2-250	57-1	-.040	2-170			-.138		2-153		11-90	11,350
RS.231	2-312	58-7	-.042	2-228			-.138		2-211		12-80	11,650
RS.236	2-362	59-9	-.042	2-278			-.138		2-261		12-90	11,900
RS.237	2-375	60-3	-.042	2-291			-.138		2-273		13-10	11,950
RS.243	2-437	61-9	-.044	2-349			-.148		2-331		13-80	12,250
RS.250	2-500	63-5	-.044	2-412			-.148		2-394		14-20	12,600
RS.255	2-559	64-9	-.046	2-467			-.148		2-449		15-20	12,850
RS.256	2-562	65-1	-.046	2-470			-.148		2-452		15-30	12,900
RS.262	2-625	66-6	-.046	2-533			-.148		2-514		15-50	13,200
RS.268	2-687	68-2	-.048	2-591			-.158		2-572		16-30	13,500
RS.275	2-750	69-8	-.048	2-654			-.158		2-635	+.000	16-80	13,850
RS.281	2-812	71-5	-.048	2-716			-.168		2-696	-.030	17-70	14,150
RS.287	2-875	73-0	-.050	2-775			-.168		2-755		18-80	14,450
RS.293	2-937	74-5	-.050	2-837			-.168		2-817		19-00	14,750
RS.295	2-952	74-9	-.050	2-852			-.168		2-831		19-20	14,850
RS.300	3-000	76-1	-.051	2-898	+.012	-.068 +.005	-.168	-.061 ± .003	2-877	+.000	24-50	18,600
RS.306	3-062	77-7	-.051	2-960	-.000	-.000	-.168		2-938	-.030	25-00	18,900
RS.312	3-125	79-3	-.052	3-021			-.178		3-000		26-20	19,300
RS.314	3-149	79-9	-.052	3-045			-.178		3-023		26-80	19,400
RS.318	3-187	81-0	-.052	3-083			-.178		3-061		27-40	19,700
RS.325	3-250	82-5	-.053	3-144			-.178		3-121		28-00	20,000
RS.331	3-312	84-4	-.055	3-202			-.188		3-180		29-20	20,500
RS.334	3-343	84-9	-.055	3-233			-.188		3-210		29-60	20,700
RS.337	3-375	85-8	-.055	3-265			-.188		3-242		30-10	20,800
RS.343	3-437	87-2	-.056	3-325			-.188		3-301		31-20	21,200
RS.350	3-500	88-8	-.056	3-388			-.188		3-363	+.000	31-80	21,700
RS.354	3-543	89-9	-.058	3-427			-.198		3-402	-.040	32-80	21,900
RS.356	3-562	90-5	-.058	3-446			-.198		3-422		33-10	22,100
RS.362	3-625	92-0	-.058	3-509			-.198		3-483		33-80	22,400
RS.368	3-687	93-6	-.059	3-569			-.198		3-543		35-00	22,800
RS.374	3-740	95-0	-.059	3-622			-.198		3-597		35-70	23,200
RS.375	3-750	95-2	-.059	3-632			-.198		3-606		35-80	23,250
RS.381	3-812	97-1	-.059	3-694			-.198		3-668		37-30	23,600
RS.387	3-875	98-3	-.062	3-751			-.208		3-724		38-70	24,000
RS.393	3-938	99-9	-.062	3-814			-.208		3-784		39-30	24,300
RS.400	4-000	101-5	-.065	3-870			-.218		3-842		41-60	24,800
RS.406	4-063	103-2	-.065	3-933			-.218		3-906		42-40	25,100
RS.412	4-125	104-8	-.065	3-995			-.218		3-967		43-30	25,500
RS.413	4-134	105-0	-.065	4-004			-.218		3-975		43-40	25,600
RS.425	4-250	107-9	-.068	4-114			-.228		4-084		46-30	26,300
RS.431	4-312	109-5	-.068	4-176			-.228		4-147		47-00	26,700
RS.433	4-331	110-0	-.068	4-195			-.228		4-164		47-30	26,800
RS.437	4-375	111-0	-.068	4-239			-.228		4-208		49-00	27,100
RS.443	4-437	112-7	-.068	4-301			-.228		4-271		50-10	27,500
RS.450	4-500	114-2	-.071	4-358			-.238		4-326		51-20	27,900
RS.456	4-562	116-0	-.073	4-416	+.012	-.079 +.005	-.250	-.072 ± .004	4-384	+.000	71-20	33,500
RS.462	4-625	117-4	-.073	4-479	-.000	-.000	-.250		4-447	-.040	72-30	33,900
RS.468	4-687	119-0	-.073	4-541			-.250		4-508		72-90	34,500
RS.472	4-724	120-0	-.073	4-578			-.250		4-546		73-80	34,700

TACLAB

SERIES "S" EXTERNAL

IMPERIAL SIZES

GROOVE DIMENSIONS

RING DIMENSIONS—TWO TURN

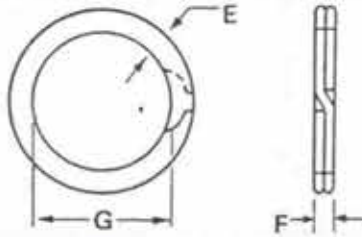
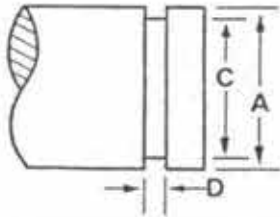

Ring Number RS	A Shaft Diam. inches	A m/m.	Groove Depth	C Diam.	C Tolerance	D Width	E Radial Wall	F Thickness	Freq. Diam.	G Tolerance	Approx. Wt. lb. per 1000	Thrust Load lb.
RS.475	4.750	120.6	-.073	4.604	+.012	-.079+.005	-.250	-.072±.004	4.571	+.000	74.2	34,900
RS.481	4.812	122.2	-.073	4.666	—000	—000	-.250		4.633	—040	75.3	35,300
RS.487	4.875	123.8	-.073	4.729			-.250		4.695		76.3	35,800
RS.493	4.937	125.4	-.073	4.791			-.250		4.757		77.3	36,200
RS.500	5.000	126.9	-.075	4.850			-.250		4.820		78.2	36,800
RS.511	5.118	130.0	-.075	4.968			-.250		4.934		80.1	37,500
RS.512	5.125	130.1	-.075	4.975			-.250		4.939		80.2	38,000
RS.525	5.250	133.2	-.075	5.100	+.014		-.250		5.064	+.000	82.0	38,600
RS.537	5.375	136.5	-.077	5.221	—000		-.250		5.187	—050	84.0	39,500
RS.550	5.500	139.9	-.077	5.346			-.250		5.308		85.9	40,500
RS.551	5.511	140.0	-.077	5.357			-.250		5.320		86.0	40,600
RS.562	5.625	142.8	-.077	5.471			-.250		5.438		87.8	41,300
RS.575	5.750	145.9	-.080	5.590			-.250		5.550		89.7	42,300
RS.587	5.875	149.2	-.080	5.715			-.250		5.674		91.6	43,200
RS.590	5.905	150.0	-.080	5.745			-.250		5.705		92.7	43,400
RS.600	6.000	152.3	-.080	5.840			-.250		5.798		93.5	44,100
RS.612	6.125	155.6	-.090	5.945	+.016	-.094+.006	-.312	-.086±.004	5.903	+.000	144.0	54,000
RS.625	6.250	158.8	-.090	6.070	—000	—000	-.312		6.026	—060	148.0	55,200
RS.629	6.299	160.0	-.090	6.119			-.312		6.076		149.0	55,500
RS.637	6.375	162.0	-.090	6.195			-.312		6.152		150.0	56,200
RS.650	6.500	165.1	-.090	6.320			-.312		6.274		153.0	57,300
RS.662	6.625	168.3	-.095	6.435			-.312		6.390		156.0	58,400
RS.675	6.750	171.4	-.095	6.560			-.312		6.513		158.0	59,500
RS.687	6.875	174.6	-.095	6.685			-.312		6.638		162.0	60,600
RS.700	7.000	177.8	-.095	6.810			-.312		6.761		164.0	61,600
RS.712	7.125	181.0	-.100	6.925			-.312		6.877		167.0	62,800
RS.725	7.250	184.1	-.100	7.050			-.312		6.999		170.0	64,000
RS.737	7.375	187.3	-.100	7.175			-.312		7.125		173.0	65,000
RS.750	7.500	190.5	-.100	7.300			-.312		7.250	+.000	176.0	66,300
RS.762	7.625	193.7	-.105	7.415			-.312		7.363	—070	178.0	67,200
RS.775	7.750	196.8	-.105	7.540			-.312		7.486		181.0	68,400
RS.787	7.875	200.0	-.105	7.665			-.312		7.611		184.0	69,400
RS.800	8.000	203.0	-.105	7.790			-.312		7.734		187.0	70,600
RS.825	8.250	209.5	-.110	8.030	+.016	-.094+.006	-.375	-.086±.004	7.972	+.000	233.0	72,800
RS.850	8.500	216.0	-.110	8.280	—000	—000	-.375		8.220	—070	240.0	75,000
RS.875	8.750	222.2	-.115	8.520			-.375		8.459		249.0	77,200
RS.900	9.000	228.6	-.115	8.770			-.375		8.707		254.0	79,400
RS.925	9.250	235.0	-.120	9.010			-.375		8.945		260.0	81,500
RS.950	9.500	241.0	-.120	9.260			-.375		9.194		267.0	83,800
RS.975	9.750	247.8	-.125	9.500			-.375		9.432		274.0	86,000
RS.1000	10.000	254.0	-.125	9.750			-.375		9.680		281.0	88,200
RS.1025	10.250	260.7	-.130	9.990			-.375		9.918		288.0	90,500
RS.1050	10.500	265.0	-.130	10.240			-.375		10.166		295.0	92,700
RS.1075	10.750	273.0	-.135	10.480			-.375		10.405		301.0	95,000
RS.1100	11.000	279.6	-.135	10.730			-.375		10.653		309.0	97,000

Taclab: info@taclab.net
3341016916

TACLALAB

SERIES "S" INTERNAL

IMPERIAL SIZES

GROOVE DIMENSIONS

RING DIMENSIONS—TWO TURN

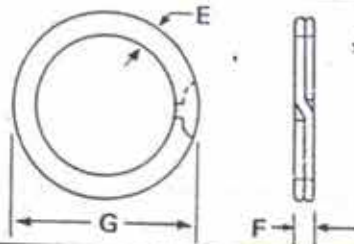
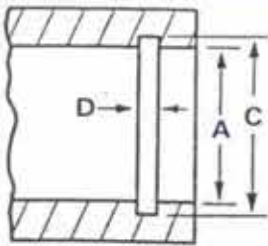

Ring Number	A Housing Diam. inches	A Housing Diam. m/m.	Groove Depth	C Diam.	C Tolerance	D Width	E Radial Wall	F Thickness	G Free Diam.	G Tolerance	Approx. Wt. lb. per 1000	Thrust Load lb.
RR.50	.500	12.7	.014	.528	+000 -004	.030+.003 -000	.045	.025±.002	.532	+013 -000	.47	1,260
RR.53	.531	13.5	.014	.559			.045		.564		.50	1,340
RR.56	.562	14.3	.014	.590			.045		.594		.53	1,410
RR.59	.593	15.1	.014	.621			.045		.626		.56	1,490
RR.62	.625	15.9	.014	.653			.045		.658		.59	1,570
RR.65	.656	16.7	.014	.684			.045		.689		.66	1,650
RR.68	.687	17.2	.014	.715			.045		.720		.74	1,730
RR.71	.718	18.2	.014	.746			.045		.751		.81	1,810
RR.75	.750	19.0	.017	.784	+000 -006	.036+.003 -000	.065	.031±.002	.790	+013 -000	1.04	2,360
RR.77	.777	19.7	.017	.811			.065		.817		1.08	2,440
RR.78	.781	19.8	.017	.815			.065		.821		1.09	2,460
RR.81	.812	20.6	.017	.846			.065		.853		1.13	2,560
RR.84	.843	21.4	.020	.883			.065		.889		1.30	2,660
RR.87	.875	22.2	.020	.915			.065		.922		1.44	2,760
RR.90	.901	22.9	.020	.941			.065		.949		1.48	2,840
RR.93	.938	23.8	.020	.978			.065		.986		1.54	2,920
RR.96	.968	24.6	.025	1.018	+000 -006	.042+.003 -000	.075	.037±.002	1.025	+013 -000	2.21	3,620
RR.100	1.000	25.4	.023	1.046			.075		1.054		2.26	3,780
RR.103	1.031	26.2	.023	1.077			.075		1.084		2.32	3,900
RR.106	1.062	27.0	.023	1.108	+000 -008		.075		1.117	+015 -000	2.40	4,010
RR.109	1.093	27.8	.023	1.139			.075		1.147		2.47	4,120
RR.112	1.125	28.6	.023	1.171			.075		1.180		2.54	4,240
RR.115	1.156	29.4	.023	1.202			.075		1.210		2.61	4,350
RR.118	1.188	30.2	.026	1.240	+000 -008	.048+.004 -000	.085	.043±.002	1.249	+015 -000	3.50	5,200
RR.121	1.218	30.9	.026	1.270			.085		1.278		3.64	5,340
RR.125	1.250	31.7	.026	1.302			.085		1.312		3.68	5,520
RR.128	1.281	32.5	.026	1.333			.085		1.342		3.77	5,650
RR.131	1.312	33.3	.026	1.364			.085		1.374		3.87	5,770
RR.134	1.347	34.2	.026	1.399			.085		1.408		4.32	5,910
RR.137	1.375	34.9	.028	1.431			.095		1.442		4.57	6,050
RR.140	1.406	35.7	.028	1.462			.095		1.472		4.66	6,170
RR.143	1.437	36.5	.028	1.493			.095		1.504		4.75	6,310
RR.146	1.468	37.3	.028	1.524			.095		1.535		4.81	6,450
RR.150	1.500	38.1	.028	1.556			.095		1.567		4.93	6,620

TACLAB

Taclab: info@taclab.net
3341016916

Single and multi-turn rings to customers' dimensions can be manufactured subject to design and material confirmation. New sizes are continually added to the range. If your existing groove dimensions are not shown herein, please forward details of your requirements.

SERIES "S" INTERNAL

IMPERIAL SIZES

GROOVE DIMENSIONS

RING DIMENSIONS—TWO TURN

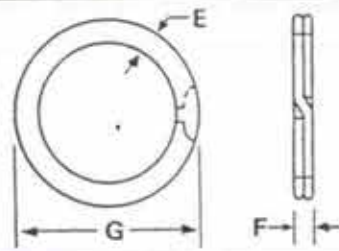
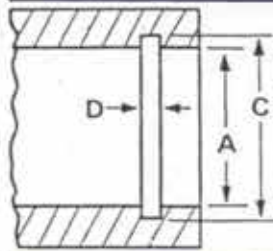

Ring Number RR	A Housing inches	Diam. m/m.	Groove Depth	Diam.	C Tolerance	D Width	E Radial Wall	F Thickness	Free Diam.	G Tolerance	Approx. Wt. lb. per 1000	Thrust Load lb.
RR.156	1-562	39-6	.032	1-622	+000 -010	.056+004 -000	.108	.049±.003	1-634	+020 -000	6-34	7,860
RR.162	1-625	41-2	.032	1-689			.108		1-701		6-89	8,170
RR.165	1-653	42-0	.032	1-717			.108		1-730		7-02	8,330
RR.168	1-678	42-8	.034	1-755			.118		1-768		7-50	8,470
RR.175	1-750	44-4	.034	1-818			.118		1-834		7-75	8,820
RR.181	1-813	46-0	.034	1-880			.118		1-894		8-40	9,120
RR.187	1-875	47-6	.036	1-947			.118		1-960		9-12	9,420
RR.193	1-938	49-2	.036	2-010			.118		2-025		9-32	9,730
RR.200	2-000	50-8	.038	2-076			.128		2-091		10-00	10,080
RR.206	2-062	52-3	.038	2-138	+000		.128		2-154	+025	10-30	10,350
RR.212	2-125	53-9	.038	2-201	-012		.128		2-217	-000	10-60	10,650
RR.216	2-165	55-0	.040	2-245			.138		2-260		11-20	10,900
RR.218	2-188	55-5	.040	2-268			.138		2-284		11-40	11,000
RR.225	2-250	57-1	.040	2-330			.138		2-347		11-70	11,350
RR.231	2-312	58-7	.042	2-396	+000	.056+004 -000	.138	.049±.003	2-403	+025 -000	12-40	11,650
RR.237	2-375	60-3	.042	2-459	-012		.138		2-476	-000	12-70	11,950
RR.243	2-437	61-9	.044	2-525			.148		2-543		13-40	12,250
RR.250	2-500	63-5	.044	2-588			.148		2-606		13-80	12,600
RR.253	2-531	64-2	.046	2-623			.148		2-641		14-40	12,750
RR.256	2-562	65-0	.046	2-654			.148		2-673		14-60	12,900
RR.262	2-625	66-6	.046	2-717			.148		2-736		15-00	13,200
RR.267	2-677	68-0	.048	2-773			.158		2-789		15-70	13,450
RR.268	2-688	68-2	.048	2-784			.158		2-803		15-80	13,500
RR.275	2-750	69-8	.048	2-847			.158		2-865		16-20	13,850
RR.281	2-813	71-4	.048	2-909			.158		2-929		17-10	14,150
RR.283	2-834	71-9	.050	2-934			.168		2-954		17-80	14,250
RR.287	2-875	73-0	.050	2-975			.168		2-995		18-10	14,450
RR.293	2-937	74-5	.050	3-037			.168		3-058		18-40	14,750
RR.295	2-952	75-0	.050	3-052			.168		3-073		18-70	14,850
RR.300	3-000	76-1	.051	3-102	+000	.068+005 -000	.168	.061±.003	3-122	+030 -000	23-70	18,600
RR.306	3-062	77-7	.051	3-164	-012		.168		3-186	-000	24-20	18,900
RR.312	3-125	79-3	.052	3-229			.178		3-251		25-40	19,300
RR.314	3-149	80-0	.052	3-253			.178		3-276		25-70	19,400
RR.318	3-187	81-0	.052	3-289			.178		3-311		26-40	19,700
RR.325	3-250	82-5	.053	3-356			.178		3-379		27-20	20,000
RR.331	3-312	84-0	.055	3-422			.188		3-446		28-20	20,500
RR.334	3-346	84-9	.055	3-456			.188		3-479		28-80	20,700
RR.337	3-375	85-7	.055	3-485			.188		3-509		29-20	20,800
RR.343	3-437	87-2	.056	3-549			.188		3-574		30-30	21,200
RR.350	3-500	88-8	.056	3-612			.188		3-636		31-00	21,700
RR.354	3-543	89-9	.058	3-659			.198		3-684		32-00	21,900
RR.356	3-562	90-4	.058	3-678			.198		3-703		32-20	22,100
RR.362	3-625	92-0	.059	3-743			.198		3-769		32-80	22,400
RR.368	3-687	93-6	.059	3-805			.198		3-832		33-50	22,800
RR.374	3-740	95-0	.059	3-858			.198		3-885		34-50	23,200
RR.375	3-750	95-2	.059	3-868			.198		3-894		34-60	23,250
RR.381	3-812	96-7	.062	3-936			.208		3-963		36-30	23,600
RR.387	3-875	98-3	.062	3-999			.208		4-025		37-90	24,000
RR.393	3-938	99-9	.062	4-062			.208		4-089		38-50	24,300
RR.400	4-000	101-5	.065	4-130			.218		4-157		40-80	24,800
RR.406	4-063	103-2	.065	4-193			.218		4-222		42-10	25,100
RR.412	4-125	104-7	.065	4-255			.218		4-284	+035 -000	43-30	25,500
RR.418	4-187	106-5	.065	4-317			.218		4-347		44-40	25,900
RR.425	4-250	107-9	.068	4-386			.228		4-416		45-50	26,300
RR.431	4-312	109-7	.068	4-448			.228		4-479		46-00	26-700
RR.433	4-330	109-9	.068	4-466			.228		4-497		46-5	26,800
RR.437	4-375	111-3	.068	4-511			.228		4-543		47-4	27,100
RR.443	4-437	112-8	.071	4-579			.238		4-611		49-3	27,500
RR.450	4-500	114-2	.071	4-642			.238		4-674		50-3	27,900

TACLAB

SERIES "S" INTERNAL

IMPERIAL SIZES

GROOVE DIMENSIONS

RING DIMENSIONS—TWO TURN

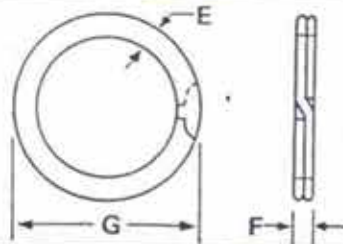
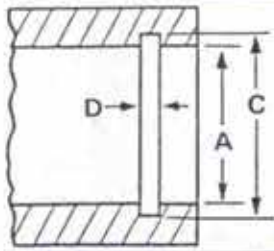

Ring Number RR	A Housing inches	A Diam. m/m.	Groove Depth	C Diam.	C Tolerance	D Width	E Radial Wall	F Thickness	G Free Diam.	G Tolerance	Approx. Wt. lb. per 1000	Thrust Load lb.
RR.452	4-527	115-0	-071	4-669	+000	.068+.005	.238	.061 ± .003	4-701	+035	50-7	28,000
RR.456	4-562	116-0	-071	4-704	-012	—000	.238		4-737	-000	51-3	28,300
RR.462	4-625	117-4	-073	4-771	+000	.079+.005	.250	.072 ± .004	4-803	+035	71-5	33,900
RR.468	4-687	119-0	-073	4-833	-012	—000	.250		4-867	-000	72-4	34,500
RR.472	4-724	120-0	-073	4-870			.250		4-903		73-4	34,700
RR.475	4-750	120-8	-073	4-896			.250		4-930		73-7	34,900
RR.481	4-812	122-1	-073	4-958			.250		4-993		74-5	35,300
RR.487	4-875	123-8	-073	5-021			.250		5-055		75-5	35,800
RR.492	4-921	125-0	-073	5-067			.250		5-102		76-3	36,100
RR.493	4-937	125-6	-075	5-087			.250		5-122		76-4	36,200
RR.500	5-000	126-9	-075	5-150			.250		5-185		77-4	36,800
RR.511	5-118	129-9	-075	5-268			.250		5-304		79-4	37,500
RR.512	5-125	130-3	-075	5-275			.250		5-311		79-5	38,000
RR.525	5-250	133-2	-075	5-400	+000		.250		5-436	+045	81-1	38,600
RR.537	5-375	136-4	-077	5-529	-014		.250		5-566	-000	83-0	39,500
RR.550	5-500	139-8	-077	5-654			.250		5-693		84-8	40,500
RR.551	5-511	139-9	-077	5-665			.250		5-703		84-9	40,600
RR.562	5-625	142-8	-077	5-779			.250		5-818		86-8	41,300
RR.570	5-708	145-0	-080	5-868			.250		5-909		87-7	41,900
RR.575	5-750	145-9	-080	5-910			.250		5-950		88-6	42,300
RR.587	5-875	149-3	-080	6-035			.250		6-077		90-1	43,200
RR.590	5-905	149-9	-080	6-065			.250		6-106		90-5	43,400
RR.600	6-000	152-3	-080	6-160			.250		6-202		92-4	44,100
RR.612	6-125	155-9	-090	6-350	+000	.094+.006	.312	.086 ± .004	6-349	+055	140-0	54,000
RR.625	6-250	158-9	-090	6-430	-016	—000	.312		6-474	-000	141-0	55,200
RR.629	6-299	160-0	-090	6-479			.312		6-524		142-0	55,500
RR.637	6-375	162-1	-090	6-555			.312		6-601		144-0	56,200
RR.650	6-500	165-3	-090	6-680			.312		6-726		147-0	57,300
RR.662	6-625	168-4	-095	6-815			.312		6-863		153-0	58,400
RR.669	6-692	170-0	-095	6-882			.312		6-931		154-0	59,000
RR.675	6-750	171-7	-095	6-940			.312		6-987		155-0	59,500
RR.687	6-875	174-8	-095	7-065			.312		7-114		158-0	60,600
RR.700	7-000	178-0	-095	7-190			.312		7-239		161-0	61,600
RR.708	7-086	180-0	-100	7-286			.312		7-337		163-0	62,500
RR.712	7-125	181-0	-100	7-325			.312		7-376		164-0	62,800
RR.725	7-250	184-0	-100	7-450			.312		7-501	+065	167-0	64,000
RR.737	7-375	187-2	-100	7-575			.312		7-628	-000	170-0	65,000
RR.748	7-480	190-0	-100	7-680			.312		7-734		173-0	66,000
RR.750	7-500	190-5	-100	7-700			.312		7-754		174-0	66,300
RR.762	7-625	193-8	-105	7-835			.312		7-890		176-0	67,200
RR.775	7-750	197-0	-105	7-960			.312		8-014		179-0	68,400
RR.787	7-875	200-0	-105	8-085			.312		8-141		180-0	69,400
RR.800	8-000	203-3	-105	8-210			.312		8-266		185-0	70,600
RR.825	8-250	209-8	-110	8-470	+000	.094+.006	.375	.086 ± .004	8-528	+065	228-0	72,800
RR.826	8-267	210-0	-110	8-487	-016	—000	.375		8-546	-000	229-0	73,000
RR.846	8-464	215-0	-110	8-684			.375		8-744		234-0	74,600
RR.850	8-500	216-0	-110	8-720			.375		8-780		235-0	75,000
RR.875	8-750	222-2	-115	8-980			.375		9-041		242-0	77,200
RR.885	8-858	225-0	-115	9-088			.375		9-151		246-0	78,000
RR.900	9-000	228-8	-115	9-230			.375		9-293		250-0	79,400
RR.905	9-055	230-0	-120	9-295			.375		9-359		251-0	79,800
RR.925	9-250	235-0	-120	9-490			.375		9-555		257-0	81,500
RR.944	9-448	240-0	-120	9-688			.375		9-755		263-0	83,300
RR.950	9-500	241-5	-120	9-740			.375		9-806		264-0	83,800
RR.975	9-750	248-0	-125	10-000			.375		10-068		271-0	86,000
RR.1000	10-000	254-0	-125	10-250			.375		10-320		278-0	88,200
RR.1025	10-250	260-8	-130	10-510			.375		10-582		286-0	90,500
RR.1050	10-500	266-7	-130	10-760			.375		10-834		292-0	92,700
RR.1075	10-750	273-0	-135	11-020			.375		11-095		300-0	95,000
RR.1100	11-000	279-0	-135	11-270			.375		11-347		307-0	97,000

TACLAB

SERIES "T" EXTERNAL

IMPERIAL SIZES

GROOVE DIMENSIONS

RING DIMENSIONS—TWO TURN

THREE TURN

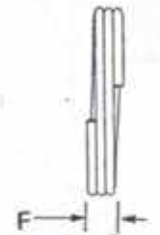
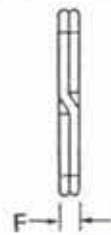
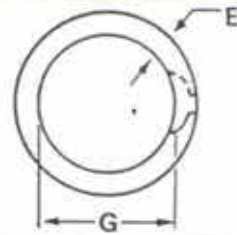
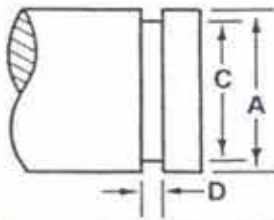

Ring Number	A Shaft Diam. inches	A Shaft Diam. m/ml.	Groove Depth	C Diam.	C Tolerance	D Width	E Radial Wall	F Thickness	G Free Diam.	G Tolerance	Approx. Wt. lb. per 1000	Thrust Load lb.
RST.46	.469	11.9	.013	.443	±.002	.028+.003 -.000	.045	.024±.002	.436	+.000 -.010	.46	1,300
RST.50	.500	12.7	.013	.474	±.003	.039+.003 -.000	.045	.035±.002	.469	+.000 -.013	.70	1,850
RST.56	.562	14.3	.014	.535			.045		.529		.78	2,080
RST.59	.594	15.1	.0145	.565			.045		.559		.82	2,180
RST.62	.625	15.9	.0145	.596			.055		.590		1.10	2,300
RST.67	.672	17.1	.016	.640			.055		.634		1.14	2,470
RST.68	.688	17.5	.016	.655	±.003	.046+.003 -.000	.065	.042±.002	.648	+.000 -.013	1.72	3,020
RST.75	.750	19.0	.0175	.715			.065		.708		1.87	3,300
RST.78	.781	19.8	.018	.745			.065		.738		1.96	3,430
RST.81	.812	20.6	.018	.776			.065		.768		2.02	3,660
RST.87	.875	22.2	.021	.835			.075		.827		2.52	3,840
RST.93	.938	23.8	.021	.894			.075		.896		2.68	4,100
RST.98	.984	25.0	.022	.940			.075		.934		2.82	4,320
RST.100	1.000	25.4	.0225	.955			.075		.947		2.84	4,400
RST.102	1.023	26.0	.023	.977			.075		.969		2.91	4,500
RST.106	1.062	27.0	.0235	1.015	±.004	.056-.004 -.000	.088	.050±.002	1.005	+.000 -.015	4.12	5,560
RST.112	1.125	28.6	.025	1.075			.088		1.064		4.35	5,900
RST.118	1.188	30.2	.026	1.135			.088		1.126		4.57	6,200
RST.125	1.250	31.7	.0275	1.195			.098		1.184		5.07	6,550
RST.131	1.312	33.3	.031	1.250			.098		1.240		5.70	6,900
RST.137	1.375	34.9	.0325	1.310			.108		1.298		6.14	7,200
RST.143	1.438	36.5	.034	1.370			.108		1.359		6.40	7,500
RST.150	1.500	38.1	.035	1.430			.108		1.418		6.66	7,850
RST.156	1.562	39.6	.0365	1.490	±.005	.068-.004 -.000	.118	.062±.003	1.476	+.000 -.020	9.10	10,150
RST.162	1.625	41.7	.0375	1.550			.118		1.537		10.40	10,550
RST.168	1.687	42.8	.038	1.610			.118		1.598		10.75	11,000
RST.175	1.750	44.4	.040	1.670			.118		1.657		11.10	11,375
RST.177	1.771	44.9	.041	1.689			.128		1.676		11.75	11,500
RST.181	1.812	46.0	.0415	1.730			.128		1.714		12.00	11,750
RST.187	1.875	47.6	.0425	1.790			.128		1.774		12.50	12,200
RST.200	2.000	50.8	.045	1.910			.128		1.894		13.90	13,000
RST.206	2.062	52.3	.0465	1.970	±.006	.086+.005 -.000	.141	.078±.003	1.955	+.000 -.025	18.80	16,700
RST.212	2.125	53.9	.049	2.027			.141		2.012		19.40	17,100
RST.215	2.156	54.7	.0495	2.057			.141		2.041		19.70	17,400
RST.225	2.250	57.1	.0525	2.145			.141		2.129		20.50	18,100
RST.231	2.312	58.7	.054	2.205			.141		2.188		21.10	18,500
RST.237	2.375	60.3	.055	2.265			.141		2.248		21.70	19,000
RST.243	2.437	61.9	.056	2.325			.141		2.307		22.20	19,500
RST.250	2.500	63.5	.0575	2.385			.188		2.366		31.00	20,300
RST.255	2.559	64.9	.054	2.451			.188		2.432		31.80	20,800
RST.262	2.625	66.6	.060	2.505			.188		2.485		32.50	21,300
RST.268	2.687	68.2	.061	2.565			.188		2.545		33.20	21,800

TACLAB

Single and multi-turn rings to customers' dimensions can be manufactured subject to design and material confirmation.

New sizes are continually added to the range. If your existing groove dimensions are not shown herein, please forward details of your requirements.

SERIES "T" EXTERNAL

IMPERIAL SIZES

GROOVE DIMENSIONS

RING DIMENSIONS—TWO TURN THREE TURN

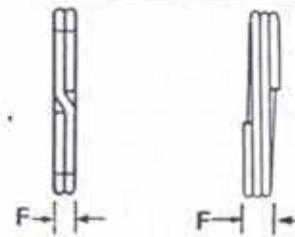
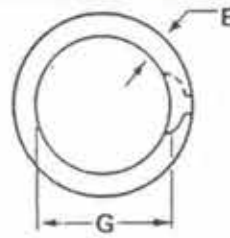
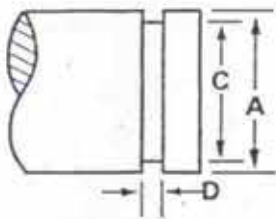

Ring Number	A Shaft Diam.		Groove Depth	C Diam.	C Tolerance	D Width	E Radial Wall	F Thickness	Free Diam.	G Tolerance	Approx. Wt. per 1000	Thrust Load
RST	inches	m/m.									lb.	lb.
RST.275	2-750	69-8	-0625	2-625	±.006	-103+.005	-188	-.093±.003	2-604	+.000	39-9	26,300
RST.287	2-875	73-0	-066	2-742		—000	-188		2-722	—030	41-7	27,400
RST.293	2-937	74-5	-068	2-801			-188		2-780		42-6	28,000
RST.300	3-000	76-1	-070	2-860			-188		2-838		43-5	28,500
RST.306	3-062	77-7	-071	2-920			-188		2-897		44-4	29,100
RST.312	3-125	79-3	-0725	2-980			-188		2-957		45-2	29,600
RST.315	3-156	80-1	-073	3-010			-188		2-986		45-7	29,900
RST.325	3-250	82-5	-075	3-100			-188		3-075		47-1	30,800
RST.334	3-344	84-9	-077	3-190			-188		3-164		48-4	31,800
RST.343	3-437	87-2	-078	3-280			-188		3-254		49-8	32,400
RST.350	3-500	88-8	-080	3-340	±.006	-120+.005	-250	-.111±.003	3-315	+.000	78-8	38,900
RST.354	3-543	89-9	-081	3-381		—000	-250		3-356	—040	79-7	39,300
RST.362	3-625	92-0	-083	3-458			-250		3-433		81-6	40,100
RST.368	3-687	93-6	-085	3-517			-250		3-483		82-9	40,700
RST.375	3-750	95-2	-0865	3-577			-250		3-550		84-3	41,400
RST.387	3-875	98-3	-089	3-696			-250		3-670		87-0	42,700
RST.393	3-938	99-9	-0905	3-756			-250		3-730		88-4	43,400
RST.400	4-000	101-5	-092	3-815			-250		3-787		89-7	44,000
RST.425	4-250	107-9	-092	4-065			-250		4-037		95-5	46,700
RST.437	4-375	111-0	-092	4-190			-250		4-162		98-4	48,100
RST.450	4-500	114-2	-095	4-310			-250		4-280		101-0	49,400
RST.475	4-750	120-6	-100	4-550			-250		4-515		107-0	51,900
RST.500	5-000	126-9	-105	4-790			-250		4-755		112-0	54,700
RST.525	5-250	133-2	-110	5-030	±.007	-139+.006	-375	-.127±.004	4-995	+.000	222-0	65,500
RST.550	5-500	140-0	-117	5-265		—000	-375		5-229	—050	232-0	68,500
RST.575	5-750	145-9	-122	5-505			-375		5-466		241-0	72,000
RST.600	6-000	152-3	-127	5-745			-375		5-705		251-0	75,000

ALL RINGS LISTED BELOW ARE 3 TURN CONSTRUCTION

RST.625	6-250	158-6	-132	5-985	±.008	-174+.008	-312	-.165±.005	5-938	+.000	284-0	105,700
RST.650	6-500	165-0	-137	6-225		—000	-312		6-182	—060	295-0	110,000
RST.675	6-750	171-3	-142	6-465			-312		6-420		306-0	114,000
RST.700	7-000	177-7	-147	6-705			-312		6-658		317-0	118,000
RST.750	7-500	190-4	-160	7-180	±.008	-209+.008	-375	-.189±.005	7-130	+.000	469-0	144,300
RST.762	7-625	193-7	-162	7-301		—000	-375		7-251	—070	475-0	148,300
RST.775	7-750	196-8	-165	7-420			-375		7-368		484-0	150,700
RST.787	7-875	200-0	-167	7-541			-375		7-486		492-0	153,000
RST.800	8-000	203-0	-170	7-660			-375		7-607		498-0	155,500
RST.850	8-500	215-7	-180	8-140			-375		8-083		528-0	165,300
RST.862	8-625	219-0	-181	8-263			-375		8-204		530-0	168,000
RST.875	8-750	222-2	-182	8-383			-375		8-321		543-0	170,100
RST.900	9-000	228-4	-190	8-620			-375		8-560		558-0	175,000
RST.912	9-125	231-7	-191	8-743			-375		8-679		565-0	177,300
RST.943	9-437	239-7	-198	9-041			-375		8-974		585-0	183,000
RST.950	9-500	241-1	-200	9-100			-375		9-036		589-0	188,000
RST.981	9-812	249-2	-208	9-396			-375		9-331		605-0	190,800
RST.1000	10-000	253-8	-212	9-575			-375		9-508		617-0	195,000

Taclab: info@taclab.net
3341016916

TACLAB

SERIES "T" INTERNAL

IMPERIAL SIZES

GROOVE DIMENSIONS

RING DIMENSIONS—TWO TURN

THREE TURN

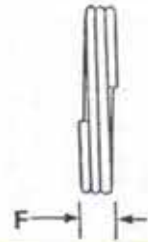
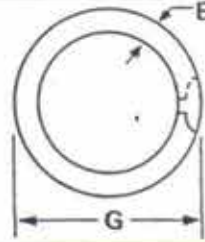
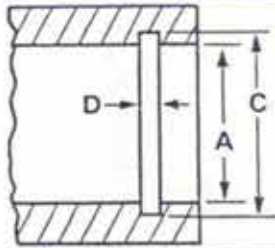

Ring Number RRT	A Housing Diam. inches	A Housing Diam. m/m.	Groove Depth	C Diam.	C Tolerance	D Width	E Radial Wall	F Thickness	G Free Diam.	G Tolerance	Approx. Wt. lb. per 1000	Thrust Load lb.
RRT.50	.500	12.7	.012	.524	±.003	.039+.003 -.000	.045	.035±.002	.529	+.013 -.000	.65	1,850
RRT.56	.562	14.3	.015	.592			.045		.597		.75	2,050
RRT.62	.625	15.9	.017	.659			.045		.665		.78	2,300
RRT.68	.688	17.5	.0185	.724			.055		.730		1.12	2,500
RRT.75	.750	19.0	.020	.790			.055		.796		1.25	2,700
RRT.77	.777	19.7	.021	.819	±.003	.046+.003 -.000	.065	.042±.002	.825	+.013 -.000	1.84	3,300
RRT.81	.812	20.6	.022	.857			.065		.864		1.93	3,500
RRT.87	.875	22.2	.0235	.922			.065		.929		2.10	3,800
RRT.90	.901	22.9	.0245	.950			.065		.957		2.18	3,900
RRT.93	.938	23.8	.0255	.989			.075		.997		2.59	4,100
RRT.100	1.000	25.4	.0275	1.055			.075		1.063		2.78	4,400
RRT.106	1.062	27.0	.0285	1.120	±.004	.056+.004 -.000	.078	.050±.002	1.129	+.015 -.000	3.50	5,300
RRT.112	1.125	28.6	.030	1.185			.078		1.195		4.00	5,650
RRT.118	1.188	30.2	.0315	1.250			.088		1.260		4.17	6,000
RRT.125	1.250	31.7	.035	1.320			.098		1.330		4.86	6,300
RRT.131	1.312	33.3	.0365	1.385			.098		1.395		5.13	6,600
RRT.137	1.375	34.9	.0375	1.450			.098		1.461		5.68	6,900
RRT.143	1.438	36.5	.039	1.515			.108		1.526		6.25	7,240
RRT.150	1.500	38.1	.040	1.580			.108		1.591		6.85	7,550
RRT.156	1.562	39.6	.0425	1.647	±.005	.068+.004 -.000	.118	.062±.003	1.659	+.020 -.000	9.20	10,150
RRT.162	1.625	41.2	.045	1.715			.118		1.727		9.50	10,550
RRT.165	1.653	42.0	.046	1.745			.118		1.757		10.10	10,750
RRT.168	1.688	42.8	.0465	1.780			.118		1.793		10.40	11,000
RRT.175	1.750	44.4	.0475	1.845			.118		1.858		10.70	11,375
RRT.181	1.812	46.0	.049	1.910			.128		1.923		11.20	11,750
RRT.187	1.875	47.6	.050	1.975			.128		1.989		11.90	12,200
RRT.193	1.938	49.2	.0515	2.040			.138		2.054		13.30	12,600
RRT.200	2.000	50.8	.055	2.110			.138		2.125		14.30	13,000
RRT.206	2.062	52.3	.0565	2.175	±.006	.086+.005 -.000	.141	.078±.003	2.190	+.025 -.000	18.40	16,400
RRT.212	2.125	53.9	.057	2.240			.141		2.255		19.00	17,400
RRT.218	2.188	55.5	.059	2.305			.141		2.321		19.60	17,900
RRT.225	2.250	57.1	.060	2.370			.141		2.386		20.30	18,400
RRT.231	2.312	58.7	.0635	2.440			.188		2.457		27.30	18,800
RRT.237	2.375	60.3	.065	2.505			.188		2.522		28.20	18,900
RRT.243	2.437	61.9	.066	2.570			.188		2.588		29.00	19,300

Taclab: info@taclab.net
3341016916

Single and multi-turn rings to customers' dimensions can be manufactured subject to design and material confirmation.

New sizes are continually added to the range. If your existing groove dimensions are not shown herein, please forward details of your requirements.

SERIES "T" INTERNAL

IMPERIAL SIZES

GROOVE DIMENSIONS

RING DIMENSIONS—TWO TURN

THREE TURN

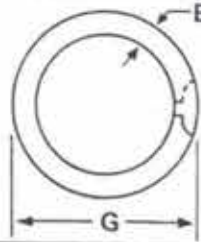
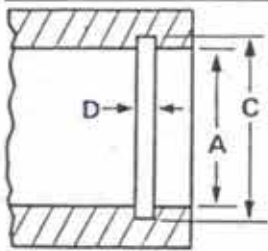

Ring Number	A Housing Diam. inches	Groove Depth m/m.	C Diam.	Tolerance	D Width	E Radial Wall	F Thickness	G Free Diam.	Tolerance	Approx. Wt. lb. per 1000	Thrust. Load lb.	
RRT.250	2-500	63-5	-0675	2-635	±.006	-.086+.005	.188	.078±.003	2-653	+.025	29-80	19,900
RRT.253	2-531	64-2	-0685	2-668		-.000	.188		2-687	-.000	30-30	20,100
RRT.256	2-562	65-0	-069	2-700	±.006	-.103+.005	.188	.093±.003	2-720	+.025	36-3	24,200
RRT.262	2-625	66-6	-070	2-765		-.000	.188		2-785	-.000	37-4	24,750
RRT.268	2-688	68-2	-072	2-834			.188		2-855		38-4	25,300
RRT.275	2-750	69-8	-075	2-900			.188		2-921		39-4	25,900
RRT.281	2-813	71-4	-076	2-965			.188		2-987		40-3	26,500
RRT.283	2-834	71-9	-0765	2-987			.188		3-009		40-7	26,700
RRT.287	2-875	73-0	-0775	3-030			.188		3-053		41-3	27,100
RRT.300	3-000	76-1	-0825	3-165			.188		3-188		43-4	28,300
RRT.306	3-062	77-7	-0835	3-230	±.006	-.120+.005	.250	.111±.003	3-257	+.030	66-8	33,400
RRT.312	3-125	79-3	-085	3-295		-.000	.250		3-318	-.000	68-2	34,100
RRT.315	3-156	80-1	-086	3-328			.250		3-354		69-9	34,400
RRT.325	3-250	82-5	-088	3-426			.250		3-450		71-3	35,400
RRT.334	3-346	85-0	-090	3-525			.250		3-550		73-6	36,500
RRT.347	3-469	88-0	-094	3-657			.250		3-683		76-6	37,800
RRT.350	3-500	88-8	-095	3-690			.250		3-716		77-5	38,200
RRT.354	3-543	89-9	-096	3-735			.250		3-761		78-5	38,600
RRT.356	3-562	90-4	-097	3-756			.250		3-783		79-0	38,800
RRT.362	3-625	92-0	-0985	3-822			.250		3-849		80-6	39,500
RRT.375	3-750	95-2	-1025	3-955			.250		3-982		83-5	40,900
RRT.387	3-875	98-3	-106	4-087			.250		4-115		86-7	42,300
RRT.393	3-938	99-9	-106	4-150			.250		4-178		88-2	42,900
RRT.400	4-000	101-5	-110	4-220			.250		4-248		89-7	43,600
RRT.412	4-125	104-7	-110	4-339	±.006	-.120+.005	.312	.111±.003	4-368	+.035	114-0	45,000
RRT.425	4-250	107-9	-110	4-470		-.000	.312		4-500	-.000	118-0	46,300
RRT.433	4-330	109-9	-113	4-556			.312		4-586		120-0	47,200
RRT.460	4-500	114-2	-117	4-735			.312		4-768		125-0	49,100
RRT.462	4-625	117-4	-120	4-865			.312		4-897		129-0	50,400
RRT.475	4-750	120-6	-122	4-995			.312		5-028		133-0	51,800
RRT.500	5-000	126-9	-130	5-260			.312		5-295		140-0	54,500
RRT.525	5-250	133-2	-135	5-520	±.007	-.139+.006	.375	.127±.004	5-559	+.045	214-0	65,800
RRT.537	5-375	136-4	-135	5-560		-.000	.375		5-689	-.000	219-0	67,300
RRT.550	5-500	139-6	-135	5-770			.375		5-810		225-0	68,700
RRT.575	5-750	145-9	-135	6-020			.375		6-062		235-0	72,000
RRT.600	6-000	152-3	-135	6-270			.375		6-314		243-0	75,000

ALL RINGS LISTED BELOW ARE 3 TURN CONSTRUCTION

RRT.625	6-250	158-6	-140	6-530	±.008	-.174+.008	.312	.165±.005	6-576	+.055	285-0	105,700
RRT.650	6-500	165-0	-145	6-790		-.000	.312		6-837	-.000	295-0	110,300
RRT.662	6-625	168-1	-150	6-925			.312		6-973		304-0	112,700
RRT.675	6-750	171-3	-152	7-055			.312		7-104		310-0	115,000
RRT.700	7-000	177-7	-157	7-315			.312		7-366		319-0	118,300
RRT.725	7-250	184-0	-162	7-575	±.008	-.209+.008	.375	.189±.005	7-628	+.070	454-0	141,000
RRT.750	7-500	190-5	-170	7-840		-.000	.375		7-895	-.000	468-0	146,000
RRT.762	7-625	193-8	-172	7-969			.375		8-024		479-0	148,300
RRT.775	7-750	197-0	-175	8-100			.375		8-156		490-0	151,000
RRT.787	7-875	200-0	-175	8-225			.375		8-283		495-0	153,000
RRT.800	8-000	203-3	-180	8-360			.375		8-418		503-0	155,700
RRT.825	8-250	209-8	-185	8-620			.375		8-680		520-0	160,700
RRT.850	8-500	216-0	-190	8-880			.375		8-942		539-0	165,000
RRT.875	8-750	222-2	-197	9-145			.375		9-209		555-0	170,300
RRT.900	9-000	228-8	-202	9-405			.375		9-471		570-0	175,000
RRT.912	9-125	232-0	-202	9-529			.375		9-588		575-0	177,700
RRT.925	9-250	235-0	-202	9-669			.375		9-736		589-0	180,000
RRT.950	9-500	241-5	-215	9-930			.375		9-999		600-0	184,000
RRT.975	9-750	248-0	-215	10-189			.375		10-260		620-0	190,000
RRT.1000	10-000	254-0	-225	10-450			.375		10-552		638-0	195,000
RRT.1050	10-500	266-7	-235	10-970			.375		11-036		667-0	205,000

SERIES "S" EXTERNAL

METRIC SIZES

GROOVE DIMENSIONS

RING DIMENSIONS—TWO TURN

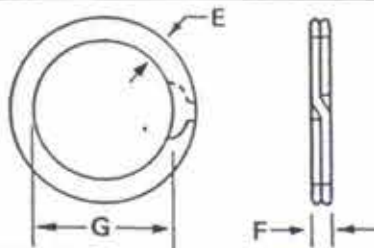
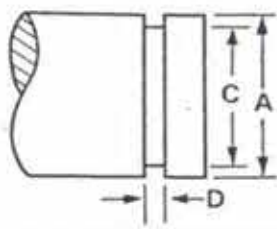

Ring Number	A Shaft Diam. mm	Groove Depth mm	C Diam. mm	Toler- ance mm	D Width mm	E Radial Wall mm	F Thickness mm	G Free Diam. mm	Toler- ance mm	Approx. Wt. kg per 1,000	Thrust Load kg
MS.47	12	0.33	11.34	+0.1	0.75+0.075	1.14	0.64±0.05	11.21	+0.00	0.22	570.00
MS.51	13	0.36	12.28	-0.0	-0.00	1.14		12.15	-0.33	0.22	608.00
MS.55	14	0.36	13.28			1.14		13.15		0.23	625.00
MS.59	15	0.36	14.28			1.14		14.15		0.26	675.00
MS.62	16	0.43	15.14			1.4		14.98		0.33	710.00
MS.66	17	0.43	16.14			1.4		15.98		0.35	750.00
MS.70	18	0.43	17.14			1.4		16.98		0.37	820.00
MS.75	19	0.43	18.14	+0.1	0.91+0.075	1.65	0.8±0.05	17.98	+0.00	0.48	1070.00
MS.78	20	0.43	19.14	-0.0	-0.00	1.65		18.98	-0.33	0.5	1110.00
MS.82	21	0.43	20.14			1.65		19.98		0.55	1180.00
MS.86	22	0.5	21.0			1.65		20.82		0.67	1250.00
MS.90	23	0.5	22.0			1.65		21.82		0.69	1290.00
MS.93	24	0.5	23.0			1.65		22.80		0.72	1320.00
MS.98	25	0.58	23.84	+0.13	1.07+0.076	1.9	0.94±0.05	23.64	+0.00	1.05	1690.00
MS.102	26	0.58	24.84	-0.00	-0.00	1.9		24.61	-0.33	1.08	1750.00
MS.106	27	0.58	25.84			1.9		25.61	+0.0	1.11	1820.00
MS.109	28	0.58	26.84			1.9		26.61	-0.38	1.15	1870.00
MS.114	29	0.58	27.84			1.9		27.61		1.21	1950.00
MS.118	30	0.66	28.68	+0.20	1.22+0.10	2.16	1.1±0.05	28.45	+0.00	1.59	2360.00
MS.125	32	0.66	30.68	-0.00	-0.00	2.16		30.43	-0.38	1.7	2500.00
MS.129	33	0.66	31.68			2.4		31.42		1.80	2600.00
MS.134	34	0.66	32.68			2.4		32.43		1.93	2700.00
MS.137	35	0.7	33.6			2.4		33.32		2.1	2740.00
MS.141	36	0.7	34.6			2.4		34.32		2.14	2800.00
MS.145	37	0.7	35.66			2.4		35.33		2.20	2900.00
MS.150	38	0.7	36.6			2.4		36.32		2.26	3000.00
MS.153	39	0.76	37.48	+0.25	1.42+0.10	2.75	1.25±0.08	37.25	+0.00	2.68	3290.00
MS.157	40	0.76	38.48	-0.00	-0.00	2.75		38.15	-0.50	3.1	3580.00
MS.165	42	0.8	40.4			2.75		40.1		3.24	3700.00
MS.169	43	0.81	41.38			3.0		41.04		3.44	3820.00
MS.173	44	0.81	42.38			3.0		42.06		3.64	3940.00
MS.177	45	0.86	43.28			3.0		42.95		3.84	4050.00
MS.185	47	0.9	45.22			3.25		44.85		4.05	4210.00
MS.188	48	0.9	46.2			3.25		45.85		4.2	4300.00
MS.196	50	0.9	48.2			3.25		47.82		4.4	4500.00
MS.204	52	1.0	50.0	+0.30		3.25		49.62		4.62	4700.00
MS.208	53	1.0	51.00	-0.00		3.25		50.62	+0.00	4.79	4780.00
MS.212	54	1.0	52.00			3.25		51.62	-0.63	4.96	4870.00
MS.216	55	1.0	53.0			3.5		52.62		5.2	4950.00
MS.220	56	1.0	54.0			3.5		53.62		5.3	5050.00
MS.228	58	1.07	55.86			3.5		55.43		5.8	5300.00
MS.232	59	1.07	56.86			3.5		56.43		5.82	5350.00
MS.236	60	1.07	57.86			3.5		57.43		5.85	5400.00
MS.240	61	1.12	58.76			3.5		58.36		6.05	5470.00
MS.243	62	1.12	59.76			3.76		59.3		6.25	5550.00
MS.248	63	1.12	60.76			3.76		60.3		6.45	5640.00
MS.251	64	1.12	61.76			3.76		61.25		6.68	5720.00
MS.255	65	1.17	62.66			3.76		62.2		6.9	5800.00
MS.259	66	1.18	63.64			3.76		63.16		7.07	5900.00
MS.263	67	1.22	64.56			3.76		64.16		7.24	6000.00
MS.267	68	1.22	65.56			4.0		65.08		7.4	6100.00
MS.271	69	1.22	66.56			4.0		66.06	+0.00	7.5	6180.00
MS.275	70	1.22	67.56			4.0		67.08	-0.76	7.6	6260.00
MS.279	71	1.22	68.56			4.0		68.04		7.8	6330.00
MS.283	72	1.25	69.5			4.27		69.0		8.0	6400.00
MS.295	75	1.27	72.46			4.27		71.93		8.7	6720.00

TACLAB

SERIES "S" EXTERNAL

METRIC SIZES

GROOVE DIMENSIONS

RING DIMENSIONS—TWO TURN

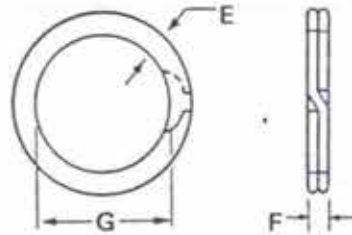
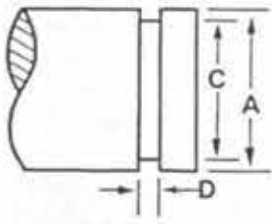

Ring Number	A Shaft Diam. mm	Groove Depth mm	Diam. mm	C Toler- ance mm	D Width mm	E Radial Wall mm	F Thickness mm	G Free Diam. mm	Toler- ance mm	Approx. Wt. kg per 1,000	Thrust Load kg
MS.306	78	1.30	75.4	+0.30	1.73+0.13	4.27	1.55±0.08	74.84	+0.00	11.3	8500.00
MS.314	80	1.32	77.36	-0.00	-0.00	4.52		76.80	-0.76	12.1	8800.00
MS.322	82	1.35	79.3			4.52		78.72		12.7	9000.00
MS.334	85	1.40	82.2			4.77		81.62		13.4	9400.00
MS.346	88	1.42	85.16			4.77		84.53	+0.00	14.3	9800.00
MS.354	90	1.47	87.06			5.03		86.43	-1.0	14.9	9950.00
MS.374	95	1.50	92.0			5.03		91.37		16.2	10500.00
MS.393	100	1.57	96.86			5.28		96.10		17.8	11000.00
MS.413	105	1.65	101.7			5.53		100.94		19.7	11600.00
MS.433	110	1.73	106.54			5.8		105.75		21.4	12100.00
MS.452	115	1.80	111.4			6.05		110.59		23.2	12700.00
MS.472	120	1.85	116.3	+0.30	2.00+0.13	6.35	1.83±0.10	115.49	-0.00	33.5	15700.00
MS.492	125	1.85	121.3	-0.00	-0.00	6.35		120.44	-1.0	35.0	16400.00
MS.511	130	1.90	126.2			6.35		125.34		36.4	17000.00
MS.531	135	1.95	131.1	+0.35		6.35		130.20	-0.00	38.0	17700.00
MS.551	140	1.96	136.08	-0.00		6.35		135.14	-1.3	39.0	18400.00
MS.570	145	2.00	141.0			6.35		140.00		40.6	19100.00
MS.590	150	2.00	146.0			6.35		145.00		42.0	19600.00
MS.610	155	2.30	150.4	+0.40	2.40+0.15	7.92	2.18±0.10	149.33	-0.00	65.0	24400.00
MS.629	160	2.30	155.4	-0.00	-0.00	7.92		154.31	-1.52	67.5	25200.00
MS.650	165	2.30	160.4			7.92		159.23		69.2	26000.00
MS.669	170	2.40	165.2			7.92		164.00		71.5	26800.00
MS.687	175	2.40	170.2			7.92		169.00		73.4	27400.00
MS.708	180	2.50	175.0			7.92		173.78		75.7	28400.00
MS.728	185	2.50	180.0			7.92		178.70		77.0	29000.00
MS.750	190	2.50	185.0			7.92		183.70	0.00	80.0	30000.00
MS.767	195	2.60	189.8			7.92		188.43	-1.75	82.0	30800.00
MS.787	200	2.60	194.8			7.92		193.43		83.5	31400.00
MS.826	210	2.80	204.4	+0.40	2.40+0.15	9.52	2.18±0.10	202.93	-0.00	106.0	33000.00
MS.866	220	2.90	214.2	-0.00	-0.00	9.52		212.65	-1.75	113.0	35000.00
MS.905	230	2.90	224.2			9.52		222.60		115.0	36200.00
MS.944	240	3.00	234.0			9.52		232.32		121.0	38000.00
MS.984	250	3.20	243.6			9.52		241.83		124.0	39500.00
MS.1025	260	3.30	253.4			9.52		251.57		131.0	41000.00
MS.1062	270	3.40	263.2			9.52		261.30		136.0	42500.00
MS.1100	280	3.50	273.0			9.52		271.04		140.0	44000.00

TACLAB

Taclab: info@taclab.net
3341016916

Single and multi-turn rings to customers' dimensions can be manufactured subject to design and material confirmation.

New sizes are continually added to the range. If your existing groove dimensions are not shown herein, please forward details of your requirements.

SERIES "S" INTERNAL

METRIC SIZES

GROOVE DIMENSIONS

RING DIMENSIONS—TWO TURN

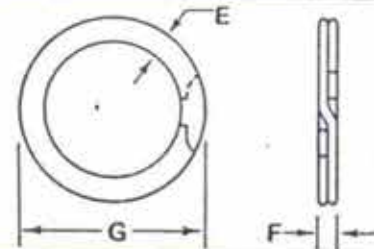
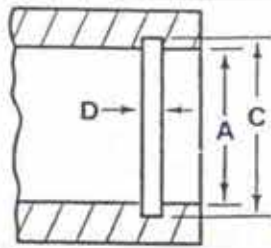

Ring Number	A Housing Diam. mm	Groove Depth mm	C Diam. mm	Tolerance mm	D Width mm	E Radial Wall mm	F Thickness mm	Free Diam. mm	G Tolerance mm	Approx. Wt. kg per 1,000 kg	Thrust Load
MR.47	12	0.33	12.66	+0.00	0.75+0.08	1.14	0.64±0.05	12.78	+0.33	0.21	570.00
MR.51	13	0.36	13.72	-0.10	-0.00	1.14		13.84	-0.00	0.22	580.00
MR.55	14	0.36	14.72			1.14		14.85		0.24	640.00
MR.59	15	0.36	15.72			1.14		15.85		0.25	670.00
MR.62	16	0.36	16.72			1.14		16.85		0.27	710.00
MR.66	17	0.36	17.72			1.14		17.85		0.33	780.00
MR.70	18	0.36	18.72			1.14		18.85		0.35	825.00
MR.75	19	0.43	19.86	+0.00	0.91+0.08	1.65	0.80±0.05	20.00	+0.33	0.46	1070.00
MR.78	20	0.43	20.86	-0.15	-0.00	1.65		21.10	-0.00	0.50	1110.00
MR.82	21	0.43	21.86			1.65		22.04		0.51	1160.00
MR.86	22	0.50	23.00			1.65		23.18		0.64	1230.00
MR.90	23	0.50	24.00			1.65		24.19		0.67	1275.00
MR.94	24	0.50	25.00			1.65		25.20		0.70	1320.00
MR.98	25	0.63	26.26	+0.00	1.07+0.08	1.90	0.94±0.05	26.45	+0.33	1.0	1640.00
MR.102	26	0.63	27.26	-0.15	-0.00	1.90		27.50	-0.00	1.05	1750.00
MR.110	28	0.63	29.26			1.90		29.50		1.12	1870.00
MR.114	29	0.63	30.26			1.90		30.50		1.36	2015.00
MR.118	30	0.66	31.32	+0.00	1.22+0.10	2.16	1.10±0.05	31.55	+0.40	1.60	2360.00
MR.126	32	0.66	33.32	-0.20	-0.00	2.16		33.57	-0.00	1.67	2500.00
MR.129	33	0.66	34.32			2.16		34.57		1.81	2590.00
MR.134	34	0.66	35.32			2.16		35.57		1.96	2680.00
MR.137	35	0.71	36.42			2.40		36.70		2.08	2740.00
MR.141	36	0.71	37.42			2.40		37.70		2.12	2800.00
MR.145	37	0.71	38.42			2.40		38.70		2.18	2900.00
MR.150	38	0.71	39.42			2.40		39.70		2.23	3000.00
MR.153	39	0.80	40.60	+0.00 -0.25	1.42+0.10 -0.00	2.75	1.25±0.08	40.90	+0.50 -0.00	2.57	3250.00
MR.157	40	0.80	41.60			2.75		41.90		2.90	3580.00
MR.161	41	0.80	42.60			2.75		42.92		3.04	3690.00
MR.165	42	0.80	43.60			2.75		43.93		3.18	3770.00
MR.169	43	0.86	44.72			3.00		45.00		3.35	3820.00
MR.173	44	0.86	45.72			3.00		46.02		3.52	3950.00
MR.177	45	0.86	46.72			3.00		47.08		3.70	4080.00
MR.185	47	0.90	48.80			3.00		49.18		4.05	4230.00
MR.188	48	0.90	49.80			3.00		50.18		4.15	4270.00
MR.196	50	0.96	51.92			3.25		52.30		4.54	4560.00
MR.204	52	0.96	53.92			3.25		54.30		4.60	4650.00
MR.208	53	0.96	54.92			3.25		55.32		4.80	4780.00
MR.216	55	1.00	57.00	+0.00		3.50		57.38	+0.63	5.20	4980.00
MR.220	56	1.00	58.00	-0.30		3.50		58.40	-0.00	5.20	5060.00
MR.228	58	1.00	60.00			3.50		60.43		5.40	5150.00
MR.232	59	1.04	61.08			3.50		61.54		5.55	5270.00
MR.236	60	1.07	62.14			3.50		62.57		5.70	5400.00
MR.240	61	1.12	63.24			3.76		63.65		5.90	5490.00
MR.244	62	1.12	64.24			3.76		64.70		6.10	5560.00
MR.248	63	1.12	65.24			3.76		65.70		6.25	5700.00
MR.251	64	1.17	66.34			3.76		66.77		6.42	5800.00
MR.256	65	1.17	67.34			3.76		67.82		6.60	5850.00
MR.259	66	1.17	68.34			3.76		68.80		6.77	5920.00
MR.263	67	1.20	69.40			3.76		69.90		6.94	6000.00
MR.267	68	1.22	70.44			4.00		70.94		7.10	6100.00
MR.271	69	1.22	71.44			4.00		71.94		7.20	6200.00
MR.275	70	1.22	72.44			4.00		72.94		7.30	6290.00
MR.279	71	1.22	73.44			4.00		73.99		7.70	6320.00
MR.283	72	1.27	74.54			4.27		75.04		8.10	6460.00
MR.295	75	1.27	77.54			4.27		78.07		8.50	6740.00

SERIES "S" INTERNAL

METRIC SIZES

GROOVE DIMENSIONS

RING DIMENSIONS—TWO TURN

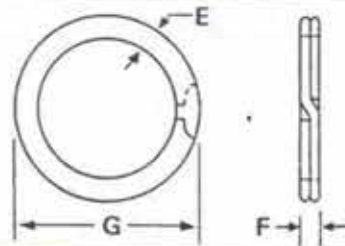
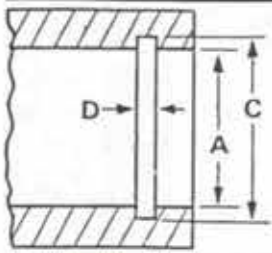

Ring Number	A Housing Groove Diam. mm	Depth mm	C Diam. mm	Toler- ance mm	D Width mm	E Radial Wall mm	F Thickness mm	G Free Diam. mm	Toler- ance mm	Approx. Wt. kg per 1,000 kg	Thrust Load
MR.306	78	1.30	80.6	+0.00	1.73+0.13	4.27	1.55±0.08	81.21	+0.76	11.0	8560.00
MR.314	80	1.32	82.64	-0.30	-0.00	4.52		83.22	-0.00	11.6	8800.00
MR.322	82	1.35	84.70			4.52		85.28		12.3	9000.00
MR.334	85	1.40	87.80			4.78		88.38		13.0	9400.00
MR.346	88	1.42	90.84			4.78		91.45		13.7	9600.00
MR.354	90	1.47	92.94			5.03		93.58		14.5	9900.00
MR.362	92	1.50	95.00			5.03		95.66		14.9	10100.00
MR.374	95	1.50	98.00			5.03		98.69		15.6	10500.00
MR.385	98	1.57	101.14			5.28		101.83		17.1	10900.00
MR.393	100	1.57	103.14			5.28		103.83		17.5	11000.00
MR.400	102	1.65	105.30			5.54		106.0		18.5	11200.00
MR.412	105	1.65	108.30			5.54		109.0	+0.90	19.6	11500.00
MR.425	108	1.73	111.46			5.80		112.22	-0.00	20.6	11900.00
MR.433	110	1.73	113.46			5.80		114.25		21.0	12100.00
MR.440	112	1.80	115.60			6.05		116.44		22.2	12400.00
MR.452	115	1.80	118.60			6.05		119.44		23.0	12700.00
MR.472	120	1.85	123.70	+0.00	2.00+0.13	6.35	1.83±0.10	124.54	-0.90	33.0	15700.00
MR.492	125	1.85	128.70	-0.30	-0.00	6.35		129.59	-0.00	35.0	16300.00
MR.511	130	1.90	133.80			6.35		134.71		36.0	17000.00
MR.531	135	1.90	138.80	+0.00		6.35		139.74	-1.14	37.0	17700.00
MR.551	140	1.95	143.90	-0.36		6.35		144.87	-0.00	38.0	18400.00
MR.570	145	2.00	149.00			6.35		150.04		40.0	19000.00
MR.590	150	2.00	154.00			6.35		155.07		41.0	19600.00
MR.610	155	2.30	159.60	+0.00	2.40+0.15	7.92	2.18 0.10	160.72	-1.40	63.0	24300.00
MR.629	160	2.30	164.60	-0.40	-0.00	7.92		165.74	-0.00	65.0	25200.00
MR.650	165	2.30	169.60			7.92		170.77		67.0	26000.00
MR.669	170	2.40	174.80			7.92		176.05		70.0	26800.00
MR.687	175	2.40	179.80			7.92		181.05		72.0	27500.00
MR.708	180	2.54	185.08			7.92		186.38		74.0	28400.00
MR.728	185	2.54	190.08			7.92		191.10	-1.65	76.0	29000.00
MR.748	190	2.54	195.08			7.92		196.45	-0.00	78.0	29900.00
MR.767	195	2.67	200.34			7.92		201.74		80.0	30500.00
MR.787	200	2.67	205.34			7.92		206.76		82.0	31400.00
MR.826	210	2.80	215.60	+0.00	2.40+0.15	9.52	2.18±0.10	217.10	+1.65	104.0	33000.00
MR.866	220	2.92	225.84	-0.40	-0.00	9.52		227.40	-0.00	110.0	35000.00
MR.905	230	3.05	236.10			9.52		237.73		114.0	36200.00
MR.944	240	3.05	246.10			9.52		247.80		119.0	37800.00
MR.984	250	3.18	256.36			9.52		258.10		123.0	39000.00
MR.1025	260	3.30	266.60			9.52		268.43		130.0	40800.00
MR.1062	270	3.30	276.60			9.52		278.50		133.0	42000.00
MR.1100	280	3.43	286.86			9.52		288.82		139.0	44000.00

Single and multi-turn rings to customers: dimensions can be manufactured subject to design and material confirmation.

New sizes are continually added to the range. If your existing groove dimensions are not shown herein, please forward details of your requirements.

SERIES "T" EXTERNAL

METRIC SIZES

GROOVE DIMENSIONS

RING DIMENSIONS—TWO TURN THREE TURN

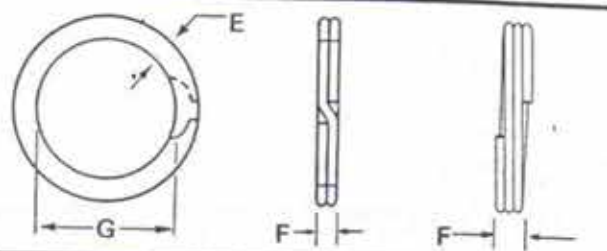
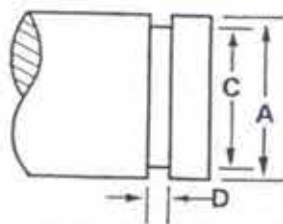

Ring Number	A Shaft Diam. mm	C Groove Depth mm	Diam. mm	Toler- ance mm	D Width mm	E Radial Wall mm	F Thickness mm	Free Diam. mm	G Toler- ance mm	Approx. Wt. kg per 1,000	Thrust Load kg
MST.47	12	0.33	11.34	±0.08	1.0+0.08	1.14	0.89±0.05	11.21	+0.00	0.32	840.00
MST.51	13	0.33	12.34		-0.00	1.14		12.21	-0.33	0.32	860.00
MST.55	14	0.35	13.30			1.14		13.15		0.35	920.00
MST.59	15	0.36	14.28			1.14		14.13		0.37	980.00
MST.62	16	0.36	15.28			1.40		15.13		0.50	1040.00
MST.66	17	0.40	16.20			1.40		16.05		0.52	1110.00
MST.70	18	0.43	17.14	±0.08	1.17+0.08	1.65	1.07±0.05	16.96	-0.00	0.78	1370.00
MST.75	19	0.44	18.12		-0.00	1.65		17.94	-0.33	0.85	1500.00
MST.78	20	0.46	19.08			1.65		18.90		0.89	1550.00
MST.82	21	0.46	20.08			1.65		19.88		0.91	1660.00
MST.86	22	0.53	20.94			1.90		20.74		1.14	1740.00
MST.90	23	0.53	21.94			1.90		21.74		1.20	1770.00
MST.93	24	0.53	22.94			1.90		22.74		1.22	1860.00
MST.98	25	0.56	23.88			1.90		23.68		1.28	1960.00
MST.102	26	0.58	24.84			1.90		24.64		1.32	2040.00
MST.106	27	0.60	25.80	±0.10	1.42-0.10	2.24	1.27±0.05	25.55	-0.00	1.90	2520.00
MST.109	28	0.60	26.80		-0.00	2.24		26.55	-0.40	1.95	2580.00
MST.114	29	0.63	27.74			2.24		27.46		2.00	2670.00
MST.118	30	0.66	28.68			2.24		28.40		2.10	2780.00
MST.125	32	0.70	30.60			2.50		30.32		2.30	2980.00
MST.129	33	0.75	31.50			2.50		31.22		2.45	3040.00
MST.134	34	0.80	32.40			2.50		32.12		2.60	3160.00
MST.137	35	0.82	33.36			2.75		33.06		2.80	3270.00
MST.141	36	0.86	34.28			2.75		33.98		2.90	3380.00
MST.145	37	0.86	35.28			2.75		34.88		2.95	3460.00
MST.150	38	0.90	36.20			2.75		35.90		3.00	3510.00
MST.153	39	0.90	37.70	±0.13	1.73-0.10	3.00	1.58±0.08	37.40	-0.00	3.55	3880.00
MST.157	40	0.94	38.12		-0.00	3.00		37.76	-0.50	4.10	4000.00
MST.165	42	0.96	40.08			3.00		39.72		4.70	4300.00
MST.169	43	0.96	41.08			3.00		40.69		4.90	4390.00
MST.173	44	0.96	41.96			3.25		41.60		5.10	4550.00
MST.177	45	1.05	42.90			3.25		42.54		5.30	4690.00
MST.185	47	1.10	44.80			3.25		44.39		5.55	5420.00
MST.188	48	1.10	45.80			3.25		45.39		5.70	5500.00
MST.196	50	1.15	47.70			3.25		47.29		5.90	5800.00
MST.204	52	1.17	49.66	±0.15	2.18-0.13	3.58	1.98±0.08	49.28	-0.00	8.50	7500.00
MST.208	53	1.20	50.60		-0.00	3.58		50.25	-0.63	8.65	7620.00
MST.212	54	1.25	51.50			3.58		51.11		8.80	7740.00
MST.216	55	1.27	52.46			3.58		52.05		8.90	7850.00
MST.220	56	1.27	53.46			3.58		53.05		9.40	8100.00
MST.228	58	1.37	55.26			3.58		54.83		9.50	8400.00
MST.232	59	1.37	56.26			3.58		55.75		9.65	8500.00
MST.236	60	1.40	57.20			3.58		56.77		9.80	8600.00
MST.240	61	1.40	58.20			3.58		57.73		9.90	8725.00
MST.243	62	1.42	59.16			3.58		58.70		10.00	8850.00
MST.248	63	1.45	60.10			4.77		59.62		14.00	9150.00
MST.251	64	1.45	61.10			4.77		60.62		14.20	9275.00
MST.255	65	1.45	62.10			4.77		61.62		14.40	9400.00
MST.259	66	1.48	63.04			4.77		62.58		14.60	9550.00
MST.263	67	1.55	63.90			4.77		64.38		14.80	9700.00
MST.267	68	1.55	64.90			4.77		64.40		15.00	9850.00
MST.271	69	1.55	65.90			4.77		65.38		16.50	11750.00
MST.275	70	1.57	66.86	±0.15	2.62-0.13	4.77	2.36±0.08	66.33	+0.00	18.00	11900.00
MST.279	71	1.65	67.70			4.77		67.15	-0.75	18.40	12050.00
MST.283	72	1.65	68.70			4.77		68.20		18.80	12200.00
MST.295	75	1.73	71.54			4.77		71.00		19.40	12700.00
MST.306	78	1.80	74.40			4.77		73.82		20.00	13200.00

SERIES "T" EXTERNAL

METRIC SIZES

GROOVE DIMENSIONS

RING DIMENSIONS—TWO TURN THREE TURN

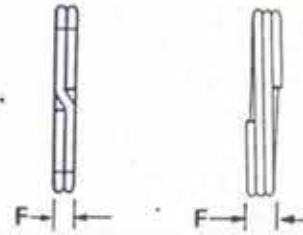
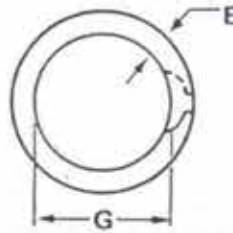
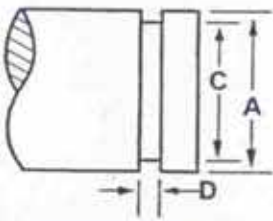

Ring Number	A Shaft Diam. mm	Groove Depth mm	C Diam. mm	Toler- ance mm	D Width mm	E Radial Wall mm	F Thickness mm	Free Diam. mm	G Toler- ance mm	Approx. Wt. kg per 1,000	Thrust Load kg
MST.314	80	1.85	76.30	±0.15	2.62+0.13	4.77	2.36±0.08	75.69	+0.00	20.70	13500.00
MST.322	82	1.90	78.20		-0.00	4.77		77.57	-0.75	21.40	13900.00
MST.334	85	1.95	81.10			4.77		80.44		22.00	14300.00
MST.346	88	2.00	84.00			4.77		83.34		22.70	14700.00
MST.354	90	2.05	85.90	±0.15	3.05+0.13	6.35	2.82±0.08	85.27	+0.00	36	17800.00
MST.374	95	2.20	90.60		-0.00	6.35		89.91	-1.00	38	18700.00
MST.393	100	2.30	95.40			6.35		94.70		40	19600.00
MST.413	105	2.34	100.32			6.35		99.61		42	20700.00
MST.433	110	2.34	105.32			6.35		104.60		44	21600.00
MST.452	115	2.42	110.16			6.35		109.40		46	22500.00
MST.472	120	2.54	114.92			6.35		114.03		49	23400.00
MST.492	125	2.65	119.70			6.35		118.81		51	24400.00
MST.511	130	2.72	124.56			6.35		123.65		52	25000.00
MST.531	135	2.80	129.40	±0.18	3.53-0.15	9.52	3.23±0.10	128.50	+0.00	101	30100.00
MST.551	140	2.97	134.06		-0.00	9.52		133.15	-1.27	105	32000.00
MST.570	145	3.10	138.80			9.52		137.80		109	32500.00
MST.590	150	3.18	143.64			9.52		142.60		113	33400.00
MST.610	155	3.25	148.50			9.52		147.43		116	34500.00

ALL RINGS LISTED BELOW ARE 3 TURN

MST.629	160	3.35	153.30	±0.20	4.42-0.20	7.92	4.20±0.13	152.11	+0.00	130	48400.00
MST.650	165	3.50	158.00		-0.00	7.92		156.81	-1.52	134	50000.00
MST.669	170	3.60	162.80			7.92		161.61		138	51200.00
MST.687	175	3.70	167.60			7.92		166.41		141	52800.00
MST.708	180	3.80	172.40			7.92		171.20		146	54300.00
MST.728	185	3.80	177.40			7.92		176.18		150	55600.00
MST.750	190	3.80	182.40	±0.20	5.30-0.20	9.52	4.80±0.13	181.13	+0.00	213	65600.00
					-0.00				-1.78		
MST.767	195	4.20	186.60			9.52		185.33		216	68000.00
MST.787	200	4.24	191.52			9.52		190.14		223	69400.00
MST.826	210	4.40	201.20			9.52		199.80		232	73300.00
MST.866	220	4.60	210.80			9.52		209.30		241	76400.00
MST.905	230	4.82	220.36			9.52		218.74		254	80000.00
MST.944	240	5.00	230.00			9.52		228.30		265	83000.00
MST.984	250	5.30	239.40			9.52		237.70		274	86600.00
MST.1025	260	5.40	249.20			9.52		247.50		287	90500.00
MST.1062	270	5.45	259.10			9.52		257.33		298	94400.00
MST.1100	280	5.50	269.00			9.52		267.17		309	98000.00

Single and multi-turn rings to customers' dimensions can be manufactured subject to design and material confirmation.

New sizes are continually added to the range. If your existing groove dimensions are not shown herein, please forward details of your requirements.

SERIES "T" INTERNAL

METRIC SIZES

GROOVE DIMENSIONS

RING DIMENSIONS—TWO TURN THREE TURN

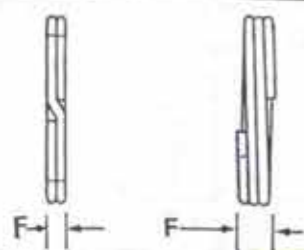
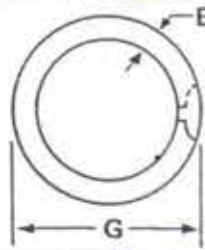
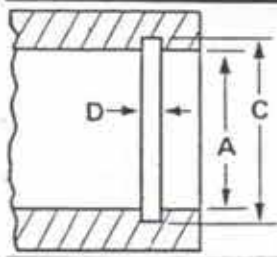

Ring Number	A Housing Groove		C Diam. mm	Tolerance mm	D Width mm	E Radial Wall mm	F Thickness mm	G		Approx. Wt. kg per 1,000	Thrust Load kg
	Diam. mm	Depth mm						Free Diam. mm	Tolerance mm		
MRT.47	12	0.30	12.60	±0.08	1.00+0.08	1.14	0.89±0.05	12.73	+0.33	0.30	840.00
MRT.51	13	0.30	13.60		-0.00	1.14		13.73	-0.00	0.31	860.00
MRT.55	14	0.38	14.76			1.14		14.89		0.34	920.00
MRT.59	15	0.43	15.86			1.14		16.01		0.35	980.00
MRT.62	16	0.43	16.86			1.14		17.01		0.36	1040.00
MRT.66	17	0.45	17.90			1.40		18.05		0.50	1100.00
MRT.70	18	0.45	18.90			1.40		19.05		0.52	1160.00
MRT.75	19	0.50	20.00			1.40		20.15		0.57	1220.00
MRT.78	20	0.53	21.06	±0.08	1.17+0.08	1.65	1.07±0.05	21.21	+0.33	0.83	1500.00
MRT.82	21	0.56	22.12		-0.00	1.65		22.30	-0.00	0.87	1560.00
MRT.86	22	0.58	23.16			1.65		23.34		0.94	1680.00
MRT.90	23	0.61	24.22			1.65		24.50		1.06	1770.00
MRT.94	24	0.63	25.26			1.90		25.46		1.18	1860.00
MRT.98	25	0.70	26.40			1.90		26.60		1.25	1970.00
MRT.102	26	0.71	27.42			1.90		27.62		1.29	2020.00
MRT.110	28	0.74	29.48	±0.10	1.42+0.10	1.98	1.27±0.05	29.71	+0.38	1.65	2500.00
MRT.114	29	0.76	30.52		-0.00	1.98		30.77	-0.00	1.77	2610.00
MRT.118	30	0.78	31.56			2.24		31.81		1.89	2720.00
MRT.126	32	0.90	33.80			2.50		34.05		2.21	2870.00
MRT.129	33	0.92	34.84			2.50		35.12		2.36	2960.00
MRT.134	34	0.94	35.88			2.50		36.16		2.52	3050.00
MRT.137	35	0.95	36.90			2.50		37.18		2.58	3130.00
MRT.141	36	0.95	37.90			2.50		38.18		2.66	3220.00
MRT.145	37	1.00	39.00			2.75		39.28		3.02	3300.00
MRT.150	38	1.00	40.00			2.75		40.28		3.10	3420.00
MRT.153	39	1.03	41.06			2.75		41.37		3.64	4035.00
MRT.157	40	1.07	42.14	±0.13	1.73+0.10	3.00	1.57±0.08	42.44	-0.50	4.18	4650.00
MRT.161	41	1.12	43.24		-0.00	3.00		43.54	-0.00	4.38	4765.00
MRT.165	42	1.17	44.34			3.00		44.64		4.58	4880.00
MRT.169	43	1.18	45.36			3.00		45.69		4.72	4990.00
MRT.173	44	1.19	46.38			3.00		46.81		4.86	5100.00
MRT.177	45	1.20	47.40			3.00		47.73		5.00	5210.00
MRT.185	47	1.27	49.54			3.25		49.84		5.26	5440.00
MRT.188	48	1.27	50.54			3.25		50.90		5.45	5550.00
MRT.196	50	1.32	52.64			3.50		53.00		6.12	5810.00
MRT.204	52	1.42	54.84	±0.15	2.18+0.13	3.58	1.98±0.08	55.22	+0.63	8.30	7400.00
MRT.208	53	1.44	55.88		-0.00	3.58		56.26	-0.00	8.47	7620.00
MRT.216	55	1.47	57.94			3.58		58.34		8.80	8050.00
MRT.220	56	1.47	58.94			3.58		59.34		9.00	8200.00
MRT.228	58	1.60	61.20			4.77		61.63		12.40	8490.00
MRT.232	59	1.60	62.22			4.77		62.65		12.60	8505.00
MRT.236	60	1.65	63.30			4.77		63.73		12.80	8520.00
MRT.240	61	1.65	64.30			4.77		64.76		12.95	8650.00
MRT.244	62	1.68	65.36			4.77		65.82		13.10	8750.00
MRT.248	63	1.70	66.40			4.77		66.86		13.30	8900.00
MRT.251	64	1.70	67.40			4.77		67.90		14.90	9950.00
MRT.256	65	1.75	68.50	±0.15	2.62+0.13	4.77	2.36±0.08	69.00	+0.63	16.50	11000.00
MRT.259	66	1.75	69.50		-0.00	4.77		70.03	-0.00	16.80	11166.00
MRT.263	67	1.80	70.60			4.77		71.13		17.10	11332.00
MRT.267	68	1.83	71.66			4.77		72.19		17.40	11500.00
MRT.271	69	1.87	72.74			4.77		73.27		17.65	11650.00
MRT.275	70	1.90	73.80			4.77		74.33		17.90	11800.00
MRT.279	71	1.90	74.80			4.77		75.36		18.20	11950.00
MRT.283	72	1.93	75.86			4.77		76.42		18.50	12100.00
MRT.295	75	2.00	79.00			4.77		79.58		19.20	12600.00

SERIES "T" INTERNAL

METRIC SIZES

GROOVE DIMENSIONS

RING DIMENSIONS—TWO TURN

THREE TURN

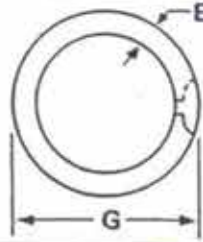
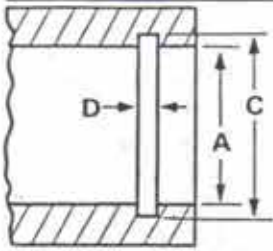

Ring Number	A Housing Groove Diam. mm	C Groove Depth mm	D Diam. mm	C Toler- ance. mm	D Width mm	E Radial Wall mm	F Thickness mm	G Free Diam. mm	G Toler- ance mm	Approx. Wt. kg per 1,000	Thrust Load kg
MRT.306	78	2.13	82.26	±0.15	3.05+0.13	6.35	2.82±0.08	82.95	+0.76	30.30	15200.00
MRT.314	80	2.18	84.36		-0.00	6.35		85.02	-0.00	31.70	15600.00
MRT.322	82	2.20	86.40			6.35		87.06		32.20	15900.00
MRT.334	85	2.29	89.58			6.35		90.21		33.40	16500.00
MRT.346	88	2.39	92.78			6.35		93.44		34.80	17100.00
MRT.354	90	2.44	94.88			6.35		95.54		35.70	17500.00
MRT.362	92	2.50	97.00			6.35		97.68		36.60	17900.00
MRT.374	95	2.60	100.20			6.35		100.88		38.00	18500.00
MRT.385	98	2.70	103.40			6.35		104.11		39.40	19000.00
MRT.393	100	2.70	105.40			6.35		106.11		40.00	19400.00
MRT.400	102	2.80	107.60			6.35		108.31		41.00	19900.00
MRT.412	105	2.80	110.60	±0.15	3.05+0.13	7.92	2.82±0.08	111.34	+0.90	52	20400.00
MRT.425	108	2.80	113.60		-0.00	7.92		114.36	-0.00	53	21000.00
MRT.433	110	2.87	115.74			7.92		116.50		54	21400.00
MRT.440	112	2.92	117.84			7.92		118.60		55	21800.00
MRT.452	115	3.00	121.00			7.92		121.83		57	22400.00
MRT.472	120	3.10	126.20			7.92		127.04		60	23300.00
MRT.492	125	3.25	131.50			7.92		132.39		63	24300.00
MRT.511	130	3.35	136.70			7.92		137.61		65	25400.00
MRT.531	135	3.45	141.90	±0.18	3.53+0.15	9.52	3.23±0.10	142.90	+1.14	98	30200.00
MRT.551	140	3.45	146.90		-0.00	9.52		147.91	-0.00	103	31200.00
MRT.570	145	3.45	151.90			9.52		152.97		106	32500.00
MRT.590	150	3.45	156.90			9.52		158.02		108	33400.00
MRT.610	155	3.45	161.90			9.52		163.04		112	34600.00

ALL RINGS LISTED BELOW ARE 3 TURN

MRT.629	160	3.55	167.10	±0.20	4.42+0.20	7.92	4.20±0.13	168.27	+1.40	130	48300.00
MRT.650	165	3.68	172.36		-0.00	7.92		173.55	-0.00	134	50000.00
MRT.669	170	3.85	177.70			7.92		178.94		139	51800.00
MRT.687	175	3.90	182.80			7.92		184.09		144	53400.00
MRT.708	180	4.00	188.00			7.92		189.30		147	54400.00
MRT.728	185	4.12	193.24	±0.20	5.30+0.20	9.52	4.80±0.13	194.59	+1.78	208	64300.00
MRT.748	190	4.32	198.64		-0.00	9.52		200.04	-0.00	212	65700.00
MRT.767	195	4.37	203.74			9.52		205.14		220	67600.00
MRT.787	200	4.45	208.90			9.52		210.37		224	69400.00
MRT.826	210	4.70	219.40			9.52		220.92		236	72800.00
MRT.866	220	4.95	229.90			9.52		231.52		248	76100.00
MRT.905	230	5.10	240.20			9.52		241.90		258	80000.00
MRT.944	240	5.45	250.90			9.52		252.65		270	83000.00
MRT.984	250	5.45	260.90			9.52		262.70		283	87000.00
MRT.1025	260	5.70	271.40			9.52		273.20		294	90400.00
MRT.1062	270	5.70	281.40			9.52		283.20		304	93800.00
MRT.1100	280	5.70	291.40			9.52		293.30		315	95100.00

Single and multi-turn rings to customers' dimensions can be manufactured subject to design and material confirmation.

New sizes are continually added to the range. If your existing groove dimensions are not shown herein, please forward details of your requirements.