

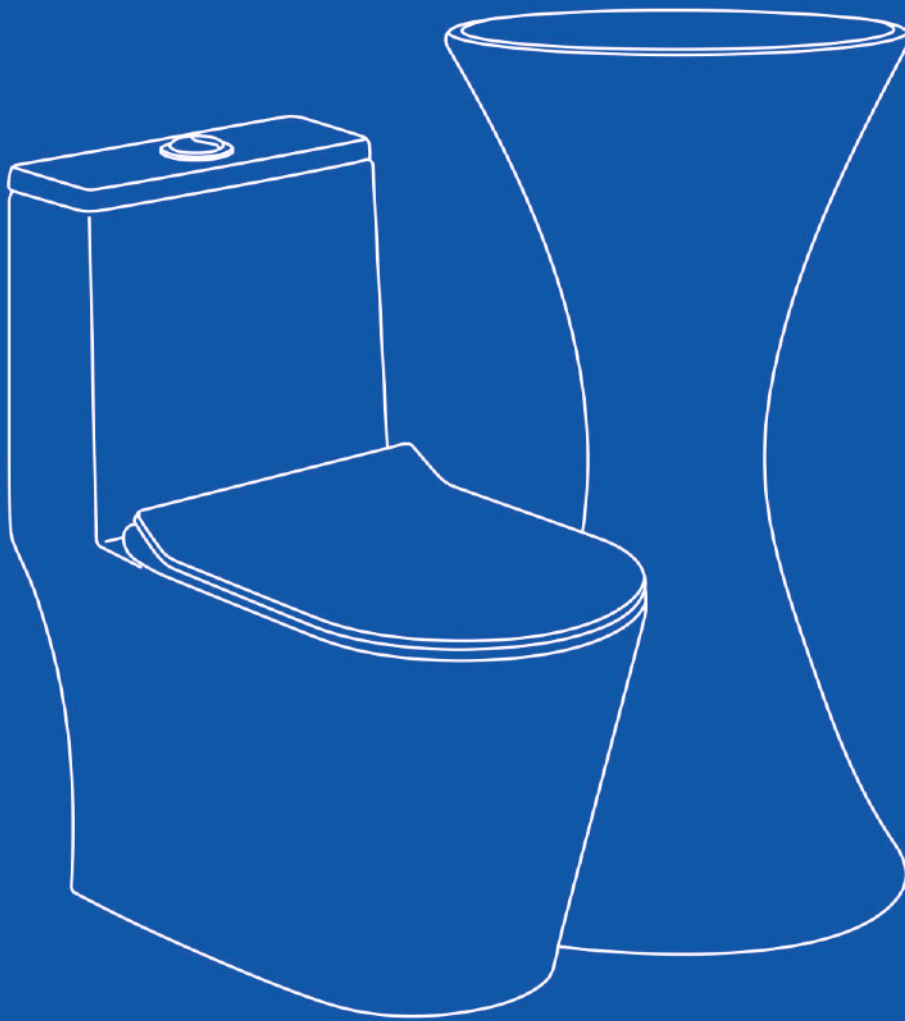

ANJUL

Elegance
Creates



LU

XU

RY

"The Most Important Necessity of Life"

VOL.5.1
CATALOGUE
W.E.F. 01-11-2025



EXPERIENCE TECHNOLOGY

- * Established in the year 1994 at Delhi, India. Two Manufacturing units in Delhi and sanitary ware Manufacturing units in Noida, U.P.
- * To ensure performance and Durability, all our products under goes a series of quality check.
- * A look at our technological standards of excellence.
- * Fully equipped testing laboratory with Pneumatic Testing & Endurance Test machines that test out the product life cycle.
- * Advanced Silica Core Technology guarantees defect-free, uniform wall thickness for the internal water passage of the product.
- * Auto polishing and grinding machines, along with chemical coating plant ensures excellent mirror finish.
- * BUREAU OF INDIAN STANDARD Approved Company and ISI MARK on the Products Manufactured.

EXPERIENCE DESIGN

Technical edge In house tool room modern machines CNC, VMC. This is the result of a passion that shared by Anjul pool of talented and experienced product designers in its Design Studio. Their endeavor is to create the most magnificent and stunning bathing products for Anjul! In line with its vision to be a complete bathing solutions brand, Anjul design philosophy is to create harmony in bath spaces through product ranges which are coordinated and have a similar design language, turning bath spaces into bath suites for contemporary living.



EXPERIENCE THE GROUP

Anjul Group is built on the platform of highest quality standards and aesthetics, with the intent to provide world class products. Anjul have great experience working with white goods companies like HINDWARE, MINDA, LUXOR, SPM MEDICARE, SUPREME etc. Anjul Group is an undisputed market leader in the bath Sanitaryware Category that has transformed the industry from merely utilitarian to an aspirational one to the become leader in the industry.

OUR COMPELLING TECHNOLOGIES

YOU MAY NOT SEE IT AT FIRST SIGHT - BUT OUR CERAMICS ARE EQUIPPED WITH THE MOST ADVANCED TECHNOLOGY. AT ANJUL IT IS OUR ASPIRATION TO MAKE YOUR TIME IN THE BATHROOM AS COMFORTABLE AS POSSIBLE WITHOUT ANY RESTRICTIONS. DISCOVER OUR INNOVATIVE ANJUL TECHNOLOGIES.



PUREGUARD
STAYS SPARKLING WHITE - NO CHANCE FOR BACTERIA AND DIRT



TRIPLE VORTEX FLUSH
THE POWER OF THREE: CLEAN AND SILENT



RIMLESS TECHNOLOGY
LEAVES BACTERIA NOWHERE TO HIDE



QUICK RELEASE SEAT
FAST REMOVAL FOR EASY CLEANING



SEAT & COVER SOFT CLOSE
GENTLE AND QUIET



INDEX

ONE PIECE **CLOSET** — 01-04

WALL HUNG **CLOSET** — 05

TABLE TOP **BASIN** — 06

WASH BASIN **FULL PEDESTAL** — 07

WALL HUNG **BASIN** — 08-10

WATER **CLOSET** — 11

URINAL — 12

PAN — 13

COLLECTION **COLOUR** — 14-19



AS-1001 DURA

M.R.P. ₹ 9750.00

SIZE 660 x 370 x 750mm

S-Trap : 225, 300mm



6D, Syphonic

S-Trap : 225, 300mm



SOFT CLOSE SEAT COVER



DUAL FLUSH



WATER SAVING



ANTI BACTERIAL

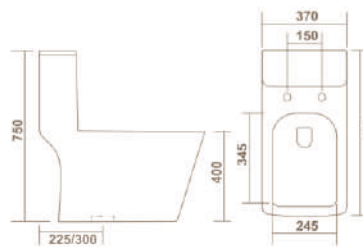

AS-1003 MOON

M.R.P. ₹ 9000.00

SIZE 675 x 360 x 740mm

Rimless, Wash Down

S-Trap : 225, 300mm

P-Trap



SOFT CLOSE SEAT COVER



DUAL FLUSH



WATER SAVING



ANTI BACTERIAL

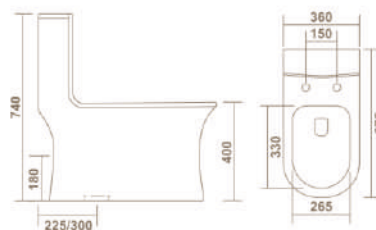



AS-1004 ALIVE

M.R.P. ₹ 9300.00
 SIZE 675 x 360 x 740mm

2D, Rimless, Syphonic
 S-Trap : 225, 300mm

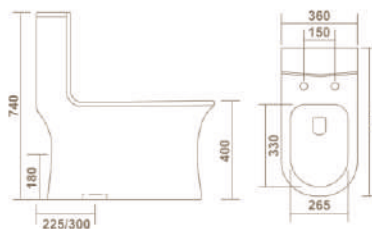

AS-1005 ADMIN

M.R.P. ₹ 9150.00
 SIZE 665 x 350 x 750mm
 Rimless, Wash Down
 S-Trap : 100, 225, 300mm
 P-Trap

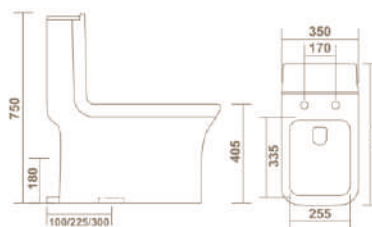



AS-1007 VENUE

M.R.P. ₹ 9450.00
 SIZE 665 x 360 x 725mm
 S-Trap : 225, 300mm

3D, Rimless, Syphonic
 S-Trap : 255, 300mm

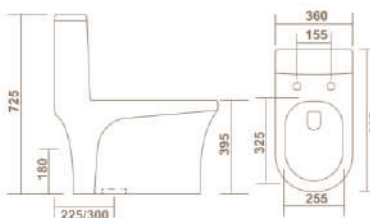

AS-1008 CRETA

M.R.P. ₹ 8850.00
 SIZE 665 x 360 x 730mm
 Boxrim, Wash Down
 S-Trap : 225mm
 P-Trap : 225mm
 P-Trap

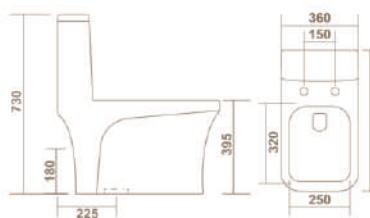



AS-1012 SMOOW

M.R.P. ₹ 12600.00
 SIZE 660 x 390 x 670mm

Rimless, 6D, Syphonic
 S-Trap : 225, 300mm

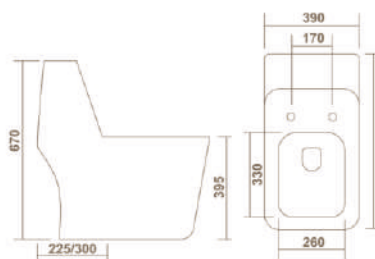

AS-1023 SHINE

M.R.P. ₹ 8850.00
 SIZE 655 x 355 x 745mm
 Boxrim, Wash Down
 S-Trap : 225mm

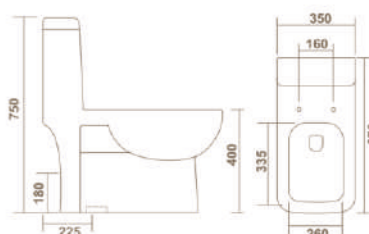



AS-2001 LACME

M.R.P. ₹ 5250.00
 SIZE 500 x 345 x 350mm
 Boxrim

-  SOFT CLOSE SEAT COVER
-  WATER SAVING
-  ANTI BACTERIAL

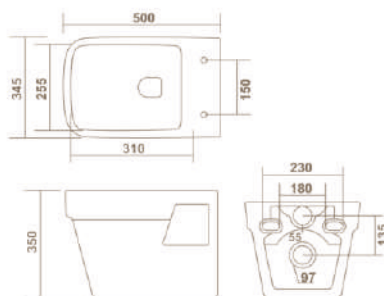

AS-2003 BELLA

M.R.P. ₹ 6000.00
 SIZE 520 x 360 x 365mm
 Boxrim

-  SOFT CLOSE SEAT COVER
-  WATER SAVING
-  ANTI BACTERIAL

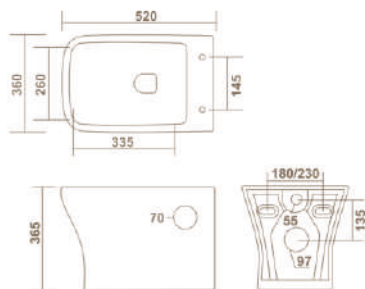

AS-2004 ICONIC

M.R.P. ₹ 4800.00
 SIZE 515 x 370 x 370mm
 Boxrim

-  SOFT CLOSE SEAT COVER
-  WATER SAVING
-  ANTI BACTERIAL

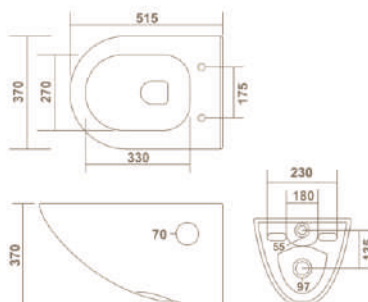



AS-3004 CELLO

M.R.P. ₹ 1620.00
 SIZE 445 x 325 x 125mm
 Thinrim



AS-3018 ROSSA

M.R.P. ₹ 2700.00
 SIZE 500 x 390 x 130mm
 Thinrim

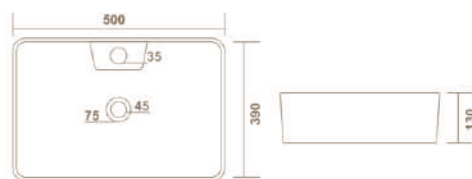



AS-4012 PRADO BASIN WITH PED

M.R.P. ₹ 2670.00
 SIZE 545 x 430 x 750mm
 22" x 17"

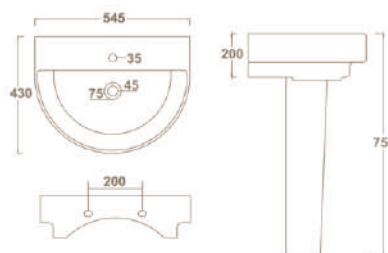

AS-4016 VENUS BASIN WITH PED

M.R.P. ₹ 2700.00
 SIZE 450 x 350 x 800mm
 18" x 14"

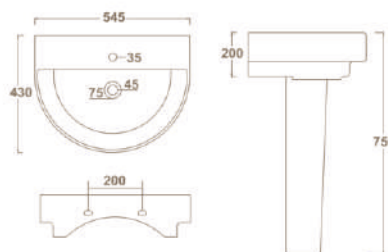



AS-4001 OPEL BASIN

M.R.P. ₹ 1410.00
SIZE 570 x 420 x 450mm
22" x 18"

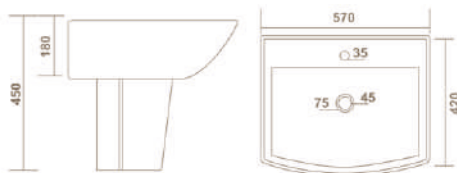

AS-4006 HEXA BASIN

M.R.P. ₹ 1410.00
SIZE 580 x 445 x 460mm
23" x 17"

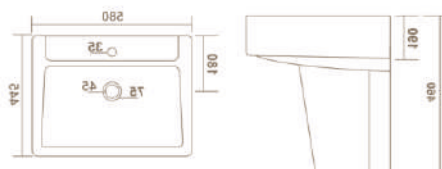



AS-5004 LEXO BASIN

M.R.P. ₹ 1110.00
 SIZE 460 x 370 x 455mm
 18" x 14"



AS-5008 MARS

M.R.P. ₹ 1050.00
 SIZE 370 x 270 x 105mm
 15" x 11"

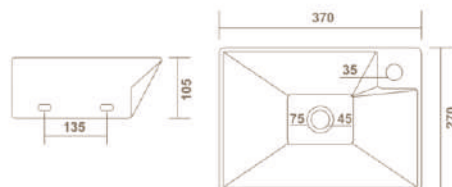



AS-5010 JUPITER BASIN

M.R.P. ₹ 1290.00
 SIZE 465 x 360 x 440mm
 18" x 14"



AS-5019 ITALIA

M.R.P. ₹ 1200.00
 SIZE 421 x 312 x 155mm
 13" x 12"





AS-7005 EWC "S"

M.R.P. ₹ 1400.00
 SIZE 525 x 360 x 400mm

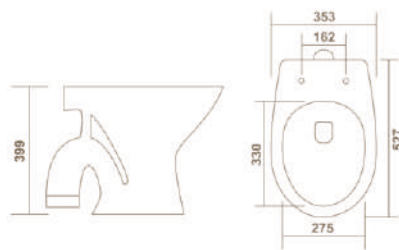

AS-7007 CONCEALED EWC

M.R.P. ₹ 1950.00
 SIZE 455 x 360 x 400mm

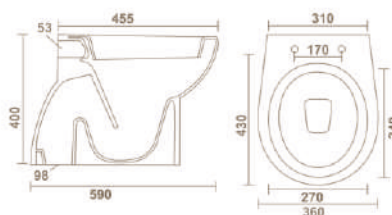



AS-8003 FLAT BLACK

M.R.P. ₹ 1200.00
 SIZE 320 x 250 x 400mm

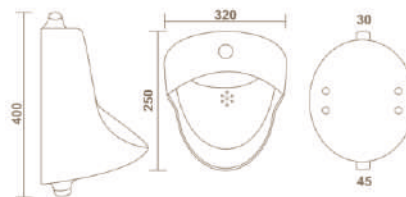

AS-8004 STYLE

M.R.P. ₹ 2400.00
 SIZE 250 x 290 x 530mm

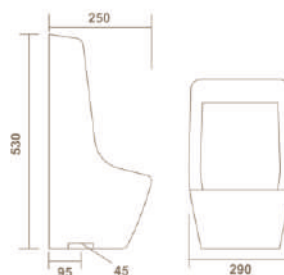



AS-9001 ORISSA PAN- 23"

M.R.P. ₹ 1350.00
 SIZE 595 x 450 x 310mm

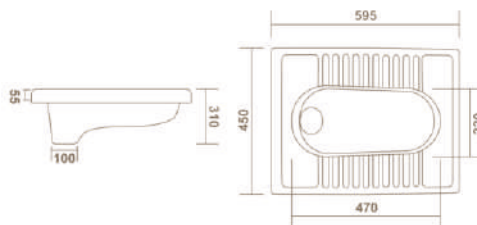

AS-9003 ORISSA PAN- 20"

M.R.P. ₹ 1050.00
 SIZE 525 x 430 x 280mm

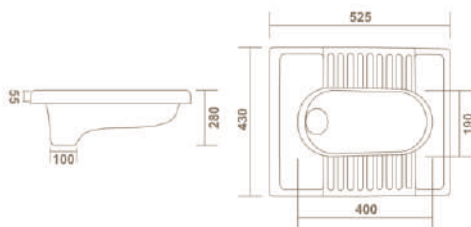

AS-9005 CITY PAN- 20"

M.R.P. ₹ 1050.00
 SIZE 535 x 430 x 175mm

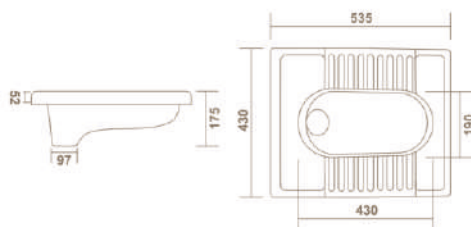



ACL-1001 PEACOCK GREEN

M.R.P. ₹ 13500.00
 SIZE 665 x 355 x 735mm
 6D, Rimless, Syphonic
 S-Trap : 225, 300mm



ACL-1005 PEACOCK GREEN

M.R.P. ₹ 12000.00
 SIZE 665 x 360 x 255mm
 Rimless, Wash Down
 S-Trap : 100, 225, 300mm



ACL-3005 PEACOCK GREEN

M.R.P. ₹ 4200.00
 SIZE 490 x 400 x 155mm | 20" x 16"



ACL-3013 PEACOCK GREEN

M.R.P. ₹ 4800.00
 SIZE 490 x 380 x 130mm | 20" x 15"



ACL-1001 VALENTINE BLACK

M.R.P. ₹ 12600.00
 SIZE 665 x 355 x 735mm
 6D, Rimless, Syphonic
 S-Trap : 225, 300mm



ACL-1005 VALENTINE BLACK

M.R.P. ₹ 11700.00
 SIZE 665 x 360 x 255mm
 Rimless, Wash Down
 S-Trap : 100, 225, 300mm



ACL-3005 VALENTINE BLACK

M.R.P. ₹ 4200.00
 SIZE 490 x 400 x 155mm | 20" x 16"



ACL-3013 VALENTINE BLACK

M.R.P. ₹ 4800.00
 SIZE 490 x 380 x 130mm | 20" x 15"



- SOFT CLOSE SEAT COVER
- DUAL FLUSH
- WATER SAVING
- ANTI BACTERIAL

ACL-1001 ROYAL BLUE

M.R.P. ₹ 13500.00
 SIZE 665 x 355 x 735mm
 6D, Rimless, Syphonic
 S-Trap : 225, 300mm



- SOFT CLOSE SEAT COVER
- DUAL FLUSH
- WATER SAVING
- ANTI BACTERIAL

ACL-1005 ROYAL BLUE

M.R.P. ₹ 12000.00
 SIZE 665 x 360 x 255mm
 Rimless, Wash Down
 S-Trap : 100, 225, 300mm

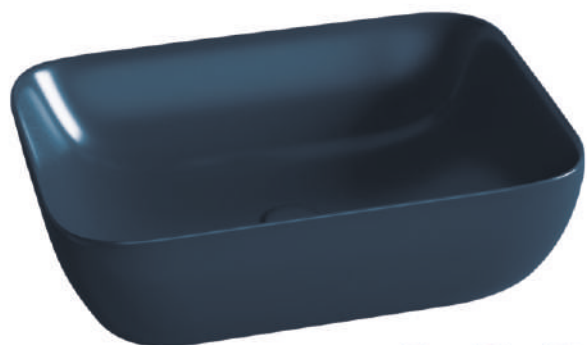

- WATER SAVING
- ANTI BACTERIAL
- THINRIM

ACL-3005 PEACOCK GREEN

M.R.P. ₹ 3600.00
 SIZE 490 x 400 x 155mm | 20" x 16"



- WATER SAVING
- ANTI BACTERIAL
- THINRIM

ACL-3013 PEACOCK GREEN

M.R.P. ₹ 4800.00
 SIZE 490 x 380 x 130mm | 20" x 15"

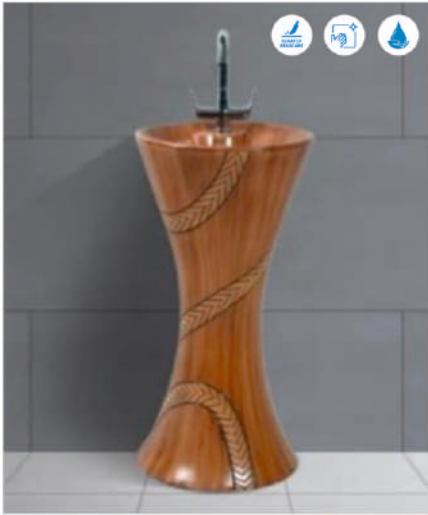

ACL-5001 DENTA
M.R.P. ₹ 6000.00

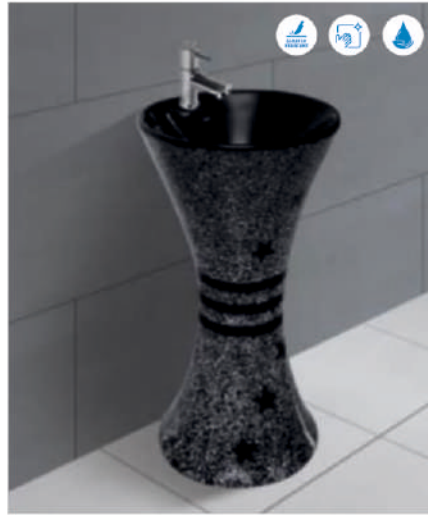

ACL-5003 DENTA
M.R.P. ₹ 6000.00

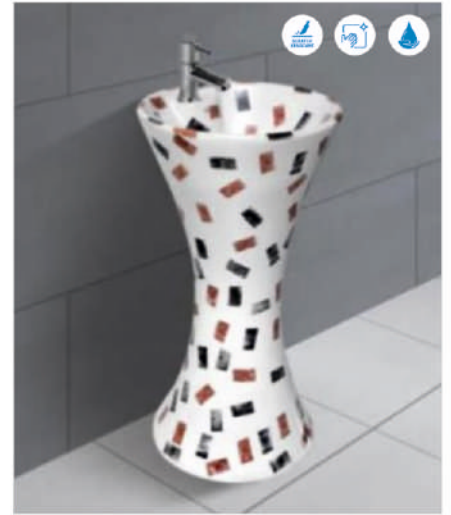

ACL-5004 DENTA
M.R.P. ₹ 6000.00

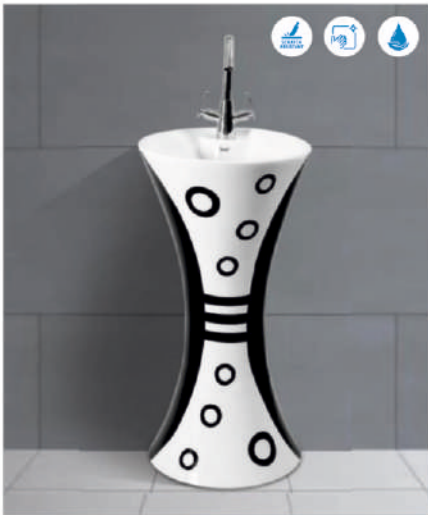

ACL-5008 DENTA
M.R.P. ₹ 6000.00

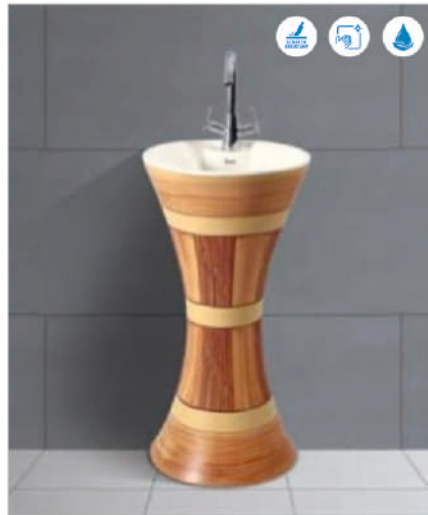

ACL-5010 DENTA
M.R.P. ₹ 6000.00

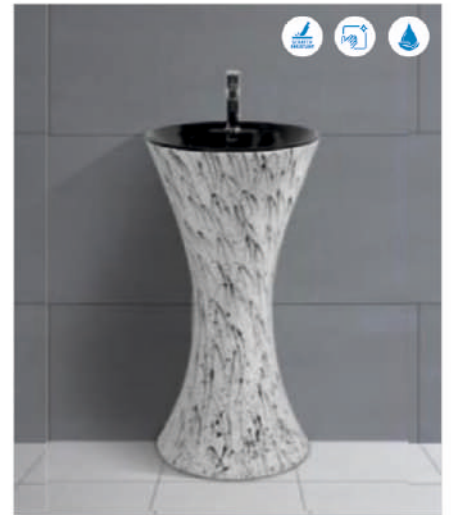

ACL-5016 DENTA
M.R.P. ₹ 6000.00

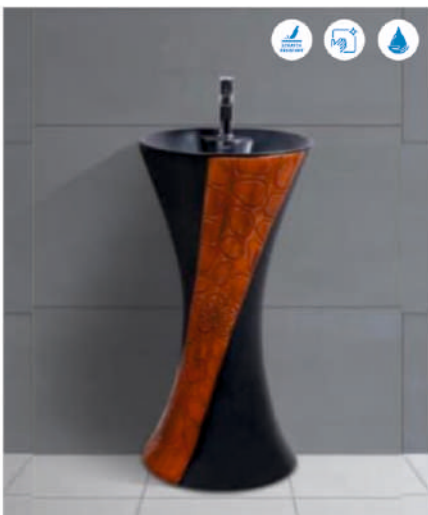

ACL-5017 DENTA
M.R.P. ₹ 6000.00

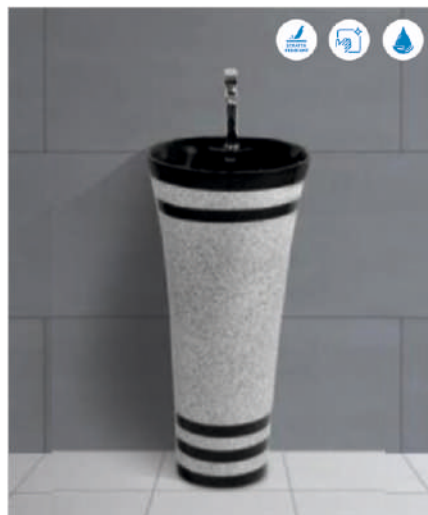

ACL-601 VAN
M.R.P. ₹ 6000.00

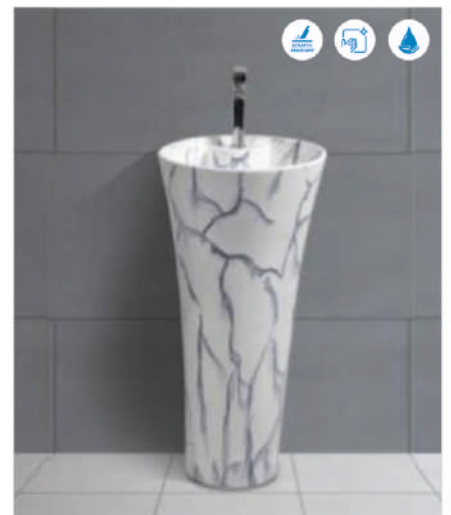

ACL-610 VAN
M.R.P. ₹ 6000.00

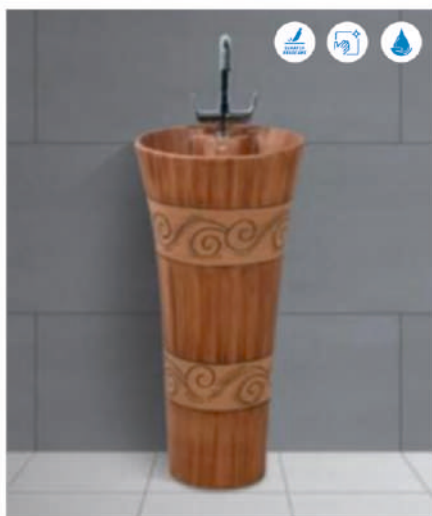

ACL-6014 VAN

M.R.P. ₹ 6000.00

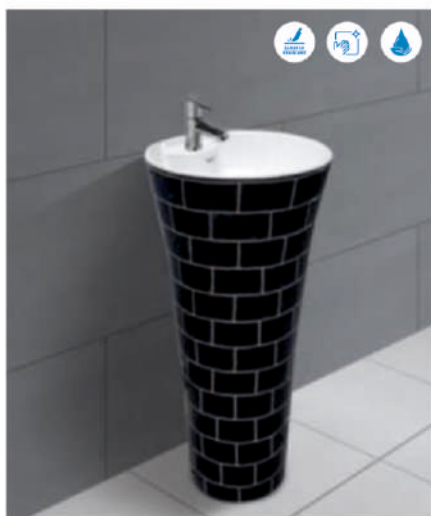

ACL-617 VAN

M.R.P. ₹ 6000.00

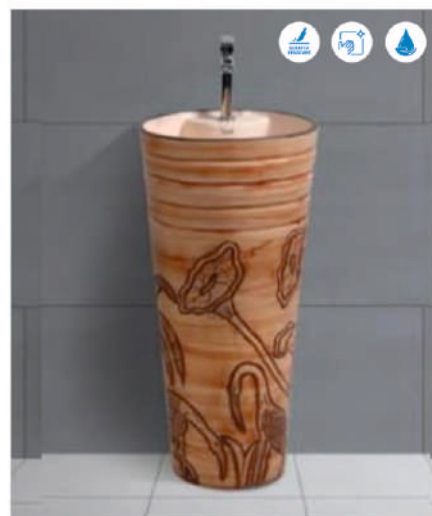

ACL-700 LITO

M.R.P. ₹ 7500.00

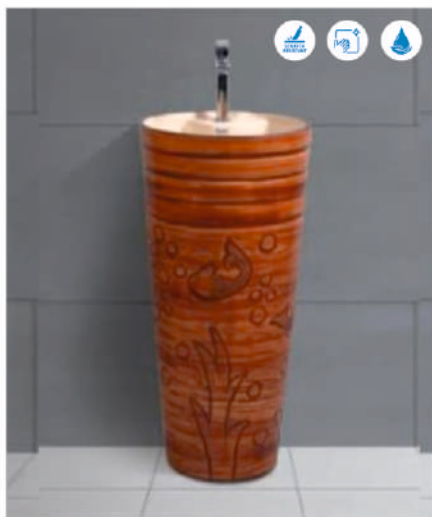

ACL-7005 LITO

M.R.P. ₹ 7500.00

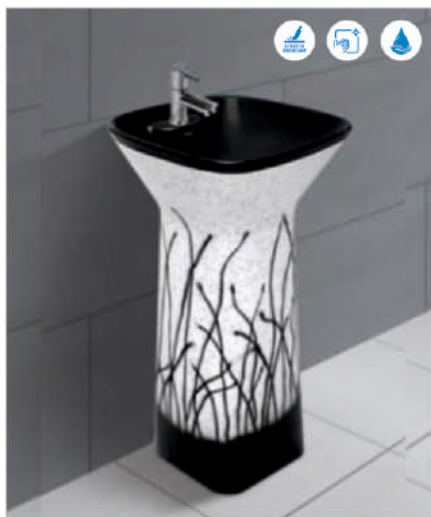

ACL-805 DYNA

M.R.P. ₹ 7500.00

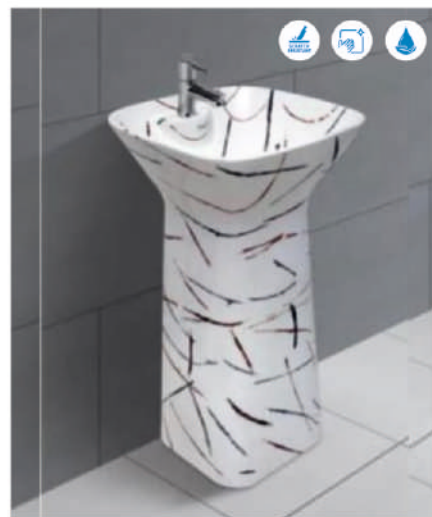

ACL-806 DYNA

M.R.P. ₹ 7500.00



ADG-2007

M.R.P. ₹ 5700.00



ADG-0901

M.R.P. ₹ 5700.00

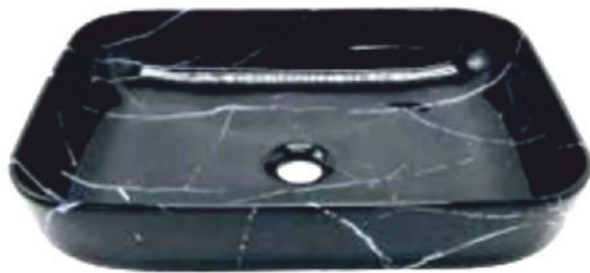

ADG-D040

M.R.P. ₹ 5700.00

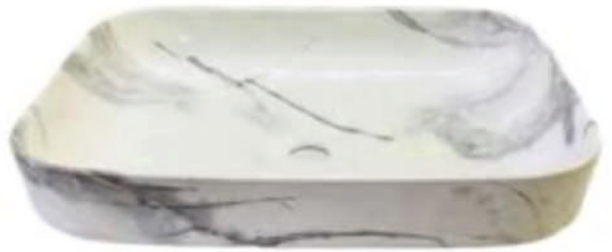

ADG-D038

M.R.P. ₹ 5700.00



ADG-0258

M.R.P. ₹ 5700.00

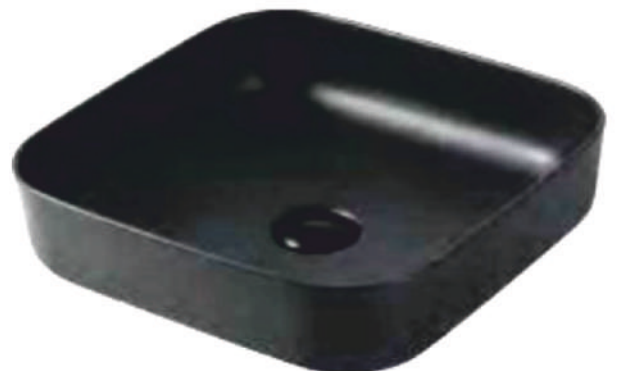

ADG-C018

M.R.P. ₹ 5700.00



Terms & Conditions

- Prices are subject to change prior Notice.
- The company products specifications and features change without prior notice.
- All disputes are subject to Noida Jurisdiction.



ANJUL

OUR COLLECTION



P.T.M.T. FAUCETS



SHOWER



CISTERN



SEAT COVER



UNBREAKABLE ACC.



PP TAPS



KITCHEN SINKS



ACCESSORIES



SANITARYWARE



CPVC PIPE & FITTING



MANUFACTURED & MARKETED BY:

ANJUL INDUSTRIES

380, 381, Udyog Kendra-1, Ecotech-III, Greater Noida, G.B. Nagar-201306 (U.P.)

E-mail: info@anjulindustries.com

Website: www.anjulindustries.com | Customer Care No.0120-605-1175