

Product Overview

XCompletion Tubing Anchor Catcher - XC-1 is a retrievable double-grip tubing anchor designed to secure the tubing string under both tension and compression. When set with the correct tubing tension, the tool stabilizes the tubing string during rod-pumping operations, minimizing vertical movement. This stability improves pump efficiency, increases fluid production per stroke, and extends the operational life of the pump, rods, and tubing—ultimately reducing overall lifting and maintenance costs.

The tool incorporates a fully adjustable emergency shear-release mechanism, allowing field personnel to configure release values as required. Unless otherwise requested, the XC-1 Anchor Catcher is supplied with secondary shear-release settings calibrated to 22,000 daN (50,000 lbs).

For superior reliability and reduced service costs, the XC-1 Anchor Catcher utilizes drag pads supported by Inconel leaf springs. This design delivers more consistent drag engagement and reduces repair requirements by at least 50% compared to legacy drag-spring systems.

Features & Benefits

- Adjustable safety shear release
- Drag block allow the anchor to be run deeper than conventional drag spring anchors
- Available in Left and Right hand set configurations.
- Optional Carbide slips

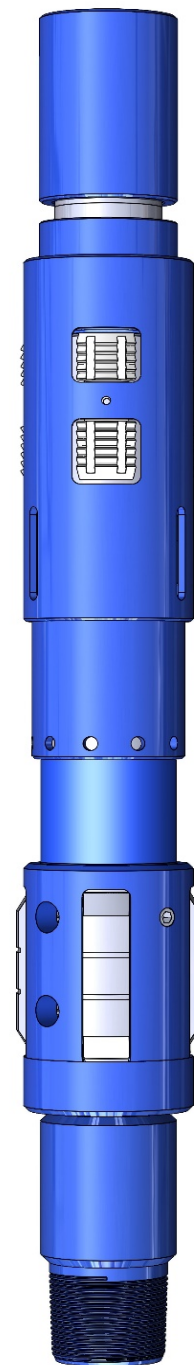



TUBING ANCHORS

Specifications

CASING						ANCHOR				
MAX. OD		WEIGHT		MIN. ID		TOOL OD		TOOL ID		THREAD EUE
(in.)	(mm)	(lb/ft.)	(kg/m)	(in.)	(mm)	(in.)	(mm)	(in.)	(mm)	
4 1/2	114.3	9.5 - 13.5	14.1 - 20.1	3.920	99.6	3.75	95.3	1.93	49.0	2 3/8
5	127	11.5 - 18.0	17.1 - 26.8	4.276	108.6	4.12	104.6	1.93	49.0	2 3/8
5 1/2	139.7	20.0 - 26.0	29.8 - 38.7	4.548	115.5	4.50	114.3	1.93	49.0	2 3/8
5 1/2	139.7	13.0 - 17.0	19.3 - 25.3	4.892	124.3	4.62	117.3	1.93	49.0	2 3/8
5 1/2	139.7	20.0 - 26.0	29.8 - 38.7	4.548	115.5	4.5	114.3	2.44	62.0	2 7/8
5 1/2	139.7	13.0 - 17.0	19.3 - 25.3	4.892	124.3	4.62	117.3	2.44	62.0	2 7/8
7	177.8	23.0 - 38.0	34.2 - 56.6	5.920	150.4	5.88	149.4	2.44	62.0	2 7/8
7	177.8	17.0 - 20.0	25.3 - 29.8	6.456	164	6.25	158.7	2.99	76	3 1/2
8 5/8	219.1	24.0 - 49.0	35.7 - 72.9	7.511	190.8	7.00	177.8	3.00	76.2	3 1/2
9 5/8	244.5	32.4 - 47.0	48.1 - 69.9	8.681	220.5	8.25	209.6	3.00	76.2	3 1/2

Proven Above | Trusted Below

www.xcompletion.com