



PRAKRIT

Exclusive 3 BHK TOWN HOUSES

A HOUSE FOR GENERATIONS

Contact 7066000058 | 7066000053 for Bookings or Site Visit

SUSTAINABLE HOMES AMIDST *nature's embrace*

Nestled amidst lush greenery and serene landscapes, Our project is a visionary & Luxury Town Houses that stands as a testament to harmonious living with nature. Situated in the heart of Zirakpur in most green vicinity, this innovative development offers a sustainable and eco-friendly lifestyle that redefines modern living. The concept behind our luxury villa project was born out of a deep-rooted desire to create a residential haven where residents could escape the hustle and bustle of urban life and embrace a more balanced, expandable, sustainable, and healthier way of living. With a focus on preserving the natural beauty of the surroundings, the project aims to strike a seamless balance between need of the hour for and environmental consciousness.

Exclusive
3 BHK TOWN HOUSES

Contact 7066000058 | 7066000053 for Bookings or Site Visit

Disclaimer: This document is a conceptual draft of a future project, and is created for internal use only.

LOCATION *map*



Contact 7066000058 | 7066000053 for Bookings or Site Visit

LOCATION *advantage*

CONVENIENTLY LOCATED ON
CHANDIGARH-PATIALA HIGHWAY (NH-64)

2 Min.

- Mohali City Square
- Gopal Sweets

3 Min.

- HP Petrol Pump
- Holy Convent School
- Radisson Hotel

5 Min.

- Bus Stop
- MCD/KFC/Burger King
- Amcare Hospital
- Decathlon
- PVR Cinema
- HLP Social Square

15 Min.

- Best Price & Metro
- Upcoming Metro Station
- International Airport
- IT City & AERO City
- Elante Mall
- ST. Xavier's School
- Railway Station
- Amity University

High Ground Road, Patiala Rd, Zirakpur – Punjab

SITE *Plan*

Conceptual Plan

Subject to final approvals & amendments as per Authority.



PROJECT *amenities*



BASKETBALL COURT



KIDS PLAY ZONE



POLLUTION FREE
ENVIRONMENT



RAIN WATER
HARVESTING



UNDERGROUND
WIRING



CCTV
SURVEILLANCE



GATED TOWNSHIP
WITH 24X7 SECURITY



GREEN PARK FOR
YOGA AND MEDITATION



WIFI CONNECTIVITY

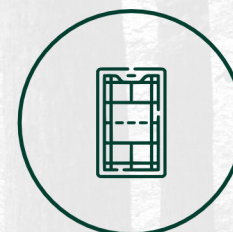

BADMINTON COURT



GYMNASIUM



POWER BACKUP



MULTIPURPOSE
PARTY HALL



24X7 WATER SUPPLY

TECHNICAL *Specifications*

Contact 7066000058 | 7066000053 for Bookings or Site Visit

LIVING/DINING ROOM

- Vitrified/ceramic Tiles
- Long-lasting Emulsion Walls
- Branded UPVC Windows
- Secure Mortise Locks
- Premium Modular Switches
- Copper Wiring for AC
- 8 feet High Flush Doors
- Designer Wallpaper



TOILETS

- Anti-skid Ceramic Tiles
- Designer Ceramic Tiles
- 8 feet High Flush Doors
- Secure Mortise Locks
- Premium Modular Switches
- Branded Bath Fittings
- Branded CPVC Fittings



MASTER BEDROOM

- Vitrified,/Ceramic Tiles
- Long-lasting Emulsion Walls
- Branded UPVC Windows
- 8 feet High Flush Doors
- Secure Mortise Locks
- Premium Modular Switches
- Copper Wiring for AC
- Designer Wallpaper



OTHER ROOMS

- Vitrified,/Ceramic Tiles
- Long-lasting Emulsion Walls
- Branded UPVC Windows
- 8 feet High Flush Doors
- Secure Mortise Locks
- Premium Modular Switches
- Copper Wiring for AC
- Designer Wallpaper



KITCHEN

- Modular Kitchen
- Granite Counter Top
- Double Bowl SS sink
- Branded Faucet
- Provision for under sink RO
- Branded Chimney
- HOB



STANDARD FEATURES

- Power Backup
- Wiring as per IGBC Standards
- Table Tennis
- 24x7 security
- Earthquake Resistant Structure



Disclaimer: This document is a conceptual draft of a future project, and is created for internal use only.



CLUB *house*

CLUBHOUSE FACILITIES AS NEVER BEFORE

- Multipurpose Party Hall
- Recreation Room
- Billiards Room
- Table Tennis
- Gymnasium
- Badminton Court
- Basketball Court & many more...

Contact 7066000058 | 7066000053 for Bookings or Site Visit



Disclaimer: This document is a conceptual draft of a future project, and is created for internal use only.

FLOOR *Plan*

EXCLUSIVE 3 BHK TOWN HOUSES

GROUND FLOOR



FLOOR *Plan*

EXCLUSIVE 3 BHK TOWN HOUSES

FIRST FLOOR



FLOOR *Plan*

EXCLUSIVE 3 BHK TOWN HOUSES

TERRACE FLOOR

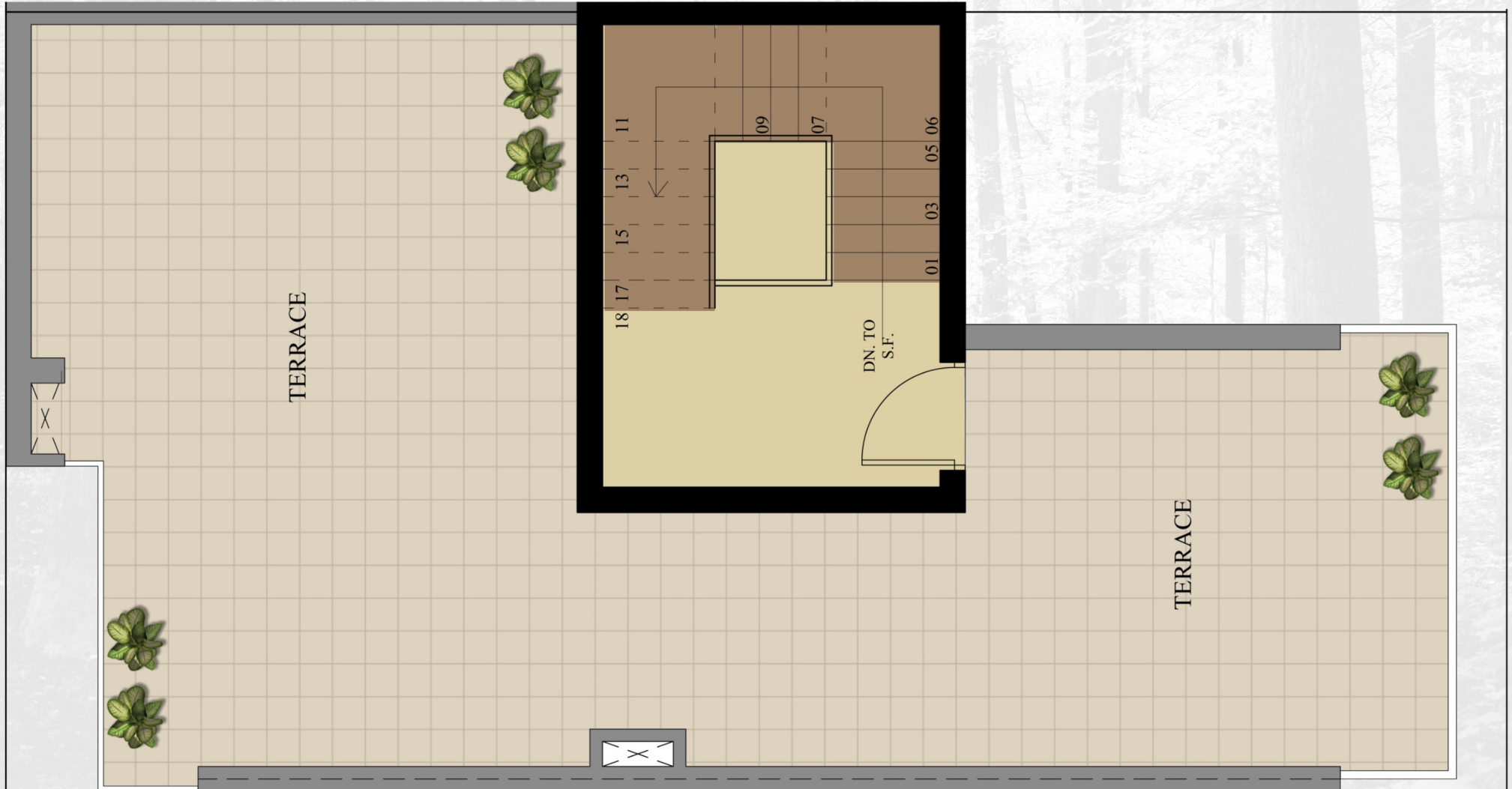

CONCEPTUAL PROJECT *image*



CONCEPTUAL PROJECT *image*



CONCEPTUAL PROJECT *image*



CONCEPTUAL PROJECT *image*



CONCEPTUAL PROJECT *image*



CONCEPTUAL PROJECT *image*



CONCEPTUAL PROJECT *image*



CONCEPTUAL PROJECT *image*





EXPERIENCE THE ENCHANTING SYMPHONY OF NATURE
NESTLED AMIDST TOWERING TREES AND

Flourishing greenery