



FOOTBALL ACADEMY PROJECT GHANA





340 m² Prefabricated Dining Block:

- Dining Hall
- Kitchen + Hot hall
- Storage
- Pantry
- Cold Hall
- Washing Hall

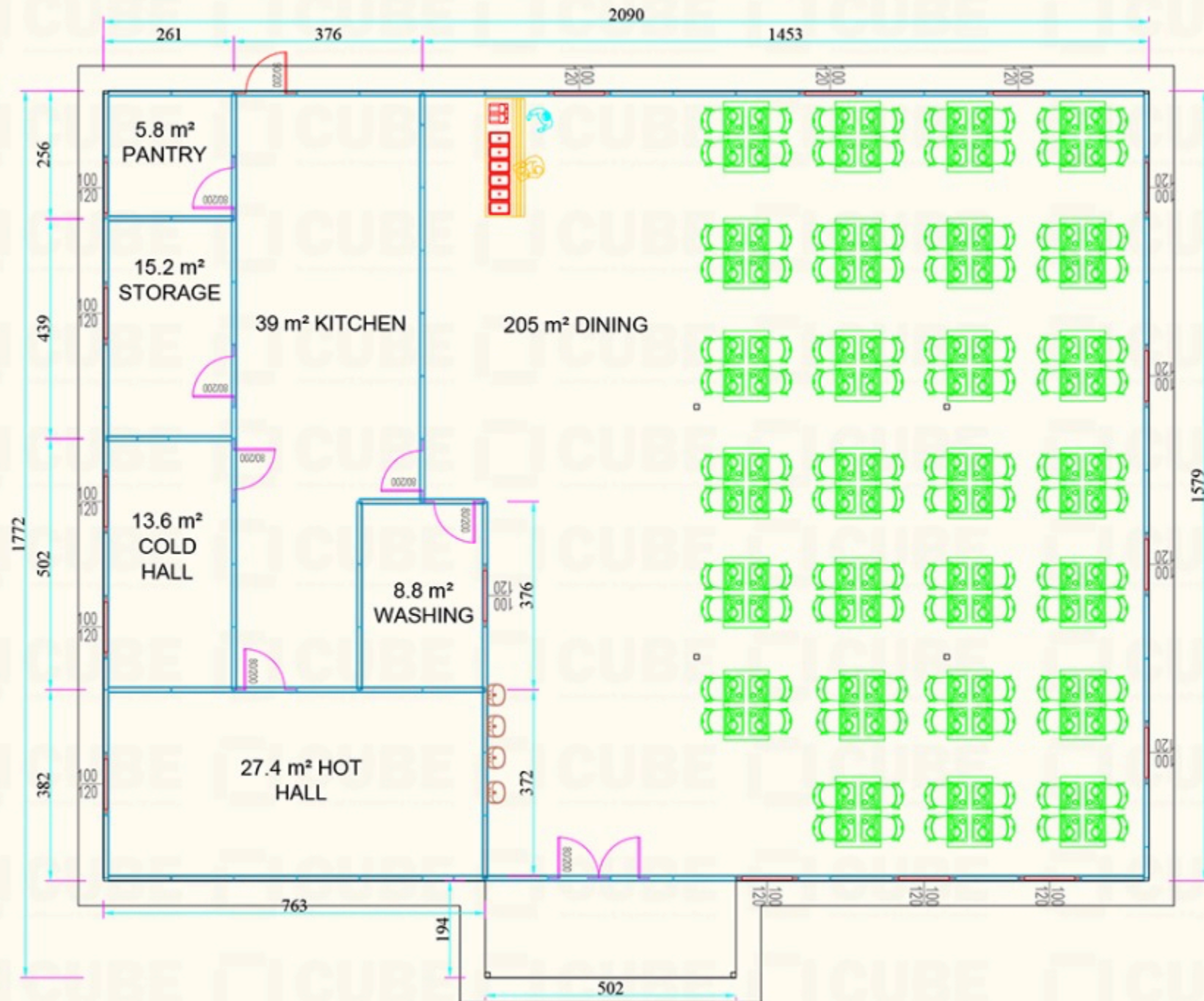



313 m² Prefabricated GYM Block:

- GYM
- Storage
- 14 WC's
- 12 Wash basin
- 2 lockers Halls
- 2 Laundry Halls

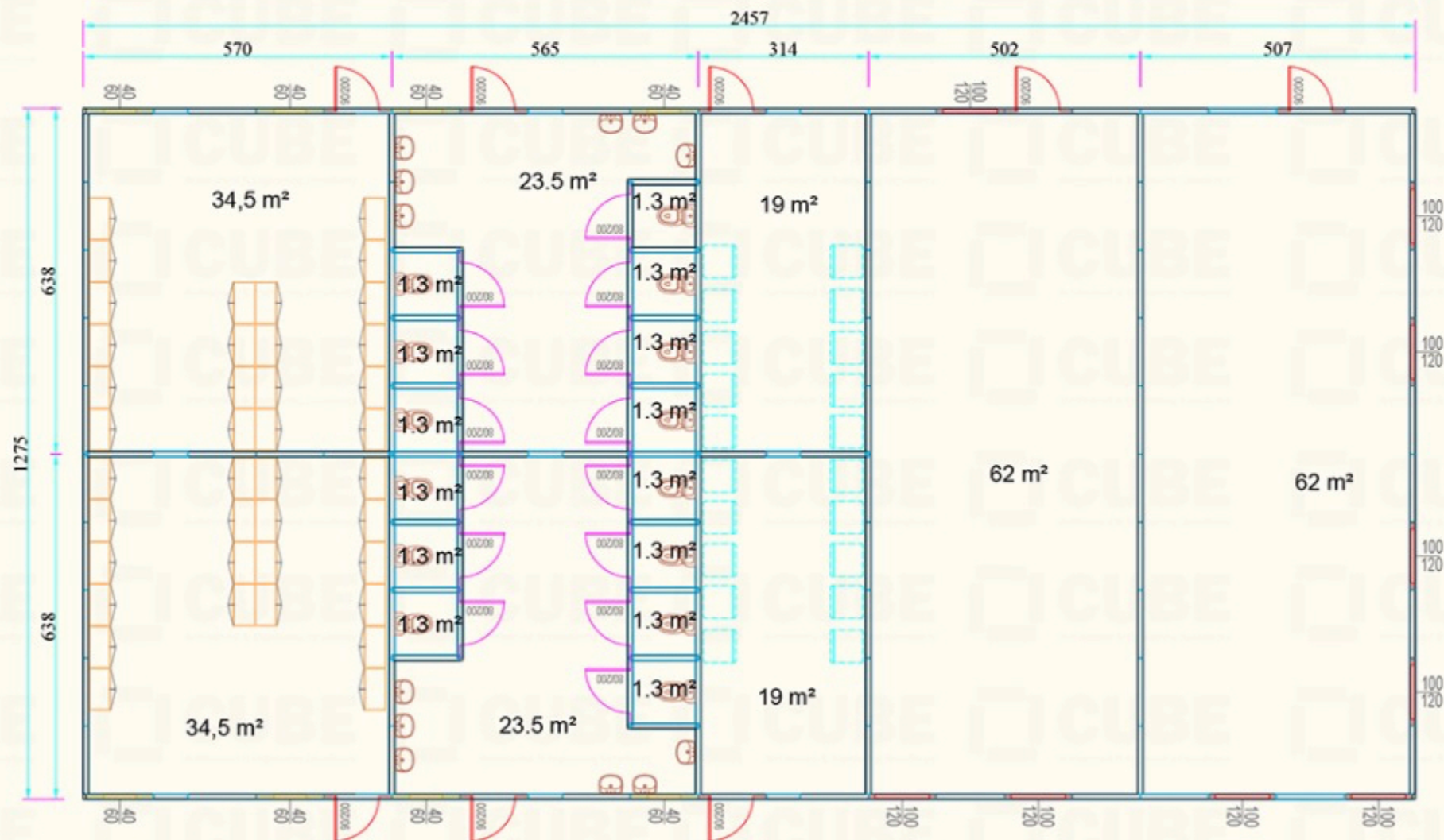



2 Blocks of 246m² Prefabricated Hostel Blocks:

- Junior Staff Residence
- 2 Stories building
- Ext Steel Stair
- 8 Bed Rooms x 18.5 m²
- 4 WC's + 4 Showers
- 8 Wash Basins

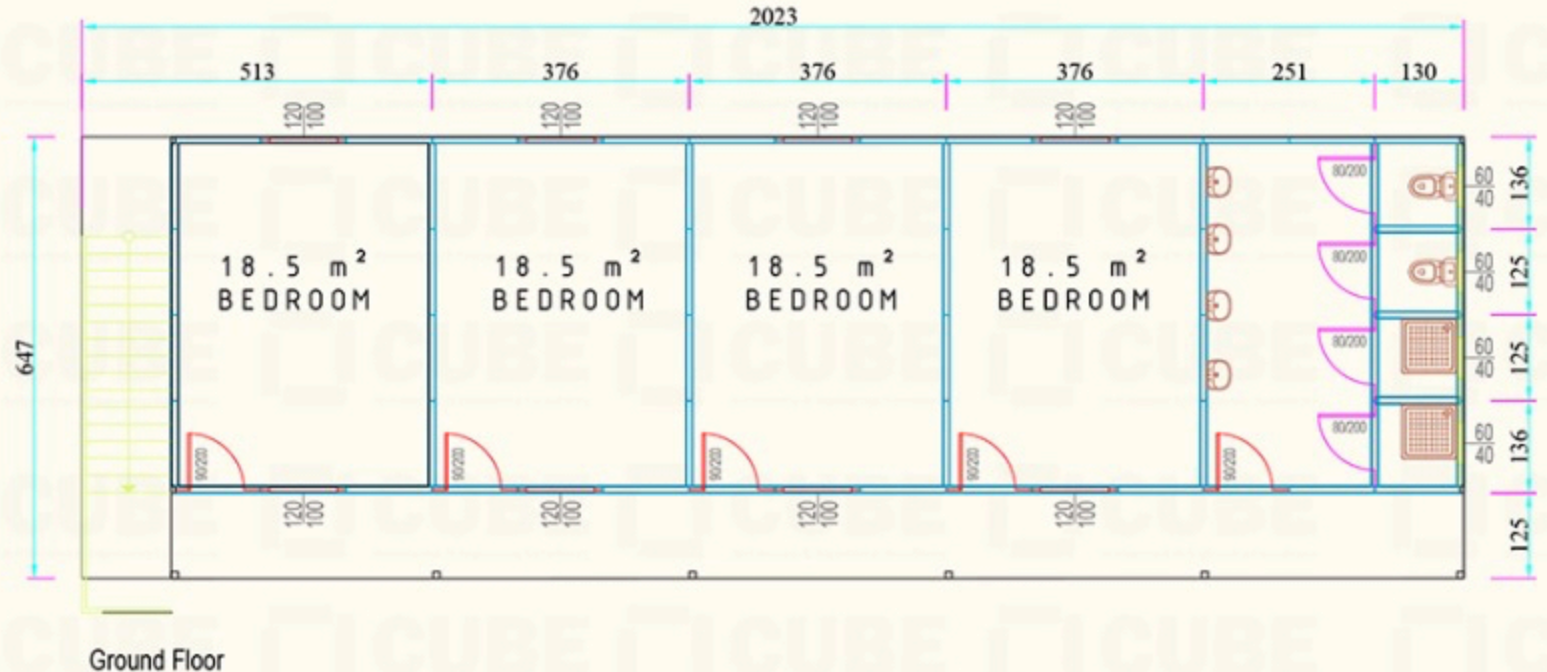
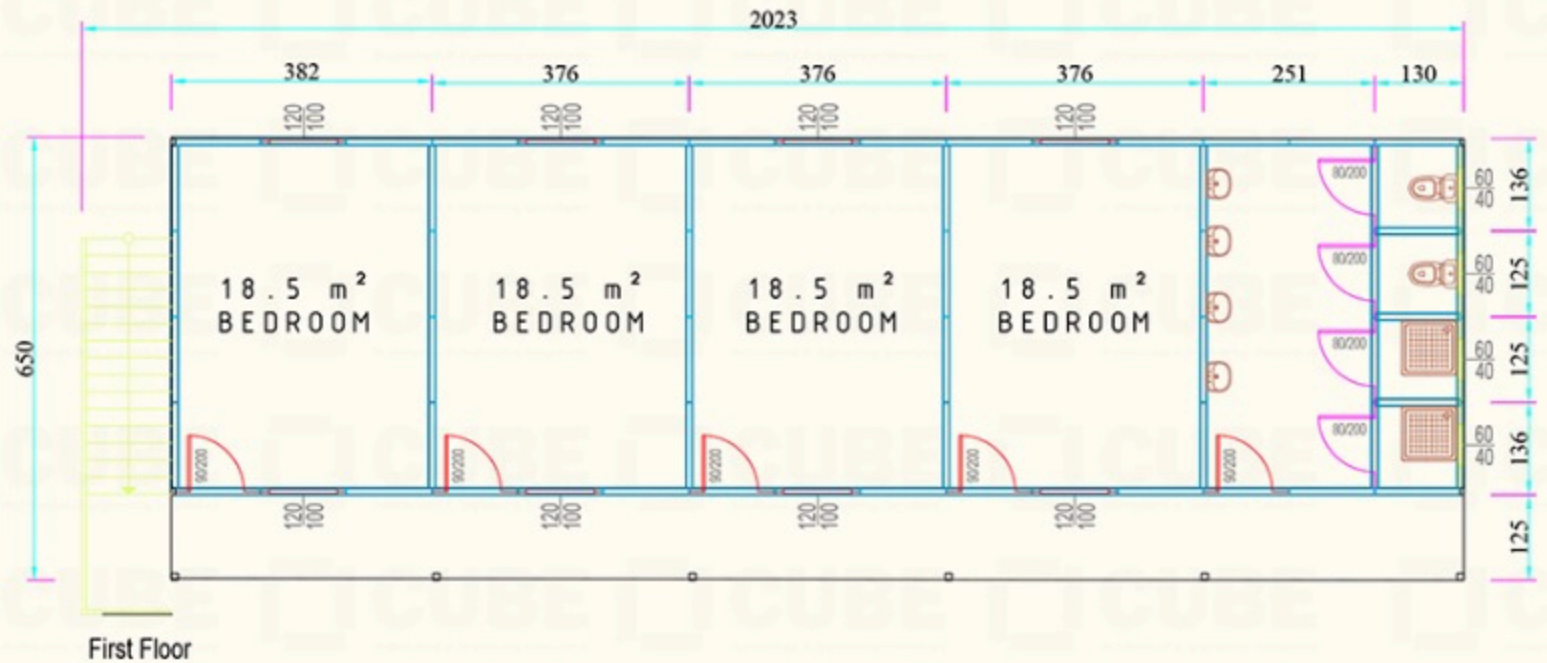



2 Blocks of 258 m² Prefabricated Semi-detached house Block:

- 2 Management Simi Detached Houses
- Entrance
- Living Room
- 2 Bed Rooms
- Bathroom
- Storage
- Kitchen

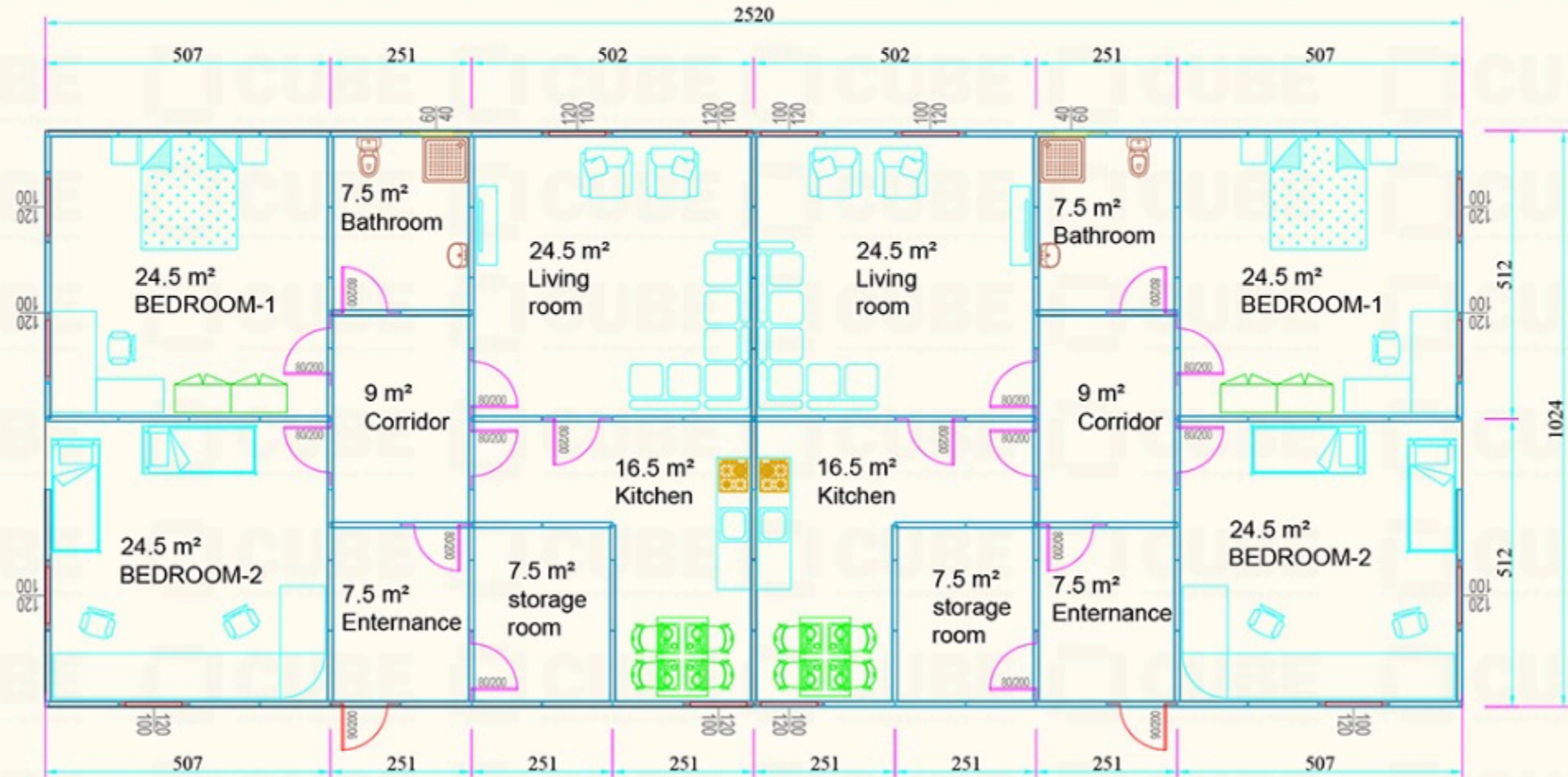



320 m² Prefabricated Hostel Block:

- Senior Staff Residence
- 2 Stories building
- Ext Steel Stair
- 24 Bed Rooms x 7.5 m²
- 4 WC's + 4 Showers
- 6 Wash Basins

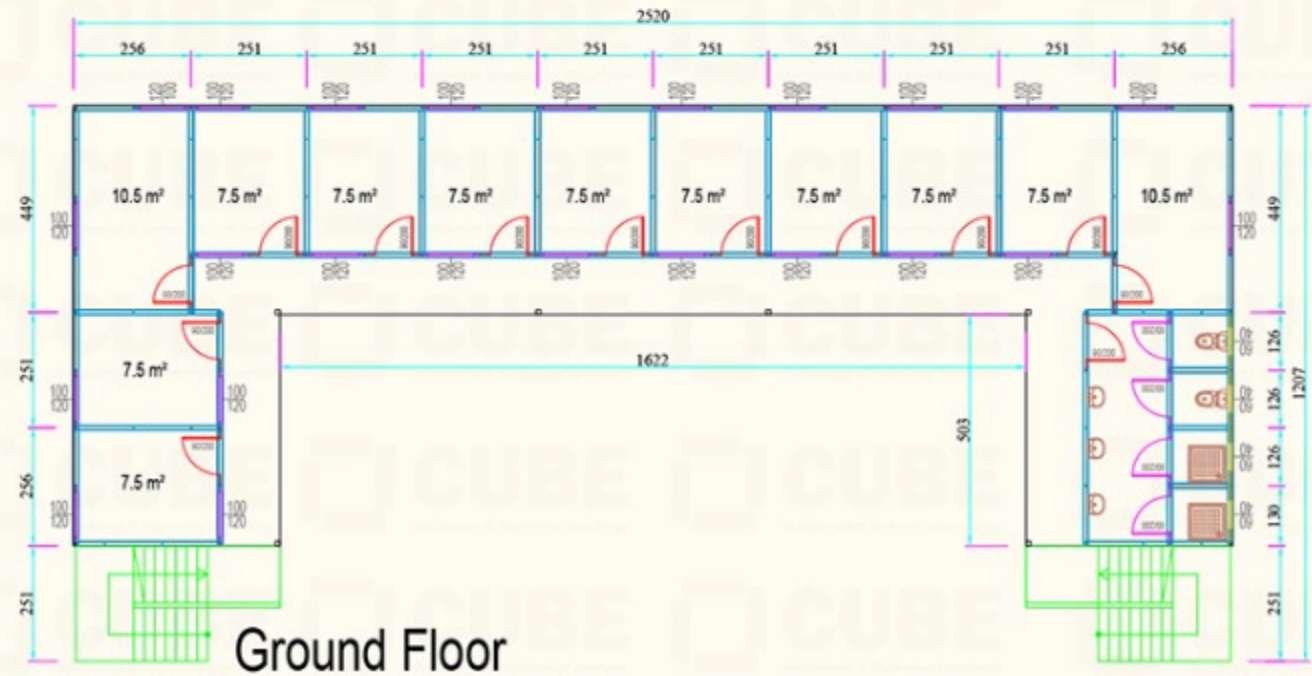
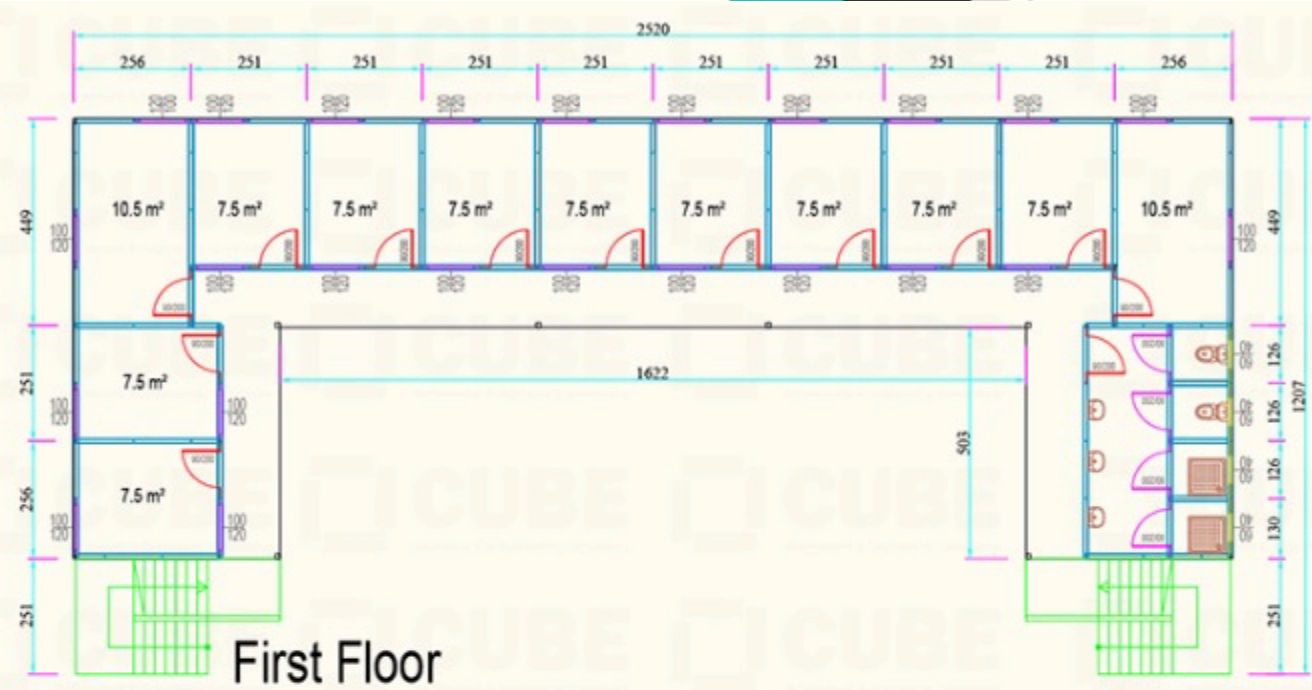



484 m² Prefabricated Training Center Block:

- 3 Training Class Rooms
- Games Hall + WC's
- Clinic and Medical
- WC's + Washbasins

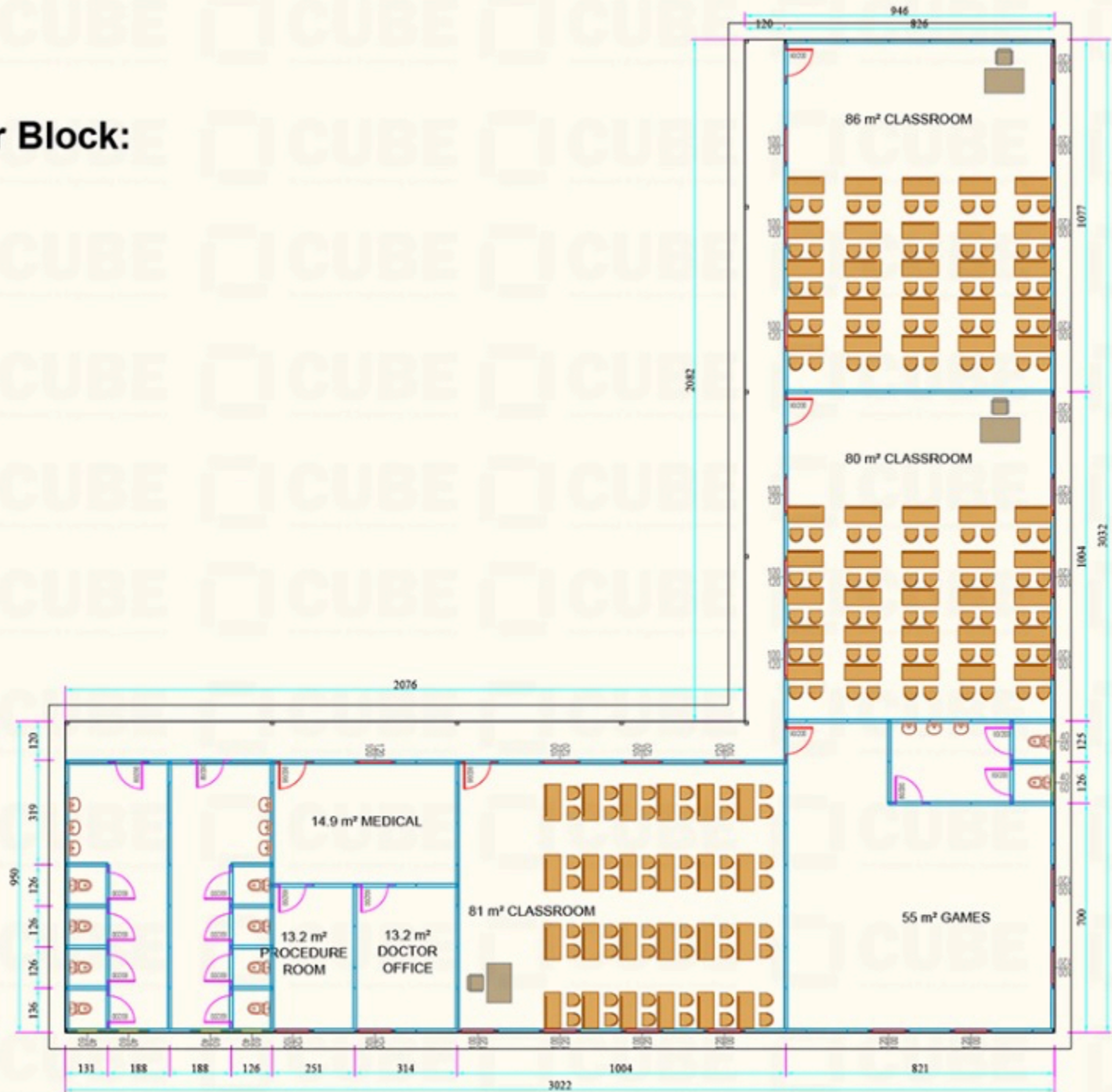























PROJECT ASSEMBLING PICTURES





J C C
GROUP

info@jccgroup.co

+2250747444498

📍 11 BP 114 ABIDJAN 11