



**E&C**

**Elisha & Charles Solutions, Inc.**  
“Your Elevator and Escalator Company”



***Fuji***  
***Elevator***

# E&C

Elisha & Charles Solutions, Inc.  
“Your Elevator and Escalator Company”

**Elisha & Charles Solutions, Inc.** is founded on the principles of innovation and progress, inspired by two pioneers who transformed the way we move. The name **Elisha** honors **Elisha Otis**, the **inventor of the elevator**, and **Charles** refers to **Charles Seeberger**, who **developed the modern escalator**. Just as their inventions revolutionized vertical transportation, we aim to drive forward cutting-edge solutions that elevate industries and enhance everyday life. Whether it's through innovative technology, efficient services, or tailored strategies, we are dedicated to taking businesses and communities to new heights.

# **COMPANY PROFILE**

## **Our Philosophy**

Elevating Safety, Innovation, and Customer Experience

## **Our Mission**

To provide safe, reliable, and innovative vertical and horizontal transportation solutions that enhance mobility in buildings and public spaces.

## **Our Vision**

To be the global leader in elevator and escalator solutions, setting the standard for safety, innovation, and sustainability.

## **Our Goals**

To continually improve and expand our range of vertical and horizontal transportation solutions, ensuring safety, efficiency, and reliability.

# **CORPORATE HEADS**



**Atty. Rogelio D. Peig II**

Board of Directors  
Member



**Mr. Jasper A. Vloria**

President, CEO



**Engr. Genaro S.  
Piceller PME**

Chairman of the  
Board

# CORPORATE HEADS



**Mr. Neio John E. Peig**

Board of Directors  
Member



**Mr. Julius G. Jamarabon**

Treasurer



**Mr. Brendon C. Enteria**

Installation Head



**Engr. Saturnino D.  
Palen, PEE**

Preventive  
Maintenance Head

# ***ABOUT THE PRODUCT***

Fuji Elevator is prominent quality known for supplying its high-quality products to over 30 nations across Africa, the Middle East, North America, South America, and Southeast Asia.

While the primary manufacturing site for Fuji Elevator is in Japan, similar products are produced under rigorous quality control in China and Taiwan.



***Fuji***  
***Elevator***



# Authorization Certificate



## AUTHORIZATION CERTIFICATE

This is to certify that

**Elisha & Charles Solutions, Inc.**

Add: Unit 104, Mission Garden Condominium, 59 Scout Ybardolaza Street, South Triangle, Quezon City, Philippines

is distributor of FUJI ELEVATOR (ASIA) CO., LTD. in Philippines. It is appointed and authorized by FUJI ELEVATOR (ASIA) CO.,LTD. to present, promote, supply, install, engineering and after service in Philippines.

Wan Zhenyong  
Chairman of the Board

FUJI ELEVATOR (ASIA) CO.,LTD.

Date: August 28, 2024

**FUJI ELEVATOR (ASIA) CO.,LTD.**

21F, Building C, Ouhai Headquarters E conomical Park,  
No. 81, Zhonghui Road, Wenzhou City, Zhejiang Province, China  
Tel: +86 18958888553 E-mail: export@cnfuji.com  
Website: www.fujielevatorcn.com

# Certificate of Incorporation



REPUBLIC OF THE PHILIPPINES  
SECURITIES AND EXCHANGE COMMISSION  
3/F Newtown Square, Navy Base Road, Baguio City



COMPANY REG. NO.: 2024090168525-00

## CERTIFICATE OF INCORPORATION

KNOW ALL PERSONS BY THESE PRESENTS:

This is to certify that the Articles of Incorporation and By Laws of:

**ELISHA & CHARLES SOLUTIONS, INC.**

were duly approved by the Commission on this date upon the issuance of this Certificate of Incorporation in accordance with the Revised Corporation Code of the Philippines (Republic Act No. 11232), which took effect on February 23, 2019 and copies of said Articles of Incorporation and By Laws are hereto attached.

This Certificate grants juridical personality to the corporation but does not authorize it to issue, sell or offer for sale to the public, securities such as but not limited to, shares of stock, investment contracts, debt instruments and virtual currencies without prior Registration Statement approved by the Securities and Exchange Commission; nor to undertake business activities requiring a Secondary License from this Commission such as, but not limited to acting as: broker or dealer in securities, government securities eligible dealer (GSED), investment adviser of an investment company, close-end or open-end investment company, investment house, transfer agent, commodity/financial futures exchange/broker/merchant, financing/lending company, and time shares/club shares/membership certificate issuers or selling agents thereof; nor to operate a fiat money to virtual currency exchange. Neither does this Certificate constitute a permit to undertake activities for which other government agencies require a license or permit.

This Certificate **DOES NOT AUTHORIZE INVESTMENT SOLICITATION AND INVESTMENT-TAKING WITHOUT A SECONDARY LICENSE FROM THIS COMMISSION.**

As a registered corporation, it shall submit annually to this Commission the reports indicated at the back of this certificate.

IN WITNESS WHEREOF, I have hereunto set my hand and caused the seal of this Commission to be affixed to this Certificate at 3/F Newtown Square, Navy Base Road, Baguio City, Philippines, this day of 13 September Two Thousand Twenty Four.

REGINA MAY M. CAJUCOM - DE GUZMAN  
Director

*This is a computer generated certificate,  
signature is not required.*

For SEC use only  
S969 (PSIC as reserved)  
Stock Corporation  
Regular

DOCUMENTARY STAMP TAX PAID

# Mayor's Permit



**MAYOR'S PERMIT**  
Business Permits and Licensing Department

Mayors Permit No. <b>24-910195</b>	Type of Application <b>NEW</b>	Official Receipt No. <b>B-2024-000-195-0003530</b>	Date of Payment <b>10/10/2024</b>
Date Issued <b>OCTOBER 12, 2024</b>	Valid Until <b>OCTOBER 12, 2025</b>	Amount Paid <b>30,137.00</b>	Period Covered <b>1-4(4) 2024</b>
Business Name <b>ELISHA &amp; CHARLES SOLUTIONS, INC.</b>			
Trade Name <b>ELISHA &amp; CHARLES SOLUTIONS, INC.</b>			
President <b>VILORIA, JASPER ALEC A.</b>			
Address <b>U104 MISSION GARDEN CONDOMINIUM 59 SCT. YBARDOLAZA SOUTH TRIANGLE DISTRICT 4, QUEZON CITY 1103</b>			
Type of Business Organization <b>CORPORATION</b>	Proof of Business Registration <b>SEC 202409016852500</b>	TIN <b>659-653-553-000</b>	SSS <b>000-000-000</b>
<b>CONTRACTOR</b> * REPAIR AND MAINTENANCE OF ELEVATORS			
Area of Establishment <b>20.00 SQM</b>	Total No. of Employees Male: 0 Female: 0		
<b>Ancillary Clearance</b>	<b>Clearance No.</b>	<b>Validity</b>	
Locational Certificate (ZAU)	C24-N-GEXX25HV	2024-10-07 to 2029-10-07	
Sanitary Permit (QCHD)	NOT REQUIRED	NOT REQUIRED	
Fire Safety Inspection Certificate (BFP-QC)	FOR COMPLIANCE	FOR COMPLIANCE	
Barangay Clearance (BARANGAY SOUTH TRIANGLE)			
Traffic Clearance (TTMD)	NOT REQUIRED	NOT REQUIRED	
Environmental Clearance (DSQC)	FOR COMPLIANCE	FOR COMPLIANCE	
Veterinary Clearance (CVD)	NOT REQUIRED	NOT REQUIRED	
Market Clearance (MDAD)	NOT REQUIRED	NOT REQUIRED	
Liquor Clearance (BPLD)	NOT REQUIRED	NOT REQUIRED	
Security Clearance (DPOS)	NOT REQUIRED	NOT REQUIRED	
QC Tourism Certificate (QCTD)	NOT REQUIRED	NOT REQUIRED	
Occupational Permit of employees (BPLD): 0			

Subject to: COND. 1, 2, 3, 4, 5 & 7 \*\* TO COMPLY WITH ANCILLARY REMARKS AND FINDINGS AS SENT VIA EMAIL DURING EVALUATION OF PERMIT APPLICATION BY REGULATORY DEPARTMENTS/OFFICES WITHIN 45 DAYS. TO SUBMIT DTI ACCRED. WITHIN 45 DAYS. THIS PERMIT IS VALID ONE (1) YEAR FROM DATE OF ISSUE PURSUANT TO CITY ORDINANCE NO. SP-3013, S-2021, SUBJECT TO PROVISIONS OF APPLICABLE LAWS, ORDINANCES, RULES AND REGULATIONS PERTINENT TO THE CONDUCT OF BUSINESS. FAILURE TO COMPLY SHALL REVOKE/CANCEL THIS PERMIT.



Remarks:  
• NON-TRANSFERABLE AND VALID ONLY WITH CORRESPONDING OFFICIAL RECEIPTS SHOWING PAYMENT OF PERMIT FEES AND CITY TAXES. ERASURE/ALTERATIONS WILL INVALIDATE THIS PERMIT.  
• FAILURE TO RENEW THIS BUSINESS PERMIT/LICENSE WITHIN THE PRESCRIBED PERIOD SHALL SUBJECT THE TAXPAYER TO A TWENTY-FIVE PERCENT (25%) SURCHARGE OF THE PERMIT FEE.

For and By Authority of the City Mayor:  
**HON. MA. JOSEFINA G. BELMONTE**

*Margarita Meja*  
**MA. MARGARITA MEJIA, DPA**  
City Government Department Head III

**ANY ERASURE/ALTERATION WILL INVALIDATE THIS PERMIT**

# ○○○○ **FUJI FACTORY**



## **Japan Factory Address:**

599-3, Maegasaki, Nagareyama Shi, Chiba  
Ken, Japan



## **Taiwan Factory Office:**

7F – 7 No. 133, Ren 1st Rd., Ren'ai District  
Keelung City, Taiwan



## **China Factory Offices:**

21F, Building C, Ouhai Headquarters  
Economical Park, No. 81, Zhonghui Road,  
Wenzhou City, Zhejiang Province, China  
E-mail: [export@cnfuji.com](mailto:export@cnfuji.com)





○ ○ ○ ○

# ***ANNUAL PRODUCTION CAPACITY***

- **5000** Elevators
- **20000** Parking Lifts
- **2000** Moving Walk
- **3000** Escalators

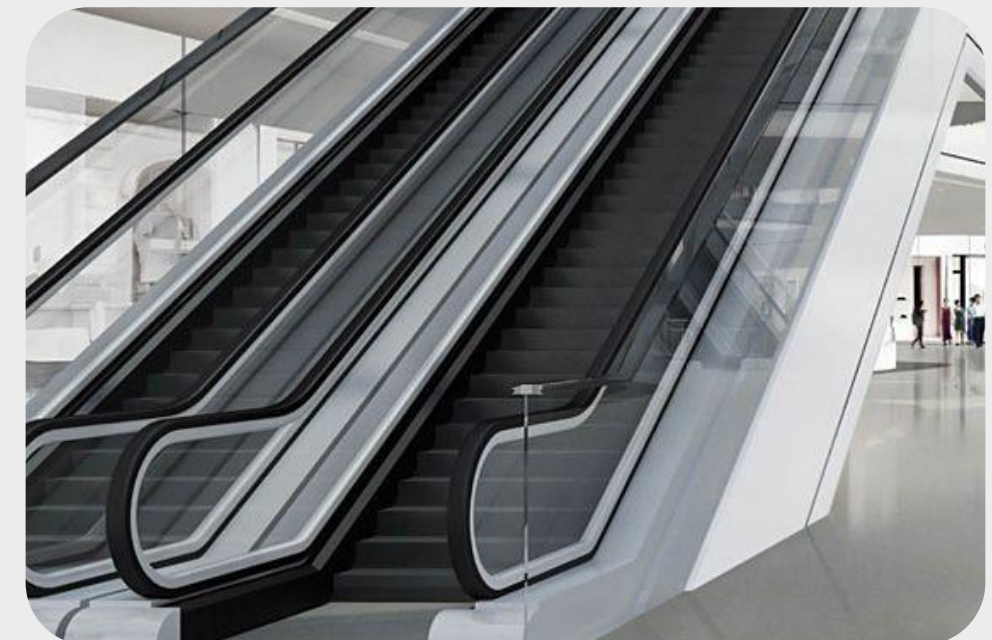



# ***KEY PRODUCTS AND SERVICES***

## **PRODUCTS**

- Passenger Elevator
- Bed Elevator
- Observation Elevator
- Cargo elevator
- Car Elevator
- Dumbwaiter elevator
- Escalator & Moving walk

## **SERVICES**

- Regular Maintenance & Safety Checks (Elevator & Escalator)
- Modernization of Existing Elevator/Escalator



# ON-GOING PROJECT

## 1.) Navotas Convention Center

1 Unit Scenic Elevator

Date Started

October 2024

Target Date Completion February 2025

## 2.) Caloocan City North Medical Center

2 Units Passenger Elevator

Date Started

October 2024

Target Date Completion

January 2025

## 3.) Navotas Polytechnic College

2 Units Passenger Elevator

Date Started

October 2024

Target Date Completion

January 2025

## 4.) 101 Wack-Wack Apartment

2 Units Passenger Elevator

Date Started

October 2024

Target Date Completion

February 2025

## 5.) Ospital ng Makati Main Building

2 Units Passenger Elevator and

1 Unit Hydraulic Elevator

Date Started

October 2024

Target Date Completion

February 2025

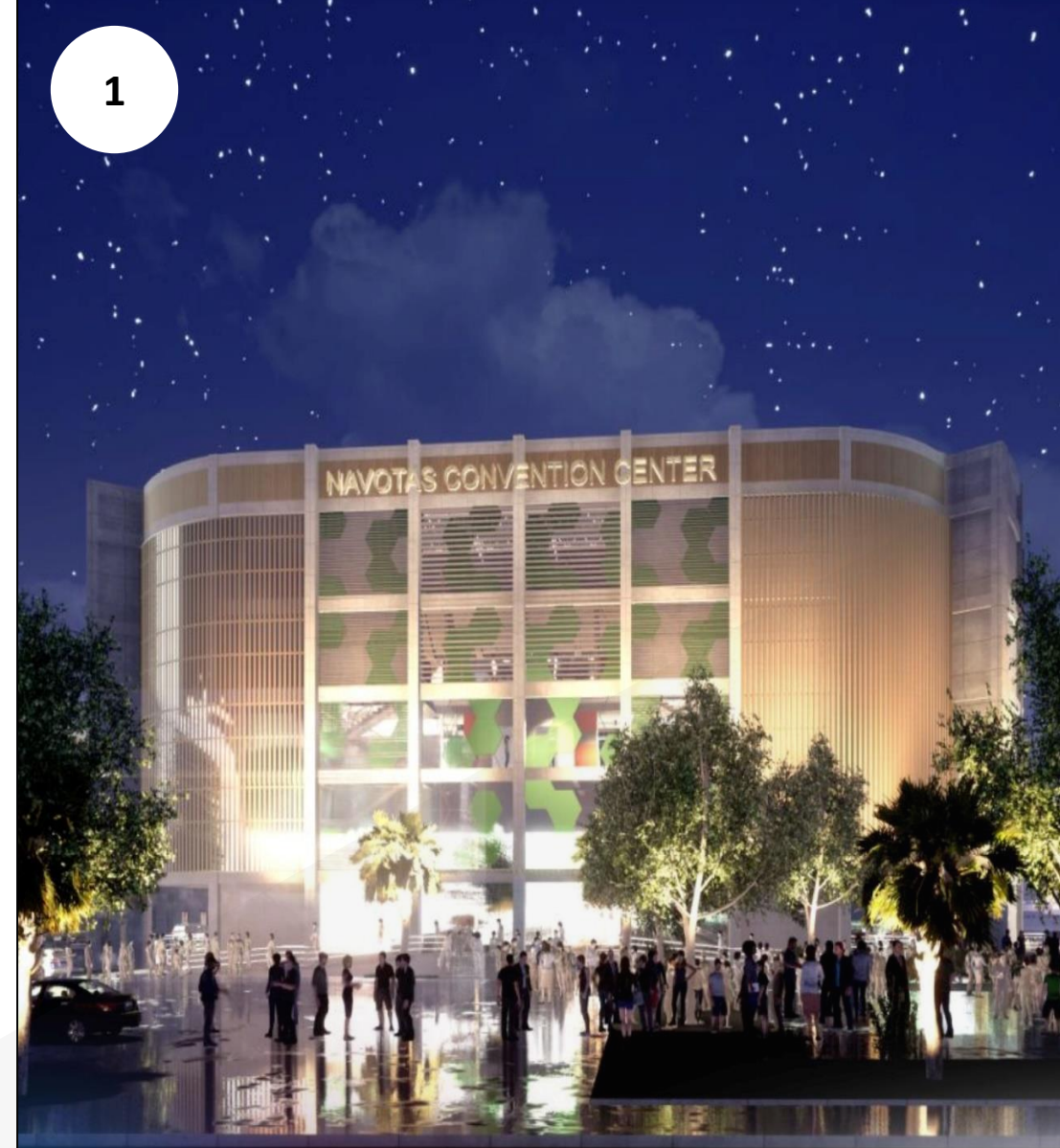

# ON-GOING PROJECT

## 6.) Alvarado Residence

1 unit Home Elevator

**Date Started**

December 2024

**Target Date Completion**

March 2025

## 7.) Sandico Project

1 Unit Passenger Elevator

**Date Started**

December 2024

**Target Date Completion**

June 2025

## 8.) Maristel Project (under construction)

1 Unit Scenic Elevator

1 Freight Elevator

4 Escalator

**Date Started**

December 2024

**Target Date Completion**

June 2025

## 9.) Pineapple St. Malabon Project

1 unit Home Elevator

**Date Started**

December 2024

**Target Date Completion**

March 2025

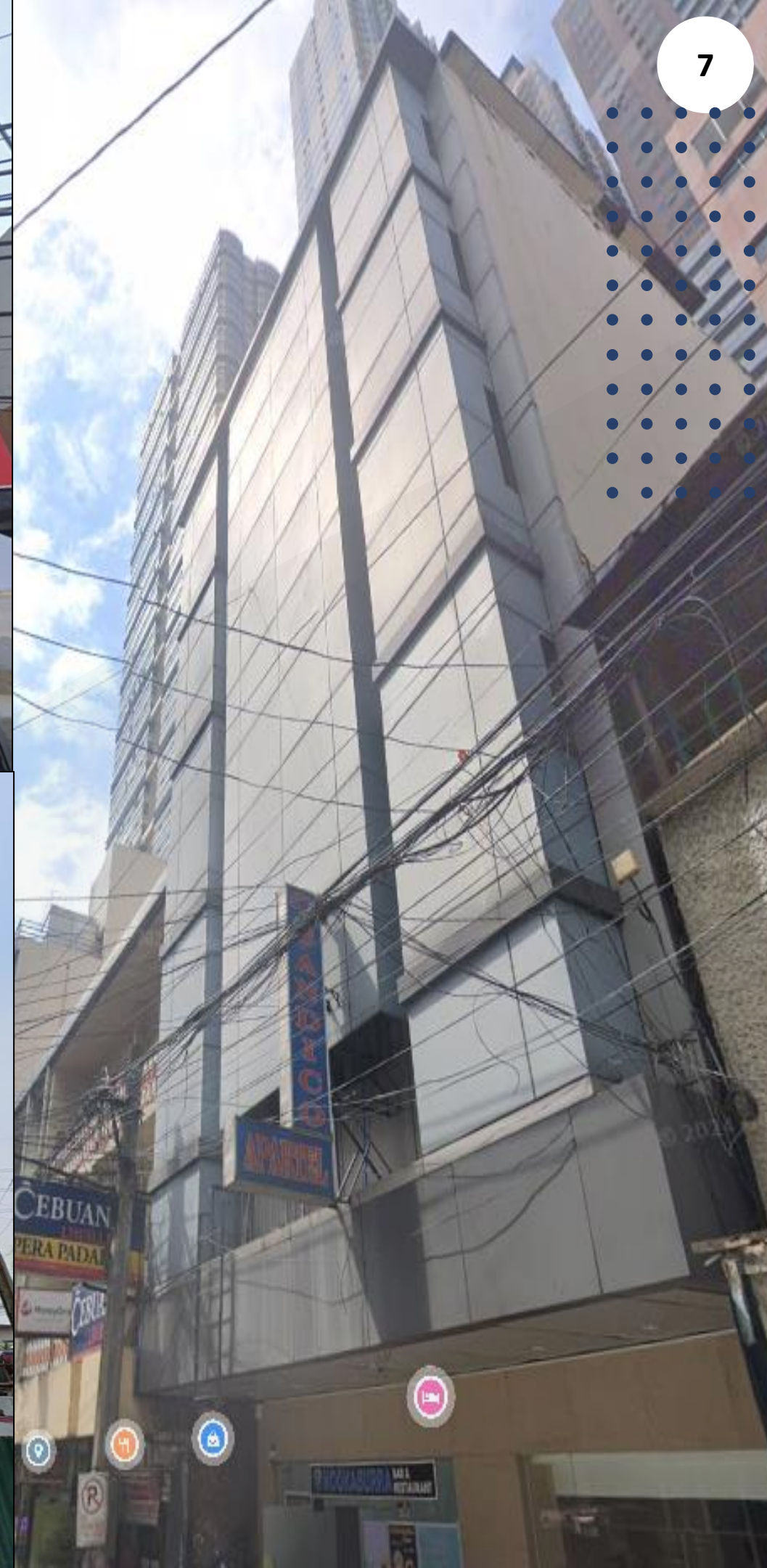

# PREVENTIVE MAINTENANCE

## 1.) Rose Building (Quezon City)

1 Unit Passenger Elevator

## 2.) Project 8 (Kango Express)

1 Unit Passenger Elevator

## 3.) Manhattan Townhomes Quezon City

1 unit Home Elevator

## 4.) Mary the Queen College Quezon City

1 Unit Passenger Elevator

## 5.) Paradise Garden Boracay

1 Unit Passenger Elevator

1 Unit Capsule Type Elevator

## 6.) The Forum

2 Unit Passenger Elevator

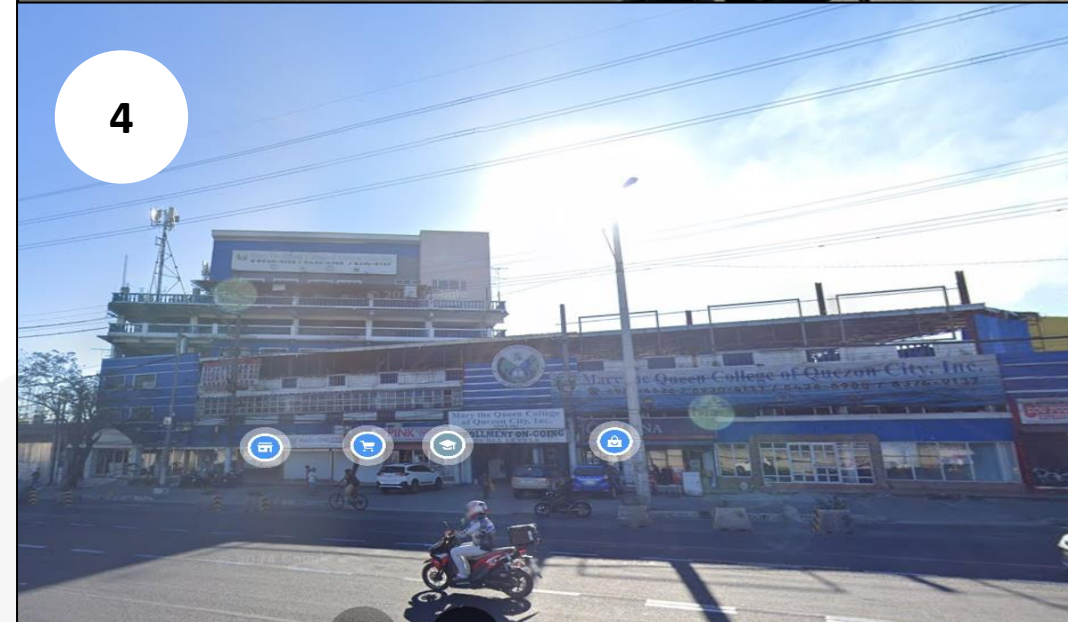

# PREVENTIVE MAINTENANCE

## 7.) Makati Sports Complex

- A. San Antonio Community Sports
- B. Olympia Community Sports
- C. West Rembo Community Complex
- D. Comembo Community Sports Complex
- E. Pitogo Community Complex
- F. Valenzuela Community Sports Complex

**6 Units Elevator**



# **PREVENTIVE MAINTENANCE PROJECT ACEMC Hospital Projects:**

**1. ACEMC Hospital – Mandaluyong Project**

**3 Units Bed Elevator**

**2. ACEMC HOSPITAL – Dipolog Project**

**4 Units Bed Elevator**

**3. ACEMC HOSPITAL – San Jose Del Monte Project**

**3 Units Bed Elevator**

**4. ACEMC HOSPITAL – Sariaya Project**

**3 Units Bed Elevator**

**5. ACEMC HOSPITAL – Tuguegarao Project**

**2 Units Bed Elevator**

**6. ACEMC HOSPITAL – Pangasinan Project**

**3 Units Bed Elevator**

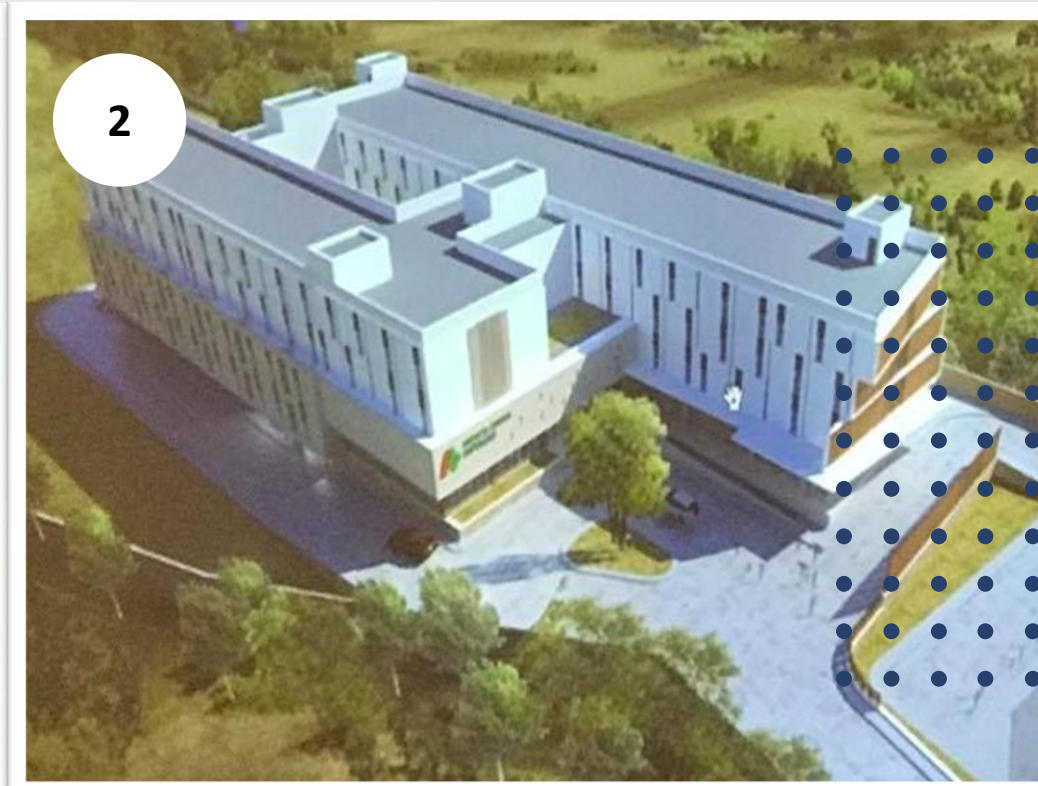



---

# THANK YOU

*We look forward to working  
with you*

---

## OFFICES



**Makati Office:** G and A Realty building, 2303 Chino Roces Ave, Makati, Metro Manila



**QC Office:** Mission Garden Condominium, 59 Sct. Ybardolaza, Sacred Heart, South Triangle, Quezon City, 1103 Metro Manila



**Phone:** +63-2-8823-1673

**Phone:** +63-917-112-2195



**Email:** [ecsi.sales24@gmail.com](mailto:ecsi.sales24@gmail.com)

