

PGL

Calibration Pump (± 400 mbar)

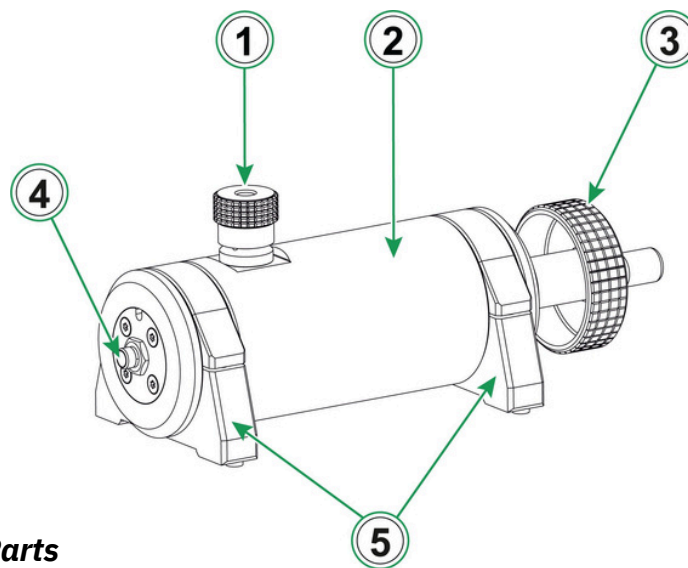

Figure PGL Parts

1. Combined Fine Adjust Knob and Release Valve (clockwise to increase and counterclockwise to decrease pressure and vent)
2. Cylinder
3. Coarse Adjust Handwheel (clockwise to increase pressure)
4. Pressure output fitting. Default: Bx G 1/8" male for the Beamex 40 bar pressure hose
5. Support legs. (By loosening the screws of both legs, it is possible to readjust the cylinder so that the Fine Adjust Knob is located on the left or right side of the pump, whichever feels more convenient in terms of usability)

Specifications

Specification	PGL
Pressure Range ¹	-400 to +400 mbar / -160 to 160 iwc
Adjusting Sensitivity	< ± 0.05 mbar / 0.02 iwc ²
Pressure change after 1 min waiting time and readjustment ³	< 0.3 mbar / min / 0.12 iwc / min
Wetted Parts	Stainless steel, nitrile rubber, polyacetal See
Dimensions	technical drawing: Figure 1: Technical Drawing
Weight	~1.8 kg / 4.0 lbs
Pressure Port	G1/8" (ISO228/1) female port with pressure fitting (Bx G1/8" male) for Beamex 40 bar pressure hose
Pressure Media	Air
Storage Temperature	-20 to 60°C / -4 to 140°F
Operating Temperature	0 to 50°C / 32 to 122°F
Humidity	< 95%RH

¹Depending on the volume of the test setup. With smaller volumes (max. 20 ml / 0.68 fl.oz) you can also operate in the following pressure ranges: -0.7 to 3.0 bar / -281 to 1204.4 iwc.

²Into a volume of max. 20 ml / 0.68 fl.oz.

³In stable conditions and a volume of max. 20 ml / 0.68 fl.oz.