

TOP VIEW (UPPER DECK)

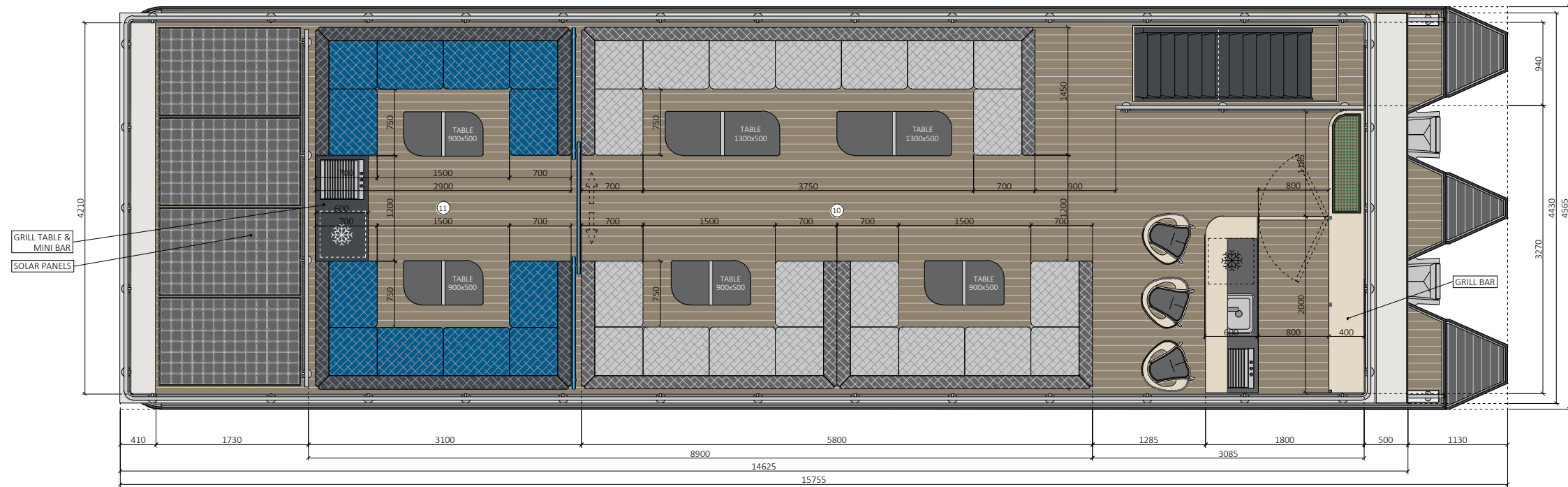

TOP VIEW (INTERIOR)

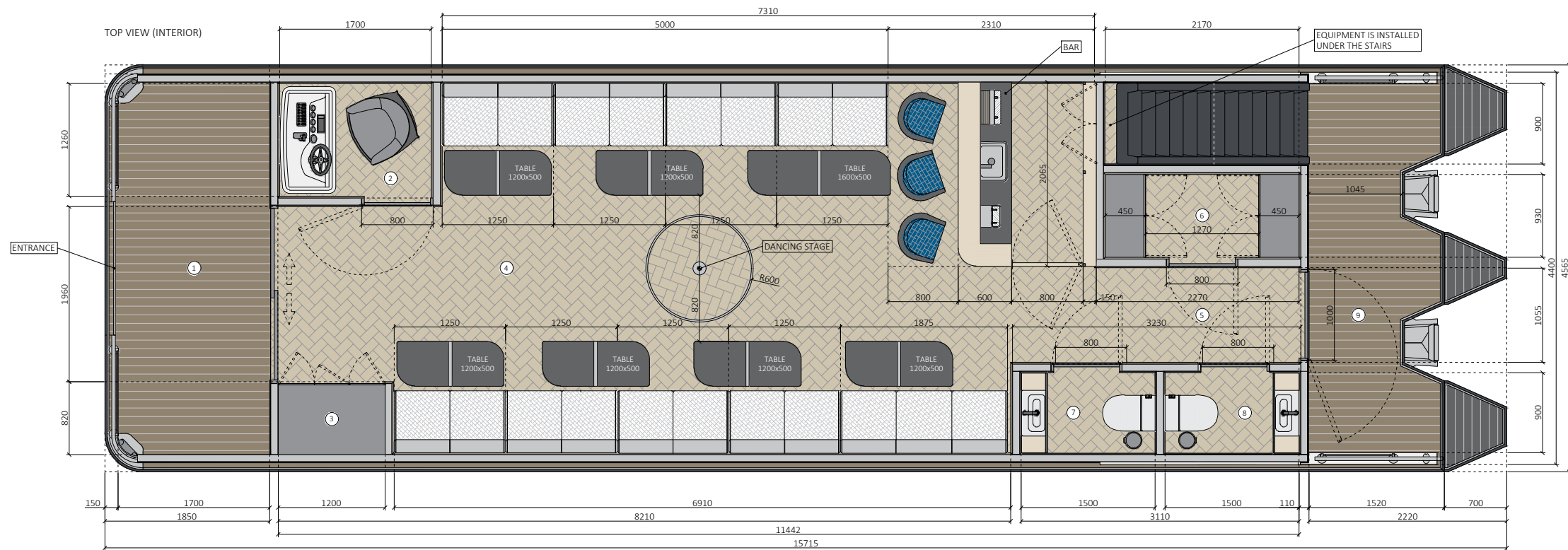

VESSEL EXPLANATION		
NO.	ROOM	AREA (m ²)
1	Front deck	7,05
2	Cabin	2,16
3	Wardrobe	0,96
4	Main room	36,37
5	Corridor	2,52
6	Technical room	2,14
7	WC no.1	1,44
8	WC no.2	1,44
9	Rear deck	5,50
10	Upper deck main area	34,61
11	Upper deck VIP	13,04
Total interior area		47,03
Total exterior area		60,20
Total area of the vessel		107,23
*Reserved for solar panels		7,12

MAIN PROJECTIONS: INTERIOR & UPPER DECK. SOLUTION NO.2					A3	1 / 1
PROJECT: PRIVATE VESSEL "ATHENA 160" (MOTOR TRIMARAN)						
MANUFACTURER						
COMPANY	PAREIGOS	VARDAS PAVARDĖ	DATA	PARAŠAS		
UAB "Inter corpora"	Production manager	Remigijus Kaniauskas	2020-09-01			
DESIGNER						
"IN"	Designer	Deividas Kaniauskas	2020-09-01			
CLIENT						