

Low voltage and high frequency ionizing air blower KF-06W (constant air volume)



Technical Parameters

Category	Parameters	Category	Parameters
Model	KF-06W	Air volume	0.55-0.71m³/min (constant air volume)
Input voltage	DC24V	Ozone concentration	0.03ppm(distance 150mm)
Decay time	1.5s(200mm)	Working temperature	0-40°C
Ion balance	Automatic ion balance system 0±15V	Working humidity	30-70%RH(No condensation or water droplets)

Test conditions working voltage:DC24V testing voltage: ±1000V-±100V Temperature: 23°C±2°C

Distance	Decay time (+/-)	Ion balance (+/-)
200mm	1.5s/-2.0s	0±15V
300mm	2.0s/-2.5s	0±15V

Remark: 1. Testing method: Using charged plate monitor to test.
2. Decay time means with the maximum air volume from ±1000V to ±100V.
3. Test in the central area of the front air window.

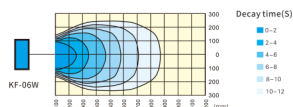

Features

- 01 Apply high frequency AC type to achieve excellent ion balance.
- 02 Special tungsten alloy discharge needle for longer service time.
- 03 Unique appearance design and visual management of working performance.
- 04 Removable discharge needle parts and the front window, convenient for cleaning, maintenance and replacement.

Ionizing air blower KF-06W (constant air volume)

Dimension /84.5×55×112mm Weight /0.56kg (including stand)

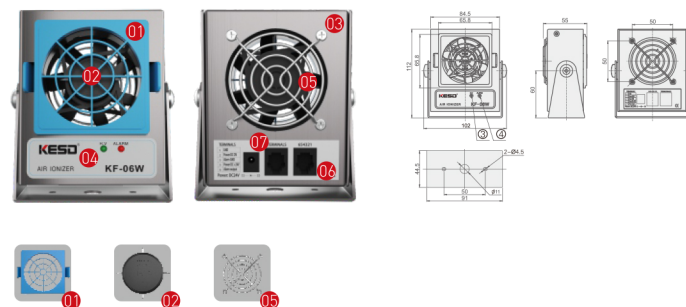

- 01 **Front window (KF-06W-BL)**
The linear grid type air window is used to make the blow wind linear, increase the static elimination effect, and can be flexibly disassembled for easy maintenance.
Accessory, can be purchased separately.
- 02 **Discharge needle (KF-06W-Z1)**
Discharge needle parts can be disassembled for replacement and maintenance. Cleaning or maintenance outside the working area to avoid secondary pollution.
Accessory, can be purchased separately.
- 03 **Housing**
The outer casing is made of stainless steel, which is more suitable for use in clean rooms.
- 04 **Indicator**
● Green lights on in normal working condition.
● Red lights on in abnormal operating condition.
- 05 **Metal window mesh (60x60mm)**
Accessory, can be purchased separately.
- 06 **Network socket**
- 07 **Power socket**

Low voltage and high frequency ionizing air blower KF-10A (adjustable air volume)



Technical Parameters

Category	Parameters	Category	Parameters
Model	KF-10A	Air volume	0.82-1.21m ³ /min
Input voltage	DC24V	Ozone concentration	0.03ppm(distance 150mm)
Decay time	1.5s(200mm)	Working temperature	0-40°C
Ion balance	Automatic ion balance system 0±10V	Working humidity	30-70%RH (No condensation or water droplets)

Test conditions working voltage:DC24V testing voltage: ±1000V ±100V Temperature: 23°C±2°C

Distance	Decay time (+/-)	Ion balance (+/-)
200mm	1.5s/-2.0s	0±15V
300mm	2.0s/-2.5s	0±15V

Remark: 1. Testing method: Using charged plate monitor to test.
2. Decay time means with the maximum air volume from ±1000V to ±100V.
3. Test in the central area of the front air window.

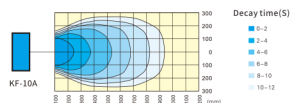

Features

- 01 Apply high frequency AC type to achieve excellent ion balance.
- 02 Indicator for fan operating alarm of both normal and abnormal condition.
- 03 Indicator for High voltage operating alarm of both normal and abnormal condition.
- 04 Visual management of working performance and wind speed display.
- 05 Removable discharge needle parts and the front window and convenient for cleaning, maintenance and replacement.

Ionizing air blower KF-10A (adjustable air volume) Dimension / 106 × 61 × 120mm (without stand) Weight / 0.63kg (including stand)

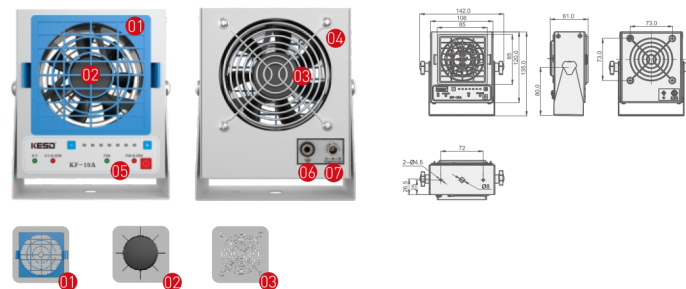

- 01 Front window (KF-10A-BH)
Use a linear grid type air window to concentrate the blow wind and enhance the static elimination effect, and can be flexibly disassembled for easy maintenance.
Accessory, can be purchased separately.
- 02 Discharge needle (KF-10A-Z2)
Discharge needle parts can be disassembled for replacement and maintenance. Cleaning or maintenance outside the working area to avoid secondary pollution.
Accessory, can be purchased separately.
- 03 Metal window mesh (80×80mm)
Accessory, can be purchased separately.
- 04 Housing
The outer casing is made of stainless steel, which is more suitable for use in clean rooms. (white powder coating)
- 05 LED Indicator
Unique LED display for visual viewing the work status and management.
 - normal working condition
 - abnormal working condition
 - fan normal operating condition
 - fan abnormal operating condition
- 06 Grounding socket
- 07 Power socket

Low voltage and high frequency ionizing air blower KF-21F



Technical Parameters

Category	Parameters	Category	Parameters
Model	KF-21F	Air volume	2.56-4.07m³/min
Input voltage	DC24V	Ozone concentration	0.03ppm(distance 150mm)
Decay time	1.5s(200mm)	Working temperature	0-40°C
Ion balance	Automatic ion balance system 0±10V	Working humidity	30-70%RH(No condensation or water droplets)

Test conditions working voltage:DC24V testing voltage: ±1000V-±100V Temperature: 23°C±2°C

Distance	Decay time (+/-)	Ion balance (+/-)
300mm	1.0s/-1.5s	0±10V
600mm	2.5s/-3.5s	0±15V
900mm	4.0s/-5.5s	0±20V

Remark: 1. Testing method: Using charged plate monitor to test.
2. Decay time means with the maximum air volume from ±1000V to ±100V.
3. Test in the central area of the front air window.

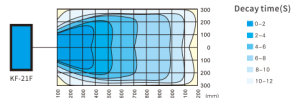

Features

- 01 Apply high frequency AC type to achieve excellent ion balance.
- 02 Special tungsten alloy discharge needle for longer service time.
- 03 Indicator for fan operating alarm of both normal and abnormal condition.
- 04 Indicator for High voltage operating alarm of both normal and abnormal condition.
- 05 Visual management of working performance and wind speed display.
- 06 Removable discharge needle parts and the front window and convenient for cleaning, maintenance and replacement.

Ionizing air blower KF-21F

Dimension /142×69×174mm(without stand) Weight /1.26kg (including stand)

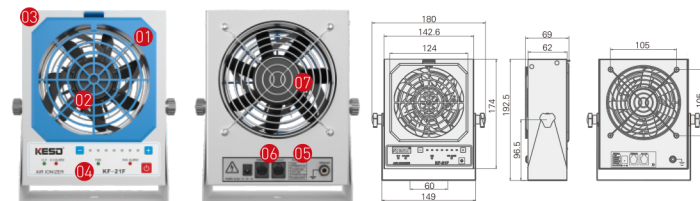

01 Front window

Use a linear grid type window to make the blowing wind diffuse and enhance the static elimination effect, and can be flexibly disassembled for easy maintenance.
Accessory, can be purchased separately.

02 Discharge needle (KF-21F-Z3)

Discharge needle parts can be disassembled for replacement and maintenance.
Cleaning or maintenance outside the work area to avoid secondary pollution.
Accessory, can be purchased separately.

03 Housing

Powder coating process, with standard white powder.

04 Indicator

Unique LED display for visual viewing the working status and management.

- H.V HV normal working condition
- HV ALARM HV abnormal working condition
- FAN fan normal operating condition
- FAN ALARM fan abnormal operating condition

□ --- □ Air volume decrease, increase button and air volume indicator

05 Rear label



06 Power supply

Equipped with DC socket and network power socket for easy connection with equipment and neat line.

07 Back window mesh

Metal window mesh (120x120mm) Filter window (accessory, can be purchased separately.)