



EXPERIENCE HOMES DESIGNED FOR MORE

Established in 2008, Provident Housing Limited is a large-scale community developer, offering the greatest value within the residential segment. The company caters to the diverse residential needs of buyers, with a focus on aspirational home ownership. Customer obsession is at the heart of everything we do at Provident Housing. This credo guides us in every aspect of our work, from design to handover, ensuring that we consistently enhance the customer's experience and elevate their lifestyle with homes designed for more.

16+ YEARS OF TRUST

9 PROJECT PRESENCE ACROSS CITIES

12.8 MILLION SQ. FT. DELIVERED

55,000+ HAPPY RESIDENTS

12,500+ HOMES DELIVERED

11,000+ HOMES IN THE MAKING





Scan QR

WE BELIEVE IN THE POWER OF MORE



OUR BELIEFS



More Value
We strive to bring you a holistic living experience within a thriving community.



More Trust
Uncompromising integrity is the way of life at Provident.



More Quality
Our work is built on modern technique, meticulous detailing, and industry expertise.

OUR WAY FORWARD



MORE TECHNOLOGY
We pay close attention to making our homes future-ready.



More Sustainability
We put nature at the centre of our processes and efforts.



More Transparency
Respect for our consumers translates to adoption of honest practices.



THE CENTRE OF POSSIBILITIES AND GROWTH



South Bengaluru exudes the old-world charm as some of the old renowned localities are located here. Mysore Road is also surrounded by prominent places of worship, lending the the region with rich heritage value. With several investments and cutting-edge infrastructure cropping up, South Bengaluru presents alluring opportunities for the future, making it every home buyer's dream.





Connectivity

The project is situated near NICE Junction, which connects the city's northern and southern suburbs, and provides a signal-free corridor between Hosur & Tumkur Road. A bus terminal, a railway station and two metro stations- particularly the Challaghatta Metro Station is within reach. With the current metro infrastructure, one can easily reach Central Bengaluru in 30 minutes. And with more metro phases being proposed and under development, Provident Sunworth City is a gold mine of connectivity.



Economic Corridor

The only residential neighbourhood connected to both IT and Manufacturing Hubs, provide employment to millions. The Bidadi Industrial Area spread across ~860 acres, housing some of the most prominent MNCs, along with Toyota, Bosch, Hindustan Coca-Cola Beverages, to name a few. Global Village Tech Park, spread over 120 acres with a total built-up area of 3.3 million sq.ft., has some of the most eminent IT/ITES like Accenture, Capgemini, Mindtree, etc.



Scan QR



Healthcare & Education

The micro-market has seen a steady growth in its social infrastructure development, with it becoming a Prominent hub for healthcare and education. Raja Rajeshwari Medical College, a well-reputed hospital, is just 1 km from the property. Within the 10 km radius, 5-6 prominent hospitals like BGS Gleneagles Global and Medsol are located. There are around 20+ Schools and 12+ Colleges & Universities are present in the area with premier ducational institutes like Tattva School, IBS School of Management & R.V. College of Engineering.



Tourism Corridor

Mysore Road, now a 10-lane Expressway, is a major tourism corridor, connecting picturesque hill stations in Tamil Nadu, Kerala, and Karnataka, so weekend plans are never canceled over traffic woes. Just 5 minutes away from the project, it ensures that one cruise through the traffic and reach Mysore in just 90 minutes.

LOCATION
MAP

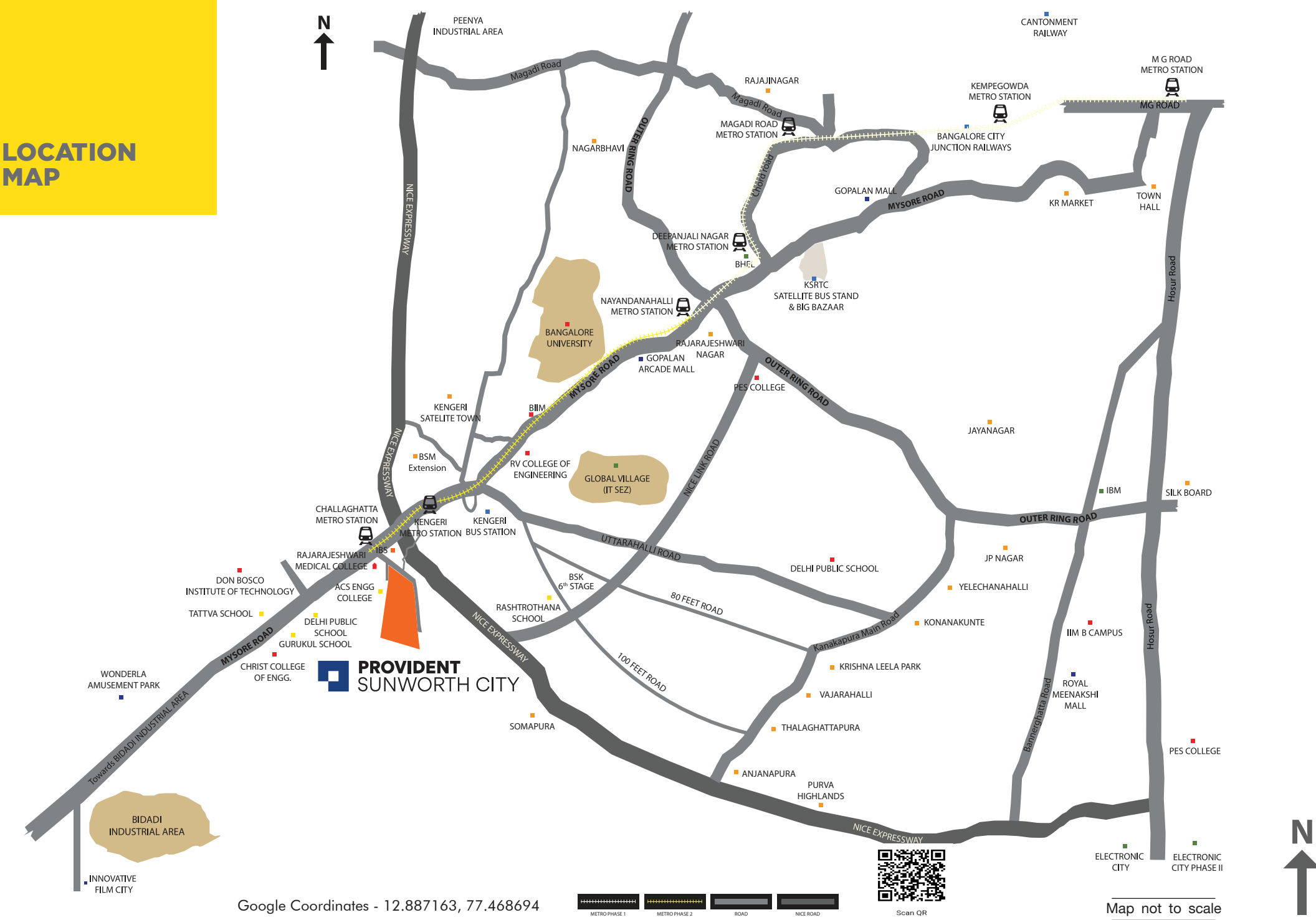

Google Coordinates - 12.887163, 77.468694



Map not to scale

LOCATION
HIGHLIGHTS

COMMUTE

- Challaghatta Metro Station - 2 km
- NICE Road Junction - 3 km
- Kengeri Metro Station - 3 km
- Kengeri Railway Station - 5 km
- Kengeri Bus Terminal - 6 km

OFFICES

- Global Village Tech Park - 7 km
- Bidadi Industrial Estate - 18 km
- Hindustan Coca Cola Beverages Ltd - 18 km
- Toyota Kirloskar Motor Pvt. Ltd. - 19 km

HOSPITALS

- Raja Rajeshwari Medical College and Hospital - 1 km
- Raja Rajeshwari Dental College and Hospital - 4 km
- BGS Hospital - 6 km
- Medisol Hospital - 7 km

ENTERTAINMENT

- Good Earth Eco Tourism - 1 km
- Grips Gokarting and Clubbing - 3 km
- Decathalon - 4 km
- The Garden Asia Resort - 5 km
- Gopalan Arcade Mall - 10 km
- Wonderla - 12 km

SCHOOLS

- National Public School - 4 km
- Marigold International School - 5 km
- Gurukula Vidya Peetha School - 6 km
- Gopalan National School - 6 km
- Tattva School - 9 km

COLLEGES

- ACS College of Engineering - 500 m
- RR College of Engineering - 5 km
- Don-Bosco Institute of Technology - 6 km
- RV College of Engineering - 9 km
- Bangalore University - 10 km

GOOGLE COORDINATES: 12.887163, 77.468694

PROVIDENT SUNWORTH CITY = PROVIDENT EQUINOX 4



THE DREAM OF EMBRACING THE CITY



Bengaluru is a metropolitan city that celebrates the culture of community living. A city which openly engulfs you with sounds and sights of nature and biodiversity, welcomes a 60-acre gated community that amasses the spirit of this phenomenal city.

In an era where people have limited time for loved ones, Provident Sunworth City comes through like a glimmer of hope. A flawless property built within the city, we've created a sanctum filled with love, laughter, and homeliness, with beautiful apartments, and an estate that captures the essence of an unparalleled sanctuary.

Let your escape be your home.





NOW ENTERING PROVIDENT SUNWORTH CITY

Imagine the home of your dreams.

Does it come alive in a city surrounded by nature?

Where your health thrives as you walk around the vast open spaces and enjoy a sport of your choice?

Where every little convenience is only a quiet walk away?

A place where you belong to a community of people that soon become family?

Then, we welcome you to Provident Sunworth City.

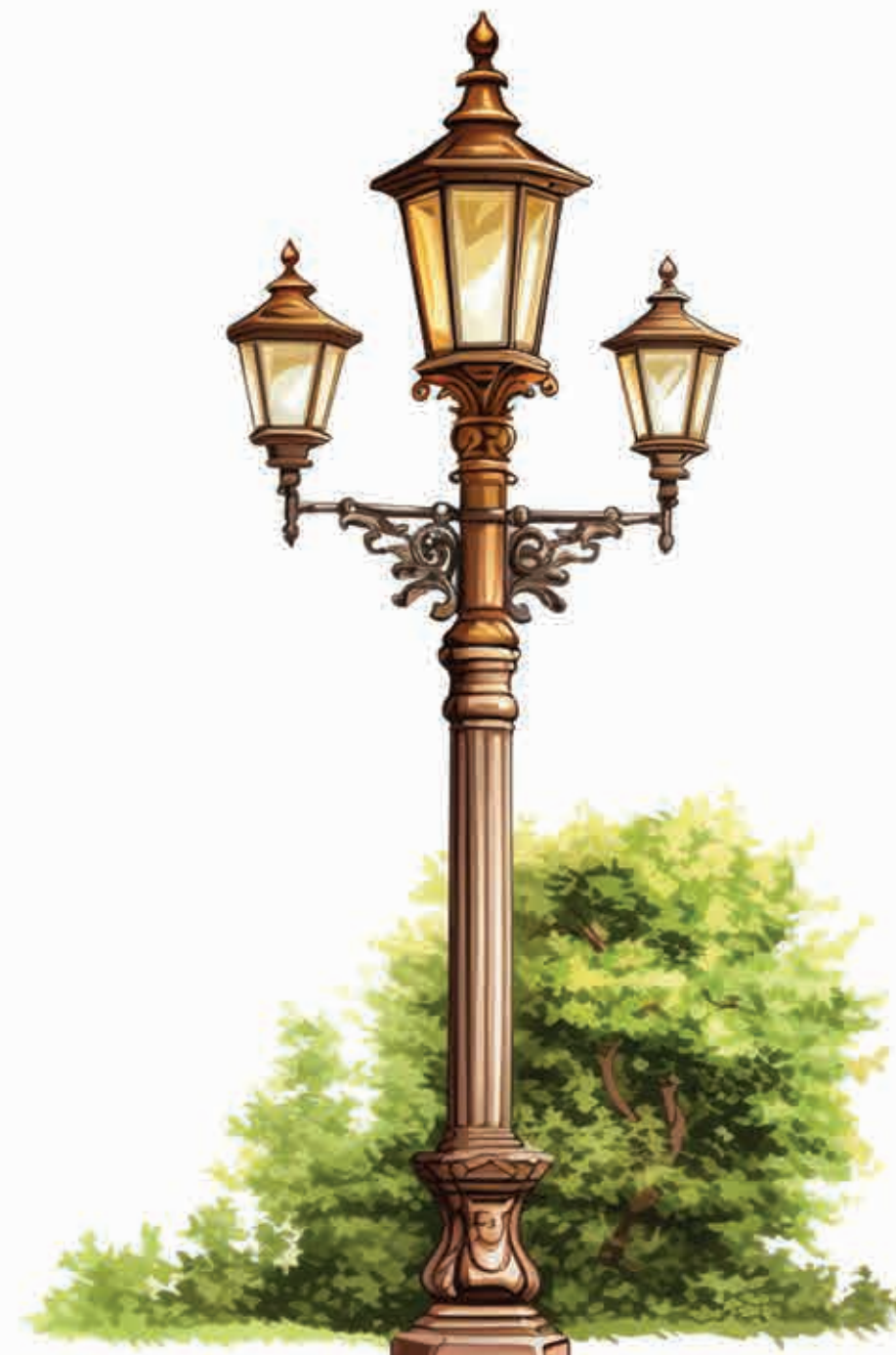



A SENSE OF PEACE AND TRANQUILLITY



Discover the essence of Provident Sunworth City, where cross-shaped towers guarantee abundant sunlight for every home. Peer through your windows onto a thoughtfully designed cityscape adorned with expansive, nature-filled open spaces. Draw back the curtains to reveal panoramic views of 7000 trees and plants, offering a rich tapestry of vibrant flora and fresher air. Across 19 acres of lush greenery, enjoy breezy parks and the serenity of sustainable living, all within Bengaluru's refined ambiance.



MASTER PLAN

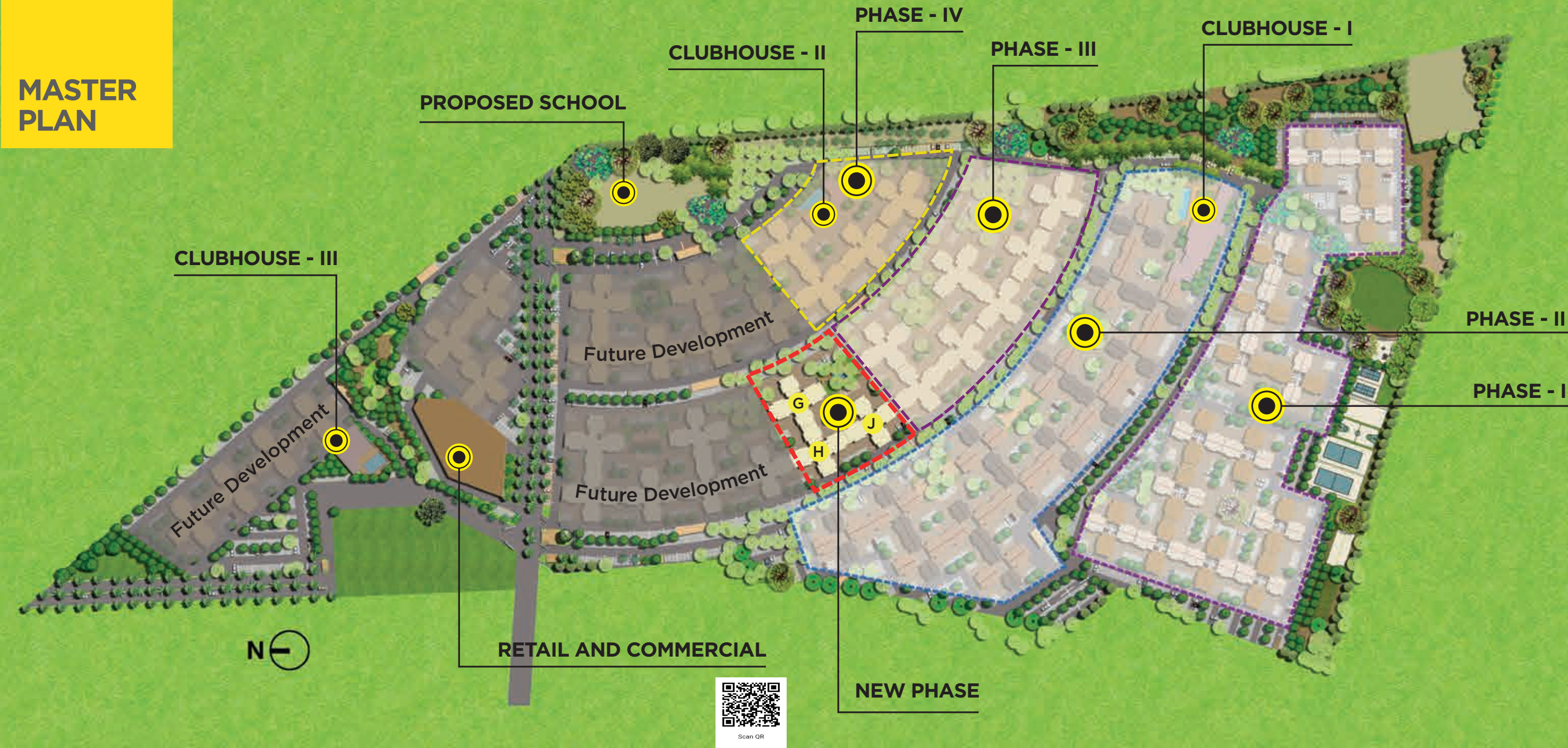

READY AMENITIES

- East Promenade
- Pavilion
- Mini Forest
- Leisure Deck
- South Promenade
- Yoga Pavilion
- Paw Park
- Community Lawn (Mini Hockey)
- Kids' Play Area
- Badminton Court
- Multipurpose Court (Kabaddi/ Volleyball)
- Basketball Court
- Cricket Net
- Outdoor Tennis Court
- Play Lawn
- Jogging Track
- Butterfly Garden
- Skating Rink
- Outdoor Exercise Court
- Swimming Pool
- Table Tennis
- Multipurpose Hall
- Carrom
- Pool Table
- Convenience Store
- Reading Room
- Gymnasium

AMENITIES UNDER FUTURE DEVELOPMENT

- Children's Play Area
- Mini Bridge
- Foot Soak
- Rock Garden
- Pavilion
- Archery (As part of Jogging Track)
- Laughter Court
- Mini Golf
- Party Lawn



TAKE A BREAK OR BREAK A SWEAT



Feel like going for a run before work? We got your back. Feel like taking a dip in the pool after a hard day? Not a problem. Now, whether it's a mind-boggling game of chess with a friend, a game of catch with your pet, or your little one wanting to skate around, there's room for refreshment & recreation of pretty much every kind. With 50+ lifestyle amenities, including 3 well-equipped clubhouses, take your pick from indulging in an activity indoors or taking a stroll in our vast open spaces at Provident Sunworth City.



**THE
CLUBHOUSE**

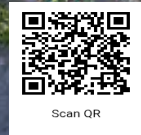

**TENNIS
COURT**



**POOL
TABLE**



**JOGGING
TRACK**



**BADMINTON
COURT**



**MASSAGE
ROOM**



GYMNASIUM



**TABLE
TENNIS**



**CRICKET
PITCH**



**PLAY
LAWN**



**CHILDREN'S
PLAY AREA**



**BASKETBALL
COURT**



**SKATING
RINK**



**CONVENIENCE
STORE**



**MINI
FOREST**



**READING
ROOM**



Scan QR

TOWER PLAN

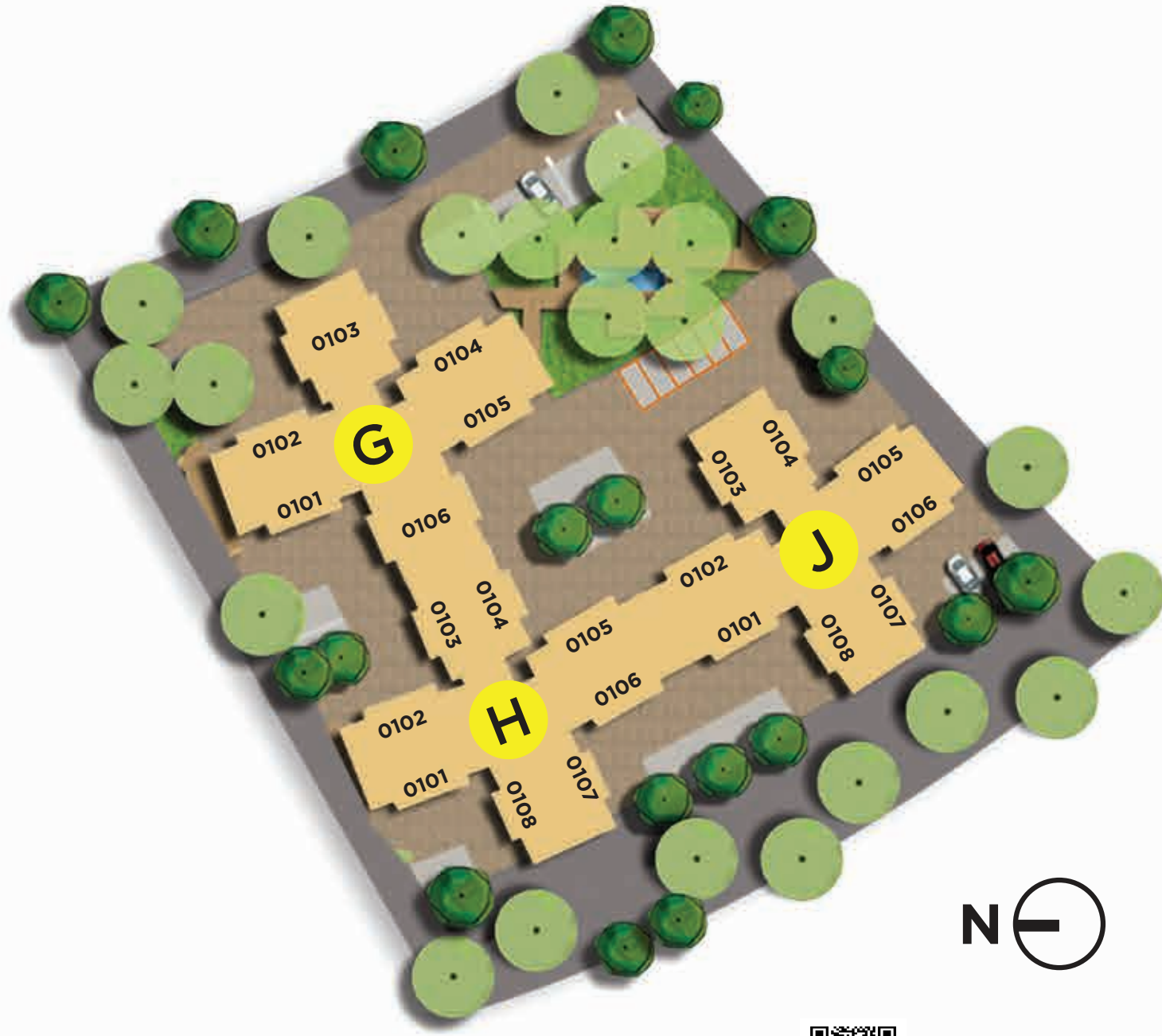

These photographs are indicative only. Floor plans are in accordance with the last approved sanctioned plan and may be subject to change mandated by authorities and/or applicable law. As a measure of transparency, you are informed that the entrance to kitchen has been moved to the opposite wall in order to improve aesthetics, efficiency and privacy for home owners. No change in the carpet / useable area of the apartment.

TYPICAL FLOOR PLAN 1

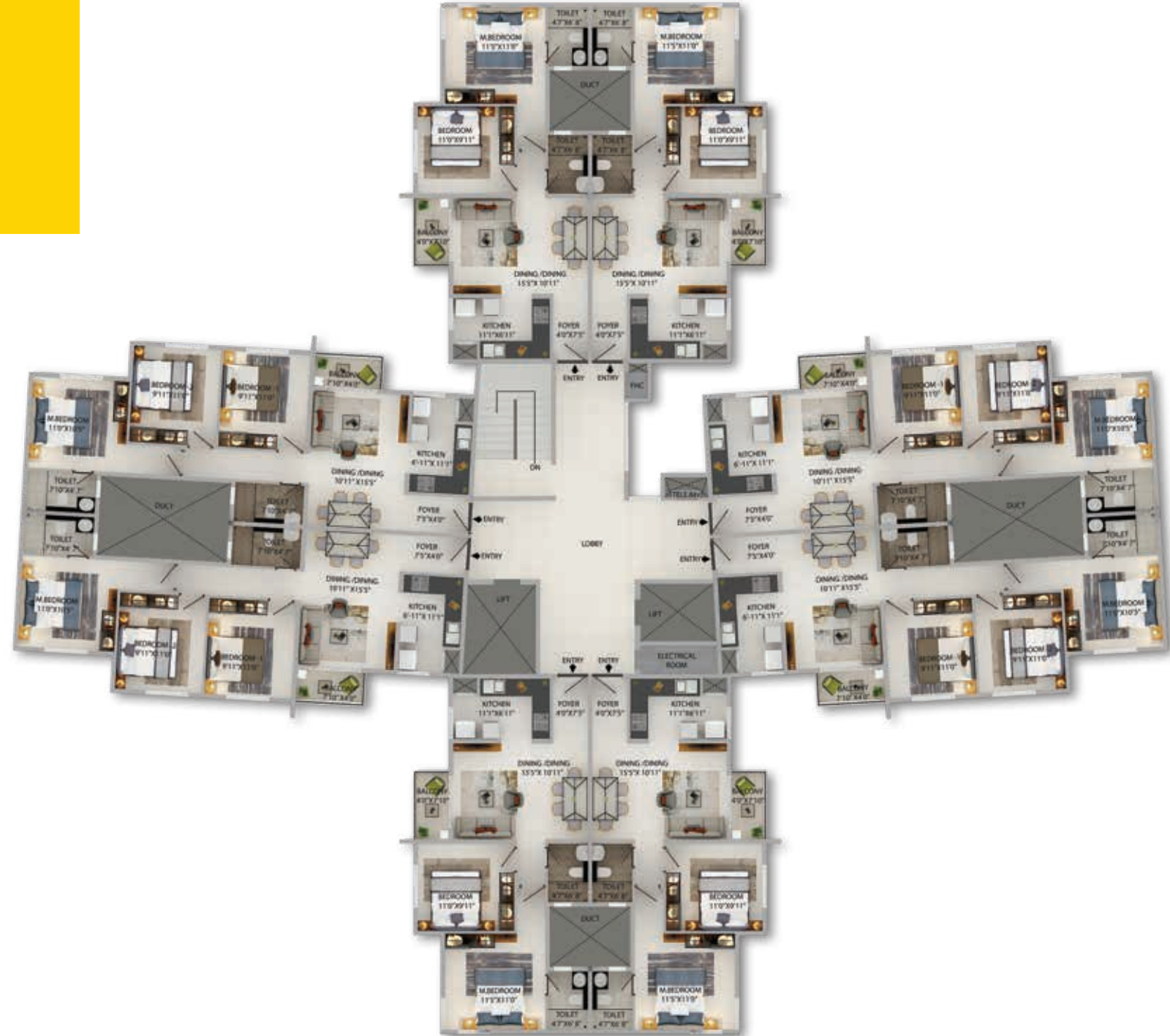

TYPICAL
FLOOR
PLAN 2



Scan QR

TYPICAL
FLOOR
PLAN 3



TYPICAL
UNIT PLAN:
2BHK

| | |
|-----------------------|---------------|
| Typical Carpet Area | ~ 628 sq. ft. |
| Typical Usable Area | ~ 655 sq. ft. |
| Typical Saleable Area | ~ 883 sq. ft. |



The imagery used in the brochure is indicative of style only. The photographs of the interiors, surrounding views and location may have been digitally enhance
These photographs are indicative only. Floor plans are in accordance with the last approved sanctioned plan and may be subject to change mandated by governmental authorities and/or applicable law.

TYPICAL
UNIT PLAN:
3BHK

| | |
|-----------------------|----------------|
| Typical Carpet Area | ~ 779 sq. ft. |
| Typical Usable Area | ~ 805 sq. ft. |
| Typical Saleable Area | ~ 1082 sq. ft. |



The imagery used in the brochure is indicative of style only. The photographs of the interiors, surrounding views and location may have been digitally enhanced or altered and do not represent actual views or surrounding views.
These photographs are indicative only. Floor plans are in accordance with the last approved sanctioned plan and may be subject to change mandated by governmental authorities and/or applicable law.

TYPICAL
UNIT PLAN:
3BHK
ROYALE
(TYPE 1)

| | |
|-----------------------|----------------|
| Typical Carpet Area | ~ 1264 sq. ft. |
| Typical Usable Area | ~ 1327 sq. ft. |
| Typical Saleable Area | ~ 1756 sq. ft. |



Scan QR

The imagery used in the brochure is indicative of style only. The photographs of the interiors, surrounding views and location may have been digitally enhanced or altered. These photographs are indicative only. Floor plans are in accordance with the last approved sanctioned plan and may be subject to change mandated by governmental authorities and/or applicable law.

TYPICAL
UNIT PLAN:
3BHK
ROYALE
(TYPE 2)

| | |
|-----------------------|----------------|
| Typical Carpet Area | ~ 1287 sq. ft. |
| Typical Usable Area | ~ 1351 sq. ft. |
| Typical Saleable Area | ~ 1779 sq. ft. |



The imagery used in the brochure is indicative of style only. The photographs of the interiors, surrounding views and location may have been digitally enhanced or altered and do not represent actual views or surrounding views. These photographs are indicative only. Floor plans are in accordance with the last approved sanctioned plan and may be subject to change mandated by governmental authorities and/or applicable law.

TYPICAL
UNIT PLAN:
3BHK
ROYALE
(TYPE 3)

| | |
|-----------------------|----------------|
| Typical Carpet Area | ~ 1264 sq. ft. |
| Typical Usable Area | ~ 1327 sq. ft. |
| Typical Saleable Area | ~ 1756 sq. ft. |



Scan QR

represent actual views or surrounding views. These
able law.

TYPICAL
UNIT PLAN:
3BHK
ROYALE
(TYPE 4)

| | |
|-----------------------|----------------|
| Typical Carpet Area | ~ 1287 sq. ft. |
| Typical Usable Area | ~ 1351 sq. ft. |
| Typical Saleable Area | ~ 1779 sq. ft. |



The imagery used in the brochure is indicative of style only. The photographs of the interiors, surrounding views and location may have been digitally enhanced or altered and do not represent actual views or surrounding views. These
photographs are indicative only. Floor plans are in accordance with the last approved sanctioned plan and may be subject to change mandated by governmental authorities and/or applicable law.



ADDING FEATHERS TO OUR CAP, YEAR ON YEAR



Scan QR



**PAUL WRITER REAL ESTATE
MARKETING CONCLAVE AND AWARDS:**
Outstanding Outdoor – Out of Home
advertising that cuts through the clutter –
Provident – Sunworth for 'I made life
changing decision' campaign



EMERGING DEVELOPER OF THE YEAR -
Residential Provident Housing Ltd.
for Sunworth at the 6th REALTY PLUS
EXCELLENCE AWARDS

SKOCH ORDER-OF -MERIT AWARD
received for Business process
improvement, Quality Improvement &
Technology Deployment, for qualifying in
India's Best projects for the presentation
done on Provident Sunworth



7TH REALTY PLUS EXCELLENCE AWARDS
for Affordable Housing Project of the Year -
Provident Sunworth

**8TH FRANCHISE INDIA ET NOW ESTATE
AWARDS** for Affordable Housing Project of
the Year - Provident Sunworth

PARRYWARE NDTV PROPERTY AWARDS
for Budget Apartment of the Year - Tier 1 -
Provident Sunworth



ACCE(I)-SARVAMANGALA AWARD 2016
for Excellence in Construction in the Field
of Civil Engineering - Provident Sunworth

**5TH ANNUAL 'SILICON INDIA BENGALURU
REAL ESTATE AWARDS' 2016** for the
'Best Affordable Apartment Project Of The
Year' – South Bengaluru' - Provident
Sunworth

**INDIAN CONCRETE INSTITUTE BIRLA
SUPER AWARD - 2016** - Outstanding
Concrete Structure of Karnataka (Building



**9TH REALTY PLUS EXCELLENCE
AWARDS (SOUTH) 2017** - Excellence in
delivery - Provident Sunworth



**BAM (BUILDERS, ARCHITECTS &
BUILDING MATERIAL) AWARDS 2018** for
Best Affordable Housing Project –
Provident Sunworth



**CIA WORLD CONSTRUCTION & INFRA
AWARDS 2019** for the Best Township
Project - Provident Sunworth

**GLOBAL REAL ESTATE & BUSINESS
EXCELLENCE AWARDS 2019** – Dubai -
for Best Affordable Housing Project of
the Year – Provident Sunworth



**THE ECONOMIC TIMES REAL ESTATE
AWARDS 2022** - SOUTH - Best Residential
Project - Mid Segment (Ongoing: Metro) –
Provident Sundek

**GREEN APARTMENTS BY KARNATAKA
STATE POLLUTION CONTROL BOARD** for
its contribution towards Sustainable
development

MID-SEGMENT PROJECT OF THE YEAR
at Realty+ Excellence Awards 2022,
SOUTH



THE CITY OF MORE

