



INNOVATIVE DRILLING SOLUTIONS

Webpage :- www.innovativedrillingsolutions.in



ABOUT US

Over the years, our company has experienced steady growth by delivering high-quality, durable, and innovative mining tools that meet the evolving needs of the mining industry. Our commitment to excellence and customer satisfaction has helped us build a strong reputation in both domestic and international markets. Looking ahead, we aim to expand our global footprint by entering new mining regions and forming strategic partnerships. We are also focused on developing next-generation tools that incorporate automation, digital monitoring, and sustainable technologies to enhance efficiency, safety, and environmental responsibility. By continuously investing in research, workforce development, and customer support, we are committed to driving long-term value for our clients and contributing to the future of responsible mining.

GOALS

4 Build long term
relation with client

3 Invest in
innovation and
new technology

5 Empower our
workforce to develop

2 Operational excellence

6 Expand Global Reach
in Mining Markets

1 Deliver high precision result
in demanding conditions

7 Enhance Customer Support
and After-Sales Services

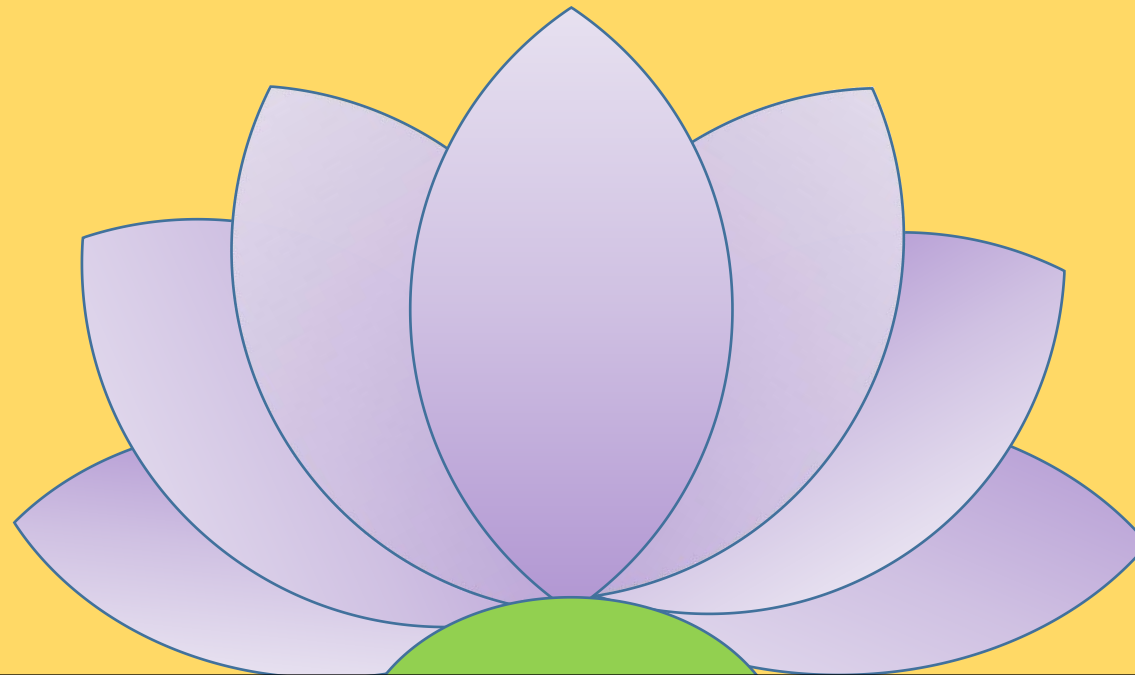

SHANK ADAPTERS





A Shank Adapter, also known as a Striking Bar, is a crucial component in rock drilling tools that connects the drill string to the rock drill or drilling machine. It transmits impact energy and rotational force from the rock drill to the drill rods and bits.

- Connects rock drill to drill rods or drill string.
- Transmits impact and rotational energy efficiently.
- Made from high-strength, wear-resistant alloy steel.
- Available in different thread types like T38, T45, T51.
- Used in mining, tunneling, quarrying, and construction drilling.



WE ALSO PROVIDE DIFFERENT SPECIFICATION OF PRODUCTS LIKE

R25
R28
R32
R35
R38
T38
T45
T51
ST68
GT60

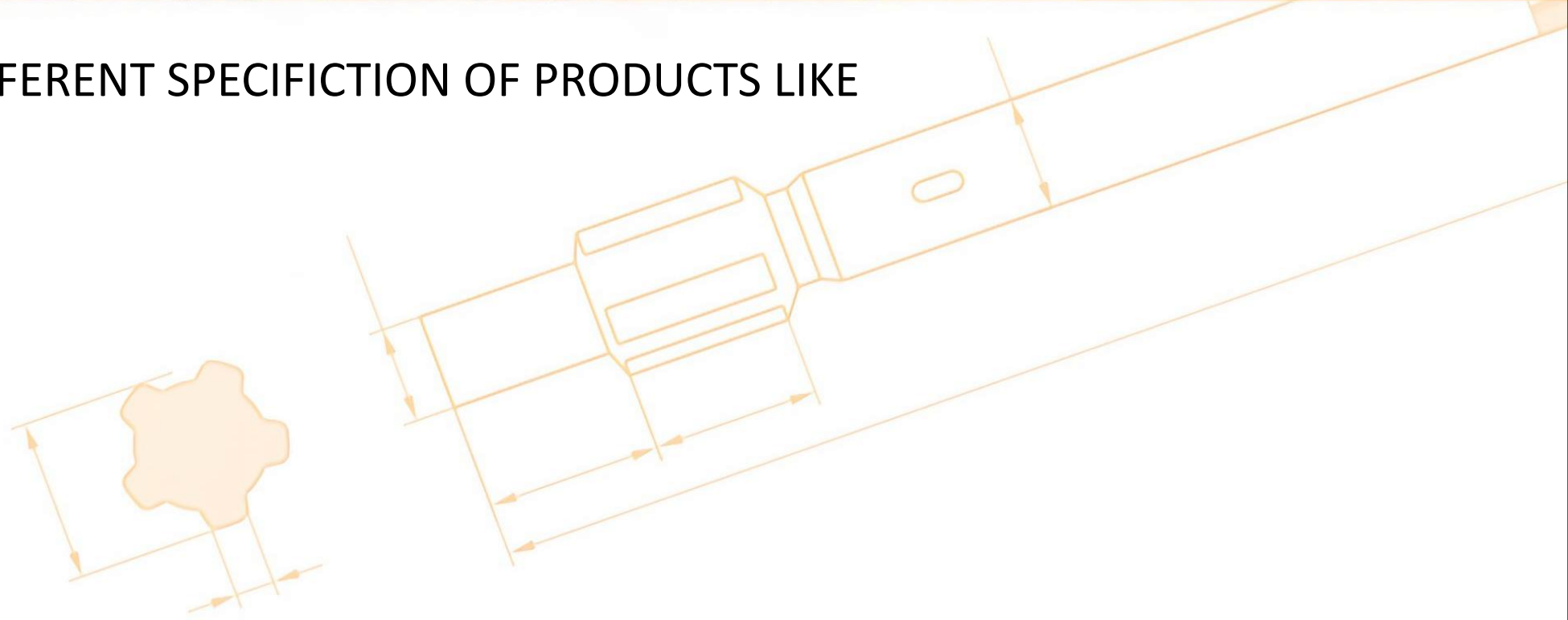



R25



Shank rod



R32

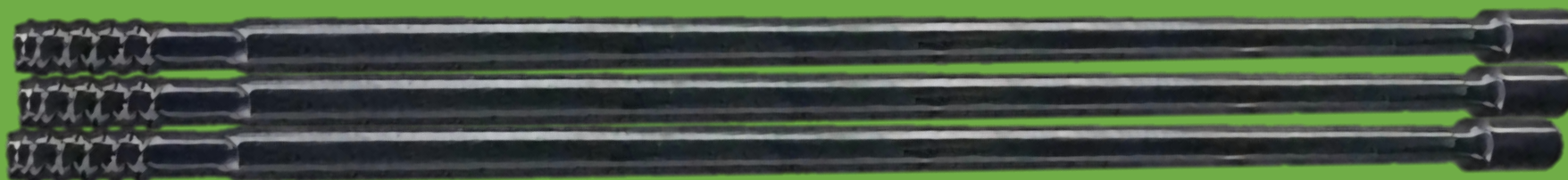

MF ROD



R25

They are available in the threads R25 bit diameter ranging from 33 mm to 51 mm. Furthermore, we use extremely durable steel in all our drilling rods and bits, meaning they have a high wear resistance and unrivalled anti-corrosion abilities, resulting in a longer service life!

SHANK ROD

The R28 shank refers to a specific thread type used in top hammer drilling for rock drilling tools. It's a common thread size used in drifting, tunneling, and bench drilling applications. R28 shank adapters are designed to withstand the high impact power of modern rock drills.

R32

An R32 shank adapter is a component used in rock drilling, specifically designed to connect drill rods hammers. It's a crucial part for ensuring a secure and efficient connection, especially in applications like drifting, tunneling, and extension drilling where high bending stresses are common

MF ROD

The "shank R35" likely refers to a shank adapter used in rock drilling equipment. These adapters, often found in mining and construction, connect the drill machine to the drill string, transmitting rotational torque, feed force, and flushing medium. They are designed to withstand the high impact and stress of drilling operations.

T51



GT60



R38



T38



T45



T51

A T51 shank adapter is a crucial component in top hammer drilling, connecting the rock drill to the drill string and drill bit. It transmits impact energy and rotation torque from the drill to the drill bit. The T51 designation indicates the adapter's size and compatibility with T51 drill steel.

GT 60

A GT60 shank is a component used in top hammer drilling systems, specifically designed to connect the rock drill to the drill string (rods and bits). It's a crucial part for transferring impact energy and rotation torque from the drill to the drill string, ensuring efficient and reliable drilling.

R38

The "R38" in "R38 shank info" refers to a specific type of shank adapter used in rock drilling equipment, particularly in mining and construction. These adapters are crucial for connecting drill rods to rock drills, ensuring efficient energy transfer and reliable drilling performance.

T38

A T38 shank is a specific type of shank used in rock drilling, characterized by its six-sided (hexagonal) shape. It acts as a crucial interface, connecting the rock drill to the drill string and transmitting power and rotation to the drill bit.

This connection is vital for efficient rock penetration in various drilling applications like mining and tunneling.

T45

A T45 shank adapter is a critical component in rock drilling systems, connecting drill rods to the drilling equipment and transmitting rotational torque, feed force, impact energy, and flushing medium. It ensures proper alignment, stability, and efficient energy transfer during drilling operations. These adapters are designed to withstand the high stresses and impacts of drilling, contributing to the overall durability and longevity of the drilling equipment.

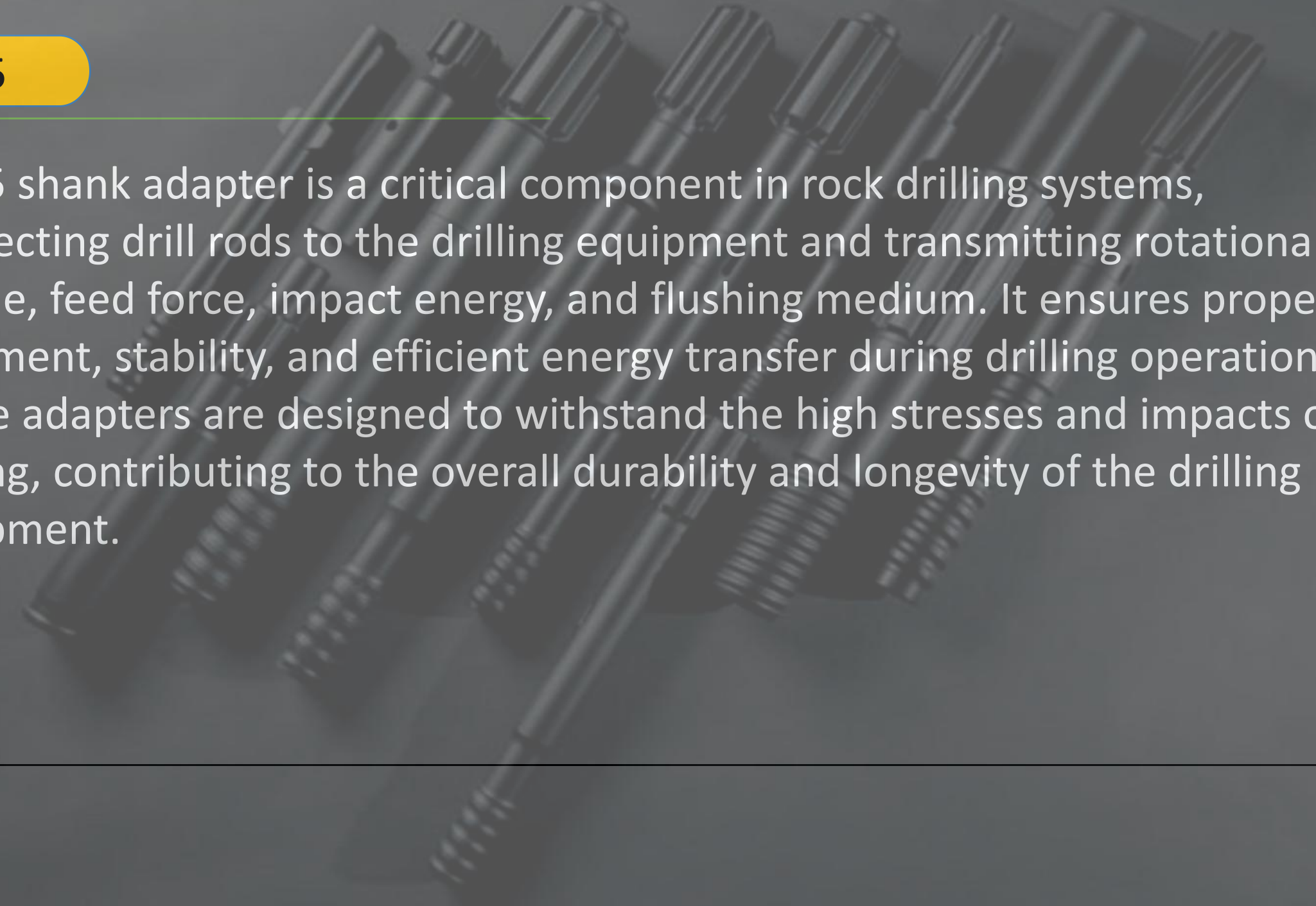

TOP HAMMERS DRILLING TOOLS





Top hammer drilling is a method where the hammer mechanism is located at the top of the drill string, outside the hole being drilled. This contrasts with down-the-hole (DTH) drilling, where the hammer is positioned at the bit inside the hole. Top hammer drilling excels in various applications, particularly in hard rock formations, offering high penetration rates, accuracy, and suitability for smaller diameter holes.

- Top hammer drills utilize a piston that strikes the drill steel at high frequency, generating the impact force to break rock.
- Common applications include drilling blast holes, anchor holes, and exploration drilling.
- Top hammer drilling is well-suited for smaller diameter holes.

WE ALSO PROVIDE DIFFERENT SPECIFICATION OF PRODUCTS LIKE

- **T38 -50**
- **R25 -DIA33,25,38,41,45MM RANGE AVAILABLE IN STRAIGHT AND RETRACT BIT**
- **R32 -DIA 41,45,48,51,57,64,76,89MM RANGE AVAILABLE IN STRAIGHT AND RETRACT BIT**
- **T38/R38- DIA 76,89,102,115,127MM RANGE AVAILABLE IN STRAIGHT AND RETRACT BIT**
- **T45 - DIA 89,102,115,127MM RANG AVAILABLE IN STRAIGHT AND RETRACT BIT**
- **T51- DIA 89,102,115,127MM RANGE AVAILABLE IN STRAIGHT AND RETRACT**
- **T51 - DIA 89,102,115,127MM RANG AVAILABLE IN STRAIGHT AND RETRACT BIT**



R38/T38 -76MM



T51 -102MM



T51 -102MM



R32 -45MM

R38/T38 -76MM

The T38/R38 - 76mm Top Hammer Drilling System is widely used in mining, tunneling, and civil engineering for narrow-hole applications like rock bolting and ground support. Featuring a robust T38/R38 thread, it ensures high torque transfer and reliability in medium to hard rock. The 76mm bit diameter is ideal for precision drilling, offering a high penetration rate and durability with tungsten carbide button bits. The system includes drill bits, T38/R38 rods, couplings, and shank adapters, all designed for efficiency and compatibility with hydraulic top hammer rigs. Its strong thread design and performance make it a cost-effective choice for demanding drilling conditions.

T51 -102

The T51 - 102mm Top Hammer system is built for heavy-duty drilling in surface and underground mining, quarrying, and large-scale construction. With a T51 thread, it offers high strength and torque transfer, suitable for tough rock conditions. The 102mm (4-inch) bit diameter is ideal for production drilling and benching, ensuring deep penetration and stability. This system includes durable carbide button bits, high-tensile T51 drill rods, couplings, and shank adapters, all optimized for top hammer hydraulic drills. Known for its reliability, long service life, and ability to handle high-impact energy, T51-102mm systems are a top choice for high-performance drilling in hard formations.

T51 -102

The T51 - 103mm Top Hammer system is designed for demanding drilling in mining, quarrying, and construction projects. It uses a strong T51 thread, known for high torque transfer and resistance to breakage, ideal for hard and abrasive rock conditions. With a 103mm (4.05-inch) bit diameter, it delivers excellent penetration rates and stability for production drilling, benching, and pre-split applications. The system consists of carbide button bits, high-strength T51 drill rods, couplings, and shank adapters, all compatible with powerful hydraulic top hammer rigs. Its robust design ensures efficiency, durability, and reliable performance in tough drilling environments.

R32 -45MM

The T51 - 102mm Top Hammer system is built for heavy-duty drilling in surface and underground mining, quarrying, and large-scale construction. With a T51 thread, it offers high strength and torque transfer, suitable for tough rock conditions. The 102mm (4-inch) bit diameter is ideal for production drilling and benching, ensuring deep penetration and stability. This system includes durable carbide button bits, high-tensile T51 drill rods, couplings, and shank adapters, all optimized for top hammer hydraulic drills. Known for its reliability, long service life, and ability to handle high-impact energy, T51-102mm systems are a top choice for high-performance drilling in hard formations.



T38 -76MM



R32 -127MM



T51 -90MM

T38 -76MM

The T38 - 77mm Top Hammer system is a popular choice for medium-duty rock drilling in mining, tunneling, and construction. It features a reliable T38 thread, providing strong torque transfer and durability, especially in hard and abrasive rock conditions. The 77mm (3-inch) bit diameter offers excellent performance for bench drilling, rock bolting, and underground applications where hole precision and penetration rate are key. The system includes tungsten carbide button bits, high-strength T38 drill rods, couplings, and shank adapters, all optimized for use with hydraulic top hammer drills.

T51 -102MM

The T51 - 102mm Top Hammer system is designed for high-performance drilling in surface mining, quarrying, tunneling, and construction. It uses a robust T51 thread, ensuring excellent torque transfer and resistance to breakage in tough rock conditions. With a 102mm (4-inch) bit diameter, it delivers efficient penetration and stable hole quality for production drilling, benching, and pre-split applications. The system includes tungsten carbide button bits, high-strength T51 drill rods, couplings, and shank adapters, all compatible with powerful hydraulic top hammer rigs.

R32 -127MM

The R32 - 127mm Top Hammer system is designed for medium-duty drilling in mining, tunneling, and construction applications. Featuring the R32 thread, known for good torque transfer and easy coupling, this system is typically used for smaller hole diameters. However, a 127mm (5-inch) bit is considered large for an R32 system, and is not standard for typical R32 setups, which generally range between 45mm to 76mm in bit diameter.





COUPLING SLEEVES DRILLING TOOLS



A Coupling Adapter is a vital component used in mining drills to connect drill rods, shank adapters, and bits, ensuring smooth energy transfer during drilling. Made from high-strength alloy steel, it provides excellent torque resistance and durability. Coupling adapters allow easy tool changes and help extend the drill string for deep rock drilling in mining, tunneling, and construction applications.

- Connects drill rods, bits, and shank adapters for continuous drilling operations.
- Made from high-strength alloy steel to withstand high impact and torque.
- Ensures accurate energy transfer from the drill rig to the drilling tool.
- Allows quick and easy tool changes during drilling processes.
- Widely used in mining, tunneling, and construction for rock drilling applications.

WE ALSO PROVIDE DIFFERENT SPECIFICATION OF PRODUCTS LIKE

- R32-R25
- R32-R32
- R25-R25
- R22-R22
- R38-R38
- R38-R32
- T38-T38
- T38-R38
- T45-R38
- T38-R32



INFO

Coupling adapters are essential connectors in rock drilling that join drill rods, shank adapters, and other drilling tools, ensuring smooth energy transfer and extending the drill string. They come in various types like R25-R25, R32-R32, and R32-R25, designed to connect same or different thread sizes for maximum compatibility. These adapters are widely used in mining, tunneling, quarrying, and construction, providing strong connections, reducing downtime, and allowing flexible tool combinations for efficient and reliable drilling operations.

COUPLING ADAPTORS DRILLING TOOLS



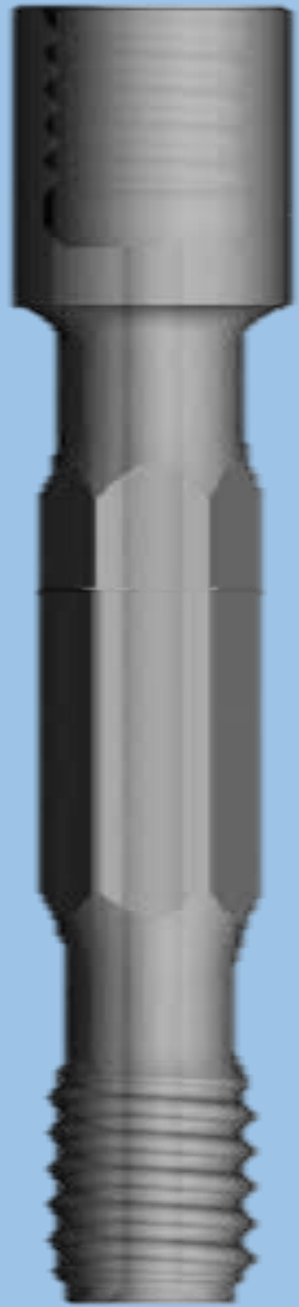

Coupling Sleeves are essential drilling accessories used to join two drill rods or extensions together, ensuring a secure and aligned connection during rock drilling operations. They allow the drill string to be extended to the desired depth while maintaining structural integrity.

- Connects two drill rods or extensions securely.
- Made from wear-resistant, high-strength alloy steel.
- Ensures accurate alignment and smooth torque transmission.
- Available in different thread types like R25, R32, R38, T38, T5, T51, etc.
- Used in rock drilling for mining, tunneling, and construction.



WE ALSO PROVIDE DIFFERENT SPECIFICATION OF PRODUCTS LIKE

- R32M -R22F ..
- R25M -R22F..
- R38M -R32F..
- R32M -R25F..
- R25M -R32F..
- R22M -R32F..
- R32M -T38F..
- BIT ADAPTER R32
- R25M -R32F
- HEX 22 R32F
- HEX 22 R25F
- T38M -R32F



R32M -R22F



R25M -R22F



R38M -R32F



R32M -R25F



HEX 22 R25F



HEX 22 R32F



R22M -R32F



R32M -T38F



BIT ADAPTOR R32



R25M -R32F



T38M -R32F

INFO

- R25 Coupling Sleeve
- Connects two R25 threaded drill rods; ideal for light to medium rock drilling.
- R32 Coupling Sleeve
- Joins two R32 threaded rods; used for medium to heavy drilling applications.
- R38 Coupling Sleeve
- Connects R38 threaded rods; offers high strength for deep and tough drilling.
- T38 Coupling Sleeve
- Links T38 threaded rods; designed for high-impact, top hammer rock drilling.
- T45 Coupling Sleeve
- Connects T45 rods; used for deep hole drilling in hard rock conditions.
- T51 Coupling Sleeve
- Joins T51 threaded rods; heavy-duty, suitable for large-scale mining and tunneling.
- Crossover Coupling Sleeves (e.g., R32-R25)
- Connects rods with different thread sizes, allowing flexible tool combinations.

THANK YOU FOR CHOOSING INNOVATIVE DRILLING SOLUTIONS

PROPRIETOR :- VIKAS KALLAPA KORE



ADD:- S-234/20, NEAR POONA FORGE, MIDC, BHOSARI PUNE - 411026

MOB :- +91 9059882454

EMAIL :- innovativedrillingsolutions@gmail.com

MFG. OF COUPLING SLEEVES, SHANK ADAPTER & THREADED BUTTON BITS