

ROLL GROOVE MACHINE OPERATION MANUAL FOR MODEL: RG-5S



WARNING:

Read this Operator's Manual carefully before using this tool. Failure to understand and follow the contents of this manual may result in electrical shock, fire and/or serious personal injury.



GENERAL SAFETY REQUIREMENTS

Work Area Safety

- Keep work zone **clean and lighted**. Cluttered or dark areas may bring accidents.
- **Do not operate groover in explosive atmospheres**, such as in the presence of flammable liquids, gases, or dust. Groover creates sparks which may ignite the dust or fumes.
- **Keep children and irrelevant person away** while operating a roll groover.
- Keep floors dry and **free of slippery materials** such as oil.

Personal Safety

- **Stay alert** while operating a groover. Do not use a groover while fatigued or under the influence of drugs, alcohol, or medication. Inattention when using groover may result in serious personal injury.
- Use **personal protective equipment**. Always wear eyeglasses.
- **Remove any adjusting rulers or wrench before using groover**. Tools left attached to a rotating part of the groover may result in personal injury.
- **Dress properly**. Do not wear loose clothing or jewelry. Keep hair, clothing, and gloves away from moving parts.

Electrical Safety

- **Power tool plugs must match the outlet. Never modify the plug in any way**. Do not use any adapter plugs with grounded (earthed) power tools. Unmodified plugs and matching outlets will reduce risk of electric shock.
- **Avoid body contact with grounded or earthed surfaces, such as pipes or radiators**. There is an increased risk of electric shock if personal body is grounded.
- **Do not expose power tools to rain or wet conditions**. Water entering a power tool will cause electric shock.
- **Do not abuse the cord**. Never use the cord for carrying, pulling or unplugging the power tool. **Keep cord away from heat, oil, sharp edges or moving parts**. Damage or entangled cords increase the risk of electric shock.
- **When operating a power tool outdoors, use an extension cord suitable for outdoor use**.
- **If operating a power tool in a damp location, use a Ground Fault Circuit Interrupter (GFCI) protected supply**.

Power Tool Use and Care

- **Always use the correct power tool for each application**. The correct power tool will do the job right and safer at the rate for which it was designed.
- **Do not use the power tool if the switch does not turn it ON and OFF**. Any power tool that cannot be controlled with the switch is dangerous and must be repaired.
- **Disconnect the plug from the power source before making any adjustments, changing accessories or storing power tools**.
- **Store idle tools away from children** and do not allow persons unfamiliar with the tool or these instructions to use the groover. Roll groover is dangerous in the hands of untrained users.
- **Maintain tools**. Check for misalignment or binding of moving parts, breakage of parts and any other condition that may affect the tool's operation. If damaged, have the tool repaired before use.
- Use only accessories that are recommended for RG-5S Electronic Hydraulic Roll Groover.
- **Keep handles dry and clean**; free from oil and grease.

Service

- Have the roll groover serviced only by a qualified repair person using identical replacement parts.

Foot Switch Safety

Using the electric roll groover without a foot switch increases the risk of serious injury. A foot switch provides better control by letting the operating personnel shut off the motor by simply removing foot. If clothing should become caught in the machine, it will continue to rolling in and pulling personnel into the machine. Because the roll groover has high torque, the clothing itself can bind around arm or other body parts with enough force to crush or break bones.

Roll Groover Safety

- **Keep hands away from grooving rolls.** Do not wear loose fitting gloves.
- **Keep hands away from ends of pipe.** Burrs and sharp edges may catch and cut.
- **Properly support the pipe** to prevent the tipping of the pipe and equipment.
- **Set-up the groover on a flat, level surface.** Be sure the machine, stand and groover are stable.
- **Always wear appropriate personal protective equipment** such as protection glasses, tight fitting leather gloves, steel toed footwear, and a hardhat.
- **Do not wear loose clothing. Keep sleeves and jackets buttoned. Do not reach across the machine or pipe.** Clothing can be caught by the pipe resulting in entanglement and serious injury.
- **Do not use this groover without a foot switch.** Foot switch is a safety device to prevent serious injury.
- **Only use roll groover to groove pipe of recommended sizes and types according to this instruction.** Improper use or modification of the roll groover for other applications may increase the risk of injury.



DESCRIPTION, SPECIFICATIONS & STANDARD EQUIPMENT DESCRIPTION

RG-5S Universal Electric Groover is a motor driven roll groover designed with an advanced hydraulic feeding system. It can form roll grooves in carbon steel and stainless steel pipe of 1" thru 8" diameter SCH10/40 and 10" thru 12" SCH10/20 pipes. The grooves are formed by mechanically advancing a grooving roller into the pipe which is supported by a knurl drive roller. The only adjustment necessary is for the depth of the groove. Unique integrated drive roller with draft shaft reduces the chance of drive shaft break.

The RG-5S Electric Hydraulic Roll Groover is an ideal tool for light and medium volume work on job site and for workshop in-house fabrication on all 1"~12"pipes.



Specifications

Capacity	1" – 8" Schedule 10/40 CS/SS pipe with roll change
	10" – 12" Schedule 10/20 CS/SS pipe with roll change (See Chart A for groove specification)
Max. allowance of pipe thickness.....	8mm / 5/16inch
Max. hydraulic pressure of cylinder.....	35Mpa / 350 bars / 5000psi
Max. extrusion force.....	6,000kgs / 13,200lbs
Capacity of hydraulic oil reservoir	110mL / 3 3/4 fl.oz.
Grooving speed (w/ 1400rpm gear motor)	23 r.p.m.
Groove Diameter Lock device	Stop knob
Operation Methods.....	Single phase motor 1100W ,240V / 50/60Hz
Actuation.....	Hydraulic Hand Pump
Weight	approx.135kgs/ 298 lbs.
Packing size L×W×H	1430mm×680mm×1330mm
Groove specification.....	AWWA C606-87

GROOVING PROCESS

Work Area & Machine Set-up

1. Make sure the work area follows:
 - Adequate lighting
 - No flammable liquids, vapors or dust that may ignite.
 - Grounded electrical outlet
 - Clear path to the electrical outlet without any oil, sharp edges or moving parts which may damage the electric cord.

- Dry place for machine and operator. Do not use the machine when standing in water.
 - Level ground
 - Cleanup the work area prior to setup any equipment.
2. One person can easily lift the roll groover and press down the red buckle to fix. To restore or moving the machine, lift the red buckle and press the machine support down. Refer to Fig.2.

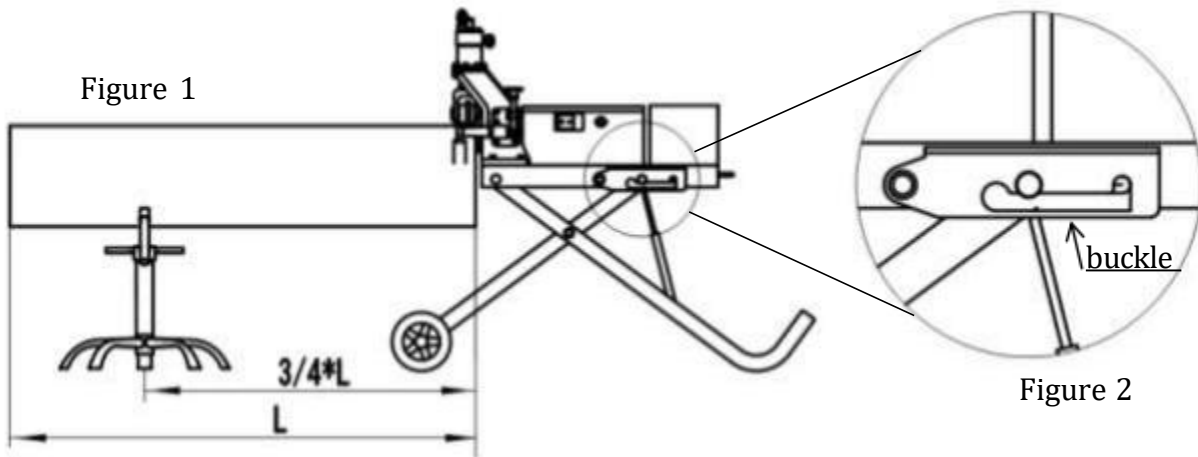

3. Turn the upper portion of the leg until the foot makes full contact with ground. Adjust all four legs until the machine is level. Secure set screws to fix legs.
4. Install pump handle with pin attached.
5. Make sure the power switch is in the OFF position.
6. Place the foot switch so that the operator can safely control the roll groover and workpiece. It should allow the operator to do the following:
- Stand facing the hydraulic pump.
 - Control the foot switch with left foot.
 - Have convenient access to the groover and hydraulic pump without reaching across the machine.
7. Plug the machine into the power socket and make sure cord is in good & safe condition.
8. Inspect the roll groover as following steps:
- Turn the power switch in ON position.
 - Press and release the foot switch. Check that the groove roller rotates in a counterclockwise direction as the operator faces the groover.
 - Depress the foot switch and hold. Inspect all moving parts for misalignment, binding, odd noise or any other unusual conditions.
 - Release foot switch and turn the power switch in OFF position.
 - If any founding that may affect the safe and normal operation of the machine, have the roll groover repaired before use.

Pipe Preparation

These are generalized instruction only. Always follow grooved coupling manufacturer's specific recommendations for pipe end preparation. Failure to follow the grooved coupling manufacturer's recommendations may lead to an improper connection and cause leaks.

1. Cut pipe to proper length. Make sure pipe end is cut square and free of burrs. Cut off method and large burrs can affect the quality of the groove made and the tracking of the groove. Do not attempt to groove pipe that has been cut with a torch.
2. All internal/external weld bead, flash, or seams must be ground flush at least 2" back from the end of the pipe. Do not cut flats into gasket seat area, this could cause leaks.
3. Remove all scale, dirt, rust and other contaminants **at least 2"/50mm back** from the end of the pipe. Contaminants can clog the drive knurls and prevent proper driving and tracking of the pipe while grooving.

4. Make sure that the pipes to be grooved have appropriate support. When using one pipe stand, make sure the stand supports the pipe at the place where 3/4 of the total length from the grooved end. **Refer to Figure 1.**
5. Pipes equal or **over 108"/3.0meter** should be supported with **at least two pipe stands**. Locate each stand at the 1/3 point of the pipe. Failure to properly support the pipe may allow the pipe or the pipe and machine to tip and fall.
6. Square pipe and pipe support to roll groover making sure pipe is flush against drive roller plate.
7. Verify that the pipe is level or sloped slightly downward away from the operator (pipe stand slightly lower than the groove machine about 1°-2°).
8. Turn the power switch to ON position, depress the foot switch and hold. Observe the pipe rotation. If the pipe turns spiral and tends to "walk off" the drive roller, check setup and level status of the pipe. If correct, slightly offset the pipe and pipe stands approximately 1°-2° degree (about 2" over at 10 feet/ 50mm over at 3.0meters from the roll groover) away from the operator. Recheck the rotation until pipe turns stable

Start A Test Grooving

A test grooving should be always performed when setting up or changing pipe sizes.

1. Turn the pump release valve clockwise, in "SHUT" direction, till full close. Press down the pump lever to push down the groove roller in contact with the pipe top surface.
2. Turn down the stop knob clockwise until it contacts the oil cylinder top surface. The pipe and roll groover should be secure to each other at this stage. Refer to Figure 3.
3. Depend on required groove depth (refer to Chart A "Groove Parameters"), turn up the stop knob counter-clockwise. Each full circle is approximately 1/16" (2mm).
4. Turn the gear of the pipe stabilizer clockwise until the stabilizer stay in touch with pipe body.
5. Start the roll groover by step on the foot switch while pressing down the pump lever. Allow one full pipe rotation between half strokes of the pump lever.
6. When the stop knob contacts the cylinder top surface, allow two more full pipe rotation.
7. Stop the roll groover by releasing foot switch. Loose the pump knob counter-clockwise and perform groove inspection. Use groove tape to check groove diameter.
8. If the groove is too large, the groover can be adjusted and the groove will be made smaller by turning stop knob counter-clockwise slightly. Repeat steps 4 -6. If the groove is too small, turn the stop knob clockwise slightly. Another groove will need to be made. Proper groove diameter is important to insure connection performance. Out of specification grooves could cause joint failure.

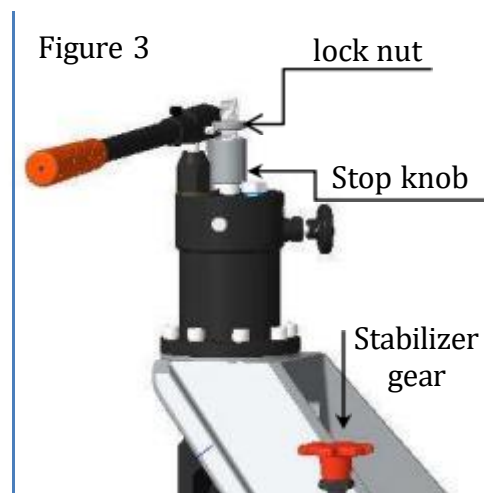

Roll grooving with RG-5S

1. After the test grooving is made and the groove meets requirement, turn down the lock nut and fix the stop knob in proper groove depth. The roll groover is ready to operate on pipes in the same size.
2. Repeat "Pipe Preparation" section and steps 4-7 in "Start a test groove" for more grooving.
3. **Implement at least one groove diameter inspection after every 5 grooves are formed.**

Changing Roller Sets

1. Open the release valve on hydraulic pump counter-clockwise and raise the groove roller to the top position. Refer to Figure 4.
 2. Remove Groove Roller
Loose the setscrew on the side block with a 3/16" (5mm) hex wrench. Grasp the groove roller steady and draw out the groove shaft from the side block. Refer to Figure 4.
 3. Remove Drive Roller
Loose the flush bolt in the center of drive shaft with a 5/16"(10mm) hex wrench. Grasp the knurl drive roller and draw the drive shaft out. Refer to Figure 5.
 4. Reverse step 2 & 3, install suitable groove roller and drive roller shaft as demanded.
- ★ **All rollers may use flat bearing. Do not drop the bearings and covers.**

Figure 4

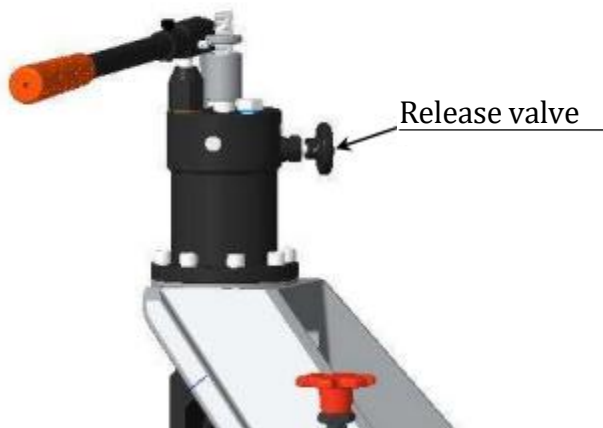
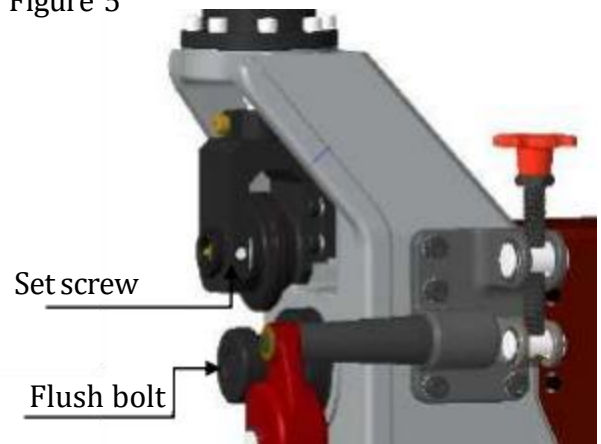

Figure 5



MAINTENANCE INSTRUCTIONS

Lubrication

RG-5S Universal Electric Hydraulic Roll Groover with good general purpose should lubrication periodically as below specified.

- 2 Grease nozzles are integrated on RG-5S groover. Grease nozzle of Drive Shaft lubrication located on the side of the groover housing. Roll shaft nozzle at the front-center of the roll shaft. Always add grease until a small amount is pushed out.
- **At least every 4 hours of operation**, lubricate the roll shaft.
- **Every month**, add grease to the drive shaft lubrication nozzle.
- The gear box of the RG-5S Roll Groover is greased for life and does not require the addition of any grease unless the gear box is opened. See Inspection Section for other information on maintenance.
- Grease the bearing prior assembling when repairing the roll groover.

Cleaning

- Clean the driveshaft knurls with a wire brush on a daily basis or more often if needed.
- Clean the unit surface with dry soft cotton cloth.

Machine Storage

- Store the tool in a locked area that is out of reach of children and people unfamiliar with roll groover equipment. This tool can cause serious injury in the hands of untrained users.



- Store the tool in a locked area away from moisture and corrosion material. Apply a thin coat of anti-rust liquid on moving parts and shafts are strongly recommended.

Accessories

The following products have been designed to function with the RG-5S Universal Electric Hydraulic Roll Groover. Other accessories suitable for use with other tools maybe hazardous when used on the RG-5S Roll Groover. To reduce the risk of serious injury, only use accessories specifically designed and recommended for use with the RG-5S Hydraulic Roll Groover, such as those listed below.

Standard Equipment & Item Code of

RG-5S Universal Electric Hydraulic Roll Groover

#99041	RG-5S Roll groover		
#98055	Single phase motor -- 1100W / 110-240V / 50/60Hz	#11109 & #12043	Roller set for 8 " ~ 12"
		#98078	Pipe stand for 1" ~ 12"
#98009	Hydraulic pump	#98026	Foot switch
#11106 & #12041	Roller set for 1" ~ 1½"	#98011	Pipe stabilizer
#11107 & #12042	Roller set for 2" ~ 3"		
#11108 & #12042	Roller set for 3½" ~ 6"		

Troubleshooting

Problem	Cause	Correction
Pump not delivering oil, cylinder does not advance	Low hydraulic oil in reservoir	Check oil level and add hydraulic oil if necessary.
	Low quality oil, pump nozzle blocked.	Change qualified oil and flush the oil tube.
	Seat inside the check valve worn or leak.	Loose screws and spring, knock the steel shot with proper tool and recreate sealing.
Unusual loud and sharp noise from the pipe when grooving.	Wrong position of pipe stand with long pipe causes echo..	Relocate the pipe stand to right or left.
	Pipe end not square cut with pipe axis. Pipe end scratch the drive shaft plate.	Cut pipe end square.
	Excessive friction between pipe and drive roll.	Apply a thin coat of grease on pipe end.
Pipe will not track while grooving	Pipe not level.	Adjust stand to level pipe.
	Stabilizer wheel not engaging pipe.	Offset pipe 1. -2. and tight the stabilizer again.
	Groover not level.	Level groover.
Pipe rocks from side to side	Improper setup of pipe stand.	Adjust the pipe stand location, direction and height.
	Pipe end flattened or damaged	Cut off damaged pipe end or grind flat.

Service and Repair

The "Maintenance Instructions" will take care of most of the service needs of this machine. Any problems not addressed by this section should only be handled by an authorized service technician. Tool should be taken to a Independent Authorized Service Center or returned to the factory. When servicing this machine, only identical replacement parts should be used. Use of other parts may create a risk of serious injury

Chart A -Roll grooving parameters

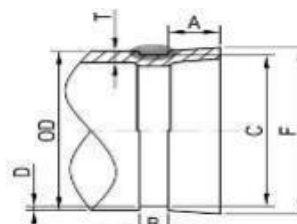
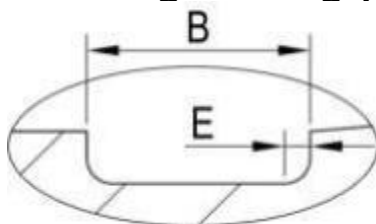

Nom. Pipe Size	Pipe O.D. Basic Tolerance			Gasket Seat A	Groove Width B	Groove Diameter Basic Tol.		Groove Depth D(ref.)	Allow. Flare Dia. F(max)
in. mm	in. mm	+in. mm	+ -mm	±0.03in. ±0.76mm	±0.03in. ±0.76mm	in. mm	in. mm	in. mm	in. mm
1" 25	1.325 33.7	0.013 0.33	0.027 0.68	0.625 15.88	0.281 7.14	1.535 38.99	-0.015 -0.38	0.063 1.60	1.36 34.5
1¼" 32	1.660 42.4	0.016 0.41	0.024 0.60	0.625 15.88	0.281 7.14	1.775 45.09	-0.015 -0.38	0.063 1.60	1.77 45.0
1½" 40	1.900 48.3	0.019 0.48	0.020 0.52	0.625 15.885	0.281 7.14	2.12 53.85	-0.015 -0.38	0.063 1.60	2.01 51.1
2" 50	2.375 60.3	0.024 0.61	0.024 0.61	0.625 15.88	0.344 8.74	2.250 57.15	-0.015 -0.38	0.063 1.60	2.48 63.0
2½" 65	2.875 73.0	0.029 0.74	0.029 0.74	0.625 15.88	0.344 8.74	2.720 69.09	-0.018 -0.46	0.078 1.98	2.98 75.7
3OD 65	3.000 76.1	0.030 0.76	0.030 0.76	0.625 15.88	0.344 8.74	2.845 72.26	-0.018 -0.46	0.078 1.98	3.10 78.7
3" 80	3.500 88.9	0.035 0.89	0.031 0.79	0.625 15.88	0.344 8.74	3.344 84.94	-0.018 -0.46	0.078 1.98	3.60 91.4
3½" 90	4.000 101.6	0.040 1.02	0.031 0.79	0.625 15.88	0.344 8.74	3.834 97.38	-0.020 -0.51	0.083 2.11	4.10 104.1
4" 100	4.500 114.3	0.045 1.14	0.031 0.79	0.625 15.88	0.344 8.74	4.334 110.08	-0.020 -0.51	0.083 2.11	4.60 116.8
4½OD 120	5.000 127.0	0.050 1.27	0.031 0.79	0.625 15.88	0.344 8.74	4.834 122.78	-0.020 -0.51	0.083 2.11	5.10 129.5
5½OD 125	5.500 139.7	0.056 1.42	0.031 0.79	0.625 15.88	0.344 8.74	5.334 135.48	-0.020 -0.51	0.083 2.11	5.60 142.2
5" 125	5.563 141.3	0.056 1.42	0.031 0.79	0.625 15.88	0.344 8.74	5.395 137.03	-0.022 -0.56	0.084 2.13	5.66 143.8
6½OD 150	6.500 165.1	0.063 1.60	0.031 0.79	0.625 15.88	0.344 8.74	6.330 160.78	-0.022 -0.56	0.085 2.16	6.60 167.6
6" 150	6.625 168.3	0.063 1.60	0.031 0.79	0.625 15.88	0.344 8.74	6.455 163.96	-0.022 -0.56	0.085 2.16	6.73 170.9
8OD 200	8.000 203.2	0.063 1.60	0.031 0.79	0.750 19.05	0.469 11.91	7.816 198.53	-0.025 -0.64	0.092 2.34	8.17 207.5
8" 200	8.625 219.1	0.063 1.60	0.031 0.79	0.750 19.05	0.469 11.91	8.441 214.40	-0.025 -0.64	0.092 2.34	8.80 223.5
10OD 250	10.000 254.0	0.063 1.60	0.031 0.79	0.750 19.05	0.469 11.91	9.812 249.23	-0.027 -0.69	0.094 2.39	10.17 258.3
10" 250	10.750 273.0	0.063 1.60	0.031 0.79	0.750 19.05	0.469 11.91	10.562 268.28	-0.027 -0.69	0.094 2.39	10.92 277.4
12OD 300	12.000 304.8	0.063 1.60	0.031 0.79	0.750 19.05	0.469 11.91	11.781 299.24	-0.030 -0.76	0.109 2.77	12.17 309.1
12" 300	12.750 323.9	0.063 1.60	0.031 0.79	0.750 19.05	0.469 11.91	12.531 318.29	-0.030 -0.76	0.109 2.77	12.92 328.2