

FlexShield

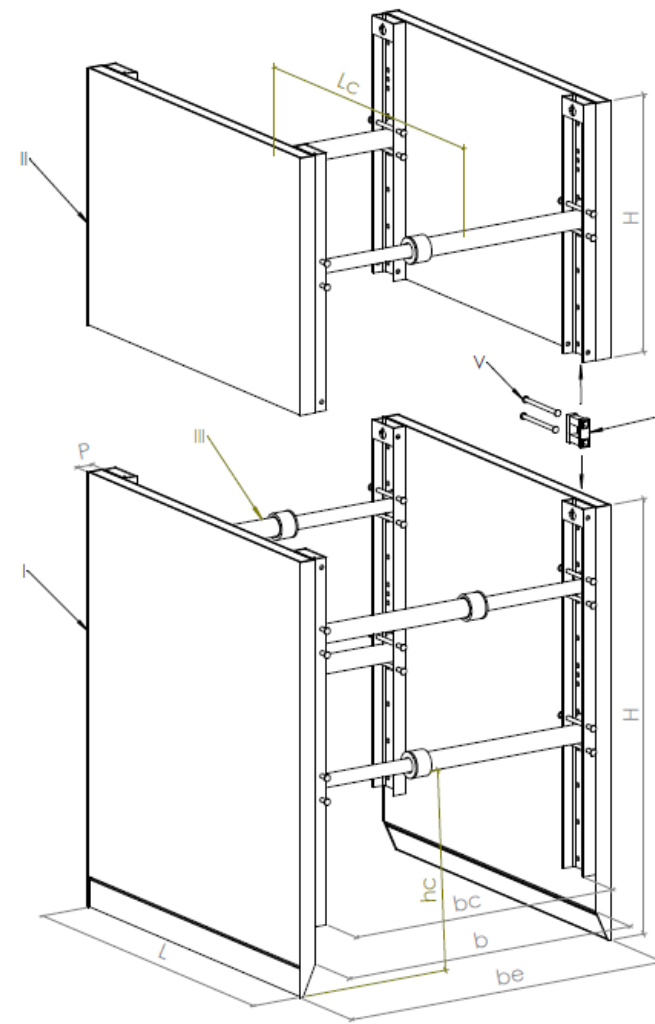

The robust, long-lasting FlexShield features a reinforced head, which can resist even the high loads when using the cut and lower method. At the same time, the reinforced cutting edge design enables even firm earth to be stripped away.

- Side parts with additional supports to minimize deformation.
- Articulated spindles enable use with non-stable soils, using the cut and lower method.

- ACCESSORIES**
- Base panel
 - Extension panel
 - Strut (XSpindle)
 - Panel connector
 - Pin

Plate thickness = 108mm

Panel length L (m)	Panel height H (m)	Panel length clearance Lc (m)	Panel height clearance hc (m)	Allowable Earth Pressure (kN / m ²)	Panel weight (Kg)
4.0	2.0	3.6	1.50	51.8	795
	2.0	3.6			970

XSPINDLE

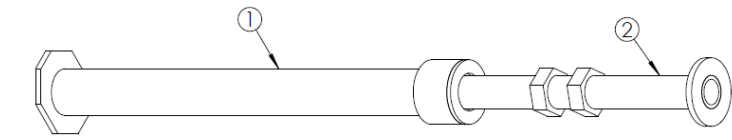

Xspindle are set to the required trench width by simply slotting and coupling together the extension pipes. Up to 2 extension pipes. Extension pipes up to a total length of 3 m can be used as extension. The extension pipes are available in lengths from 1 m can be combined to achieve your desired working width.

In traditional system, the extension pipes have to pinned together. That takes and requires lot of bolts. But with SafeXTrench, you just slot the extension pipes together and pin them and you are done. This makes it possible to alternately press the plates down using the cut and lower method.

XSpindle

Trench clearance width (m)	Type Blue series			Allowable compressive force (kN)	Total weight (Kg)
	Part 1	Part 2	Part 3		
1.2 - 1.8	1 Nos	1 Nos	-	520	34
1.8 - 2.8	1 Nos	1 Nos	1 Nos	520	51.4
2.8 - 3.8	1 Nos	1 Nos	2 Nos	520	68.8