

heatJET

Operating and assembly instructions

Preparing for Installation

Before starting the installation, ensure that you have:

- | heatJET device
- | smartY for heatJET device
- | 12 V DC power supply with appropriate current rating
- | Temperature sensor
- | Control button with LED ring

Mechanical Installation

The smartY in version for heatJET device is supplied with open terminal block connectors. The customer connects the 12 V DC power supply cables to the designated power input terminal.

Ensure that the polarity is correct:



Output connectors — P: Parking Heater — H: heatJET

Power supply

- | **Left terminal** → Positive / Voltage (+) — typically a red wire
- | **Right terminal** → Negative / Ground (-) — typically a black wire

Installation of the Temperature Sensor

Place the temperature sensor in the designated location on the boiler to accurately measure the water temperature.

How to connect heatJET and smartY version for heatJET

The diagram shows an example of a correctly connected installation.

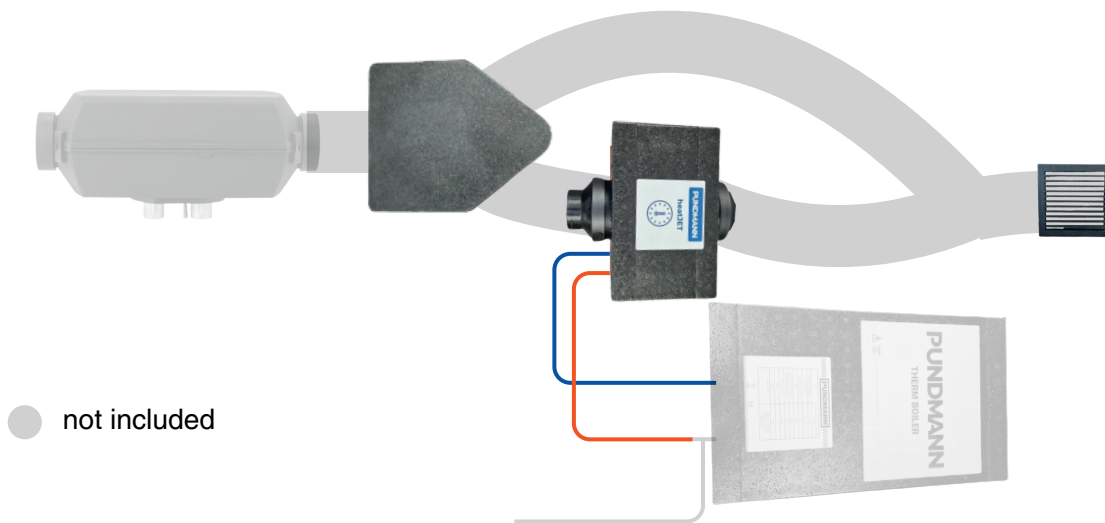

The heatJET should be connected to the boiler using the cables supplied with the kit. The heatJET version of the smartY must be connected to the power cable from the heatJET and the parking heater so that the heatJET version of the smartY can control the devices. Connection diagram below.

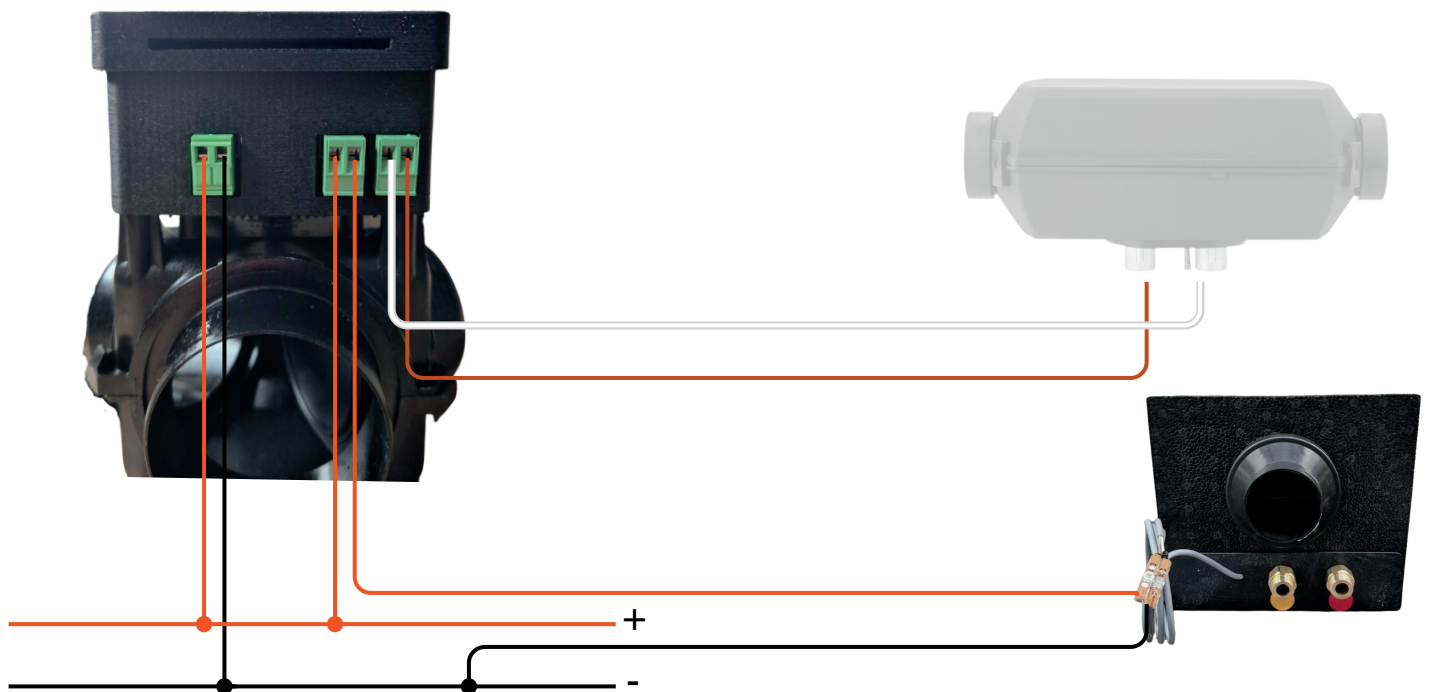

Cables on the heatJET:
brown = +
white = -

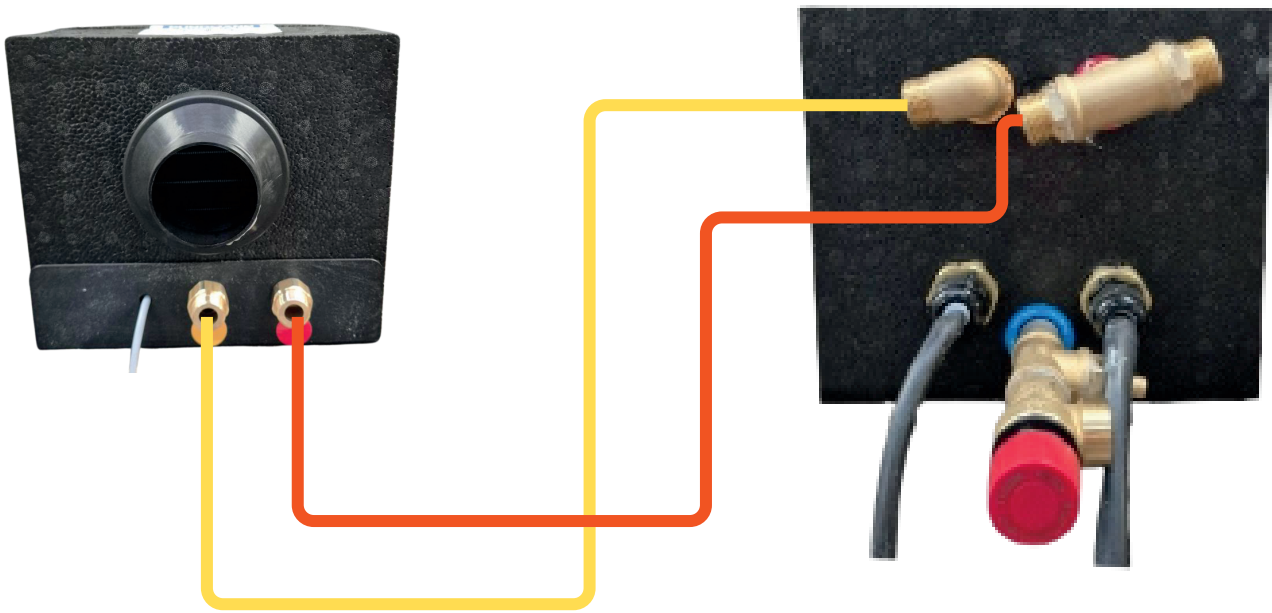

The correct connection of the boiler to the heatJET is shown in the diagram above.

Start-Up

After connecting all components, switch on the 12 V DC power supply. The device will initialise automatically.

Button Control

Single Press — MANUAL Mode (one heating cycle)

A single short press activates one complete heating cycle:

- | The LED ring in the button lights up continuously.
- | If the water temperature in the boiler is below 80°C, the auxiliary heater switches on.
- | The smartY damper adjusts its position, directing hot air through the heatJET.
- | The circulation pump starts, circulating water through the heat exchanger to load up the boiler with heat.
- | When 85°C is reached, the heater switches off and the damper returns to its default position.
- | The pump continues to run for an additional 120 seconds to cool down, then switches off.
- | The device returns to standby.

**** Never manually interrupt the 120-second pump cooling period.***

Second Press During Operation — AUTO Mode (60 minutes)

Pressing the button a second time while the system is running activates 60-minute automatic mode:

- | The system automatically restarts heating whenever the water temperature drops below 80°C within the 60-minute window.
- | The LED ring in the button flashes every 2 seconds.
- | After 60 minutes, the device returns to standby.

** While in AUTO mode, a short press is ignored. To stop AUTO mode, use the long press (3-5 s).*

Long Press (3–5 seconds) — Stop / Return to Standby

Use this to stop any active operation and return the device to standby — including stopping AUTO mode, which cannot be cancelled with a short press.

- | heatJET immediately returns to standby mode, switching off all active components.
- | Cancels AUTO and MANUAL modes and resets all timers.
- | LED turns off; device is idle in standby.

** Use this whenever you need to stop all activity or exit AUTO mode.*

Long Press (10–20 seconds) — Open Web Configuration Panel

This function is only needed if you want to change the operating temperature thresholds — for example, the temperature at which the heater switches on, default 80°C and switches off, above default 85°C. It activates the device's built-in Wi-Fi access point so you can connect and adjust settings via a web browser.

1. Hold the button for 10–20 seconds, then release.
2. The LED lights up briefly as confirmation, then turns off — the AP is active.
3. The device enables its own Wi-Fi access point without restarting.

Network credentials:

- | SSID: heatJET
- | Password: Pundmann25

How to connect and change settings:

1. Connect your phone or computer to the heatJET network.
 2. A captive portal configuration page opens automatically.
 3. To connect the device to your home network: select your network from the list and enter the password.
 4. Once connected, open a browser and go to <http://heatjet.local>
 5. Adjust the target temperature (heater ON/OFF thresholds) as required.
 6. Home Assistant detects the device automatically via mDNS.
-

Long Press (20+ seconds) — Return to Standard Settings

1. Hold the button for more than 20 seconds, then release.
2. The LED ring flashes rapidly 3 times as confirmation.
3. The device erases the saved Wi-Fi network and all custom settings, restoring standard defaults.
4. The device restarts automatically.
5. After restart, the device waits with no network — Wi-Fi configuration is required (see above).
 - * *Use this when changing your Wi-Fi network or to restore the device to its original standard settings.*

LED Indicator

The LED ring in the button provides information about the current system status:

LED State	Meaning
Off	Standby — device is idle
Steady light	MANUAL mode active — one heating cycle in progress
Flashes every 2 seconds	AUTO mode active — 60-minute automatic monitoring
Lights up once briefly, then off	Wi-Fi configuration AP activated (hold 10–20 s) — connect to "heatJET" network to configure
Flashes rapidly 3x, then device restarts	Return to Standard Settings confirmed — device is resetting

Safety

- | Use only a certified 12 V DC power supply.
- | Do not install the device in areas exposed to direct water contact.
- | Disconnect the power supply before performing any maintenance.
- | Installation in heating systems must be carried out in accordance with local building regulations.
- | Never manually interrupt the 120-second pump cooling period.

Technical Support

If you encounter technical problems or have questions regarding installation, please contact our technical support.

Document version: 2.5.0 Date of update: May 2026

service@pundmann.pl