

Transform your fan into a
Smart Fan with



A Quality product from



User Manual

Contents

- **Package Contents**
- **Product Specifications**
- **Features**
- **Installation instructions**
- **How to Use? and Do's & Don'ts**
- **Troubleshooting**
- **Warranty Certificate**
- **Support**

Note: It is MANDATORY to read through this manual thoroughly prior to installation and usage of EasyBreez Fan Remote. Contact us for support, if you need any clarification.

Package contents

- EasyBreez Module – 1 No
- Remote Control unit – 1 No
- Cable crimping lugs – 5 Nos
- Fixing Screw – 1 No
- User Manual

Product Specifications

- Rated Voltage: 220V/230V AC,
- Frequency: 50Hz
- Operating Range: 180v AC – 270v AC
- Wattage Support: up to 100W max.
- Control unit weight: 33g, Remote – 41g
- Ambient working temperature: 5°C – 50°C
- Mounting type: Down-rod mount, under the lower canopy

Features

- Transforms any regular induction fan to smart fan
- Intelligent speed regulator wirelessly, no more manual regulator operation
- 5 Speeds and ON/OFF
- Remembers last set fan speed, operates at same speed when power lost and powered ON
- Audio acknowledgement for Remote commands
- Smooth transition between speeds
- Works up to 15ft distance from any part of room, with line of sight
- Wireless communication using IR Remote
- Switch to manual mode, if remote lost / not functioning
- No additional wiring or electrical work required
- Conveniently fits under the lower canopy of your fan
- Easy to install, electrician can easily fix just in 10mins

Installation instructions

WARNING: ELECTRICAL SHOCK HAZARD. DISCONNECT POWER TO INSTALLATION AREA AT YOUR CIRCUIT BREAKER OR FUSE BOX BEFORE BEGINNING INSTALLATION. ALWAYS USE CAUTION WHEN HANDLING ELECTRICAL WIRING. INSTALLATION BY A QUALIFIED ELECTRICIAN IS REQUIRED.

Step 1: Remote existing capacitor clamp from the fan shaft

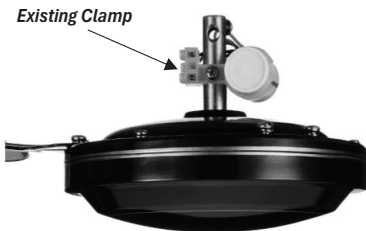

Step 2: Fix EasyBreez on fan shaft at the same position of existing slot

Use the same screw hole on fan shaft to fix EasyBreez product.

Insert capacitor in holder provided on EasyBreez plastic

Step 3: Follow the below diagram for wiring EasyBreez

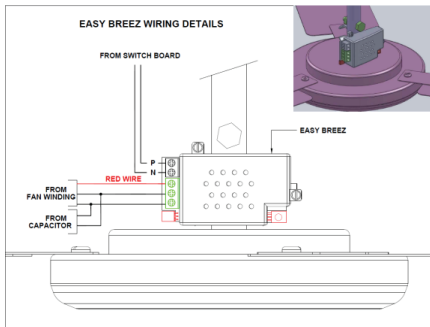

Wiring:

Use cable crimping lugs () to input and output cables for better and safe installations avoiding loose contacts and short circuits

Input Wiring (Mains from Switch Board):

P – Live

N – Neutral

Output Wiring (to Fan Motor):

R – Red wire

Y – Yellow wire + Capacitor

B – Blue / Black wire + Capacitor

Step 4: Canopy Placement

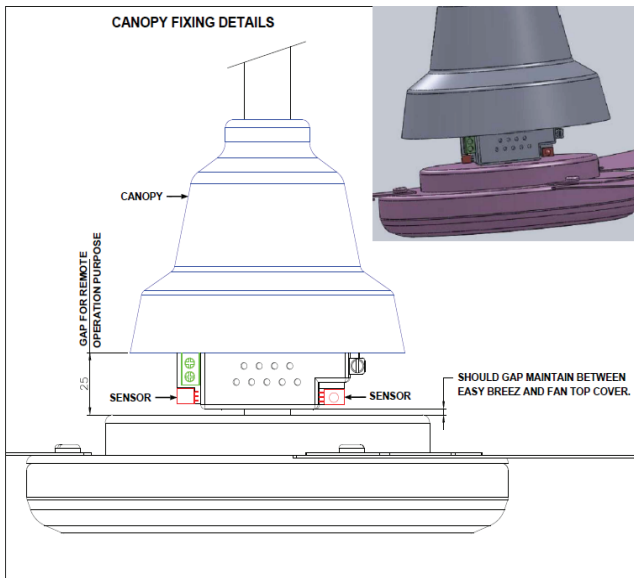

Note: Leave a clearance of 25mm (1inch) between top cover of the fan and lower canopy as show above for best remote signal reception

Step 5: Bypassing the manual regulator in switch board

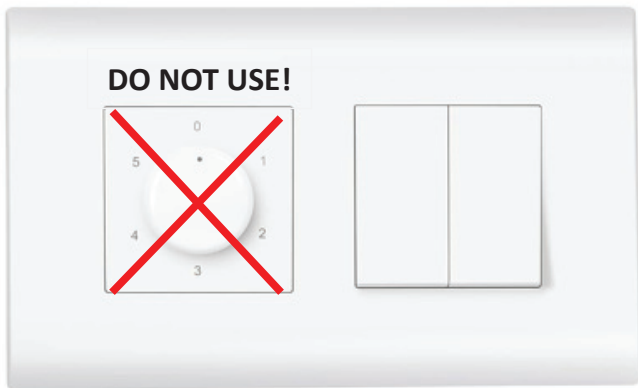

Note: Bypassing manual regulator in switch board wiring is mandatory.

Warranty void if any failure arises due to usage of manual regulator along with EasyBreez.

Step 6: Operating Remote

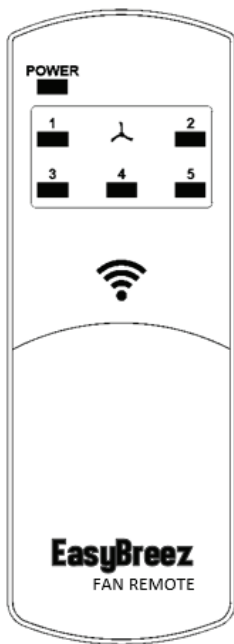

Insert AAA batteries - 2 Nos
(not included in package)

Keys:

Power ON / OFF
Speeds – 1 to 5

Usage:

Works up to 15ft from any
direction within the room

Remembers last set speed,
runs when you re-ON main
switch

Refer to next section, “how
use operate when remote
lost / not working”

How to Use?

Do's and Don'ts

NOTE: Don't forget to Bypass Manual Regulator in Switch board for EasyBreez functioning.

- EasyBreez Remote provides best communication from any part of room.
- Remote offers 1-5 speeds and ON / OFF functions
- Supports up to 15ft distance

When remote lost / not working?

You can move to manual mode till you get a working remote back as follows

- Switch OFF/ON the mains switch 3 times in an interval of 1 second
- EasyBreez gives a buzzer sound and goes to manual mode
- Fan runs in top speed in this mode
- Use remote when you get it back, system goes back to remote mode and works as usual

Troubleshooting Guide

Why Fan is not responding to Remote Signals?

Possible Reasons:

1. Remote battery level is too or fully drained out
 - a. Try replacing batteries and check again
2. Lower canopy on fan top cover is fully covering EasyBreez product
 - a. Provide a minimum gap of an Inch between fan top cover and lower canopy i.e., keep the EasyBreez unit 50% visible and try again
3. Fan ceiling shaft is too long i.e., more than 3ft
 - a. Lengthy (more than 3ft) shaft may degrade signal taking ability considerably, may experience signal loss
4. You may be using manual Regulator
 - a. Manual regulator must be bypassed during EasyBreez installation without fail. Keeping regulator connected can spoil electronic circuitry, also voids warranty of the product

If your problem still persists, please contact our service team for support. Contact details are provided on last page of this manual.



EasyBreez
FAN REMOTE

WARRANTY

Certificate

Customer Name: _____

Address: _____

Model No. _____ Serial No. _____

Purchase Date: _____ Invoice No. _____

This certificate extends the warranty of the product "EasyBreez" for a period of **Twelve (12) Months** from the date of purchase. This warranty covers the repair or replacement of the faulty unit at our discretion.

This certificate does not provide coverage for the loss or destroyed products. This warranty is void, if altered in anyway.

Dealer: _____ Contact No. _____

Signature and Seal: _____

Date: _____



Support

Thank you for choosing



Love to hear your valuable
feedback

Email us

bd@powernsolutions.in

or contact us on

Call / WhatsApp: **91-9063563358**

Landline: **91-40-40149555**

To visit our website for EasyBreez product
installation and support videos

Scan here



Also,
available online



EasyBreez
FAN REMOTE