



ALFAROUC

Trading & Supplies

الفاروق للتجارة والتوريدات





ALFAROUQ
Trading & Supplies

الفاروق للتجارة والتوريدات



نبذة عن الشركة

شركة الفاروق للتجارة والتوريدات

تأسست الشركة عام 2010 ومن هذا التاريخ ونحن نقوم بإستيراد جميع أنواع المسامير ومهمات الرباط والتثبيت .
وتقوم الشركة بتوريد أصناف كثيرة تثق بها المهمات والمشروعات بأنواعها وهي كالتالي ...

- مسمار مسدس 8.8 / 10.9
- صاموله
- تيش مستورد ومحلي
- أفيز هنجر مستورد ومحلي
- أفيز بالفشر
- كرسي خشب
- أكمون ماركة Fischer
- أكمون ماركة Friulsider
- اكمون صيني وماركات أخرى
- مسمار سن بنطه
- مسمار هلتي
- فلانشات PN10 / PN16 (محلي ومستورد)



رسالتنا

المساهمة في بناء المستقبل من خلال توفير
خدمات ومنتجات عالية الجودة والالتزام بتوفير
اعلي مستويات المهنية والاستجابة والسلامة .

CLEVIS HANGER

MATERIAL

Mild Steel. Also other materials can be provided on request

FINISH AVAILABLE

Electro-Galvanized, Hot Dip Galvanized, Epoxy, Plain

NOMINAL PIPE SIZE

From 1/2" To 30"

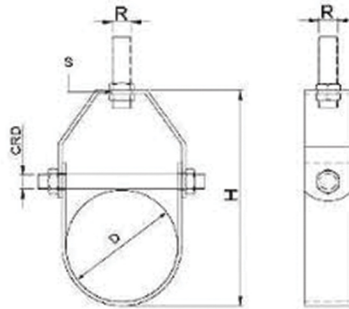

SPRINKLER HANGER

MATERIAL

Mild Steel. Also other materials can be provided on request

FINISH AVAILABLE

Electro-Galvanized, Hot Dip Galvanized, Epoxy, Plain

NOMINAL PIPE SIZE

From 3/4" To 12"



Sprinkler Hanger
WITHOUT NUT

PIPE HANGER WITH EPDM LINING

MATERIAL

Mild Steel. Also other materials can be provided on request

FINISH AVAILABLE

Electro-Galvanized, Hot Dip Galvanized, Epoxy, Plain

NOMINAL PIPE SIZE

From 1/2" To 3"



PIPE HANGER WITH LINING LIGHT DUTY WITH STUD

MATERIAL

Mild Steel. Also other materials can be provided on request

FINISH AVAILABLE

Electro-Galvanized, Hot Dip Galvanized, Epoxy, Plain

NOMINAL PIPE SIZE

From 1/2" To 8"

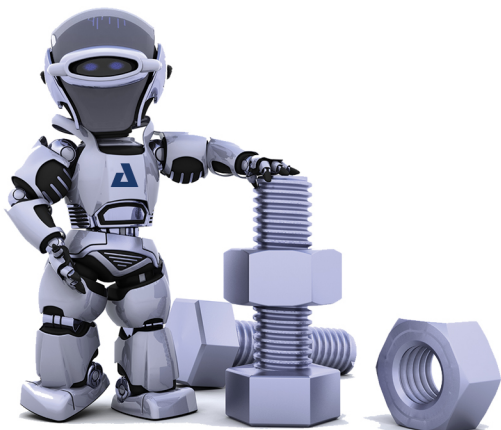

U STRAP

MATERIAL

Mild Steel. Also other materials can be provided on request

FINISH AVAILABLE

Electro-Galvanized, Hot Dip Galvanized, Epoxy, Plain

NOMINAL PIPE SIZE

From 1/2" To 24"

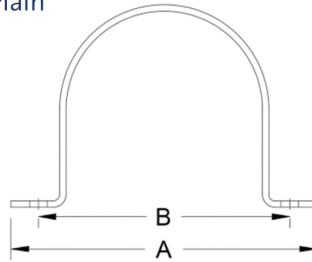

RISER CLAMP

MATERIAL

Mild Steel. Also other materials can be provided on request

FINISH AVAILABLE

Electro-Galvanized, Hot Dip Galvanized, Epoxy, Plain

NOMINAL PIPE SIZE

From 1/2" To 24"

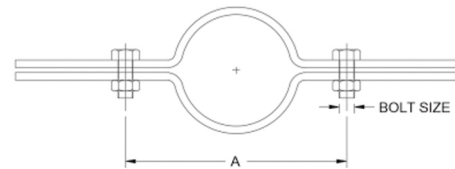

U BOLT

MATERIAL

Mild Steel. Also other materials can be provided on request

FINISH AVAILABLE

Electro-Galvanized, Hot Dip Galvanized, Plain

NOMINAL PIPE SIZE

From 1/2" To 24"

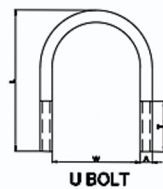

HEX BOLTS

MATERIAL

Mild Steel, Carbon Steel, Alloy Steel & Stainless Steel

FINISH

Finish (Black, GI, Yellow, HDG, Cadmium, Nickel, PTFE etc)

SIZE RANGE

- M6 to M64 in metric series
- ¼" to 2½" in imperial
- Bigger sizes can be manufactured as per order

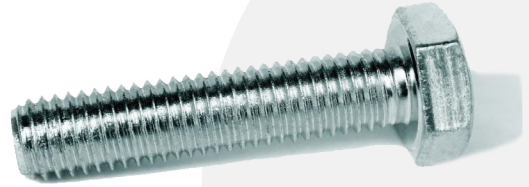

SOCKET SCREWS

MATERIAL

Alloy Steel & Stainless Steel (304, 304L, 316, 316L)

SIZE RANGE

- M5 to M24 in metric series
- Bigger sizes can be manufactured as per order



NUTS AND WASHERS

MATERIAL

Mild Steel, Carbon Steel, Alloy Steel & Stainless Steel

FINISH

(Black, GI, Yellow, HDG, Cadmium, Nickel, PTFE etc)

SIZE RANGE

- M6 to M64 in metric series
- ¼" to 2-½" in imperial
- Bigger sizes can be manufactured as per order



HEX NUTS

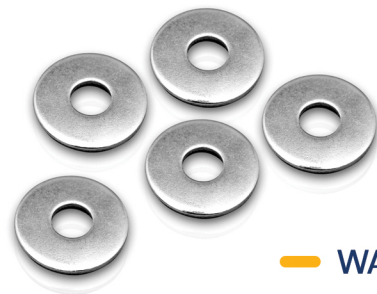

WASHERS

DROP IN ANCHOR

SIZE AND OTHERS ..

| Size | Drill Bit (B) | Anchor Length (C) | Thread Length (D) |
|------|---------------|-------------------|-------------------|
| M6 | 8 | 25 | 10 |
| M8 | 10 | 30 | 13 |
| M10 | 12 | 40 | 16 |
| M12 | 16 | 50 | 21 |
| M16 | 20 | 65 | 30 |
| M20 | 25 | 80 | 30 |

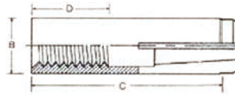

DRAW IN ANCHOR

SIZE AND OTHERS ..

| Size | Shield Length | Hole Diameter | Length of Anchor |
|------|---------------|---------------|------------------|
| M6 | 45 | 12 | 45 |
| M8 | 50 | 14 | 50 |
| M10 | 60 | 16 | 60 |
| M12 | 75 | 20 | 65 |
| M16 | 115 | 25 | 95 |
| M20 | 130 | 32 | 115 |



WEDGE ANCHOR

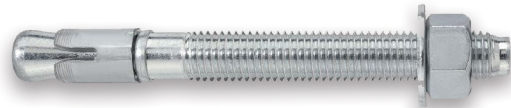

SIZE AND OTHERS ..

| | Measure | M6 | M8 | M10 | M12 | M16 | M20 | M24 |
|-------------------------------|-------------------|-----|-----|------|------|------|------|------|
| Thread Diameter | mm | 6 | 8 | 10 | 12 | 16 | 20 | 24 |
| Drill Hole Diameter | mm | 6 | 8 | 10 | 12 | 16 | 20 | 24 |
| Clearance Hole Diameter | mm | 7 | 9 | 12 | 14 | 18 | 22 | 26 |
| Embedment Depth | mm | 35 | 40 | 50 | 60 | 70 | 100 | 120 |
| Minimum Structure Thickness | mm | 50 | 60 | 80 | 100 | 110 | 130 | 180 |
| Ultimate Tensile Strength | N/mm ² | 500 | 500 | 500 | 500 | 400 | 400 | 400 |
| Yield Strength | N/mm ² | 400 | 400 | 400 | 400 | 240 | 240 | 240 |
| Recommended Tightening Torque | Nm | 6 | 10 | 28 | 34 | 85 | 160 | 300 |
| Characteristic Tensile Load | kN | 5.4 | 8.4 | 12.9 | 20.4 | 24 | 32.4 | 57.6 |
| Recommended Tensile Load | kN | 1.8 | 2.8 | 4.3 | 6.8 | 8 | 10.8 | 26.2 |
| Characteristic Shear Load | kN | 5.8 | 8 | 14.5 | 18 | 26 | 35 | 74 |
| Recommended Shear Load | kN | 2.3 | 3.2 | 5.8 | 7.2 | 10.4 | 14 | 49.3 |
| Minimum Centre Spacing | mm | 70 | 80 | 100 | 120 | 140 | 200 | 240 |
| Minimum Edge Distance | mm | 50 | 60 | 80 | 100 | 130 | 160 | 200 |

BEAM CLAMP

MATERIAL

Ductile Iron, Hardened Steel cup point set screw and lock nut

FINISH

Black or Galvanized

SIZE RANGE

3/8" and 1/2" or M10 and M12



STANDARD STEEL BEAM CLAMP

MATERIAL

Mild Steel

FINISH AVAILABLE

Electro-Galvanized /Hot Dip Galvanized

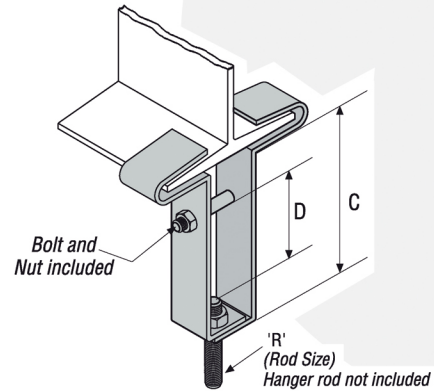

BOX STEEL BEAM CLAMP

MATERIAL

Mild Steel

FINISH AVAILABLE

Electro-Galvanized /Hot Dip Galvanized

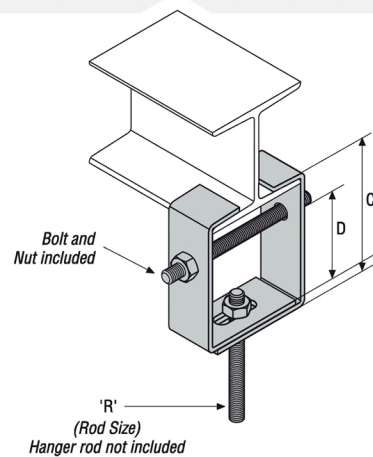

BOX BEAM CLAMP

MATERIAL

Mild Steel

FINISH AVAILABLE

Electro-Galvanized /Hot Dip Galvanized

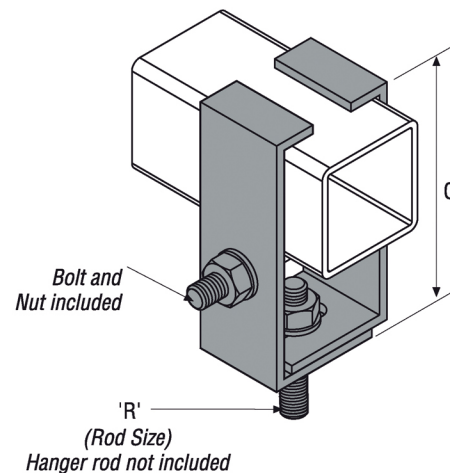

SQUARE BOLT BEAM CLAMP

MATERIAL

Mild Steel

FINISH AVAILABLE

Electro-Galvanized /Hot Dip Galvanized

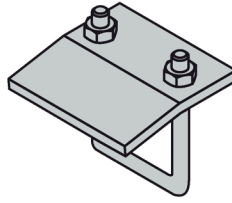

Type 1

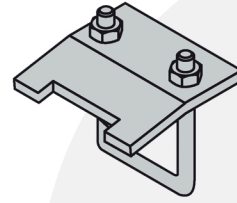

Type 2

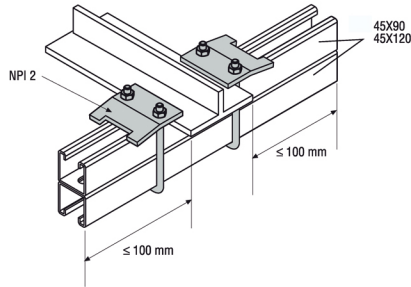
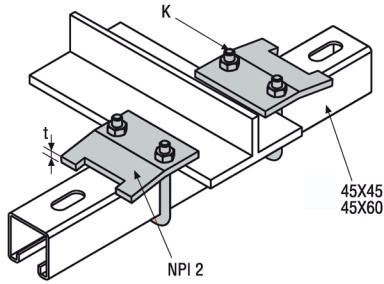

NPI

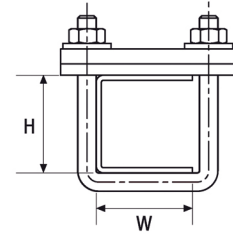

CEILING FLANGE

MATERIAL

Mild Steel

FINISH AVAILABLE

Electro-Galvanized /Hot Dip Galvanized

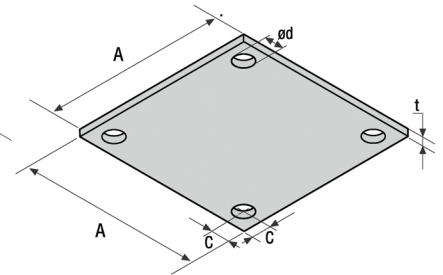
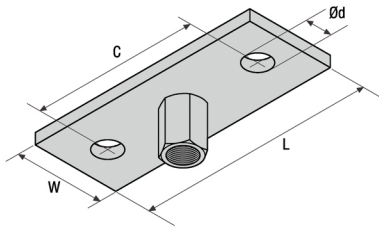

Plate

WELDING BEAM ATTACHMENT

MATERIAL

Mild Steel

FINISH AVAILABLE

Electro-Galvanized /Hot Dip Galvanized

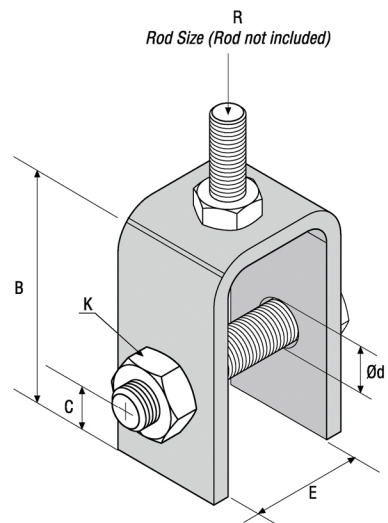

UPPER ATTACHMENT

MATERIAL

Mild Steel

FINISH AVAILABLE

Electro-Galvanized /Hot Dip Galvanized

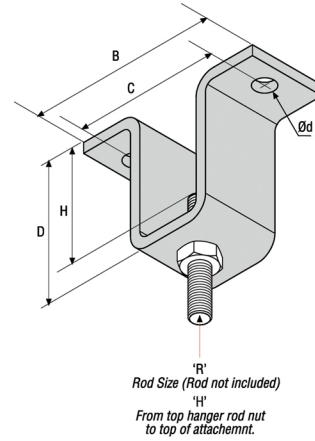

SINGLE LUG PLATE

MATERIAL

Mild Steel

FINISH AVAILABLE

Electro-Galvanized /Hot Dip Galvanized

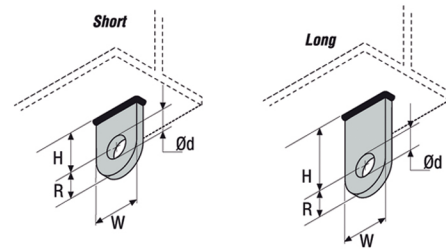

CONCRETE ROD ATTACHMENT PLATE

MATERIAL

Mild Steel

FINISH AVAILABLE

Electro-Galvanized /Hot Dip Galvanized

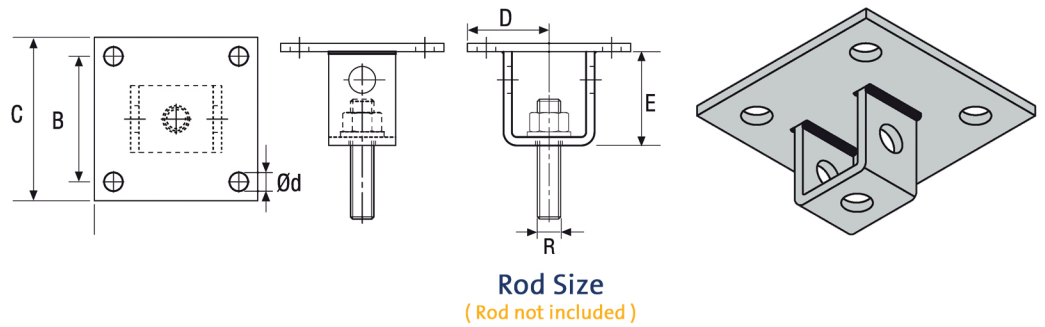

CONCRETE ATTACHMENT PLATE

MATERIAL

Mild Steel

FINISH AVAILABLE

Electro-Galvanized /Hot Dip Galvanized

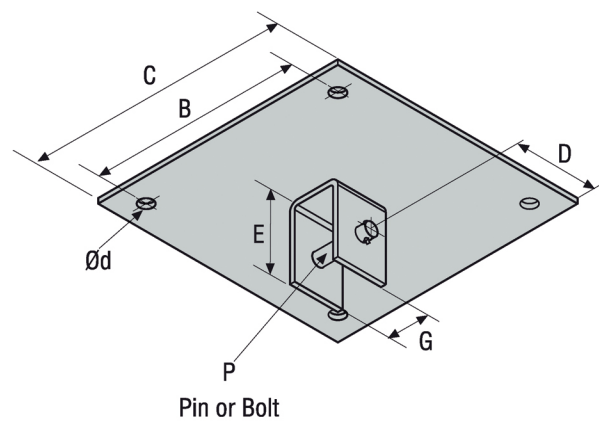

THREADED RODS

MATERIAL

Mild Steel, Carbon Steel, Alloy Steel & Stainless Steel

FINISH

(Black, GI, Yellow, HDG, Cadmium, Nickel, PTFE etc)

SIZE RANGE

- M6 to M100 in metric series
- ¼" to 4" in imperial

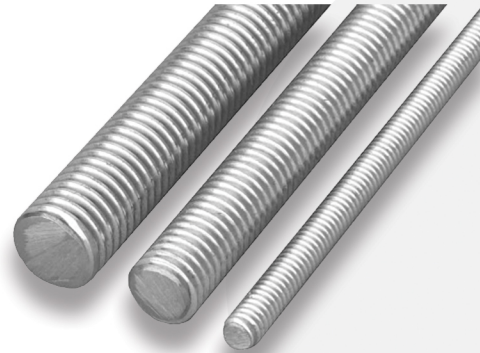

STUD BOLTS

MATERIAL

Mild Steel, Carbon Steel, Alloy Steel & Stainless Steel

FINISH

(Black, GI, Yellow, HDG, Cadmium, Nickel, PTFE etc)

SIZE RANGE

- M6 to M100 in metric series
- ¼" to 4" in imperial



ANCHOR BOLTS

MATERIAL

Mild Steel, Carbon Steel, Alloy Steel & Stainless Steel

FINISH

(Black, GI, Yellow, HDG, Cadmium, Nickel, PTFE etc)

SIZE RANGE

- M6 to M100 in metric series
- ¼" to 4" in imperial

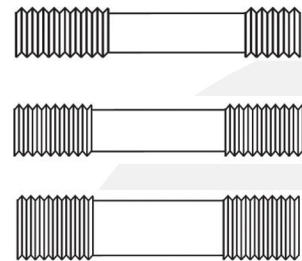
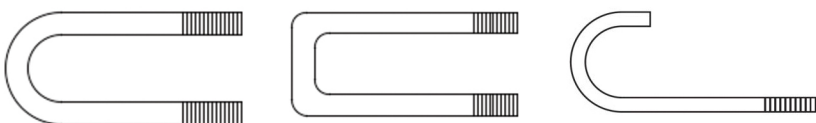

- All products are available with the appropriate grades of nuts & washers.
- All forms of plating and coating can be carried out.

STRUT CHANNELS

MATERIAL

Mild Steel. Also other materials can also be provided on request

FINISH

Electro-Galvanized, Hot dip
Galvanized & Pregalvanized,
Plain

SLOT SIZE

- 12/30
 - 14/28
- Requested slot size can be manufactured.*



| Product Code | | SE- SCHN -21-1.5 | SE- SCHN -41-1.5 | SE- SCHN -21-2.0 | SE- SCHN -41-2.0 | SE- SCHN -21-2.5 | SE- SCHN -41-2.5 |
|--------------------------|--------------------|------------------|------------------|------------------|------------------|------------------|------------------|
| Size | Unit | 41 X 21 X 1.5 | 41 X 41 X 1.5 | 41 X 21 X 2.0 | 41 X 41 X 2.0 | 41 X 21 X 2.5 | 41 X 41 X 2.5 |
| Area of Shrear | cm ² | 0.42 | 1.02 | 0.55 | 1.34 | 0.67 | 1.67 |
| Moment of Inertia (xx) | cm | 0.7 | 3.87 | 0.88 | 4.59 | 1.03 | 5.87 |
| Moment of Inertia (yy) | cm | 3.34 | 5.68 | 4.25 | 6.99 | 5.07 | 8.76 |
| Min.Section Modulus | cm | 0.6 | 1.76 | 0.75 | 2.18 | 0.89 | 2.72 |
| Wrapping Constant | cm | 17.49 | 114.17 | 21.34 | 138.49 | 24.34 | 171.52 |
| Torsional Constant | cm | 0.01 | 0.02 | 0.02 | 0.03 | 0.06 | 0.07 |
| Allowable Bending Stress | kN/cm ² | 21.82 | 21.82 | 21.82 | 21.82 | 21.82 | 21.82 |
| Allowable Shrear Stress | kN/cm ² | 12.6 | 12.6 | 12.6 | 12.6 | 12.6 | 12.6 |
| Modulus of Elasticity | kN/cm ² | 21 | 21 | 21 | 21 | 21 | 21 |

CANTILEVER ARMS

MATERIAL

Mild Steel. Also other materials can also be provided on request

FINISH

Plain, Hot Dip Galvanized As per ASTM A123,
Electro-Galvanized as per ASTM B633



DOUBLE CHANNEL
CANTILEVER ARMS

CANTILEVER
ARMS

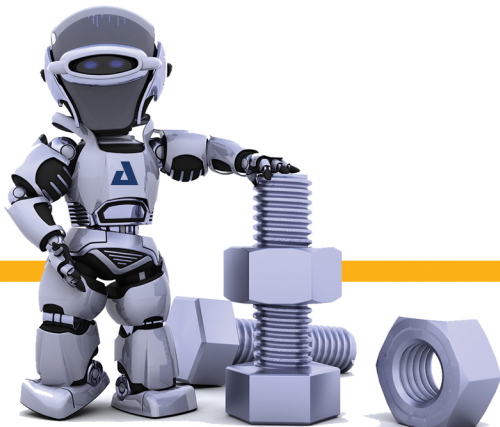

Product Range

Advanced Anchor Solutions

Self Drilling Screw



Hex Head SDS
(BLK EPDM Washer)



Countersunk Phillips
Head (CSK)



Hex Head SDS
(BLK EPDM Washer)



Phillips Truss
Head (TPH)



Farmer Head (FH)



Truss Phillips
Head (TPH)



Pan Phillips Farmer
Head (PPFH)



Drywall Screw



Fine Thread



Coarse
Thread



Hi-Low
Thread



Chipboard Screw



Pozi Drive
Head

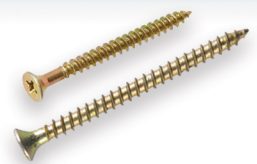

Rib Design
Head



MILD STEEL FLANGE



ALFAROUQ
FLANGE

