

Here is a *LEGO* train...

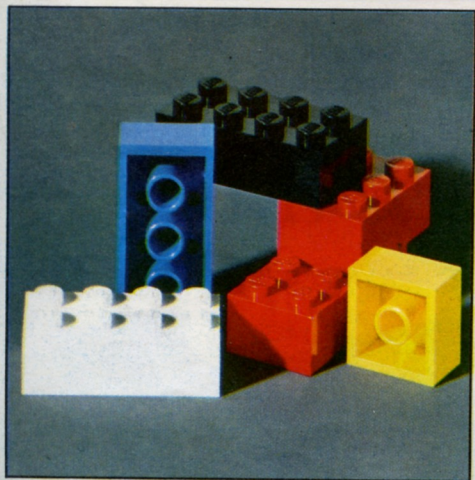

This is how boys and girls start playing with Lego when they are two or three years old. In one basic set alone there are Lego bricks enough to build lots of trains – or if you build them upwards, fantastic skyscrapers, chimneys, and many other things.

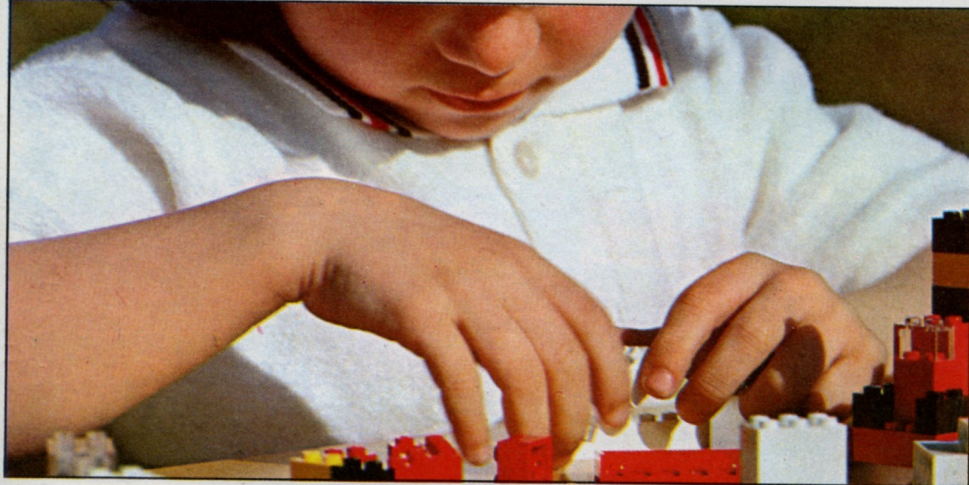

But when the child gets older he discovers the wheels of Daddy's car ... and of trains, and of all sorts of things that move. So there must be wheels for Lego ... big wheels, small wheels, with or without tyres.

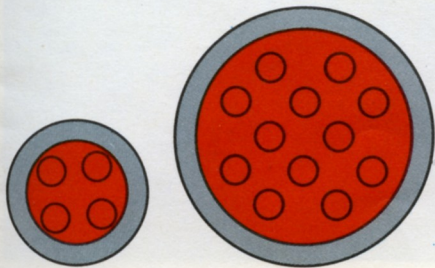



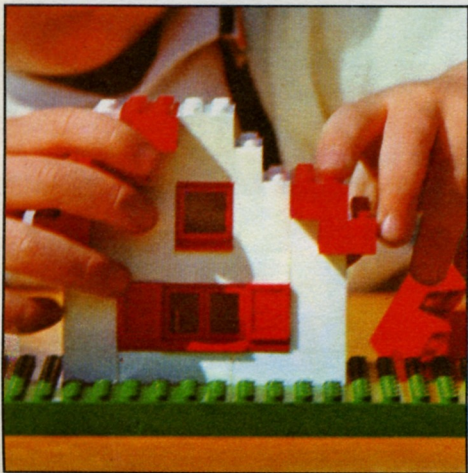
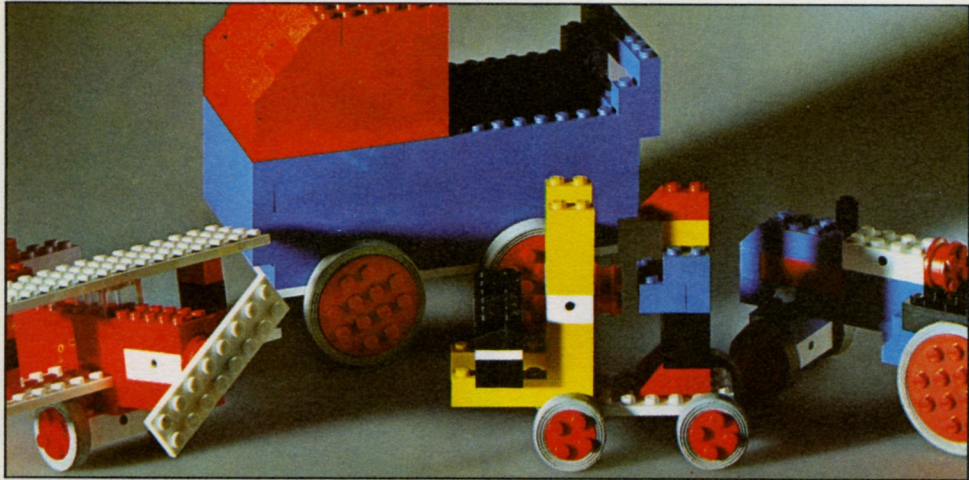

Now ... he can make almost anything with Lego. But he needs more and more bricks, because his fertile imagination keeps on suggesting new things to make: aeroplanes, tractors, dolls' prams. But he still uses the bricks that came with his first set.

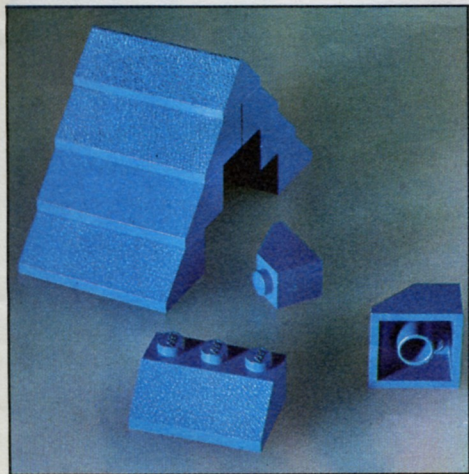

Now things have to look more realistic; houses must have sloping roofs, and doors and windows. Lego has tiles and real window panes that fit in like ordinary bricks.



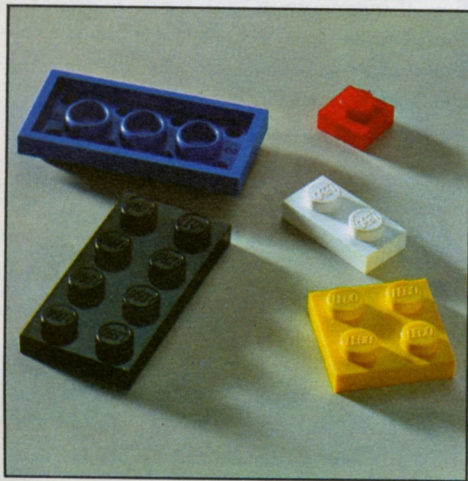
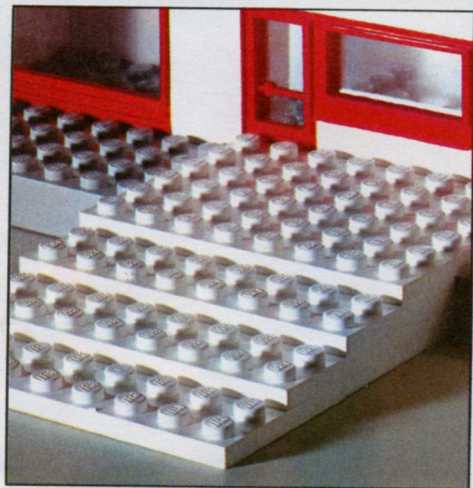
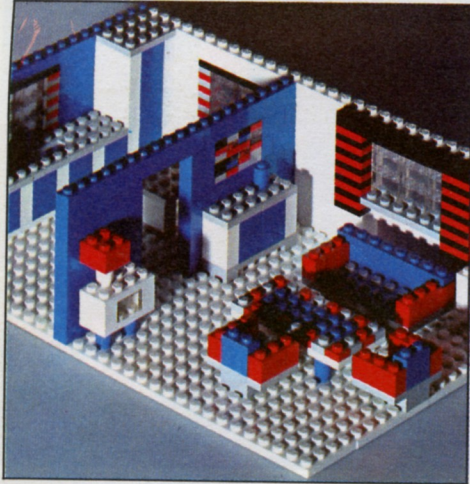

Next, details start to be important. Ordinary bricks are too large to make stairways, floorboards and small pieces of furniture. But his fingers have grown strong enough to put together and separate the Lego "slimbricks" that open up so many new possibilities.



A fine house like this has to have a fence round it, and trees and a flagstaff in the garden. And when you have built a wonderful shop, there has to be a name over the front.



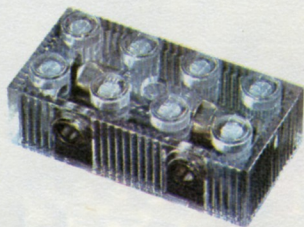
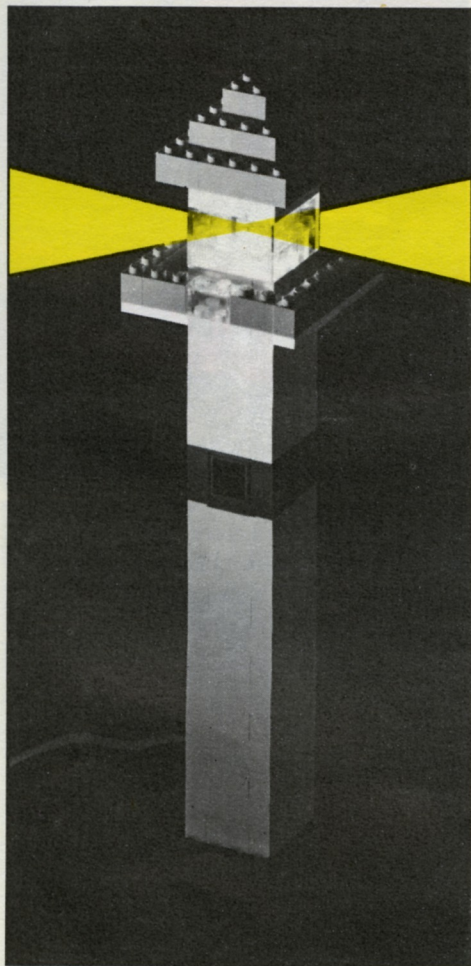

When night falls in Lego-land it's great fun to be able to turn on the lights, – in houses, cars, lighthouses. That's why there are Lego bricks with real light bulbs and wiring.





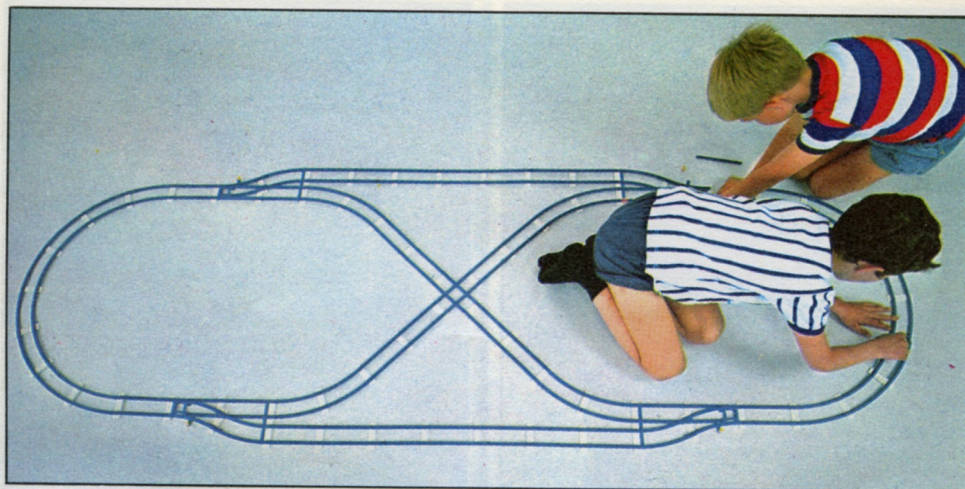

A whole new field of play starts when the Lego train has rails to run on – straights, curves, crossovers and points. You can put them together a thousand

different ways, with bridges and level crossings. And there are Lego couplings to connect the trucks together, too.

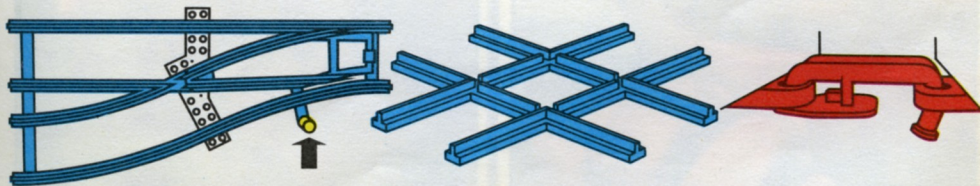

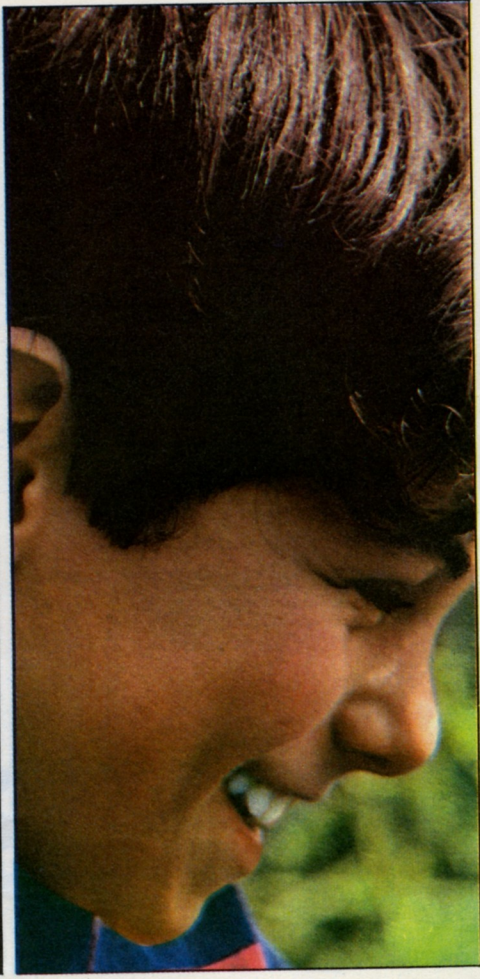



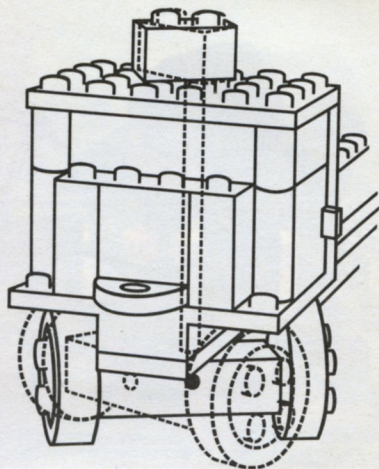
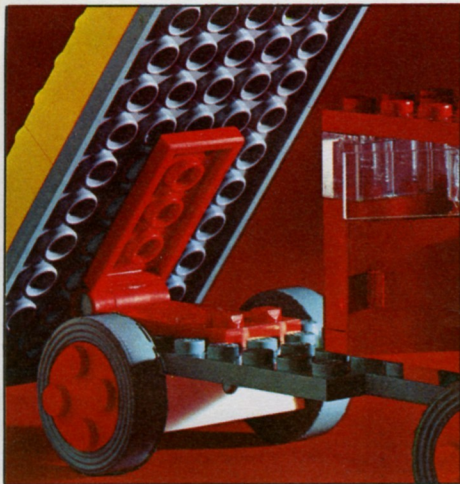

Cars are just as exciting as trains especially when the front wheels steer – but best of all when the doors open and things can be loaded in. There is also a Lego tipper truck, and a breakdown truck with a working crane. Children think these are the most wonderful vehicles in the world – because they build them themselves!

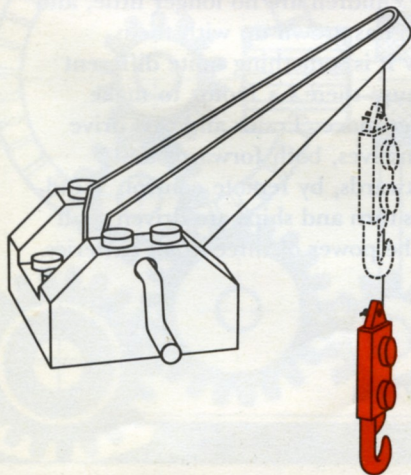



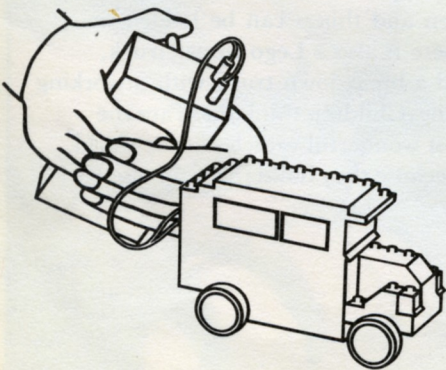
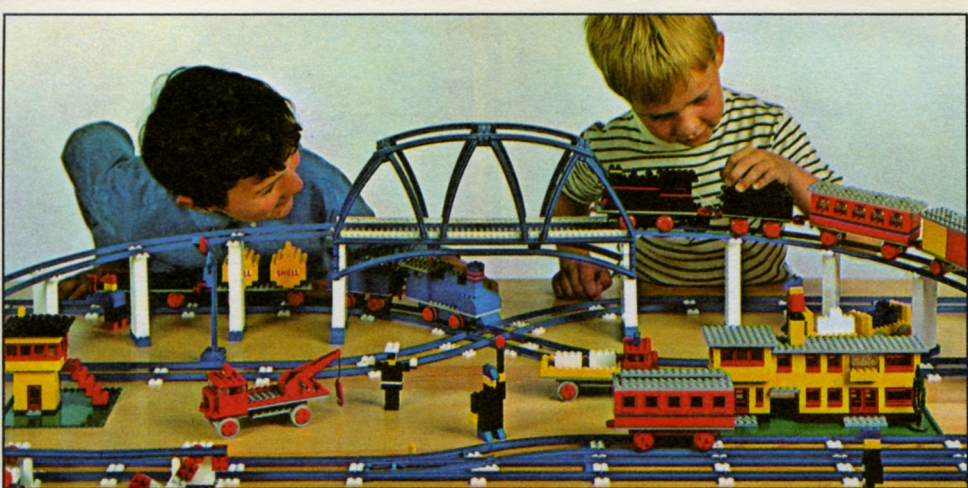

The children are no longer little, and Lego has grown up with them. Now it is something quite different because there's a motor to make things move. Trains and cars drive themselves, both forwards and backwards, by remote control. Windmills turn and ships are driven – all on the power of three small batteries.

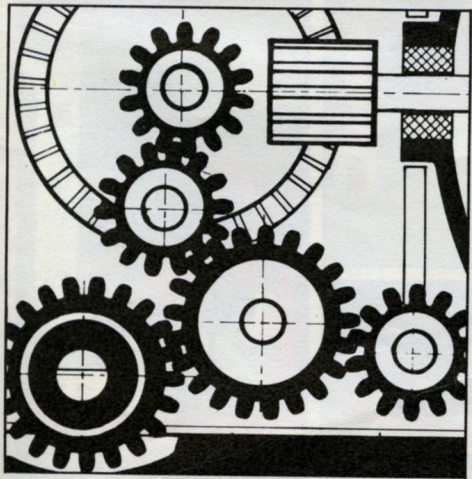
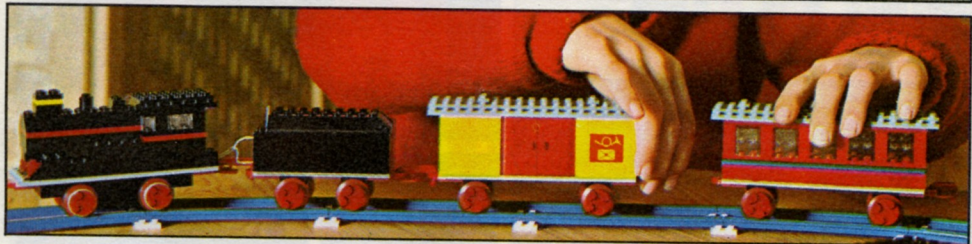
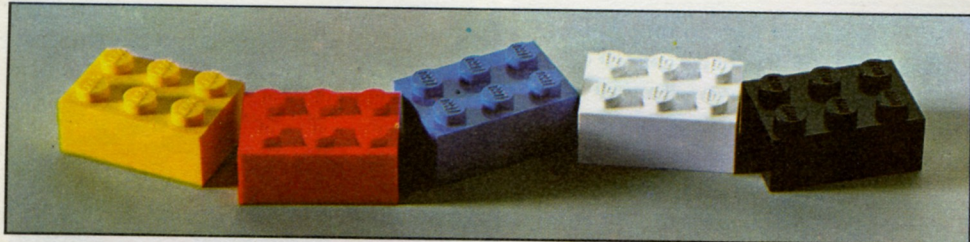

Two Lego trains with seven years between them! Because Lego can be used again and again, the first train is part of the second. This year's Lego fits last year's and will fit all the Lego to come, as each new set opens a wider field of creative enjoyment. Above all, Lego is food for a child's imagination – any child, of any age!



Lego collections are easy to supplement, because there are sets at all prices. A Lego present is always welcome. All bricks and components fit into the system. And each new set adds to the number of possibilities and ideas. In short: More Lego – more play – more fun!

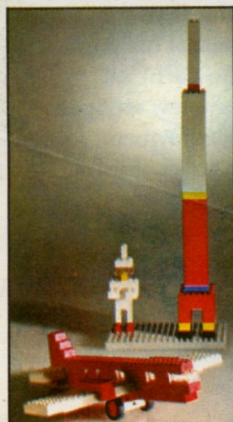
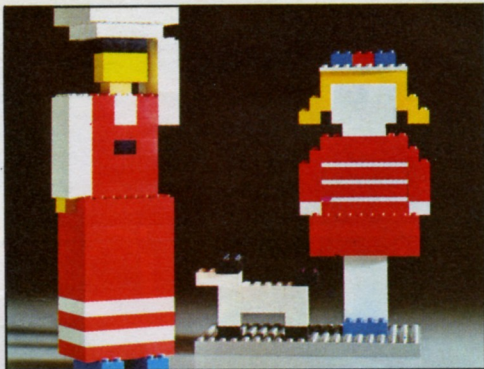
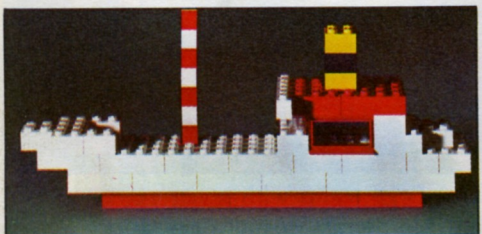





Basic Sets – the start of a good  
Lego collection.

020 – 17/11	030 – 27/11
040 – 37/11	050 – 55/11
060 – 81/11	070 – £ 5.1.11
810 – £ 8.4.11	

On page 14 we show a few of the  
many models which can be built from  
the contents of Lego Basic Sets.



Special boxes: Enough components  
for a certain model.

313 Bus	19/11
315 Taxi	7/11
324 House	21/11
325 Garage	30/11
331 Truck	12/11
332 Tow truck	15/11
333 Lorry	19/11
335 Big lorry	24/11



There are a wide range of little supplementary boxes at pocket money prices to make Lego collecting easy. Most are only 2/6 each.

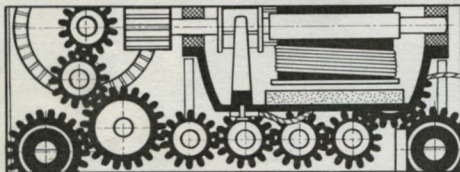
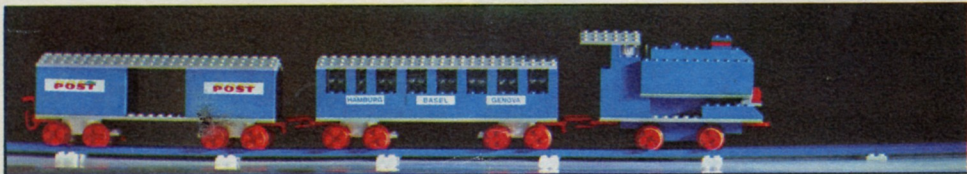

Motor- and train sets. Latest Lego novelty.

100 Motor set	39/9
101 Battery case	12/9
111 Train set	37/9
112 Locomotive	59/9
113 Train set	£ 6.9.9
115 Train set	89/9
150 Straight rails	8/9
151 Curved rails	8/9
152 2 chassis	8/9
153 Big chassis	8/9
154 Points	12/9
155 Crossings	8/9

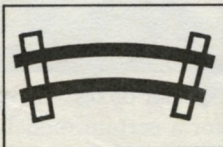
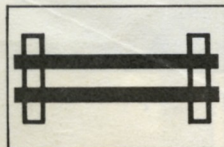

British Lego Limited