

**PLANO DE PERMISOS**

**"INDUJAL PARQUE INDUSTRIAL"**

**DESCRIPCION DE PROYECTO**

Superficie de Terreno: **197.357.07 M2** Tipo de Obra: \_\_\_\_\_  
 Planta Baja: \_\_\_\_\_ M2  
 Planta Alta: \_\_\_\_\_ M2 Uso de la Obra: \_\_\_\_\_  
 Planta Azotea: \_\_\_\_\_ M2

**COEFICIENTES**

COEFICIENTES	PERMITIDO	PROPUESTO
Coefficiente de Ocupación del Suelo (C.O.S.)	0.8 m <sup>2</sup>	m <sup>2</sup>
Coefficiente de Utilización del Suelo (C.U.S.)	2.4 m <sup>2</sup>	m <sup>2</sup>
Cajones de estacionamiento		
Porcentaje de Área Ajardinada	m <sup>2</sup>	m <sup>2</sup>

**CUADRO DE CARGAS**

	ENTREPISO	CUBIERTA
CARGAS VIVAS	200 Kg/m <sup>2</sup>	120 Kg/m <sup>2</sup>
CARGAS MUERTAS	400 Kg/m <sup>2</sup>	380 Kg/m <sup>2</sup>
CARGAS TOTALES	600 Kg/m <sup>2</sup>	500 Kg/m <sup>2</sup>

**UBICACION**

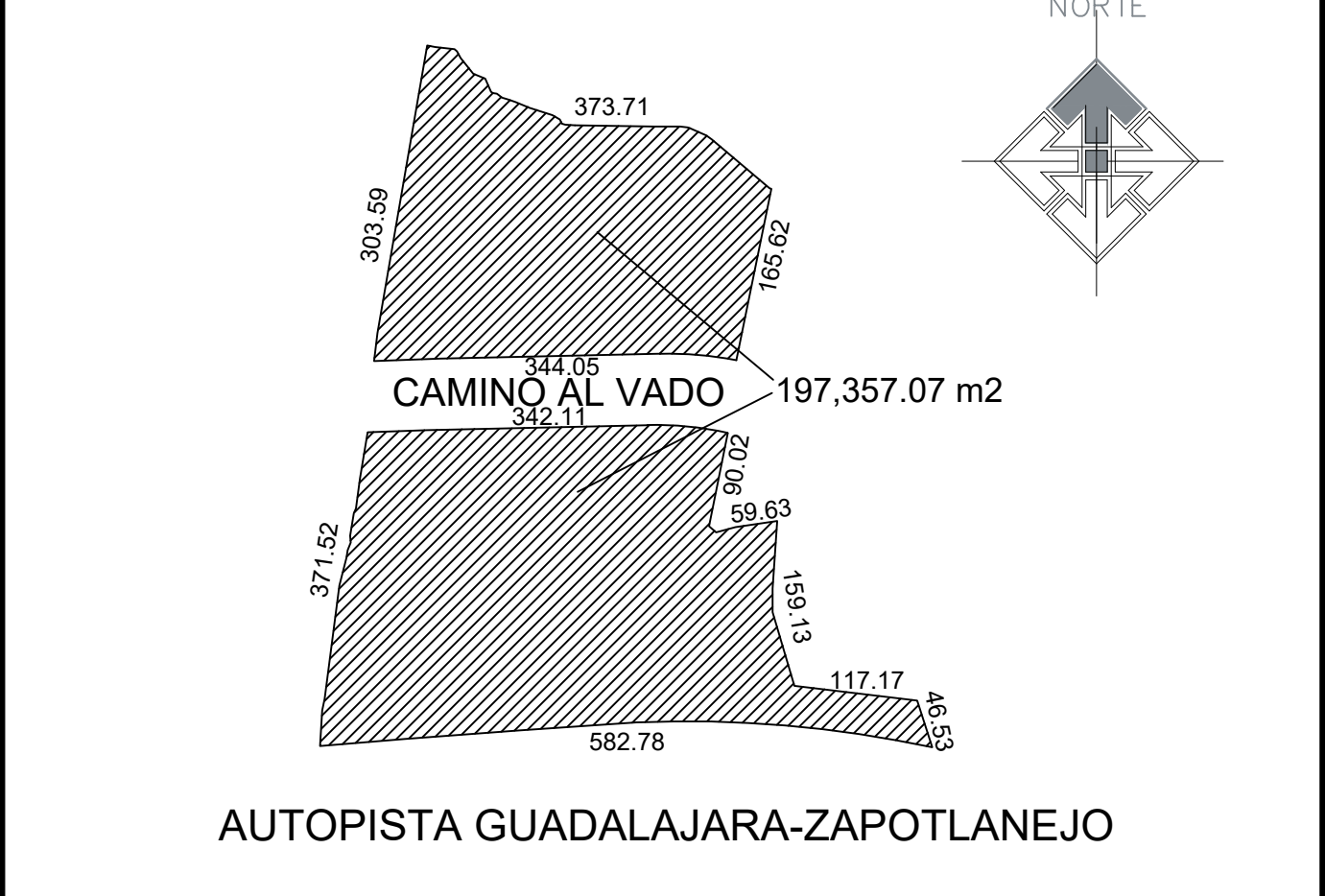

**SELLOS**

**PROPIETARIO**

Ubicación: CAMINO AL VADO S/N., COL. LOS ENCINOS, TONALA JALISCO  
 Manzana: \_\_\_\_\_ Lote: \_\_\_\_\_  
 Tipo de Obra: \_\_\_\_\_  
 Nombre: TERMOPOLAR S.A. DE C.V. / JUAN MENDOZA ALVAREZ  
 Firma: \_\_\_\_\_

**DIRECTOR RESPONSABLE DE OBRA LAMINA**

Nombre: ARO. PEDRO R. GOMEZ GUTIERREZ  
 Registro: TN-OU/815/2004  
 Firma: \_\_\_\_\_  
 Fecha: SEPTIEMBRE DEL 2024  
 Escala: 1 : 1000

COORDENADAS U.T.M.  
 PROYECCION: UTM ZONA NORTE\_13  
 DATUM: ITRF 2008

**CUADRO DE CONSTRUCCION**

LADO EST	PV	RUMBO	DISTANCIA	V	X	Y
1	2	S 24°20'11.86" W	85.0	2,280,553.1970	690,117.2751	
2	3	S 30°43'39.89" E	9.0	2,280,475.7288	690,082.2372	
3	4	N 88°01'17.62" E	18.9	2,280,469.1355	690,106.5320	
4	5	S 89°24'59.31" E	40.1	2,280,465.9227	690,146.5423	
5	6	S 16°37'55.33" W	63.9	2,280,404.7704	690,127.8865	
6	7	S 12°14'53.55" W	22.5	2,280,382.8250	690,121.1228	
7	8	S 02°32'39.76" E	72.7	2,280,352.2277	690,121.6181	
8	9	S 70°14'16.94" E	117.2	2,280,270.6098	690,237.8917	
9	10	S 00°10'40.45" E	46.5	2,280,224.2711	690,242.0908	
10	12	N 72°22'19.92" W	281.2	2,280,359.4061	689,974.1167	
		CENTRO DE CURVA BETA = 144°25'58"				
		RADIO = 1,200.0				
		LONG. CURVA = 281.9				
		SUB-TANG = 68.7				
12	13	N 81°00'01.41" W	110.8	2,280,326.7340	689,864.7272	
13	14	N 81°30'26.26" W	109.3	2,280,342.8785	689,756.6077	
14	15	N 81°47'31.41" W	86.8	2,280,354.4099	689,676.6625	
15	16	N 16°15'50.69" E	33.9	2,280,386.9227	689,686.1458	
16	17	N 20°15'44.08" E	11.1	2,280,396.9813	689,690.8460	
17	18	N 20°11'23.05" E	108.5	2,280,498.8058	689,728.2894	
18	19	N 27°25'13.91" E	27.0	2,280,522.7792	689,743.7289	
19	20	N 20°16'48.70" E	7.3	2,280,520.6099	689,743.3664	
20	21	N 34°15'46.68" E	7.6	2,280,535.9292	689,747.6718	
21	22	N 09°37'55.66" E	6.6	2,280,542.4571	689,748.7784	
22	23	N 22°14'34.34" E	21.5	2,280,562.3459	689,756.9129	
23	24	N 30°37'35.46" E	4.9	2,280,569.2093	689,760.7421	
24	25	N 20°16'52.37" E	28.7	2,280,593.1986	689,769.6831	
25	26	N 22°19'21.06" E	39.3	2,280,629.5787	689,784.6169	
26	28	N 22°19'21.06" E	15.3	2,280,644.7461	689,790.4369	
28	29	N 79°19'58.87" W	9.4	2,280,648.4801	689,791.2042	
29	30	N 20°16'48.70" E	15.2	2,280,659.7646	689,786.4370	
30	31	N 20°17'48.52" E	21.6	2,280,680.0254	689,793.8641	
31	32	N 22°37'25.11" E	276.9	2,280,935.6533	689,900.3955	
32	33	S 62°42'58.93" E	7.8	2,280,932.4368	689,907.5292	
33	34	S 70°16'16.17" E	14.4	2,280,926.2119	689,924.8980	
34	35	S 33°59'53.96" E	2.9	2,280,923.8255	689,928.4975	
35	36	S 17°30'20.64" E	7.3	2,280,916.8818	689,928.7140	
36	37	S 22°19'21.06" E	18.9	2,280,899.7498	689,936.8114	
37	38	S 84°55'56.30" E	12.5	2,280,892.5808	689,941.0241	
38	39	S 101°18'58" E	13.6	2,280,879.1584	689,949.4606	
39	40	S 45°04'48.53" E	3.1	2,280,877.6735	689,950.9467	
40	41	S 68°09'52.46" E	4.0	2,280,876.1950	689,954.6271	
41	42	S 38°57'35.78" E	6.2	2,280,871.3907	689,956.5833	
42	43	S 62°12'20.39" E	6.1	2,280,868.9772	689,953.8704	
43	44	S 57°53'48.43" E	7.2	2,280,864.7419	689,949.9837	
44	45	S 50°54'37.84" E	14.4	2,280,856.4792	689,981.8179	
45	46	S 59°18'05.05" E	22.8	2,280,844.8285	690,001.4411	
46	47	S 44°03'59.97" E	8.1	2,280,839.2119	690,028.9543	
47	48	S 12°13'37.82" E	4.6	2,280,834.8069	690,028.4098	
48	49	S 58°01'37.37" E	3.3	2,280,833.1233	690,011.2148	
49	50	S 74°03'37.12" E	9.1	2,280,830.6232	690,011.9669	
50	51	S 76°12'31.97" E	79.4	2,280,819.6187	690,028.1673	
51	52	S 77°31'58.11" E	24.5	2,280,807.5919	690,117.0794	
52	53	S 68°59'48.52" E	7.3	2,280,804.7655	690,124.9203	
53	54	S 61°47'24.51" E	2.5	2,280,803.5703	690,126.1484	
54	55	S 52°37'16.84" E	16.6	2,280,793.6814	690,131.4341	
55	56	S 41°38'54.73" E	6.4	2,280,788.8982	690,143.6913	
56	57	S 36°52'4.59" E	71.7	2,280,731.5518	690,186.7024	
57	58	S 51°24'03.06" E	1.8	2,280,730.4308	690,188.1067	
58	59	S 24°20'11.86" W	160.6	2,280,584.0902	690,121.9142	
59	60	S 24°20'11.86" W	150.0	2,280,515.4127	690,115.7350	
60	62	S 65°02'36.49" E	4.5	2,280,566.8667	690,123.4577	
		CENTRO DE CURVA BETA = 97°26'46.1"				
		RADIO = 322.5				
		LONG. CURVA = 4.3				
		SUB-TANG = 4.3				
62	1	S 24°20'11.86" W	150.0	2,280,553.1970	690,117.2751	

SUPERFICIE = 204,216.713 m<sup>2</sup>

SUPERFICIE TOTAL DE LOTES	131,986.27 M <sup>2</sup>	66.97 %
SUPERFICIE TOTAL LOTE COMERCIAL	644.39 M <sup>2</sup>	0.33 %
SUPERFICIE TOTAL VIALIDADES	27,620.34 M <sup>2</sup>	13.87 %
SUPERFICIE TOTAL AREAS VERDES	5,023.56 M <sup>2</sup>	2.47 %
SUPERFICIE TOTAL AREAS AFECTACION ARROYO	6,426.10 M <sup>2</sup>	3.36 %
SUPERFICIE TOTAL AREAS DONACION	25,656.41 M <sup>2</sup>	13.00 %
SUPERFICIE TOTAL DEL PREDIO	197,357.07 M <sup>2</sup>	100 %

- LIMITE DE PROPIEDAD
- LINDEROS DE FRACCIONES
- AREAS VERDES
- AREA DE DONACION
- AREA AFECTACION ARROYO

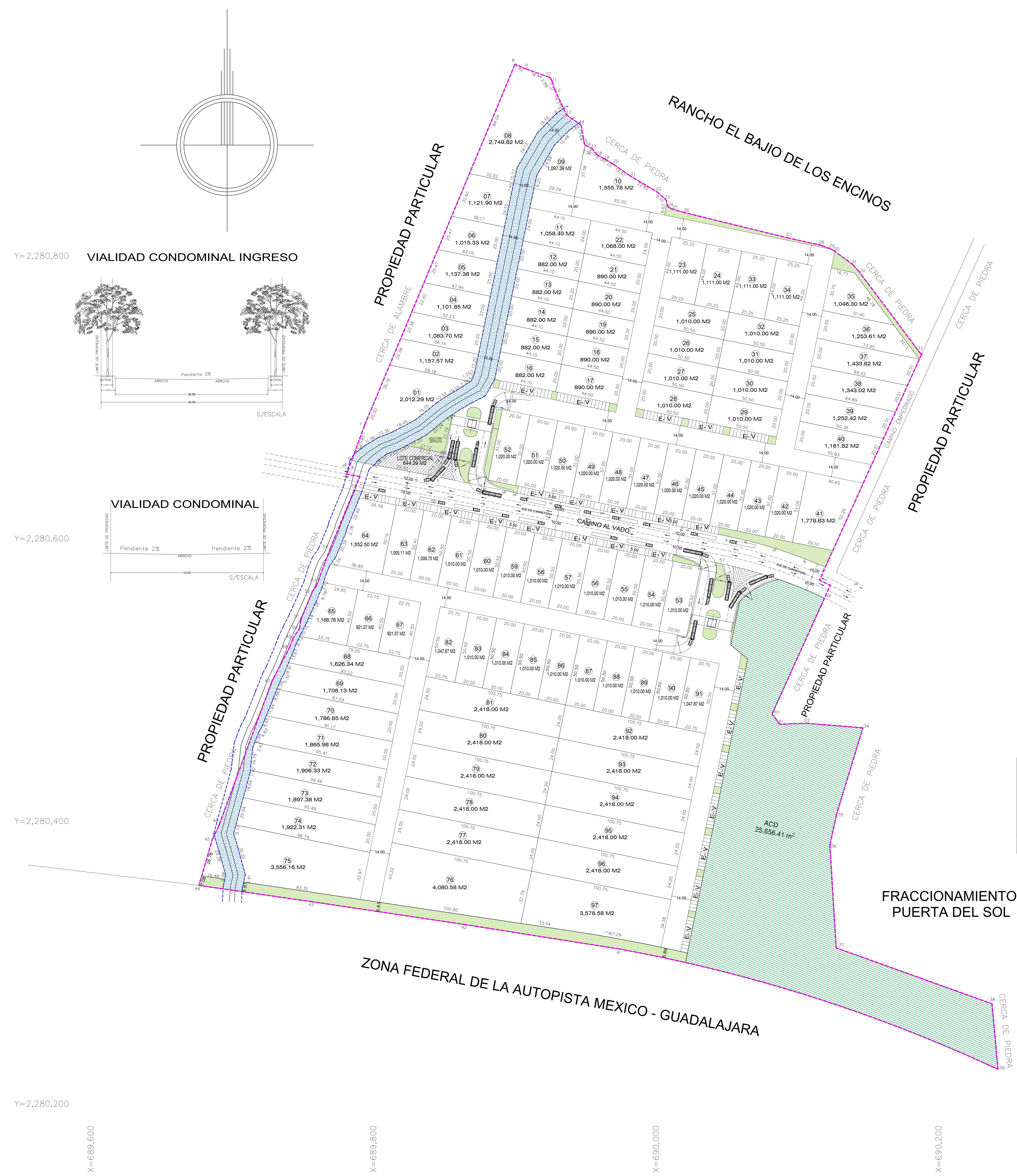

Y=2,280,800 VIALIDAD CONDOMINIAL INGRESO

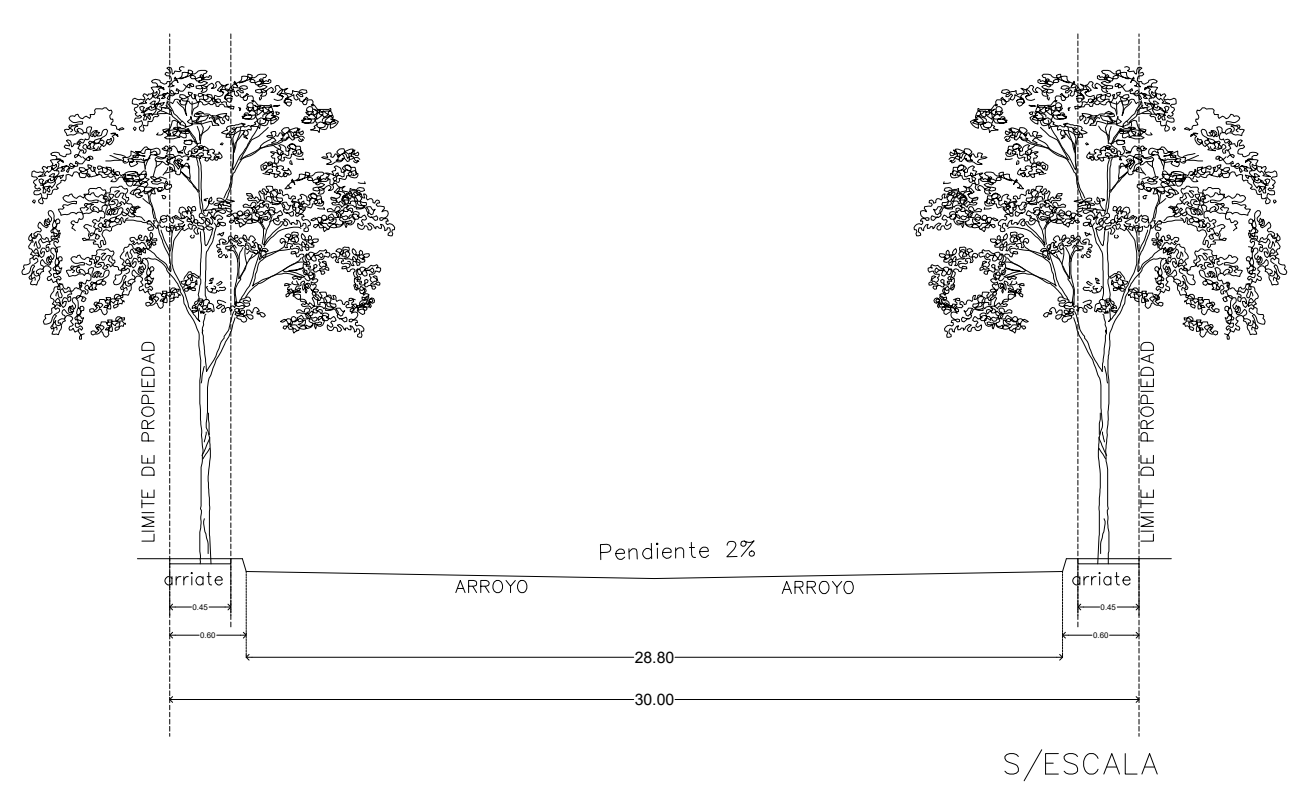

Y=2,280,600 VIALIDAD CONDOMINIAL

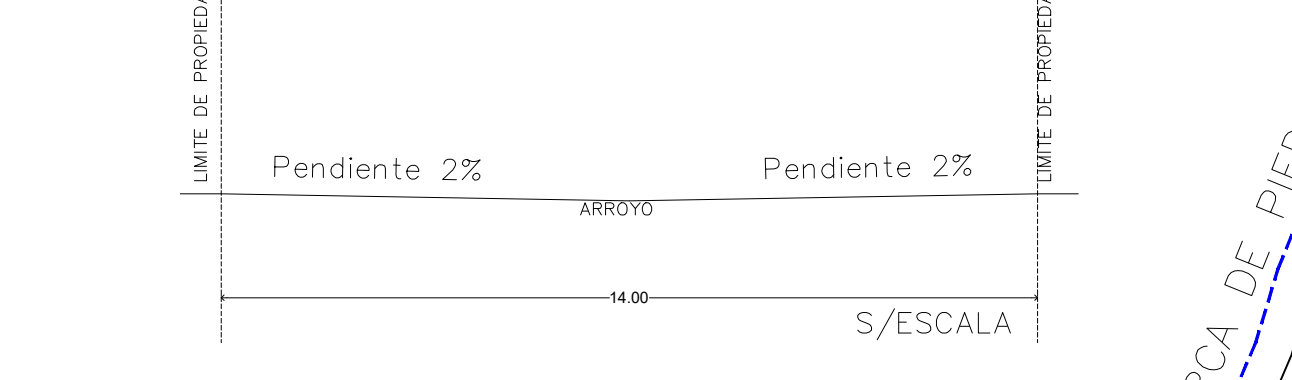

Y=2,280,400

Y=2,280,200

X=689,600

X=689,800

X=690,000

X=690,200

X=690,400