

INSTRUCTION MANUAL

Cardans

READ
CAREFULLY





Read the operating instruction as specified in the operation manual carefully before the use of this drive shaft.



Danger! The rotating drive shaft may result in injury or even death. Please keep a proper safe distance! ***Never wear loose clothes and jewelries or have the hair unbound while operating the drive shaft, so as to avoid the drive system from being twined.

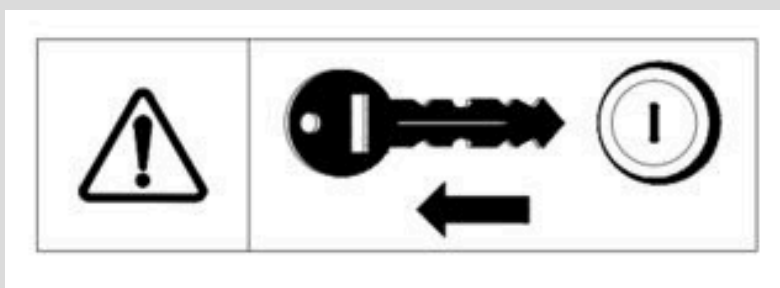

Disconnect the drive shaft. Before the maintenance, make sure that the tractor engine is shut off and pull out the start key.



Prohibition of use

- The drive shaft without protective cover;
- The drive shaft not fully protected by the protective cover;
- The drive shaft with the damaged protective cover.

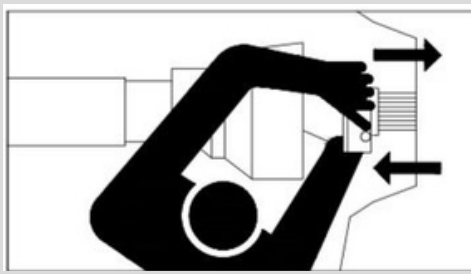

After the installation of the drive shaft, it is required to check:

- 1. Whether the motive direction of the drive shaft is correct;**
- 2. Both ends of the drive shaft are fixed and safe;**
- 3. The safety chain of the protective cover is firmly linked onto the tractor and tool equipment, to ensure that the drive shaft will not rotate with the fixed protective cover.**

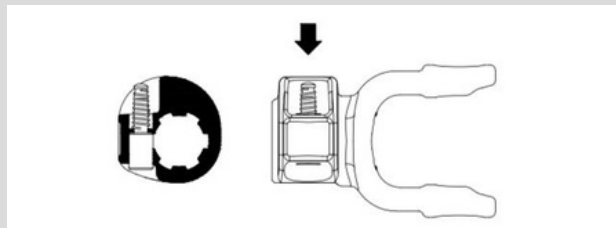

Push away the lock pin on the joint fork, nest the joint fork onto the output drive shaft of the tractor, snap the lock pin into the groove of the output drive shaft, to ensure that the lock pin springs back to the original position.

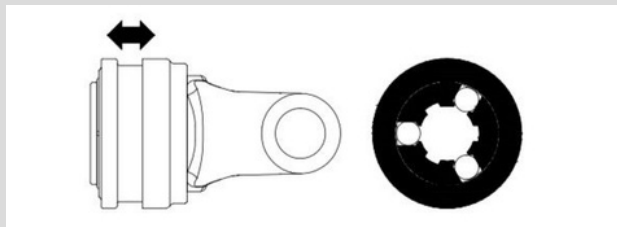

Push the sliding sleeve on the joint fork, nest the joint fork onto the output drive shaft of the tractor, loosen the sliding sleeve, push the joint fork till the steel ball snaps into the groove of the output drive shaft, and the sliding sleeve returns to the original position.



Never stand on the drive shaft. Never tread on or go across the drive shaft.

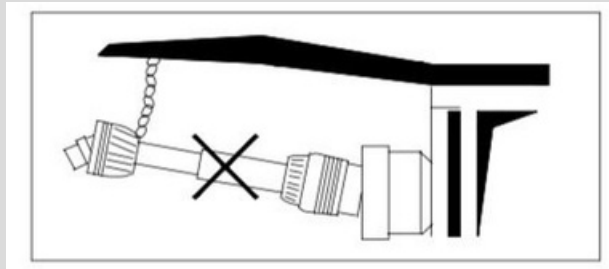

The safety chain of the drive shaft is used to fix the protective cover, to prevent the rotation of the protective cover. Never hang the drive shaft assembly by the safety chain.

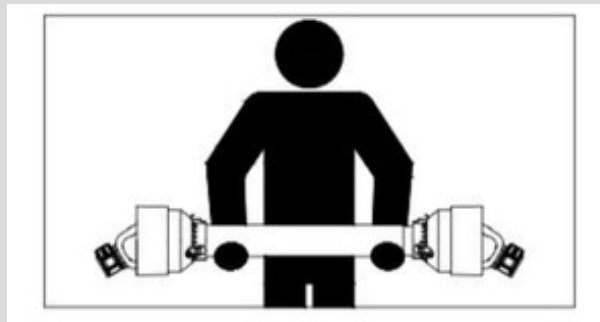

When handling the drive shaft, keep it horizontal, to prevent the inner and outer tubes of the drive shaft from sliding and separating, and avoid damage to the drive shaft and injury to persons due to its falloff.

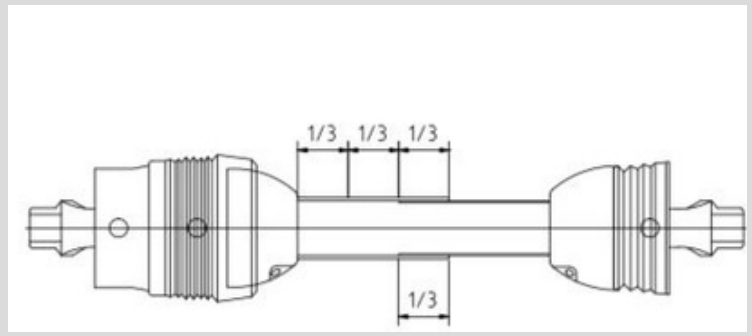
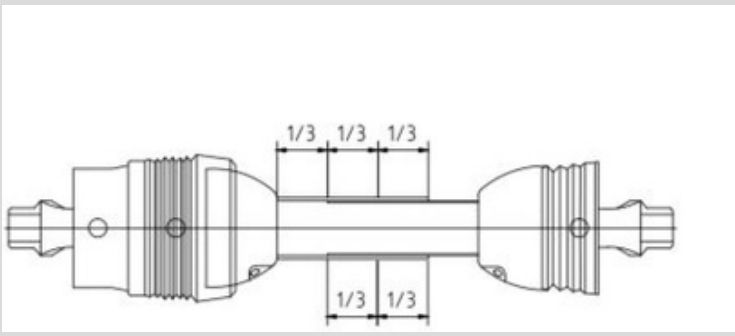

Before the work of the drive shaft, it is required to pay attention to the length of the lapping part for the inner and outer linking shaft tubes, and the recommended length and the minimum allowable safety operation length are respectively $2/3$ and $1/3$ of that of the shaft tube.

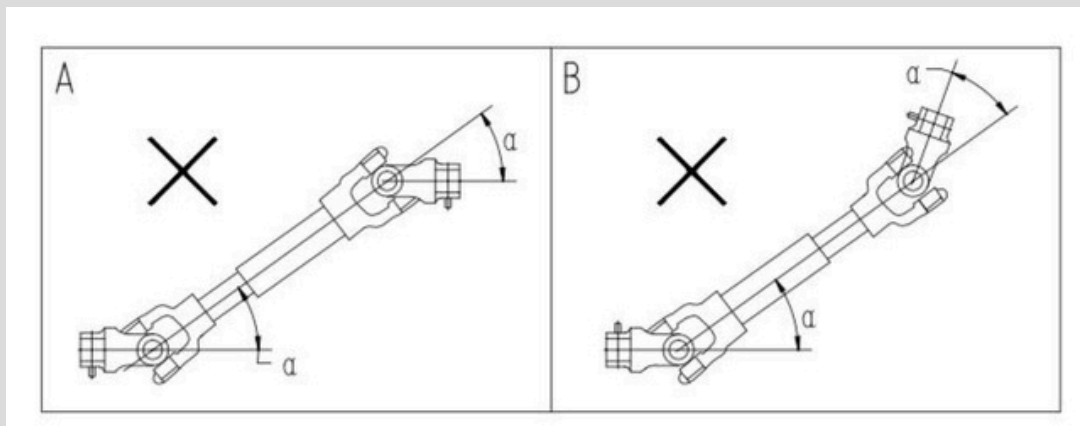

Allowable working angle of the conventional drive shaft:

1. During the work, it is required to avoid the contact of the protective device of the drive shaft with the rotating components;
2. Reduce the big-angle working time. In case of exceeding the allowable working angle, it will result in premature wear of and damage to the drive shaft;
3. No work is allowed in the bending angle of A and B in the drawing.

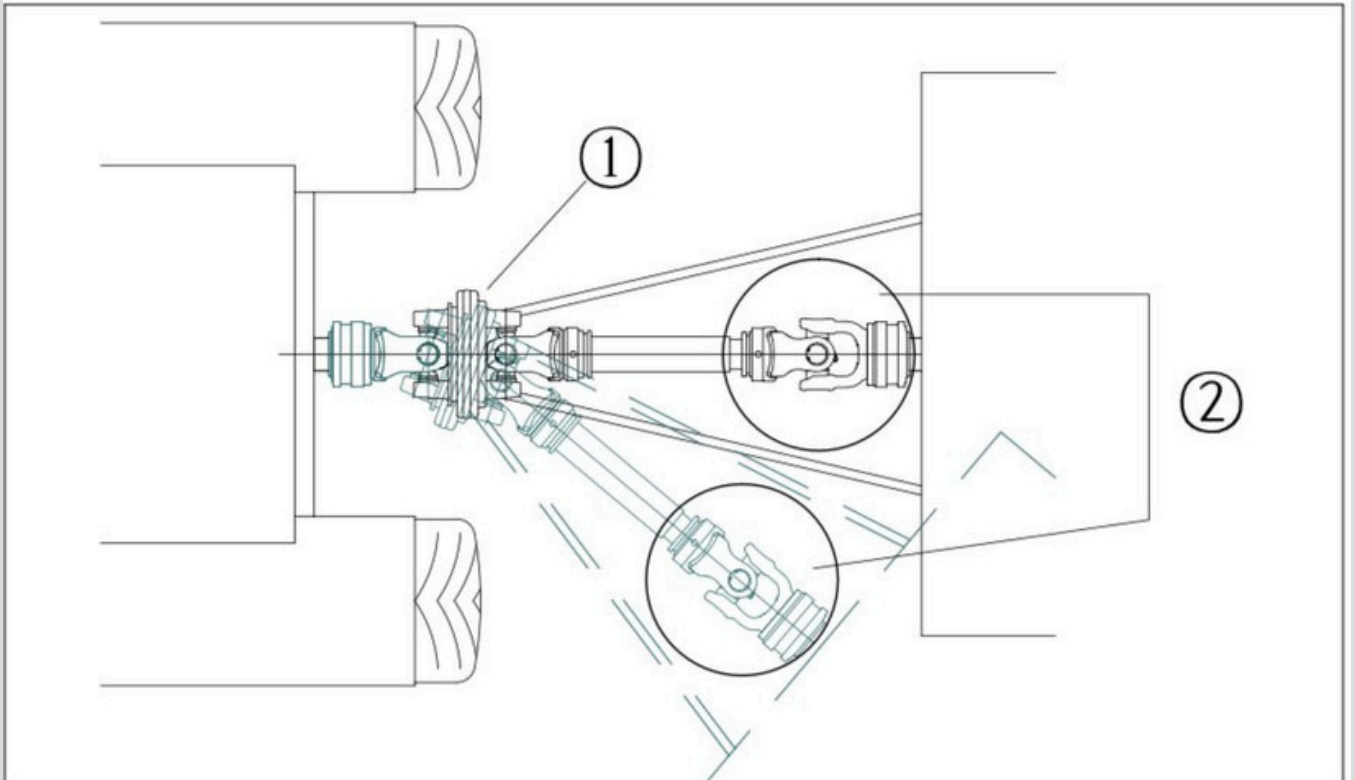

Allowable working angle of the wide-angle drive shaft:

- 1. During the work, it is required to avoid the contact of the protective device of the drive shaft with the rotating components;**
- 2. Reduce the big-angle working time. In case of being beyond the allowable working angle, it will result in premature wear and damage to the drive shaft**
- 3. Either during the operation or in the stop status, the bending angle of the wide-angle joint might be over**
- 4. For the drive shaft with wide-angle joint, the pivoting point between the tractor and the tool shall be equal to the pivoting point of the wide-angle joint;**
- 5. For the drive shaft with wide-angle joint, the single joint linked with the universal joint shall run linearly.**

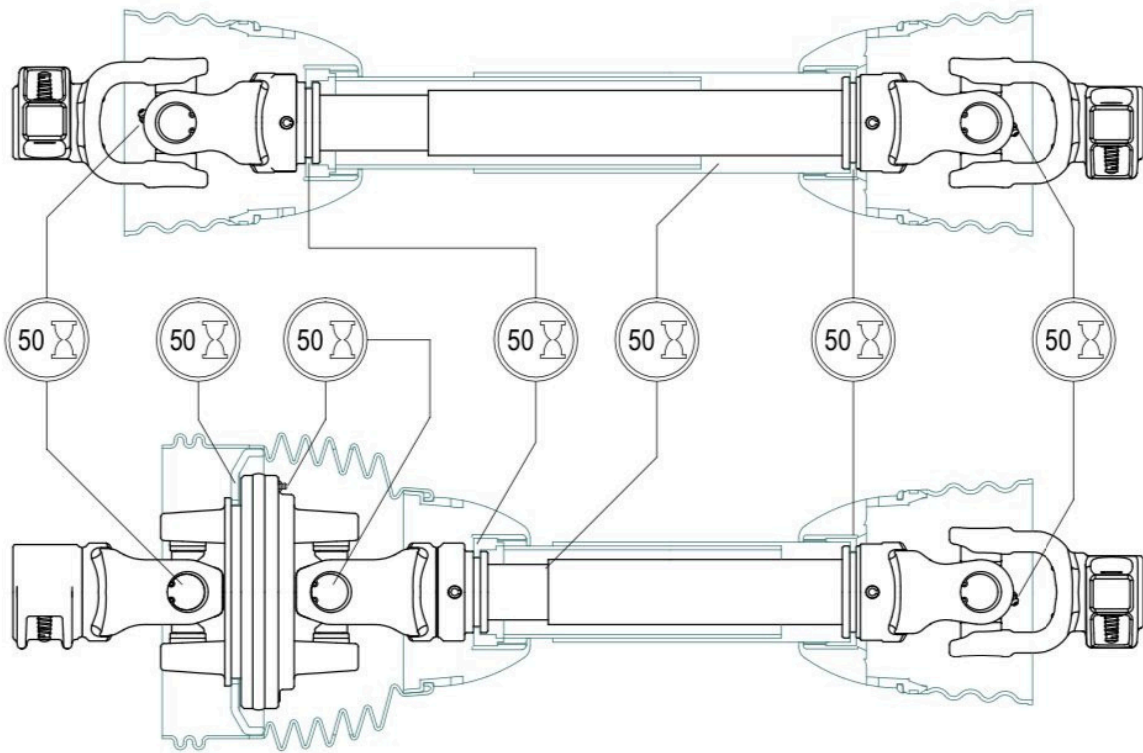

Servicing and maintenance of PTO drive shaft Type of the lubricating grease: extreme pressure composite lithium-based lubricating grease; Consistency class of the lubricating grease: NLGI2; The lubrication maintenance zone and the lubricating period are shown in the diagram.

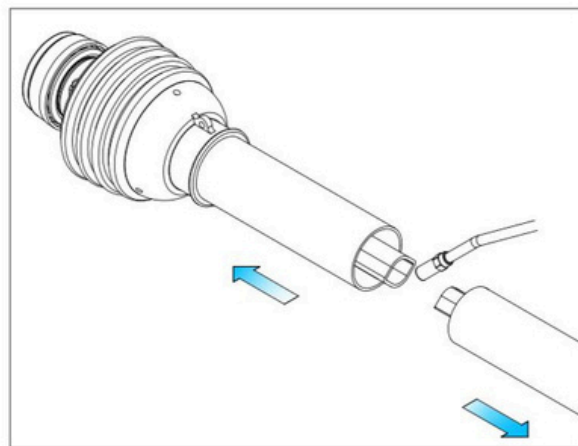

When there is no grease fitting at the linking shaft tube of the drive shaft, it is required to pull off the inner and outer tubes, and apply straightly the lubricating grease onto the inner wall of the outer tube.

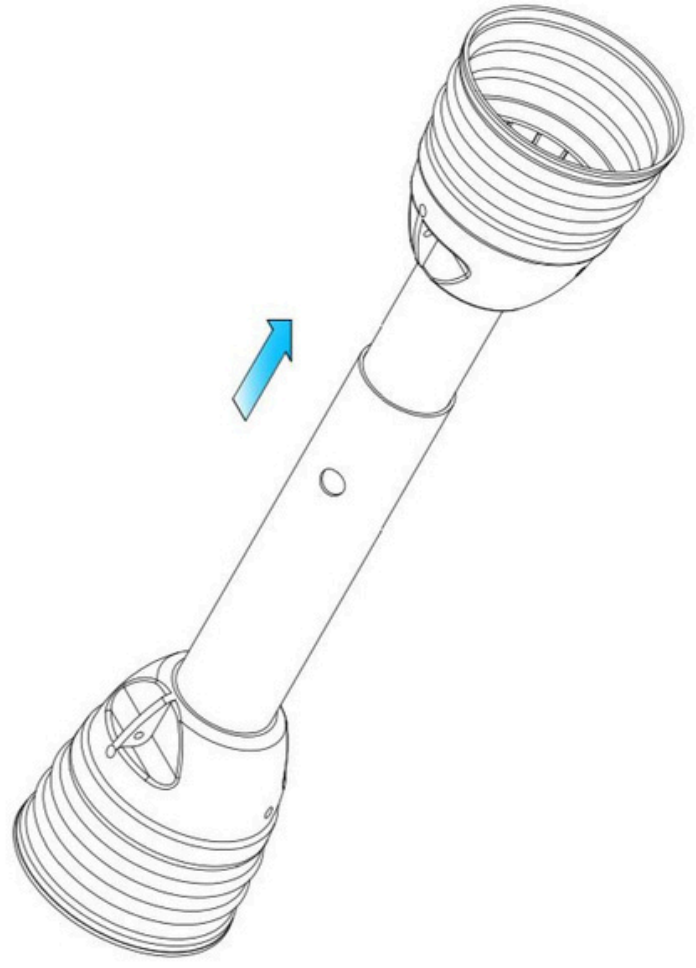
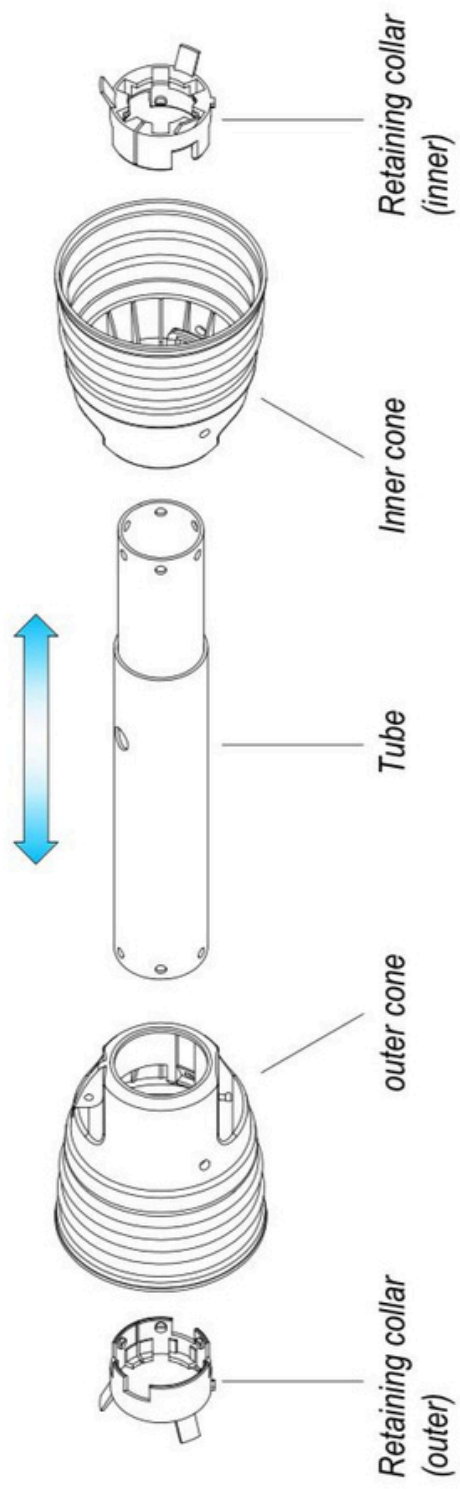



Protective cover disassembly steps.

Insert the screwdriver into the hole, and pull away three barbs in the support frame.

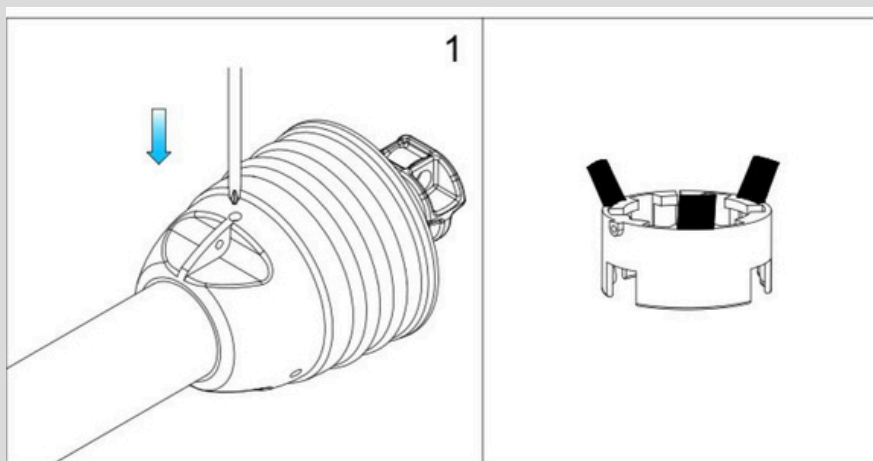

Separate and push out the sleeve.

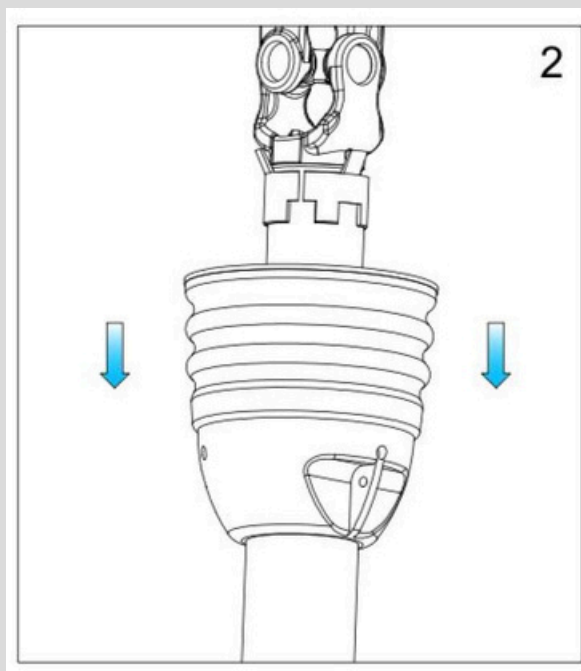

Open the metal ring.

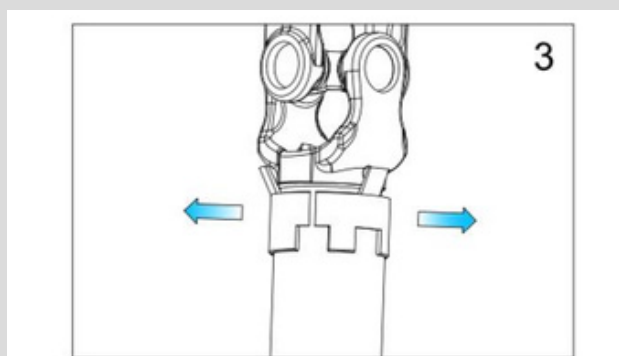



Unthread tube - metal ring.

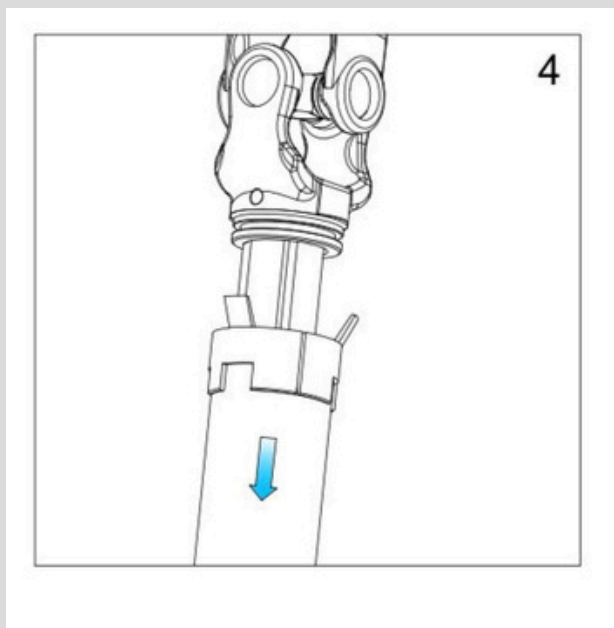

Take off the metal ring from the tube.

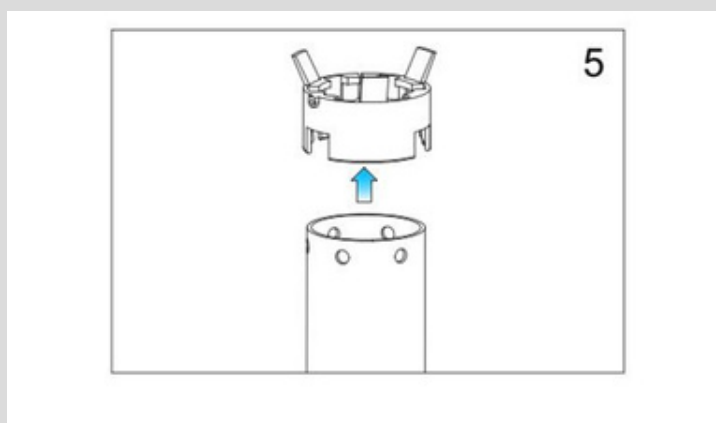

Protective cover installation steps.

Apply the lubricating grease in the joint fork slot.

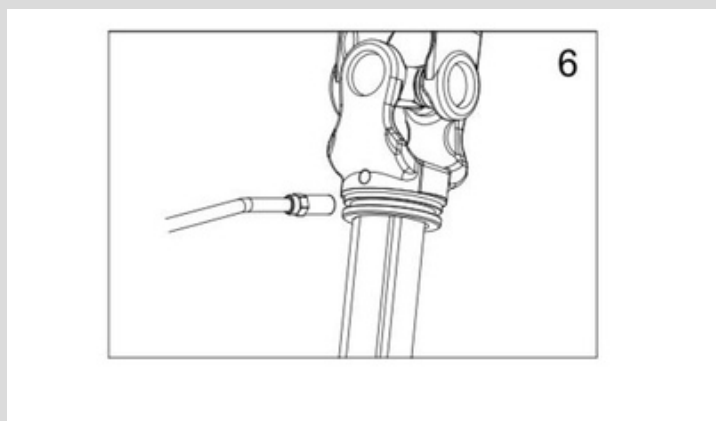



Fit the ring nut.

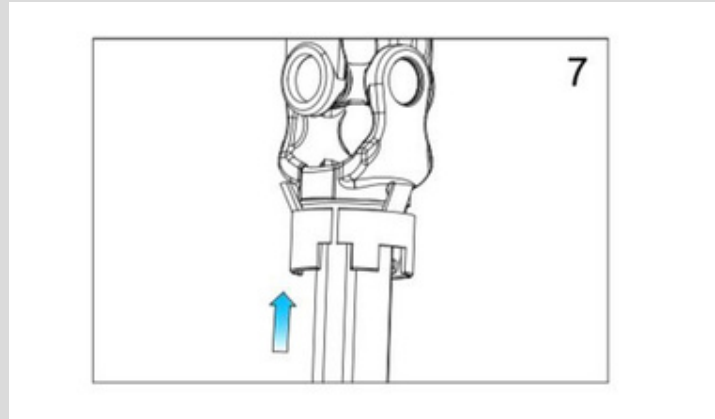

Assemble the protection tube.

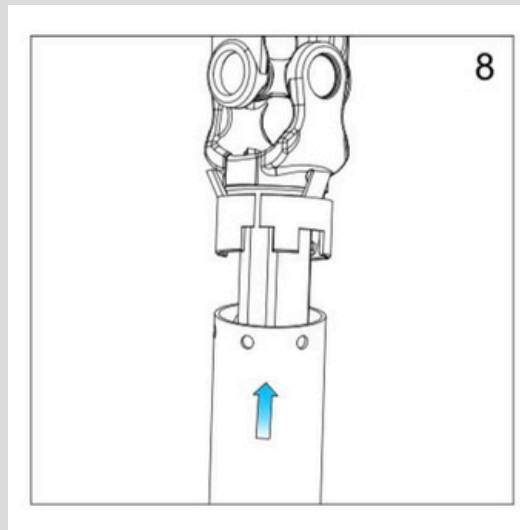

Thread the casing.

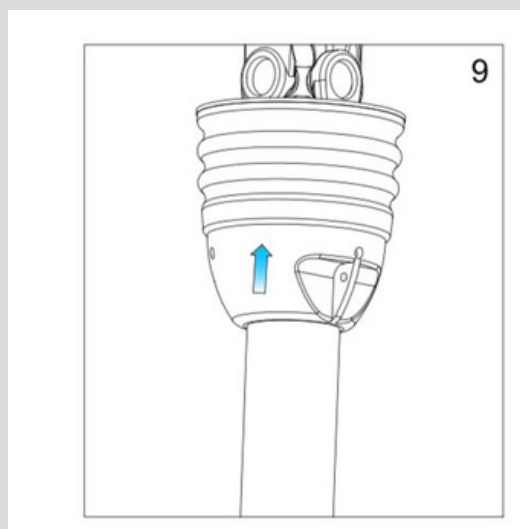



Push powerfully to hook it.

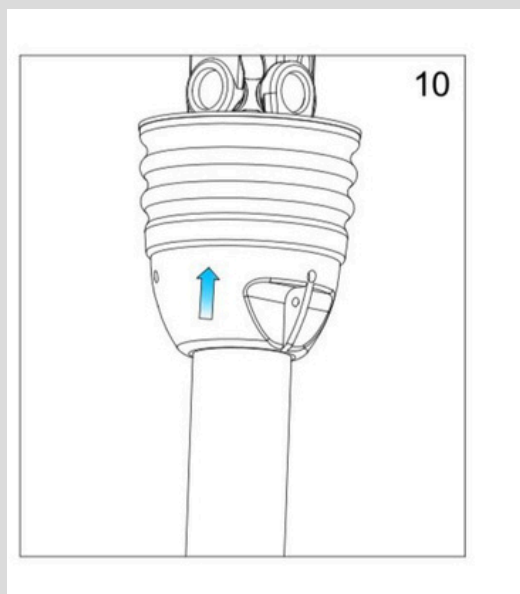

Push the sleeve forcibly, and check whether it is firmly linked.

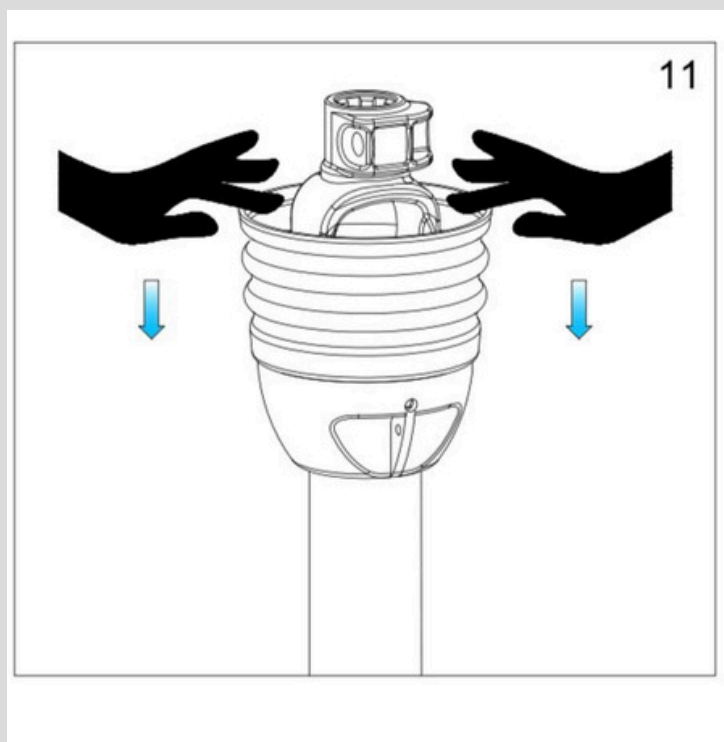

CONTACT US

Rod. Pista Lateral Br-116, 495 - Tres Portos, Esteio - RS

Phone +555134542004

<https://www.bebagroparts.com/>

email: comercial@bebagroparts.com.br

