

| PARTS LIST | | |
|------------|-----|--------------------------|
| ITEM | QTY | DESCRIPTION |
| 1 | 1 | XL1.0 SWIVEL MODULE ASSY |
| 2 | 1 | SEAL BLOCK, PTFE |
| 3 | 2 | PRODUCT SEAL O-RING |
| 4 | 2 | XL1.0 SWIVEL FLANGE |
| 5 | 1 | SCH 40 LR 90 ELBOW |
| 6 | 2 | SCH 40 RF WN FLANGE |

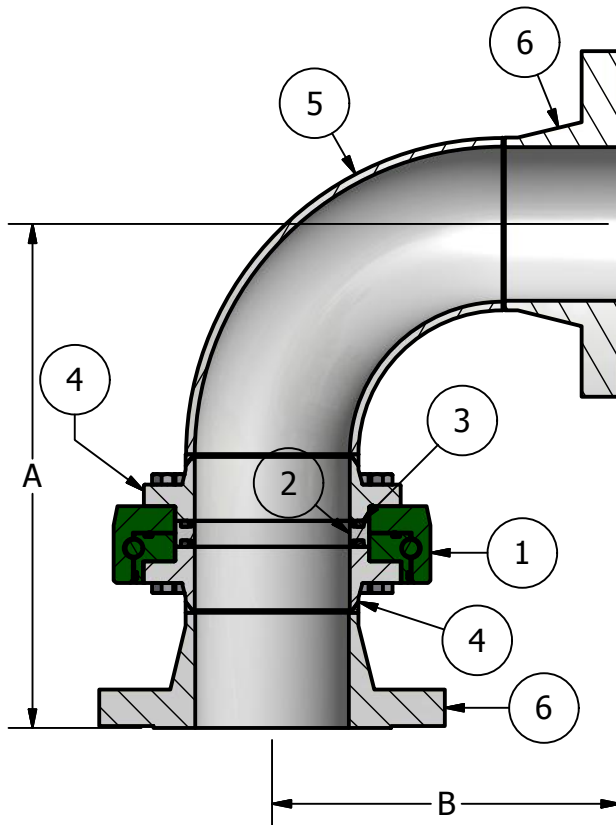

SECTION A-A
SCALE 1 / 5

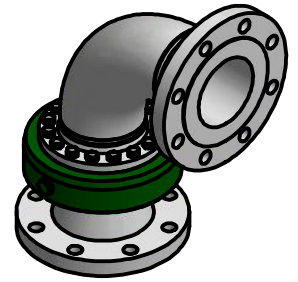
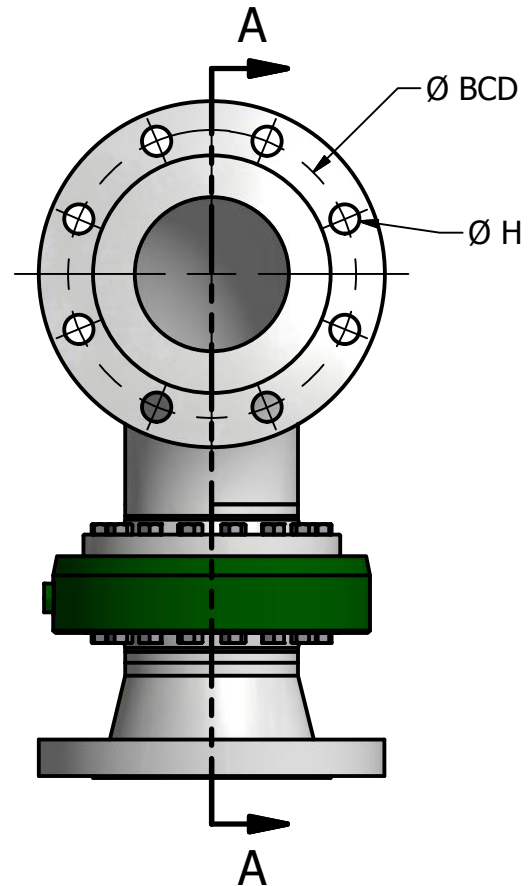

WETTED MATERIALS:

- CARBON STEEL
- 316L STAINLESS STEEL
- 304L STAINLESS STEEL
- OTHERS BY REQUEST

SEAL MATERIAL:

- BUNA
- VITON
- FEP
- EPDM

| PART NUMBER | SIZE | A | B | BCD | H (QTY) | CONN TYPE |
|---------------------|------|--------|---------|-------|---------|-----------|
| S30XL1.02 _ _ 15X15 | 2" | 9 5/8 | 5 9/16 | 4 3/4 | 3/4 (4) | 150 # |
| S30XL1.02 _ _ 30X30 | 2" | 9 7/8 | 5 13/16 | 5 | 3/4 (4) | 300 # |
| S30XL1.03 _ _ 15X15 | 3" | 11 3/8 | 7 5/16 | 6 | 3/4 (4) | 150 # |
| S30XL1.03 _ _ 30X30 | 3" | 11 3/4 | 7 11/16 | 6 5/8 | 7/8 (8) | 300 # |
| S30XL1.04 _ _ 15X15 | 4" | 13 1/8 | 9 1/16 | 7 1/2 | 3/4 (8) | 150 # |
| S30XL1.04 _ _ 30X30 | 4" | 13 1/2 | 9 7/16 | 7 7/8 | 7/8 (8) | 300 # |

STYLE 30 FLANGED
XL1.0 SWIVEL

