

Phantom 12



CE F IP20 $t_a 40^{\circ}\text{C}$ $t_c 100^{\circ}\text{C}$

User Manual

KEEP THIS MANUAL FOR FUTURE NEEDS

1 SAFETY INSTRUCTIONS



CAUTION

Be careful with your operations. With a dangerous voltage you can suffer a Dangerous electric shock when touching wires!

This device has left the factory in perfect condition. In order to maintain this condition and to ensure a safe operation, it is absolutely necessary for the user to follow the safety instructions and warning notes written in this user manual.



IMPORTANT

Damages caused by the disregard of this user manual are not subject to warranty. The dealer will not accept liability for any resulting defects or problems.

If the device has been exposed to temperature changes due to environmental changes, do not switch it on immediately. The arising condensation could damage the device. Leave the device switched off until it has reached room temperature.

This device falls under protection-class I. Therefore it is essential that the device be earthed.

The electrical connection must be carried out by a qualified person.

The device shall only be used with the rated voltage and frequency.

Make sure that the available voltage is not higher than stated at the end of this manual.

Make sure the power cord is never crimped or damaged by sharp edges. If this would be the case, replacement of the cable must be done by an authorised dealer.

Always disconnect from the mains, when the device is not in use or before cleaning it. Only handle the power cord by the plug. Never pull out the plug by tugging the power cord.

During initial start-up some smoke or smell may arise. This is a normal process and does not necessarily mean that the device is defective, it should decrease gradually.

Please don't project the beam onto combustible substances.

Fixtures cannot be installed on combustible substances, keep more than 50cm distance with wall for smooth air flow, so there should be no shelter for fans and ventilation for heat radiation.

If the external flexible cable or cord of this luminaire is damaged, it shall be exclusively replaced by the manufacturer or his service agent or a similar qualified person in order to avoid a hazard.

8 MAINTENANCE AND CLEANING

The following points have to be considered during the inspection:

- 1) All screws for installing the devices or parts of the device have to be tightly connected and must not be corroded.
- 2) There must not be any deformations on the housing, colour lenses, fixations and installation spots (ceiling, suspension, trussing).
- 3) Mechanically moving parts must not show any traces of wearing and must not rotate with unbalances.
- 4) The electric power supply cables must not show any damage, material fatigue or sediments.

Further instructions depending on the installation spot and usage have to be adhered by a skilled installer and any safety problems have to be removed.



CAUTION

Disconnect from mains before starting maintenance operation.

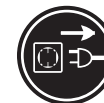

In order to make the lights in good condition and extend the life time, we suggest a regular cleaning to the lights.

- 1) Clean the inside and outside lens each month to avoid the dulling of the lights due to accumulation of dust.
- 2) Clean the fan each month.
- 3) A detailed electric check by an approved electrician each three month, make sure that the circuit contacts are in good condition, to prevent circuit from overheating.

We recommend a frequent cleaning of the device. Please use a moist, lint-free cloth. Never use alcohol or solvents.

There are no serviceable parts inside the device. Please refer to the instructions under "Installation instructions".

Should you need any spare parts, please order genuine parts from your local dealer.

11	LED Green	0 - 255	
12	LED Blue	0 - 255	
13	LED White	0 - 255	
14	Color temp.	0 - 255	
15	Effect	0 - 255	
16	Effect speed	0 - 255	
17	LED strip dimming	0 - 255	
18	LED strip strobe	0 - 255	
19	LED strip red.	0 - 255	
20	LED strip green.	0 - 255	
21	LED strip is blue.	0 - 255	
22	LED strip effect	0 - 255	
23	LED strip effect speed	0 - 255	
24	324 dimming	0 - 255	
25	324 strobe	0 - 3	
		4 - 103	
		104 - 107	
		108 - 207	
		208 - 212	
		213 - 225	
		226 - 238	
		239 - 251	
		252 - 255	
26	Warm White 1	0 - 255	
27	Cold White 1	0 - 255	
28	Warm White 2	0 - 255	
29	Cold White 2	0 - 255	
30	Warm White 3	0 - 255	
31	Cold White 3	0 - 255	
32	Warm White 4	0 - 255	
33	Cold White 4	0 - 255	
34	Warm White 5	0 - 255	
35	Colour temperature	0 - 255	
36	Effect	0 - 255	
37	Effect speed	0 - 255	
38	Reset	0 - 255	

2 UNPACKING

The DOUBLE-SIDED designed Phantom 12 is an ultra compact and light weight stylish moving head WASH+STROBE light (2 Faces). Face 1 features 7*12W 4-IN-1 RGBW LEDs+60*0.2W 3-IN-1 RGB LEDs. It provides 2800K-5600K colour temperature adjustment. With the unique and creative LED strip that surrounds the main LEDs, it helps to generate complex graphic effects. It can be used alone or in combination with the main LEDs. Face 2 features 324*0.5W 5730 WW+CW LEDs which is designed with 9 individual rings. They also provide 2500K-4600K colour temperature adjustment. The fixture could be used not just only as a wash light (specially moving face light) but also as a remarkable moving strobe light.

It provides 360° continuous fast and smooth PAN/TILT movement with variable speed which delivers even more vivid visual effect to the show. The fixture supports DMX, RDM (Remote Device Management).

It features excellent colour mixing, quiet running and flicker free control. The fixture is built in with different internal dynamic effect with variable speed. The moving head also features optimum optic design that integrates with extremely effective aluminium heat sink system.

The Phantom 12 is designed for applications as concerts, TV studios, banquet halls, bars, pubs, DJ entertainment, ballrooms, etc.

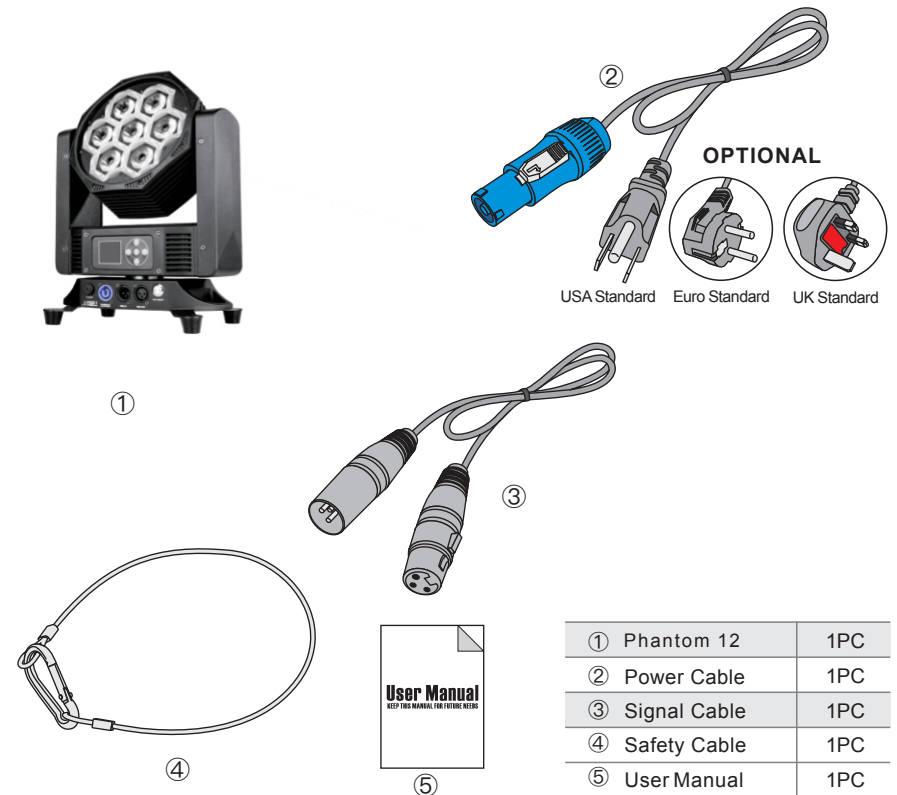

3 FEATURES & SPECIFICATIONS

Face 1:

7*12W 4-IN-1 LEDs(RGBW)

60*0.2W 3-IN-1 LEDs(RGB)

Pixel mapping capability for the exceptional luminaire

Face 2:

324*0.5W 5730 LEDs (WW + CW)

9 Individual control rings (5730 LEDs)

31/ 38 DMX channels USITT DMX-512

DMX512, host, sound or auto operation

RDM available (Remote Device Management)

Art-NET (Optional)

Shielded input signal protection for stable signal without interference

RJ45etherCON IN/OUT (Optional with Art-Net)

3-Pin and 5-pin XLRDMX connectors IN/ OUT

Software up-datable through DMX connectors

Multi units up-datable in daisy chain

1.44" TFT LCD display

5 Control buttons

180°Reversible for LCD display

Display auto OFF

DMX signal and error monitoring indicators

Electronic supply with active PFC

AC100-240V 50/60Hz

PowerCON connectors IN& OUT

340W Power consumption

IP20protection rating

25	324 strobe	0 - 3	
		4 - 103	
		104 - 107	
		108 - 207	
		208 - 212	
		213 - 225	
		226 - 238	
		239 - 251	
		252 - 255	
26	324 Warm white	0 - 255	
27	324 Cold white	0 - 255	
28	324 Colour temp.	0 - 255	
29	324 effect	0 - 255	
30	Effect speed	0 - 255	
31	Reset	0 - 255	

38CH

Channel	Function	Dmx Value	Description
1	Pan 540	0 - 255	
2	Pan540 fine	0 - 255	
3	Tilt 270	0 - 255	
4	Tilt fine	0 - 255	
5	Motor speed	0 - 255	
6	Pan infinite rotation	0 - 255	
7	Tilt infinite rotation	0 - 255	
8	LED Dimmer	0 - 255	
9	LED Strobe	0 - 3	
		4 - 103	
		104 - 107	
		108 - 207	
		208 - 212	
		213 - 225	
		226 - 238	
		239 - 251	
		252 - 255	
Ten	LED Red	0 - 255	

7 DMX CHANNELS

31CH

Channel	Function	Dmx Value	Description
1	Pan 540	0 - 255	
2	Pan fine	0 - 255	
3	Tilt 270	0 - 255	
4	Tilt fine	0 - 255	
5	Motor speed	0 - 255	
6	Pan infinite rotation	0 - 255	0-129 CCW, 130-255 CW
7	Tilt infinite rotation	0 - 255	0-129 back, 130-255 forward
8	LED Dimming	0 - 255	
9	LED Strobe	0 - 3	
		4 - 103	
		104 - 107	
		108 - 207	
		208 - 212	
		213 - 225	
		226 - 238	
		239 - 251	
		252 - 255	
Ten	LED Red	0 - 255	
11	LED Green	0 - 255	
12	LED Blue	0 - 255	
13	LED White	0 - 255	
14	Colour temperature	0 - 255	
15	Effect	0 - 255	
16	Effect speed	0 - 255	
17	LED strip dimming	0 - 255	
18	LED strip strobe	0 - 255	
19	LED strip red.	0 - 255	
20	LED strip green.	0 - 255	
21	LED strip blue.	0 - 255	
22	effect	0 - 255	
23	effect speed	0 - 255	
24	324 LEDs dimming	0 - 255	

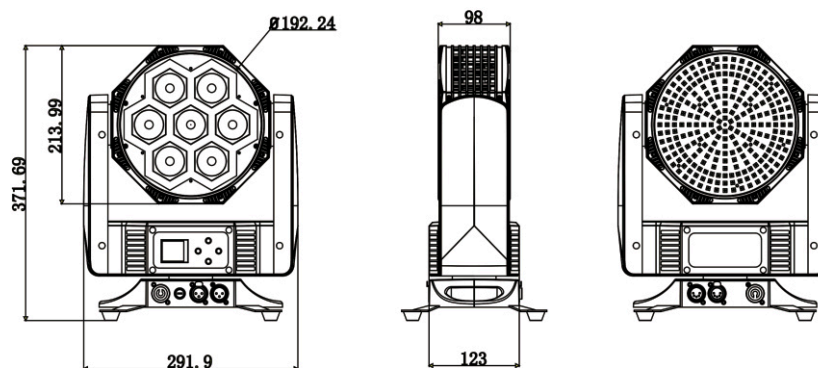

4 PHOTOMETRIC DATA

■ Photometric Beam Angle Data 25° Beam Angle $LUX \times 0.0929 = FC$

R	1700/157	193/18	74/7
G	6850/636	822/76	317/29
B	353/32	43/4	18/2
W	8380/778	1010/94	383/35
RGBW	15830/1470	1940/180	736/68 (LUX)

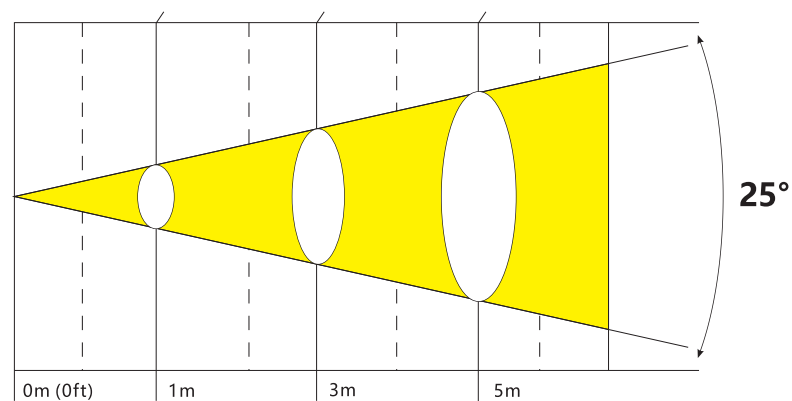

5 DMX-512 CONTROL CONNECTIONS

Connect the provided XLR cable to the female 3-pin XLR output of your controller and the other side to the male 3-pin XLR input of the fixture. You can chain multiple

fixtures together through parallel linking. The cable needed should be two core, screened cable with XLR input and output connectors. Please refer to the diagram below.

DMX-512 connection with DMX terminator.

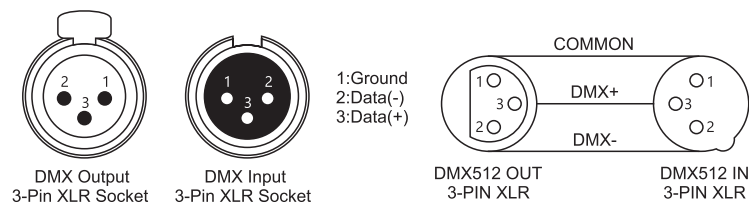

For installations where the DMX cable has to run a long distance or is in an electrically noisy environment, such as in a discotheque, it is recommended to use a DMX terminator. This helps in preventing corruption of the digital control signal by electrical noise. The DMX terminator is simply an XLR plug with a 120 Ω resistor connected between pins 2 and 3, which is then plugged into the output XLR socket of the last fixture in the chain. Please see illustrations below.

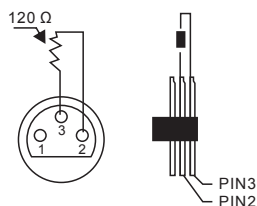

6 MENU OPERATIONS

Main Menu	Second	Third	Fourth
Dmx Address	000 - 512		
Fixture	Dmx Mode	STD / EXT	
	Run Mode	DMX / Host / Sound	
	Pan Invert	Close / Open	
	Tilt Invert	Close / Open	
	No Dmx Signal	Clear / Hold	
	Y Position	000 - 180	
Manual	Sensitivity	00 - 99	
	Mode Dependent		
Information	Time	Current Time	xxxH
		Total Time	xxxH
	Sensor	All Sensors are ok!	
	Temperature	Lamp Temp	xxxC
Factory	Software Version	Panel	Vx.xx
	Password	000 - 255	
	Pan	000 - 255	
Fixture Reset	Tilt	000 - 255	
	All Reset	Off / Run	
	Factory	Off / Run	
Display	Language	CH / EN	
	Display Flip	Off / On	
	Display Mode	60s / Show	