

CEA Information

<u>Subject Item</u>	<u>Description</u>
CEA100026507	The plume is centered around the dispenser island extending from Route 130 to beneath Washington Place. Horizontal delineation complete with a clay/silt bed defining vertical bounds.

<u>Subject Item</u>	<u>Affected Geologic Formation</u>	<u>Vertical Depth</u>
CEA100026507	Pennsauken	30 feet

<u>Subject Item</u>	<u>Classification</u>
CEA100026507	II-A

Contaminants

This CEA/WRA applies only to the contaminants listed in the table below. Pursuant to N.J.A.C. 7:9C-1.6, all constituent standards of the surrounding classification area apply at the CEA perimeter.

<u>Subject Item</u>	<u>Contaminant</u>	<u>Concentration (1)</u>	<u>GWQS (2)</u>
CEA100026507	Benzene	1660 Micrograms Per Liter	1 Micrograms Per Liter
CEA100026507	Bis (2-ethylhexyl) phthalate	5 Micrograms Per Liter	3 Micrograms Per Liter
CEA100026507	Ethylbenzene	2800 Micrograms Per Liter	700 Micrograms Per Liter
CEA100026507	Methyl tert-butyl ether	83.6 Micrograms Per Liter	70 Micrograms Per Liter
CEA100026507	Methylnaphthalene (1-)	100 Micrograms Per Liter	5 Micrograms Per Liter
CEA100026507	Methylnaphthalene (2-)	92.3 Micrograms Per Liter	30 Micrograms Per Liter
CEA100026507	Naphthalene	433 Micrograms Per Liter	300 Micrograms Per Liter
CEA100026507	Synthetic Organic Chemicals - Non-Carcinogen [Total]	8140 Micrograms Per Liter	500 Micrograms Per Liter
CEA100026507	Tert-butyl alcohol	241 Micrograms Per Liter	100 Micrograms Per Liter
CEA100026507	Tetrachloroethylene	1.8 Micrograms Per Liter	1 Micrograms Per Liter
CEA100026507	Toluene	2510 Micrograms Per Liter	600 Micrograms Per Liter
CEA100026507	Trimethylbenzene (1,2,4-)	2450 Micrograms Per Liter	100 Micrograms Per Liter
CEA100026507	Xylenes (total)	10800 Micrograms Per Liter	1000 Micrograms Per Liter

Note: (1) Maximum concentration detected at the time of CEA establishment
 (2) Ground Water Quality Standards

CEA Boundary: Refer to Exhibit B – CEA Boundary Map

Projected Term of CEA:

<u>Subject Item</u> CEA100026507	<u>Date Established</u> 12/1/2021
<u>Subject Item</u> CEA100026507	<u>Duration in Years</u> 34.5
<u>Subject Item</u> CEA100026507	<u>Anticipated Expiration Date</u> 05/24/2056

Well Restrictions set within the boundaries of the CEA

Since groundwater quality data within the CEA indicates exceedance of the Primary Drinking Water Standards, and the primary designated uses of Class II-A ground water is the provision of potable water supply, the CEA established for this site is also a Well Restriction Area, pursuant to N.J.A.C. 7:9C-1.6(d). The extent of Well Restriction shall coincide with the boundaries of the CEA unless otherwise specified.

<i>Subject Item</i>	<i>Restriction</i>
CEA100026507	Double Case Wells: With the exception of monitoring wells installed into the first water bearing zone, any proposed well to be installed within the CEA/WRA boundary shall be double cased to an appropriate depth in order to prevent any vertical contaminant migration pathways. This depth is either into a confining layer or 50 feet below the vertical extent of the CEA.
CEA100026507	Evaluate Production Wells: Any proposed high capacity production wells in the immediate vicinity of the CEA/WRA should be pre-evaluated to determine if pumping from these wells would draw a portion of the contaminant plume into the cone of capture of the production wells or alter the configuration of the contaminant plume.
CEA100026507	Sample Potable Wells: Any potable well to be installed within the footprint of the CEA/WRA shall be sampled annually for the parameters of concern. The first sample shall be collected prior to using the well. If contamination is detected, contact your local Health Department. If the contamination is above the Safe Drinking Water Standards, then the NJDEP Hot Line should be called. Treatment is required for any well that has contamination above the Safe Drinking Water Standards.

Site Location

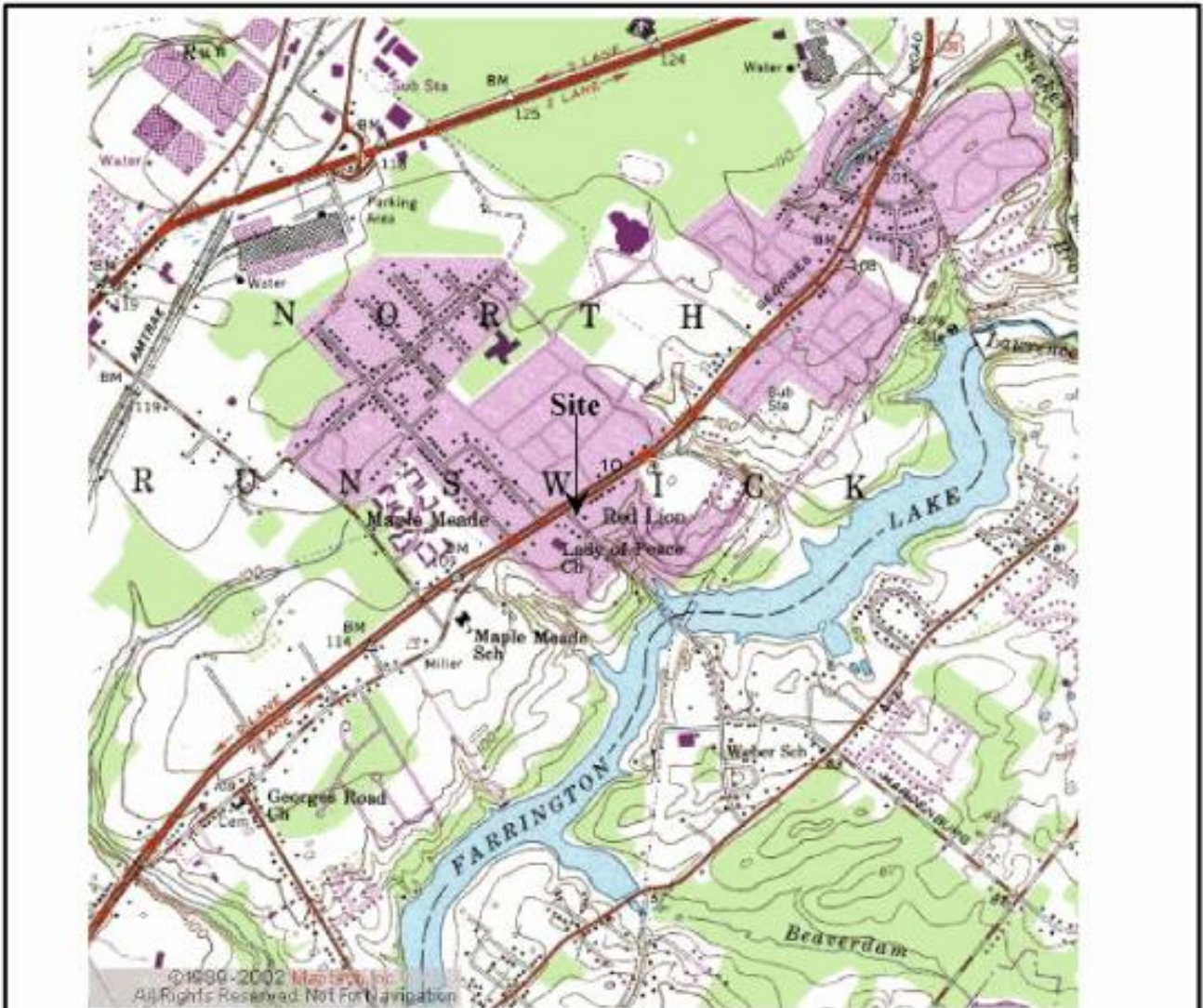

North Brunswick Quadrangle



0' 2030'
(approximate scale in feet)

Contour Interval: 10 feet
Photo Revised: 1981

ON-SITE ENVIRONMENTAL
114 Riverline Rd • Quakertown, PA 19208
Phone: 215-884-2577 • Fax: 215-884-2748

Drawing #	Date
File: Topo 10	8/12/16

Figure 1 Site Location

North Brunswick 0917
1696 Georges Road Rt 130
North Brunswick, New Jersey

CEA Boundaries

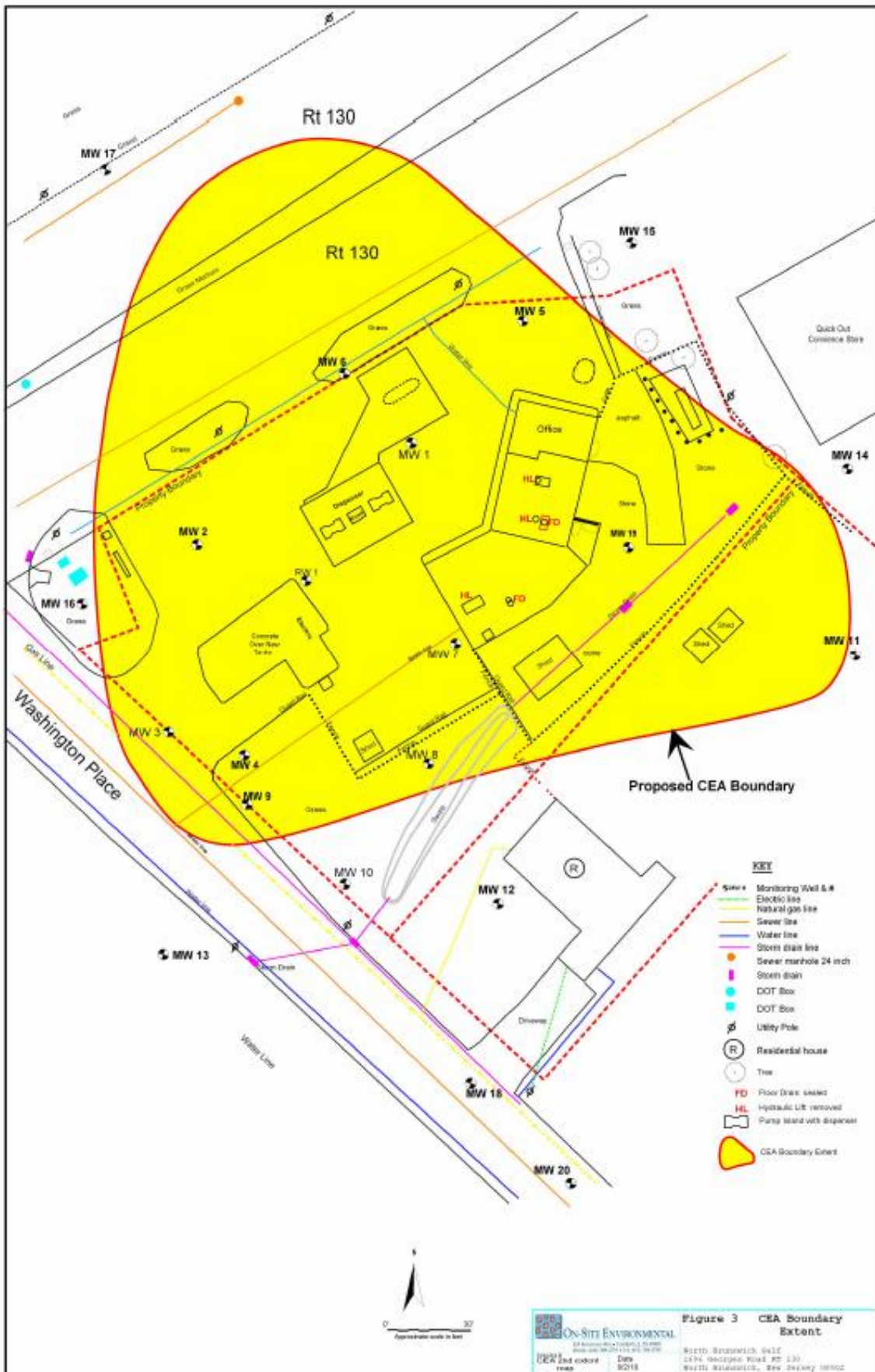

Figure 3 CEA Boundary Extent
ON-SITE ENVIRONMENTAL
 2018
 1274 GEORGETOWN ROAD, RT 130
 WASHINGTON PLACE, NEW BRUNSWICK, NJ 08902

