



**New Jersey Department of Environmental Protection  
Site Remediation Program**

**RECEPTOR EVALUATION FORM**

Non-LSRP (Existing Cases)    LSRP    Subsurface Evaluator

**RECEIN**  
FEB 27 2012  
Date Stamp  
(For Department use only)

**SECTION A. SITE NAME AND LOCATION**

Site Name: North Brunswick Gulf

List all AKAs: \_\_\_\_\_

Street Address: 1696 Georges Road RT 130

Municipality: North Brunswick (Township, Borough or City)

County: Middlesex Zip Code: 08902

Mailing Address if different than street address: \_\_\_\_\_

Program Interest (PI) Number(s): 010180 Case Tracking Number(s): 01-08-301546-07

The purpose of this form is to document the existence of receptors and the actions taken to protect receptors. A Receptor Evaluation (RE) is required unless an unrestricted remedial action is completed before the due date of the initial RE. At the time of the initial or interim RE the NJDEP acknowledges that the remedial investigation may not be fully complete. Complete the RE in accordance with requirements and timeframes in the Technical Requirements for Site Remediation and is an ongoing process as the extent of contamination is defined. The Receptor Evaluation should be submitted within the Mandatory Timeframes.

Initial RE Submission    Interim RE Submission  
 No Change (if no change, indicate last RE date and skip to Section G: \_\_\_\_\_)

**SECTION B. ON SITE AND SURROUNDING PROPERTY USE**

1. Identify any sensitive populations/uses that are currently on-site or surrounding property usage within 200 feet of the site boundary (check all that apply):

	On-site	Off-site
None of the following .....	<input type="checkbox"/>	<input type="checkbox"/>
Residences or residential property .....	<input type="checkbox"/>	<input checked="" type="checkbox"/>
Public or Private Schools grades K-12 .....	<input type="checkbox"/>	<input type="checkbox"/>
Child care centers .....	<input type="checkbox"/>	<input type="checkbox"/>
Public parks, playgrounds or other recreation areas .....	<input type="checkbox"/>	<input type="checkbox"/>
Other sensitive population use(s) Explain <u>on-site office in gas station</u> .....	<input checked="" type="checkbox"/>	<input type="checkbox"/>

If any of the above applies, attach a list of addresses, facility names, type of use, and a map depicting each location relative to the site.

2. Current site uses (check all that apply):

Industrial    Residential    Commercial    Agricultural  
 School or child care    Government    Park or recreational use  
 Vacant    Other: \_\_\_\_\_

3. Planned future site uses and off-site use within 200 ft of site boundary (check all that apply):

Industrial    Residential    Commercial    Agricultural  
 School or child care    Government    Park or recreational use  
 Vacant    Other: \_\_\_\_\_

Provide a map depicting the location of the proposed changes in land use.

**SECTION C. DESCRIPTION OF CONTAMINATION**

1. Identify if any of the following exist at the site (check all that apply):

Free product [N.J.A.C. 7:26E-1.8] identified is  LNAPL\* or  DNAPL\*\*. Date identified: \_\_\_\_\_

Residual product [N.J.A.C. 7:26E-1.8]

Other high concentration source materials not identified above (e.g., buried drums, containers, unsecured friable asbestos)

Explain: BTEX, MTBE, TBA, naphthalene, & lead in soil and BTEX, MTBE & TBA in groundwater

\* LNAPL – measured thickness of .01 feet or more

\*\*DNAPL – See US EPA DNAPL Overview

2. If this evaluation is submitted with a technical document that includes contaminant summary information, proceed to Section D. Otherwise attach a brief summary of all currently available data and information to be included in the site investigation or remedial investigation report.

**SECTION D. GROUND WATER USE**

1. Has the requirement for ground water sampling been triggered? .....  Yes  No  Unknown  
If "No," proceed to Section F. If "Unknown," explain: \_\_\_\_\_

2. Is Ground water contaminated above the Ground Water Remediation Standards [N.J.A.C.7:9C]? .....  Yes  No  Unknown

Or  Awaiting laboratory data with the expected due date: \_\_\_\_\_

If "Yes," provide the date that the laboratory data was available and confirmed contamination above the Ground Water Remediation Standards. Date: 08/30/2001

If "Unknown," explain: \_\_\_\_\_

If "No," or awaiting laboratory data proceed to Section F.

3. Has a well search been completed? .....  Yes  No

Date of most recent or updated well search: 03/24/2010

Identify if any of the following conditions exist based on the well search [N.J.A.C.7:26E-1.17(a)] (check all that apply):

Potable wells located within 1000 feet from the downgradient edge of the currently known extent of contamination.

Potable well located 250 feet upgradient or 500 feet side gradient of the currently known extent of contamination.

Ground water contamination is located within a wellhead protection area Tier 1 or Tier 2 (WHPA).

Tier: Identify if Tier 1  or Tier 2 .

4. Is a completed Well Search Spreadsheet or historical well search table attached and has an electronic copy of the spreadsheet been submitted to [srpgis@dep.state.nj.us](mailto:srpgis@dep.state.nj.us) .....  Yes  No

If "No," explain: \_\_\_\_\_

5. Are any private potable or irrigation wells located within 1/2 mile of the currently known extent of contamination? .....  Yes  No

If "Yes," was a door to door survey completed? .....  Yes  No

If survey was not completed explain: \_\_\_\_\_

6. Has sampling been conducted of  potable well(s) and /or  non-potable use well(s)? .....  Yes  No

If "No," provide justification then proceed to Section E.

No potable or irrigation wells found within 1,000 ft. of site during door to door survey

7. Has contamination been identified in potable well(s) above Ground Water Remediation Standards that is not suspected to be from the site? (If "Yes," provide justification) .....  Yes  No

8. Has contamination been identified in potable well(s) that is above the Ground Water Remediation Standards or Federal Drinking Water Standards? .....  Yes  No

Provide date laboratory data was received: \_\_\_\_\_

Or  awaiting laboratory data with the expected due date: \_\_\_\_\_

If "Yes" for potable well contamination **not attributable to background**, follow the IEC Guidance Document at [http://www.nj.gov/dep/srp/guidance/srra/iec\\_guidance\\_draft.pdf](http://www.nj.gov/dep/srp/guidance/srra/iec_guidance_draft.pdf) for required actions and answer the following:

Has an engineered system response action been completed on all receptors? .....  Yes  No  
Provide a brief narrative description:

Date completed: \_\_\_\_\_ NJDEP Case Manager: \_\_\_\_\_

9. Were Non-potable use well(s) sampled and results were above Class II Ground Water Remediation Standards? .....  Yes  No

Provide date laboratory data was received: \_\_\_\_\_

Or  awaiting laboratory data with the expected due date: \_\_\_\_\_

**SECTION E. VAPOR INTRUSION (VI)**

1. Contaminants present in ground water exceed Vapor Intrusion Ground Water Screening Levels that trigger a VI evaluation. (see NJDEP Vapor Intrusion Guidance)....  Yes  No  Unknown

Or  Awaiting laboratory data and the expected due date: \_\_\_\_\_

Provide the date that the laboratory data was available and confirmed contamination above the Vapor Intrusion Trigger Levels. Date: 10/19/2009

If "No," or awaiting laboratory data, proceed to Section F.

2. Was a site specific screening level developed for the evaluation of the VI pathway? .....  Yes  No

3. Identify and locate on a scaled map any structures/sensitive populations that exist within the following distances from ground water contamination with concentrations above the Vapor Intrusion Ground Water Screening Levels or specific threats (check all that apply):

- 30 feet of dissolved petroleum hydrocarbon contamination in ground water
- 100 feet of any free product or any non-petroleum dissolved volatile organic ground water contamination
- No structures exist within the specified distances

Other existing conditions

- Unsaturated zone contamination
- Landfills on or adjacent to site
- Elemental mercury
- Other \_\_\_\_\_
- Methanogenic conditions
- Elevated soil gas or indoor vapors
- Basement or sump contains contaminated ground water or product

4. The vapor intrusion pathway is a concern at or adjacent to the site (if "No," attach justification) .....  Yes  No

5. Has vapor intrusion sampling of the structure(s) been conducted? .....  Yes  No  N/A  
If "No," or "N/A," proceed to #10

6. Has indoor air sampling been conducted at the identified structure(s)? .....  Yes  No  
If "No," proceed to #10

7. Has indoor air contamination been identified but not suspected to be from the site? (if "Yes," attach justification) .....  Yes  No

8. Indoor air results were above the NJDEP's Vapor Intrusion Rapid Action Levels .....  Yes  No

Provide the date that the laboratory data was available and confirmed contamination above the Vapor Intrusion Rapid Action Levels. Date: \_\_\_\_\_

Or  Awaiting laboratory data with the expected due date: \_\_\_\_\_

If "Yes" to #8 above, follow the IEC Guidance Document at [http://www.nj.gov/dep/srp/guidance/srra/iec\\_guidance\\_draft.pdf](http://www.nj.gov/dep/srp/guidance/srra/iec_guidance_draft.pdf) for required actions.

The IEC receptor engineering system response for receptor control was implemented for all identified structures .....  Yes  No

Date: \_\_\_\_\_ NJDEP Case Manager: \_\_\_\_\_

9. Indoor air sampling was conducted and results were above the NJDEP's Indoor Air Screening Levels but at or below the proposed vapor intrusion Rapid Action Levels.....  Yes  No

Provide the date that the laboratory data was available. Date: \_\_\_\_\_

Or  Awaiting laboratory data with the expected due date: \_\_\_\_\_

If "Yes" to #9 above, answer the following:

Has the Vapor Concern Response Action Form notifying the NJDEP of the exceedances been submitted?.....  Yes  No

Date: \_\_\_\_\_

Has a plan to mitigate and monitor the exposure been submitted?.....  Yes  No

Date: \_\_\_\_\_

Has the Mitigation Response Action Report been submitted?.....  Yes  No

Date: \_\_\_\_\_

10. The vapor intrusion investigation is being completed and/or stepping out as part of the site investigation or remedial investigation. (If "No," attach justification).....  Yes  No

**SECTION F. ECOLOGICAL RECEPTORS**

1. Has a baseline Ecological Evaluation (BEE) has been conducted? [N.J.A.C. 7:26E-3.11] .....  Yes  No

Date conducted: 03/24/2010

2. Do the results of a BEE trigger a remedial investigation of ecological receptors? [N.J.A.C. 7:26E-4.7] ....  Yes  No

3. Has a remedial investigation of ecological receptors been conducted?.....  Yes  No

Date conducted: \_\_\_\_\_

4. Provide the name(s) of any surface water body on or within 200 feet of the site:  
none

5. Is free product or residual product located within 100 feet from an ecological receptor?.....  Yes  No

6. Does available data indicate an impact on ecological receptor(s), surface water or sediment? .....  Yes  No

**SECTION G. PERSON RESPONSIBLE FOR CONDUCTING THE REMEDIATION INFORMATION AND CERTIFICATION**

Full Legal Name of the Person Responsible for Conducting the Remediation: North Brunswick Gulf, Inc.

Representative First Name: Walter Representative Last Name: Lapp

Title: President

Phone Number: \_\_\_\_\_ Ext: \_\_\_\_\_ Fax: \_\_\_\_\_

Mailing Address: 1696 Georges Road Rt 130

City/Town: North Brunswick State: New Jersey Zip Code: 08902

Email Address: \_\_\_\_\_

This certification shall be signed by the person responsible for conducting the remediation who is submitting this notification in accordance with Administrative Requirements for the Remediation of Contaminated Sites rule at N.J.A.C. 7:26C-1.5(a).

*I certify under penalty of law that I have personally examined and am familiar with the information submitted herein, including all attached documents, and that based on my inquiry of those individuals immediately responsible for obtaining the information, to the best of my knowledge, I believe that the submitted information is true, accurate and complete. I am aware that there are significant civil penalties for knowingly submitting false, inaccurate or incomplete information and that I am committing a crime of the fourth degree if I make a written false statement which I do not believe to be true. I am also aware that if I knowingly direct or authorize the violation of any statute, I am personally liable for the penalties.*

Signature: Walter Lapp Sr.

Date: 2-4-12

Name/Title: Walter Lapp Sr., President

No Changes Since Last Submittal

**SECTION H. NON-LSRP SITE REMEDIATION PROFESSIONAL STATEMENT**

First Name: \_\_\_\_\_ Last Name: \_\_\_\_\_  
Phone Number: \_\_\_\_\_ Ext: \_\_\_\_\_ Fax: \_\_\_\_\_  
Mailing Address: \_\_\_\_\_  
City/Town: \_\_\_\_\_ State: \_\_\_\_\_ Zip Code: \_\_\_\_\_  
Email Address: \_\_\_\_\_  
*I believe that the information contained herein, and including all attached documents, is true, accurate and complete.*  
Signature: \_\_\_\_\_ Date: \_\_\_\_\_  
Name/Title: \_\_\_\_\_ **No Changes Since Last Submittal**   
Company Name: \_\_\_\_\_

Submit this form to the assigned case manager, municipal clerk and designate health department. If there is no assigned case manager, submit this form to:

Bureau of Case Assignment & Initial Notice  
Site Remediation Program  
NJ Department of Environmental Protection  
401-05H  
PO Box 420  
Trenton, NJ 08625-0420

**SECTION H. LICENSED SITE REMEDIATION PROFESSIONAL INFORMATION AND STATEMENT**

LSRP ID Number: 519420

First Name: Frank

Last Name: Jasiulewicz

Phone Number: (610) 384-2719

Ext: \_\_\_\_\_

Fax: (610) 384-2709

Mailing Address: 119 Shepherds Way

City/Town: Coatesville

State: Pa.

Zip Code: 19320

Email Address: onsitefj@aol.com

This statement shall be signed by the LSRP who is submitting this notification in accordance with SRRA Section 16 d. and Section 30 b.2.

*I certify that I am a Licensed Site Remediation Professional authorized pursuant to N.J.S.A. 58:10C to conduct business in New Jersey. As the Licensed Site Remediation Professional of record for this remediation, I:*

**[SELECT ONE OR BOTH OF THE FOLLOWING AS APPLICABLE]:**

*directly oversaw and supervised all of the referenced remediation, and/or*

*personally reviewed and accepted all of the referenced remediation presented herein.*

*I believe that the information contained herein, and including all attached documents, is true, accurate and complete.*

*It is my independent professional judgment and opinion that the remediation conducted at this site, as reflected in this submission to the Department, conforms to, and is consistent with, the remediation requirements in N.J.S.A. 58:10C-14.*

*My conduct and decisions in this matter were made upon the exercise of reasonable care and diligence, and by applying the knowledge and skill ordinarily exercised by licensed site remediation professionals practicing in good standing, in accordance with N.J.S.A. 58:10C-16, in the State of New Jersey at the time I performed these professional services.*

*I am aware pursuant to N.J.S.A. 58:10C-17 that for purposely, knowingly or recklessly submitting false statement, representation or certification in any document or information submitted to the board or Department, etc., that there are significant civil, administrative and criminal penalties, including license revocation or suspension, fines and being punished by imprisonment for conviction of a crime of the third degree.*

LSRP Signature: \_\_\_\_\_

**Frank Jasiulewicz**

Digitally signed by Frank Jasiulewicz  
DN: cn=Frank Jasiulewicz, o=On-Site Environmental, Inc., ou  
email=onsitefj@aol.com, c=US  
Date: 2012.02.20 13:35:04 -05'00'

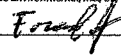

Date: 1/24/12

2-20-12

LSRP Name/Title: Frank Jasiulewicz/President

**No Changes Since Last Submittal**

Company Name: On-Site Environmental, Inc.

Submit this form to the assigned case manager, municipal clerk and designate health department. If there is no assigned case manager, submit this form to:

Bureau of Case Assignment & Initial Notice  
Site Remediation Program  
NJ Department of Environmental Protection  
401-05H  
PO Box 420  
Trenton, NJ 08625-0420

**SECTION H. SUBSURFACE EVALUATOR UST REPORT CERTIFICATION FORM**

*I certify under penalty of law that the work was performed under my oversight and I have reviewed the report and all attached documents, and the submitted information is true, accurate and complete in accordance with the requirements of N.J.A.C. 7:14B and N.J.A.C. 7:26E. I am aware that there are significant civil and criminal penalties for submitting false, inaccurate or incomplete information including fines and/or imprisonment.*

Name: _____	UST Cert. No.: _____
Firm: _____	Firm's UST Cert. Number: _____
Firm Address: _____	
City/Town: _____	State: _____ Zip Code: _____
Phone Number: _____	Ext: _____ Fax: _____
Signature: _____	Date: _____
<b>No Changes Since Last Submittal</b> <input type="checkbox"/>	

Submit this form to the assigned case manager, municipal clerk and designate health department. If there is no assigned case manager, submit this form to:

Bureau of Case Assignment & Initial Notice  
Site Remediation Program  
NJ Department of Environmental Protection  
401-05H  
PO Box 420  
Trenton, NJ 08625-0420

## Supplemental Information for Receptor Evaluation Form

### Section B: #1: OnSite & Surrounding Property Use

- **Table 1:** Presents Properties within 200 feet of the site.
- **Figure 1:** Tax Map showing locations within 200 feet of the site.

### Section C: #2: Description of Contamination

Remedial investigations at the site were initiated in 2001 in response to a damaged underground storage tank that stored unleaded gasoline. The site has been a gasoline service station for approximately 45 years and facility operations may have contributed to the contamination. Since 2001 approximately 71 soil borings were installed, 167 soil samples were analyzed, and 16 groundwater monitoring wells have been installed and sampled to evaluate the contamination at the site. That information indicates that :

- There are concentrations of gasoline constituents in soil above the current residential direct contact soil standards. The compounds detected above the RDCS include benzene, naphthalene and lead. Although the extent of the naphthalene and lead in soil above the residential direct contact soil standards has not been totally defined to date the existing data indicates it does not extend off site. **Figure 2, 3 and 4** show the inferred extent of benzene, naphthalene and lead above the RDCS, respectively.
- There are concentrations of gasoline constituents in soil above the NJDEP default soil to groundwater screening levels. Those compounds include: BTEX, MTBE, naphthalene and lead. Since the laboratory detection levels for benzene, TBA and MTBE in a number of samples were higher than the default screening levels, the extent of soil above the default soil to groundwater screening levels has not been totally defined. **Figure 2, 3 and 4** show the inferred extent of benzene, naphthalene and lead above the default soil to groundwater screening levels, respectively.
- The extent of the groundwater plume has been defined and extends off site. In summary, the plume extends approximately 50 feet to the north beneath Rt. 130 and approximately 35 feet past the property boundary to the east and south. The compounds in groundwater above the NJDEP GWQS include BTEX, Naphthalene, MTBE, and TBA. **Figure 5** shows the extent of the benzene, MTBE and TBA groundwater plumes.

### Section D: # 4: Ground Water Use

**Table 2:** Presents Well Search Information for Searches Performed in 2002 and 2010.

### Section E # 3:

**Figure 6:** Map showing properties/sensitive populations within 30 feet of dissolved petroleum hydrocarbon contamination in groundwater with concentrations above vapor intrusion groundwater screening levels.

Table 1: Properties within 200 feet of North Brunswick Gulf Station & Mailing List that Received Notification Letters

Block	Lot	Occupant	Property Address	Township	State	Zip Code	Owner Name	Owner Address	City	State	Zip Code	Type of Use
230	15	WOODED LOT	RT 130 (WOODED LOT)	NORTHBRUNSWICK	NJ	08902	Labarbera Santo o/e S. Childs	101 CRICKET HILL CIRCLE	Princeton	NJ	08540	Vacant
230	16	FRIENDLY RENTAL	1709 RT 130	NORTHBRUNSWICK	NJ	08902	Calvert Associates LLC	PO BOX 1021	MT LAUREL	NJ	08054	Equipment Rental
230	17	FRIENDLY RENTAL	1709 RT 130	NORTHBRUNSWICK	NJ	08902	Calvert Associates LLC	PO BOX 1021	MT LAUREL	NJ	08054	Equipment Rental
278	1,01	AMEDURI CHRISTOPHER J & MICHELE	1675 KUNDES STREET	NORTHBRUNSWICK	NJ	08902	Same as Occupant	1675 KUNDES STREET	NORTHBRUNSWICK	NJ	08902	Residential
278	1	VALET DRY CLEANERS	1674 RT 130	NORTHBRUNSWICK	NJ	08902	Jacob Krauszer	18 MULBERRY LANE	EDISON	NJ	08820	Dry Cleaner
278	1	QUIK OUT (CONVENIENCE STORE)	1674 RT 130	NORTHBRUNSWICK	NJ	08902	Jacob Krauszer	18 MULBERRY LANE	EDISON	NJ	08820	Convenience store
278	2	CARIAN CARBAJAL & ULYSSES GONZALEZ	1670 RT 130	NORTHBRUNSWICK	NJ	08902	Roy & Amy Chereath	2 JUMPING BROOKE	MONROE	NJ	08831	Convenience store
278	3	DAMATO JOSEPH & KATHLEEN	1660 RT 130	NORTHBRUNSWICK	NJ	08902	Same as Occupant	1660 RT 130	NORTHBRUNSWICK	NJ	08902	Residential
278	4	DAMATO JOSEPH & KATHLEEN	1665 KUNDES STREET	NORTHBRUNSWICK	NJ	08902	Same as Occupant	1665 KUNDES STREET	NORTHBRUNSWICK	NJ	08902	Residential
278	28	CONLIN MARK J & KATHLEEN M	1680 KUNDES STREET	NORTHBRUNSWICK	NJ	08902	Same as Occupant	1680 KUNDES STREET	NORTHBRUNSWICK	NJ	08902	Residential
278	35	RAVENS JUAN R & LUCILLE	321 WASHINGTON PLACE	NORTHBRUNSWICK	NJ	08902	Same as Occupant	321 WASHINGTON PLACE	NORTHBRUNSWICK	NJ	08902	Residential
282	1	NORTH BRUNSWICK GULF	1696 GEORGES RD RT 130	NORTHBRUNSWICK	NJ	08902	Walter Lapp Sr.	1696 GEORGES RD RT 130	NORTHBRUNSWICK	NJ	08902	Service Station
282	2	THOMAS & ANA CSEPEP	1686 GEORGES RD RT 130	NORTHBRUNSWICK	NJ	08902	Tennant	1686 GEORGES RD RT 130	NORTHBRUNSWICK	NJ	08902	Residential
282	3	ZHANG RONGSHU	359 WASHINGTON PLACE	NORTHBRUNSWICK	NJ	08902	Same as Occupant	359 WASHINGTON PLACE	NORTHBRUNSWICK	NJ	08902	Residential backyard
282	4	CASSELLA DAVID	335 WASHINGTON PLACE	NORTHBRUNSWICK	NJ	08902	Same as Occupant	1685 KUNDES STREET	NORTHBRUNSWICK	NJ	08902	Residential
282	5	THOMAS & ANA CSEPEP	359 WASHINGTON PLACE	NORTHBRUNSWICK	NJ	08902	Same as Occupant	335 WASHINGTON PLACE	NORTHBRUNSWICK	NJ	08902	Residential
283	1	GETTY SERVICE STATION	1710 RT 130	NORTHBRUNSWICK	NJ	08902	Giovanni & Dolores Pernice	358 WASHINGTON PLACE	NORTHBRUNSWICK	NJ	08902	Residential
283	1	ENTERPRISE RENT-A-CAR	1710 RT 130	NORTHBRUNSWICK	NJ	08902	Giovanni & Dolores Pernice	12 PINE VALLEY LANE	MONROE	NJ	08831	Service Station
283	2	LUZACK DENISE	368 WASHINGTON PLACE	NORTHBRUNSWICK	NJ	08902	Same as Occupant	12 PINE VALLEY LANE	MONROE	NJ	08831	Car Rental
283	3	ALZATE JORGE & HARUMI ROXANA	360 WASHINGTON PLACE	NORTHBRUNSWICK	NJ	08902	Same as Occupant	368 WASHINGTON PLACE	NORTHBRUNSWICK	NJ	08902	Residential
283	4,01	MATTEI RICHARD J & MARY M	355 WASHINGTON PLACE	NORTHBRUNSWICK	NJ	08902	Same as Occupant	360 WASHINGTON PLACE	NORTHBRUNSWICK	NJ	08902	Residential
283	4,02	PEDDI RAVINDRA & KAVITHA	333 HARDING AVENUE	NORTHBRUNSWICK	NJ	08902	Same as Occupant	356 WASHINGTON PLACE	NORTHBRUNSWICK	NJ	08902	Residential
283	5	STORAGE YARD FOR LOT 1	HARDING AVE (STORAGE YARD)	NORTHBRUNSWICK	NJ	08902	Giovanni & Dolores Pernice	333 HARDING AVENUE	NORTHBRUNSWICK	NJ	08902	Residential
283	5	STORAGE YARD FOR LOT 1	HARDING AVE (STORAGE YARD)	NORTHBRUNSWICK	NJ	08902	Giovanni & Dolores Pernice	12 PINE VALLEY LANE	MONROE	NJ	08831	Storage yard for lot 1

Table 2: Well Search Information from Searches Performed in 2002 & 2010

WELL PERMIT NUM	WELL TYPE	LOCATION ADDRESS	COUNTY	MUNICIPALITY	COMU	BLOCK	LOT	X	Y	COORD METHOD	FINISHED_DEPTH	OPEN INTER	STATIC LEVEL	STATUS
2800039	Domestic	65 Wood Ave	Middlesex	Middlesex Boro	1211	228	1	498228	586963	OTHER STATE COORD	64	36.88	7	
2800097	Domestic	East Brunswick Twp	Middlesex	East Brunswick Twp	1204	309.02	4.0	501319	582567	OTHER STATE COORD	107	22.88	32	
2800041	Domestic	Hardenburg Lane	Middlesex	East Brunswick Twp	1204	307.12	2.11	502597.7	584118.8	OTHER STATE COORD	81	40	16	
2800050	Domestic	East Brunswick Twp	Middlesex	East Brunswick Twp	1204	309.03	27.25	501615.2	584118.4	OTHER STATE COORD	87.5	37.5	13	
2800057	Domestic	North Brunswick Twp.	Middlesex	North Brunswick Twp	1215	262	136.18	502596.6	586749.7	OTHER STATE COORD	130	44.86	14	
2800060	Domestic	East Brunswick Twp	Middlesex	East Brunswick Twp	1204	262	120	501514.7	585433.8	OTHER STATE COORD	109	43.88	19	
2800037	Domestic	North Brunswick Twp.	Middlesex	North Brunswick Twp	1215	230	23	498040.5	586748.5	OTHER STATE COORD	242	78.8	10	
2800043	Domestic	North Brunswick Twp.	Middlesex	North Brunswick Twp	1215	143.10	7	500508.7	588165.5	OTHER STATE COORD	153	38.5	26	
2800081	Domestic	North Brunswick Twp.	Middlesex	North Brunswick Twp	1215	262	120	501514.7	585433.8	OTHER STATE COORD	91.83	39.5	14	
2800092	Domestic	North Brunswick Twp.	Middlesex	North Brunswick Twp	1215	235	11	500509.2	586748.9	OTHER STATE COORD	57	34	14	
2800116	Domestic	409555 743430	Middlesex	East Brunswick Twp	1204	307.12	12	498422.8	582802	OTHER STATE COORD	99	20	40	
2800150	Domestic	East Brunswick Twp	Middlesex	East Brunswick Twp	1212	307.12	2.11	503602.9	584119.3	OTHER STATE COORD	88.5	59	20	
2800788	Garage	Milltown	Middlesex	Milltown Boro	1212	274	9	503601	588166.7	OTHER STATE COORD	150	28	10	
2800833	Domestic	East Brunswick Twp	Middlesex	East Brunswick Twp	1204	307.12	2.11	502597.7	584118.8	OTHER STATE COORD	72	37.3	17	
2801023	discontinued	Fresh Pond Rd Milltown	Middlesex	Milltown Boro	1212	146	98.02	495411.7	586747.8	OTHER STATE COORD	100	44	30	
2801494	Domestic	Milltown	Middlesex	Milltown Boro	1212	274	9	503501	588166.7	OTHER STATE COORD	82	28	34	
2801913	Industrial	East Brunswick Twp	Middlesex	East Brunswick Twp	1204	274	9	503961	588166.7	OTHER STATE COORD	90	28	3	
2802999	Domestic	Adams Station	Middlesex	East Brunswick Twp	1204	221	10	498421.8	586748.2	OTHER STATE COORD	50	20	12	
2802801	Domestic	Adam Lane	Middlesex	North Brunswick Twp	1215	307.12	2.11	498411.7	586747.8	OTHER STATE COORD	100	20	12	
2803682	Domestic	Milltown	Middlesex	Milltown Boro	1212	275	6	502596	588166.3	OTHER STATE COORD	82	26	8	
2804170	Domestic	North Brunswick Twp	Middlesex	North Brunswick Twp	1215	307.12	2.11	498411.7	586747.8	OTHER STATE COORD	150	61	10	
2815692	Domestic	Block 227 Lot 17.1 should be 17.03	Middlesex	North Brunswick Twp	1215	227 or 221	17.03 or 19	498040.5	588040.1	OTHER STATE COORD	150	61	10	
2817626	Public	Greenbrook Twp	Middlesex	Greenbrook Twp	143	162		500044.6	588772.4	OTHER STATE COORD	200	52	60	
2821308	Domestic	RTE 130	Middlesex	North Brunswick Twp	1215	219	35	497416.7	586748	OTHER STATE COORD	200	60	20	
2827289	Monitoring	J/S Landfill RI 535	Middlesex	South Brunswick Twp	1221	309.03	26.01	501434	583408	OTHER STATE COORD	56	45	40	
2827989	Monitoring	J/S Landfill RI 535	Middlesex	South Brunswick Twp	1221	309.03	26.01	501434	583408	OTHER STATE COORD	132	120	120	
2827989	Monitoring	J/S Landfill RI 535	Middlesex	South Brunswick Twp	1221	309.03	26.01	501434	583408	OTHER STATE COORD	135	120	78	
2827987	Monitoring	J/S Landfill RI 535	Middlesex	South Brunswick Twp	1221	309.03	26.01	501434	583408	OTHER STATE COORD	135	120	78	
2827962	pleasometer	277 Washington Place	Middlesex	North Brunswick Twp	1215	286	1	498421.8	586748.2	OTHER STATE COORD	45.6	20	5	
2829497	Monitoring	Block 73 & 601 Lot C & 2C	Middlesex	North Brunswick Twp	1215	275 or 73 & 61 or 1C & 2		502598	588166.3	OTHER STATE COORD	20	5	7	
2828498	Monitoring	Block 73 & 601 Lot C & 2C	Middlesex	North Brunswick Twp	1215	275 or 73 & 61 or 1C & 2		502598	588166.3	OTHER STATE COORD	20	5	7	
2828498	Monitoring	Block 73 & 601 Lot C & 2C	Middlesex	North Brunswick Twp	1215	275 or 73 & 61 or 1C & 2		502598	588166.3	OTHER STATE COORD	20	5	7	
2828498	Monitoring	Block 73 & 601 Lot C & 2C	Middlesex	North Brunswick Twp	1215	275 or 73 & 61 or 1C & 2		502598	588166.3	OTHER STATE COORD	20	5	7	
2828498	Monitoring	Block 73 & 601 Lot C & 2C	Middlesex	North Brunswick Twp	1215	275 or 73 & 61 or 1C & 2		502598	588166.3	OTHER STATE COORD	20	5	7	
2828498	Monitoring	Block 73 & 601 Lot C & 2C	Middlesex	North Brunswick Twp	1215	275 or 73 & 61 or 1C & 2		502598	588166.3	OTHER STATE COORD	20	5	7	
2828498	Monitoring	Block 73 & 601 Lot C & 2C	Middlesex	North Brunswick Twp	1215	275 or 73 & 61 or 1C & 2		502598	588166.3	OTHER STATE COORD	20	5	7	
2828498	Monitoring	Block 73 & 601 Lot C & 2C	Middlesex	North Brunswick Twp	1215	275 or 73 & 61 or 1C & 2		502598	588166.3	OTHER STATE COORD	20	5	7	
2828498	Monitoring	Block 73 & 601 Lot C & 2C	Middlesex	North Brunswick Twp	1215	275 or 73 & 61 or 1C & 2		502598	588166.3	OTHER STATE COORD	20	5	7	
2828498	Monitoring	Block 73 & 601 Lot C & 2C	Middlesex	North Brunswick Twp	1215	275 or 73 & 61 or 1C & 2		502598	588166.3	OTHER STATE COORD	20	5	7	
2828498	Monitoring	Block 73 & 601 Lot C & 2C	Middlesex	North Brunswick Twp	1215	275 or 73 & 61 or 1C & 2		502598	588166.3	OTHER STATE COORD	20	5	7	
2828498	Monitoring	Block 73 & 601 Lot C & 2C	Middlesex	North Brunswick Twp	1215	275 or 73 & 61 or 1C & 2		502598	588166.3	OTHER STATE COORD	20	5	7	
2828498	Monitoring	Block 73 & 601 Lot C & 2C	Middlesex	North Brunswick Twp	1215	275 or 73 & 61 or 1C & 2		502598	588166.3	OTHER STATE COORD	20	5	7	
2828498	Monitoring	Block 73 & 601 Lot C & 2C	Middlesex	North Brunswick Twp	1215	275 or 73 & 61 or 1C & 2		502598	588166.3	OTHER STATE COORD	20	5	7	
2828498	Monitoring	Block 73 & 601 Lot C & 2C	Middlesex	North Brunswick Twp	1215	275 or 73 & 61 or 1C & 2		502598	588166.3	OTHER STATE COORD	20	5	7	
2828498	Monitoring	Block 73 & 601 Lot C & 2C	Middlesex	North Brunswick Twp	1215	275 or 73 & 61 or 1C & 2		502598	588166.3	OTHER STATE COORD	20	5	7	
2828498	Monitoring	Block 73 & 601 Lot C & 2C	Middlesex	North Brunswick Twp	1215	275 or 73 & 61 or 1C & 2		502598	588166.3	OTHER STATE COORD	20	5	7	
2828498	Monitoring	Block 73 & 601 Lot C & 2C	Middlesex	North Brunswick Twp	1215	275 or 73 & 61 or 1C & 2		502598	588166.3	OTHER STATE COORD	20	5	7	
2828498	Monitoring	Block 73 & 601 Lot C & 2C	Middlesex	North Brunswick Twp	1215	275 or 73 & 61 or 1C & 2		502598	588166.3	OTHER STATE COORD	20	5	7	
2828498	Monitoring	Block 73 & 601 Lot C & 2C	Middlesex	North Brunswick Twp	1215	275 or 73 & 61 or 1C & 2		502598	588166.3	OTHER STATE COORD	20	5	7	
2828498	Monitoring	Block 73 & 601 Lot C & 2C	Middlesex	North Brunswick Twp	1215	275 or 73 & 61 or 1C & 2		502598	588166.3	OTHER STATE COORD	20	5	7	
2828498	Monitoring	Block 73 & 601 Lot C & 2C	Middlesex	North Brunswick Twp	1215	275 or 73 & 61 or 1C & 2		502598	588166.3	OTHER STATE COORD	20	5	7	
2828498	Monitoring	Block 73 & 601 Lot C & 2C	Middlesex	North Brunswick Twp	1215	275 or 73 & 61 or 1C & 2		502598	588166.3	OTHER STATE COORD	20	5	7	
2828498	Monitoring	Block 73 & 601 Lot C & 2C	Middlesex	North Brunswick Twp	1215	275 or 73 & 61 or 1C & 2		502598	588166.3	OTHER STATE COORD	20	5	7	
2828498	Monitoring	Block 73 & 601 Lot C & 2C	Middlesex	North Brunswick Twp	1215	275 or 73 & 61 or 1C & 2		502598	588166.3	OTHER STATE COORD	20	5	7	
2828498	Monitoring	Block 73 & 601 Lot C & 2C	Middlesex	North Brunswick Twp	1215	275 or 73 & 61 or 1C & 2		502598	588166.3	OTHER STATE COORD	20	5	7	
2828498	Monitoring	Block 73 & 601 Lot C & 2C	Middlesex	North Brunswick Twp	1215	275 or 73 & 61 or 1C & 2		502598	588166.3	OTHER STATE COORD	20	5	7	
2828498	Monitoring	Block 73 & 601 Lot C & 2C	Middlesex	North Brunswick Twp	1215	275 or 73 & 61 or 1C & 2		502598	588166.3	OTHER STATE COORD	20	5	7	
2828498	Monitoring	Block 73 & 601 Lot C & 2C	Middlesex	North Brunswick Twp	1215	275 or 73 & 61 or 1C & 2		502598	588166.3	OTHER STATE COORD	20	5	7	
2828498	Monitoring	Block 73 & 601 Lot C & 2C	Middlesex	North Brunswick Twp	1215	275 or 73 & 61 or 1C & 2		502598	588166.3	OTHER STATE COORD	20	5	7	
2828498	Monitoring	Block 73 & 601 Lot C & 2C	Middlesex	North Brunswick Twp	1215	275 or 73 & 61 or 1C & 2		502598	588166.3	OTHER STATE COORD	20	5	7	
2828498	Monitoring	Block 73 & 601 Lot C & 2C	Middlesex	North Brunswick Twp	1215	275 or 73 & 61 or 1C & 2		502598	588166.3	OTHER STATE COORD	20	5	7	
2828498	Monitoring	Block 73 & 601 Lot C & 2C	Middlesex	North Brunswick Twp	1215	275 or 73 & 61 or 1C & 2		502598	588166.3	OTHER STATE COORD	20	5	7	
2828498	Monitoring	Block 73 & 601 Lot C & 2C	Middlesex	North Brunswick Twp	1215	275 or 73 & 61 or 1C & 2		502598	588166.3	OTHER STATE COORD	20	5	7	
2828498	Monitoring	Block 73 & 601 Lot C & 2C	Middlesex	North Brunswick Twp	1215	275 or 73 & 61 or 1C & 2		502598	588166.3	OTHER STATE COORD	20	5	7	
2828498	Monitoring	Block 73 & 601 Lot C & 2C	Middlesex	North Brunswick Twp	1215	275 or 73 & 61 or 1C & 2		502598	588166.3	OTHER STATE COORD	20	5	7	
2828498	Monitoring	Block 73 & 601 Lot C & 2C	Middlesex	North Brunswick Twp	1215	275 or 73 & 61 or 1C & 2		502598	588166.3	OTHER STATE COORD	20	5	7	
2828498	Monitoring	Block 73 & 601 Lot C & 2C	Middlesex	North Brunswick Twp	1215	275 or 73 & 61 or 1C & 2		502598	588166.3	OTHER STATE COORD	20	5	7	
2828498	Monitoring	Block 73 & 601 Lot C & 2C	Middlesex	North Brunswick Twp	1215	275 or 73 & 61 or 1C & 2		502598	588166.3	OTHER STATE COORD	20	5	7	
2828498	Monitoring	Block 73 & 601 Lot C & 2C	Middlesex	North Brunswick Twp	1215	275 or 73 & 61 or 1C & 2		502598	588166.3	OTHER STATE COORD	20	5	7	
2828498	Monitoring	Block 73 & 601 Lot C & 2C	Middlesex	North Brunswick Twp	1215	275 or 73 & 61 or 1C & 2		502598	588166.3	OTHER STATE COORD	20	5	7	
2828498	Monitoring	Block 73 & 601 Lot C & 2C	Middlesex	North Brunswick Twp	1215	275 or 73 & 61 or 1C & 2		502598	588166.3	OTHER STATE COORD	20	5	7	
2828498	Monitoring	Block 73 & 601 Lot C & 2C	Middlesex	North Brunswick Twp	1215	275 or 73 & 61 or 1C & 2		502598	588166.3	OTHER STATE COORD	20	5	7	
2828498	Monitoring	Block 73 & 601 Lot C & 2C	Middlesex	North Brunswick Twp	1215	275 or 73 & 61 or 1C & 2		502598						

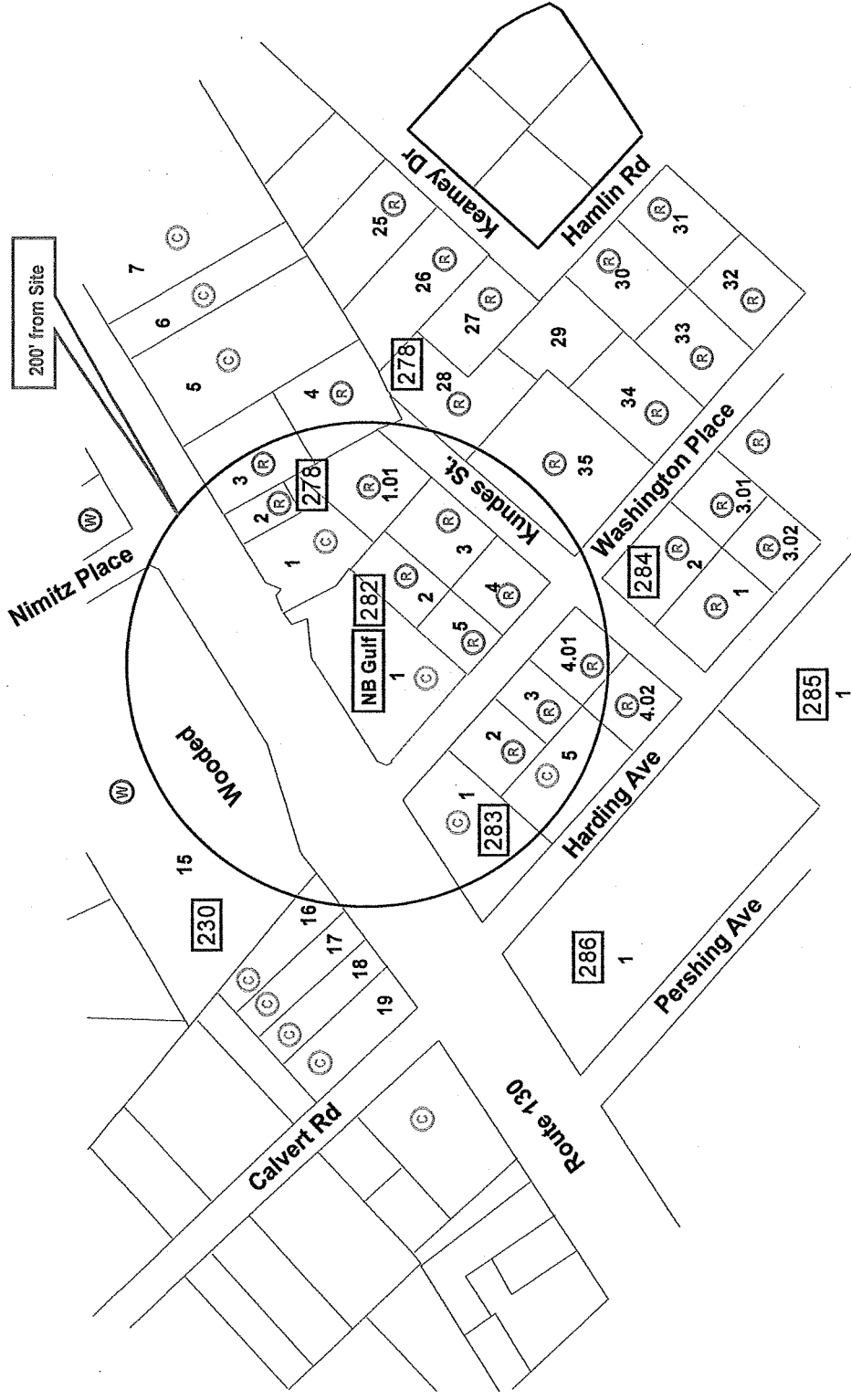

- KEY**
- Residential Property
  - Commercial Property
  - Wooded
  - Block
  - Lot



**RedHawk Environmental**  
 169 York Road  
 Bridgewater, NJ 08803  
 File: 169016P.dwg Date: 8/11/10

**Figure 1 Tax Map**  
 North Brunswick Golf  
 1696 Georges Road Rt. 139  
 North Brunswick, New Jersey

30 feet from groundwater with concentrations above vapor intrusion screening levels for groundwater

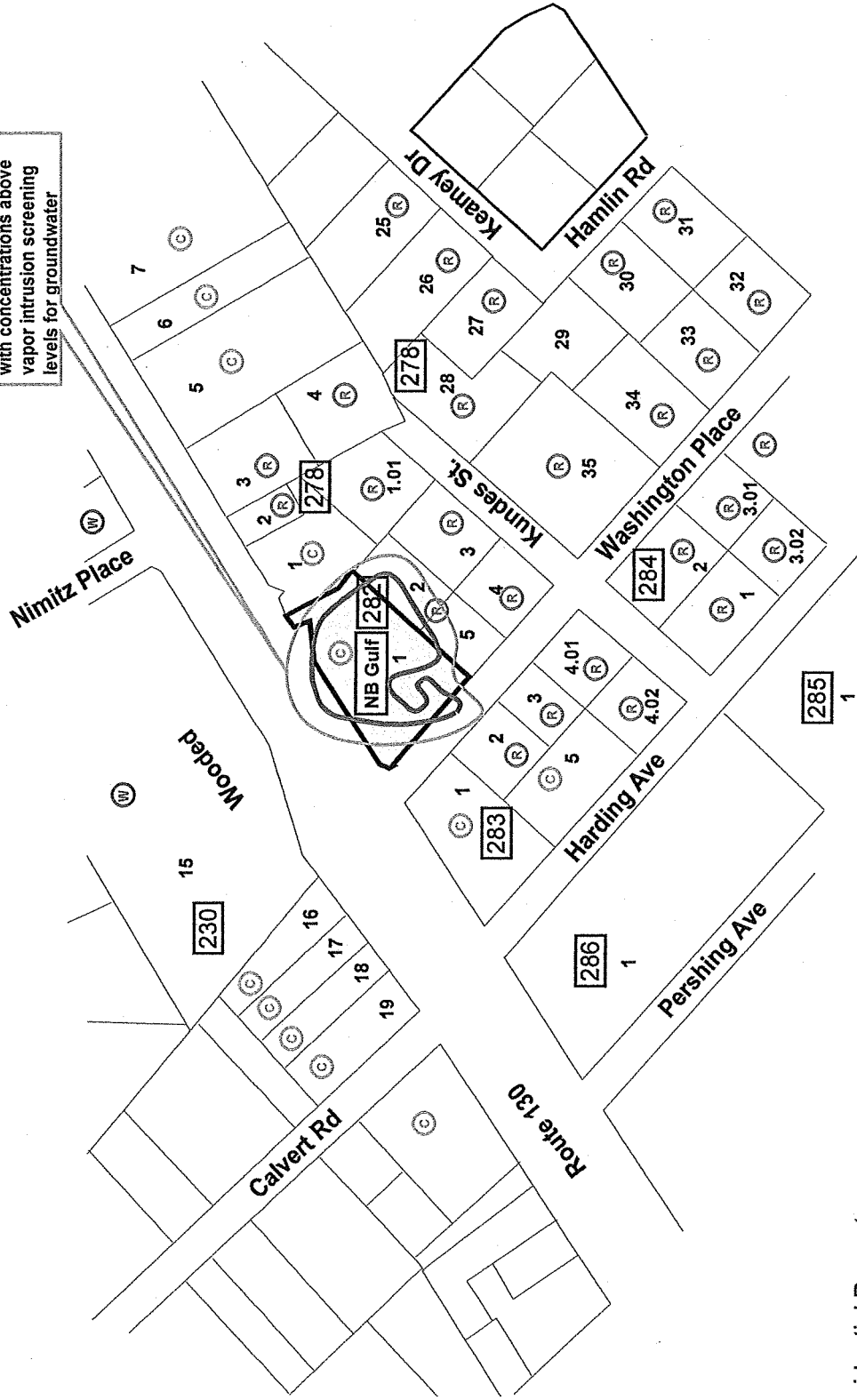

- KEY**
- (R) Residential Property
  - (C) Commercial Property
  - (W) Wooded
  - 4208 Block
  - 2 Lot



Approximate Extent of Impacts above Vapor Intrusion Screening Levels for Groundwater

